

DIVISION OF FORESTRY & WILDLIFE
Hilo Arboretum
PLANT IDENTIFICATION GUIDE



QUICK LOOK

Arboretum Plants by Type

Many of the arboretum trees have multiple uses and are sorted here by their primary use. Food plants might be eaten alone or used for seasoning. Landscape plants may be ornamental, shade trees, or windbreaks. Timber trees can be used for their hard wood or for their beautiful grain. Plants sorted into the 'other' category have unique uses like traditional crafts or medicine.

Food

4. Tamarind, *Tamarindus indica*
10. Avocado, *Persia americana*
12. Surinam Cherry, *Eugenia uniflora*
14. Cinnamon, *Cinnamomum burmanii*
25. Star Apple, *Chrysophyllum cainito*
30. Ice cream Bean, *Inga edulis*
32. Orange, *Citrus sinensis*
31. Fig, *Ficus carica*
33. Honey Tangerine, *Citrus reticulata* x *sinensis* var. *Murcott*
34. Thornless Tangerine, *Citrus tangerina*
35. Calamansi, *Citrofortunella microcarpa*
36. Lychee, *Litchi chinensis*
39. Macadamia Nut, *Macadamia tetraphylla*
41. Durian, *Durio spp*
45. Baobab, *Adansonia spp*
46. Malabar Chestnut, *Pachira aquatica*
47. Breadnut, *Artocarpus camansi*
50. Santol, *Sandoricum koetjape*
56. Mango, *Mangifera indica*
59. Alupag, *Dimocarpus didyma*
60. Sapucacia Nut, *Lecythis zabuajo*
66. Jackfruit, *Artocarpus heterophyllus*
71. African Fan Palm, *Brosius aethiopum*
74. Ulu (Rare Autia), *Artocarpus altilis*
81. Wampi, *Clausena lansing*
88. Cacao, *Theobroma cacao*
95. Lemon Drop Mangosteen, *Garcinia intermedia*
96. Coconut, *Cocos nucifera*
97. White Sapote, *Cassimiroa edulis*
98. Atemoya, *Annona x atemoya*
99. Peach Palm, *Bactris gasipaes*
100. Pineapple Guava, *Acca sellowiana*

102. Sour Mangosteen, *Garcinia dulces*
103. Mangosteen, *Garcinia mangostana*
105. Lemon, *Citrus limon*
104. Jabong (Pomelo), *Citrus maxima*
107. Jaboticaba, *Plinia cauliflora*
110. Pulasan, *Nephelium rambutan-ake*
111. Mulberry, *Morus spp*
113. Rambutan, *Nephelium lappaceum*
122. Abiu, *Pouteria caimito*
123. Canistel, *Pouteria campechiana*
124. Bilimbi, *Averrhoa bilimbi*
130. Unknown citrus, *Citrus spp*

Landscape

1. Royal Palm (row), *Roystonea regia*
2. Bird of Paradise, *Strelitzia alba*
3. Ixora, *Ixora spp*
6. Plumeria, *Plumeria spp*
7. Magnolia, *Magnolia grandiflora*
8. Paperbark, *Melaleuca quinquenervia*
15. Tiger Grass, *Thysanolaena latifolia*
16. Giant Crepe Myrtle, *Lagerstroemia indica*
17. Royal Poinciana, *Delonix regia*
18. Grass Tree, *Xanthorrhoea spp*
19. Queen Crepe Myrtle, *Lagerstroemia speciosa*
20. Fiddle Leaf Fig, *Ficus lyrata*
21. Pinanga, *Pinanga kuhlii*
22. Rainbow Shower, *Cassia fistula* x *javanica*
24. Veitchia, *Vietchia spp*
26. Traveler's Palm, *Ravenala madagascariensis*
28. Cupaniopsis, *Cupaniopsis spp*
37. Golden Shower Tree, *Cassia fistula*
42. Alexandra palm, *Archontophoenix alexandrae*

51. Pink Shower Tree, *Cassia bakeriana*
54. Othalam, *Cerbera odollum*
57. Unknown, Myrtaceae
58. Unknown, Sapindaceae
63. Shaving Brush Tree, *Pseudobombax ellipticum*
64. Mexican Fan Palms, *Washingtonia robusta*
65. Vittata Bamboo, *Bambusa vulgaris*
68. Tabebuia, *Tabebuia rosea*
69. Pink Tecoma Tabebuia, *Tabebuia heterophylla*
70. Sesbania, *Sesbania spp*
73. Fishtail Palm, *Caryota spp*
75. Sandpaper Tree, *Ehretia anacua*
76. Japanese Fern Tree, *Filicium decipiens*
79. Syzygium, *Syzygium spp*
80. Tabebuia, *Tabebuia spp*
82. Green Bamboo, *Bambusa spp*
84. Ruffle Palm, *Aiphanes lindeniana*
85. Pritchardia, *Pritchardia spp*
86. Rhapis Palm, *Rhapis spp*
87. Pygmy Date Palm, *Pheonix reobelenii*
89. Kou, *Cordia subcordata*
90. Milo, *Thespesia populnea*
91. Loulu, *Pritchardia maideniana*
92. Firewheel Tree, *Stenocarpus sinuous*
93. Hibiscus (hedge), *Hibiscus waimeae*
106. Roystonia, *Roystonia spp*
108. Brownea, *Brownea macrophylla*
112. Mahogany, *Swietenia macrophylla*
114. Loulu, *Pritchardia spp*
115. Cinnamon gardenia, *Tabernaemontana pachysiphon*
117. Cook Pine, *Araucaria columnar*
118. Ornamental Pandanus, *Pandanus spp*
120. Palm Perimeter
121. Maroon Bell-bean, *Markhamia zanzibarica*
125. Banana Magnolia, *Magnolia figo*
126. Pua kenikeni, *Fragraea berteriana*
127. Caliandra, *Calliandra haematocephala*
128. Caliandra, *Calliandra surinamensis*
129. Nagi Podocarpus, *Nageia nagi*
131. African Fern Pine, *Podocarpus falcatus*

Timber

9. Lancewood, *Calycophyllum candissium*
11. Manao Pine, *Manaoa colensoi*
23. Kamani, *Calophyllum inophyllum*
27. Camphor, *Cinnamomum camphora*
29. Bursera, *Bursera simaruba*
40. Malay Beechwood, *Gmelina arborea*
43. Narra, *Pterocarpus indica*
44. Teak, *Tectona grandis*
49. Brazilian Ironwood. *Libidibia ferrea*
52. Devil Tree, *Alstonia macrophylla*
55. Kauri, *Agathis macrophylla*
67. Molave, *Vitex parviflora*
72. Queensland Maple, *Flindersia brayleyana*
78. Spanish Cedar, *Cedrella odorata*
83. Pheasantwood, *Senna siamea*
109. Blue Marble, *Elaeocarpus angustifolium*

Other

5. La'amia Gourd Tree, *Crescentia cujete*
13. Climbing Ilangilang, *Artabotrys hexapetalus*
38. Red Kamala Tree, *Mallotus philippensis*
48. Arjuna, *Terminalia Arjuna*
53. Sandbox Tree, *Hura crepitans*
61. Ivory nut palm, *Metroxylon amicarum*
62. Sausage Tree, *Kigelia africana*
77. Ant Tree, *Triplaris weigeltiana*
94. Christmas Tree Trial
101. Northern White Beech, *Gmelina fasciculiflora*
116. Kukui, *Aleurites molucannus*

Quick Guide to Other Uses:

5. Container
13. Fragrance
38. Dye
48. Traditional medicine
53. Container
61. Carving
62. Traditional medicine, ceremonial practice
77. Traditional medicine
94. Science
101. Carving
116. Fuel
119. Weaving

Map of the Hilo DOFAW Arboretum



Sectional map of Arboretum Trees



Map of Arboretum Trees: Section 1



Tree Identification Information

Tree Number	Common Name	Scientific Name	Plant Family	Plant Use
1.	Royal Palm (row)	<i>Roystonea regia</i>	Arecaceae	Landscape
2.	Bird of Paradise	<i>Strelitzia alba</i>	Strelitziaceae	Landscape
3.	Ixora	<i>Ixora spp.</i>	Rubiaceae	Landscape
4.	Tamarind	<i>Tamarindus indica</i>	Fabaceae	Food
5.	La'amia Gourd Tree	<i>Crescentia cujete</i>	Bignoniaceae	Other (Container)
6.	Plumeria	<i>Plumeria spp.</i>	Apocynaceae	Landscape
7.	Magnolia	<i>Magnolia grandiflora</i>	Magnoliaceae	Landscape
8.	Paperbark	<i>Melaleuca quinquenervia</i>	Myrtaceae	Landscape
9.	Lancewood	<i>Calycophyllum candissium</i>	Rubiaceae	Timber
10.	Avocado	<i>Persia americana</i>	Lauraceae	Food
11.	Manoao Pine	<i>Manoao colensoi</i>	Podocarpaceae	Timber
12.	Surinam Cherry	<i>Eugenia uniflora</i>	Myrtaceae	Food
13.	Climbing Ilangilang	<i>Artabotrys hexapetalus</i>	Annonaceae	Other (Fragrance)
14.	Cinnamon	<i>Cinnamomum burmanii</i>	Lauraceae	Food
15.	Tiger Grass	<i>Thysanolaena latifolia</i>	Poaceae	Landscape
16.	Giant Crepe Myrtle	<i>Lagerstroemia indica</i>	Lythraceae	Landscape
17.	Royal Poinciana	<i>Delonix regia</i>	Fabaceae	Landscape
18.	Grass Tree	<i>Xanthorrhoea spp.</i>	Xanthorrhoeaceae	Landscape
19.	Queen Crepe Myrtle	<i>Lagerstroemia speciosa</i>	Lythraceae	Landscape
20.	Fiddle Leaf Fig	<i>Ficus lyrata</i>	Moraceae	Landscape
21.	Pinanga	<i>Pinanga kuhlii</i>	Arecaceae	Landscape

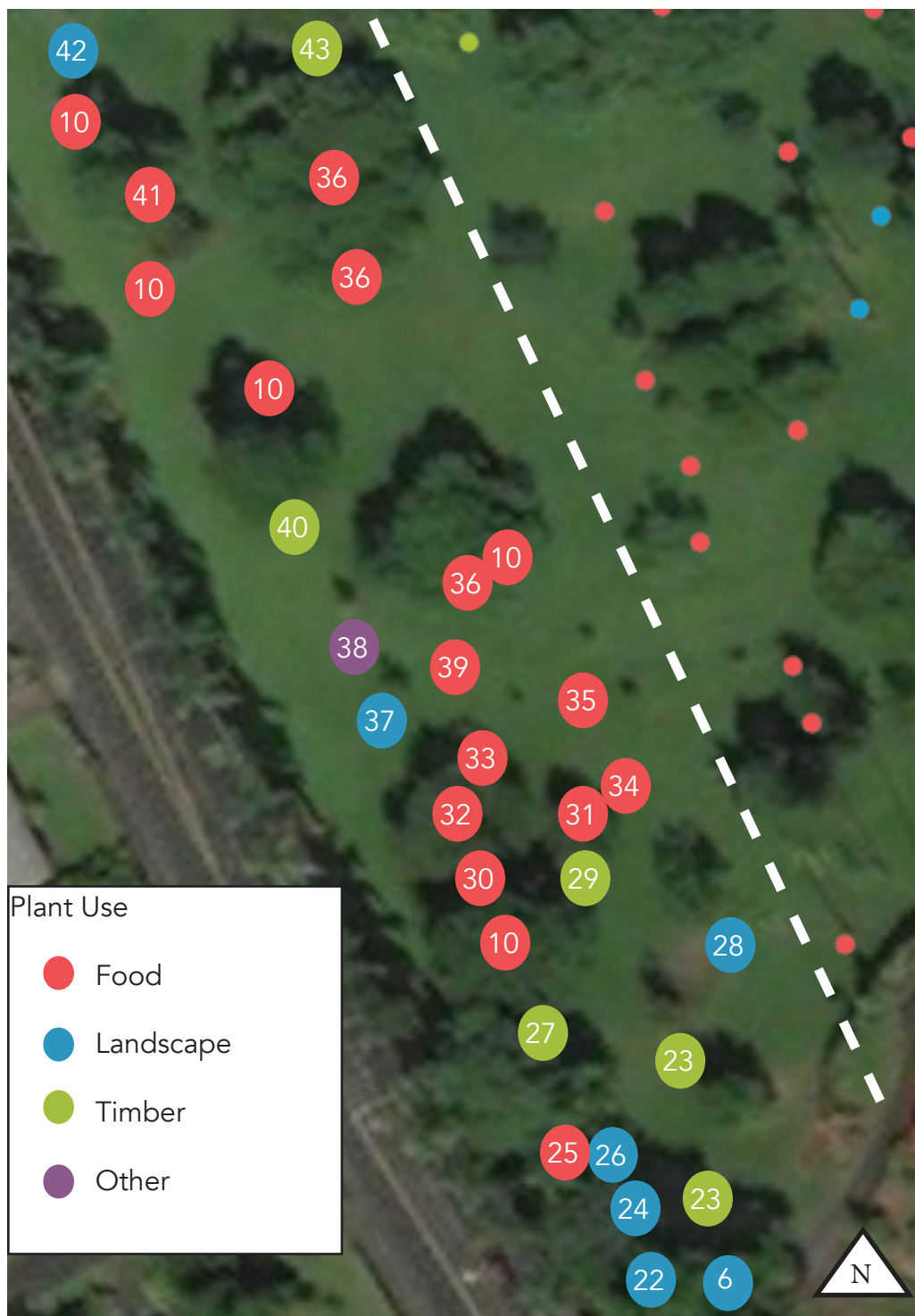

Map of Arboretum Trees: Section 2

Tree Identification Information

Tree Number.	Common Name, Scientific Name, Plant Family	Plant Use
6.	Plumeria, <i>Plumeria spp</i> , Apocynaceae	Landscape
10.	Avocado, <i>Persia americana</i> , Lauraceae	Food
22.	Rainbow Shower, <i>Cassia fistula x javanica</i> , Fabaceae	Landscape
23.	Kamani, <i>Calophyllum inophyllum</i> , Calophyllaceae	Timber
24.	Veitchia, <i>Vietchia spp</i> , Arecaceae	Landscape
25.	Star Apple, <i>Chrysophyllum cainito</i> , Sapotaceae	Food
26.	Traveler's Palm, <i>Ravenala madagascariensis</i> , Strelitziaceae	Landscape
27.	Camphor, <i>Cinnamomum camphora</i> , Lauraceae	Timber
28.	Cupaniopsis, <i>Cupaniopsis spp</i> , Sapindaceae	Landscape
29.	Bursera, <i>Bursera simaruba</i> , Burseraceae	Timber
30.	Ice cream Bean, <i>Inga edulis</i> , Fabaceae	Food
31.	Fig, <i>Ficus carica</i> , Moraceae	Food
32.	Orange, <i>Citrus sinensis</i> , Rutaceae	Food
33.	Honey Tangerine, <i>Citrus reticulata x sinensis var. Murcott</i> , Rutaceae	Food
34.	Thornless Tangerine, <i>Citrus tangerina</i> , Rutaceae	Food
35.	Calamansi, <i>Citrofortunella microcarpa</i> , Rutaceae	Food
36.	Lychee, <i>Litchi chinensis</i> , Sapindaceae	Food
37.	Golden Shower Tree, <i>Cassia fistula</i> , Fabaceae	Landscape
38.	Red Kamala Tree, <i>Mallotus philippensis</i> , Euphorbiaceae	Other (Dye)
39.	Macadamia Nut, <i>Macadamia tetraphylla</i> , Proteaceae	Food
40.	Malay Beechwood, <i>Gmelina arborea</i> , Lamiaceae	Timber
41.	Durian, <i>Durio spp</i> , Malvaceae	Food
42.	Alexandra palms, <i>Archontophoenix alexandrae</i> , Arecaceae	Landscape
43.	Narra, <i>Pterocarpus indica</i> , Fabaceae	Timber

Map of Arboretum Trees: Section 3



Plant Use

- Food
- Landscape
- Timber
- Other

Tree Identification Information

Tree Number	Common Name	Scientific Name	Plant Family	Plant Use
10.	Avocado	<i>Persia americana</i>	Lauraceae	Food
23.	Kamani	<i>Calophyllum inophyllum</i>	Calophyllaceae	Timber
27.	Camphor	<i>Cinnamomum camphora</i>	Lauraceae	Timber
37.	Golden Shower Tree	<i>Cassia fistula</i>	Fabaceae	Landscape
39.	Macadamia Nut	<i>Macadamia tetraphylla</i>	Proteaceae	Food
44.	Teak	<i>Tectona grandis</i>	Lamiaceae	Timber
45.	Baobab	<i>Adansonia spp</i>	Malvaceae	Food
46.	Malabar Chestnut	<i>Pachira aquatic</i>	Malvaceae	Food
47.	Breadnut	<i>Artocarpus camansi</i>	Moraceae	Food
48.	Arjuna	<i>Terminalia arjuna</i>	Combretaceae	Other (Ayurveda)
49.	Brazilian Ironwood	<i>Libidibia ferrea</i>	Fabaceae	Timber
50.	Santol	<i>Sandoricum koetjape</i>	Meliaceae	Food
51.	Pink Shower Tree	<i>Cassia bakeriana</i>	Fabaceae	Landscape
52.	Devil Tree	<i>Alstonia macrophylla</i>	Apocynaceae	Timber
53.	Sandbox Tree	<i>Hura crepitans</i>	Euphorbiaceae	Other (Container)
54.	Othalam	<i>Cerbera odollum</i>	Apocynaceae	Landscape
55.	Kauri	<i>Agathis macrophylla</i>	Araucariaceae	Timber
56.	Mango	<i>Mangifera indica</i>	Anacardiaceae	Food
57.	Unknown		Myrtaceae	Landscape
58.	Unknown		Sapindaceae	Food/Landscape
59.	Alupag	<i>Dimocarpus didyma</i>	Sapindaceae	Food
60.	Sapucacia Nut	<i>Lecythis zabuajo</i>	Lecythidaceae	Food
61.	Ivory nut palm	<i>Metroxylon amicarum</i>	Arecaceae	Other (Carving)
62.	Sausage Tree	<i>Kigelia africana</i>	Bignoniaceae	Other (Container)
63.	Shaving Brush Tree	<i>Pseudobombax ellipticum</i>	Malvaceae	Landscape
64.	Mexican Fan Palms	<i>Washingtonia robusta</i>	Arecaceae	Landscape
65.	Vittata Bamboo	<i>Bambusa vulgaris</i>	Poaceae	Landscape

Plant Use

- Food
- Landscape
- Timber
- Other

Tree Number. Common Name, <i>Scientific Name</i> , Plant Family	Plant Use
10. Avocado, <i>Persia americana</i> , Lauraceae	Food
23. Kamani, <i>Calophyllum inophyllum</i> , Calophyllaceae	Timber
37. Golden Shower, <i>Casia fistula</i> , Fabaceae	Landscape
56. Mango, <i>Mangifera indica</i> , Anacardiaceae	Food

Tree Number, Common Name, Scientific Name, Plant Family	Plant Use
66. Jackfruit, <i>Artocarpus heterophyllus</i> , Moraceae	Food
67. Molave, <i>Vitex parviflora</i> , Verbenaceae	Timber
68. Tabebuia, <i>Tabebuia rosea</i> , Bignoniaceae	Landscape
69. Pink Tecoma Tabebuia, <i>Tabebuia heterophylla</i> , Bignoniaceae	Landscape
70. Unknown Sesbania, <i>Sesbania spp</i> , Fabaceae	Landscape
71. African Fan Palms, <i>Brosius aethiopum</i> , Areceae	Food
72. Queensland Maple, <i>Flindersia brayleyana</i> , Rutaceae	Timber
73. Fishtail Palm, <i>Caryota spp</i> , Areceae	Landscape
74. Ulu (Rare Autia), <i>Artocarpus altilis</i> , Moraceae	Food
75. Sandpaper Tree, <i>Ehretia anacua</i> , Boraginaceae	Landscape
76. Japanese Fern Tree, <i>Filicium decipiens</i> , Sapindaceae	Landscape
77. Ant Tree, <i>Triplaria weigeltiana</i> , Polygonaceae	Other (Medicine)
78. Spanish Cedar, <i>Cedrella odorata</i> , Meliaceae	Timber
79. Syzygium spp, Myrtaceae	Landscape
80. Tabebuia, <i>Tabebuia spp</i> , Bignonicaceae	Landscape
81. Wampi, <i>Clausena lansing</i> , Rutaceae	Food
82. Green bamboo , <i>Bambusa spp</i> , Poaceae	Landscape
83. Pheasantwood, <i>Senna siamea</i> , Fabaceae	Timber
84. Ruffle Palm, <i>Aiphanes lindeniana</i> , Arecaceae	Landscape
85. Pritchardia, <i>Pritchardia spp</i> , Arecaeae	Landscape
86. Rhaps Palm, <i>Rhapis spp</i> , Areceae	Landscape
87. Pygmy Date Palm, <i>Pheonix reobelenii</i> , Areceae	Landscape
88. Cacao, <i>Theobroma cacao</i> , Malvaceae	Food
89. Kou, <i>Cordia subcordata</i> , Boraginaceae	Landscape
90. Milo, <i>Thespesia populnea</i> , Malvaceae	Landscape
91. Loulu, <i>Pritchardia maideniana</i> , Areceae	Landscape
92. Firewheel Tree, <i>Stenocarpus sinuous</i> , Protaceae	Landscape
93. Hibiscus (hedge), <i>Hibiscus Waimea</i> , Malvaceae	Landscape
94. Christmas Tree Trial, Pinaceae	Other (Science)

Map of Arboretum Trees: Section 5

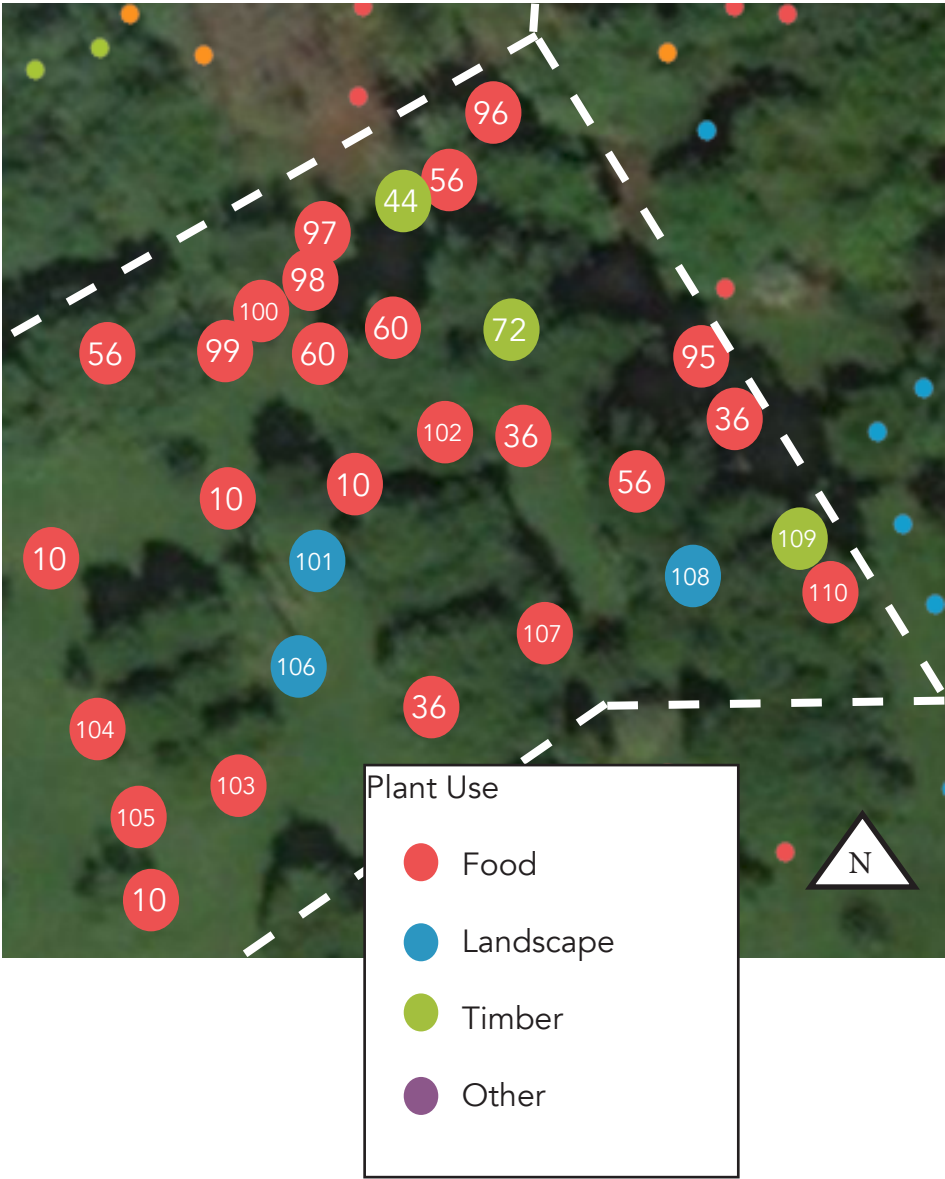

Tree Identification Information

Tree Number.	Common Name, <i>Scientific Name</i> , Plant Family	Plant Use
10.	Avocado, <i>Persia americana</i> , Lauraceae	Food
36.	Lychee, <i>Litchi chinensis</i> , Sapindaceae	Food
44.	Teak, <i>Tectona grandis</i> , Lamiaceae	Timber
56.	Mango, <i>Mangifera indica</i> , Anacardiaceae	Food
72.	Queensland Maple, <i>Flindersia brayleyana</i> , Rutaceae	Timber
95.	Lemon Drop Mangosteen, <i>Garcinia intermedia</i> , Clusiaceae	Food
96.	Coconut , <i>Cocos nucifera</i> , Areceae	Food
97.	White Sapote, <i>Cassimiroa edulis</i> , Rutaceae	Food
98.	Atemoya, <i>Annona x atemoya</i> , Annonaceae	Food
99.	Peach Palm, <i>Bactris gasipaes</i> , Areceae	Food
100.	Pineapple Guava, <i>Acca sellowiana</i> , Myrtaceae	Food
101.	Northern White Beech, <i>Gmelina fasciculiflora</i> , Lamiaceae	Landscape
102.	Sour Mangosteen, <i>Garcinia dulces</i> , Sapotaceae	Food
103.	Mangosteen (6 trees), <i>Garcinia mangostana</i> , Sapotaceae	Food
104.	Jabong (Pomelo), <i>Citrus maxima</i> , Rutaceae	Food
105.	Lemon, <i>Citrus limon</i> , Rutaceae	Food
106.	Royal Palm (2), <i>Roystonea regia</i> , Arecacaeae	Landscape
107.	Jaboticaba, <i>Plinia cauliflora</i> , Myrtaceae	Food
108.	Brownea, <i>Brownea macrophylla</i> , Fabaceae	Landscape
109.	Blue Marble, <i>Elaeocarpus angustifolium</i> , Elaeocarpaceae	Timber
110.	Pulasan, <i>Nephelium ramboutan-ake</i> , Sapindaceae	Food

Map of Arboretum Trees: Section 6

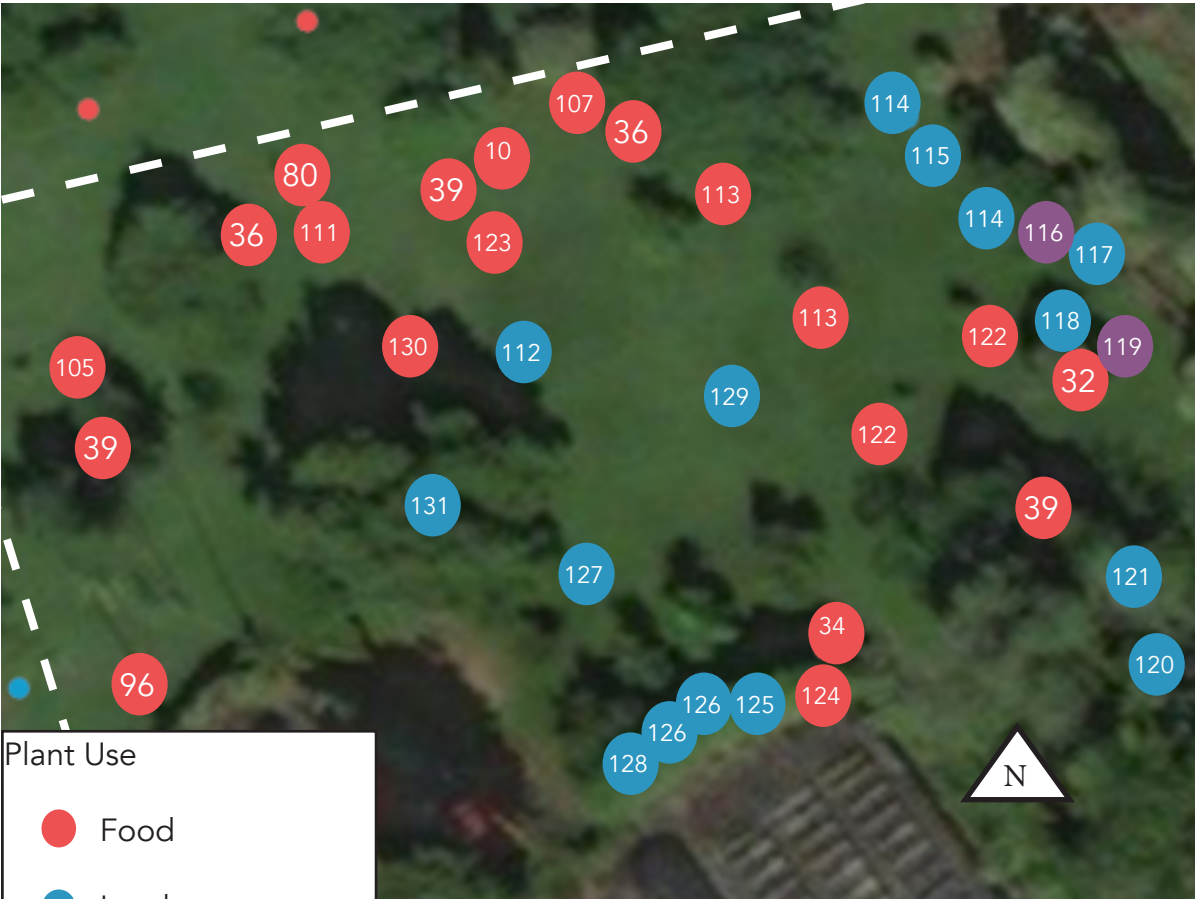

Plant Use

- Food
- Landscape
- Timber
- Other

Tree Identification Information

Tree Number.	Common Name, Scientific Name, Plant Family	Plant Use
34.	Tangerine, <i>Citrus tangerina</i> , Rutaceae	Food
36.	Lychee, <i>Litchi chinensis</i> , Sapindaceae	Food
39.	Macadamia Nut, <i>Macadamia tetraphylla</i> , Proteaceae	Food
80.	Wampi, <i>Clausena lansing</i> , Rutaceae	Food
96.	Coconut , <i>Cocos nucifera</i> , Areceae	Food
105.	Lemon, <i>Citrus limon</i> , Rutaceae	Food

Tree Identification Information

Tree Number.	Common Name, Scientific Name, Plant Family	Plant Use
111.	Mulberry, <i>Morus spp</i> , Moraceae	Food
112.	Mahogany, <i>Swietenia macrophylla</i> , Meliaceae	Landscape
113.	Rambutan, <i>Nephelium lappaceum</i>	Food
114.	Loulou, <i>Pritchardia spp</i> , Arecaceae	Landscape
115.	Cinnamon gardenia, <i>Tabernaemontana pachysiphon</i> , Apocynaceae	Landscape
116.	Kukui, <i>Aleurites molucannus</i> , Euphorbiaceae	Other (Oil)
117.	Cook Pine (row), <i>Araucaria columnar</i> , Araucariaceae	Landscape
118.	Ornamental Pandanus, <i>Pandanus spp</i> , Pandanaceae	Landscape
119.	Hala, <i>Pandanus tectorius</i> , Pandanaceae	Other (Weaving)
120.	Palm perimeter, Arecaceae	Landscape
121.	Maroon bell-bean, <i>Markhamia zanzibarica</i> , Bignoniaceae	Landscape
122.	Abiu, <i>Pouteria caimito</i> , Sapotaceae	Food
123.	Canistel, <i>Pouteria campechiana</i> , Sapotaceae	Food
124.	Blimbi, <i>Averrhoa bilimbi</i> , Oxalidaceae	Food
125.	Banana Magnolia, <i>Magnolia figo</i> , Magnoliaceae	Landscape
126.	Pua kenikeni, <i>Fragraea berteriana</i> , Gentianaceae	Landscape
127.	Caliandra, <i>Calliandra haematocephala</i> , Fabaceae	Landscape
128.	Caliandra, <i>Calliandra surinamensis</i> , Fabaceae	Landscape
129.	Nagi Podocarpus , <i>Nageia nagi</i> , Podocarpaceae	Landscape
130.	Unknown, <i>Citrus spp</i> , Rutaceae	Food
131.	African Fern Pine, <i>Podocarpus falcatus</i> , Podocarpaceae	Landscape