

Setting Aside Land for Public Purposes

By this Executive Order, I, the undersigned, Governor of the State of Hawaii, by virtue of the authority in me vested by Section 171-11, Hawaii Revised Statutes, and every other authority me hereunto enabling, do hereby order that the public land hereinafter described be, and the same is, hereby set aside for the following public purposes:

FOR NATURAL AREA RESERVES, to be under the control and management of the Department of Land and Natural Resources, State of Hawaii, being the lands situate at Kaohe, Hamakua, Island of Hawaii, Hawaii, designated as MAUNA KEA ICE AGE NATURAL AREA RESERVE, PART 1, containing an area of 3750.0 Acres, more or less, and PART 2, containing an area of 143.5 Acres, more or less, all more particularly described in Exhibit "A" and delineated on Exhibit "B", both of which are attached hereto and made a part hereof, said exhibits being, respectively, a survey description and survey map prepared by the Survey Division, Department of Accounting and General Services, State of Hawaii, both being designated C.S.F. No. 18,645 and dated May 4, 1979.

SUBJECT to disapproval by the Legislature by two-thirds vote of either the Senate or the House of Representatives or by majority vote of both, in any regular or special session next following the date of this Executive Order.

In Witness Whereof, I have hereunto set my hand and caused the Great Seal of the State of Hawaii to be affixed. Done at the Capitol at Honolulu this 16th day of November, Nineteen Hundred and 81.



Governor of the State of Hawaii

Approved as to form:

Deputy Attorney General

State of Hawaii

Office of the Lieutenant Governor

3101

This is to Certify That the within is a true copy of Executive Order No.....
setting aside land for public purposes, the original of which is on file in this office.

In Testimony Whereof, the Lieutenant Governor of the
State of Hawaii, has hereunto subscribed his name
and caused the Great Seal of the State to be affixed.

DONE in Honolulu, this day of
....., A.D. 19.....

Executive Order No. 3101

**Setting Aside Land for
Public Purposes**

Land
Purpose
Date



STATE OF HAWAII

SURVEY DIVISION

DEPT. OF ACCOUNTING AND GENERAL SERVICES

HONOLULU

C.S.F. No. 18,645

May 4, 1979

MAUNA KEA ICE AGE NATURAL AREA RESERVE

PARTS 1 AND 2

Kaohe, Hamakua, Island of Hawaii, Hawaii

Being a portion of the Government Land of Kaohe.

Being also a portion of Mauna Kea Science Reserve covered by General Lease S-4191 to the University of Hawaii.

PART 1:

Beginning at the north corner of this parcel of land, being also 100.00 feet west from the west side of Mauna Kea Observatory Access Road, the direct azimuth end distance from Government Survey Triangulation Station "SUMMIT 1955" being $78^{\circ} 16' 41''$ 2264.70 feet, thence running by azimuths measured clockwise from True South:-

1. Along the remainder of Mauna Kea Forest Reserve (Governor's Proclamation dated June 5, 1909), the boundary follows 100.00 feet west and parallel to the west side of the Mauna Kea Observatory Access Road, the direct azimuth and distance being: $348^{\circ} 21' 56.6''$ 18,484.74 feet;
2. $109^{\circ} 00'$ 14,185.41 feet along the remainder of Mauna Kea Forest Reserve (Governor's Proclamation dated June 5, 1909), to the top west edge of Pohakuloa Gulch;
3. Thence along the remainder of Mauna Kea Forest Reserve (Governor's Proclamation dated June 5, 1909), along the top west edge of Pohakuloa Gulch, the direct azimuth and distance being: $214^{\circ} 00'$ 12,626.46 feet;
4. $221^{\circ} 00'$ 4000.00 feet along the remainder of Mauna Kea Forest Reserve (Governor's Proclamation dated June 5, 1909), to the point of beginning and containing an AREA OF 3750.0 ACRES MORE OR LESS.

May 4, 1979

PART 2: PUU POHAKU

Beginning at the northeast corner of this parcel of land, the direct azimuth and distance from Government Survey Triangulation Station "SUMMIT 1955" being 114° 30' 7350.00 feet, thence running by azimuths measured clockwise from True South:-

1. 360° 00' 2500.00 feet along the remainder of Mauna Kea Forest Reserve (Governor's Proclamation dated June 5, 1909);
2. 90° 00' 2500.00 feet along the remainder of Mauna Kea Forest Reserve (Governor's Proclamation dated June 5, 1909);
3. 180° 00' 2500.00 feet along the remainder of Mauna Kea Forest Reserve (Governor's Proclamation dated June 5, 1909);
4. 270° 00' 2500.00 feet along the remainder of Mauna Kea Forest Reserve (Governor's Proclamation dated June 5, 1909), to the point of beginning and containing an AREA OF 143.5 ACRES.

SURVEY DIVISION
DEPARTMENT OF ACCOUNTING AND GENERAL SERVICES
STATE OF HAWAII

By: Robert T. Hashimoto
Robert T. Hashimoto
Land Surveyor

Compiled from data furn.
by N.A.R.S., U.S.G.S. Map
& Govt. Survey Records.

gm

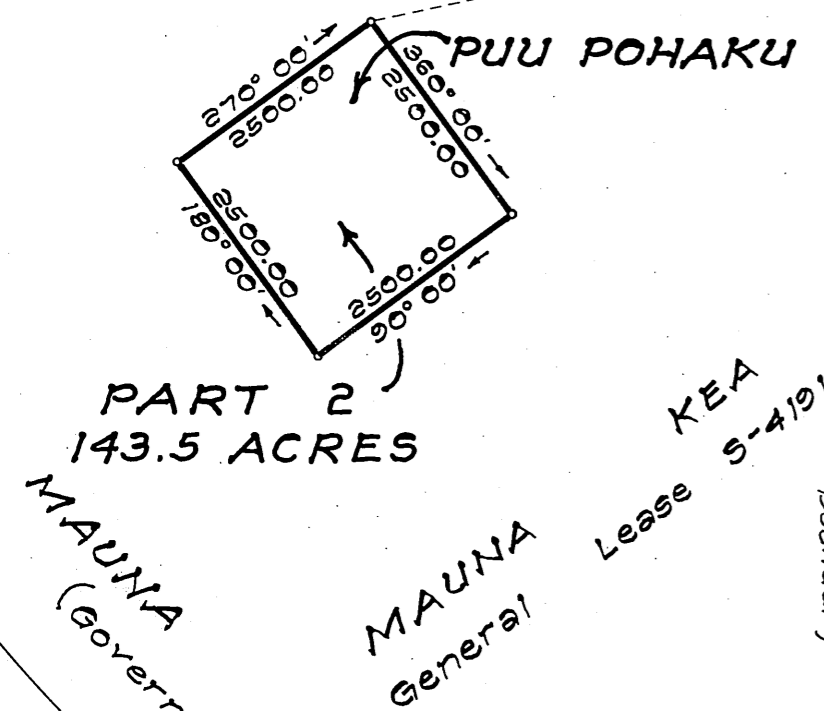
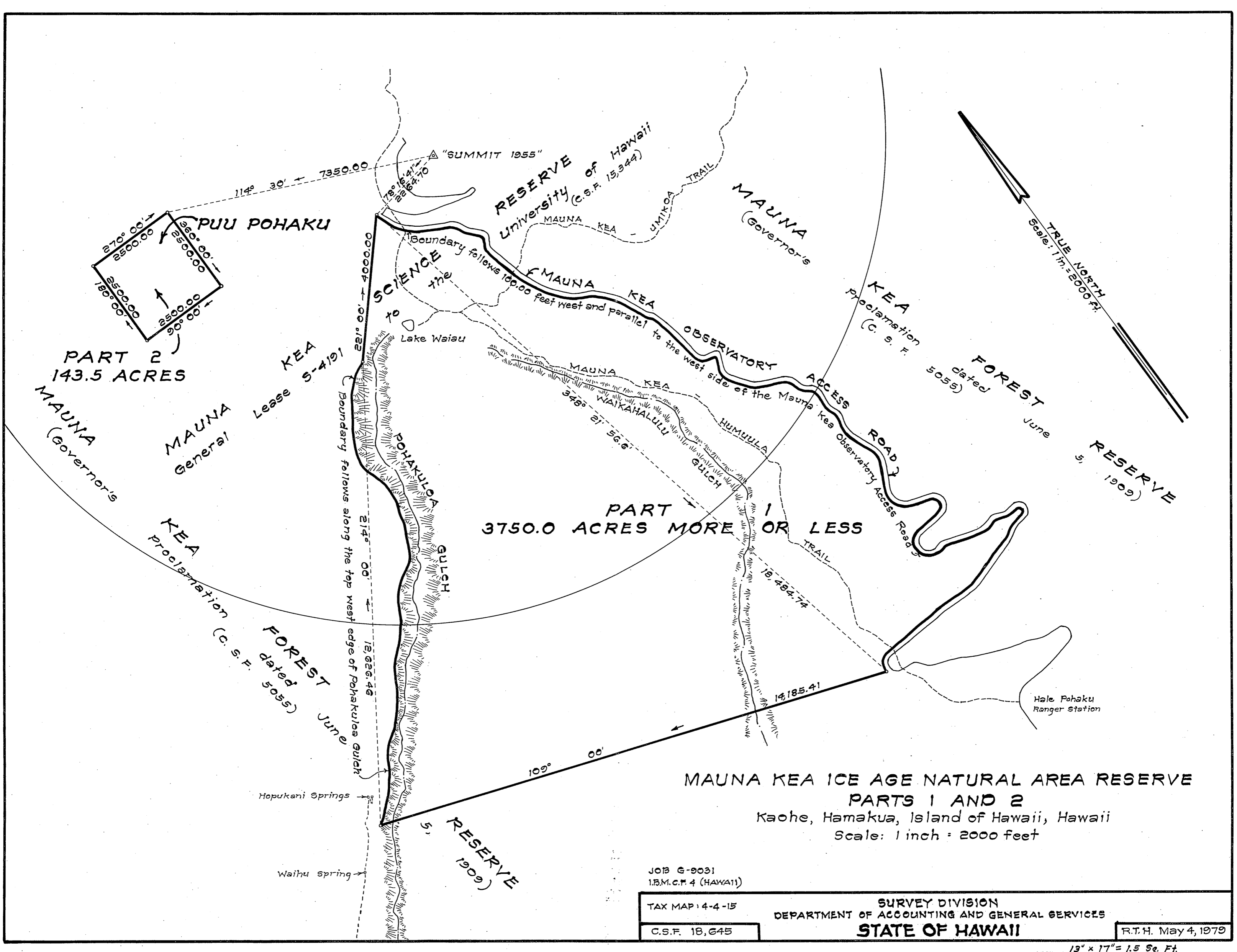

**PART 1
3750.0 ACRES MORE OR LESS**

**MAUNA KEA ICE AGE NATURAL AREA RESERVE
PARTS 1 AND 2
Kaohe, Hamakua, Island of Hawaii, Hawaii
Scale: 1 inch = 2000 feet**

JOB G-9031
I.B.M.C.F. 4 (HAWAII)

TAX MAP 4-4-15
C.S.F. 18,645

**SURVEY DIVISION
DEPARTMENT OF ACCOUNTING AND GENERAL SERVICES
STATE OF HAWAII**

R.T.H. May 4, 1979

13" x 17" = 1.5 Sq. Ft.