

Setting Aside Land for Public Purposes

By this Executive Order, I, the undersigned, Governor of the State of Hawaii, by virtue of the authority in me vested by Section 171-11, Hawaii Revised Statutes, and every other authority me hereunto enabling, do hereby order that the public land hereinafter described be, and the same is, hereby set aside for the following public purposes:

FOR NATURAL AREA RESERVES SYSTEM PURPOSES, to be under the control and management of the Department of Land and Natural Resources, and being designated as the West Maui Natural Area Reserve, containing a total area as follows:

- (1) Kahakuloa Section - 3275 acres, more or less
- (2) Honokowai Section - 750 acres, more or less
- (3) Panaewa Section - 1717 acres
- (4) Lihau Section - 960 acres, more or less;

situate at Lahaina, Kaaanapali and Wailuku Districts, Maui, Hawaii; the land being more particularly described in Exhibits "A-1", "A-2", "A-3", and "A-4" and delineated on Exhibits "B-1", "B-2", and "B-3", these exhibits being respectively, survey descriptions and survey maps prepared by the Survey Division, Department of Accounting and General Services, State of Hawaii, being designated as C.S.F. Nos. 20,155, 20,156, 20,157 and 20,158 and dated February 27, 1985.

SUBJECT to disapproval by the Legislature by two-thirds vote of either the Senate or the House of Representatives or by majority vote of both, in any regular or special session next following the date of this Executive Order.

In Witness Whereof, I have hereunto set my hand and caused the Great Seal of the State of Hawaii to be affixed. Done at the Capitol at Honolulu this 7th day of March, Nineteen Hundred and 86.

Governor of the State of Hawaii

Approved as to form:

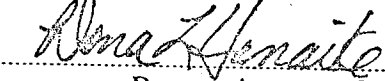
Deputy Attorney General

Dated: FEB 21 1986

State of Hawaii

Office of the Lieutenant Governor

3329

This is to Certify That the within is a true copy of Executive Order No.
setting aside land for public purposes, the original of which is on file in this office.

In Testimony Whereof, the Lieutenant Governor of the
State of Hawaii, has hereunto subscribed his name
and caused the Great Seal of the State to be affixed.

DONE in Honolulu, this day of
....., A.D. 19.....

3329

Executive Order No. _____

Setting Aside Land for
Public Purposes

Land
.....
Purpose
.....
Date



STATE OF HAWAII

SURVEY DIVISION

DEPT. OF ACCOUNTING AND GENERAL SERVICES

HONOLULU

February 27, 1985

C.S.F. No. 20,155

WEST MAUI NATURAL AREA RESERVE

KAHAKULOA SECTION

Kahakuloa (Kaanapali), Wailuku, Maui, Hawaii

Being portion of the Government (Crown) Land of Kahakuloa.

Beginning at a Forest Reserve Monument on "Maunakini", the highest and most prominent peak on the west side of Kahakuloa Valley, at the north corner of this parcel of land, the coordinates of said point of beginning referred to Government Survey Triangulation Station "KAHAKULOA" (KOA) being 7793.19 feet South and 5018.08 feet West, thence running by azimuths measured clockwise from True South:-

1. 324° 26' 4827.00 feet along Lot 15 of Kahakuloa Homesteads (Subdivision of 1938) to the Forest Reserve Monument on Puu Olelo;
2. 318° 57' 2597.16 feet along Lots 8 and 14 of Kahakuloa Homesteads (Subdivision of 1938) to the Forest Reserve Monument on the mauka west corner of Grant 4982 to J. W. L. Marshall;
3. 67° 52' 30" 1130.50 feet along the remainder of the Government (Crown) Land of Kahakuloa;
4. 37° 37' 1200.00 feet along the remainder of the Government (Crown) Land of Kahakuloa;
5. 6° 24' 30" 1583.20 feet along the remainder of the Government (Crown) Land of Kahakuloa;
6. 312° 04' 30" 57.62 feet along the remainder of the Government (Crown) Land of Kahakuloa;
7. Thence southerly along West Maui Forest Reserve, Governor's Proclamation dated April 21, 1908 to the summit of Lanihili Hill;

EXHIBIT A-1

- 8. Thence southwesterly along West Maui Forest Reserve, Governor's Proclamation dated April 21, 1908, the boundary follows along the top of ridge between the lands of Waihee, R.P. 4475, L.C.Aw. 7713, Apana 24 to V. Kamamalu and Kahakuloa to east of Eke Crater;
- 9. Thence northwesterly along West Maui Forest Reserve, Governor's Proclamation dated April 21, 1908, the boundary follows along the top of ridge between the land of Honokohau, L.P. 8130, L.C.Aw. 7714-B to Kekuaiwa and the land of Kahakuloa to the west side of Eke Crater;
- 10. Thence northerly for a distance of approximately 17,424 feet, more or less, along West Maui Forest Reserve, Governor's Proclamation dated April 21, 1908, the boundary follows along the top of ridge between the land of Honokohau, L.P. 8130, L.C.Aw. 7714-B to Kekuaiwa and the land of Kahakuloa to Uau Hill;
- 11. Thence easterly for a distance of approximately 4300 feet, more or less, along West Maui Forest Reserve, Governor's Proclamation dated April 21, 1908;
- 12. Thence northeasterly for a distance of approximately 5500 feet, more or less, along West Maui Forest Reserve, Governor's Proclamation dated April 21, 1908 to the point of beginning and containing an AREA OF 3275 ACRES, MORE OR LESS.

SURVEY DIVISION
DEPARTMENT OF ACCOUNTING AND GENERAL SERVICES
STATE OF HAWAII

By: Stanley T. Hasegawa
Stanley T. Hasegawa
Land Surveyor

pt

Compiled from Reg. Map 771,
780, 3031, Certificate of
Boundaries 31, 74 and 99,
CSF 12,184, 12,260, 9261,
9854 and other Govt. Survey
Records.



STATE OF HAWAII

SURVEY DIVISION

DEPT. OF ACCOUNTING AND GENERAL SERVICES

HONOLULU

C.S.F. No. 20,157

February 27, 1985

WEST MAUI NATURAL AREA RESERVE
HONOKOWAI SECTION

Honokowai, Lahaina, Maui, Hawaii

Being portion of the Government Land of Honokowai.

Beginning at the south corner of this parcel of land at the summit of Puu Kukui, thence running:-

1. Northwesterly along West Maui Forest Reserve, Governor's Proclamation dated April 21, 1908, the boundary follows along L.C. Award 7713, Apana 26 to Victoria Kamamalu to the northerly side of Waikiki Branch of Honokowai Stream;
2. Thence northerwesterly along West Maui Forest Reserve, Governor's Proclamation dated April 21, 1908, the boundary follows along the northerly side of Waikiki Branch of Honokowai Stream, along L.C. Award 76, Apana 5 to William Shaw;
3. Thence southeasterly along West Maui Forest Reserve, Governor's Proclamation dated April 21, 1908;
4. Thence northeasterly along West Maui Forest Reserve, Governor's Proclamation dated April 21, 1908;
5. Thence northwesterly along West Maui Forest Reserve, Governor's Proclamation dated April 21, 1908 to the northerly side of the Waikiki Branch of Honokowai Stream;
6. Thence northwesterly along West Maui Forest Reserve, Governor's Proclamation dated April 21, 1908, the boundary follows along the northerly side of the Waikiki Branch of Honokowai Stream, along L.C. Award 76, Apana 5 to William Shaw;
7. Thence northeasterly along West Maui Forest Reserve, Governor's Proclamation dated April 21, 1908 to the top of ridge between the lands of Honokowai and Honokahua, R.P. 2236, L.C. Award 8522-B to Kale Davis;

EXHIBIT A-2

February 27, 1985

8. Thence southeasterly along West Maui Forest Reserve, Governor's Proclamation dated April 21, 1908, the boundary follows along the top of ridge between the lands of Honokowai and Honokahua, R.P. 2236, L.C. Award 8522-B to Kale Davis to the point of beginning and containing an AREA OF 750 ACRE, MORE OR LESS.

SURVEY DIVISION
DEPARTMENT OF ACCOUNTING AND GENERAL SERVICES
STATE OF HAWAII

By: Stanley T. Hasegawa
Stanley T. Hasegawa
Land Surveyor

pt

Compiled from Certificate
of Boundaries 11, 21 and 99,
Reg. Maps 778, 1180, Ld. Ct.
App. 439 (pending) and Govt.
Survey Records.



STATE OF HAWAII

SURVEY DIVISION

DEPT. OF ACCOUNTING AND GENERAL SERVICES

HONOLULU

February 27, 1985

C.S.F. No. 20,158

WEST MAUI NATURAL AREA RESERVE

PANAWEA SECTION

Lahaina, Maui, Hawaii

Being all of Lot E containing an AREA OF 1717.0 ACRES as shown on Map 11 of Land Court Application 403 filed in the Office of the Assistant Registrar of the Land Court of the State of Hawaii covered by Owner's Transfer Certificate of Title 44,733 issued to the Territory of Hawaii.

SURVEY DIVISION
DEPARTMENT OF ACCOUNTING AND GENERAL SERVICES
STATE OF HAWAII

By: Stanley T. Hasegawa
Stanley T. Hasegawa
Land Surveyor

pt

Compiled from Map 11
of Land Court App. 403.

EXHIBIT A-3



STATE OF HAWAII

SURVEY DIVISION

DEPT. OF ACCOUNTING AND GENERAL SERVICES

HONOLULU

C.S.F. No. 20,156

February 27, 1985

WEST MAUI NATURAL AREA RESERVE

LIHAU SECTION

Olowalu, Lahaina, Maui, Hawaii

Being a portion of the Government Land of Olowalu.

Beginning at a Forest Reserve Monument at the west angle of this parcel of land, the coordinates of said point of beginning referred to Government Survey Triangulation Station "KILEA" being 4731.7 feet North and 825.8 feet West, thence running by azimuths measured clockwise from True South:-

1. 161° 53' 3019.80 feet along the remainder of the Government Land of Olowalu;
2. Thence northeasterly along West Maui Forest Reserve, Governor's Proclamation dated April 21, 1908, the boundary follows along the top of ridge between the lands of Launiupoko, R.P. 1358, L.C.Aw. 82 to T. Phillips and Olowalu to a Puu on ridge.
3. Thence northeasterly along West Maui Forest Reserve, Governor's Proclamation dated April 21, 1908, the boundary follows along the top of ridge between the lands of Launiupoko, R.P. 1358, L.C.Aw. 82 to T. Phillips and Olowalu for a distance of approximately 2508 feet, more or less to the highest peak of Lihau mountain;
4. Thence southeasterly along West Maui Forest Reserve, Governor's Proclamation dated April 21, 1908, the boundary follows along the western top of ridge of Olowalu Gulch;
5. Thence southwesterly along West Maui Forest Reserve, Governor's Proclamation dated April 21, 1908, the boundary follows along the western top of ridge of Olowalu Gulch;

EXHIBIT A-4

February 27, 1985

6. $121^{\circ} 34' 30''$ for a distance of approximately 3700 feet, more or less, along the remainder of the Government Land of Olowalu to the point of beginning and containing an AREA OF 960 ACRES, MORE OR LESS.

SURVEY DIVISION
DEPARTMENT OF ACCOUNTING AND GENERAL SERVICES
STATE OF HAWAII

By: Stanley J. Hasegawa
Stanley J. Hasegawa
Land Surveyor

pt

Compiled from CSF 1854,
10,675, 18,533 and other
Govt. Survey Records.

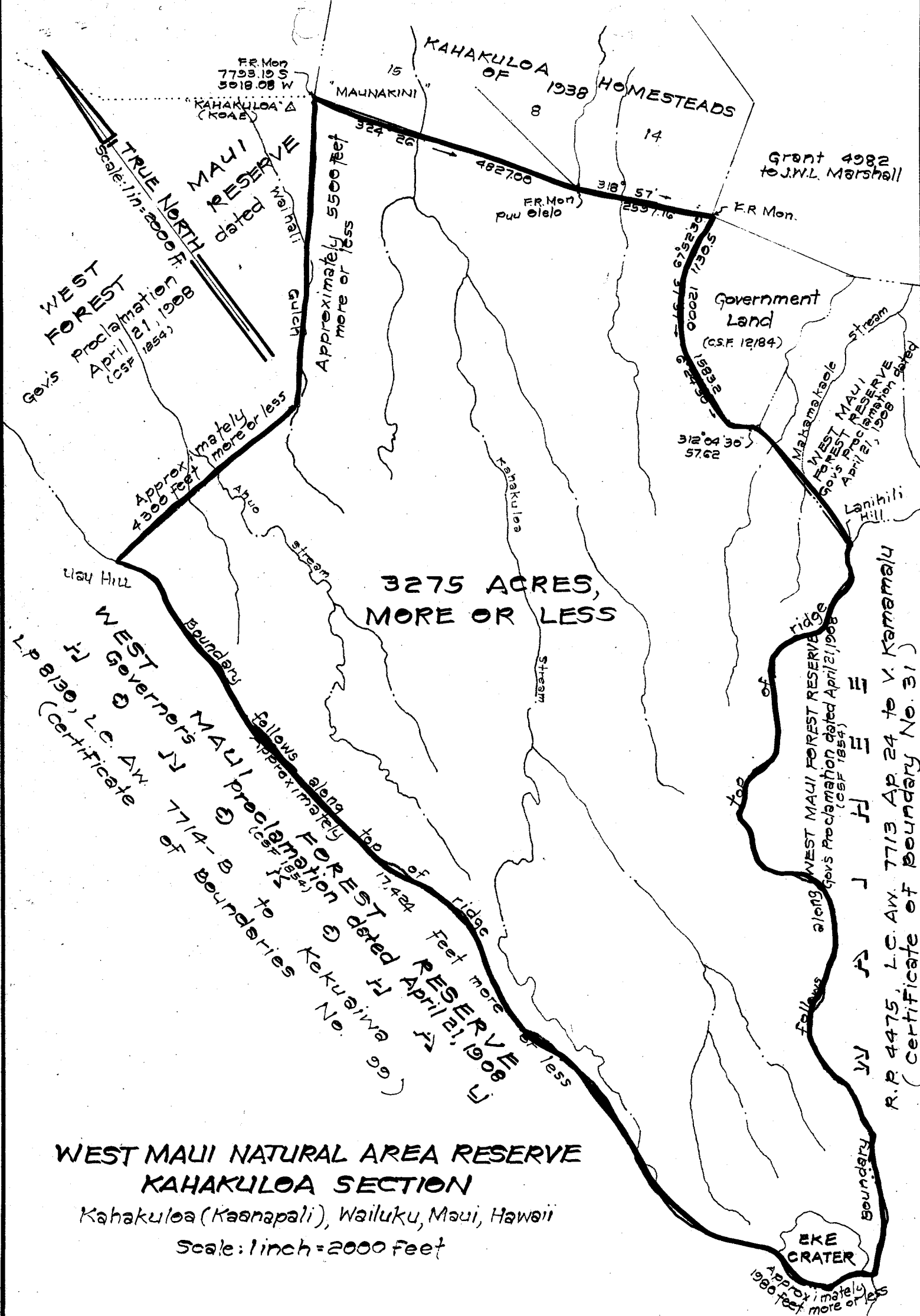

**WEST MAUI NATURAL AREA RESERVE
KAHAKULOA SECTION**
Kahakuloa (Kaunapali), Wailuku, Maui, Hawaii
Scale: 1 inch = 2000 feet

JOB Ma-84(84)
C. BK Hasegawa 9 Pg 40

EXHIBIT B-1

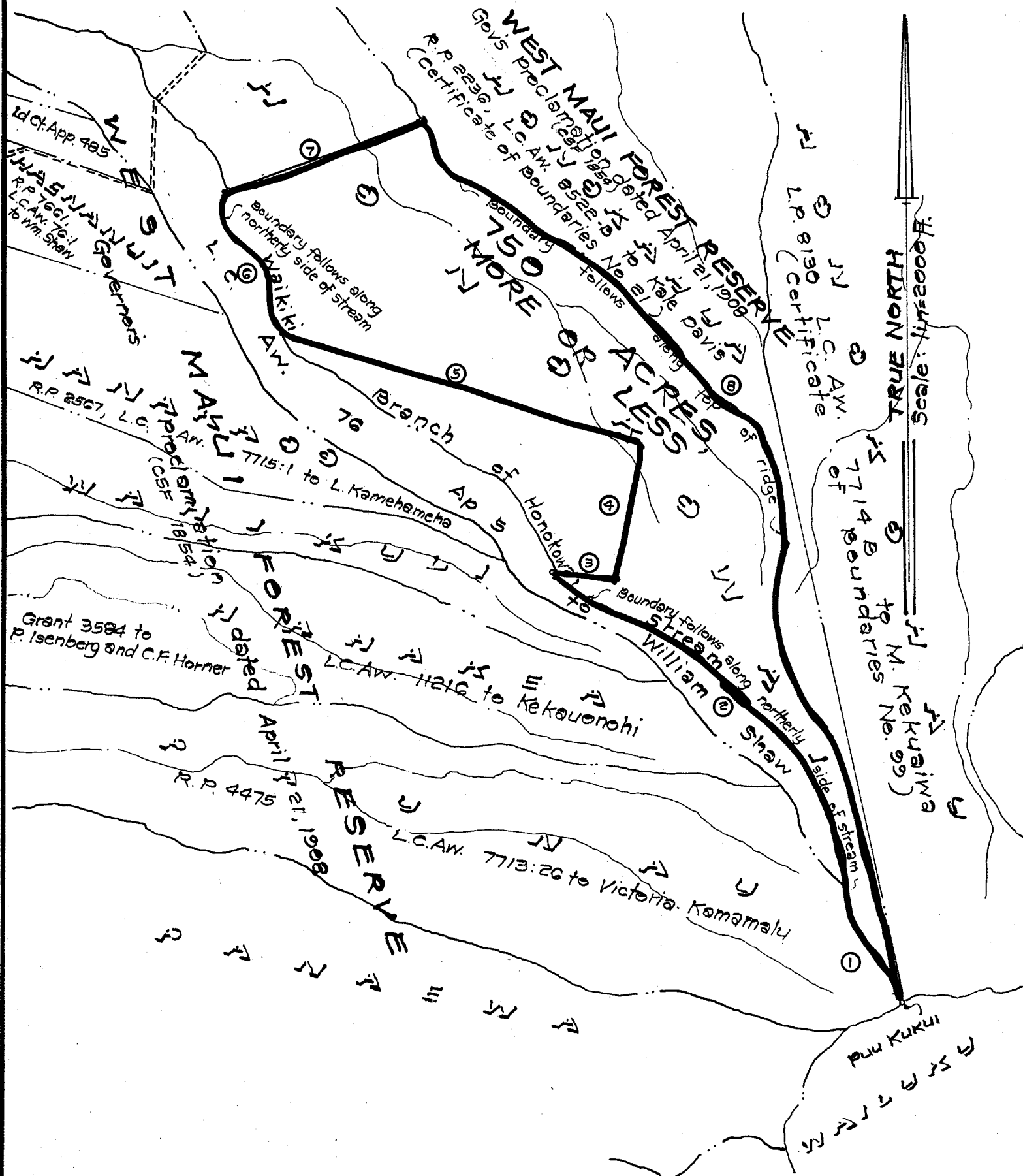

**WEST MAUI NATURAL AREA RESERVE
HONOKOWAI SECTION**

Honokowai, Lahaina, Maui, Hawaii
Scale: 1 inch = 2000 feet

EXHIBIT B-2

JOB Ma-84(84)
C. BK Hasegawa & Pg 42

⊙ Denotes course in description

TAX MAP 4-4-07

**SURVEY DIVISION
DEPARTMENT OF ACCOUNTING AND GENERAL SERVICES
STATE OF HAWAII**

C. S. F. No. 20,157

STH: Feb. 27, 1985

