



Kaluanui, Koolauloa, Oahu, Hawaii, and identified as "Kaluanui Natural Area Reserve," containing an area of 378.249 acres, more or less, more particularly described in Exhibit "A" and delineated on Exhibit "B," both of which are attached hereto and made parts hereof, said exhibits being respectively, a survey description and survey map prepared by the Survey Division, Department of Accounting and General Services, State of Hawaii, both being designated C.S.F. No. 25,274 and dated April 10, 2013.

SUBJECT, HOWEVER, to the condition that upon cancellation of this executive order or in the event of non-use or abandonment of the premises or any portion thereof for a continuous period of one (1) year, or for any reason whatsoever, the State of Hawaii, Department of Land and Natural Resources, Division of Forestry and Wildlife, Natural Area Reserve System shall, within a reasonable time, restore the premises to a condition satisfactory and acceptable to the Department of Land and Natural Resources, State of Hawaii.

SUBJECT, FURTHER, to disapproval by the Legislature by two-thirds vote of either the Senate or the House of Representatives or by majority vote of both, in any regular or special session next following the date of this Executive Order.

This executive order does not authorize the recipient of the set aside to sell or exchange or otherwise relinquish the State of Hawaii's title to the subject public land.

IN WITNESS WHEREOF, I have hereunto set my hand and caused the Great Seal of the State of Hawaii to be affixed. Done at the Capitol at Honolulu this 15th day of February, 2014. 

NEIL ABERCROMBIE
Governor of the State of Hawaii

APPROVED AS TO FORM:

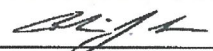
COLIN J. LAU
Deputy Attorney General

Dated: 11/15/13

STATE OF HAWAII

Office of the Lieutenant Governor

THIS IS TO CERTIFY That the within is a true copy of
Executive Order No. 4446 setting aside land for public
purposes, the original of which is on file in this office.

IN TESTIMONY WHEREOF, the Lieutenant
Governor of the State of Hawaii, has
hereunto subscribed his name and caused
the Great Seal of the State to be affixed.



SHAN S. TSUTSUI
Lieutenant Governor of the State of Hawaii

DONE in Honolulu, this 12th day of
February, A.D. 2011 

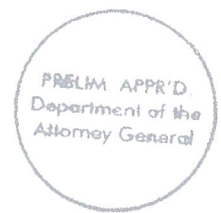



STATE OF HAWAII
SURVEY DIVISION
DEPARTMENT OF ACCOUNTING AND GENERAL SERVICES
HONOLULU

C.S.F. No. 25,274

April 10, 2013

KALUANUI NATURAL AREA RESERVE

Kaluanui, Koolauloa, Oahu, Hawaii

Being a portion of Royal Patents 4475 and 7805, Land Commission Award 7713, Apana 32 to V. Kamamalu conveyed to the State of Hawaii by George H. Sakoda and Jitsuichi Tamashiro by deed dated August 27, 1976 and recorded in Liber 11635, Page 415 (Land Office Deed S-26635).

Beginning on the top of ridge at the south corner of this parcel of land, the coordinates of said point of beginning referred to Government Survey Triangulation Station "KAIPAPAU" being 26,773.90 feet South and 737.71 feet East, thence running by azimuths measured clockwise from True South:-

1. Along top of ridge along R.P. 4475, L.C. Aw. 7713, Ap. 33 to V. Kamamalu, the direct azimuth and distance being:
167° 05' 4830.00 feet;

Thence along top of ridge along Hauula Forest Reserve, Governor's Proclamation dated December 31, 1918 for the next three (3) courses, the direct azimuths and distances between points along said top of ridge being:

2. 172° 00' 2170.00 feet;
3. 183° 40' 2340.00 feet;
4. 198° 00' 1251.00 feet;

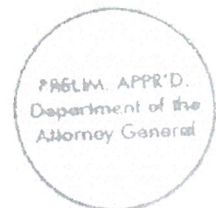

5. 289° 15' 26" 2925.09 feet along Sacred Falls State Park, Governor's Executive Order 2830 to the top of ridge;

Thence along top of ridge along R.P. 7804, L.C. Aw. 9971, Ap. 25 to W.P. Leleiohoku for the next seven (7) courses, the direct azimuths and distances between points along said top of ridge being:

- 6. 27° 40' 686.00 feet;
- 7. 60° 20' 1325.00 feet;
- 8. 333° 10' 1190.00 feet;
- 9. 353° 40' 1620.00 feet;
- 10. 32° 35' 1365.00 feet;
- 11. 360° 00' 1990.00 feet;
- 12. 10° 20' 2380.00 feet to the point of beginning and containing an AREA OF 378.249 ACRES, MORE OR LESS.

SURVEY DIVISION
DEPARTMENT OF ACCOUNTING AND GENERAL SERVICES
STATE OF HAWAII

By: Glenn J. Kodani

Glenn J. Kodani
Land Surveyor

ry

Compiled from CSF 25273
and other Gov't Survey Records.

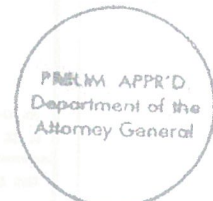

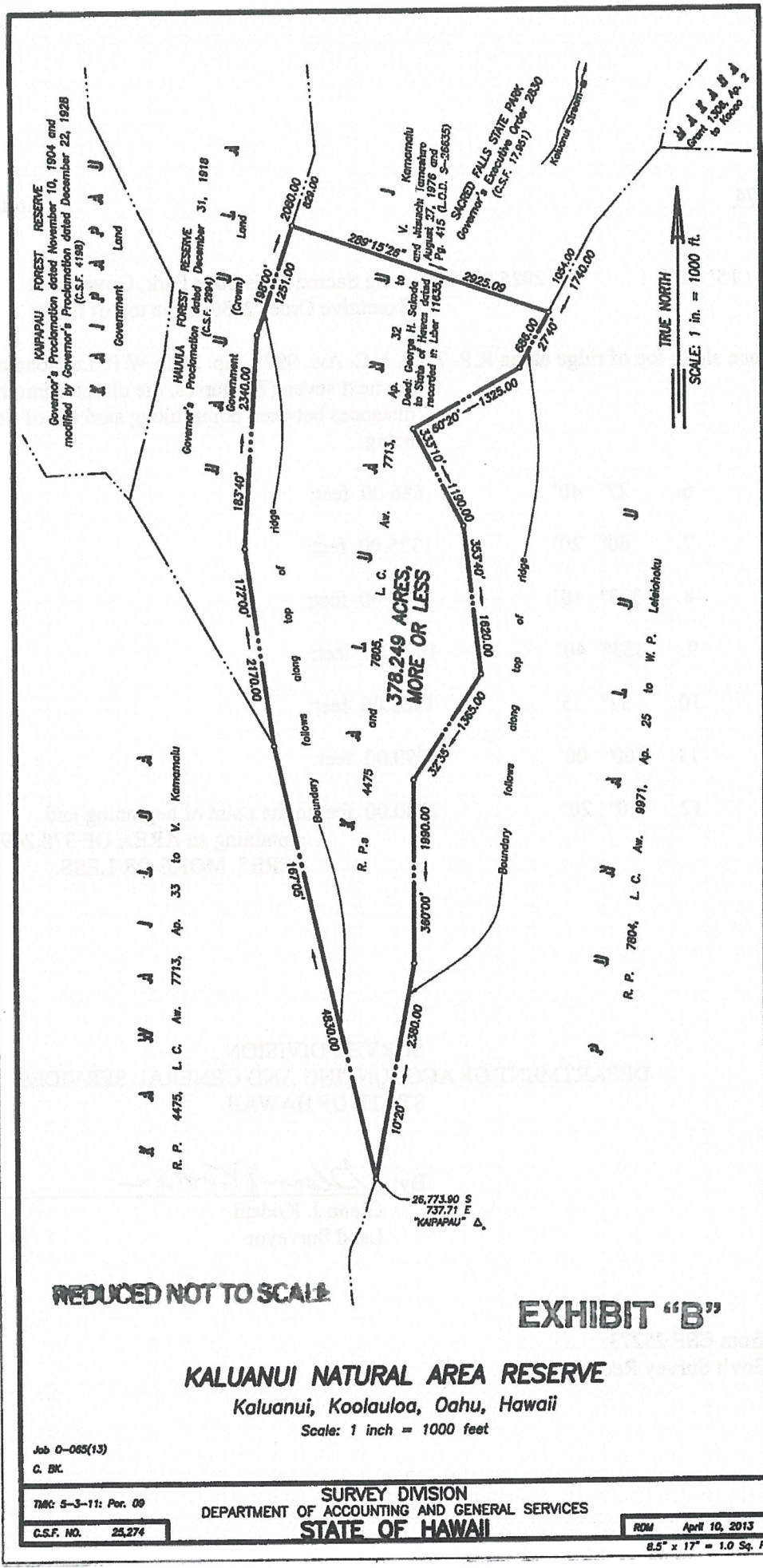

REDUCED NOT TO SCALE

EXHIBIT "B"

KALUANUI NATURAL AREA RESERVE
 Kaluanui, Koolauloa, Oahu, Hawaii

Scale: 1 inch = 1000 feet

Job O-065(13)
 C. BK.

TMC 5-3-11: Par. 09

C.S.F. NO. 25,274

SURVEY DIVISION
 DEPARTMENT OF ACCOUNTING AND GENERAL SERVICES
STATE OF HAWAII

RDW April 10, 2013

8.5" x 17" = 1.0 Sq. Ft.

PRELIM. APPR'D.
 Department of the
 Attorney General

LAND COURT SYSTEM)
 REGULAR SYSTEM)
 Return by Mail () Pickup () To:

Total Number of Pages:
 Tax Map Key No. (1) 5-3-011:009 por.

FROM: STATE OF HAWAII
 DEPARTMENT OF LAND AND NATURAL RESOURCES
 DIVISION OF STATE PARKS

 TO: STATE OF HAWAII
 BOARD OF LAND AND NATURAL RESOURCES
 1151 Punchbowl Street
 Honolulu, Hawaii 96813

EXECUTIVE ORDER NO. 4445

WITHDRAWING LAND FROM THE OPERATION OF
 GOVERNOR'S EXECUTIVE ORDER NO. 2830
 DATED MARCH 28, 1977

WHEREAS, by Governor's Executive Order No. 2830 dated
 March 28, 1977, certain land situate at Kaluanui, Koolauloa,
 Oahu, Hawaii was set aside for Sacred Falls State Park; and

WHEREAS, the Board of Land and Natural Resources at its
 meeting of March 8, 2013, approved the withdrawal of a portion of
 land from Executive Order No. 2830 dated March 28, 1977.

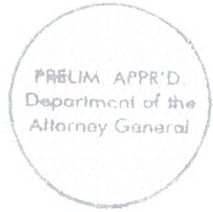

NOW, THEREFORE, I, NEIL ABERCROMBIE, Governor of the State of Hawaii, by virtue of the authority vested in me under Section 171-11, Hawaii Revised Statutes, as amended, do hereby order that the following described land, identified as "Withdrawal Portion of Sacred Falls State Park, Governor's Executive Order 2830," situate at Kaluanui, Koolauloa, Oahu, Hawaii, containing an area of 378.249 acres, more or less, more particularly described in Exhibit "A" and delineated on Exhibit "B," both of which are attached hereto and made parts hereof, said exhibits being respectively, a survey description and survey map prepared by the Survey Division, Department of Accounting and General Services, State of Hawaii, being designated as C.S.F. No. 25,273 and dated April 10, 2013, is hereby withdrawn from the Operation of Governor's Executive Order No. 2830 dated March 28, 1977.

SUBJECT to disapproval by the Legislature by two-thirds vote of either the Senate or the House of Representatives or by majority vote of both, in any regular or special session next following the date of this Executive Order.

IN WITNESS WHEREOF, I have hereunto set my hand and caused the Great Seal of the State of Hawaii to be affixed. Done at the Capitol at Honolulu this 10th day of

February, 2014.

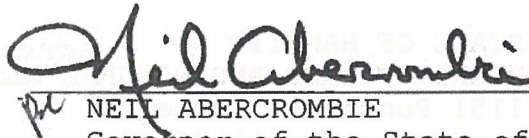

NEIL ABERCROMBIE

Governor of the State of Hawaii

APPROVED AS TO FORM:

COLIN S. LAU
Deputy Attorney General

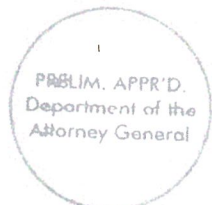
Dated: 11/15/13



STATE OF HAWAII

Office of the Lieutenant Governor

THIS IS TO CERTIFY That the within is a true copy of Executive Order No. 4445 withdrawing land from the operation of Executive Order No. 2830, the original of which is on file in this office.

IN TESTIMONY WHEREOF, the Lieutenant Governor of the State of Hawaii, has hereunto subscribed his name and caused the Great Seal of the State to be affixed.

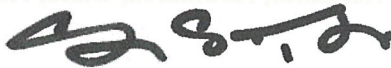

SHAN S. TSUTSUI
Lieutenant Governor of the State of Hawaii

DONE in Honolulu, this 12th day of February, A.D. 2013 2014





STATE OF HAWAI'I
SURVEY DIVISION
DEPARTMENT OF ACCOUNTING AND GENERAL SERVICES
HONOLULU

C.S.F. No. 25,273

April 10, 2013

WITHDRAWAL
PORTION OF SACRED FALLS STATE PARK
Governor's Executive Order 2830

Kaluanui, Koolauloa, Oahu, Hawaii

Being a portion of Royal Patents 4475 and 7805, Land Commission Award 7713, Apana 32 to V. Kamamalu conveyed to the State of Hawaii by George H. Sakoda and Jitsuichi Tamashiro by deed dated August 27, 1976 and recorded in Liber 11635, Page 415 (Land Office Deed S-26635).

Beginning on the top of ridge at the south corner of this parcel of land, the coordinates of said point of beginning referred to Government Survey Triangulation Station "KAIPAPAU" being 26,773.90 feet South and 737.71 feet East, thence running by azimuths measured clockwise from True South:-

1. Along top of ridge along R.P. 4475, L.C. Aw. 7713, Ap. 33 to V. Kamamalu, the direct azimuth and distance being:
167° 05' 4830.00 feet;

Thence along top of ridge along Hauula Forest Reserve, Governor's Proclamation dated December 31, 1918 for the next three (3) courses, the direct azimuths and distances between points along said top of ridge being:

2. 172° 00' 2170.00 feet;
3. 183° 40' 2340.00 feet;
4. 198° 00' 1251.00 feet;



5. 289° 15' 26" 2925.09 feet along the remainder of Sacred Falls State Park, Governor's Executive Order 2830 to the top of ridge;

Thence along top of ridge along R.P. 7804, L.C. Aw. 9971, Ap. 25 to W.P. Leleiohoku for the next seven (7) courses, the direct azimuths and distances between points along said top of ridge being:

- 6. 27° 40' 686.00 feet;
- 7. 60° 20' 1325.00 feet;
- 8. 333° 10' 1190.00 feet;
- 9. 353° 40' 1620.00 feet;
- 10. 32° 35' 1365.00 feet;
- 11. 360° 00' 1990.00 feet;
- 12. 10° 20' 2380.00 feet to the point of beginning and containing an AREA OF 378.249 ACRES, MORE OR LESS.

SURVEY DIVISION
DEPARTMENT OF ACCOUNTING AND GENERAL SERVICES
STATE OF HAWAII

By: Glenn J. Kodani
Glenn J. Kodani
Land Surveyor ry

Compiled from data provided by
DOFAW and Gov't Survey Records.

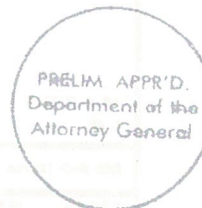

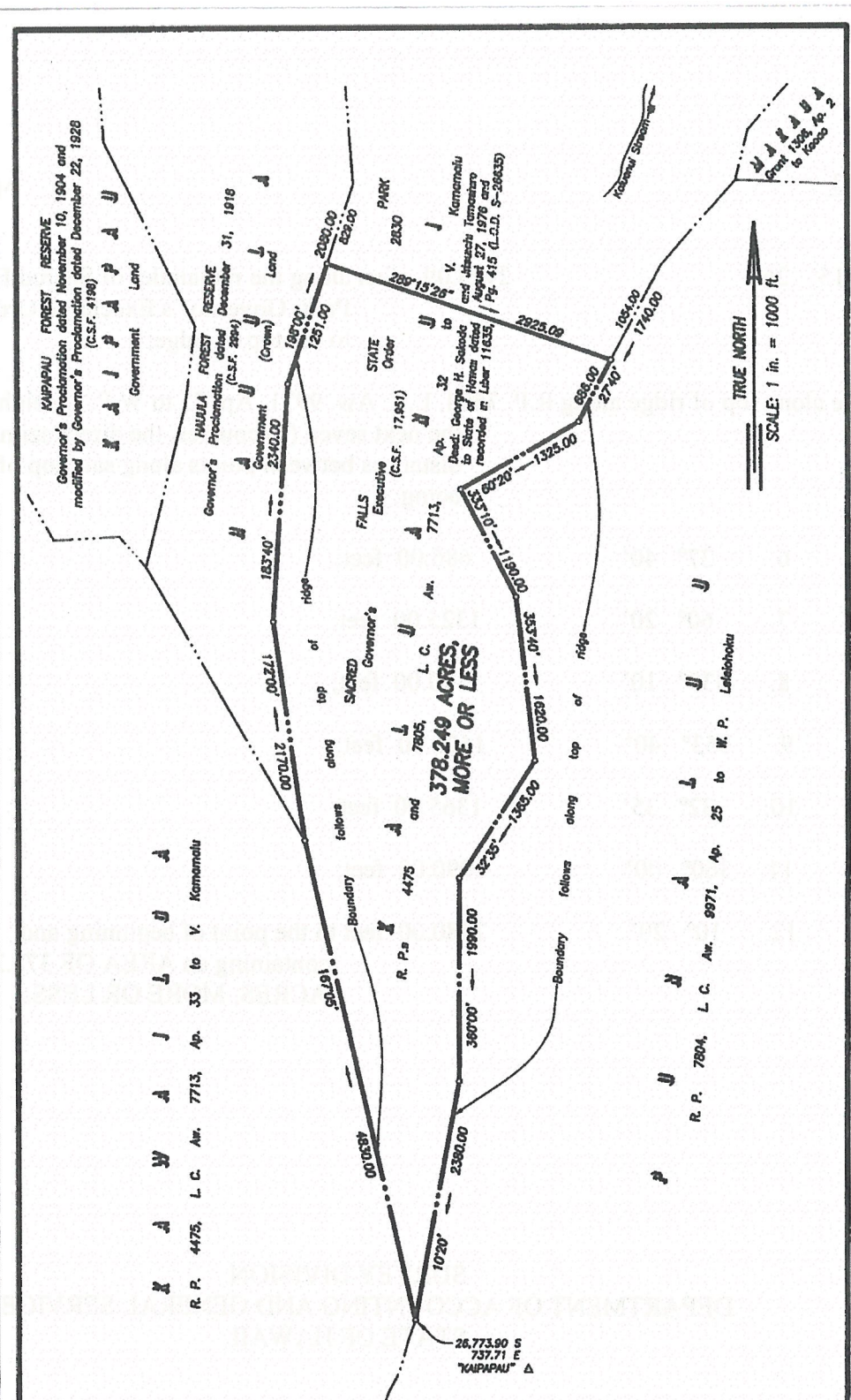

REDUCED NOT TO SCALE

EXHIBIT "B"

**WITHDRAWAL
PORTION OF SACRED FALLS STATE PARK**

Governor's Executive Order 2830
Kalanui, Koolauloa, Oahu, Hawaii

Job O-085(13)
C. BK.

Scale: 1 inch = 1000 feet

TMC 5-3-11: Por. 09

**SURVEY DIVISION
DEPARTMENT OF ACCOUNTING AND GENERAL SERVICES
STATE OF HAWAII**

C.S.F. NO. 25,273

RDM April 10, 2013

8.5" x 17" = 1.0 Sq. Ft.

