

Setting Aside Land for Public Purposes

By this Executive Order, I, the undersigned, Governor of the State of Hawaii, by virtue of the authority in me vested by Section 171-11, Hawaii Revised Statutes, and every other authority me hereunto enabling, do hereby order that the public land hereinafter described be, and the same is, hereby set aside for the following public purposes:

FOR NATURAL AREA RESERVE, to be under the control and management of the Department of Land and Natural Resources, State of Hawaii, being the lands situate at Mokuleia and Makaha, Waialua and Waianae, Oahu, Hawaii, and designated as MOUNT KAALA NATURAL AREA RESERVE, containing a Gross Area of 1103.0 Acres, more or less, and a Net Area of 1099.6 Acres, more or less, all more particularly described in Exhibit "A" and delineated on Exhibit "B", both of which are attached hereto and made a part hereof, said exhibits being, respectively, a survey description and survey map prepared by the Survey Division, Department of Accounting and General Services, State of Hawaii, both being designated C.S.F. No. 18,642 and dated August 5, 1981.

SUBJECT to disapproval by the Legislature by two-thirds vote of either the Senate or the House of Representatives or by majority vote of both, in any regular or special session next following the date of this Executive Order.

In Witness Whereof, I have hereunto set my hand and caused the Great Seal of the State of Hawaii to be affixed.
Done at the Capitol at Honolulu this 14th day of November, Nineteen Hundred and 81.



Governor of the State of Hawaii

Approved as to form:

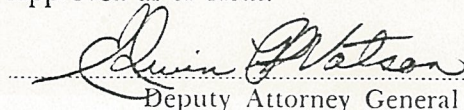
Deputy Attorney General



STATE OF HAWAII

SURVEY DIVISION

DEPT. OF ACCOUNTING AND GENERAL SERVICES

HONOLULU

August 5, 1980

C.S.F. No. 18,642

(REVISED AUGUST 1980)

MOUNT KAALA

NATURAL AREA RESERVE

Mokuleia and Makaha, Waialua and Waianae, Oahu, Hawaii

Comprising the following:-

- A. Portion of the Government Land of Mokuleia.
- B. Government Land (Portion of the Summit Plateau of Mount Kaala).

Beginning at the east corner of this parcel of land, the south corner of Land Court Application 1297 and at the intersection of boundaries between the lands of Mokuleia, Kamananui and Waianae-Uka, the coordinates of said point of beginning referred to Government Survey Triangulation Station "MOKULEIA" (1927) being 22,608.47 feet South and 18,909.85 feet East, thence running by azimuths measured clockwise from True South:-

Along top of ridge, along the boundary between the lands of Waianae-Uka and Mokuleia for the next two (2) courses, the direct azimuths and distances between points along said top of ridge being:

- 1. 76° 55' 44" 7095.1 feet;
- 2. 64° 40' 25" 3570.86 feet;
- 3. Thence along top of ridge, along the boundary between the lands of Waianae-Uka, Waianae-Kai and Makaha, the direct azimuth and distance being:
48° 10' 57" 2628.64 feet;
- 4. Thence along a contour line 3910 feet above mean sea level, along Lot 412-B as shown on Map 13 of Land Court Application 1052, the direct azimuth and distance being:
174° 51' 30" 2181.7 feet
to the top of ridge;

August 5, 1980

5. Thence along top of ridge, along the boundary between the lands of Makaha and Mokuleia, the direct azimuth and distance along said top of ridge being:
276° 20' 840.0 feet
to the easterly side of Dupont Trail;
6. Thence along the easterly side of Dupont Trail (along the easterly side of Access Easement and T. V. Translator Site, General Lease S-5006 to University of Hawaii and Access Easement and Reflector Site, General Lease S-4223 to Hawaiian Telephone Company), along the remainder of Mokuleia Forest Reserve (Governor's Proclamation dated December 31, 1918), the direct azimuth and distance along said easterly side of trail being:
182° 00' 5520.0 feet;
7. 262° 10' 4040.0 feet along the remainder of Mokuleia Forest Reserve (Governor's Proclamation dated December 31, 1918);
8. 267° 25' 3800.0 feet along the remainder of Mokuleia Forest Reserve (Governor's Proclamation dated December 31, 1918) to the westerly side of Jeep Trail;
9. Thence along the westerly side of Jeep Trail, along the remainder of Mokuleia Forest Reserve (Governor's Proclamation dated December 31, 1918), the direct azimuth and distance being:
280° 28' 25" 1554.68 feet;
10. 328° 24' 3700.0 feet along Grant 1799 to W. C. Collins and Land Court Application 1297 to the point of beginning and containing a GROSS AREA OF 1103.0 ACRES MORE OR LESS and a NET AREA OF 1099.6 ACRES MORE OR LESS after excluding therefrom the following listed Exclusions.

EXCLUSIONS

- | | |
|--|------------------|
| 1. Portion of the Government Land of Mokuleia covered by General Lease S-3747 to United States of America | 1.0 ACRE |
| 2. Boresite Facility Site covered by General Lease S-4027 to Communication Satellite Corp. | 0.1 ACRE |
| 3. Portion of easement for Mount Kaala Access Road (100-Feet Wide) covered by General Lease No. S-3748 to United States of America (Federal Aviation Agency) | <u>2.3 ACRES</u> |
| TOTAL AREA OF EXCLUSIONS | 3.4 ACRES |

August 5, 1980

SURVEY DIVISION
DEPARTMENT OF ACCOUNTING AND GENERAL SERVICES
STATE OF HAWAII

By: Raymond S. Nakamura
Raymond S. Nakamura
Land Surveyor

gm/ac

Compiled from map furn.
by DLNR, U.S.G.S. Quad Maps,
CSF 2642, Plat 2131, CSF 6309
and Govt. Survey Records.

MOKULEIA
(Governor's
(CSF 2642)

FOREST
Proclamation dated December
262° 10' → 4040.0

GROSS AREA
Less Exclusions 1, 2
NET AREA

WAIALUA DISTRICT
WAIANAE DISTRICT

Land Court Application
1052 (Amended)
Lot 412-B
(Map 13)

Boundary follows along
Approx. location of contour line
3910 feet above mean sea level

Boundary follows
along top of Ridge

Boundary follows along
easterly side of trail

SEE INSET

WAIALUA DISTRICT
WAHIAWA DISTRICT

BARRACKS
Executive

SCHOFIELD
(Presidential

SCHOFIELD
(Governor's
(CSF

BARRACKS
Proclamation
4683)

INSET
Scale: 1 inch

WAIALE - KAI
WAIALE-KAI FOREST RESERVE
(Governor's Proclamation dated Sept. 7, 1906)
(CSF 1737)

WAHIAWA DISTRICT
WAIANAE DISTRICT

ATTACHMENT B
STATE OF HAWAII
DEPARTMENT OF LAND AND NATURAL RESOURCES

RECORDATION REQUESTED BY:

68-20228

LIBER 6067 PAGE 85

68 MAY 20 PM 2:04

AFTER RECORDATION, RETURN TO:

RETURN BY: MAIL () PICKUP (x)

STATE OF HAWAII

DEPARTMENT OF LAND AND NATURAL RESOURCES

STATE GENERAL LEASE NO. S-3747

U. S. Lease, Contract No. DACA84-5-68-38

1. THIS INDENTURE OF LEASE, made this 14th day of May, 1968, by and between the STATE OF HAWAII, by its Board of Land and Natural Resources, hereinafter called the "LESSOR", pursuant to the provisions of Section 103A-90(b), Revised Laws of Hawaii 1955 (Supplement 1965), and THE UNITED STATES OF AMERICA, by its Corps of Engineers, hereinafter called the "GOVERNMENT",

WITNESSETH THAT:

2. For and in consideration of the covenants and mutual promises herein contained, the Lessor does hereby demise and lease unto the Government a portion of the State land of Mokuleia, being a portion of the Mokuleia Forest Reserve, more particularly described in Exhibit "A" and shown on Exhibit "B", attached hereto and made parts hereof.

3. TO HAVE AND TO HOLD, all and singular, said premises herein mentioned and described, unto said Government for and during the term of SIXTY-FIVE (65) YEARS, to commence from the 19th day of April, 1963, and to terminate on the 15th day of April, 2028.

EXEMPT—HAWAII CONVEYANCE TAX

AFFIDAVIT NOT REQUIRED

EXHIBIT "A"

PORTION OF THE GOVERNMENT LAND OF MOKULEIA

Mount Kaala, Mokuleia, Waialua, Oahu, Hawaii

Being also portion of Mokuleia Forest Reserve
covered by Governor's Proclamation dated December 31, 1918

Beginning at the south corner of this parcel of land, and on the boundary between the lands of Waianae Uka and Mokuleia, the coordinates of said point of beginning referred to Government Survey Triangulation Station "KAALA 1965" being 273.11 feet South and 180.51 feet West, as shown on Government Survey Registered Map 1533, thence running by azimuths measured clockwise from True South:-

1. 136° 07' 150.00 feet along the remainder of Mokuleia Forest Reserve;
2. 226° 07' 463.93 feet along the remainder of Mokuleia Forest Reserve;
3. 316° 07' 150.00 feet along the remainder of Mokuleia Forest Reserve;
4. Thence along top of ridge, along the boundary between the lands of Waianae Uka and Mokuleia, the direct azimuth and distance being: 344° 27' 103.09 feet;
5. Thence along top of ridge along the boundary between the lands of Waianae Uka and Mokuleia, the direct azimuth and distance being: 58° 27' 424.81 feet to the point of beginning and containing an AREA OF 1.80 ACRES.

SUBJECT, HOWEVER, to an easement in favor of the United States of America (Federal Aviation Agency) for the Mount Kaala Access Road (100 Feet Wide) covered by General Lease No. S-3748, as shown on plan attached hereto and made a part hereof.

RESERVE
December 31, 1918

TRUE NORTH
Scale: 1 in = 100 ft.

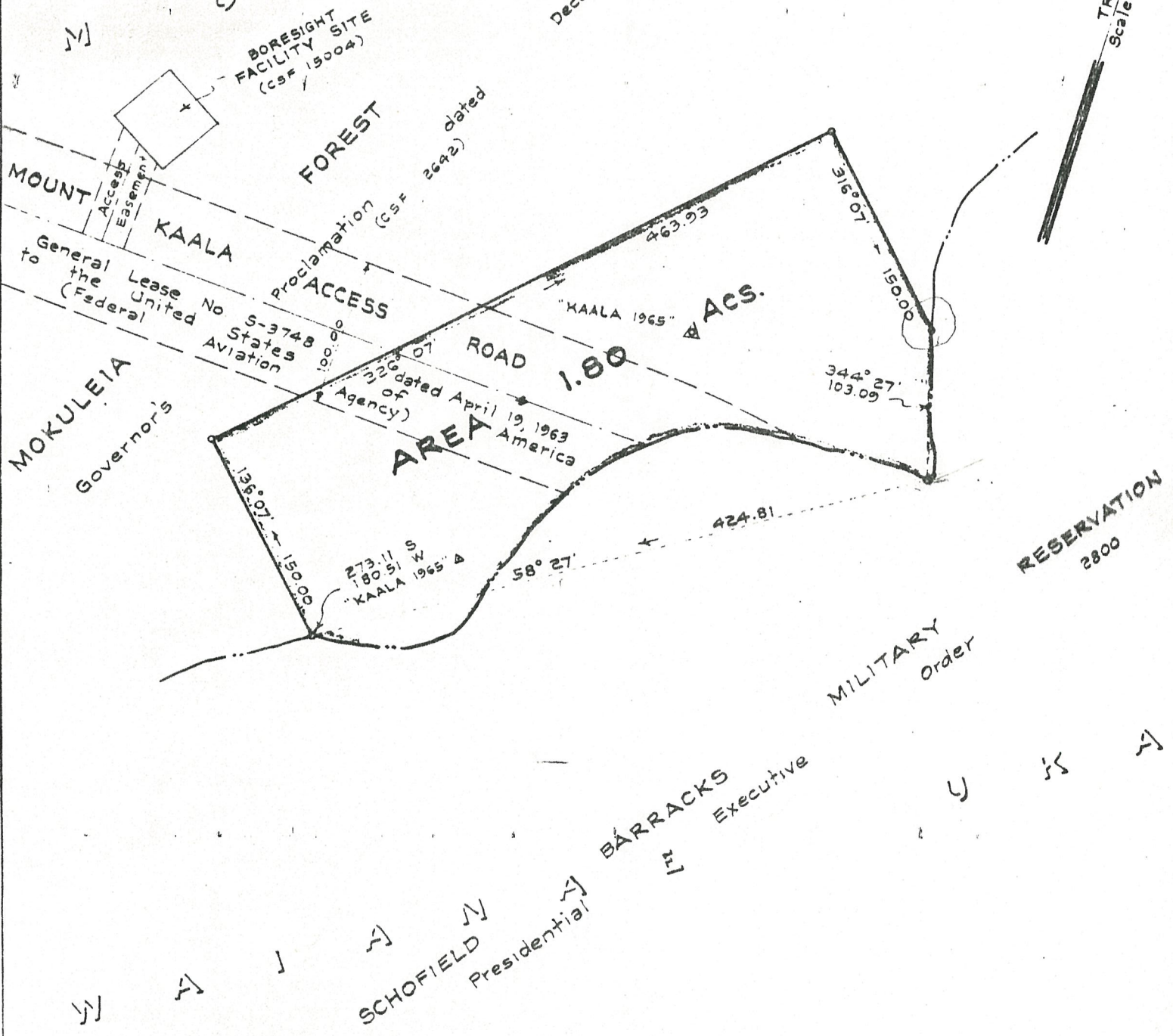

EXHIBIT "B"

PORTION OF THE
GOVERNMENT LAND OF MOKULEIA
Mount Kaala, Mokuleia, Waialua, Oahu, Hawaii
Scale: 1 inch = 100 feet

JOB O-4045
C. BK 7, Sakamoto

TAX MAP G-7-03; 8-4-02

SURVEY DIVISION
DEPARTMENT OF ACCOUNTING AND GENERAL SERVICES
STATE OF HAWAII

C. S. F. No. 15484

I.S. April 10 196