

Setting Aside Land for Public Purposes

By this Executive Order, I, the undersigned, Governor of the State of Hawaii, by virtue of the authority in me vested by Section 171-11, Hawaii Revised Statutes, and every other authority me hereunto enabling, do hereby order that the public land hereinafter described be, and the same is, hereby set aside for the following public purposes:

FOR NATURAL AREA RESERVE, to be under the control and management of the Department of Land and Natural Resources, State of Hawaii, being the lands situate at Waiakea, South Hilo and Olaa, Puna, Island of Hawaii, Hawaii, and designated as PUU MAKAAALA NATURAL AREA RESERVE, containing an area of 12,106 acres, more or less, all more particularly described in Exhibit "A" and delineated on Exhibit "B", both of which are attached hereto and made a part hereof, said exhibits being a survey description designated as C.S.F. No. 18,646 dated May 4, 1979, and a survey map designated as H.S.S. Plat 933, both prepared by the Survey Division, Department of Accounting and General Services, State of Hawaii.

SUBJECT to disapproval by the Legislature by two-thirds vote of either the Senate or the House of Representatives or by majority vote of both, in any regular or special session next following the date of this Executive Order.

In Witness Whereof, I have hereunto set my hand and caused the Great Seal of the State of Hawaii to be affixed.
Done at the Capitol at Honolulu this 16th day of November, Nineteen Hundred and 81

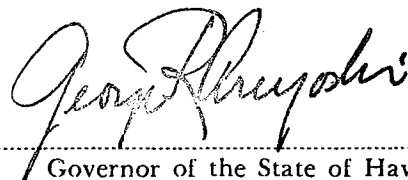

Governor of the State of Hawaii

Approved as to form:

Deputy Attorney General

State of Hawaii

Office of the Lieutenant Governor

3102

This is to Certify That the within is a true copy of Executive Order No.....
setting aside land for public purposes, the original of which is on file in this office.

In Testimony Whereof, the Lieutenant Governor of the
State of Hawaii, has hereunto subscribed his name
and caused the Great Seal of the State to be affixed.

DONE in Honolulu, this day of
....., A.D. 19.....

Executive Order No. 3102

Setting Aside Land for
Public Purposes

Land
Purpose
Date



STATE OF HAWAII

SURVEY DIVISION

DEPT. OF ACCOUNTING AND GENERAL SERVICES

C.S.F. No. 18,646

HONOLULU

May 4, 1979

PUU MAKAAALA NATURAL AREA RESERVE

Waiakea, South Hilo and Olaa, Puna

Island of Hawaii, Hawaii

Being portions of the Government (Crown) Lands of Waiakea and Olaa.

Beginning at the Government Survey Triangulation Station "KULANI" on the common corner of the lands of Keauhou, Waiakea and Olaa, as shown on Government Survey Registered H.S.S. Plat 933, thence running by azimuths measured clockwise from True South:-

1. 133° 18' 05" 1000.00 feet along Kilauea Forest Reserve (Governor's Proclamation dated December 22, 1928), along the boundary between the lands of Keauhou and Waiakea;

Thence along the south side of Roadway, along the remainder of Kulani Prison Site (Governor's Executive Order 1225) for the next five (5) courses, the direct azimuths and distances between points along said south side of roadway being:

2. 180° 30' 1260.00 feet;
3. 244° 45' 1310.00 feet;
4. 275° 00' 880.00 feet;
5. 293° 40' 1088.17 feet;
6. 318° 25' 753.90 feet to the boundary between the lands of Olaa and Waiakea;
7. 243° 20' 16,520.00 feet along the remainder of Upper Waiakea Forest Reserve (Governor's Proclamation dated January 3, 1923), along the boundary between the lands of Olaa and Waiakea;
8. Thence along the contour line 4000 feet above mean sea level, along the remainder of Upper Waiakea Forest Reserve (Governor's Proclamation dated January 3, 1923), the direct azimuth and distance being:
167° 09' 12" 6808.36 feet to the south side of Stainback Highway;

May 4, 1979

9. Thence along the south side of Stainback Highway, along the remainder of Upper Waiakea Forest Reserve (Governor's Proclamation dated January 3, 1923), the direct azimuth and distance being:
259° 50' 03" 17,874.62 feet;
10. Thence along the contour line 3000 feet above mean sea level, along the remainder of Upper Waiakea Forest Reserve (Governor's Proclamation dated January 3, 1923), the direct azimuth and distance being:
2° 44' 24" 1761.32 feet to the boundary between the lands of Olaa and Waiakea;
11. Thence along the contour line 3000 feet above mean sea level, along the remainder of Olaa Forest Reserve (Governor's Proclamation dated December 31, 1918), the direct azimuth and distance being:
353° 48' 52" 15,913.31 feet;
12. 302° 21' 10" 1100.00 feet along the remainder of Olaa Forest Reserve (Governor's Proclamation dated December 31, 1918);
13. 302° 21' 10" 4257.80 feet along Lots 129, 128, 127, 126 and 125, Olaa New Tract Lots;
14. 48° 32' 30" 3057.06 feet along Lot 135-B, Olaa New Tract Lots and along the northwest end of Roadway (50.00 ft. wide);
15. 302° 21' 10" 1506.52 feet along the southwest side of Roadway (50.00 ft. wide);
16. 34° 08' 30" 7462.10 feet along Lots 99, 98, 97, 96, 95, 94, 93, 92, 91, 90-B and 90-A, Olaa New Tract Lots;
17. 149° 31' 17,853.54 feet along Hawaii Volcanoes National Park, Parcel 6 (Governor's Executive Order 1540);
18. 59° 31' 20,000.00 feet along Hawaii Volcanoes National Park, Parcel 6 (Governor's Executive Order 1540);
19. 329° 31' 7976.25 feet along Hawaii Volcanoes National Park, Parcel 6 (Governor's Executive Order 1540);
20. 59° 31' 4359.10 feet along Lots 16 and 17, Volcano Farm Lots and along the northwest end of Roadway (50.00 ft. wide);

May 4, 1979

21. 149° 31' 17,016.25 feet along Kilauea Forest Reserve (Governor's Proclamation dated December 22, 1928), along the boundary between the lands of Keauhou and Olaa to the point of beginning and containing an AREA OF 12106 ACRES, MORE OR LESS.

The above-described PUU MAKAAALA NATURAL AREA RESERVE is subject, however, to the following as shown on plan attached hereto and made a part hereof.

1. Television Translator Station Site covered by General Lease S-4234 to University of Hawaii.

SURVEY DIVISION
DEPARTMENT OF ACCOUNTING AND GENERAL SERVICES
STATE OF HAWAII

By: Ichiro Sakamoto
Ichiro Sakamoto
Land Surveyor

Compiled from data furn.
by N.A.R.S., U.S.G.S. Map
& Govt. Survey Records.

gm

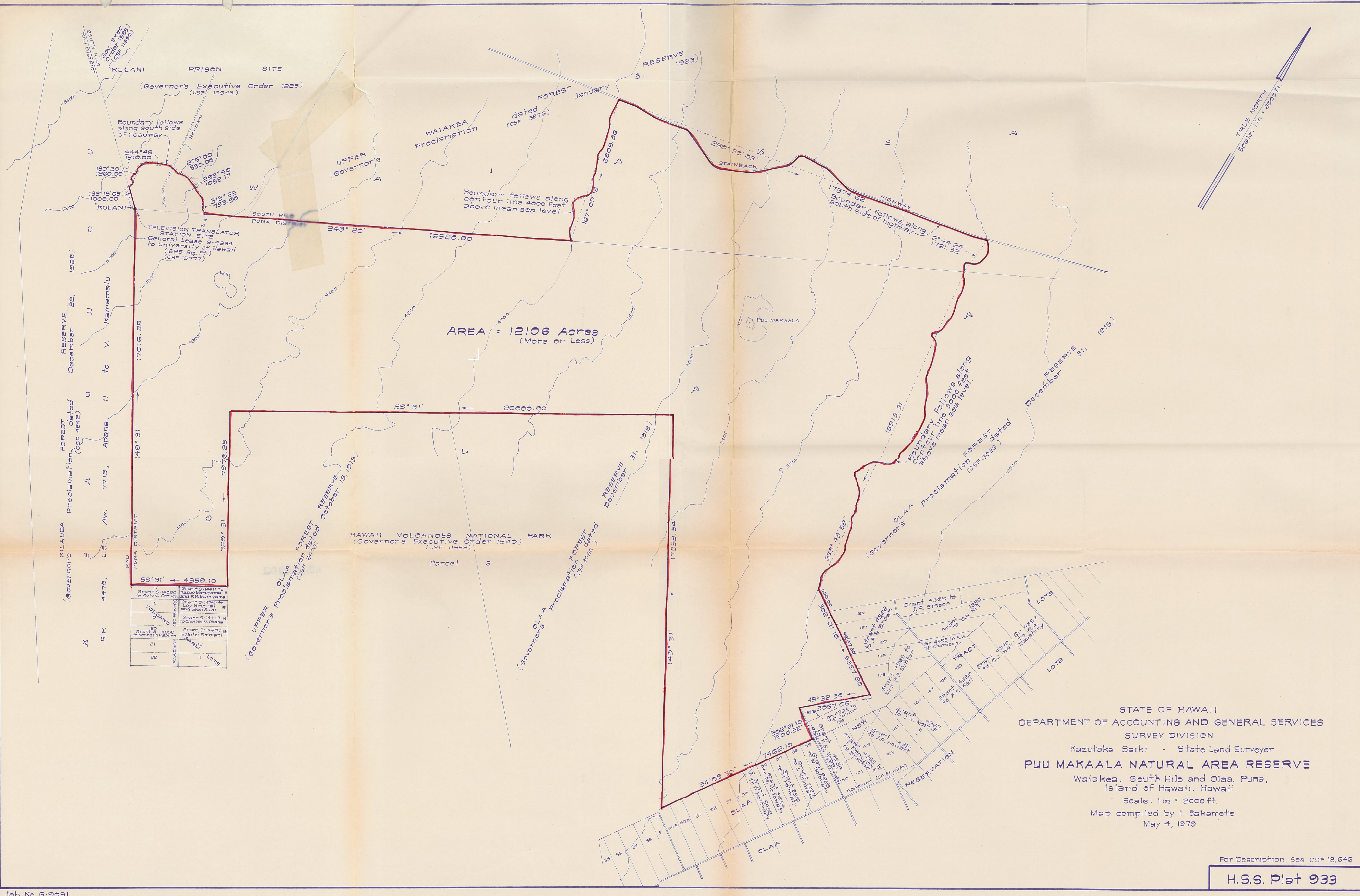

Grant S. 14000 to to Sylvia Church and 18	Grant S. 14411 to Kazuo Maruyama and 19
Grant S. 14752 to Loy Hing Lai, 15 and Joan S. Lai	Grant S. 14752 to Loy Hing Lai, 15 and Joan S. Lai
Grant S. 14443 to to Charles M. Okawa	Grant S. 14443 to to Charles M. Okawa
Grant S. 14655 to to Kenneth H. Wren	Grant S. 14655 to to Kenneth H. Wren
Grant S. 14655 to to Motoshi Shiofani	Grant S. 14655 to to Motoshi Shiofani
21	21
22	22
11	11

STATE OF HAWAII
DEPARTMENT OF ACCOUNTING AND GENERAL SERVICES
SURVEY DIVISION
Kazutaka Saiki - State Land Surveyor
PUU MAKAAALA NATURAL AREA RESERVE
Waiakea, South Hilo and Olaa, Puna,
Island of Hawaii, Hawaii
Scale: 1 in. = 2000 ft.
Map compiled by I. Sakamoto
May 4, 1979

For Description, See CSF 18,642

H.S.S. Plat 933