

JAN 11 1983

REF. NO.: CPO-1096  
FILE NO.: HA-7/22/82-1492  
180-DAY EXP, DATE: 1/20/83

Mr. Harold S. Masumoto  
Vice-President for Administration  
University of Hawaii  
2444 Dole Street, Room 202  
Honolulu, Hawaii 96822

Dear Mr. Masumoto:

We are pleased to inform you that your Conservation District Use Application for construction of the California Institute of Technology 10-meter telescope for millimeter and submillimeter astronomy at Mauna Kea, with right-of-entry, at Hamakua, Hawaii, was approved on December 17, 1982. Subject to the following recommendations and conditions:

- A. Approval of the application subject to the following conditions:
1. That the applicant comply with all applicable statutes, ordinances, rules and regulations of the Federal, State and City and County governments, and applicable parts of Section 13-2-21 of Title 13, Chapter 2, Administrative Rules, as amended;
  2. Other terms and conditions as prescribed by the Chairman;
  3. In that this approval is for use of conservation lands only, the applicant shall obtain appropriate authorization through the Division of Land Management, State Department of Land and Natural Resources for the occupancy of State lands;
  4. In the event any unanticipated sites or remains such as shell, bone or charcoal deposits, human burials, rock or coral alignments, pavings, or walls are encountered during construction, the applicant shall stop work and contact the Historic Preservation Office at 548-7460 or 548-6408;

Mr. Harold S. Masumoto  
Page 2  
JAN 11 1983

CPO--1096  
RA#1492

5. That the applicant comply with all applicable Public Health Regulations;
  6. A fire contingency plan, acceptable to the Division of Forestry and Wildlife shall be implemented during and after the construction of the structure.
- B. That this approval is not to be considered as precedence for any future action the Board may desire to exercise through their discretionary conditional land use action.
- C. That no further commitment of land use involving major improvements within the Mauna Kea Science Reserve be considered until such time as the University's Mauna Kea Science Reserve Development Plan is completed.

Should you have any questions on any of these conditions, please feel free to contact Mr. Roger C. Evans of our Planning Office at 548-7837.

Very truly yours,

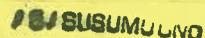
SUSUMU ONO

SUSUMU ONO, Chairman  
Board of Land and Natural Resources

cc: Hawaii Board Member  
Hawaii Land Agent  
Hawaii Planning Dept.  
DOH/OEQC/EQC/OHA/DPED

bcc: DAR  
NARS  
DOFAW  
DOWALD  
DOCARE  
Land Management  
State Parks/Historic Sites

  
ss:sta

GEORGE R. ARIYOSHI  
GOVERNOR OF HAWAII



STATE OF HAWAII  
DEPARTMENT OF LAND AND NATURAL RESOURCES  
P. O. BOX 621  
HONOLULU, HAWAII 96809

SUSUMU ONO, CHAIRMAN  
BOARD OF LAND & NATURAL RESOURCES  
EDGAR A. HAMASU  
DEPUTY TO THE CHAIRMAN

DIVISIONS:  
AQUACULTURE DEVELOPMENT  
PROGRAM  
AQUATIC RESOURCES  
CONSERVATION AND  
RESOURCES ENFORCEMENT  
CONVEYANCES  
FORESTRY AND WILDLIFE  
LAND MANAGEMENT  
STATE PARKS  
WATER AND LAND DEVELOPMENT

FILE NO.: HA-7/22/82-1492  
180-Day Exp. Date: 1/20/83

December 17, 1982

Board of Land and  
Natural Resources  
State of Hawaii  
Honolulu, Hawaii

Gentlemen:

Conservation District Use Application for  
Construction of the California Institute of Technology  
10-Meter Telescope for Millimeter and Submillimeter Astronomy  
at Mauna Kea, with Right of Entry at Hamakua, Hawaii

APPLICANT: University of Hawaii  
2444 Dole Street, Room 202  
Honolulu, Hawaii 96822

LANDOWNERSHIP: State of Hawaii, General Lease No. S-4191  
to the University of Hawaii

LOCATION: TMK: 4-4-15: 9

AREA OF PARCEL/USE: 13,321.054 acres/8,850 square feet  
on a .75 acre site

SUBZONE: Resource

DESCRIPTION OF AREA:

Access to the summit of Mauna Kea is from Saddle Road, Route 20, which connects Hilo to Mamalahoa Highway, Route 19. From Saddle Road at Puu/Huluhulu, a paved road extends approximately six miles to Hale Pohaku. From there, an 8.5 mile unpaved one-lane road extends to the summit. Exhibit A shows the roads within the Science Reserve. Caltech's proposed site is adjacent to an unpaved road.

The applicant indicates there are no officially designated endangered plant species on the summit. Photographs of the proposed site indicate that the area is a likely site for lichens and bryophytes, the principal components of flora at the summit. The project site is not suitable for higher plant life such as ferns or seed bearing plants.

The topography of the site is relatively flat.

No utilities directly serve the site. The generator used for power needs at the summit is approximately 1,300 feet south of Caltech's proposed site. Two 12 KV underground power lines run from the generator to the summit cinder cone. The power is distributed through underground conduits to the existing telescope facilities. The microwave antenna which provides telephone communication to the summit is located on the UH 88-inch telescope facility. Water must

ITEM H-6

Board of Land and  
Natural Resources

HA-1492  
December 17, 1982

be trucked to the summit from Hilo. Each telescope has its own water storage tank. Each of the four large existing telescopes has its own septic tank. Solid waste is carried down to Hale Pohaku by telescope personnel.

**CURRENT USE:**

The .75 acre site, within the Science Reserve at the foot of Puu Poliahu is empty and undeveloped.

**PROPOSED USE:**

The applicant, the University of Hawaii, proposes to utilize a .75 acre site for the purpose of constructing a 10-Meter Telescope for Millimeter and Submillimeter Astronomy for the California Institute of Technology.

The proposed telescope will be able to investigate the submillimeter portion of the electromagnetic spectrum. The development of an instrument capable of studying the submillimeter band has opened a whole new field of inquiry for astronomers. The telescope provides a new way to investigate the astronomical environment in regions inaccessible to optical methods.

The University of Hawaii is the holder of a general lease for the area known as the Science Reserve and are the applicants; however, the telescope would be constructed and operated by the California Institute of Technology. If approval is given for the proposed use, the University will enter into an operating agreement and sublease with the California Institute of Technology.

**Description of Operations:**

Construction: Although the .75 acre site selected for this telescope is essentially level, some grading and excavating will be necessary to prepare the area for construction. A minimal foundation will be required, since the telescope and dome are relatively light (total building and telescope weight will be less than 250 tons).

Approximately 100 cubic yards will have to be excavated for concrete footing, foundations, an 850 gallon septic tank, housing for the 25 KW standby generator and 1,000 gallon fuel tank, and a 1,000 to 1,500 gallon water tank. Most of the excavated material will be used as fill or for balancing the site. Additional excavation will be done for installation of the telephone and power lines. The existing utility trench and 1,300 linear feet of a new trench from the generator to the Caltech site will have to be excavated for telephone and power lines.

One hundred fifty yards of concrete will be used in the construction of the facility. No concrete batch plant will be required. Dry mix concrete will be trucked to the summit in mixing trucks and water will be added at the site. Approximately thirty truck loads will be required.

Board of Land and  
Natural Resources

HA-1492  
December 17, 1982

Construction equipment, vehicles, and materials, a temporary construction field office and an auxiliary generator will be stored on-site during construction and will be removed upon completion of the construction phase. Outdoor sanitary facilities will be used during the construction phase. Power will be provided by the on-site auxiliary generator.

Operations: It is estimated that when the telescope becomes operational an average of five to seven persons will be present on the mountain at one time, operating in two shifts per day at the telescope site. The additional personnel are expected to generate an additional 1,100 to 1,500 gallons per month of liquid sewage, the consumption of 1,500 to 2,000 gallons per month of water for heating, cooling and domestic consumption, and the additional consumption of less than four gallons per hour of diesel fuel by the 850 KW generator.

#### The Agency Review

On August 4, 1982, the application was sent out for review and comment to the following agencies:

U.S. Fish and Wildlife Service; County of Hawaii, Planning Department, Department of Water Supply, Department of Parks and Recreation, Department of Public Works; State Department of Health, Office of Hawaiian Affairs, Department of Defense, Office of Environmental Quality Control, Environmental Quality Commission; and the following Department of Land and Natural Resources divisions: Aquatic Resources, Forestry and Wildlife, State Parks/Historic Sites, Land Management, Water and Land Development, Conservation and Resources Enforcement, and the Natural Area Reserves System.

Their comments are as follows:

United State Department of the Interior, Fish and Wildlife Service:

The proposed action is not expected to have adverse impact on significant fish and wildlife resources in the area; however, we recommend that additional studies of the geoeolian ecosystems at Mauna Kea be completed, and that appropriate mitigation measures be identified to protect these resources prior to any ground-breaking or construction. (Emphasis added)

County of Hawaii, Planning Department:

We have reviewed both the subject application and its draft Environmental Impact Statement (EIS) dated May 18, 1982. We express no objection to this application; and the draft EIS appears to have adequately addressed the more significant environmental aspects of the proposal, as also referenced in our February 10, 1982 letter which responded to the EIS Preparation Notice.

County of Hawaii, Department of Water Supply:

We have no objections to the request.

There is no public water system in the area.

Board of Land and  
Natural Resources

HA-1492  
December 17, 1982

County of Hawaii, Department of Public Works:

We have no comments or objections to offer.

County of Hawaii, Department of Parks and Recreation:

This department has no adverse comments to offer.

State of Hawaii, Department of Health:

We do not foresee any major adverse environmental effects arising from this project.

Please be informed that we have no objections to granting the permit.

State of Hawaii, Department of Defense:

We have no comments to offer at this time.

Office of Environmental Quality Control:

We have no objections to this project. The Environmental Impact Statement for this project has met our disclosure criteria. The EIS was accepted on August 26, 1982.

Division of Aquatic Resources:

Our concern for this proposed project is the potential impact of sewage disposal on the waters of Lake Waiau even though the Lake is approximately 4,000 feet from and at an elevation 280 feet below the proposed Caltech telescope site. The subject document, however, addresses this potential problem at great length and we feel assured that Lake Waiau will be safe from sewage contamination. Aside from this we have no further comments to offer.

Division of Forestry and Wildlife:

We are very much concerned over the impact the astronomy development has had on Mauna Kea to date. We strongly recommend that Caltech's EIS and Conservation District Use Application not be accepted and processed individually. Rather, the Department should wait for the University of Hawaii's single EIS and Conservation District Use Application which will include all summit development to the year 2000, including Caltech's proposed facility. Such a collective proposal will provide the Department and the public with an opportunity to review and evaluate the total impact of the development proposed for the next twenty years.

We appreciate the reason for Caltech not wanting to wait. However, to accept their Conservation District Use Application will be setting a precedence for other individual requests, resulting in an erosion of the total planning concept. (Emphasis added)

Board of Land and  
Natural Resources

HA-1492  
December 17, 1982

Division of State Parks/Historic Sites:

Recreation Concerns:

We note that snow play activities will continue as they have in the past (p. 76). No mention has been made of any public information facilities at the observatory although we note Caltech has agreed to assist in funding the visitor information center in Hale Pohaku.

Historic Sites Concerns:

We concur with the subject document's statement that preserving the integrity of Lake Waiiau and protecting the adze quarry are concerns which must be addressed (Draft EIS, 1982:74).

The Mauna Kea Adze Quarry (site #4136) is listed on the National Register of Historic Places. Its proximity to the proposed telescope site may result in indirect impacts to this site. Therefore, we would like to review the archaeological report prior to making any further recommendations.

Division of Land Management:

In general, the Land Management Division has no objections to the subdivision, construction and use of State land at Mauna Kea, Hamakua, Hawaii for astronomy use by the California Institute of Technology as requested by the University of Hawaii.

However, we reserve final approval of such application pending review of the Environmental Impact Statement for the project.

Division of Water and Land Development:

1. Although the summit area has a low rainfall of less than 15 inches and minimal grading and excavation will be done for site preparation, it is suggested that appropriate measures be taken to prevent or minimize erosion and sedimentation during and after construction of the project.
2. The Draft EIS indicates sewage disposal into a septic tank is not expected to impact the hydrology of the area or pollute Lake Waiiau. However, it is suggested that the applicant monitor the septic tank disposal system on a continuing basis to identify and control any adverse environmental impacts if any should occur.

Natural Area Reserves System:

Based on information in the draft EIS for the above project (Caltech 10-Meter Telescope on Mauna Kea Summit), the nearby Mauna Kea Ice Age Natural Area Reserve and its protected resources will not be adversely impacted. Potential short- and long-term effects of air pollutants and cesspool leaching

Board of Land and  
Natural Resources

HA-1492  
December 17, 1982

on adjacent areas, including Lake Waiau, are addressed and considered to be negligible. We have no objection to the project.

SUMMARY OF PUBLIC HEARING:

The Board of Land and Natural Resources held a public hearing on this matter on September 9, 1982 at 6:30 p.m. at the Waimea State Office Building, Waimea, Hawaii.

Concerns were expressed relating to the following items:

a. Environmental Impact Statement Approval/Responsibility for action.

The Office of Environmental Quality Control makes a recommendation, based on the environmental quality requirements for information and disclosure, to the Governor regarding the EIS's acceptability. OEQC indicated the document had met their requirements for disclosure and made a recommendation for acceptance on August 19, 1982. This EIS was accepted by the Governor, State of Hawaii, on August 26, 1982.

b. Responsibility for Monitoring Lake Waiau water quality.

Lake Waiau is approximately 40,000 meters from the project site.

The applicant at the public hearing stated that the United States Geological Survey is presently monitoring the water quality of Lake Waiau; however, Staff has been informed that this is not an on-going activity and presently no one is monitoring the water quality (per telephone conversation with Natural Area Reserves administrator, 10/8/82).

We note that anyone assigned the task would require not only staff but also a laboratory able to provide the required analysis.

The University's consultant has provided additional analysis and maintains that sewage effluent pollution of Lake Waiau is "not possible."

c. Relationship of the Proposal to the 1977 Mauna Kea Plan.

(Addressed in the analysis section of this submittal)

d. Choice of Mauna Kea; other sites considered; could the project be undertaken elsewhere?

Mauna Kea satisfies all the essential criteria for the type of facility proposed. A high elevation with dry atmosphere, year-around good weather accessible by road year around, infrastructure for astronomy and technical support, location near the equator permitting a good view of the southern skies and thus the galactic center, the area of star formation (referred to as a low-latitude site). Based on these criteria, Mauna Kea was determined the best site.



Board of Land and  
Natural Resources

HA-1492  
December 17, 1982

Other sites evaluated include the following: White Mountain, California; the Chilean mountain ranges, Viero Tolo, Las Campanas; Mount Lemon and Mount Graham Arizona, several other California mountains, and mountains in the Canary Islands, off the Coast of Africa. A world-wide survey was undertaken in 1972/1973 specifically for this purpose, site evaluation.

e. Nature of Caltech/UH agreements, sub-lease; compensation/benefits.

The University of Hawaii is the holder of a master lease and are the applicants for this Conservation District Use Application. The telescope will be constructed by the California Institute of Technology. UH has a Memorandum of Understanding with the California Institute of Technology requiring the University of Hawaii to assist Caltech in all necessary applications and approvals. Should the University of Hawaii fail to require the necessary permits and approvals within the time specified in the Memorandum, the project, and agreement is terminated.

The applicant indicates that if this Conservation District Use Application is approved, the University and Caltech would enter into operating agreements and a sub-lease.

It is anticipated that Caltech would share the cost of providing infrastructure, and the associated costs of operating on Mauna Kea.

The University will also request compensation. Until now this has usually been provided in the form of free utilization of the facility during a limited time period. Other forms of compensation are being explored, time-plus-facility, or graduate student assistance. The final arrangements have not been worked out, but would essentially serve to support UH-Manoa Astronomy Program.

Presently, the University is permitted 15 percent time usage of the United Kingdom Infrared Telescope.

Economic benefit will consist of the spending of about \$500,000.00 dollars within the State. The University has leased 188 acres of land in Hilo, above the University Hilo campus off Komohana Street for lease support facilities and presently desires to locate Caltech support staff at this site, rather than on Mauna Kea.

f. Visual Pollution resulting from presence of the Caltech Telescope.

Response: The applicant indicated this telescope is situated in a flat area which cannot be seen from Hilo, Waimea, or Kailua-Kona. While the site is not in a gully, it does sit on a plateau at an elevation of 13,336 feet, between Puu Poliahu and Puu Wekui, the summit. To the north it is hidden from the Kamuela area by another 13,600+ foot peak. To the south, the site is exposed, as the slope drops down toward Hale Pohaku and the Natural Area Reserve System area, but

Board of Land and  
Natural Resources

HA-1492  
December 17, 1982

due to its placement, it appears it would not be visible from the Saddle Road. The proposed facility could only be seen at a distance, by someone on the summit or upper slopes of Mauna Loa.

g. Monitoring of Air Quality

The applicant indicates this is done by the National Oceanic and Atmospheric Administration (NOAA) on both Mauna Loa and Mauna Kea. NOAA monitors the emissions from diesel generators used for power requirements on Mauna Kea.

h. Radio Frequency Interference

The proposed telescope is a passive telescope; it receives signals. It does not generate signals. Other telescopes now present on Mauna Kea do not experience interferences.

Local island radio operators (HAM operators) have expressed concern. The University has reassured operators that any communication systems now used operate at a frequency different from that used by HAM operators.

ANALYSIS:

Following review and acceptance of the application, for processing, the applicant, by letter dated August 4, 1982, was notified that:

1. The proposed use is a conditional use in the Resource Subzone of the Conservation District according to Title 13, Chapter 2, Administrative Rules, as amended;
2. A public hearing pursuant to Chapter 183-41, Hawaii Revised Statutes, as amended, was required and held;
3. An environmental impact statement in accordance with Section 1:31 of the EIS Regulations will be required for the proposed use and written clearance from the County of Hawaii regarding SMA requirements has been obtained.

The objective of the Resource Subzone is to develop, with proper management, areas to ensure sustained use of the natural resources of those areas.

Section 13-2-21 relating to standards requires all applications be reviewed in such a manner that the objective of the subzone is given primary consideration.

This analysis consists of a review of the input received through 1) a chronology of past events, 2) agency review, the Public Hearing process, and the Environmental Impact Statement and 3) the Land Use Planning perspective.

1. Mauna Kea Chronology

1930 Hale Pohaku, "House of Stone" cabins constructed at 9,200 feet elevation. These cabins replaced a complex of buildings located at 7,800 foot elevation

Board of Land and  
Natural Resources

HA-1492  
December 17, 1982

which had been used by Forestry personnel and road construction workers. Hale Pohaku was placed under the jurisdiction of State Parks division of Department of Land and Natural Resources in 1962, but has never been designated as a State park.

- 1963 Dr. Gerald P. Kuper of University of Arizona and University of Hawaii carries out first observatory site tests with State and Federal support.
- 6/18/68 Board of Land and Natural Resources leases all lands above the 12,000 foot elevation to the University of Hawaii for a period of 65 years. (General Lease No. S-4191. Area is designated "The Mauna Kea Science Reserve". Area is 13,321 acres)
- 7/68 UH/USAF 61 cm (24 inches) Optical telescope becomes operational.
- Fall, 1968 UH/NASA 61 cm (24 inches) Optical telescope becomes operational.
- 1/70 UH/NASA 2.24 cm (88 inches) Optical/Infrared Telescope becomes operational.
- 6/8/73 Board approves CDUA No. HA-4/27/73-442 for construction of underground electric distribution line from 12,950 feet to observatory at summit - a five foot wide easement running over a distance of 5,200 feet. (12.47 kv line)
- 5/10/74 Board approves CDUA HA-1/29/74-528 by Canada-France-Hawaii Telescope Corporation for observatory use. Hawaii Corporation for temporary buildings and utilities for construction workers.
- 5/24/74 Board approves CDUA HA-1/29/74-527 by DLNR - Land Management Division for Canada-France-Hawaii Telescope Corporation for observatory use.
- 6/14/74 Board approves CDUA No. HA-2/28/74-537 by the State of Hawaii, Department of Transportation, Highways Division for Mauna Kea Observatory Access Road.
- 6/13/75 Board approves CDUA No. HA-2/27/75-640 by Downs Laboratory of Physics for temporary portable Infrared Telescope use.
- 8/4/75 Governor accepts EIS for IRTF and UKIRT facilities. (see CDUA HA-653)
- 8/29/75 Board approves CDUA No. HA-3/25/75-653 for construction Infrared Telescope Facility (IRF) and United Kingdom Infrared Telescope (UKIRT) with access road.

Board of Land and  
Natural Resources

HA-1492  
December 17, 1982

- 3/12/76 Board denies CDUA No. HA-1/2/76-746 by Science Research Council for temporary buildings.
- 5/14/76 Board approves CDUA No. HA-3/30/76-781 for construction of temporary living quarters for UKIRT workers at Hale Pohaku.
- 5/14/76 Board approves CDUA No. HA-4/26/79-789 for Temporary Access Use - a Batch Plant for construction of the UKIRT facilities.
- 7/23/76 Board approves CDUA No. HA-5/13/76-804 for  
8/26/76- improvements to existing buildings at Hale Pohaku;  
amended rennovations - fire detection and alarm systems;  
replacement of stairs, walks, railings to mess hall and Dormitory Number Two.
- 5/13/77 Board approves CDUA No. HA-1/6/77-895 for interim mid-level facilities, replacement of buildings.
- 5/27/77 Board issues revocable permit for 4.0 acres at Hale Pohaku, a portion of which is occupied by the existing dormitory/mess hall constructed for UKIRT workers.
- 5/27/77 Revocable Permit No. S-5537 for four acres of Hale Pohaku issued. This permit replaced earlier Revocable Permit No. S-4440 for 12,000 square feet. A larger area - six acres was subdivided under CDUA No. HA-1430 replacing revocable permits.
- 9/9/77 Board approves CDUA No. HA-5/26/77-954 - an after-the-fact CDUA for three (3) telescopes: 88-inch telescope, 24-inch Air Force Telescope, and the 24-inch Planetary Control Telescope plus ancillary facilities (housekeeping CDUA).
- 9/9/77 Board approves CDUA No. HA-5/26/77-995 for interim power plant expansion. (Four generator building)
- 1/13/78 Board approves CDUA No. HA-11/9/77-1009 by the National Weather Service, U. S. Department of Commerce for Telemetry Improvements which are part of the Hawaii Regional Tsunami Warning System.
- 11/9/78 Mauna Kea Ice Age Natural Area Reserve approved by the BLNR.
- 11/9/78 Agreement of transfer between the Science Research Council (agents for United Kingdom Infrared Observatory) and the University of Hawaii approved. University accepts responsibility for facilities located at Hale Pohaku.
- 1979 NASA 3.0 cm (120 inches) Infrared Telescope becomes operational.

Board of Land and  
Natural Resources

HA-1492  
December 17, 1982

- 1979 Canada/France/Hawaii Telescope (CFHT) 3.6 cm (144 inches) Optical/Infrared Telescope becomes operational.
- 1979 United Kingdom 3.8 cm (150 inches) Infrared Telescope becomes operational.
- 7/27/79 Board approves CDUA No. HA-2/14/79-1131 by the University of Hawaii for electric power use including interim and permanent improvements.
- 5/9/80 Board approves amendment to CDUA No. HA-2/14/79-1131 for temporary electrical power use.
- 5/16/80 Board approves CDUA No. HA-1210 for physiological research use involving hormone research for a period of six (6) days.
- 7/25/80 Board denies CDUA No. HA-3/17/80-1221 by Ski Shop Hawaii, Inc. for commercial snow skiing activities.
- 9/12/80 Board approves amendment to CDUA No. HA-527 for temporary research facility (Emilie Experiment); an experiment with a wide field photometer in the millimeter band.
- 3/2/81 Plans approved for replacement of Air Force 24 inch telescope with Vienna University Doppler 7-meter telescope. Amendment to CDUA: HA-5/25/77-524.
- 5/8/81  
Withdrawn CDUA No. HA-4/16/81-1284 for limited research and educational use by the University of Hawaii facility involving collection of data and specimens, biological, geological and atmospheric.
- 5/29/81 Board approves CDUA No. HA-4/6/81-1314 for Data Collection and Observation for evaluation of remaining observatory sites on Mauna Kea; data to be correlated with mainland data for site selection purposes. Data collection also found to include soil borings (per 6/16/82 DLNR letter to University of Hawaii).
- 6/2/81 Doppler 7-Meter Plans revised, reviewed and approved.
- 8/26/81 Board approves CDUA No. HA-7/23/81-1357 for boring work at Hale Pohaku, for Mid Level Facilities planning and design.
- 11/16/81 Governor, State of Hawaii, signed Executive Order establishing the Mauna Kea Ice Age Natural Area Reserve.
- 1/22/82 University of Hawaii Board of Regents approves Program Summary and Reserach Development Plan for Mauna Kea Science Reserve and Related Facilities.

Board of Land and  
Natural Resources

HA-1492  
December 17, 1982

- 3/24/82 University of Hawaii presents Program Summary and Research Development Plan for Mauna Kea Science Reserve and Related Facilities to Department of Land and Natural Resources for review.
- 4/23/82 Board approves CDUA No. HA-3/14/82-1430 for subdivision and construction of Hale Pohaku Mid-Level Facilities with Right-of-Entry for construction purposes.
- 6/29/82 University of Hawaii/Department of Land and Natural Resources meet to discuss and review Master Planning for Mauna Kea Science Reserve (First meeting).
- 7/82 Mauna Kea Science Reserve Master Plan, Environmental Impact Statement Notice of Preparation filed.
- 7/22/82 CDUA No. HA-7/22/82-1492 filed for construction of Caltech 10-Meter Telescope for Millimeter and Sub-millimeter Astronomy.
- 8/26/82 Governor accepts Environmental Impact Statement for California Institute of Technology 10-Meter Telescope for Millimeter and Sub-millimeter astronomy.
- 8/27/82 University of Hawaii/Department of Land and Natural Resources meet to discuss status of Mauna Kea Master Plan (Second meeting).
- 9/3/82 CDUA No. HA-1515 filed for construction of UK/NL Millimeter-Wave Telescope and Temporary Use of an Existing Unpaved Parking Area for a concrete batching plant in the Mauna Kea Science Reserve.
- 9/13/82 University of Hawaii/Consultants, Group 70 submit Preliminary Findings of Mauna Kea Science Reserve Master Plan; Schedule of Work Flow and Milestone Chart provided for department review and comment.
- 9/15/82 University of Hawaii, Institute of Astronomy, consultants and Department of Land and Natural Resources meet on Mauna Kea Science Reserve Master Plan. (Third meeting)
- 9/16/82 Consultant, Group 70, submits map of Mauna Kea Science Reserve Master Plan, Alternative Powerline Alignments for department review and comment.
- 9/21/82 Consultant submits Mauna Kea Science Reserve Master Plan, Outline for Management, Monitoring and Enforcement for review and comment.
- 9/82 Road to Lake Waiau closed to prevent unauthorized vehicle use. This was done by the Natural Area Reserves System staff in compliance with the Department of Land and Natural Resources' 1977

Board of Land and  
Natural Resources

HA-1492  
December 17, 1982

Mauna Kea Plan, which states that access to Lake Waiau shall be only by trail. Visitors wishing to see Lake Waiau must now walk from the parking area located at the Olde Batch Plant site.

10/8/82 Board approves amendment to CDUA No. 653A filed for expansion of UKIRT facility by constructing a 1600 square feet building for computer, laboratory and storage space plus paving 3000 square feet of unpaved area, adjacent to facility and planned 1600 foot expansion.

11/7/82 University of Hawaii Research Corporation submits Mauna Kea Science Reserve Complex Development Plan Draft Environmental Impact Statement, Volume 1 and Volume 2, Technical Appendices to Department of Land and Natural Resources and to the Office of Environmental Quality Control.

11/7/82 - Draft EIS under review by Department of Land and  
12/7/82 Natural Resources staff.

2. Agency Review, The Public Hearing Process and the Environmental Impact Statement

The Environmental Impact Statement (EIS) accepted on August 28, 1982, relating to this specific action causes Staff some concern.

- a. Several reviewers, as a part of the public review process of both the Notice of Preparation and the draft document have indicated their concern not with the program per-se, expressed by the University but by the manner in which the University is proceeding to implement their Program.

For example, the University's Environmental Center has suggested that:

"It is our understanding that the University has now adopted the "proposed" Research Development Plan and that under this plan, all future potential telescope sites and any necessary support facilities have been identified. The need now is for an overall EIS to address the impacts of the entire Research Development Plan (RDP). It appears from the Preparation Notice that such an approach is the recommended approach of the plan. What is unclear is the rationale in this EIS Preparation Notice that, because this (CALTECH) "application is preceding the adoption of the RDP, it is proceeding with its own EIS and CDUA." It would seem appropriate to delay assessment of this specific project until the State/University prepares the EIS for the total complex. Furthermore, if the RD plan has been adopted it would appear that consideration of the separate EIS would be contrary to the terms

Board of Land and  
Natural Resources

HA-1492  
December 17, 1982

acknowledged the need for a Master Plan for the use of the summit. This acknowledgement based upon discussion with Staff and the Board, and, is consistent with discussion we have held with other large project land users such as Sea Life Park, Waimea Falls Park, and Hawaii Loa College.

Furthermore, we understand that the University is in the process of preparing such a plan and expects it to be forthcoming for public review in the near future.

As such, and, insofar as this Master Plan is a logical outgrowth of the Mauna Kea Plan, and is presently in process by the University, Staff recommends as follows:

RECOMMENDATION:

- A. Approval of the application subject to the following conditions:
1. That the applicant comply with all applicable statutes, ordinances, rules and regulations of the Federal, State and City and County governments, and applicable parts of Section 13-2-21 of Title 13, Chapter 2, Administrative Rules, as amended;
  2. Other terms and conditions as prescribed by the Chairman;
  3. In that this approval is for use of conservation lands only, the applicant shall obtain appropriate authorization through the Division of Land Management, State Department of Land and Natural Resources for the occupancy of State lands;
  4. In the event any unanticipated sites or remains such as shell, bone or charcoal deposits, human burials, rock or coral alignments, pavings, or walls are encountered during construction, the applicant shall stop work and contact the Historic Preservation Office at 548-7460 or 548-6408;
  5. That the applicant comply with all applicable Public Health Regulations;
  6. A fire contingency plan, acceptable to the Division of Forestry and Wildlife shall be implemented during and after the construction of the structure.
- B. That this approval is not to be considered as precedence for any future action the Board may desire to exercise through their discretionary conditional land use action.
- C. That no further commitment of land use within the Mauna Kea Science Reserve be considered until such time as the University's Mauna Kea Science Reserve Development Plan



Board of Land and  
Natural Resources

HA-1492  
December 17, 1982

is completed and consistency between that plan and the  
Department's Mauna Kea Plan has been achieved.

Respectfully submitted,

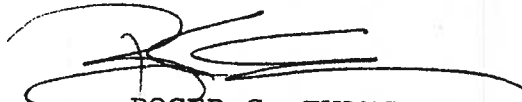

ROGER C. EVANS  
Staff Planner

Attachments

APPROVAL FOR SUBMITTAL:



SUSUMU ONO, Chairman  
Board of Land and Natural Resources

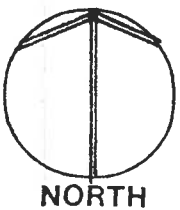
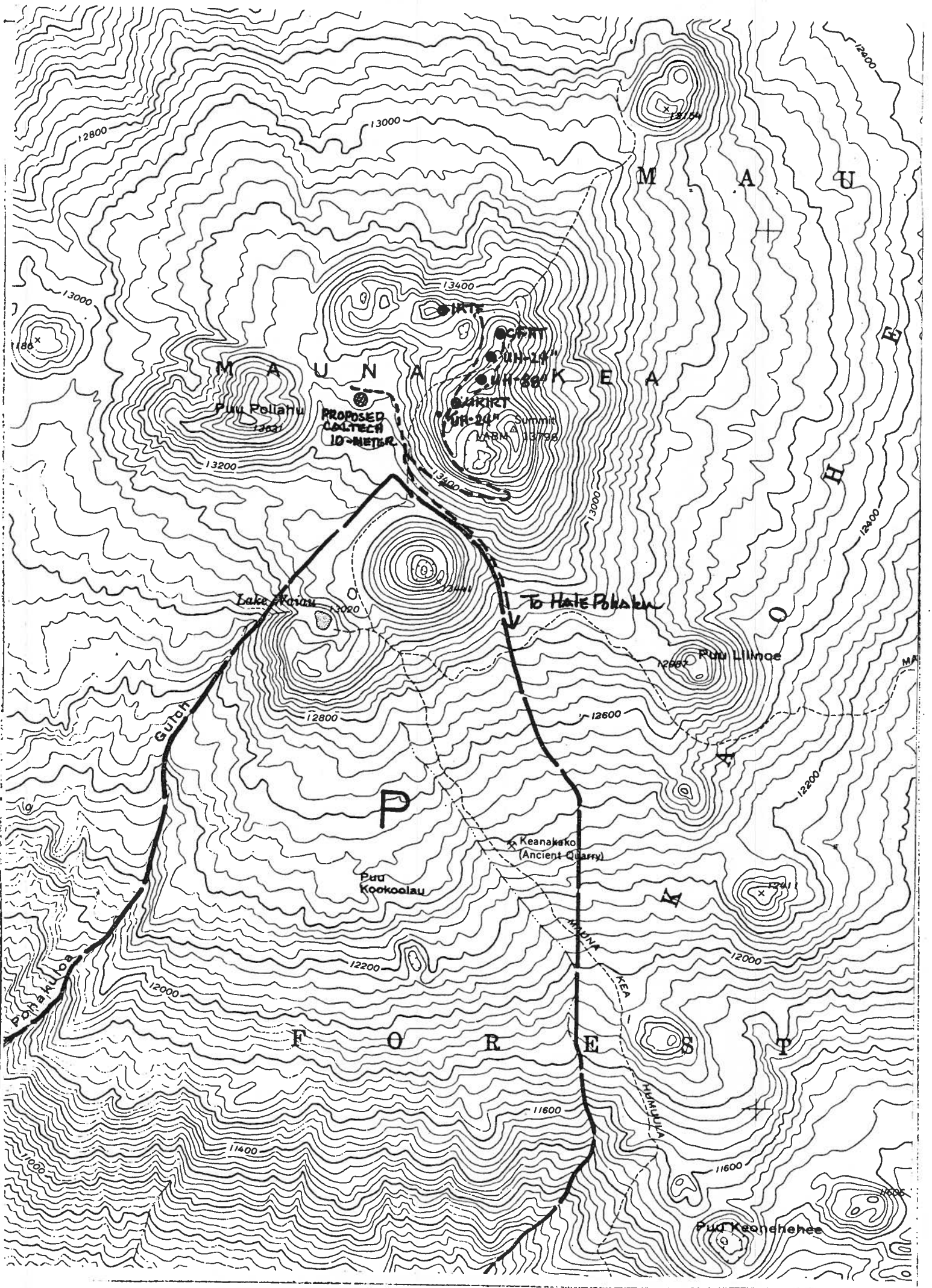



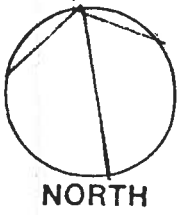
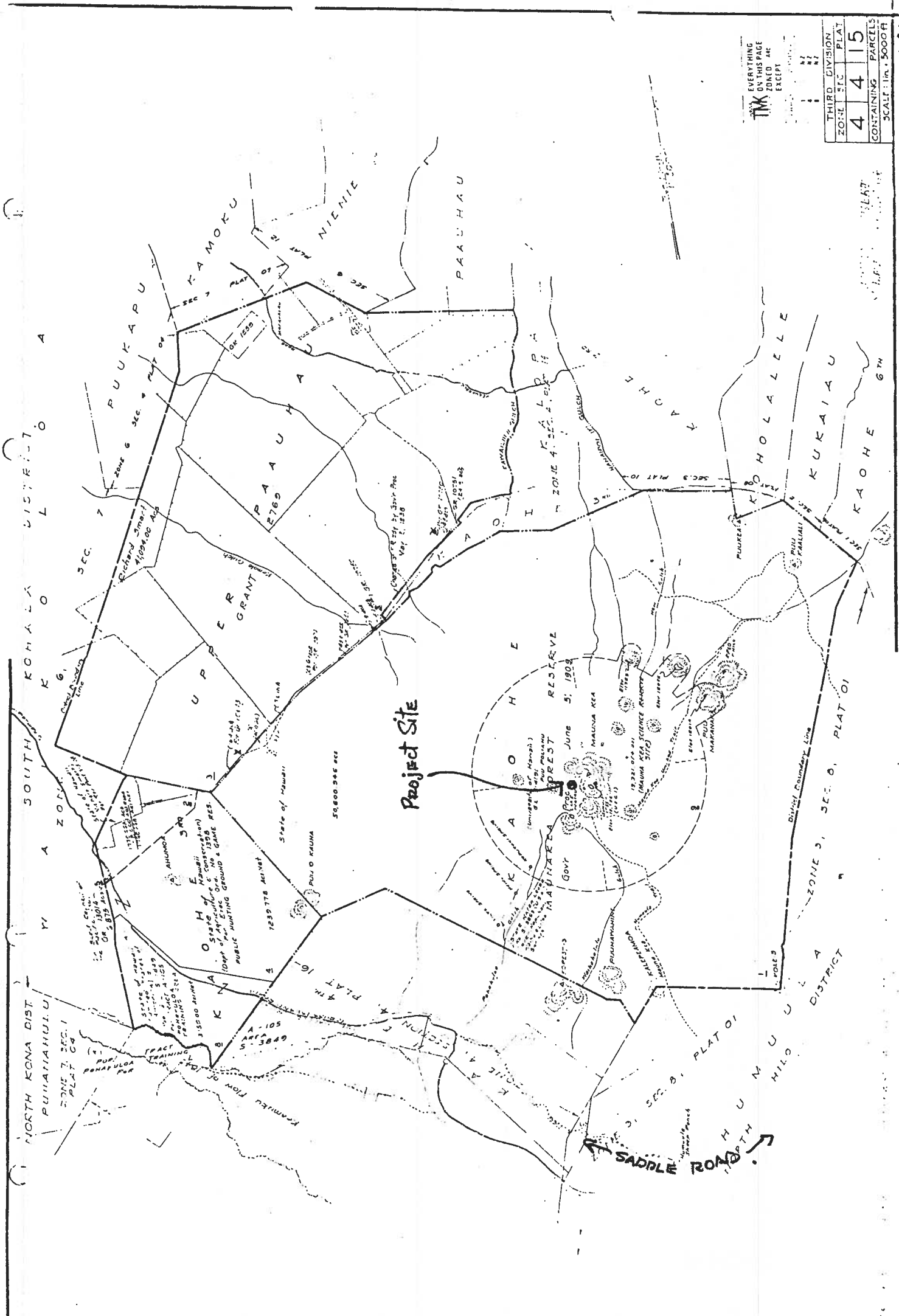

NORTH

CDUA no. HA-1492  
 APPLICANT University of Hawaii  
 AGENT none  
 TMK 4-4-19:9 (poa.)  
 SCALE 1"=2000'

- |         |  |              |
|---------|--|--------------|
| SUBZONE |  | PROTECTIVE   |
|         |  | RESOURCE     |
|         |  | LIMITED      |
|         |  | GENERAL      |
|         |  | PROJECT AREA |



CDUA no. HA-1492  
 APPLICANT University of Hawaii  
 AGENT none  
 TMK 4-4-  
 SCALE ---

SUBZONE  PROTECTIVE  
 RESOURCE  
 LIMITED  
 GENERAL  
 PROJECT AREA

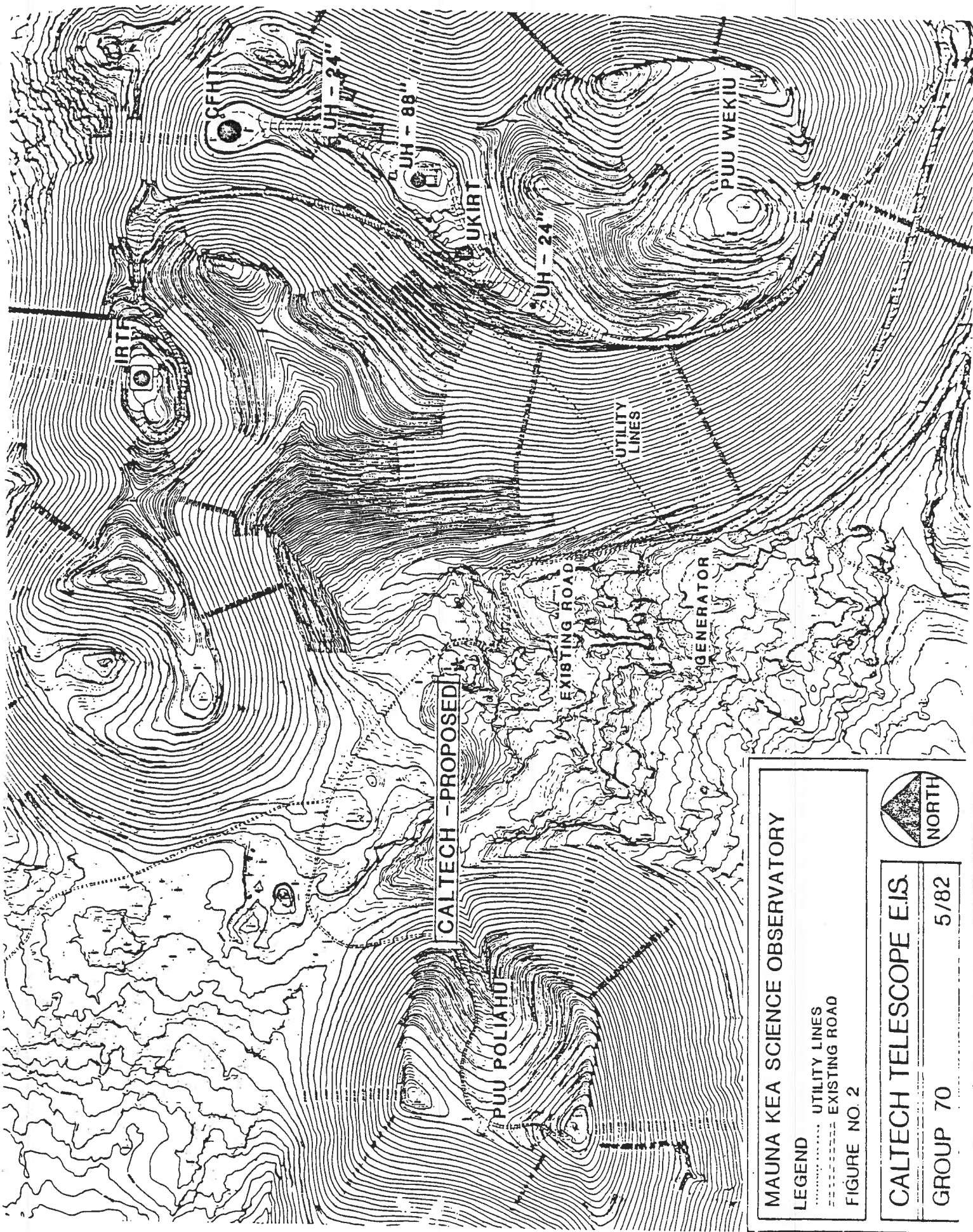

MAUNA KEA SCIENCE OBSERVATORY

LEGEND

- ..... UTILITY LINES
- EXISTING ROAD

FIGURE NO. 2

CALTECH TELESCOPE E.I.S.

GROUP 70      5/82

NORTH

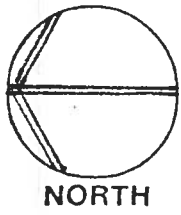

CDUA no. HA-1492

APPLICANT University of Hawaii

AGENT none

TMK 4-4-19: 9 por.

SCALE —

- \* SUBZONE  PROTECTIVE
- RESOURCE
- LIMITED
- GENERAL
- \*  PROJECT AREA

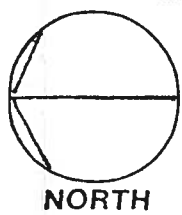

NORTH

CDUA no. HA-1492  
 APPLICANT University of Hawaii  
 AGENT none  
 TMK 4-4-15: 9 (por.)  
 SCALE ---

SUBZONE  PROTECTIVE  
 RESOURCE  
 LIMITED  
 GENERAL  
 PROJECT AREA

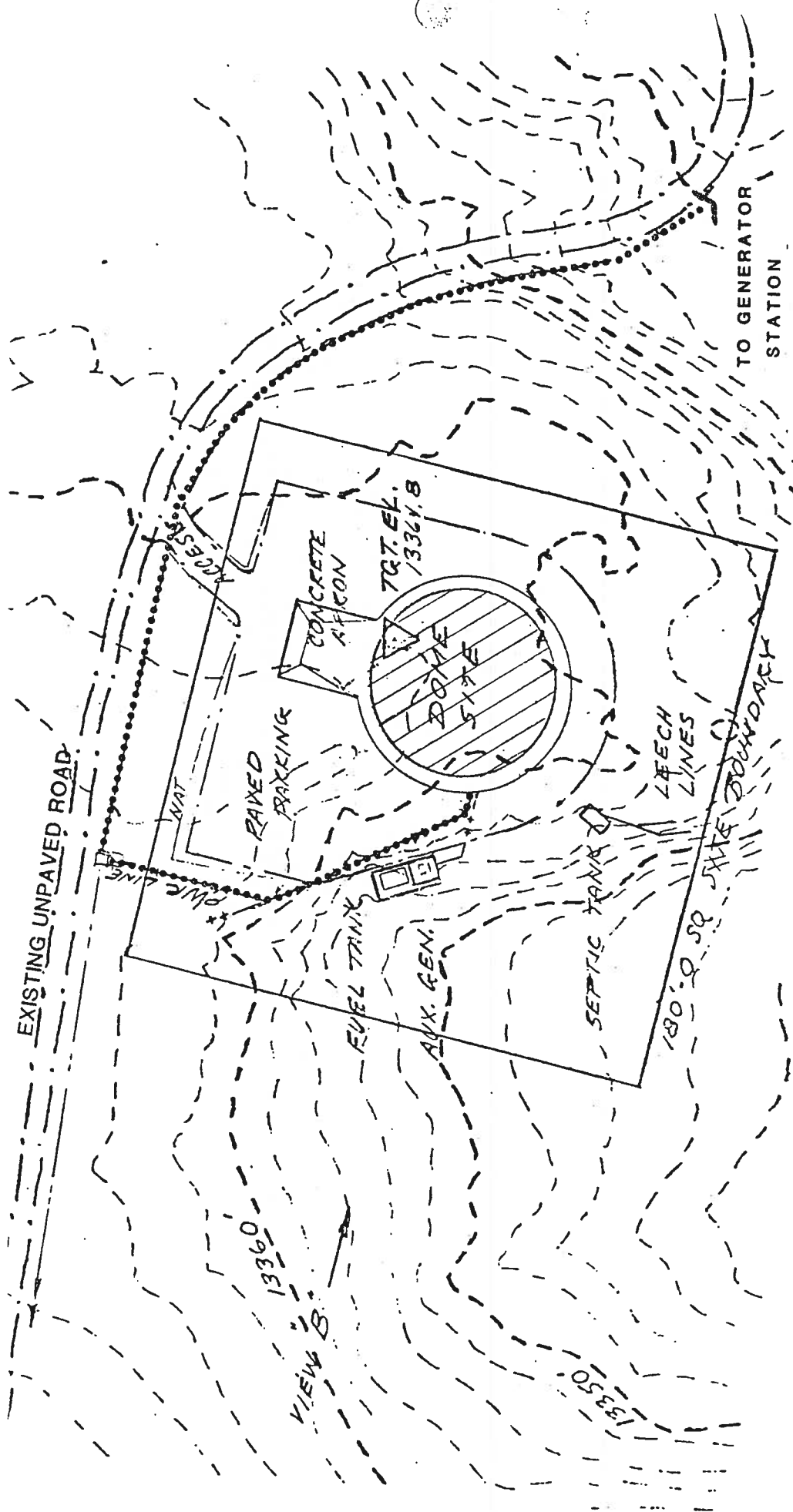

FIGURE 2

LEGEND

..... UTILITY LINES

SCALE

