

United States Department of the Interior
National Park Service

National Register of Historic Places Registration Form

This form is for use in nominating or requesting determinations for individual properties and districts. See instructions in National Register Bulletin, *How to Complete the National Register of Historic Places Registration Form*. If any item does not apply to the property being documented, enter "N/A" for "not applicable." For functions, architectural classification, materials, and areas of significance, enter only categories and subcategories from the instructions.

1. Name of Property

Historic name: Hotel Honokaa Club

Other names/site number: Honokaa Club Hotel, Honokaa Club, TMK: (3) 4-5-006:013

Name of related multiple property listing: Historic and Architectural Resources of Honoka'a Town, Hawai'i Island, Hawai'i

(Enter "N/A" if property is not part of a multiple property listing)

2. Location

Street & number: 45-3480 Māmane Street

City or town: Honoka'a State: HI County: Hawai'i

Not For Publication: ☐ Vicinity: ☐

3. State/Federal Agency Certification

As the designated authority under the National Historic Preservation Act, as amended,

I hereby certify that this ___nomination___ request for determination of eligibility meets the documentation standards for registering properties in the National Register of Historic Places and meets the procedural and professional requirements set forth in 36 CFR Part 60.

In my opinion, the property meets does not meet the National Register Criteria. I recommend that this property be considered significant at the following level(s) of significance:

___ national **X** statewide ___ local

Applicable National Register Criteria:

X A ___ B **X** C ___ D

Signature of certifying official/Title:

Date

State or Federal agency/bureau or Tribal Government

In my opinion, the property ___meets___ does not meet the National Register criteria.

Signature of commenting official:

Date

Title :

**State or Federal agency/bureau
or Tribal Government**

Hotel Honokaa Club

Name of Property

Hawai'i, Hawai'i

County and State

4. National Park Service Certification

I hereby certify that this property is:

- ☐ entered in the National Register
☐ determined eligible for the National Register
☐ determined not eligible for the National Register
☐ removed from the National Register
☐ other (explain:) _____

Signature of the Keeper

Date of Action

5. Classification

Ownership of Property

(Check as many boxes as apply.)

Private:

☒

Public – Local

☐

Public – State

☐

Public – Federal

☐

Category of Property

(Check only **one** box.)

Building(s)

☒

District

☐

Site

☐

Structure

☐

Object

☐

Hotel Honokaa Club
Name of Property

Hawai'i, Hawai'i
County and State

Number of Resources within Property

(Do not include previously listed resources in the count)

Contributing

1

Noncontributing

2

buildings

sites

structures

objects

1

2

Total

Number of contributing resources previously listed in the National Register

6. Function or Use

Historic Functions

(Enter categories from instructions.)

COMMERCE/TRADE/restaurant/bar

DOMESTIC/hotel

Current Functions

(Enter categories from instructions.)

DOMESTIC/hotel

Hotel Honokaa Club
Name of Property

Hawai'i, Hawai'i
County and State

7. Description

Architectural Classification

(Enter categories from instructions.)

OTHER/plantation

Materials: (enter categories from instructions.)

Principal exterior materials of the property: Foundation: Concrete and wood posts and piers/Walls: Wood/Roof: Metal/Other: Concrete steps and walkways

Hotel Honokaa Club

Name of Property

Hawai'i, Hawai'i

County and State

Narrative Description

(Describe the historic and current physical appearance and condition of the property. Describe contributing and noncontributing resources if applicable. Begin with a **summary paragraph** that briefly describes the general characteristics of the property, such as its location, type, style, method of construction, setting, size, and significant features. Indicate whether the property has historic integrity.)

Summary Paragraph

The Hotel Honokaa Club, circa 1927, is a two story-wood frame commercial building located at 45-3480 Māmane Street in the historic plantation town of Honoka‘a on the northeast side of the island of Hawai‘i. The building is situated on the center portion of an approximately 22,904 square-foot lot that fronts Māmane Street, the town’s main commercial corridor, and slopes downward toward Koa Street (formerly Awong Road) at the rear. The building is an example of the type of vernacular architectural design and method of construction that is known locally as “plantation style.” Defining features include a *totan* (corrugated metal) roof, single wall construction with vertical wood planks, and numerous double-hung windows. The building has three floor levels that include the main floor, a rear second story addition, and a basement area. Historically, the hotel/club functioned as a local gathering place that provided guest accommodations for travelers, temporary sales space for the display of commercial samples and wares by traveling salesmen, and a dining room and bar facility that was the site of numerous local social occasions and get-togethers from the 1920s through the 1960s and beyond. While changes to the building occurred in the 1940s, 1960s, and 1990s, it retains much of its historic integrity in terms of location, design, setting, materials, workmanship, feeling, and association. Overall, the property is in good/fair condition and it is a good example of a modest commercial hotel/restaurant built in a rural plantation town in Hawai‘i in the early part of the nineteenth century.

Hotel Honokaa Club

Name of Property

Hawai'i, Hawai'i

County and State

Narrative Description

See Continuation Sheets Section 7

8. Statement of Significance

Applicable National Register Criteria

(Mark "x" in one or more boxes for the criteria qualifying the property for National Register listing.)

☒

A. Property is associated with events that have made a significant contribution to the broad patterns of our history.

☐

B. Property is associated with the lives of persons significant in our past.

☒

C. Property embodies the distinctive characteristics of a type, period, or method of construction or represents the work of a master, or possesses high artistic values, or represents a significant and distinguishable entity whose components lack individual distinction.

☐

Hotel Honokaa Club

Name of Property

Hawai'i, Hawai'i

County and State

D. Property has yielded, or is likely to yield, information important in prehistory or history.

Criteria Considerations

(Mark "x" in all the boxes that apply.)

☐

A. Owned by a religious institution or used for religious purposes

☐

B. Removed from its original location

☐

C. A birthplace or grave

☐

D. A cemetery

☐

E. A reconstructed building, object, or structure

☐

F. A commemorative property

☐

G. Less than 50 years old or achieving significance within the past 50 years

Areas of Significance

(Enter categories from instructions.)

ARCHITECTURE

COMMERCE

COMMUNITY PLANNING AND DEVELOPMENT

ENTERTAINMENT/RECREATION

ETHNIC HERITAGE--Asian, European, Pacific Islander, Portuguese, Filipino

Period of Significance

1921-1964

Hotel Honokaa Club

Name of Property

Hawai'i, Hawai'i

County and State

Period of Significance (Justification)

The year 1921 is the date of acquisition of the property; 1927 represents an approximate date of construction based on tax assessor's field notes, although some tax records indicate a construction date of 1931. Tax assessor field notes also indicate that changes to the building occurred in 1948 and again in the 1960s. The year 1964 reflects the end of the 50-year period of significance set forth in the Secretary of Interior's guidelines.

Significant Dates

1914—Construction on original site

1921—Purchase of second site of hotel

1927—Approximate date of construction on second site

1943-44—Camp Tarawa soldier influx

1948—Back addition to hotel

Significant Person

(Complete only if Criterion B is marked above.)

Cultural Affiliation

N/A

Architect/Builder

Unknown

Statement of Significance Summary Paragraph (Provide a summary paragraph that includes level of significance, applicable criteria, justification for the period of significance, and any applicable criteria considerations.)

The Hotel Honokaa Club is significant for the Hawai'i and National Registers on the State Level under Criteria A (Events/History) and C (Architecture).

The Hotel Honokaa Club is eligible for the National Register of Historic Places on the State level under Criteria A (Events/History). The building's use as both an entertainment/social center and hotel reflect its origins in this small community. It began as a social gathering place for large numbers of unmarried males seeking entertainment after a long day's work. It branched into

Hotel Honokaa Club

Name of Property

Hawai'i, Hawai'i

County and State

hotel accommodations as a resting place and headquarters for sales personnel/drummers who went from place to place across the island peddling their wares. The facilities were Spartan, reflecting the limited means of both the proprietors and clientele. The fact that nearby Waimea had no liquor establishments, and the alcohol needs of World War II soldiers, encouraged the bar operations. Wedding receptions and high school gatherings at the Club have knit the Honoka'a community together for generations.

The Hotel Honokaa Club is eligible for the National Register of Historic Places on the State level under Criteria C (Architecture). The complex has a low-rise lodge character, complete with chimney. The architecture is vernacular plantation era design, featuring a foundation of mostly post and piers, with single wood vertical walls utilizing a horizontal girt board for stability, double hung windows, and a *totan* (corrugated iron) roof. The building features a central open raised *lanai* (veranda) facing the street that is reached by concrete steps. *Makai* of the *lanai* is an atrium that separates the entertainment activities on the Waipi'o side from the hotel space on the Hilo side. The *mauka*-Waipi'o corner area was once a bar and features the requisite long countertop to serve customers. The kitchen is *makai* of the bar with a large central dining room extending to picture windows in the back. On the far *makai*-Waipi'o side is a second bar complex. On the hotel side of the building, on the Hilo side of the atrium, are three levels of overnight accommodations. The main floor contains the original rooms. Below are communal facilities and on the top floor are the premium suites featuring expansive views of the Pacific Ocean below.

Narrative Statement of Significance (Provide at least **one** paragraph for each area of significance.)

See Continuation Sheets Section 8

Hotel Honokaa Club

Name of Property

Hawai'i, Hawai'i

County and State

9. Major Bibliographical References

Bibliography (Cite the books, articles, and other sources used in preparing this form.)

- Beechert, Alice M., Edward D. Beechert. *A Man Must Stand Up: The Autobiography of a Gentle Activist*. Honolulu: University of Hawai'i Press, 1993. (John Reinecke autobiography).
- Beechert, Edward D. "Patterns of Resistance and Social Relations of Production in Hawaii." and "Basic Pay Scales for Honokaa Sugar Co.: 1876-1900," *Sugar Plantation Workers: Resistance and Accommodation*. Brij V. Lal, Doug Munro, and Edward Beechert, editors. Honolulu: University of Hawai'i Press, 1985.
- Boot and Shoe Recorder Magazine*. Volume 57, August 3, 1910. Boston MA.
- Bureau of the Census. United States Department of Commerce. Census Year: 1910; Census Place: Hamakua, Hawaii, Hawaii Territory; Roll: T624_1751; Page: 52B; Enumeration District: 0132; FHL microfilm: 1375764.
- Bureau of the Census. United States Department of Commerce. Census Year: 1920; Census Place: Honokaa, Hawaii, Hawaii Territory; Roll: T625_2033; Page: 18A; Enumeration District.
- Bureau of the Census. United States Department of Commerce. Census Year: 1930; Census Place: Honokaa, Hawaii, Hawaii Territory; Roll: 2631; Page: 3A; Enumeration District: 0005; FHL microfilm: 2342365.
- Bureau of the Census. United States Department of Commerce. *The Fourteenth Decennial Census of the United States, Census of Population, 1920*. Washington, DC: Government Printing Office, 1921.
- Bureau of the Census. United States Department of Commerce. *The Fifteenth Decennial Census of the United States, Census of Population, 1930*. Washington, DC: Government Printing Office. 1931.
- Bureau of the Census. United States Department of Commerce. "Hawaii - Population of Cities, Towns, and Villages: 1950 and 1940." Washington, DC: Government Printing Office. 1951.
- Bureau of the Census. United States Department of Commerce. *The Eighteenth Decennial Census of the United States, Census of the Population: 1960*. Washington, DC: Government Printing Office. 1961.
- Bryan, William S. Photograph of three unidentified Japanese families, 1899.
- Bureau of Conveyances. Territory of Hawai'i. Mortgage Liber 342, pp. 282-285 (June 26, 1911).
- Bureau of Conveyances. Territory of Hawai'i. Exchange Deed Liber 702, pp. 97-99 (January 26, 1914).
- Bureau of Conveyances. Territory of Hawai'i. Deed Liber 558, pp. 126 – 127 (June 25, 1920).
- Bureau of Conveyances. Territory of Hawai'i. Deed Liber 558, p 128 (July 1, 1920).
- Bureau of Conveyances. Territory of Hawai'i. Deed Liber 582, pp. 75-76 (January 22, 1920).
- Bureau of Conveyances. Territory of Hawai'i. Warranty Deed, October 29 1921, Liber 620, p 168.
- Bureau of Conveyances. Territory of Hawai'i. Deed Liber 785, pp. 297 – 298 (June 27, 1925).

Hotel Honokaa Club

Hawai'i, Hawai'i

Name of Property

County and State

Bureau of Conveyances. Territory of Hawai'i. Deed Liber 1519, p. 168 (August 18, 1939).
Bureau of Conveyances. Territory of Hawai'i. Deed Liber 1590, p. 495 (September 30, 1940).
Bureau of Conveyances. Territory of Hawai'i. Deed Liber 1590, p. 496 (September 30, 1940).
Bureau of Conveyances. Territory of Hawai'i. Deed Liber 4613, p. 470 (December 14, 1953).
Bureau of Conveyances. Territory of Hawai'i. Mortgage Liber 4801, p. 214 (July 27, 1964).
Bureau of Conveyances. Territory of Hawai'i. Mortgage Liber 6684, p. 412 (September 16, 1969).
Bureau of Conveyances. Territory of Hawai'i. Mortgage Liber 6982, p. 168 (April 29, 1970).
Bureau of Conveyances. Territory of Hawai'i. Mortgage Liber 8665, p. 99 (October 13, 1972).
Bureau of Conveyances. Territory of Hawai'i. Mortgage Liber 9011, p. 302 (March 19, 1973).
Bureau of Conveyances. Territory of Hawai'i. Mortgage Liber 9473, p. 76 (September 6, 1973).
Bureau of Conveyances. Territory of Hawai'i. Mortgage Liber 11336, p. 511 (April 2, 1976).
Bureau of Conveyances. Territory of Hawai'i. Mortgage Liber 12044, p. 98 (March 2, 1977).
Bureau of Conveyances. Territory of Hawai'i. Warranty Deed Liber 23254, p. 537 (June 2, 1989).
Bureau of Conveyances. Territory of Hawai'i. Agreement of Sale Document No. 94-192575 (November 23, 1994).
Bureau of Conveyances. Territory of Hawai'i. Warranty Deed Document No. 98-090081 (June 23, 1998).
Cordy, Ross. A Regional Synthesis of Hāmākua District Island of Hawai'i. Honolulu: Historic Division, Department of Land and Natural Resources, State of Hawai'i. 1994.
County of Kaua'i, Real Property Division, State of Hawai'i.
<http://www.kauai.gov/Government/Departments/Finance/RealProperty/Maps/tabid/99/Default.aspx>
Daily Pacific Commercial Advertiser. "Island Notes...Honokaa, February 9, 1884: n.p.
Daily Pacific Commercial Advertiser. "Hanging in Honokaa," October 31, 1889: 3: 2. University of Hawai'i at Mānoa Library Newspaper Morgue.
Daily Pacific Commercial Advertiser. "The Shooting of the Japanese Laborer Took Place at Kukuihaele," June 27, 1893: 3: 3. University of Hawai'i at Mānoa Library Newspaper Morgue.
Daily Pacific Commercial Advertiser. "Shooting Affray at Kukuihaele," June 29, 1893: 2: 3. July 24, 1895. University of Hawai'i at Mānoa Library Newspaper Morgue.
De La Cruz, Romel. "The Last Sakadas of Pa'auilo," *Hamakua Times*. November 6, 2013: n.p.
Dove, Charles V.E. "Title Map of the Lands of the Plantation, Survey and Map for the Honokaa Sugar Company," 1904. Hawai'i State Archives. (hgs map 2267).
Frisbee, John L., Carol J. Galbreath, John R. Volz, Roger Holt, and Elizabeth Flack. *Honokaa, Hawaii: Guidelines and Recommendations for a Mamane Street Historic District*. Washington, D.C.: Preservation Press, National Trust for Historic Preservation, 1976.
Google. Camp Tarawa Images.
<https://www.google.com/search?q=Camp+Tarawa&hl=en&tbm=isch&tbo=u&source=univ&sa=X&ei=cRulUs3FOtXooATB0ILICw&ved=0CDEQsAQ&biw=1600&bih=796>
Hāmākua Times. March 25, 2014. p 1, c2.
Harunaga, Toshio. "Honoka'a Town in 1940 Memory Map." Unpublished Ms. Honoka'a: Toshio Harunaga, 2011.

Hotel Honokaa Club

Hawai'i, Hawai'i

Name of Property

County and State

Hawaii Consolidated Railway. "Map of Part of the Island of Hawaii, Showing the Lines of the Hawaii Consolidated Railway, November 1923." Hilo: Hawaii Consolidated Railway, 1923.

Hawaiian Gazette. February 13, 1884: 10: 1.

Hilo Tribune. "The Presence in Hilo of T. Thomas Fortune..." January 2, 1903: 4; 2.

Hilo Tribune. "Plantation Men Are Complimented." December 12, 1911: 6: 2-3.

Hilo Tribune. "Christ vs Buddha: Intermixture of Law and Religion in Habeas Corpus Matter." December 11, 1903: 6.

Hilo Tribune. "Cruiser Fleet Visiting Hilo: Officers and Men See Volcano and Enjoy Sight – Reception Given by Maryland – Hilo Offers Baseball Games and Dances." December 12, 1911: 1: 2.

Hilo Tribune-Herald. "Island of Hawaii Will Soon Be Belted By Government Road..." December 5, 1902: 4: 1.

Hilo Tribune-Herald. "Hamakua District Booster Edition," October 14, 1927: University of Hawai'i Libraries Newspaper Morgue.

Hilo Tribune-Herald. "Training Ship Here on Visit," June 6, 1937: 6: 6.

Hilo Tribune-Herald. "PERSONNELS [sic] of SHIPS HONORED," June 9, 1937: 3: 6.

Hilo Tribune-Herald. "New Library Building Dedicated at Honokaa," June 20, 1937: 1: 3-6.

Hilo Tribune-Herald. "Shogyo Kumiai," July 6, 1937: 1: 7.

Hilo Tribune-Herald. "OAHU ATTACKED," December 7, 1941: 1.

Hilo Tribune-Herald. JAPANESE SURRENDER!" August 11, 1945: 1: 1.

Hilo Tribune-Herald. "Hawaii Becomes Fiftieth State!" August 21, 1959: 1: 5-8.

Hilo Tribune-Herald. "Honokaa, A Town of Old Buildings," October 18, 1973: 1: 1-4.

Hilo Tribune-Herald. "Awong Store, Not Just a Building," October 18, 1973: 1: 6-9.

Hilo Tribune-Herald. "National Trust Offers Honokaa Historic Preservation Proposal," August 1-7, 1976: 17-18.

Hilo Tribune-Herald. "Plans Studied for Mamane Street District," August 8-14, 1976: 3-4.

Hilo Tribune-Herald. "Honoka'a Turned Around...Looking Good." *Hawai'i Tribune Herald*. November 8, 1981.

Honolulu Advertiser. "Victor Morita Dies in Hawaii after Stroke." A7: 1. 1953.

Honolulu Advertiser. "Night life in Honoka'a." C5: 1. August 29, 1978.

Honolulu Star Bulletin. "Open House Slated Saturday at Remodeled Honoka'a Club Hotel." March 25, 1948.

Kemp, Bill. "Late 19th Century Salesmen 'Drummed Up' Business." *The Pentagraph* Bloomington, IL. July 23, 2013. <http://www.highbeam.com/doc/1P2-34949616.html>.

Lee, J. A. *Who's who of the island of Hawaii: a biographical and statistical record of men and women on the island of Hawaii, Territory of Hawaii, U.S.A.*: Volume 1. Edited by L. C. Newton. Published by J. A Lee, Hilo, Hawaii. 1939.

Maly, Kepa and Onaona Maly. "Kukuihaele-Kanahonua Vicinity, Hāmākua." Lāna'i City: Kumu Pono. 2005.

Morita, Naomi. Interview, 2014.

Okimoto, Ken. *Exploring the Hāmākua Coast: A Pictorial Guide to the Plantation Era*. Honolulu: Watermark Publishing, 2002, 2005.

Hotel Honokaa Club

Hawai'i, Hawai'i

Name of Property

County and State

McCain, Eugene and Tom Quinlan. "Honokaa Sugar Company Manager's House (1911)."

Hawai'i Register of Historic Places. Hawi: Historic Properties Services, 1996.

Nakano, Jiro. *Kanda Home: Biography of Shigefusa and Sue Kanda*. Honolulu, HI: University of Hawaii Press. 1996.

National Archives and Records Administration (NARA); Washington, D.C.; Passenger Lists of Vessels Arriving at Honolulu, Hawaii, compiled 02/13/1900 - 12/30/1953.

National Archives and Records Administration (NARA): Washington, D.C.; Microfilm Publication: A3422; Roll: 010; Record Group Title: Records of the Immigration and Naturalization Service, 1787 - 2004; Record Group Number: RG 85.

National Archives and Records Administration (NARA): Washington, D.C.; Registration State: Hawaii; Registration County: Hawaii; Roll: 1452026; Draft Board: 1.

Naughton, Momi. "Timeline on Businesses and Infrastructure[, Honoka'a]." Unpublished MS. Honoka'a: North Hawai'i Education & Research Center (NHERC) Heritage Center, 2013.

Olival, Cindi. "Hāmākua Happenings." *Hawai'i Tribune-Herald*. July 3, 1978.

Olival, Cindi. "Hāmākua Happenings." *Hawai'i Tribune-Herald*. October 2, 1978.

Pacific Commercial Advertiser. February 12, 1884: 2: 4.

Pacific Commercial Advertiser. "Hanging at Honokaa," October 31, 1889: 3: 2.

Pacific Commercial Advertiser. "Not in Honokaa: The Shooting of the Japanese Laborer took Place in Kukuihaele." June 27, 1893: 3: 3.

Pacific Commercial Advertiser. "Fire at Hilo/Shooting Affair at Kukuihaele." June 29, 1893: 2: 3.

Pacific Commercial Advertiser. "Late News from Busy Hilo: Japanese Camp at Wainaku Destroyed by Fire." July 24, 1895: 6: 1.

Pacific Commercial Advertiser. "Farms may be Remedy: Fortune Talks of Conditions of Labor..." January 5, 1903: 3: 2.

Pacific Commercial Advertiser. "Koreans at Olaa Attempt Lynching." November 14, 1904: 8: 4.

Paiva, Eric. "Honoka'a Town in 1950 Memory Map, Sheets 1-5." Unpublished Ms. Honoka'a: Eric Paiva, n.d.

Polk-Husted Directory Company. *Directory of Honolulu and the Territory of Hawaii*.

Honolulu: Polk-Husted Directory Company, 1915, 1920, 1925, 1930, 1934-1935, 1941-42.

Polk, R.L. *Polk's Directory of the Islands of Hawaii, Maui and Kauai[,] Including Lanai and Molokai*. Honolulu: R.L. Polk & Co., Publishers, 1950, 1954-55, 1960.

Pukui, Mary Kawena, Samuel E. Elbert, & Esther T. Mookini. *Place Names of Hawai'i*.

Honolulu: University of Hawai'i Press. 1976.

Real Estate Data, Inc. (REDI), "[Map] 33, 3rd Tax Division" and aerial photograph. REDI, 1971, 1974, 1978.

Sanborn Map Company. Sanborn Map Company. "Honokaa, Hawaii County, Hawaii." Teaneck, New Jersey: Sanborn Map Company, 1914.

Sanborn Map Company. Sanborn Map Company. 1914 map revised 1955. "Honokaa, Hawaii County, Hawaii." Teaneck, New Jersey: Sanborn Map Company, 1955.

Sanborn Map Company. Sanborn Map Company. "Honokaa Sugar Co. Sugar Mill." Teaneck, New Jersey: Sanborn Map Company, 1919.

Hotel Honokaa Club

Hawai'i, Hawai'i

Name of Property

County and State

Siddall, John William (Editor). *Men Of Hawaii: A Biographical Reference Library Complete And Authentic, Of The Men Of Note And Substantial Achievement In The Hawaiian Islands*. Honolulu, HI: Honolulu Star-Bulletin, Limited. 1921.

Solamillo, Stanley. "Plantation Vernacular Architecture." Honolulu, HI: unpublished paper. 2014.

Takai, Atsuchi. "Honokaa." Japanese census thematic map. In *Hawai Ichiran* (A Glance at Hawaii). Honolulu: Motoshige Shinjudo, 1914.

Telephony. "Pioneer Telephone Man of Hawaii," 1912. Photograph of a newly constructed telephone exchange building at Honoka'a Village, January 20, 1912: 87. Vol. 62, No. 387. May 25, 1912: 650.

Thrum, Thomas G. *Thrum's Hawaiian Almanac & Annual*. Honolulu: Press Publishing Company, 1878, 1879, 1880, 1881, 1882, 1883, 1885, 1886-88, 1889, 1890, 1891, 1895, 1896, 1897, 1899, 1900, 1904, 1906, 1909, 1911, 1919, 1920-23, 1935, 1941.

Tomich, P. Quentin *Perspectives on Hāmākua History*. Honoka'a, Hawai'i: P. Quentin Tomich, 2008.

Unidentified Newspaper. "Honokaa Hotel Gets Facelift, Cocktail Lounge." June 6, 1960.

United States Geological Survey. "Hawaii, Island and County of Hawaii, Honokaa Quadrangle." Washington, D.C.: U.S. Department of the Interior, 1995.

Watland, Jory. Interview, 2014.

West Hawai'i Today. January 15, 1989. p2, c1.

Williamson, A.J. "Plan of the North Western Part of Hamakua, Hawaii Showing Honokaa and Pacific Sugar Mill Plantations and the Hamakua Upper and Lower Ditches." Government Survey Registered Map No. 2640. Hilo: A.J. Williamson, C.E., May, 1909.

Previous documentation on file (NPS):

☐ preliminary determination of individual listing (36 CFR 67) has been requested

☐ previously listed in the National Register

☒ previously determined eligible by the National Register (1976 National Trust Study)

Hotel Honokaa Club

Name of Property

Hawai'i, Hawai'i

County and State

☐ designated a National Historic Landmark
☐ recorded by Historic American Buildings Survey #
☐ recorded by Historic American Engineering Record #
☐ recorded by Historic American Landscape Survey #

Primary location of additional data:

☒ State Historic Preservation Office
☐ Other State agency
☐ Federal agency
☒ Local government
☒ University
☐ Other
Name of repository:

Historic Resources Survey Number (if assigned):

—

Hotel Honokaa Club

Name of Property

Hawai'i, Hawai'i

County and State

1. Geographical Data

Acreage of Property 0.5258

Use either the UTM system or latitude/longitude coordinates

Latitude/Longitude Coordinates (decimal degrees)

Datum if other than WGS84: _____

(enter coordinates to 6 decimal places)

- | | |
|--------------|------------|
| 1. Latitude: | Longitude: |
| 2. Latitude: | Longitude: |
| 3. Latitude: | Longitude: |
| 4. Latitude: | Longitude: |

Or

UTM References

Datum (indicated on USGS map):

☐ NAD 1927 or ☒ NAD 1983

- | | | |
|------------|--------------------|----------------------|
| 1. Zone: 5 | Easting: 242152.76 | Northing: 2222033.24 |
| 2. Zone: 5 | Easting: 242167.87 | Northing: 2222118.30 |
| 3. Zone: 5 | Easting: 242200.33 | Northing: 2222099.80 |
| 4. Zone: 5 | Easting: 242181.51 | Northing: 2222022.98 |

Hotel Honokaa Club

Name of Property

Hawai'i, Hawai'i

County and State

Verbal Boundary Description (Describe the boundaries of the property.)

Parallelogram containing parcels 5,6,17 and 18 of the Spencer Tract, now listed on State and County records as Tax Map Key (3) 4-5-006:013.

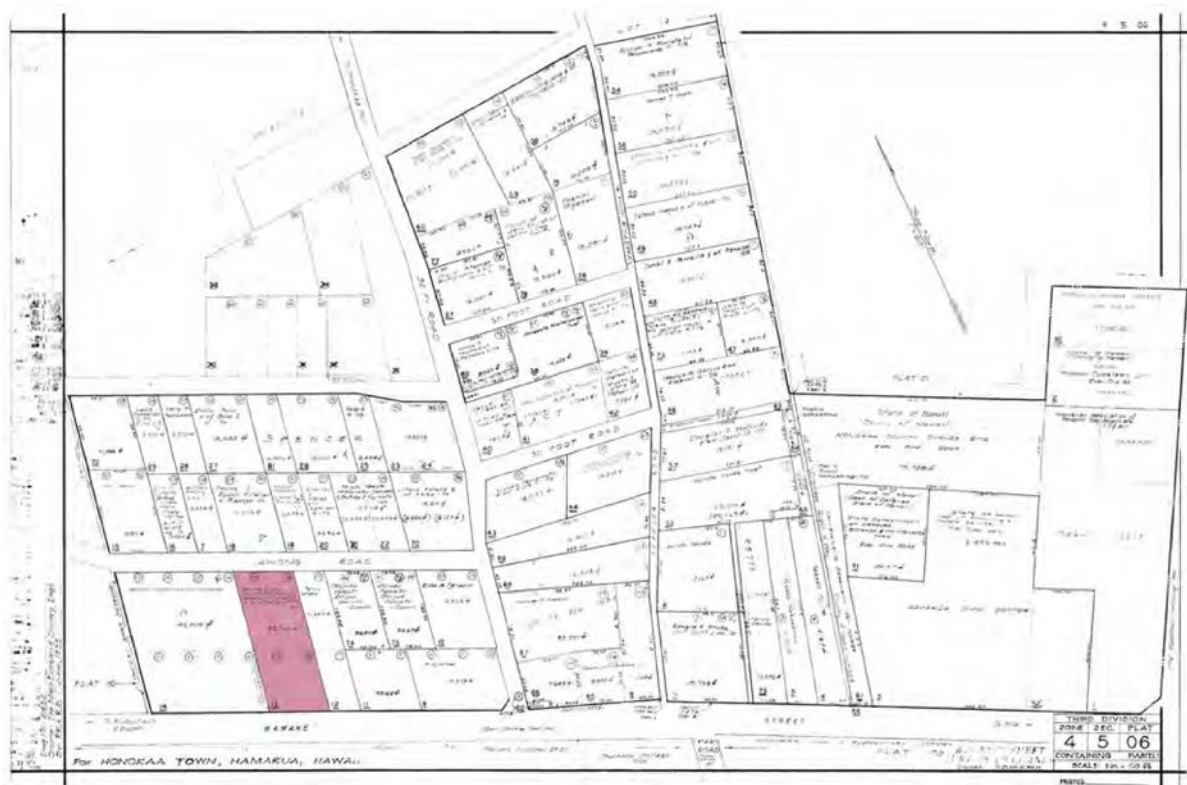

Hotel Honokaa Club

Name of Property

Hawai'i, Hawai'i

County and State

Boundary Justification (Explain why the boundaries were selected.)

Historic boundaries of these parcels.

2. Form Prepared By

name/title: Ross W. Stephenson, PhD

organization: _____

street & number: 38 South Judd Street, Unit 24B

city or town: Honolulu state: HI zip code: 96817

e-mail rwaylands808@aol.com

telephone: (808) 679-9060

date: September 19, 2014

Additional Documentation

Submit the following items with the completed form:

- **Maps:** A **USGS map** or equivalent (7.5 or 15 minute series) indicating the property's location.
- **Sketch map** for historic districts and properties having large acreage or numerous resources. Key all photographs to this map.
- **Additional items:** (Check with the SHPO, TPO, or FPO for any additional items.)

Photographs

Submit clear and descriptive photographs. The size of each image must be 1600x1200 pixels (minimum), 3000x2000 preferred, at 300 ppi (pixels per inch) or larger. Key all photographs to the sketch map. Each photograph must be numbered and that number must correspond to the photograph number on the photo log. For simplicity, the name of the photographer, photo date, etc. may be listed once on the photograph log and doesn't need to be labeled on every photograph.

Hotel Honokaa Club

Name of Property

Photo Key-Sketch

Hawai'i, Hawai'i

County and State

**HOTEL HONOKAA CLUB
MAIN FLOOR**

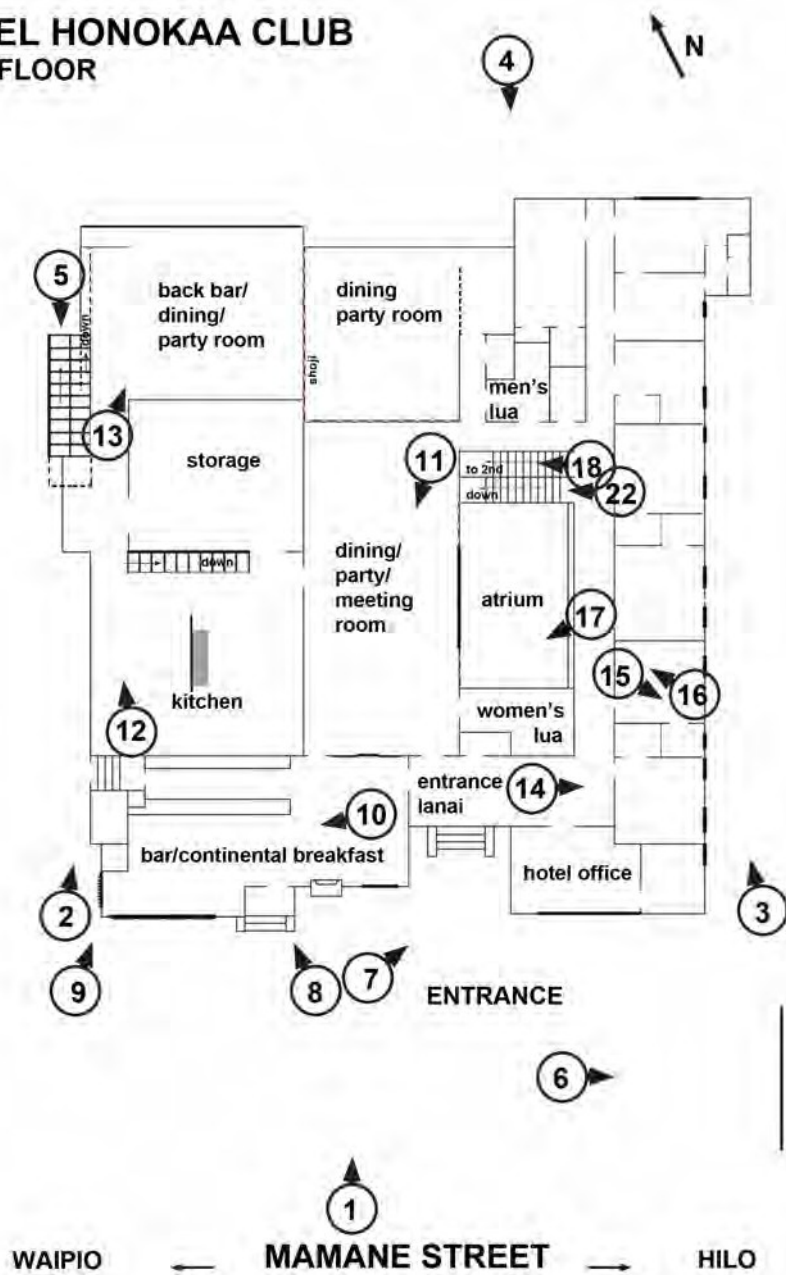

Hotel Honokaa Club
Name of Property

Hawai'i, Hawai'i
County and State

**HOTEL HONOKAA CLUB
TOP FLOOR**

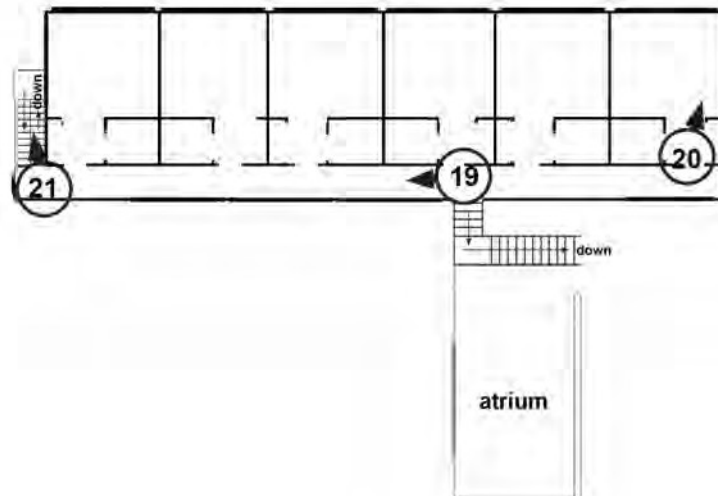

WAIPIO



MAMANE STREET



HILO

Hotel Honokaa Club

Name of Property

Hawai'i, Hawai'i

County and State

HOTEL HONOKAA CLUB BASEMENT

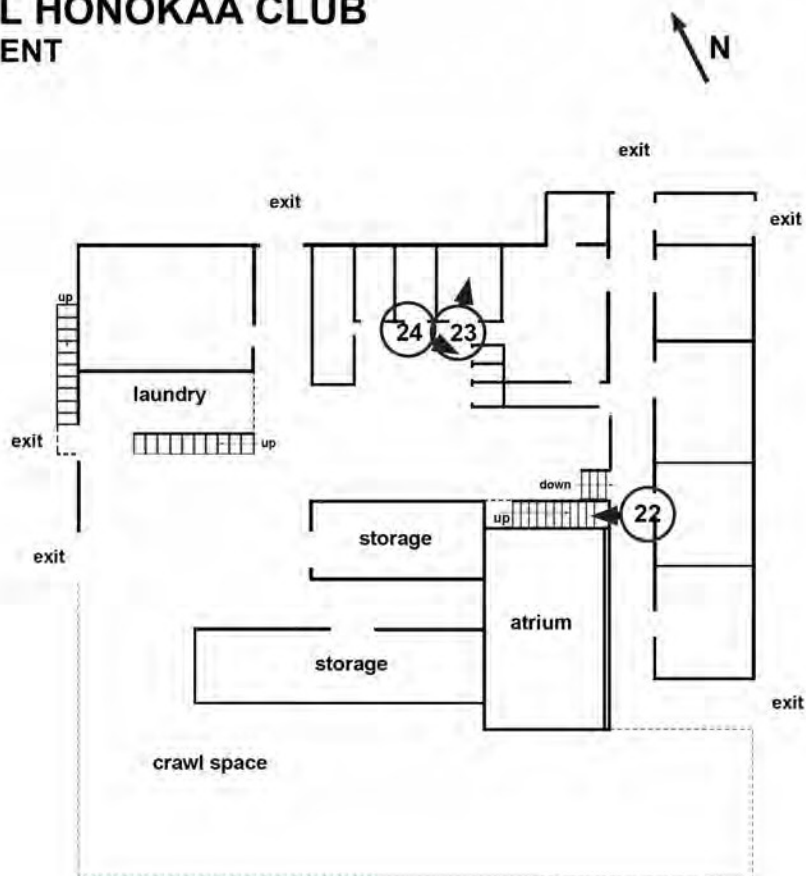

WAIPIO



MAMANE STREET



HILO

Hotel Honokaa Club

Name of Property

Hawai'i, Hawai'i

County and State

PHOTO LOG

Name of Property: Hotel Honokaa Club
City or Vicinity: Honoka'a
County: Hawai'i State: HI
Photographers: Annalise Kehler and Laura Ruby
Date Photographed: 2011 and 2014
Location of Original Digital Files: Ross W. Stephenson, PhD
38 South Judd Street, Unit 24B
Honolulu, HI 96817
Job # Historic and Architectural Resources of
Honoka'a

Photo #1 (HI_Hawai'iCounty_Hotel Honokaa Club_0001)
Mamane Street façade (mauka side) camera facing northeast

Photographer: Annalise Kehler, 2011

1 of 24

Photo #2 (HI_Hawai'iCounty_Hotel Honokaa Club_0002)
Waipi'o side façade, camera facing northeast

Photographer: Annalise Kehler, 2011

2 of 24

Photo #3 (HI_Hawai'iCounty_Hotel Honokaa Club_0003)
Hilo side façade, camera facing north-northeast

Photographer: Annalise Kehler, 2011

3 of 24

Photo #4 (HI_Hawai'iCounty_Hotel Honokaa Club_0004)
Rear façade (makai side), camera facing southwest

Photographer: Annalise Kehler, 2011

4 of 24

Hotel Honokaa Club

Name of Property

Hawai'i, Hawai'i

County and State

Photo #5 (HI_Hawai'iCounty_Hotel Honokaa Club_0005)
Waipi'o side, camera facing southwest

Photographer: Annalise Kehler, 2011

5 of 24

Photo #6 (HI_Hawai'iCounty_Hotel Honokaa Club_0006)
The Cane Cutters mural, part of the hotel but located on Harris Tanaka building, camera facing east-southeast

Photographer: Laura Ruby, 2014

6 of 24

Photo #7 (HI_Hawai'iCounty_Hotel Honokaa Club_0007)
External close-up of hotel entrance, camera facing east

Photographer: Annalise Kehler, 2011

7 of 24

Photo #8 (HI_Hawai'iCounty_Hotel Honokaa Club_0008)
External close-up of former hotel entrance, camera facing north

Photographer: Laura Ruby, 2014

8 of 24

Photo #9 (HI_Hawai'iCounty_Hotel Honokaa Club_0009)
External detail: corner eaves, camera facing northeast

Photographer: Laura Ruby, 2014

9 of 24

Hotel Honokaa Club

Name of Property

Hawai'i, Hawai'i

County and State

Photo #10 (HI_Hawai'iCounty_Hotel Honokaa Club_0010)

Interior: main floor bar, service area, camera facing southwest

Photographer: Laura Ruby, 2014

10 of 24

Photo #11 (HI_Hawai'iCounty_Hotel Honokaa Club_0011)

Interior: main floor dining and party room, camera facing south southwest

Photographer: Laura Ruby, 2014

11 of 24

Photo #12 (HI_Hawai'iCounty_Hotel Honokaa Club_0012)

Interior: main floor kitchen, camera facing north-northeast

Photographer: Laura Ruby, 2014

12 of 24

Photo #13 (HI_Hawai'iCounty_Hotel Honokaa Club_0013)

Interior: main floor Waipi'o-makai dining party room, camera facing northeast

Photographer: Laura Ruby, 2014

13 of 24

Photo #14 (HI_Hawai'iCounty_Hotel Honokaa Club_0014)

Interior: main floor entry hallway with office and hotel room # 2, camera facing south-southeast

Photographer: Annalise Kehler, 2011

14 of 25

Hotel Honokaa Club

Name of Property

Hawai'i, Hawai'i

County and State

Photo #15 (HI_Hawai'iCounty_Hotel Honokaa Club_0015)

Interior: typical main floor room, camera facing southeast

Photographer: Annalise Kehler, 2011

15 of 24

Photo #16 (HI_Hawai'iCounty_Hotel Honokaa Club_0016)

Interior: typical main floor room, camera facing northwest

Photographer: Laura Ruby, 2014

16 of 24

Photo #17 (HI_Hawai'iCounty_Hotel Honokaa Club_0017)

Interior: courtyard viewing main floor and basement windows, camera facing west

Photographer: Annalise Kehler, 2011

17 of 24

Photo #18 (HI_Hawai'iCounty_Hotel Honokaa Club_0018)

Interior: stairway from main floor to top floor, camera facing west-northwest

Photographer: Annalise Kehler, 2011

18 of 24

Photo #19 (HI_Hawai'iCounty_Hotel Honokaa Club_0019)

Interior: top floor hallway, camera facing west-northwest

Photographer: Annalise Kehler, 2011

19 of 24

Hotel Honokaa Club

Name of Property

Hawai'i, Hawai'i

County and State

Photo #20 (HI_Hawai'iCounty_Hotel Honokaa Club_0020)

Interior: typical top floor room with ocean view, camera facing northeast

Photographer: Laura Ruby, 2014

20 of 24

Photo #21 (HI_Hawai'iCounty_Hotel Honokaa Club_0021)

Interior: top floor exit stairway descending to main floor, camera facing north-north-northeast

Photographer: Laura Ruby, 2014

21 of 24

Photo #22 (HI_Hawai'iCounty_Hotel Honokaa Club_0022)

Interior: stairway from main floor to basement, camera facing west-northwest

Photographer: Annalise Kehler, 2011

22 of 24

Photo #23 (HI_Hawai'iCounty_Hotel Honokaa Club_0023)

Interior: typical basement room, camera facing northeast

Photographer: Laura Ruby, 2014

23 of 24

Photo #24 (HI_Hawai'iCounty_Hotel Honokaa Club_0024)

Interior: basement shared toilet and shower, camera facing south-southeast

Photographer: Laura Ruby, 2014

24 of 24

Hotel Honokaa Club

Name of Property

Hawai'i, Hawai'i

County and State

PHOTO LOG

Name of Property: Hotel Honoka'a Club
City or Vicinity: Honoka'a
County: Hawai'i State: HI
Photographers: Annalise Kehler and Laura Ruby
Date Photographed: 2011 and 2014
Location of Original Digital Files: Ross W. Stephenson, PhD
38 South Judd Street, Unit 24B
Honolulu, HI 96817
Job # Historic and Architectural Resources of
Honoka'a

Photo #1 (HI_Hawai'iCounty_Hotel Honokaa Club_0001)
Mamane Street façade (mauka side) camera facing northeast

1 of 24



Hotel Honokaa Club

Name of Property

Hawai'i, Hawai'i

County and State

Photo #2 (HI_Hawai'iCounty_Hotel Honokaa Club_0002)
Waipi'o side façade, camera facing northeast

2 of 24



Hotel Honokaa Club

Name of Property

Hawai'i, Hawai'i

County and State

Photo #3 (HI_Hawai'iCounty_Hotel Honokaa Club_0003)
Hilo side façade, camera facing north-northeast

3 of 24



Hotel Honokaa Club

Name of Property

Hawai'i, Hawai'i

County and State

Photo #4 (HI_Hawai'iCounty_Hotel Honokaa Club_0004)
Rear façade (makai side), camera facing southwest

4 of 24



Hotel Honokaa Club

Name of Property

Hawai'i, Hawai'i

County and State

Photo #5 (HI_Hawai'iCounty_Hotel Honokaa Club_0005)
Waipi'o side, camera facing southwest

5 of 24



Hotel Honokaa Club

Name of Property

Hawai'i, Hawai'i

County and State

Photo #6 (HI_Hawai'iCounty_Hotel Honokaa Club_0006)

The Cane Cutters mural, part of the hotel but located on Harris Tanaka building, camera facing east-southeast

6 of 24



Hotel Honokaa Club

Name of Property

Hawai'i, Hawai'i

County and State

Photo #7 (HI_Hawai'iCounty_Hotel Honokaa Club_0007)
External close-up of hotel entrance, camera facing east

7 of 24



Hotel Honokaa Club

Name of Property

Hawai'i, Hawai'i

County and State

Photo #8 (HI_Hawai'iCounty_Hotel Honokaa Club_0008)
External close-up of former hotel entrance, camera facing north

8 of 24



Hotel Honokaa Club

Name of Property

Hawai'i, Hawai'i

County and State

Photo #9 (HI_Hawai'iCounty_Hotel Honokaa Club_0009)

External detail: corner eaves, camera facing northeast

9 of 24



Hotel Honokaa Club

Name of Property

Hawai'i, Hawai'i

County and State

Photo #10 (HI_Hawai'iCounty_Hotel Honokaa Club_0010)
Interior: main floor bar, service area, camera facing southwest

10 of 24



Hotel Honokaa Club

Name of Property

Hawai'i, Hawai'i

County and State

Photo #11 (HI_Hawai'iCounty_Hotel Honokaa Club_0011)

Interior: main floor dining and party room, camera facing south southwest

11 of 24



Hotel Honokaa Club

Name of Property

Hawai'i, Hawai'i

County and State

Photo #12 (HI_Hawai'iCounty_Hotel Honokaa Club_0012)

Interior: fain floor kitchen, camera facing north-northeast

12 of 24



Hotel Honokaa Club

Name of Property

Hawai'i, Hawai'i

County and State

Photo #13 (HI_Hawai'iCounty_Hotel Honokaa Club_0013)

Internal: main floor Waipi'o-makai dining party room, camera facing northeast

13 of 24



Hotel Honokaa Club

Name of Property

Hawai'i, Hawai'i

County and State

Photo #14 (HI_Hawai'iCounty_Hotel Honokaa Club_0014)

Interior: main floor entry hallway with office and hotel room # 2, camera facing south-southeast

14 of 24



Hotel Honokaa Club

Name of Property

Hawai'i, Hawai'i

County and State

Photo #15 (HI_Hawai'iCounty_Hotel Honokaa Club_0015)

Interior: typical main floor room, camera facing southeast

15 of 24



Hotel Honokaa Club

Name of Property

Hawai'i, Hawai'i

County and State

Photo #16 (HI_Hawai'iCounty_Hotel Honokaa Club_0016)

Interior: typical main floor room, camera facing northwest

16 of 24



Hotel Honokaa Club

Name of Property

Hawai'i, Hawai'i

County and State

Photo #17 (HI_Hawai'iCounty_Hotel Honokaa Club_0017)

Interior: courtyard viewing main floor and basement windows, camera facing west

17 of 24



Hotel Honokaa Club

Name of Property

Hawai'i, Hawai'i

County and State

Photo #18 (HI_Hawai'iCounty_Hotel Honokaa Club_0018)

Interior: stairway from main floor to top floor, camera facing west-northwest

18 of 24



Hotel Honokaa Club

Name of Property

Hawai'i, Hawai'i

County and State

Photo #19 (HI_Hawai'iCounty_Hotel Honokaa Club_0019)

Interior: top floor hallway, camera facing west-northwest

19 of 24



Hotel Honokaa Club

Name of Property

Hawai'i, Hawai'i

County and State

Photo #20 (HI_Hawai'iCounty_Hotel Honokaa Club_0020)

Interior: typical top floor room with ocean view, camera facing northeast

20 of 24



Hotel Honokaa Club

Name of Property

Hawai'i, Hawai'i

County and State

Photo #21 (HI_Hawai'iCounty_Hotel Honokaa Club_0021)

Interior: top floor exit stairway descending to main floor, camera facing north-north-northeast

21 of 24



Hotel Honokaa Club

Name of Property

Hawai'i, Hawai'i

County and State

Photo #22 (HI_Hawai'iCounty_Hotel Honokaa Club_0022)

Interior: stairway from main floor to basement, camera facing west-northwest

22 of 24



Hotel Honokaa Club

Name of Property

Hawai'i, Hawai'i

County and State

Photo #23 (HI_Hawai'iCounty_Hotel Honokaa Club_0023)

Interior: typical basement room, camera facing northeast

23 of 24



Hotel Honokaa Club

Name of Property

Hawai'i, Hawai'i

County and State

Photo #24 (HI_Hawai'iCounty_Hotel Honokaa Club_0024)

Interior: basement shared toilet and shower, camera facing south-southeast

24 of 24



Paperwork Reduction Act Statement: This information is being collected for applications to the National Register of Historic Places to nominate properties for listing or determine eligibility for listing, to list properties, and to amend existing listings. Response to this request is required to obtain a benefit in accordance with the National Historic Preservation Act, as amended (16 U.S.C. 460 et seq.).

Estimated Burden Statement: Public reporting burden for this form is estimated to average 100 hours per response including time for reviewing instructions, gathering and maintaining data, and completing and reviewing the form. Direct comments regarding this burden estimate or any aspect of this form to the Office of Planning and Performance Management, U.S. Dept. of the Interior, 1849 C. Street, NW, Washington, DC.

United States Department of the Interior
National Park Service

National Register of Historic Places
Continuation Sheet

Section number 7 Page 1

Hotel Honokaa Club	Put Here
Name of Property	
Hawai'i, Hawai'i	
County and State	
Historic and Architectural Resources of Honoka'a Town	
Name of multiple listing (if applicable)	

Narrative Description

The Hotel Honokaa Club building has an irregular floor plan. The main floor or street level has a covered open-air *lanai* (veranda) at the entrance. Interior spaces include an elongated corridor or hallway with access to a row of hotel guest rooms. The remaining areas on this floor include space for a bar/continental breakfast room, kitchen, storage room, dining/party/meeting room, dining/party room and a back bar/dining/party room. At the rear of the building is an approximately 2,099 square-foot second story addition (1948) that contains six hotel guest rooms with picturesque views overlooking the Hāmākua coastline. The partially finished basement level contains the ground level atrium; laundry, utility and storage areas; and several hotel and hostel guest rooms with shared bathroom facilities.

The corrugated metal roof that covers the building's main floor has a low pitch side-facing gable-on-hip roofline with wood vented cross gables and broad overhanging open eaves. A corrugated metal roof also covers the rear second story addition and has a side-facing gable roofline. The underside of the *totan* roofing material is exposed. Most walls of the building are of single wall construction. Portions of the building sit on a wood post and concrete pier, or concrete block, foundation.

Exterior:

Principal Façade

The principal façade fronts Māmane Street and has two entrances. On the Waipi'o side there is a set of concrete steps and an unused entrance landing with wood posts, a half-height wood hand rail, and a single wood framed entry door that can provide access to the bar, restaurant, and lounge areas. The main entrance located near the center of this façade is comprised of a relatively wide covered open-air *lanai*. Concrete steps rise to front edge of the *lanai* floor. Perpendicular low-lying capped concrete walls flank these entrance steps. Wood porch railings at the *lanai* level are situated on the each side of the steps. The *lanai* leads to doorways on the Waipi'o-side that open onto the bar/continental breakfast room and the dining/party/meeting room. The *lanai* also leads to a Hilo-side hallway and a relatively long corridor that provides access to a series of hotel guest rooms. There is a brick chimney (clad in metal on the exterior of the building) built into the wall between the two entrances.

The Waipi'o-side (left) of this street frontage façade has a double ribbon or band of five window openings screened by vertical wood louvers and separated by mullions. On the left most side of the unused Waipi'o-side entrance door is a fixed wood frame window (1/1 light). Between the Waipi'o entrance door and the central *lanai* is the aforementioned chimney and one set of horizontal slider windows (2/3 lights) with an exterior mounted wood frame screen (4/3 lights). To the right of the main *lanai* entrance, perpendicular to the street, there is a single double-hung sash window with a 2/2 light pattern. The Hilo-side (right-hand side) of this façade, parallel to the street, has paired horizontal slider windows (1/3 lights). All windows on this façade have wood frames and a simple, narrow sill along the lower edge.

United States Department of the Interior
National Park Service

National Register of Historic Places
Continuation Sheet

Section number 7 Page 2

Hotel Honokaa Club Put Here

Name of Property

Hawai'i, Hawai'i

County and State

Historic and Architectural Resources of
Honoka'a Town

Name of multiple listing (if applicable)

Facade on the Hilo Side:

Along the Hilo side of the building is a concrete walkway and relatively narrow landscaped garden area that follows the sloping topography of the property. Near the center portion of this facade is a set of wood and concrete steps that lead to the basement area. Windows on this facade have exterior mounted wood frame screens and include double-hung sash windows and glass jalousies.



EARL TANAKA COLLECTION

Looking *mauka* from Koa (Awong) Street, before 1948 addition. Earl

United States Department of the Interior
National Park Service

National Register of Historic Places
Continuation Sheet

Section number 7 Page 3

Hotel Honokaa Club	Put Here
Name of Property	
Hawai'i, Hawai'i	
County and State	
Historic and Architectural Resources of Honoka'a Town	
Name of multiple listing (if applicable)	

Makai (Oceanside) Façade:

The *makai* façade has two ground level entrances that lead to lower level guest rooms, and utility and storage areas in the basement. Windows on the basement level have exterior mounted wood frame screens and include horizontal slider windows, glass jalousies, and double-hung sash windows with 2/2 lights. Windows on the main level of this facade include a combination of double-hung sash windows, large fixed pane picture windows, and horizontal slider windows. Windows on the second story addition are double-hung sash windows (2/2) situated on each side of a large fixed pane picture window. On the Waipi'o side of this façade is an enclosed wood staircase that has a large slider window on the second story level.

Façade on the Waipi'o Side:

On the Waipi'o side of the building, a metal handrail abuts a concrete walkway and series of concrete steps that follow the slope of the property's topography. Near the rear of the building is an enclosed wood staircase that provides access to the other floor levels. A wood door near the front of the building provides access to the kitchen and bar/continental breakfast areas on the main floor. Windows along this facade include a fixed picture window with a single double-hung sash window on the second story level; three double-hung sash windows over the back bar/dining/ party room; a double ribbon of vertically mounted glass jalousies along the kitchen area, and a wood louvered window opening located near the front of the building. A half-height swinging wood gate separates the side yard area from the front of the property.

Interior Features

First Floor – Bar/Continental Breakfast, Kitchen, Storage, Back Bar/Dining/Party, Dining/Party, Dining/Party/Meeting, Atrium, Hotel Office and Hotel Rooms

Located on the *mauka*-Waipi'o side of the building is space currently used as a bar/continental breakfast room featuring a large meeting table and brick fireplace. Interestingly, at the far side of this same room is an area that was once a bar, with a sculpted koa wood bar top, tabletops, decorative posts, and a carved seating booth which give the room an ambiance reminiscent of "tiki" bars of the 1960s. Windows along the frontage side and Waipi'o side of this room have wood frames and vertical wood louvers. There is also a small restroom in this area with tongue-and-groove wood walls.

Makai of the bar/continental breakfast room is an approximately 52' x 18' kitchen area that includes space for food preparation, food service, and a pantry. The centralized location of the kitchen allows support of food and drink activities in the bar/continental breakfast room, and the back bar/dining/party room, the dining/party/meeting room, and the dining/party room. The location and design of the kitchen facilitates ventilation by a ribbon of louvered windows along the Waipi'o side of the building. The kitchen was remodeled in the 1990s and features standard equipment including stoves, sinks, brown floor tile and countertops of that era. The older hallways leading from the kitchen to the public dining room areas retain the wood walls and ceilings with bead molding.

United States Department of the Interior
National Park Service

National Register of Historic Places
Continuation Sheet

Section number 7 Page 4

Hotel Honokaa Club	Put Here
Name of Property	
Hawai'i, Hawai'i	
County and State	
Historic and Architectural Resources of Honoka'a Town	
Name of multiple listing (if applicable)	

The location of the Kitchen provides immediate access to the back bar, the *makai* dining room, and the main dining/party/meeting room. The back bar, approximately 24 x 44 foot in size, features a combination of picture windows and double-hung sash windows with 2/2 lights, vertical board wood walls, a texturized ceiling, and carpet covered floors. The bar is finished with bamboo paneling.

An enclosed end-wall wood staircase with landings is located on the *makai*-Waipi'o side of the building. It provides access to the second floor guest rooms, the kitchen and back bar/dining party room on the main floor, and the exterior concrete walkway on the basement or ground level of the building. Another set of wooden stairs is located in the kitchen providing access to the laundry and utility service areas in the basement.

The dining/party/meeting room is located *makai* of the bar/continental breakfast room with access via a set of full-height, wood-frame sliding glass doors that have a 1/4 light pattern. The dining/party/meeting room features high ceilings, painted vertical board wood walls, vinyl flooring, and sliding doors that can be used to separate it from the dining/party and back bar/dining/party rooms. The dining/party room and back bar/dining/party rooms can, in turn, be segregated from each other by a series of sliding *shoji* (room divider consisting of wood and translucent *washi* [Japanese rice paper]) doors.

The main dining/party/meeting room has a white ceiling with a rectangular lattice pattern demarcated by wood trim that is influenced by Asian designs and complements the style and design of the *shoji* screen doors. Large horizontal slider windows with a 3/1 light pattern are located on the Hilo-side of the dining room overlooking the inner atrium area. From the dining/party/meeting room there is access to a men's restroom located on the *makai* side of the atrium. A women's restroom that can also be accessed from the dining room is located on the *mauka* side of the atrium.

Hotel Area

The hotel guest rooms form a front-facing L-shaped floor plan along the rear and Hilo-side portions of the building. The hotel office is situated parallel to Māmane Street, immediately to the Hilo-side, (the right) of the main entrance *lanai*. A hallway with a 90-degree angle opens onto a long corridor with direct access to the first floor guestrooms. Along the corridor there is also a wood staircase that leads to the hallway and guestrooms on the second floor level, and a wood and concrete staircase that provides access to the ground level atrium and basement level of the building. The corridor features wood walls, floors, trim, molding, and baseboards.

Atrium

Located between the guestroom corridor and the dining room area is an open-air basement-to-second floor atrium. A staircase on the *makai* side provides access to the landscaped atrium surface below and also storage, utility, and guestroom areas in the basement level of the building. Windows located on the dining room side of the atrium are large horizontal slider windows with a 3/1 light pattern. A set of paired wood framed awning type windows also open from the women's restroom.

First Floor—Guestrooms (Hilo Side)

Most of the guestrooms on the first floor have wood doors with a single fixed window pane set above

United States Department of the Interior
National Park Service

National Register of Historic Places
Continuation Sheet

Section number 7 Page 5

Hotel Honokaa Club	Put Here
Name of Property	
Hawai'i, Hawai'i	
County and State	
Historic and Architectural Resources of Honoka'a Town	
Name of multiple listing (if applicable)	

three inset wood panels, 10' high ceilings, and screened transom windows that provide cross ventilation from the hallway corridor. The guest rooms have wood walls and ceilings, interior girts, and double hung windows with wood frames. Each guestroom has a washbasin in the corner and its own private shower/toilet.

Second floor—Guestrooms (*Makai Side*)

Wood staircases situated at each end of an enclosed hallway provide access to the hotel guest rooms located on the second floor addition. The hallway has wood walls, baseboards, molding, and trim around guestroom doors and transom windows. Double-hung windows with two vertical end rectangular lights in each pane are located on both the *mauka* side and the Waipi'o end of the hallway. There are also two storage closets located on the *mauka* side of the hall. The closets have wood doors with a single recessed wood panel.

Six hotel guest rooms are located on the *makai* side of the hallway. Immediately inside each guest room is a bathroom to one side and a closet on the other. The bathrooms have large shower stalls with octagon tile floors and hand painted metal walls. In each room, large picture windows, flanked by double-hung sash windows, frame the Hāmākua coastline.

Basement Level

The basement area reflects the sloped topography of the site. The *mauka*-most portion is simply a crawl space, demarcated on the Waipi'o and Hilo side by a vertical wood skirt. A large interior open space provides access to the laundry; kitchen stairs; two storage rooms; the youth hostel rooms; and shared shower and toilet facilities. The finished areas of the basement area have either painted concrete block or wood walls. The finished floor areas are concrete or wood.

Outbuildings

There is an approximately 1,284 square-foot wood frame dwelling, circa 1941, located at the rear of the hotel/club building. Primary access to the house is from Koa Street although there is also a covered walkway that leads to the rear of the hotel-club building. The house has experienced some loss of historic integrity due to various alterations over the years and is considered a non-contributing building for the purposes of this nomination.

There is also an open-air, parking shed with dirt floor, circa 1942, that fronts Koa Street. A corrugated metal roof supported by wood posts and concrete piers partially covers the area above the parking stalls. A concrete pathway with steps goes between the parking structure and the rear of the hotel. This shed has not been maintained and is in fair to poor condition. It appears to have lost some of its historic integrity and is considered a non-contributing building for the purposes of this nomination.

Alterations and Major Changes to the Hotel Honokaa Club Building:

Changes to the exterior of the building include the addition of a low-lying cross gable roofline located at each end of the building. The date of this change is uncertain but it does not appear to significantly impact the overall visual impression of the building as a plantation style building. The second story

United States Department of the Interior
National Park Service

National Register of Historic Places
Continuation Sheet

Section number 7 Page 6

Hotel Honokaa Club	Put Here
Name of Property	
Hawai'i, Hawai'i	
County and State	
Historic and Architectural Resources of Honoka'a Town	
Name of multiple listing (if applicable)	

addition with a side-facing gable roofline was added to the rear of the building in 1948 to accommodate the addition of six hotel guest rooms with views overlooking the Hāmākua coastline. A rooftop solar photovoltaic system was added in 2006.

Interior changes made centered on attempts to retain restaurant and bar business over time.

The bar/continental breakfast room on the front Waipi'o side of the building was once the manager's quarters and later was remodeled into bar space. The wood louvered windows along this portion of the building appear to be an alteration and the date of that change is uncertain. Although the use of this portion of the building has changed over time, the wood louvers do not appear to significantly impact the design, scale, or overall visual impression of the principal facade.

In the early 1960s, the kitchen and bar/continental breakfast and back bar/dining/party room facilities were remodeled and large *shoji* screen wall partitions were added to accommodate smaller events.

The *mauka* façade, facing Māmane Street, once featured more extensive landscaping. (The parking area was expanded at an unknown date.) Portions of the original landscaping still exist on both sides along the property lines and adjacent to the Hotel structure.

United States Department of the Interior
National Park Service

National Register of Historic Places
Continuation Sheet

Section number 8 Page 1

Hotel Honokaa Club	Put Here
Name of Property	
Hawai'i, Hawai'i	
County and State	
Historic and Architectural Resources of Honoka'a Town	
Name of multiple listing (if applicable)	

Narrative Statement of Significance

The Honoka'a Hotel Club is eligible for the National Register of Historic Places on the State Level under Criteria A (Events/History) and C (Architecture).

Criteria A

Background

In 1878, three commercial sugar plantations existed in Hāmākua in the vicinity of a village that later became Honoka'a. These plantations included Honokaa Sugar Company [HSCo], Paauihau Sugar Company and Pacific Sugar Mill. By 1913 these three plantations had over 12,000 acres in sugar cane. A labor shortage beginning in the mid-19th century prompted the importation of foreign workers. The Chinese were the first to arrive, with large numbers of Japanese following beginning in 1888, then followed by Portuguese, Korean, Puerto Rican and Filipinos over the next 40 years. The workers, many married with families, were housed in 13 camps along the Hāmākua coast near Honoka'a. As these workers completed their contracts with the plantations, many moved to Honoka'a and began businesses, providing the impetus for the development of the town. As Honoka'a grew and evolved, a variety of businesses, offering wide-ranging choices of goods and services, eventually made Honoka'a the largest town on the Hāmākua coast and the second largest on the island.

In 1910 the population of Honoka'a stood at 9,037, a population sufficient to support a hotel along with lodging for travelers, salesmen and laborers in transit to the plantations to support the growing village. In 1912, A. B. Lindsay, owner of a store and the Postmaster, and Joseph Prichard, the manager of the Hamakua and South Kohala Telephone Co., provided financing and materials to build a hotel. The Hotel Honokaa Club first appears in the business directory of 1912 and is called Hotel Honokaa (Husted 1910, v. p). The original site of the hotel complex lay along the Government Road (Māmane Street) on the Hilo-side of the present Bank of Hawaii. The 1904 Dove map shows the A.B. Lindsay store situated directly across the street from the original hotel. Notably, in 1889, Sejikiro Goto, brother of the murdered Katsu Goto, clerked in Lindsay's store after returning to Hawai'i to attend his brother's funeral (Nakano 1996).

The Hotel Honokaa Club is an example of small, often ethnic, hotels that proliferated around the islands. For example, Greek immigrant George Lycurgus was instrumental in developing both San Souci (at Waikiki Beach) and the Volcano House (in 2014's Volcanoes National Park). Both of those hotels catered mostly to affluent European and American tourists. More numerous were hotels run by Japanese immigrants and their descendants. The Manago Hotel in Captain Cook, Kona, is probably the best known. Built by Kinzo Manago in the early 1900s with a loan of \$100, it is Kona's oldest operating hotel (West Hawaii Today, May 1, 2014). The Shirakawa Hotel in Waiōhinu (Ka'ū District), built in the 1920s, still rents out thirteen rooms (Hawaii Tribune Herald, December 13, 1999). While no records show when the Nanbu Hotel building in Kohala was first erected, documents show it existed as early as 1898. In 1917, Ayataro Nanbu bought the hotel and expanded it with his wife Toei (Star Bulletin, May 20, 2001). In the 1930s, after Mrs. Nanbu died of cancer in Japan, Mr. Nanbu focused on the hotel and

United States Department of the Interior
National Park Service

National Register of Historic Places
Continuation Sheet

Section number 8 Page 2

Hotel Honokaa Club	Put Here
Name of Property	
Hawai'i, Hawai'i	
County and State	
Historic and Architectural Resources of Honoka'a Town	
Name of multiple listing (if applicable)	

made it flourish. "During the war years, Ayataro Nanbu would always give the first round on the house for all soldiers and officers." The Nanbu hotel closed in 1960.

Property History

The present Hotel Honokaa Club property was part of a 225-acre Land Commission Award (Royal Patent 2465 to Olepau Kaiaokioki and Papaiki).

In 1911 the land was mortgaged by owners Samuel Mahuka and Alice K. Spencer (Bureau of Conveyances, Liber 342, p.p. 282-285). (Samuel Mahuka Spencer was from a Waimea family; over his lifetime he was employed by the Waterhouse Trust Company, in the Territorial Land Office as a clerk, as a bookkeeper for Parker Ranch, engaged in land development, was admitted to the bar and eventually became Chairman of the County Board of Supervisors for the County of Hawaii [Lee, 1939]). The Spencers likely hoped to benefit from the growth of the Hilo Railway, which by 1913 had built its line from Hilo as far as Pa'auilo—just seven miles from Honoka'a. As Honoka'a was the stated terminus for the Hilo Railway, commercial and residential construction in Honoka'a was directed toward Hilo to the east. Unfortunately, the rough terrain of the Hāmākua Coast made the cost of railroad construction so high that the Hilo Railway underwent bankruptcy proceedings in 1914 and the renamed Hawaii Consolidated Railway never was extended to Honoka'a. (The Hawaii Consolidated Railway closed down in 1946 after the *tsunami* (seismic sea wave, Japanese) of that year destroyed many key bridges [interview, Ross Stephenson, September 13, 2014].)

By best estimate, the Hotel Honokaa Club was at the present location by about 1927. Interestingly, an examination of the original Hotel complex drawn in the 1914 Sanborn Fire Insurance Company map for Honoka'a looks very similar to the present layout of the ca. 1927 portion of 2014's building. In both, the bar/restaurant is on the Waipi'o side of the building, there are central front steps, and the hotel room wing is located on the Hilo side. It is very possible that portions of the hotel, especially the main guest room floor, were relocated to the new site. (Moving wooden buildings, constructed on post and piers, was common.) What is certain is that at least part of the original hotel complex remained at the old site until 1927, when the old hotel temporarily housed the Bank of Hawaii branch until a new bank building was opened that year (*Hilo Tribune-Herald*, August 19, 1927).

The Hotel Honokaa Club occupies contiguous original lots 5, 6, 17 and 18 of the Spencer Tract subdivision. These occupy part of the block between Māmane Street (originally Government Road) and Koa Street (originally Awong Road).

In 1920, First Bank of Hilo, which held the Spencer's mortgage, sold Lots 5 and 7 to Gladys Dias for \$850 (Bureau of Conveyances, Liber 558, p. 127). Lot 5 measures 4998 sq. ft. and Lot 17 measures 6454 sq. ft. for a total of 11,452 sq. ft. That same year, Dias sold the two lots to Nam Soon Myung for \$2500 (Bureau of Conveyances, Liber 558, p. 1128). Again in the same year, Myung sold the lots to Kumakichi Morita, for \$2000, taking a \$500 loss (Bureau of Conveyance, Liber 582, pp. 75-76). In 1921, Alice Spencer sold Lots 6 and 18 to the Hilo Trading Company. Though incorporated in Hawai'i, the principal, C. G. Vicars, resided in Alameda, California (Bureau of Conveyances Liber 620, p. 168). In 1925, the Hilo Trading Company sold lots 6 and 18 to Kumakichi Morita for \$900 (Bureau

United States Department of the Interior
National Park Service

National Register of Historic Places
Continuation Sheet

Section number 8 Page 3

Hotel Honokaa Club	Put Here
Name of Property	
Hawai'i, Hawai'i	
County and State	
Historic and Architectural Resources of Honoka'a Town	
Name of multiple listing (if applicable)	

of Conveyances Liber 785, pp. 297 – 298). Lot 6 measures 4998 sq. ft. and Lot 18 measures 6454 sq. ft. for a total of 11452 sq. ft. The total square footage for the 4-lot parcel is now 22,904 sq. ft.

In 1933 these four lots were consolidated and given a single designation (3) 4-5- 006:013, using a new territory-wide Tax Map Key (TMK) system. (This was part of a government reorganization, initiated in 1917, precipitated by the development of country governments. County governments were to be dependent upon property tax revenues, which required an inventory system and method to differentiate parcels for tax rate determination and collection. In 1932, the territorial government and counties went one step further, creating a numeration system that provided locus information from the county level down to the individual parcel level. Data collected by the government using this system includes location, boundaries, square footage, improvements and ownership.)

<http://www.kauai.gov/Government/Departments/Finance/RealProperty/Maps/tabid/99/Default.aspx>

In 1939, Kane made a warranty deed for the property to son Victor (Yoshikazu) for a consideration of \$1 but she was still listed as a beneficiary of Kumakichi's estate (Bureau of Conveyances, Liber 1519, p. 168). A year later, on September 27, 1940 Victor and his wife Tomiko sold the property to F. R. H. Fraser, an officer of the Honoka'a branch of the Bank of Hawaii, and his wife for \$1 (Bureau of Conveyances Liber 1590, p. 495). Fraser immediately sold them back the parcel on the same day for the consideration of "1\$ and love" as tenants in entirety (Bureau of Conveyances, Liber 1590, p. 496). This was likely also done to clear the title for Kane who is still a non-citizen in 1940. In 1953, Victor Y. died after a stroke at the age of 44 (Honolulu Advertiser, A7:1, 1953); his wife Tomiko then deeded the property for the consideration of "\$1 and love" to sons Henry, Alexander and Robert as part of the distribution of Victor's estate (Bureau of Conveyances, Liber 4613, p. 470). In 1964, Henry, Alexander and Robert formed the Hotel Honokaa Club, Inc. and took out their first mortgage for \$17,000 (Bureau of Conveyances, Liber 4801, p. 214). Over the next 22 years, between 1964 and 1989, 7 mortgages, with ever increasing amounts, were taken out on the property (Bureau of Conveyances, various documents). In 1989, Hotel Honokaa Club became the property of Waimea Group Limited Partnership by warranty deed and the consideration of \$10. Principals of the Group were Joris Watland, Bradley Carvalho and Alvin Wakayama (Bureau of Conveyances, Liber 23254, pp. 537 – 551), though the actual sale did not take place until 1994 for \$485,000. The partnership was subsequently dissolved (Bureau of Conveyances, Document # 94-192575). In 1998, a warranty deed to back up the bill of sale was issued to Joris Watland, who is the current owner.

United States Department of the Interior
National Park Service

National Register of Historic Places
Continuation Sheet

Section number 8 Page 4

Hotel Honokaa Club	Put Here
Name of Property	
Hawai'i, Hawai'i	
County and State	
Historic and Architectural Resources of Honoka'a Town	
Name of multiple listing (if applicable)	

Historical Events

1910s, 1920s Through Early 1930s

Originally the hotel did not have a name. The 1914 Sanborn Fire Insurance map labels it as Honokaa Club (Hotel). By 1915 it was listed in the local business directory as the "Honokaa Hotel Club." An advertisement in the telephone directory for the hotel read: "A First Class Hotel and Boarding House, Rates \$3.00 per Day and Up" (Polk-Husted 1915). By 1920 the rates had increased to \$4.00 per day (Ibid). The addition of the term "Club" in the name reflects the use of the establishment from its inception as a nexus for entertainment and drinking, while the hotel portion served as a residence and lodging for immigrants, unmarried sugar cane workers, *paniolo* (cowboys), and travelling salesmen (Star Bulletin; March 25, 1948).

"At that time the majority of the key plantation men were unmarried, and it was their custom to convene on Saturday nights for merry and lengthy sessions at the hotel. They came on horseback and departed the same way although not always with the same horse.

"As years went by the hotel became the 'club' with all its members and eventually in a duly called 'committee' hearing the name was voted to become the Honokaa Club Hotel." (Star Bulletin; March 25, 1948).

The salesmen who stayed at the hotel, were known as "drummers" commercial travelers, runners, or "gripmen" ("grip" here referring to the trunk or suitcase carried by salesmen). These sales personnel travelled through Hāmākua and Kohala approximately every two weeks in a circuit from Honolulu to Kawaihae to Laupāhoehoe to Hilo "drumming up" business (Star Bulletin, March 25, 1948). One was a mainland representative, W.H. Smith of the Manufacturer's Shoe Company of Honolulu (Boot and Shoe Recorder v. 57, August 3rd 1910). These salesmen would set up their wares and samples for the various merchants within the town, and use the hotel as a headquarters.

Preparations for War

In 1940 it is significant to note that, even under the darkening threat of war, a strong sense of community existed in Honoka'a. First generation Japanese, who had worked a lifetime to acquire land, were painfully aware that elsewhere in the United States (California) they were not allowed to do so. They were also aware that, during the First World War, German citizens had had their land confiscated by the American government. Resident Japanese aliens were very afraid that they and their property would suffer the same fate. As a result, titles to goods and property were frequently transferred to citizen offspring or trusted friends from other ethnic groups. Symbolic property transfers were also undertaken, to demonstrate support for close friends by close friends. The owners of the Hotel Honokaa Club, Victor and Tomiko Morita, apparently felt it necessary to engage in similar activities. They sold the property to F. R. H. Fraser for the "consideration of \$1.00" (Bureau of Conveyances Liber 1590, p. 475) and reacquired it on the same day for "consideration of \$1.00" (Bureau of Conveyances Liber 1590, p. 476). The return of title to Victor Morita would be a public declaration of willingness by Fraser to again temporarily resume title in an emergency (Ross Stephenson, personal communication, 2014).

United States Department of the Interior
National Park Service

National Register of Historic Places
Continuation Sheet

Section number 8 Page 5

Hotel Honokaa Club	Put Here
Name of Property	
Hawai'i, Hawai'i	
County and State	
Historic and Architectural Resources of Honoka'a Town	
Name of multiple listing (if applicable)	

World War II

From 1943-1945, over 50,000 U.S. Marines lived and trained in and around Waimea and the Kohala Coast. Camp Tarawa was originally built by the 2nd Marine Division, but upon the 2nd's deployment to Saipan, the 5th Marine Division moved in to train for the Battle of Iwo Jima. Alfred Carter (manager of Parker Ranch) had historically limited the availability of liquor in Waimea, so when the Marines came in 1943-45 they found that town dry. The soldiers simply followed the Waimea ranch cowboys down the hill to "wet" Honoka'a. Hotel Honokaa Club was one of many "watering holes" in Honoka'a that benefited from the servicemen's patronage. Camp Tarawa closed in November 1945.

Post War

After the war, the hotel expanded its activities focusing on locals, hosting weddings, high school group gatherings and luau events; Victor Morita planned additions and remodeling. In 1948, Victor constructed a second story containing six bedroom suites. Five new bedrooms were added downstairs and new bathrooms were added to the original Hilo side bedrooms. The dining room was expanded and decorated, and the bar was remodeled with the addition of a cocktail lounge. An updated kitchen with electricity was also added and the entire edifice painted (Star Bulletin, March 25 1948).



OLIVAL/BOTELHO FAMILY COLLECTION

Unidentified group at a gathering at the hotel, n.d.

United States Department of the Interior
National Park Service

**National Register of Historic Places
Continuation Sheet**

Section number 8 Page 6

Hotel Honokaa Club **Put Here**

Name of Property

Hawai'i, Hawai'i

County and State

Historic and Architectural Resources
of Honoka'a Town

Name of multiple listing (if applicable)



MORITA FAMILY COLLECTION

Victor Morita preparing food in the kitchen with unidentified waitress, ca. 1940s.

United States Department of the Interior
National Park Service

National Register of Historic Places
Continuation Sheet

Section number 8 Page 7

Hotel Honokaa Club	Put Here
Name of Property	
Hawai'i, Hawai'i	
County and State	
Historic and Architectural Resources of Honoka'a Town	
Name of multiple listing (if applicable)	



MORITA FAMILY COLLECTION

Victor Morita with hotel guest. Note: the truck belongs to Harris Laundry Hilo-side of the hotel, ca. late 1940s.

United States Department of the Interior
National Park Service

National Register of Historic Places
Continuation Sheet

Section number 8 Page 8

Hotel Honokaa Club	Put Here
Name of Property	
Hawai'i, Hawai'i	
County and State	
Historic and Architectural Resources of Honoka'a Town	
Name of multiple listing (if applicable)	

The hotel would put up construction workers from time to time. Apparently, the hotel did not always have enough rooms so Henry Morita put up workers in the "down house," the family residence downhill from the hotel. One night, an *obake* (Japanese ghost) event happened: a sleeping construction worker was startled awake by someone grabbing his toes. The worker woke up Henry and told of his experience. Henry said his late grandmother, Kane, used to wake up the boys by grabbing their toes. The worker immediately asked for another room (Naomi Morita [wife of Alex Morita], interview 2013-14).



Congratulations
HOTEL HONOKAA CLUB
Comfortable Rooms With Wonderful View
Beautiful Cocktail Lounge—Delicious Meals

1950 Honokaa High School yearbook advertisement emphasizing the homey atmosphere of the hotel.

At some point in the Morita ownership, the hotel restaurant became famous for its well-regarded Japanese *teishoku* dinners (a set meal on a tray), sizzling steak dinners, and especially its lobster dinners. One of the Rockefellers would drive all the way from Kona for his favorite lobster dinner. (Jory Watland, personal communication, 2013). In 1960, the hotel added another cocktail lounge dubbed the "Waipio Room" (unidentified newspaper article June 6, 1960).

United States Department of the Interior
National Park Service

**National Register of Historic Places
Continuation Sheet**

Section number 8 Page 9

Hotel Honokaa Club	Put Here
Name of Property	
Hawai'i, Hawai'i	
County and State	
Historic and Architectural Resources of Honoka'a Town	
Name of multiple listing (if applicable)	

Where the elite of Honokaa meet

The Hotel Honokaa Club

PHONES: 752-165 - 752-175
P. O. BOX 192
HONOKAA, HAWAII

The finest in hostelry and cuisine

1958 Honokaa High School yearbook advertisement emphasizing its efforts to improve services to attract a broader range of patrons.

Still the center of gatherings in the 1970s, Henry Morita inaugurated the Dan McGuire Left-Handed Martini Room, named after a local newspaper sports writer of the time ("Night Life in Honokaa." Honolulu Advertiser, August 29, 1978). The Martini Room hosted players after the Hawaiian

United States Department of the Interior
National Park Service

National Register of Historic Places
Continuation Sheet

Section number 8 Page 10

Hotel Honokaa Club	Put Here
Name of Property	
Hawai'i, Hawai'i	
County and State	
Historic and Architectural Resources of Honoka'a Town	
Name of multiple listing (if applicable)	

Macadamia Nut Company's golf tourney played at the Hamakua Country Club as part of the annual Macadamia Nut Harvest Festival. Local personages included now Channel 2 KHON newscaster "Joltin' Joe" Moore, golf course architect Robert Trent Jones, Jr, and singer Danny Kaleikini (Honolulu Advertiser, August 29, 1978). Further shenanigans related to the martini room included Jim Nabors' dedication of the Jim Nabors Righthanded (sic) Pay Toilet.

During the last years of the Morita proprietorship, the owners were forced to take out mortgages for increasing amounts to cover expenses. They eventually lost control of the Hotel Honokaa Club.

By 1989, Waimea Group Limited Partnership acquired the property. Included in the partnership was Jory Watland, who ultimately became sole owner. During Watland's tenure, the restaurant kitchen was completely renovated, but a continuing decline in patronage eventually led to the end of meal services on the premises. Only holiday live music presentations continued to draw crowds to the former dining areas.

With the decline in sugar employment, hotel business also plateaued. In 1997, a bed in the youth hostel in the basement cost \$15 per night and a "luxury suite" upstairs \$55.

Watland has continued to have faith in his Hotel Honokaa Club. He has invested extensively in the physical plant, including a complete new *totan* roof, sewer system, and photovoltaic system. As a member of the second generation of his family that has endorsed historic preservation, he has been an advocate of placing Honoka'a on the State and National Historic Registers.

United States Department of the Interior
National Park Service

National Register of Historic Places
Continuation Sheet

Section number 8 Page 11

Hotel Honokaa Club	Put Here
Name of Property	
Hawai'i, Hawai'i	
County and State	
Historic and Architectural Resources of Honoka'a Town	
Name of multiple listing (if applicable)	

People

The Morita Clan

The first manager of the Honokaa Hotel Club complex was Kumakichi Morita. He was born about 1873 in Kumamoto Prefecture in Japan. He immigrated to the United States in September of 1905 and his wife, Kane, followed in November of the same year (*Records of the Immigration and Naturalization Service, 1787-2004*). He learned the restaurant business in San Francisco. Trained as a chef in American cuisine, he then came to Hawai'i. In Honolulu, Kumakichi spent a short period in the employ of Prince Jonah Kūhīo Kalaniana'ole. Unfortunately, the Prince did not appreciate an exclusive American cuisine and Morita soon looked elsewhere for employment.

A newspaper advertisement led him to Honoka'a and the residence of George Jamieson, the manager of Honokaa Sugar Plantation where he was to work as a cook in the Jamieson household.

Kumakichi and Kane arrived in Honoka'a, as many early emigrants did, by way of a basket transporting people and goods from shipboard by a series of wire ropes, derricks, pulleys, and counter weights connecting upper Hāmākua slopes with vessels at sea. As early as 1883, local historian Thomas Thrum noted the extensive use of by plantations of Andrew Hallidie's wire tramways at selected places along the coast.

The 1910 Census indeed noted the Kumakichi was employed as a cook in a private household; his wife Kane was unemployed (Hawaii, Compiled Census Index, 1900-1910 Provo, UT, USA). They were both literate in Japanese, and they may have had some English language proficiency. Kumakichi registered for the draft at age 45 in 1918, a common effort to qualify for citizenship (Hilo draft board, October 26, 1918).

By 1920, Kumakichi and his wife were running the hotel. He was listed as the proprietor and she as a cook. Eighteen-year-old son Yoshikazu (Victor), who had been born in Yokohama, was listed as having emigrated from Japan in 1917 where he had been a clerk. A 30-year-old male, unmarried boarder Momoro Takai, was also living with the Moritas, and working as a clerk in a retail store (Bureau of the Census, 1920).

United States Department of the Interior
National Park Service

National Register of Historic Places
Continuation Sheet

Section number 8 Page 12

Hotel Honokaa Club	Put Here
Name of Property	
Hawai'i, Hawai'i	
County and State	
Historic and Architectural Resources of Honoka'a Town	
Name of multiple listing (if applicable)	



MORITA FAMILY COLLECTION

Victor (left of center) and Tomiko (right of center) Morita's wedding party. Mother Kane Morita is in white, ca. 1920s.

In the 1930 census, Kumakichi continued to be the proprietor of the hotel, but Kane and 28-year-old Yoshikazu were not working. Yoshikazu had married 23-year-old Tomiko and had two sons, 2-year-old Shozo H. and 11-month-old Takao. The household also included a 16-year-old Japanese girl named Shizuko Uyehara and Jaoa Daug, a 19-year-old Filipino, both working as servants for a "private family." (It is unknown if the "private family" was the Moritas (Bureau of the Census 1930). During the 1930s Yoshikazu visited Japan for a week at a time: once in 1932 and twice in 1936. He was classified on the manifests as a clerk, hotel proprietor and hotel owner (Passenger Lists of Vessels Arriving at Honolulu).

United States Department of the Interior
National Park Service

National Register of Historic Places
Continuation Sheet

Section number 8 Page 13

Hotel Honokaa Club **Put Here**

Name of Property

Hawai'i, Hawai'i

County and State

Historic and Architectural Resources
of Honoka'a Town

Name of multiple listing (if applicable)



MORITA FAMILY COLLECTION

Grandmother Kane Morita with baby Henry. Henry was probably wearing special ceremonial clothing for his blessing at a Shinto shrine.

United States Department of the Interior
National Park Service

National Register of Historic Places
Continuation Sheet

Section number 8 Page 14

Hotel Honokaa Club	Put Here
Name of Property	
Hawai'i, Hawai'i	
County and State	
Historic and Architectural Resources of Honoka'a Town	
Name of multiple listing (if applicable)	

In the 1930s, not shown in the census, tragedy struck the family. It was a sad day when driving the family car Victor lost control and ran into one of the many gulches in Hāmākua. One-to-two-year-old son Jean was killed and oldest son Henry was severely injured, spent many months healing at the Honolulu Shriners' Hospital for Crippled Children, and forever walked with a limp. Alex was too young to go in the car and was spared.



MORITA FAMILY COLLECTION

Alex, Robert, and Henry Morita standing in front of the Hotel Honokaa Club sign. Also on the sign is the added establishment attraction "Kohala Hula Studio, Honokaa Branch, Mrs. Emma Moniz, Instructor." The sign on the building behind says Hamakua Laundry, ca. 1938.

United States Department of the Interior
National Park Service

National Register of Historic Places
Continuation Sheet

Section number 8 Page 15

Hotel Honokaa Club	Put Here
Name of Property	
Hawai'i, Hawai'i	
County and State	
Historic and Architectural Resources of Honoka'a Town	
Name of multiple listing (if applicable)	

The 1940s census recorded major changes in the Morita household. Not recorded were Kumakichi, Yoshikazu, Tomiko, Shozo, Takao and the two servant boarders. The names listed are Kane, who was now the head of the household, and three grandsons, 12-year old Henry, 9-year-old Alexander, and 6-year-old Robert. The three grandsons were named after Victor's friends: Henry Shozo, Alexander Hideyo, and Robert _____. (Naomi Morita, interview 2014). Later land documents confirm them as Yoshikazu and Tomiko's sons. According to Victor Y[oshikazu] Morita's obituary (Honolulu Advertiser, "Victor Morita Dies on Hawaii After Stroke." December 4, 1953, A7:1). Interestingly enough, they also had a younger daughter, Judy, though her name was not known at the time of the 1953 notice.

The three boys, Henry, Alexander and Robert, reorganized the title to the property in 1964. Over the next twenty-two years, a total of seven mortgages were taken out on the property to raise cash as declining patronage translated into operating losses. The Moritas lost control of the property in 1989 (Bureau of Conveyances, Liber 4801, p. 214 and various documents).

Alex Morita continued to contribute to Honoka'a becoming the administrator overseeing building the new Honokaa Hospital. He would live weekdays in a small cottage on the hospital grounds, returning to his home in Hilo on the weekends. (Naomi Morita, interview 2014).

Jory Watland and Annelle Lee

Jory Watland was born in Jackson, Minnesota on October 16, 1940. After attending the University of Hawai'i, he returned to the islands as a Lutheran minister in 1968. Annelle Lee, his partner, was born December 18, 1942 in Hilo and was raised in Wailuku, Maui. Both have been involved with the Hotel Honokaa Club since 1994 (Annelle Lee, interview, September 10, 2014).

The Hotel Honokaa Club remains an important asset to our social history. Very few of such facilities remain. It deserves official recognition under Criterion A.

United States Department of the Interior
National Park Service

National Register of Historic Places
Continuation Sheet

Section number 8 Page 16

Hotel Honokaa Club	Put Here
Name of Property	
Hawai'i, Hawai'i	
County and State	
Historic and Architectural Resources of Honoka'a Town	
Name of multiple listing (if applicable)	

Criterion C

“Plantation Vernacular” is used to define a regional architectural style for buildings erected during the Plantation Period. They were built by carpenters of various nationalities (using standardized lumber mostly from the Pacific Northwest). These builders had been trained by Hawaiian Sugar Planters Association (HSPA) companies, and after leaving those companies went to work as independent contractors. They continued to build in this style (and make innovations to it) because they shared a common construction and building vocabulary. Tools employed by the carpenters were a mixture of standard implements imported from the United States and the home countries of the immigrants themselves.

The primary hallmark of the style, "single wall" construction, consisted of vertical boards nailed to wood plates and sills. The vertical board faces were both the exterior and interior wall surfaces of a building. They were either of plank frame (no corner posts) or box frame (corner posts) construction, both of which were of New England origins, and were used for all classes of buildings in Hawai'i. The board-and-batten exterior wall finish came from the need to cover the interstices between vertical boards before the use of tongue-and-groove or shiplap boards rendered the vertical battens unnecessary. Imported windows and doors (designed for balloon frame construction) either projected out from the exterior wall or, if flush with the exterior wall, projected into the interior of the building.

The HSPA, under pressure to improve worker housing by the Territorial Board of Health, standardized buildings plans and construction in 1920 and continued to use “single wall” construction with the following modifications: (a) wood posts could be used at corners (box framing); and/or (b) wood studs could be used sparingly, positioned on either sides of doors and window jambs or at the intersections of interior partitions.

A variety of standardized floor plans for dwellings and barracks were produced, surmounted by hipped or gable-on-hip roofs commonly covered with *totan*, corrugated metal. For commercial buildings, stores, and theaters, gabled or shed roofs, also covered in corrugated metal, were the most common, terminating in a vertical wood board parapet which also carried the signage of an enterprise and increased the buildings height when viewed from the street. Institutional buildings were primarily U-Plans or their derivatives.

After World War II, when the lengths of wall board were reduced by mainland manufacturers, two vertical boards were necessary to span the distance between sill and plate which made it necessary to apply a horizontal wood trim or “belt board” to cover the joint on the exterior wall surface and a horizontal wood nailer on the interior wall surface. After 1960 balloon frame construction, consisting of regularly-spaced wood studs, was uniformly adopted when the building codes in Hawai'i were modified, but the traditional exterior cladding of vertical boards or board-and-batten finish, along with horizontal belt boards and hipped or gable-on-hip roofs were retained. Even in the 21st century, especially for domestic architecture, the exterior finish associated with “Plantation Vernacular” has remained popular and still is being built (Solamillo, 2013).

United States Department of the Interior
National Park Service

National Register of Historic Places
Continuation Sheet

Section number 8 Page 17

Hotel Honokaa Club	Put Here
Name of Property	
Hawai'i, Hawai'i	
County and State	
Historic and Architectural Resources of Honoka'a Town	
Name of multiple listing (if applicable)	

Ironically, many of the original plantation-era buildings are disappearing. This is due to a number of reasons.

- Plantation era buildings were minimalist in design and use of materials. The reasons for this included difficulties in obtaining lumber and other components and changing plantation technologies that required periodic relocation of structures. Such structures are easy to demolish.
- The primary use of wood for walls and corrugated iron for roofing during the plantation era also limited the retention of early plantation construction, as wood is subject to termites and rot and corrugated roofs rust. Periodic maintenance, such as painting and parts replacement, is essential in the humid climate of Hawai'i.
- Accommodating Hawai'i's expanding population requires greater density, thus increasing pressures for land redevelopment (especially on O'ahu). As most Hawai'i towns (such as Waipahu, Līhu'e, Lahaina, and Hilo) originated in agricultural areas, their initial buildings suffer accordingly.
- The architecture of the plantations was also branded as "dated" in the post World War II popular mindset. Mass production, standardization and "Bauhaus" lack of ornamentation were the architectural focus of the 1950s and beyond, where many citizens of Hawai'i felt "new" designs physically represented an era of expanded employment opportunities outside the plantation hegemony. Plantation era commercial structures were even demonized as "slum structures" by government organizations such as the Honolulu Redevelopment Agency, which celebrated their demolition for new highways and urban renewal.
- Vernacular buildings, because they were not the work of noted architects or considered architectural treasures in themselves, were overlooked until their numbers dwindled enough to make them unique.

Honoka'a's buildings are rapidly becoming unique.

The Hotel Honokaa Club is especially unique because, although it is a plantation era commercial structure, it does not have a false front. As the building housed two distinct functions, entertainment and hotel, its architecture is more subdued. The size of the footprint identifies it as institutional, but the building's visual elevation from the street shows period design influences from typical Hāmākua plantation housing and Japanese teahouse architecture. The building externally sports a boxy shape, gabled *totan* roof, large eaves, tongue-and-groove siding, wood framed double hung windows, sliding wood windows and central *lanai*. Internal are period climate controls in the forms of high ceilings to allow warm air to rise, transom windows to facilitate cross ventilation, and an atrium to allow light into the main and basement levels; period design elements include exposed *totan* roofing in the stairway ceilings, canec ceilings, brick chimney, bead molding, exposed internal girts, wood floors, wood stairs, galvanized pipe handrails, corner wash basins in bedrooms, metal shower stalls and octagonal tile shower floors. Sliding *shoji* doors are also provided to facilitate opening additional space for large entertainment functions or close off space for more private activities.

United States Department of the Interior
National Park Service

National Register of Historic Places
Continuation Sheet

Section number 8 Page 18

Hotel Honokaa Club	Put Here
Name of Property	
Hawai'i, Hawai'i	
County and State	
Historic and Architectural Resources of Honoka'a Town	
Name of multiple listing (if applicable)	

The building has been expanded and altered over time, most significantly with the 1948 second-story addition away from Māmane Street on the *makai* side and the interior remodeling of the entertainment areas.

Although the building and grounds have undergone these changes, the Hotel Honokaa Club retains its historic integrity in terms of location, design, setting, materials, workmanship, feeling, and association. It is a good example of a modest commercial hotel and restaurant designed and constructed in the vernacular building tradition of a rural plantation town in Hawai'i during the early part of the 20th century.

Hotel Honokaa Club is thus significant on the State Level under both Criteria A and C for the Hawai'i and National Registers of Historic Places.

United States Department of the Interior
National Park Service

National Register of Historic Places
Continuation Sheet

Section number 8 Page 19

Hotel Honokaa Club	Put Here
Name of Property	
Hawai'i, Hawai'i	
County and State	
Historic and Architectural Resources of Honoka'a Town	
Name of multiple listing (if applicable)	

Additional Documentation

Submit the following items with the completed form:

Maps: A USGS map or equivalent (7.5 or 15 minute series) indicating the property's location.

MAP KEY TABLE

	DATE	MAP	DESCRIPTION	SURVEYOR/CARTOGRAPHER
01	n.d.	Hawaii Territory Survey: Hawaii Index Map	Honoka'a area of significance demarked by red rectangle	Walter E. Wall
02	1995	USGS Honoka'a Quad	Honoka'a Town on the Hāmākua Coast of the Island of Hawai'i demarked by red rectangle	
03	1995	USGS Honoka'a Quad	Hotel Honokaa Club demarked	
04	1949	4-5-016: 005, 006, 0017, 0018 County tax map	Hotel Honokaa Club in color	P.K. & R.B.; Tax Bureau & Survey Department
05	2014	Honoka'a street map	Hotel Honokaa Club demarked	
06	1914	Sanborn Fire Insurance Company Map	Original "Honokaa Club (Hotel)" demarked by red rectangle	
07	1925 to 1941	Honoka'a Town (map sheet 3),	Hotel Honokaa Club demarked by red rectangle	Toshio Harunaga
08	1932	(3) 4-5 Tax Map whole Honokaa Town	Hotel Honokaa Club depicted in color	G.B.; Survey Department
09	1935	Spencer Tract Subdivision County Map: 005, 006, 0017, 0018	Hotel Honokaa Club depicted in color	P.K. & R.B.; Tax Maps Bureau & Survey Department
10	2013	Honoka'a Town Building Map	Hotel Honokaa Club depicted in color	
11	2014	Honoka'a Town Building Map Key		
12	2014	Google Map of Honokaa, HI 96727	Hotel Honokaa Club outlined in red	

United States Department of the Interior
National Park Service

National Register of Historic Places
Continuation Sheet

Section number 8 Page 20

Hotel Honokaa Club	Put Here
Name of Property	
Hawai'i, Hawai'i	
County and State	
Historic and Architectural Resources of Honoka'a Town	
Name of multiple listing (if applicable)	

1. Island of Hawai'i map: Honoka'a area of significance demarked by the red rectangle.

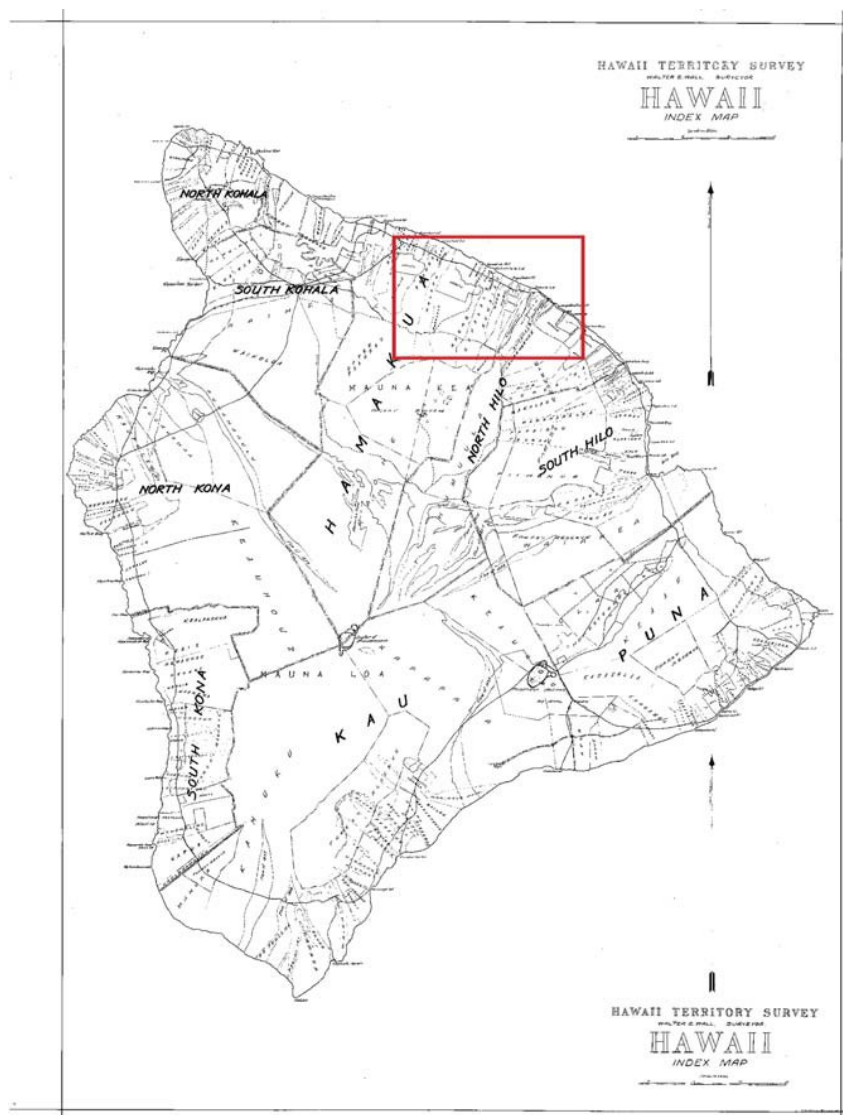

United States Department of the Interior
National Park Service

National Register of Historic Places
Continuation Sheet

Section number 8 Page 21

Hotel Honokaa Club	Put Here
Name of Property	
Hawai'i, Hawai'i	
County and State	
Historic and Architectural Resources of Honoka'a Town	
Name of multiple listing (if applicable)	

2. 1995 USGS Honoka'a Quad showing Honoka'a Town on the Hāmākua Coast of the Island of Hawai'i.

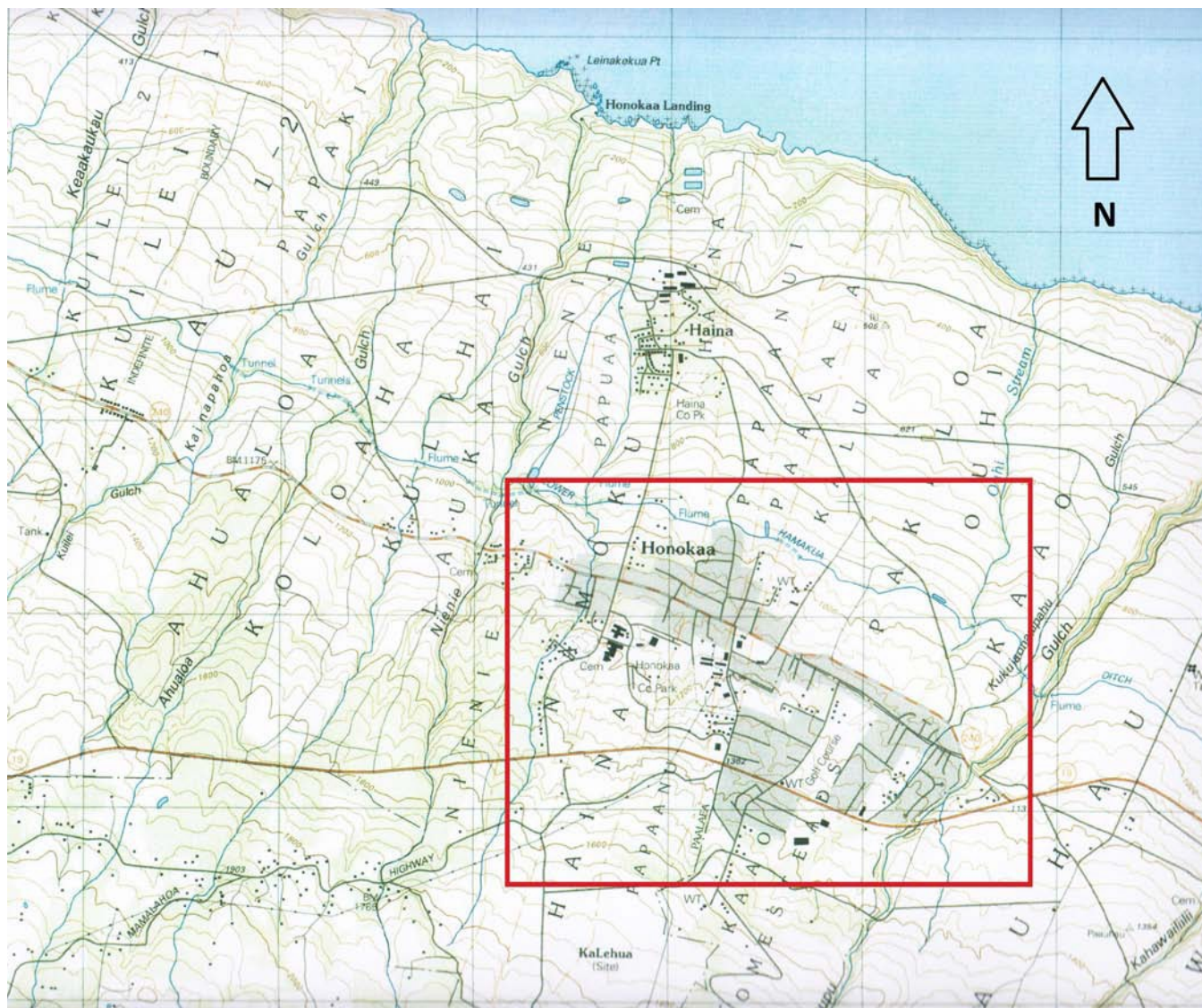

Section number 8 Page 22

Hotel Honokaa Club	Put Here
Name of Property	
Hawai'i, Hawai'i	
County and State	
Historic and Architectural Resources of Honoka'a Town	
Name of multiple listing (if applicable)	

3. 1995 USGS Honoka'a Quad showing the Hotel Honokaa Club.



United States Department of the Interior
National Park Service

National Register of Historic Places
Continuation Sheet

Section number 8 Page 23

Hotel Honokaa Club	Put Here
Name of Property	
Hawai'i, Hawai'i	
County and State	
Historic and Architectural Resources of Honoka'a Town	
Name of multiple listing (if applicable)	

4. 1949 4-5-016 County tax map showing the Hotel Honokaa Club in color.

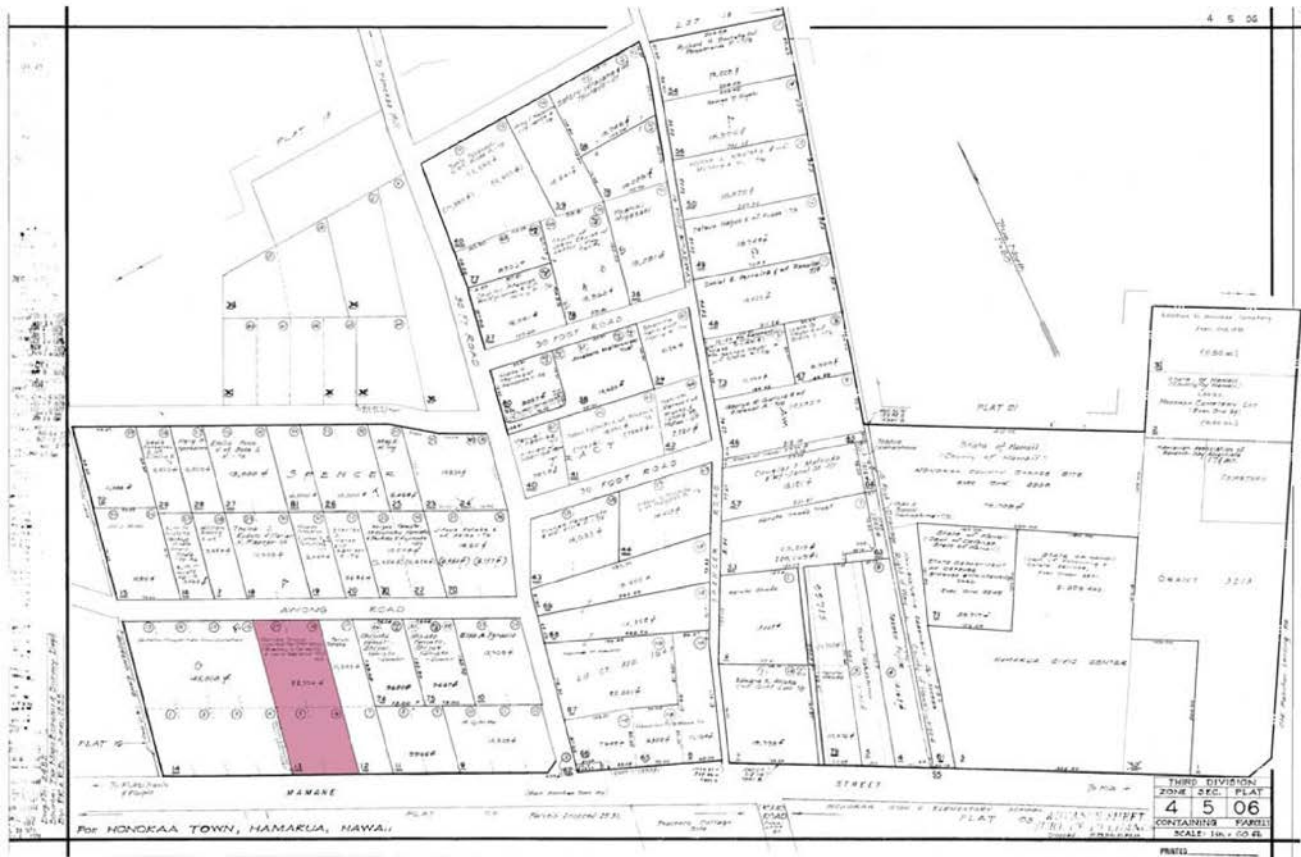

United States Department of the Interior
National Park Service

National Register of Historic Places
Continuation Sheet

Section number 8 Page 24

Hotel Honokaa Club	Put Here
Name of Property	
Hawai'i, Hawai'i	
County and State	
Historic and Architectural Resources of Honoka'a Town	
Name of multiple listing (if applicable)	

5. 2014 Honoka'a street map.

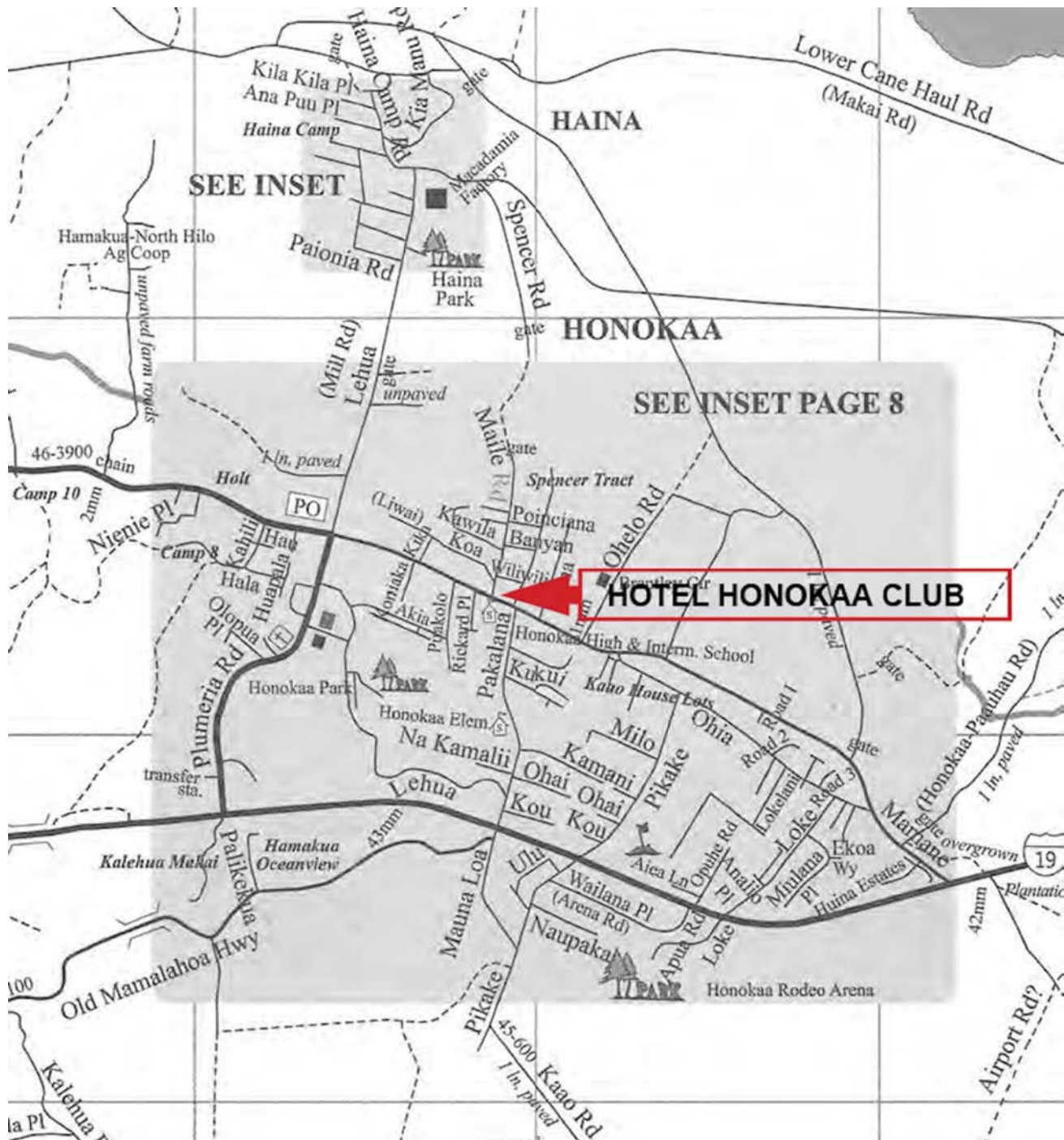

United States Department of the Interior
National Park Service

National Register of Historic Places Continuation Sheet

Section number 8 Page 25

Hotel Honokaa Club	Put Here
Name of Property	
Hawai'i, Hawai'i	
County and State	
Historic and Architectural Resources of Honoka'a Town	
Name of multiple listing (if applicable)	

6. 1914 Sanborn Fire Insurance Company Map showing “Honokaa Club (Hotel).”



United States Department of the Interior
National Park Service

National Register of Historic Places
Continuation Sheet

Section number 8 Page 26

Hotel Honokaa Club	Put Here
Name of Property	
Hawai'i, Hawai'i	
County and State	
Historic and Architectural Resources of Honoka'a Town	
Name of multiple listing (if applicable)	

7. 1925 to 1941 Honoka'a Town (map sheet 3), Hotel Honokaa Club demarked in red, created by Toshio Harunaga.

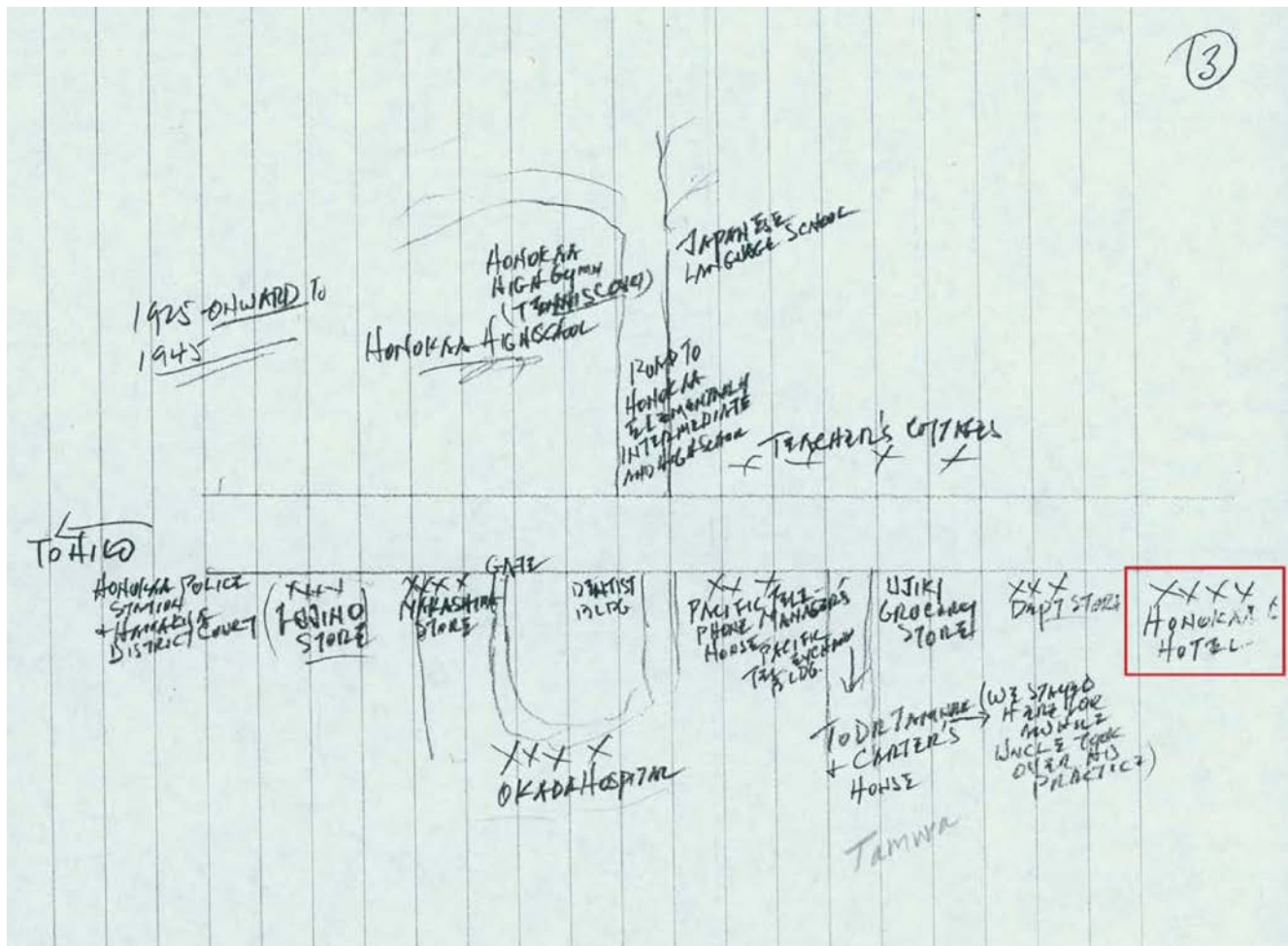

United States Department of the Interior
National Park Service

National Register of Historic Places
Continuation Sheet

Section number 8 Page 27

Hotel Honokaa Club	Put Here
Name of Property	
Hawai'i, Hawai'i	
County and State	
Historic and Architectural Resources	
of Honoka'a Town	
Name of multiple listing (if applicable)	

8. 1932 (3) 4-5 Tax Map whole Honokaa Town, Hotel Honokaa Club depicted in color.

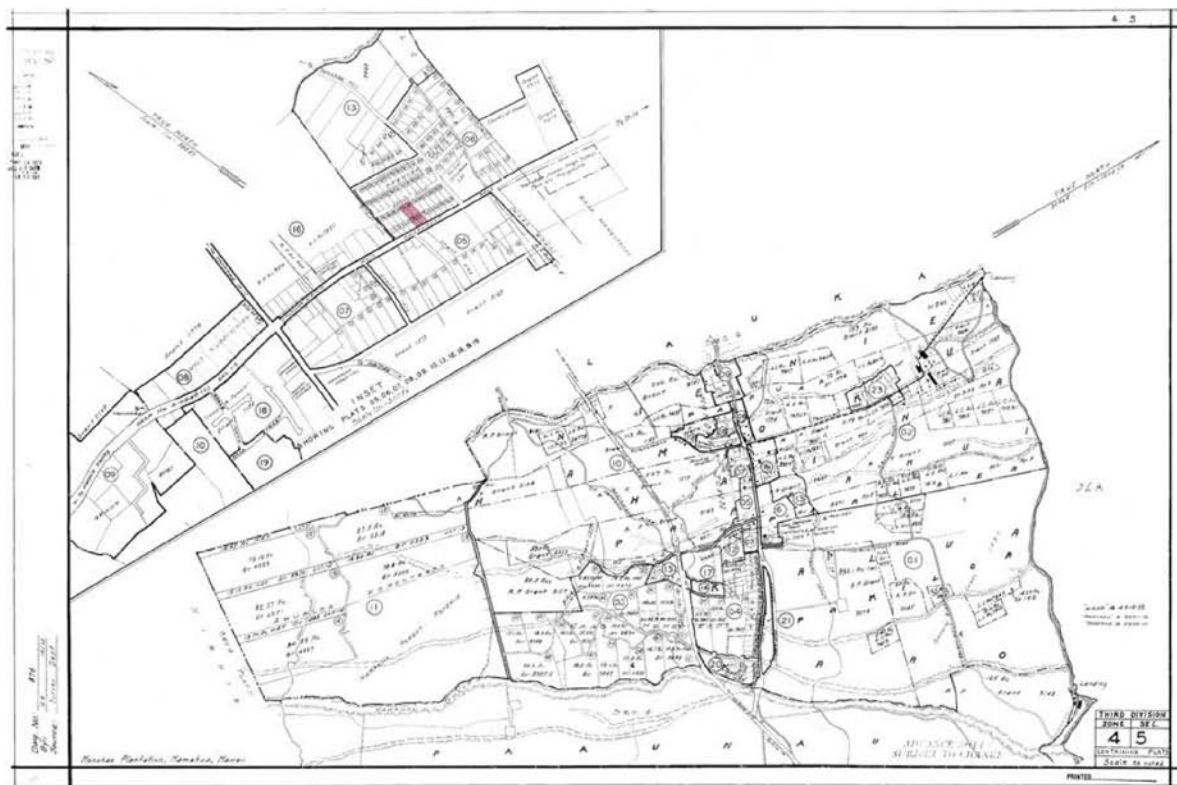

United States Department of the Interior
National Park Service

National Register of Historic Places
Continuation Sheet

Section number 8 Page 28

Hotel Honokaa Club Put Here
 Name of Property
 Hawai'i, Hawai'i
 County and State
 Historic and Architectural Resources
 of Honoka'a Town
 Name of multiple listing (if applicable)

9. 1935 Spencer Tract Subdivision County Map showing the Hotel Honokaa Club in color.



United States Department of the Interior
National Park Service

National Register of Historic Places
Continuation Sheet

Section number 8 Page 29

Hotel Honokaa Club	Put Here
Name of Property	
Hawai'i, Hawai'i	
County and State	
Historic and Architectural Resources of Honoka'a Town	
Name of multiple listing (if applicable)	

10. 2013 Honoka'a Town Building Map showing the Hotel Honokaa Club in color.

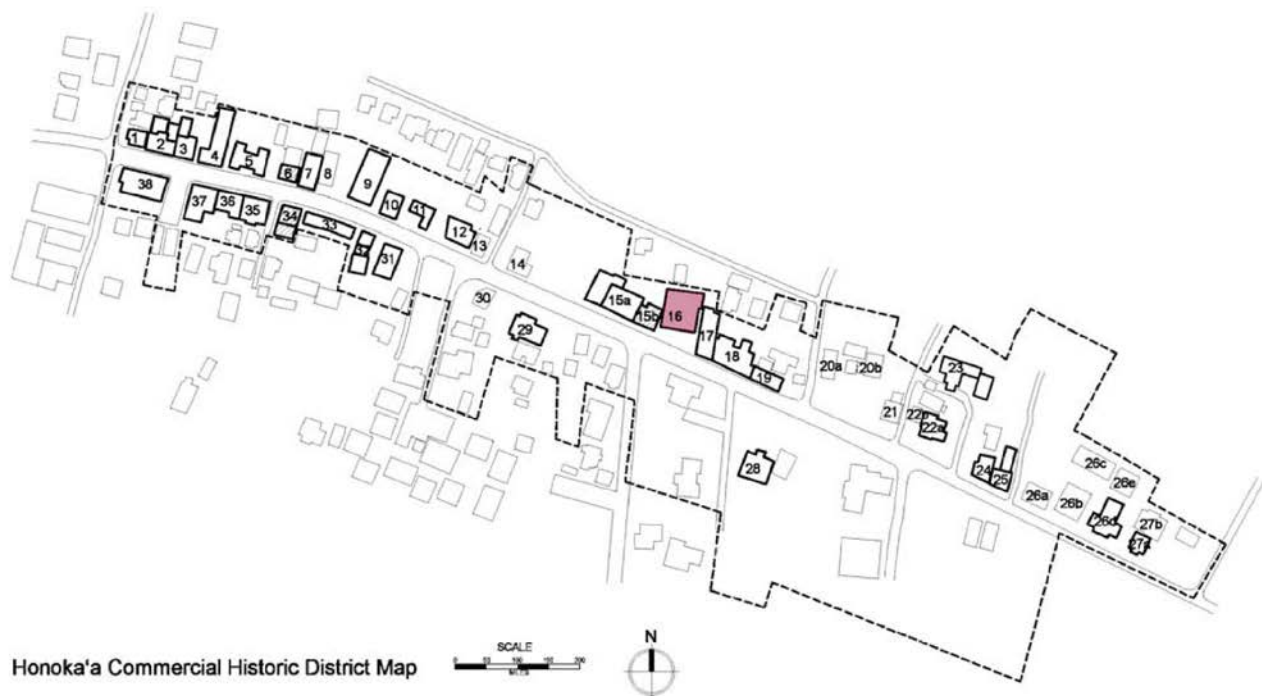

United States Department of the Interior
National Park Service

National Register of Historic Places
Continuation Sheet

Section number 8 Page 30

Hotel Honokaa Club Put Here
Name of Property
Hawai'i, Hawai'i
County and State
Historic and Architectural Resources
of Honoka'a Town
Name of multiple listing (if applicable)

11. Honoka'a Town Building Map Key.

Number	Name	Construction Date
1	Ikeuchi Building	1936
2	Andrade Building	1932
3a	Kotake Building	
3b	Hirata Building	1955
4	Old Doc Hill Theater	1939, 1958, 1968
5	Lawson/Awong/Holmes Store	1880s, 1929?
6	Yamatsuka Building	1930
7	Kiramitsu Garage	1928
8	Onomura Bar	1960
9	Honokaa People's Theater	1930
10	Bank of Hawaii	1927
11	Ted's Garage	1958
12	Shen's Emporium	1959
13	First Hawaiian Bank	Non-Contributing
14	Blane's Drive Inn	Non-Contributing
15a	Botelho Building	1927
15b	Botelho Annex	1911
16	Hotel Honokaa Club	1931, 1948
17	Harris Laundry Building	1948
18	Yamato Building	1919
19	Ujiki Building	1943
20a	Franklin Law Office	Non-Contributing
20b	Franklin/Thiel Residence	Non-Contributing
20c	Honokaa Shingon Temple	1910? Moved ca. 2013
21a	Hawaiian Telephone Building	ca. 1950
21b	site of Mutual Telephone Company Exchange; Hawaiian Telephone Company Exchange	
22a	Akioka Dentist Office	1937
22b	Akioka Dentist Residence	1937
23	Okada Japanese Hospital	1939
24	Nakashima Building	1939
25	Fujino Building	1925
26a		Non-Contributing
26b		Non-Contributing
26c		Non-Contributing
26d	Honokaa Library Building	1938
26e		Non-Contributing
27a	Board of Health Building	ca 1930s
27b		Non-Contributing
28	Rickard Residence	1883
29	Methodist Church	1927
30	76 Station	1959
31	Harunaga-Tanimoto-Tashiro Building	ca 1920s
32	Takata Building	1914
33	Sakata Building	1948
34	Hasegawa Building	1937
35	De Jesus Building	1919
36	Souza	ca 1920s
37	Rice Building	1940
38	Ferreira Building	1927

United States Department of the Interior
National Park Service

National Register of Historic Places
Continuation Sheet

Section number 8 Page 31

Hotel Honokaa Club	Put Here
Name of Property	
Hawai'i, Hawai'i	
County and State	
Historic and Architectural Resources of Honoka'a Town	
Name of multiple listing (if applicable)	

12. 2014 Google Map of Honoka'a, HI 96727. Hotel Honokaa Club is outlined in red.

Honokaa, HI 96727 - Google Maps

<https://www.google.com/maps/preview?client=firefox-a&channel>



United States Department of the Interior
National Park Service

National Register of Historic Places
Continuation Sheet

Section number 8 Page 32

Hotel Honokaa Club Put Here
Name of Property
Hawai'i, Hawai'i
County and State
Historic and Architectural Resources
of Honoka'a Town
Name of multiple listing (if applicable)

ADDENDUM A
PROPERTY TRANSFERS TABLE

TMK (3) 4-5-006:013 HONOKAA HOTEL CLUB 45-3480 Māmane Street

September 15, 2014

DATE	BOOK/PAGE	TRANSACTION	COST	LOT SIZE	DESCRIPTION
6/26/1911	342/282-285	Mortgage	\$4000	225 acres	<i>From the First Bank of Hilo to Alice K. Spencer:</i> A mortgage on a portion of Royal Patent Grant 2465 to Olepau Kaiaokioki and Papaiki (Spencer Tract).
6/25/1920	558/126-127	Deed	\$850	11,452 sq. ft.	<i>From First Bank of Hilo to Gladys Dias:</i> Lots 5 and 17 of the Spencer Tract.
7/1/1920	558/128	Deed	\$2500	11,452 sq. ft.	<i>From Gladys Dias to Nam Soon Myung:</i> Lots 5 and 17 of the Spencer Tract
12/22/1920	582/75-76	Deed	\$2000	11,452 sq. ft.	<i>From Nam Soon Myung to Kumakichi Morita:</i> Lots 5 and 17 in the Spencer Tract.
1921	620/168	Warranty Deed	\$850	11,452 sq. ft.	<i>From Alice Spencer to Hilo Trading Company, Ltd:</i> Lots 6 and 18 in the Spencer Tract
6/27/1925	785/297-298	Deed	\$900	11,452 sq. ft.	<i>From Hilo Trading Company to Kumakichi Morita:</i> Lots 6 and 18 in the Spencer Tract
8/18/1939	1519/168	Deed	\$1	22,904 sq. ft.	<i>From Kane Morita to (Victor) Yoshikazu Morita (son)</i>
9/27/1940	1590/475	Deed	\$1	22,904 sq. ft.	<i>From (Victor) Yoshikazu Morita and Tomiko (wife) to F.R.H. Fraser:</i> the entire parcel including lots 5 and 17 to augment lots 6 and 18.
9/27/1940	1590/476	Deed	\$1 and love	22,904 sq. ft.	<i>From F.R.H. Fraser to (Victor) Yoshikazu Morita and Tomiko (wife):</i> the entire parcel including lots 5 and 17 to augment lots 6 and 18.
12/14/1953	4613/470	Deed	\$1 and love	22,904 sq. ft.	<i>From Tomiko Morita to Henry, Alexander, and Robert (sons):</i> as part of the distribution of (Victor) Yoshikazu's estate after his death I 12/3/1953.
12/12/1966	5506/29	Deed	\$10	22,904 sq. ft.	<i>From Henry, Alexander and Robert Morita to Hotel Honokaa Club, Inc.</i>
1966-2000					<i>Ten Mortgages</i>
6/2/1989	23254/537	Warranty Deed	\$10	22,904 sq. ft.	<i>From Henry Morita to Waimea Group, Ltd.</i>
11/23/1994	#94-192575	Agreement of Sale	\$485,000	22,904 sq. ft.	<i>From Partner Alvin Wakayama to A. Joris Watland and Bradley Carvalho.</i> Partnership is dissolved
*6/23/1998	#98-090081	Warranty Deed		22,904 sq. ft.	<i>To back up agreement of sale</i>

*The Warranty Deed reads that it is to the Waimea Group, which no longer exists. The wording in the document follows that of the Agreement of Sale.