

United States Department of the Interior  
National Park Service

# National Register of Historic Places Registration Form

This form is for use in nominating or requesting determinations for individual properties and districts. See instructions in National Register Bulletin, *How to Complete the National Register of Historic Places Registration Form*. If any item does not apply to the property being documented, enter "N/A" for "not applicable." For functions, architectural classification, materials, and areas of significance, enter only categories and subcategories from the instructions.

## Name of Property

Historic name: Yee King Tong Cemetery

Other names/site number: Pauoa Chinese Cemetery

Name of related multiple property listing:

NA

(Enter "N/A" if property is not part of a multiple property listing)

## Location

Street & number: 352 Auwaiolimu Street

City or town: Honolulu State: Hawaii County: Honolulu

Not For Publication: ☐ Vicinity: ☐

## State/Federal Agency Certification

As the designated authority under the National Historic Preservation Act, as amended, I hereby certify that this X nomination      request for determination of eligibility meets the documentation standards for registering properties in the National Register of Historic Places and meets the procedural and professional requirements set forth in 36 CFR Part 60.

In my opinion, the property      meets      does not meet the National Register Criteria. I recommend that this property be considered significant at the following level(s) of significance:

     national      statewide X local

Applicable National Register Criteria:

X A      B X C      D

Signature of certifying official/Title:

Date

State or Federal agency/bureau or Tribal Government

In my opinion, the property      meets      does not meet the National Register criteria.

Signature of commenting official:

Date

Title : State or Federal agency/bureau  
or Tribal Government

Yee King Tong Cemetery  
Name of Property

Honolulu, Hawaii  
County and State

### National Park Service Certification

I hereby certify that this property is:

- ☐ entered in the National Register  
☐ determined eligible for the National Register  
☐ determined not eligible for the National Register  
☐ removed from the National Register  
☐ other (explain:) \_\_\_\_\_

Signature of the Keeper

Date of Action

### Classification

#### Ownership of Property

(Check as many boxes as apply.)

- Private: ☒
- Public – Local ☐
- Public – State ☐
- Public – Federal ☐

#### Category of Property

(Check only **one** box.)

- Building(s) ☐
- District ☐
- Site ☒
- Structure ☐
- Object ☐

Yee King Tong Cemetery

Honolulu, Hawaii

---

County and State

### Number of Resources within Property

(Do not include previously listed resources in the count)

Contributing	Noncontributing	
<u>1</u>	<u>                </u>	buildings
<u>1</u>	<u>                </u>	sites
<u>                </u>	<u>                </u>	structures
<u>                </u>	<u>                </u>	objects
<u>2</u>	<u>                </u>	Total

Number of contributing resources previously listed in the National Register  
none

### Function or Use

## Historic Functions

(Enter categories from instructions.)

Funerary/Cemetery

## Current Functions

(Enter categories from instructions.)

Funerary/Cemetery

Yee King Tong Cemetery  
Name of Property

Honolulu, Hawaii  
County and State

## Description

### Architectural Classification

(Enter categories from instructions.)

Neo-Classical Revival

---

---

---

---

---

---

**Materials:** (enter categories from instructions.)

Principal exterior materials of the property: Concrete

### Narrative Description

(Describe the historic and current physical appearance and condition of the property. Describe contributing and noncontributing resources if applicable. Begin with a **summary paragraph** that briefly describes the general characteristics of the property, such as its location, type, style, method of construction, setting, size, and significant features. Indicate whether the property has historic integrity.)

#### Summary Paragraph

The Yee King Tong Cemetery is situated in a quiet residential neighborhood at the back of Punchbowl. It sits on two lots, encompassing 2.21 acre and .22 acres. The larger, L-shaped lot sits to the north of and below Auwaiolimu Street, while the smaller, rectangular lot sits across the street to the south and above the road. Both lots are characterized by open lawns with headstones. A reinforced concrete bone house sits at the east side of the larger lot. Also on that lot are two single family residences, but these are not included in the nomination. The cemetery is in good condition and retains its historic integrity of design, materials, workmanship, setting, location, feeling and association.

### Narrative Description

A macadam paved driveway runs down from Auwaiolimu Street from the southwest corner of the cemetery's larger parcel, and at the intersection of the two legs of the L curves to the north and continues to the back of the lot. Lava rock gate posts, each made of a single stone, flank the driveway as it levels off, and a plumeria tree is to the south of the driveway past the gate posts. Adjacent to the driveway, on its north and west sides, is a lava rock stone wall which demarcates the boundary between the Yee King Tong Cemetery and the Tung Sing Tong Cemetery. The wall is not part of this nomination.



Yee King Tong Cemetery

Name of Property

Honolulu, Hawaii

County and State

The lands to the south and east of the driveway are in lawn and contain seventy one marked graves. Because of attrition and loss of head stones, the tombstones appear to be placed in a somewhat random manner. There are a variety of headstones, ranging in material from concrete to marble and granite, and bearing dates from the late nineteenth century into the early 21<sup>st</sup> century. Many of the stones are rectangular in shape, but some tops are ogee, others oval and still others oval with shoulders. There is one plinth and one cruciform shaped stone. Some are inscribed in English, while others are in Chinese. Many of the graves are demarcated by concrete curbing with the headstones at the foot of the grave. Five of the graves are enclosed with a pipe railing fence.

Auwaioimu Street towers above the cemetery's lower lot, and its lava rock retaining wall is approximately 19' tall and 18" wide, and forms a backdrop for the southern boundary of this cemetery lot. At the northern end of the cemetery is a broken concrete basin on concrete legs with the name "Yee Kin Tong" inscribed in the side. This basin was originally used for burning incense. A white, rectangular shaped bone house dominates the east side of the cemetery. This single story, reinforced concrete building has a flat roof and sits on a concrete slab foundation. Rendered in a neo-classical style, it is symmetric and features a flat roofed lanai which runs across the façade. The lanai is five bays wide with each bay demarcated by a 14" x 14" chamfered, Doric Column. The concrete columns rise from 8" high, 18" square concrete bases.

Two centered, concrete steps lead up to the lanai. To the north of the steps is a rectangular, concrete box with no top, which once was used to burn incense. Adjacent to the box is a tall wire basket in which firecrackers are exploded. The columns support an architrave, which in turn carries a simple cornice. The three middle bays of the architrave each have red Chinese writing incised in them. The left of center bay has the date, "1935", while the right of center bay appears to be a formal name. The center bay wishes, "Abundant Good Fortune." The cornice has the date "1935" in Arabic numerals incised in its center.

The lanai has a scored concrete floor and a 10' high paneled concrete ceiling. Its rear, east, wall has a centered double doorway which is flanked on either side by a pair of two pane casement windows. The historic two panel doors retain their original handles and hardware. Red Chinese inscriptions are incised to the walls on either side of the doorway and above it. The words above remind people that being kind, or doing good, is the happiest way to live. The writings on either side of the door seem to have some religious meaning. On the interior, the bone house is one, large, 21'- 4" x 48'- 3" rectangular space. It has a scored concrete floor and a 12'- 2" paneled concrete ceiling. Two chamfered, concrete columns mid-way back from the entry and at either side of the center bay provide extra support to the roof. The 12" square columns have no capitals and rise from a 12" high, 15" square base. The room has four rows of steel shelving which carry approximately 223 individuals, who are mostly in clay pots, although there are also four suitcases, 3 boxes and a metal can. On the south side of the room is a pair of two pane casement windows, while on the north side these historic windows have been replaced by a pair of jalousie windows. In the center of the rear, east, wall a wood plaque stands on the top shelf and leans against the wall. Its Chinese inscription prays for happiness for the generations from the ancestors to future descendants.

Yee King Tong Cemetery

Name of Property

Honolulu, Hawaii

County and State

A storm runoff channel runs in front of the bone house. The open channel is covered by a 5" thick concrete slab in front of the bone house. The walls of the approximately 3' deep and 6' wide channel are of lava rock and the floor is concrete.

The second section of the Yee King Tong cemetery is on the south side of Auwaiolimu Street and adjoins the Ket On Society's cemetery. An approximately 11' high, 18" wide, lava rock retaining wall rises from a grassed right of way which separates the cemetery property from the road. At the east end of the cemetery's land there is a break in the wall with eighteen concrete steps ascending to the graveyard. The steps have a pipe hand rail on either side and gate posts rise from the top of the wall. This sloping property is in lawn with approximately 64 headstone set in seven rows. Almost all the graves are demarcated by concrete curbs, with the headstones at the foot of the grave. In front of the many headstones is a concrete base with round and/or rectangular openings for the placement of incense, flowers, and other offerings. The headstones are of marble or granite and written in either English or Chinese. Ogee or oval tops predominate, although some flat and oval with shoulders are also present. Several small, square, concrete markers are flush with the earth.

The Yee King Tong cemetery very much retains its historic integrity. Other than the replacement of one of the bone house's side wall's pair of windows with jalousies, the remainder of the bone hose retains its original design and materials. Also, the cemetery continues as an active cemetery and retains its historic appearance. As such the Yee King Tong cemetery retains its integrity of design, materials, craftsmanship, location, setting, feelings and associations.

Yee King Tong Cemetery  
Name of Property

Honolulu, Hawaii  
County and State

## 1. Statement of Significance

### Applicable National Register Criteria

(Mark "x" in one or more boxes for the criteria qualifying the property for National Register listing.)

- ☒ A. Property is associated with events that have made a significant contribution to the broad patterns of our history.
- ☐ B. Property is associated with the lives of persons significant in our past.
- ☒ C. Property embodies the distinctive characteristics of a type, period, or method of construction or represents the work of a master, or possesses high artistic values, or represents a significant and distinguishable entity whose components lack individual distinction.
- ☐ D. Property has yielded, or is likely to yield, information important in prehistory or history.

### Criteria Considerations

(Mark "x" in all the boxes that apply.)

- ☐ A. Owned by a religious institution or used for religious purposes
- ☐ B. Removed from its original location
- ☐ C. A birthplace or grave
- ☒ D. A cemetery
- ☐ E. A reconstructed building, object, or structure
- ☐ F. A commemorative property
- ☐ G. Less than 50 years old or achieving significance within the past 50 years

### Areas of Significance

(Enter categories from instructions.)

architecture

Yee King Tong Cemetery

Name of Property

Honolulu, Hawaii

County and State

ethnic heritage/asian/Chinese

---

---

---

---

---

**Period of Significance**

1889-1973

---

---

**Significant Dates**

1889, 1935

---

---

**Significant Person**

(Complete only if Criterion B is marked above.)

NA

---

---

**Cultural Affiliation**

NA

---

---

**Architect/Builder**

unknown

---

---

**Statement of Significance Summary Paragraph** (Provide a summary paragraph that includes level of significance, applicable criteria, justification for the period of significance, and any applicable criteria considerations.)

The Yee King Tong cemetery is significant on the local level under criterion C, as a good example of a Chinese cemetery developed in Honolulu during the late nineteenth century and remaining active into the present century. The cemetery is typical of its period in its design, materials, workmanship and methods of construction, and includes a number of distinctive features, including its bone house.

Yee King Tong Cemetery

Honolulu, Hawaii

Name of Property

County and State

The cemetery is also significant under Criterion A for its associations with the Chinese in Hawaii.

The 1889-1973 period of significance was chosen as 1889 is the date the Yee King Tong was established and the cemetery continues in operation to the present.

---

**Narrative Statement of Significance** (Provide at least **one** paragraph for each area of significance.)

**Criterion C: Architecture**

The Yee King Tong Cemetery is significant as a good example of a Chinese cemetery active in Hawaii from the late nineteenth through the twenty first century. Its tombstones represent typical tombstone designs of their period, and the presence of many headstones written in Chinese reflects the ethnic origins of the cemetery, as also does the presence of a bone house. The bone house is the most architecturally distinctive in the Islands.

Yee King Tong was charted within the Kingdom of Hawaii as a “body corporate” in 1889 with its initial membership being C. Mon Ting, Goo York, Goo Fat, Lau Lin, Choo Gee, Loo Qui, Young Yong, Chang Nee Qui, and Tin Chuck, with the Minister of the Interior Lorrin A. Thurston approving their application. In 1899 the organization became an association, and in return for \$1,000 membership fee, each member was entitled to a burial plot. In 1902, when the Territorial Board of Health was weighing the possible danger of cemeteries to public health, the City Sanitary Officer reported the Yee King Tong Cemetery on the slope of Punchbowl was one of five cemeteries within a mile of downtown Honolulu, with the others being Kawaiahao Cemetery, the Catholic Cemetery on King Street, the Pauoa Church Cemetery, and the Hook Chu Co. Cemetery in Pauoa. Eleven other cemeteries were listed within the City limits including: the Makiki Cemetery, Nuuanu Cemetery, Kalaepohaku Cemetery, Manoa Church Cemetery, Manoa Chinese Cemetery, the Diamond Head Cemetery, Waikiki Church Cemetery, Kalihi Church Cemetery, Kalihi-Waena Catholic Cemetery, Pueo Cemetery and Kaumakapili Cemetery. With regards to the Yee King Tong Cemetery, the report noted it was, “Just above the Portuguese settlement. It has been in use for twenty years, and there are few graves owing to the Chinese custom of sending the bones of deceased relatives to China.” [“May Close Cemeteries in the City,” *Pacific Commercial Advertiser*, October 2, 1902, page 1] The cemeteries were not closed, and over the years more people were laid to rest in the Yee King Tong Cemetery.

In 1935 the City’s decision to connect Nuuanu and Manoa valleys via a new roadway had a major impact on the cemetery. The road plans called for circumnavigating Punchbowl by connecting Prospect and Nahoa streets, and by extending Auwaiolimu Street to connect Pensacola Street with Lusitana Street. At the time Auwaiolimu ran up from Lusitana and ended close to the cemetery. The new roads were to be constructed using Federal Emergency Relief Act (FERA) assistance, [“Mayor Plans 7 Projects in Makiki Areas,” *Star Bulletin*, December 28, 1934, page 3] which eventually fell under the Works Progress Administration (WPA). The road ran through approximately 1,377 square feet of the cemetery necessitating the disinterment of 206 individuals.

Yee King Tong Cemetery

Honolulu, Hawaii

Name of Property

County and State

["To Name Nuuanu Stream Bridge after Richards," *Honolulu Advertiser*, July 30, 1935, page 11 and "Old Chinese Custom Means Much Grief in Road Plans," *Honolulu Advertiser*, July 12, 1935, page 8] Of the graves to be emptied, 142 were unidentified, as an earlier fire at the cemetery had destroyed all the wood grave markers. In exchange for the cemetery land the Territory gave the Yee King Tong 8,940 square feet of land on the south side of the new Auwaiolimu Street, which is not the society's cemetery area above the road. Also as a result of the disinterment of the individuals the bone house was erected.

In 1936, the City and County awarded a contract to J. W. Glover to construct the Auwaiolimu extension of the road. ["Street Extension Award Delayed," *Star Bulletin*, April 3, 1936, page 4 and "Shovel Bites Out Manoa-Nuuanu Cutoff," *Star Bulletin*, June 16, 1936, page 5] This work included the construction of the lava rock retaining walls on both the uphill and downhill sides of the road.

### **Associations with the Chinese in Hawaii**

The Chinese were among the earliest foreign people to arrive in Hawaii, coming as early as 1788 or 1789, and in 1784 Captain Vancouver recorded in his log seeing Chinese among the foreigners with Kamehameha at Kealakekua Bay. [Char, page 37] During the nineteenth century the number of Chinese in Hawaii expanded dramatically and prior to the Islands' annexation by the United States, an estimated 46,000 Chinese had migrated here. Of that number between two thirds and three quarters of the people came to work on sugar or rice plantations, with the first laborers arriving in 1852 as a result of the Masters and Servants Act. [Glick, page 23] As a result of this immigration, by 1878 the Chinese constituted the largest foreign group in Hawaii, and would remain so until 1896, when they were superseded by the Japanese.

The proper treatment for the remains of the dead, was an important aspect of life for the Chinese in Hawaii, with a desire for individuals' remains to ultimately be buried in the village of their birth being a high consideration. Upon death people were buried, but later, when circumstances allowed, were disinterred and sent back to China. Between disinterment and transporting to China, the remains were held in containers in the bone house. This practice was interrupted by World War II and concluded with the communist rise to power in China.

The earliest Chinese cemetery on Oahu was in Manoa, with a group of Chinese merchants forming the Manoa Lin Yee Wui in 1852. Other cemetery associations were formed later, as the increasing Chinese population became differentiated into sub-groups with different districts, dialectical and religious backgrounds. [Glick page 187] The Yee King Tong cemetery was among the Chinese cemeteries formed in the late nineteenth century. Today, there remain seven Chinese cemeteries on Oahu, with only the Manoa Chinese cemetery listed in the Hawaii Register of Historic Places. The other six cemeteries: the Yee King Tong, Ket On, Hook Chu, Tong Sin tong, Pauoa Chinese Christian, and Makiki Chinese Christian, are all located in Pauoa, in close proximity to the Yee King Tong cemetery.

Yee King Tong Cemetery  
Name of Property

Honolulu, Hawaii  
County and State

## Criteria Consideration D

The Yee King Tong cemetery derives its primary significance from its design as a Chinese cemetery, with such distinctive features as a bone house, location on a hillside, and Chinese inscribed headstones, as well as associations with the history of the Chinese in Hawaii.

---

## 2. Major Bibliographical References

**Bibliography** (Cite the books, articles, and other sources used in preparing this form.)

City and County Tax Records

Hawaii State Bureau of Conveyances, Grant 10348, book 65

"May Close Cemeteries in the City," *Pacific Commercial Advertiser*, October 2, 1902, page 1

"Mayor Plans 7 Projects in Makiki Areas," *Star Bulletin*, December 28, 1934, page 3

"Old Chinese Custom Means Much Grief in Road Plans," *Honolulu Advertiser*, July 12, 1935, page 8

"To Name Nuuanu Stream Bridge after Richards," *Honolulu Advertiser*, July 30, 1935, page 11

"Street Extension Award Delayed," *Star Bulletin*, April 3, 1936, page 4

"Shovel Bites Out Manoa-Nuuanu Cutoff," *Star Bulletin*, June 16, 1936, page 5

Char, Tin-Yuke, *The Sandalwood Mountains*, Honolulu: University of Hawaii Press, 1975

Glick, Clarence, *Sojourners and Settlers*, Honolulu: University of Hawaii Press and Hawaii Chinese History Center, 1980

---

### Previous documentation on file (NPS):

☐ preliminary determination of individual listing (36 CFR 67) has been requested

☐ previously listed in the National Register

☐ previously determined eligible by the National Register

☐ designated a National Historic Landmark

☐ recorded by Historic American Buildings Survey # \_\_\_\_\_

☐ recorded by Historic American Engineering Record # \_\_\_\_\_

☐ recorded by Historic American Landscape Survey # \_\_\_\_\_

### Primary location of additional data:

Yee King Tong Cemetery

Name of Property

Honolulu, Hawaii

County and State

☐ State Historic Preservation Office

☐ Other State agency

☐ Federal agency

☐ Local government

☐ University

☐ Other

Name of repository: \_\_\_\_\_

**Historic Resources Survey Number (if assigned):** \_\_\_\_\_



Yee King Tong Cemetery  
Name of Property

Honolulu, Hawaii  
County and State

### 3. Geographical Data

Acreage of Property 2

Use either the UTM system or latitude/longitude coordinates

#### Latitude/Longitude Coordinates

Datum if other than WGS84: BING Maps <https://www.bing.com/maps/trail/Oahu,-Hawaii-Hawaii?id=cae5608608c34251b8135d0ea66ea1ba>

(enter coordinates to 6 decimal places)

1. Latitude: 21.314107 Longitude: 157.814714

2. Latitude: Longitude:

3. Latitude: Longitude:

4. Latitude: Longitude:

Or

#### UTM References

Datum (indicated on USGS map):

☐ NAD 1927 or ☐ NAD 1983

1. Zone: Easting: Northing:

2. Zone: Easting: Northing:

3. Zone: Easting: Northing:

4. Zone: Easting : Northing:

Yee King Tong Cemetery  
Name of Property

Honolulu, Hawaii  
County and State

**Verbal Boundary Description** (Describe the boundaries of the property.)

The property being nominated includes all the property owned by Yee King Tong in 2023 as described by Tax Map Key (1) 2-2-013: 016, and a portion of the organization's property described by Tax Map Key (1) 2-2-014: 009 as indicated on the attached Tax Map

**Boundary Justification** (Explain why the boundaries were selected.)

These are the parcels of land associated with this cemetery since its construction.

---

**4. Form Prepared By**

name/title: Don Hibbard  
organization: self  
street & number: 45-287 Kokokahi Place  
city or town: Kaneohe state: Hawaii zip code: 96744  
e-mail: \_\_\_\_\_  
telephone: (808)-542-6230  
date: July 15, 2023

---

**Additional Documentation**

Submit the following items with the completed form:

- **Maps:** A **USGS map** or equivalent (7.5 or 15 minute series) indicating the property's location.
- **Sketch map** for historic districts and properties having large acreage or numerous resources. Key all photographs to this map.
- **Additional items:** original floor plan
- **Owner:** Steven K. Young  
1019 Maunaihi Place Apt 301  
Honolulu, Hawaii 96822

Yee King Tong Cemetery  
Name of Property

Honolulu, Hawaii  
County and State

## USGS Map



Yee King Tong Cemetery

Yee King Tong Cemetery  
Name of Property

Honolulu, Hawaii  
County and State

## Tax Map



Yee King Tong Cemetery  
Name of Property

Honolulu, Hawaii  
County and State

**Map of Proposed Roads *Star Bulletin*, December 28, 1934**

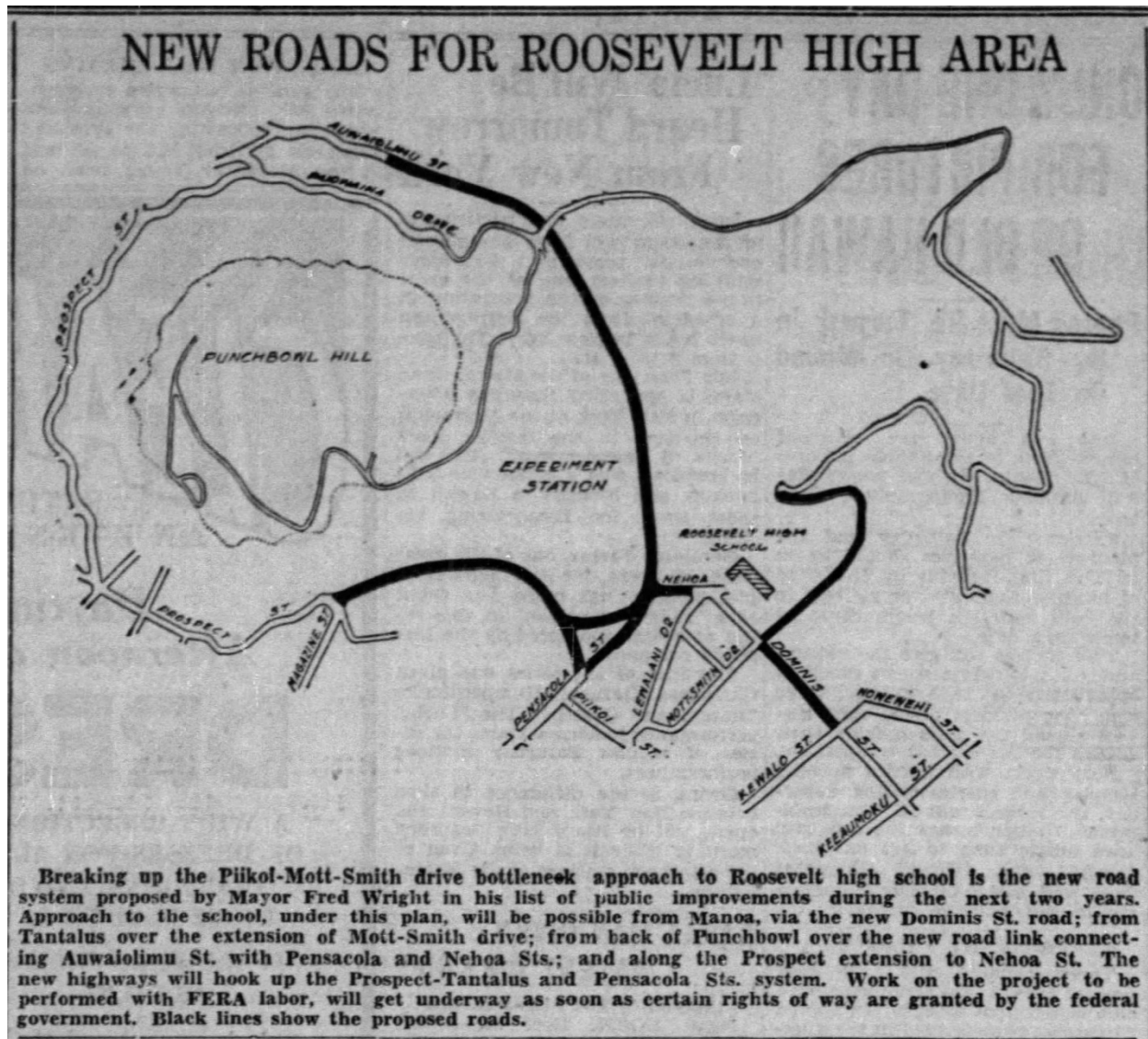



Yee King Tong Cemetery  
Name of Property

Honolulu, Hawaii  
County and State

## Grant 10348 Map Depicting Exchanged Lands

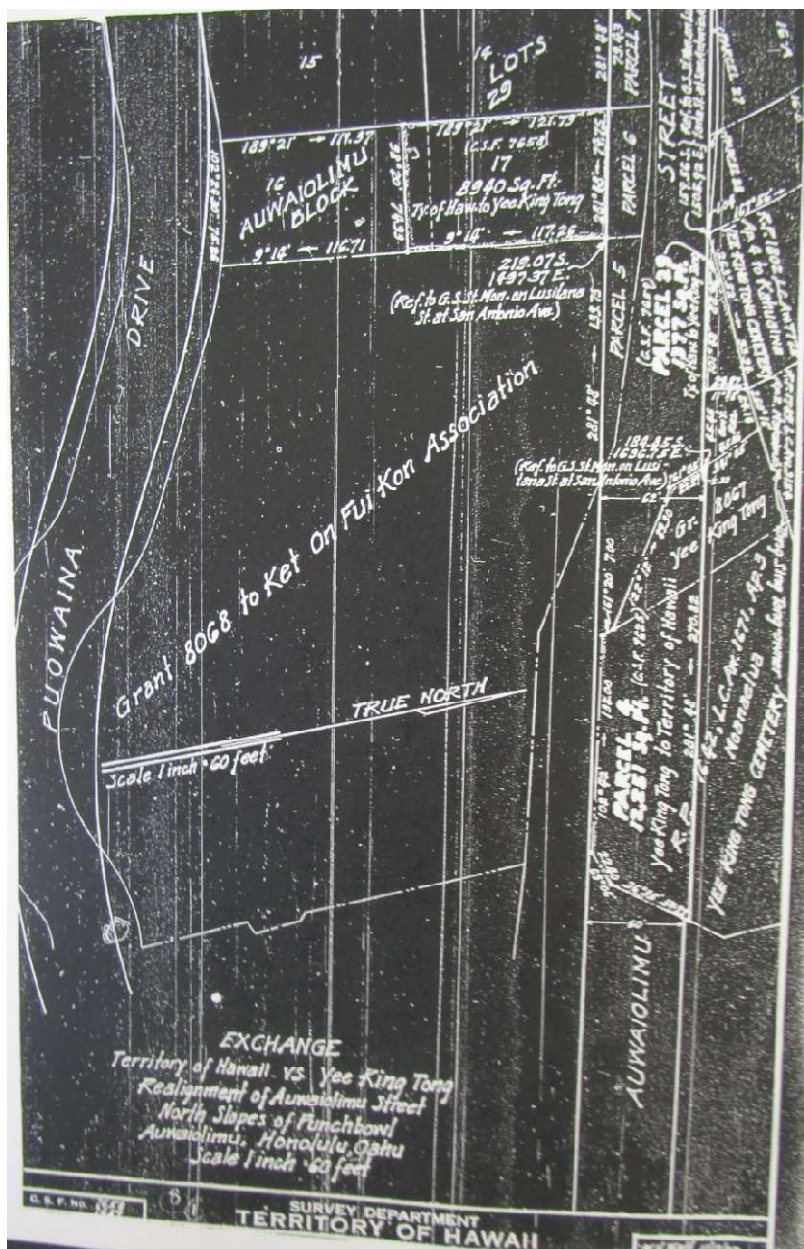



Yee King Tong Cemetery  
Name of Property

Honolulu, Hawaii  
County and State

## Photo Log

Name of Property: Yee King Tong Cemetery

City or Vicinity: Honolulu

County: Honolulu

State: Hawaii

Photographer: Kikuyo Akao

Date Photographed: June 1, 2023

View of the cemetery from the northeast

1 of 14





Yee King Tong Cemetery  
Name of Property

Honolulu, Hawaii  
County and State

## Photo Log

Name of Property: Yee King Tong Cemetery

City or Vicinity: Honolulu

County: Honolulu

State: Hawaii

Photographer: Kikuyo Akao

Date Photographed: June 1, 2023

View of the lower cemetery from the southwest

2 of 14





Yee King Tong Cemetery  
Name of Property

Honolulu, Hawaii  
County and State

## Photo Log

Name of Property: Yee King Tong Cemetery

City or Vicinity: Honolulu

County: Honolulu

State: Hawaii

Photographer: Kikuyo Akao

Date Photographed: June 1, 2023

View of the upper cemetery lot from the north

3 of 14





Yee King Tong Cemetery  
Name of Property

Honolulu, Hawaii  
County and State

## Photo Log

Name of Property: Yee King Tong Cemetery

City or Vicinity: Honolulu

County: Honolulu

State: Hawaii

Photographer: Kikuyo Akao

Date Photographed: June 1, 2023

View of the entry from the west

4 of 14





Yee King Tong Cemetery  
Name of Property

Honolulu, Hawaii  
County and State

## Photo Log

Name of Property: Yee King Tong Cemetery

City or Vicinity: Honolulu

County: Honolulu

State: Hawaii

Photographer: Kikuyo Akao

Date Photographed: June 1, 2023

Drone view of the bone house from the west

5 of 14





Yee King Tong Cemetery  
Name of Property

Honolulu, Hawaii  
County and State

## Photo Log

Name of Property: Yee King Tong Cemetery

City or Vicinity: Honolulu

County: Honolulu

State: Hawaii

Photographer: Kikuyo Akao

Date Photographed: June 1, 2023

View of the bone house from the west:

6 of 14



Yee King Tong Cemetery  
Name of Property

Honolulu, Hawaii  
County and State

### Photo Log

Name of Property: Yee King Tong Cemetery

City or Vicinity: Honolulu

County: Honolulu

State: Hawaii

Photographer: Kikuyo Akao

Date Photographed: June 1, 2023

View of the interior of the bone house from the south

7 of 14





Yee King Tong Cemetery  
Name of Property

Honolulu, Hawaii  
County and State

## Photo Log

Name of Property: Yee King Tong Cemetery

City or Vicinity: Honolulu

County: Honolulu

State: Hawaii

Photographer: Kikuyo Akao

Date Photographed: June 1, 2023

View of the cemetery from the southwest

8 of 14





Yee King Tong Cemetery  
Name of Property

Honolulu, Hawaii  
County and State

## Photo Log

Name of Property: Yee King Tong Cemetery

City or Vicinity: Honolulu

County: Honolulu

State: Hawaii

Photographer: Kikuyo Akao

Date Photographed: June 1, 2023

View of the cemetery headstones from the north

9 of 14



Yee King Tong Cemetery  
Name of Property

Honolulu, Hawaii  
County and State

### Photo Log

Name of Property: Yee King Tong Cemetery

City or Vicinity: Honolulu

County: Honolulu

State: Hawaii

Photographer: Kikuyo Akao

Date Photographed: June 1, 2023

View of headstone from the north

10 of 14





Yee King Tong Cemetery  
Name of Property

Honolulu, Hawaii  
County and State

## Photo Log

Name of Property: Yee King Tong Cemetery

City or Vicinity: Honolulu

County: Honolulu

State: Hawaii

Photographer: Kikuyo Akao

Date Photographed: June 1, 2023

View of the upper cemetery from the north

11 of 14



Yee King Tong Cemetery  
Name of Property

Honolulu, Hawaii  
County and State

## Photo Log

Name of Property: Yee King Tong Cemetery

City or Vicinity: Honolulu

County: Honolulu

State: Hawaii

Photographer: Kikuyo Akao

Date Photographed: June 1, 2023

View of the steps to upper cemetery from the north

12 of 14





Yee King Tong Cemetery  
Name of Property

Honolulu, Hawaii  
County and State

## Photo Log

Name of Property: Charles E. Meyer Residence

City or Vicinity: Honolulu

County: Honolulu

State: Hawaii

Photographer: Kikuyo Akao

Date Photographed: March 8, 2023

View of the upper cemetery from the northeast

13 of 14



Yee King Tong Cemetery  
Name of Property

Honolulu, Hawaii  
County and State

## Photo Log

Name of Property: Charles E. Meyer Residence

City or Vicinity: Honolulu

County: Honolulu

State: Hawaii

Photographer: Kikuyo Akao

Date Photographed: March 8, 2023

View of the upper cemetery from the south

14 of 14





Yee King Tong Cemetery  
Name of Property

Honolulu, Hawaii  
County and State

**Paperwork Reduction Act Statement:** This information is being collected for nominations to the National Register of Historic Places to nominate properties for listing or determine eligibility for listing, to list properties, and to amend existing listings. Response to this request is required to obtain a benefit in accordance with the National Historic Preservation Act, as amended (16 U.S.C.460 et seq.). We may not conduct or sponsor and you are not required to respond to a collection of information unless it displays a currently valid OMB control number.

**Estimated Burden Statement:** Public reporting burden for each response using this form is estimated to be between the Tier 1 and Tier 4 levels with the estimate of the time for each tier as follows:

Tier 1 – 60-100 hours  
Tier 2 – 120 hours  
Tier 3 – 230 hours  
Tier 4 – 280 hours

The above estimates include time for reviewing instructions, gathering and maintaining data, and preparing and transmitting nominations. Send comments regarding these estimates or any other aspect of the requirement(s) to the Service Information Collection Clearance Officer, National Park Service, 1201 Oakridge Drive Fort Collins, CO 80525.