

DAVID Y. IGE  
GOVERNOR



STATE OF HAWAII  
DEPARTMENT OF TRANSPORTATION  
869 PUNCHBOWL STREET  
HONOLULU, HAWAII 96813-5097

FORD N. FUCHIGAMI  
DIRECTOR

Deputy Directors  
JADE T. BUTAY  
ROSS M. HIGASHI  
EDWIN H. SNIFFEN  
DARRELL T. YOUNG

IN REPLY REFER TO:

Board of Land and  
Natural Resources  
State of Hawaii  
Honolulu, Hawaii

ISSUANCE OF A REVOCABLE PERMIT FOR SPACES IN THE  
MAIN TERMINAL FOR STORAGE AND CHECK-IN DESK FOR PORTER SERVICE  
S A S SERVICES GROUP, INC.

LĪHU'E AIRPORT

KAUA'I

TAX MAP KEY: (4) 3-5-01: PORTION OF 8

REQUEST:

Issuance of a revocable permit to S A S Services Group, Inc. (SAS), for spaces in the Main Terminal for storage and check-in desk for porter service at Līhu'e Airport.

LEGAL REFERENCE:

Sections 171-11 and 171-55, Hawai'i Revised Statutes

APPLICANT:

SAS, whose business address is 8939 S. Sepulveda Blvd., Los Angeles, California 90045

LOCATION AND TAX MAP KEY:

Portion of Līhu'e Airport, Līhu'e, Island of Kaua'i, identified by  
Tax Map Key: 4<sup>th</sup> Division, 3-5-01: Portion of 8

AREA:

Bldg/Room No. 306-252, containing a total area of approximately 204 square feet,  
Bldg/Room No. 306-241A, containing a total area of approximately 22 square feet, and  
Bldg/Room No. 306-274, containing a total area of approximately 21 square feet, as  
shown on the attached Exhibit A.

**ITEM M-11**

BLNR – ISSUANCE OF A REVOCABLE PERMIT FOR SPACES IN THE MAIN TERMINAL  
FOR STORAGE AND CHECK-IN DESK FOR PORTER SERVICE  
S A S SERVICES GROUP, INC.

Page 2

ZONING:

State Land Use District: Urban  
County of Kaua'i: Industrial (IG-STP)

LAND TITLE STATUS:

Section 5(a) lands of the Hawai'i Admission Act: Non-Ceded  
DHHL 30% entitlement lands pursuant to Hawai'i Admission Act YES \_\_\_\_\_ NO X

CURRENT USE STATUS:

Airport and aeronautical purposes

CHARACTER OF USE:

Storage and check-in desk for porter service

COMMENCEMENT DATE:

To be determined by the Director upon complete execution of the revocable permit.

MONTHLY RENTAL:

\$ 509.65 (as determined from the DOTA schedule of rates and charges established by appraisal of Airports property statewide)

SECURITY DEPOSIT:

\$ 1,528.95 (three times the monthly rental)

HOLDOVER TENANCY:

\$ 17.00

DCCA VERIFICATION:

Place of business registration confirmed: YES X NO \_\_\_\_\_  
Registered business name confirmed: YES X NO \_\_\_\_\_  
Good standing confirmed: YES X NO \_\_\_\_\_

BLNR – ISSUANCE OF A REVOCABLE PERMIT FOR SPACES IN THE MAIN TERMINAL  
FOR STORAGE AND CHECK-IN DESK FOR PORTER SERVICE  
S A S SERVICES GROUP, INC.

Page 3

REMARKS:

The Department of Transportation (DOT) has no objections to SAS's request and therefore, in accordance with Sections 171-11 and 171-55, HRS, relating to Public Purposes and Permits, respectively, and therefore, the DOT proposes to issue a month-to-month revocable permit to SAS for spaces in the Main Terminal at LIH.

RECOMMENDATION:

That the Board authorize the Department of Transportation to issue a month-to-month revocable permit to SAS, subject to: (1) terms and conditions herein outlined, which are by reference incorporated herein; and (2) such additional terms and conditions as may be prescribed by the Director of Transportation to best serve the interests of the State.

Respectfully submitted,

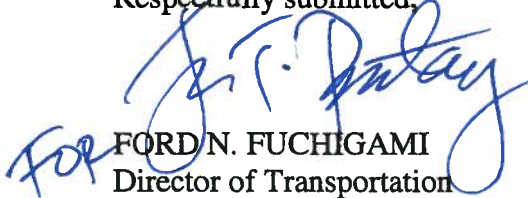
  
FORD N. FUCHIGAMI  
Director of Transportation

APPROVED FOR SUBMITTAL:

  
SUZANNE D. CASE  
Chairperson and Member

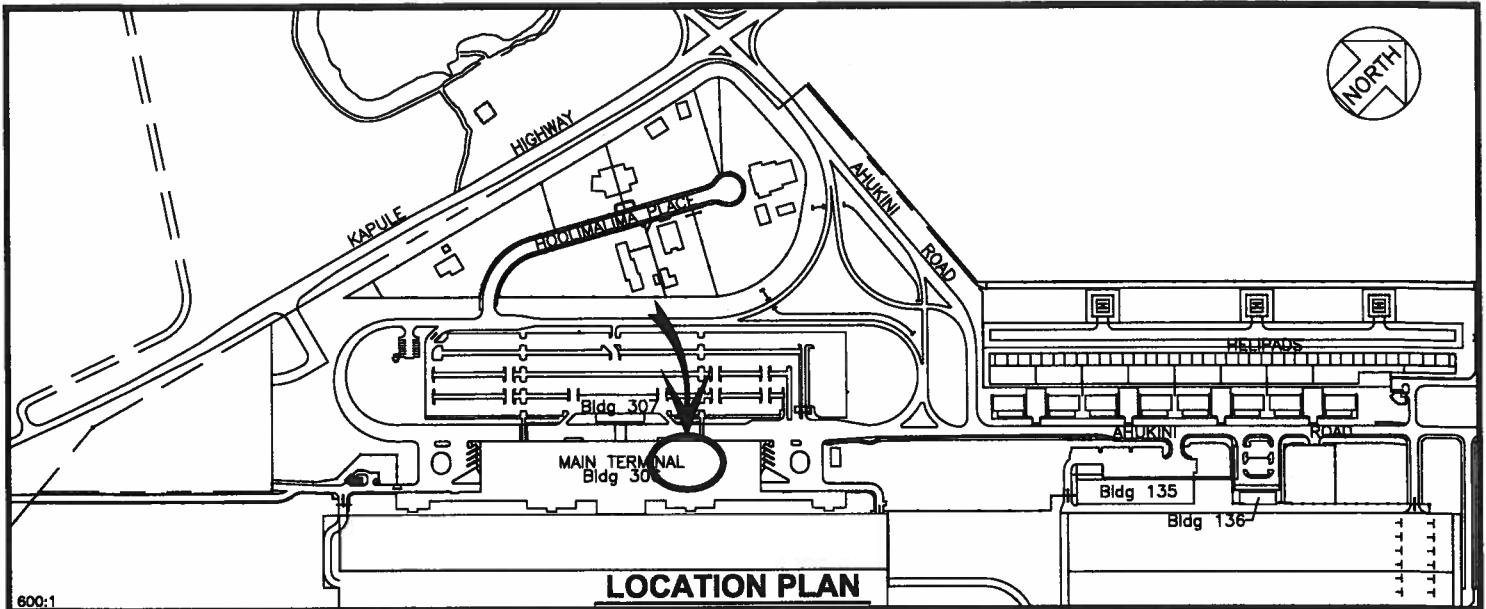

600:1

**LOCATION PLAN**

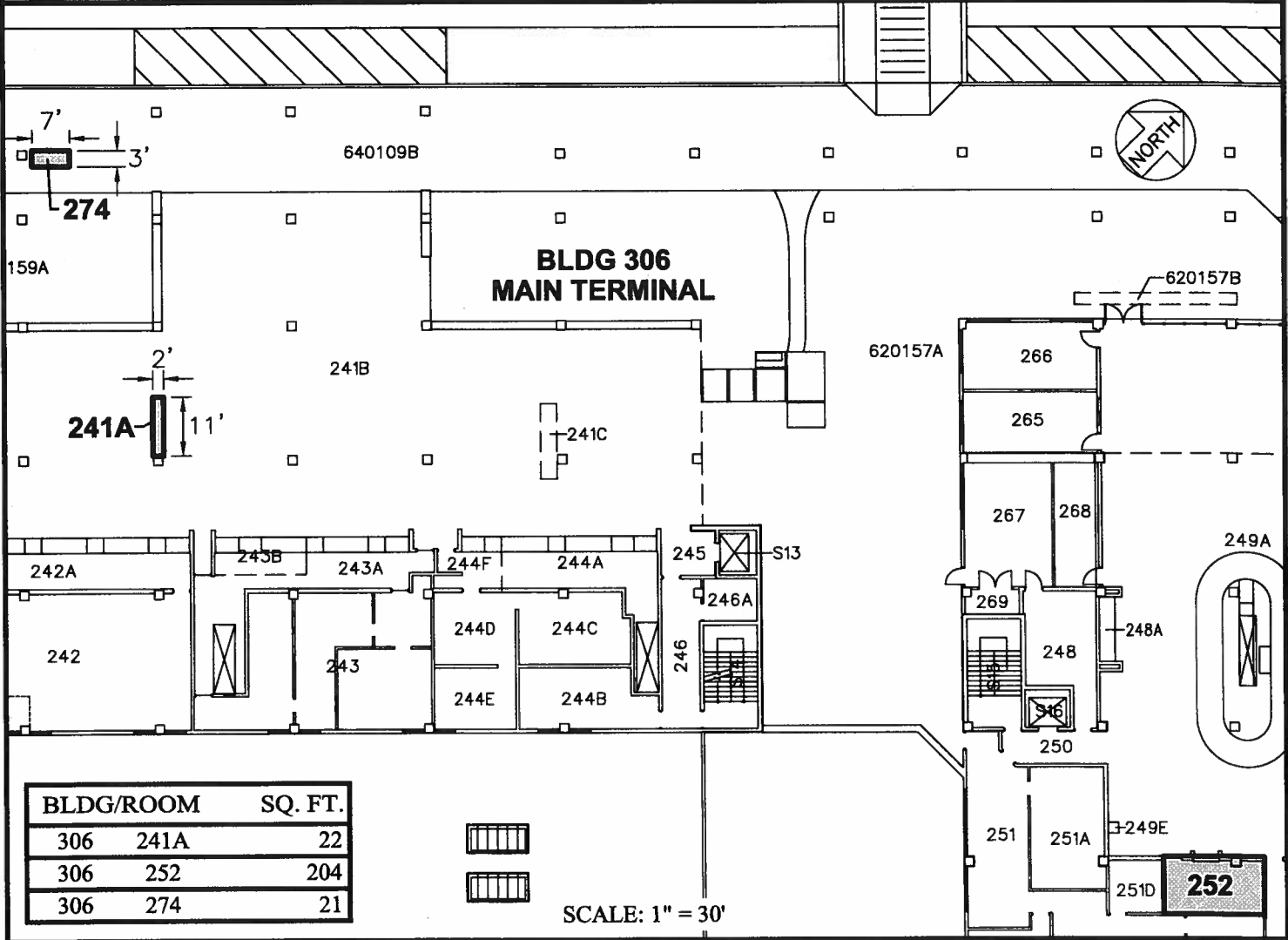

BLDG/ROOM	SQ. FT.
306 241A	22
306 252	204
306 274	21

SCALE: 1" = 30'

RP-8545	DATE : MAY 2016	EXHIBIT: <b>A</b>	
 Airports Division	<b>S.A.S. SERVICES GROUP, INC.</b>	<b>BUILDING 306 MAIN TERMINAL TERMINAL LEVEL</b>	<b>306241A 306252 306274 PLATS C2, D2, 45</b>

**LIHUE AIRPORT**