



STATE OF HAWAII
DEPARTMENT OF TRANSPORTATION
869 PUNCHBOWL STREET
HONOLULU, HAWAII 96813-5097

Board of Land and
Natural Resources
State of Hawai'i
Honolulu, Hawai'i

ISSUANCE OF A REVOCABLE PERMIT
FOR A TEMPORARY WIRELESS COMMUNICATIONS SITE
CELLCO PARTNERSHIP DBA VERIZON WIRELESS
HONOLULU INTERNATIONAL AIRPORT
TAX MAP KEY: (1) 1-1-003: 001 (PORTION)

O'AHU

APPLICANT:

Cellco Partnership dba Verizon Wireless (Verizon), whose mailing address is
3375 Koapaka Street, Suite D185, Honolulu, Hawai'i 96819.

LEGAL REFERENCE:

Section 171-55, Hawai'i Revised Statutes

LOCATION:

Portions of Honolulu International Airport, Island of O'ahu, State of Hawai'i, identified
by Tax Map Key: 1st Division, 1-1-003: 001 (Portion)

AREAS:

Space No. 611-413A, containing an area of approximately 160 square feet,
Space No. 611-413B, containing an area of approximately 165 square feet,
Space No. 611-413C, containing an area of approximately 165 square feet,
Space No. 355-157, containing an area of approximately 76 square feet,
Antenna & RHH 1, containing an area of approximately 29 square feet, and
Antenna & RHH 2, containing an area of approximately 29 square feet;
as shown and delineated on the attached map labeled Exhibits A, B & C.

ZONING:

State Land Use District: Urban
City and County of Honolulu LUO: Industrial (I-2)

BLNR – ISSUANCE OF A REVOCABLE PERMIT FOR A TEMPORARY WIRELESS COMMUNICATIONS SITE -CELLCO PARTNERSHIP DBA VERIZON WIRELESS
Page 2

LAND TITLE STATUS:

Section 5(a) lands of the Hawai‘i Admission Act: Ceded & Non-Ceded
DHHL 30% entitlement lands pursuant to Hawai‘i Admission Act YES ___ NO X

CURRENT USE STATUS:

Land presently encumbered by Governor’s Executive Order No. 3201, dated June 8, 1983, setting aside 3,152.177 acres designated as Honolulu International Airport under the control and management of the State of Hawai‘i, Department of Transportation, Airports Division for Airport Purposes.

CHARACTER OF USE:

Verizon will use the space for a temporary wireless communications site.

COMMENCEMENT DATE:

To be determined by the Director of Transportation at a later date.

MONTHLY RENTAL:

\$2,023.20 (\$1,123.20, as determined from the DOTA schedule of rates and charges established by appraisal of Airports property statewide plus \$900.00 for electricity)

SECURITY DEPOSIT:

Three (3) times the monthly rental in effect

DCCA VERIFICATION:

Place of business registration confirmed:	YES <u>X</u>	NO ___
Registered business name confirmed:	YES <u>X</u>	NO ___
Good standing confirmed:	YES <u>X</u>	NO ___

CHAPTER 343, HRS - ENVIRONMENTAL ASSESSMENT:

Pursuant to Section 11-200-8(a), Environmental Impact Statement Rules of the Department of Health, State of Hawai‘i, this disposition is exempt from requirements regarding preparation of an environmental assessment, negative declaration, or environmental impact statement as required by Chapter 343, Hawai‘i Revised Statutes, as amended, relating to Environmental Impact Statements, because the proposed action falls within Exemption Class #1, Comprehensive Exemption List for the State of Hawai‘i, Department of Transportation, dated November 15, 2000, as approved by the

BLNR – ISSUANCE OF A REVOCABLE PERMIT FOR A TEMPORARY WIRELESS COMMUNICATIONS SITE -CELLCO PARTNERSHIP DBA VERIZON WIRELESS
Page 3

Environmental Quality Council. Exemption Class #1 covers operations, repairs, or maintenance of existing structures, facilities, equipment, or topographical features involving negligible or no expansion or change of use beyond that previously existing.

REMARKS:

Verizon plans to lease space on a month-to-month revocable permit for a temporary wireless communications site at Honolulu International Airport.

RECOMMENDATION:

That the Board authorize the Department of Transportation to issue a month-to-month revocable permit to Verizon subject to: (1) terms and conditions herein outlined, which are by reference incorporated herein; and (2) such additional terms and conditions as may be prescribed by the Director of Transportation to best serve the interests of the State.

Respectfully submitted,



FORD N. FUCHIGAMI
Director of Transportation

APPROVED FOR SUBMITTAL:



SUZANNE D. CASE
Chairperson and Member

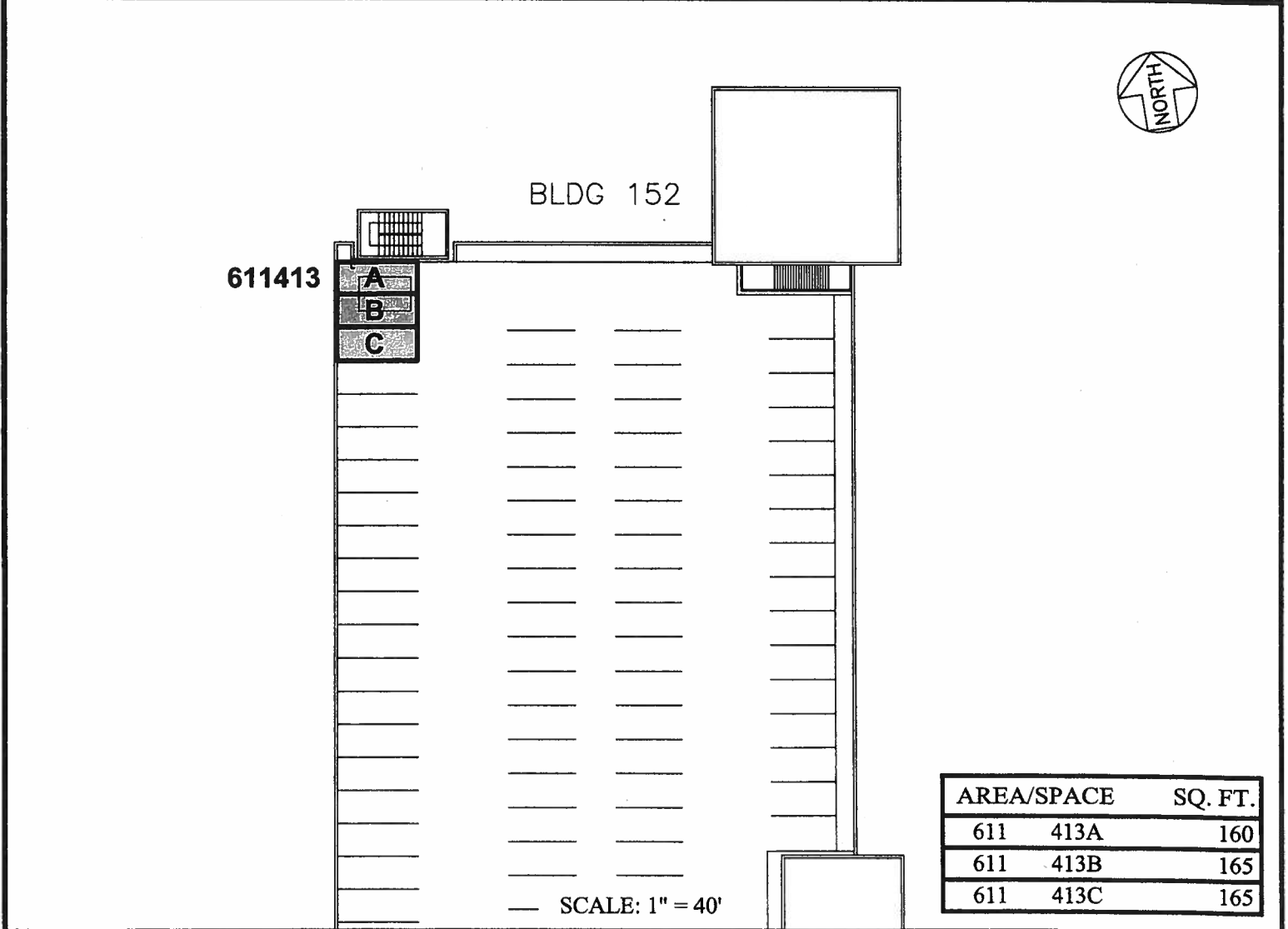
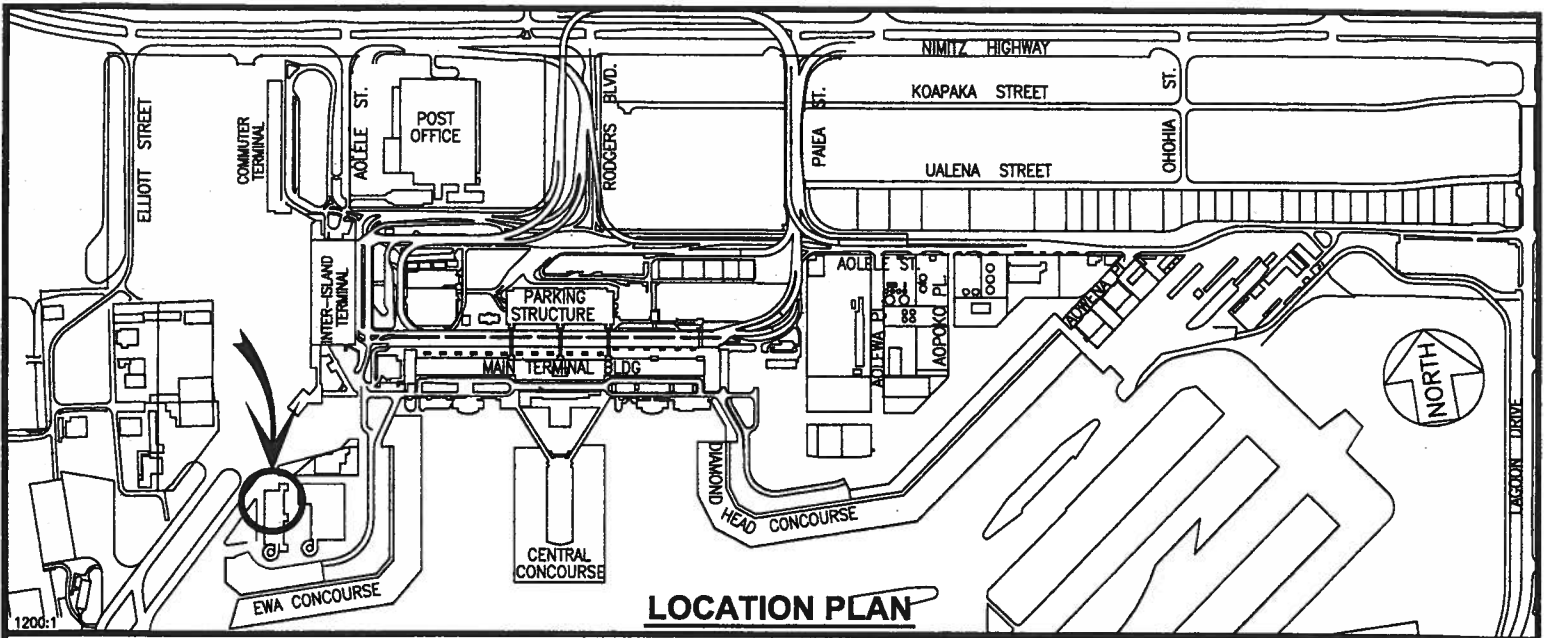

AREA/SPACE	SQ. FT.
611 413A	160
611 413B	165
611 413C	165

SCALE: 1" = 40'

DATE : MARCH 2016

EXHIBIT: **A-1**



VERIZON WIRELESS

**PARKING FACILITIES
AIRLINE CARGO BUILDING
FOURTH LEVEL**

**611413A-C
PLAT F1**

HONOLULU INTERNATIONAL AIRPORT

N:\AIRPORTS\HNL_HONOLULU\CAD\PM\HNL_611413A-01.DWG

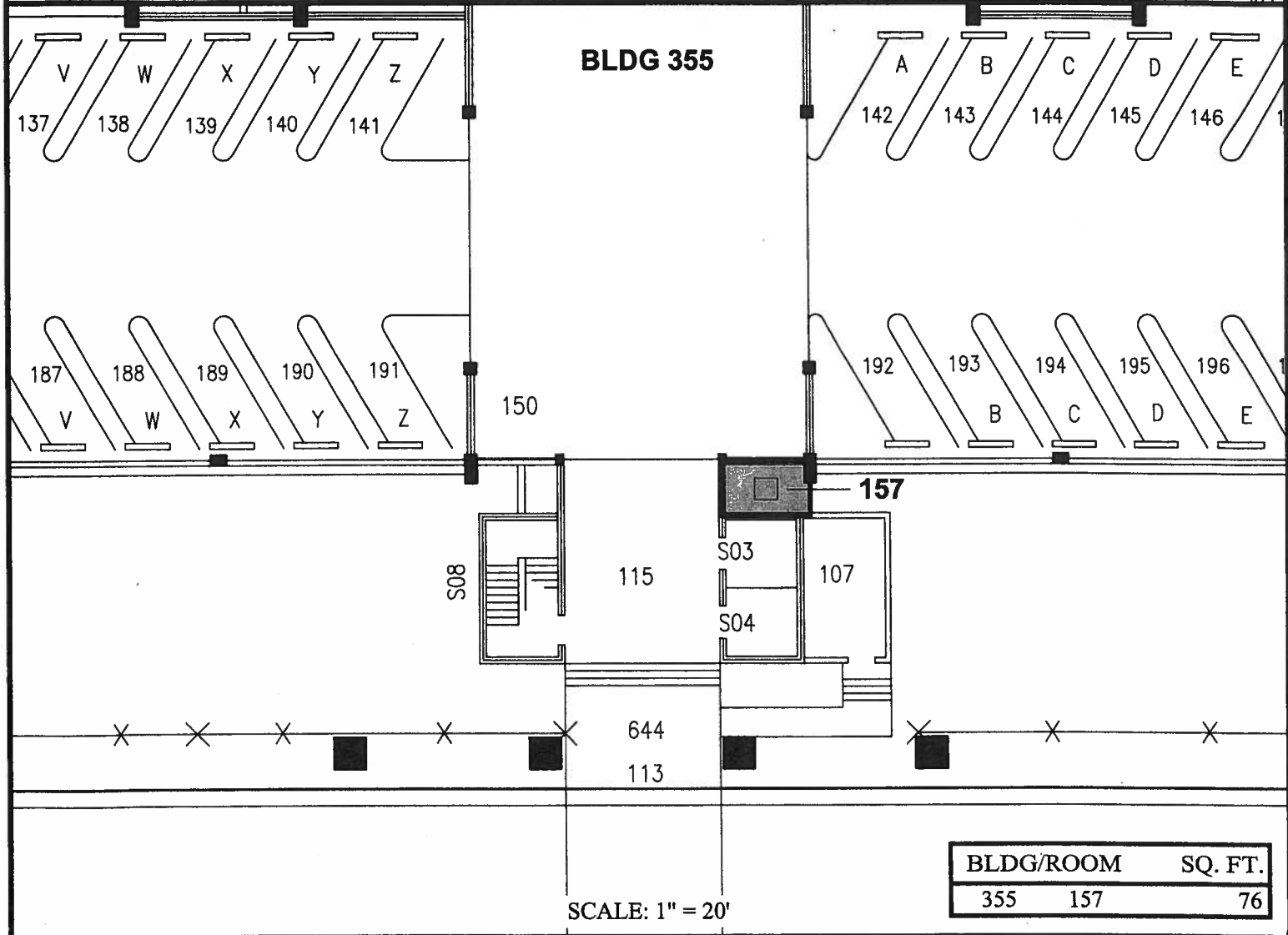
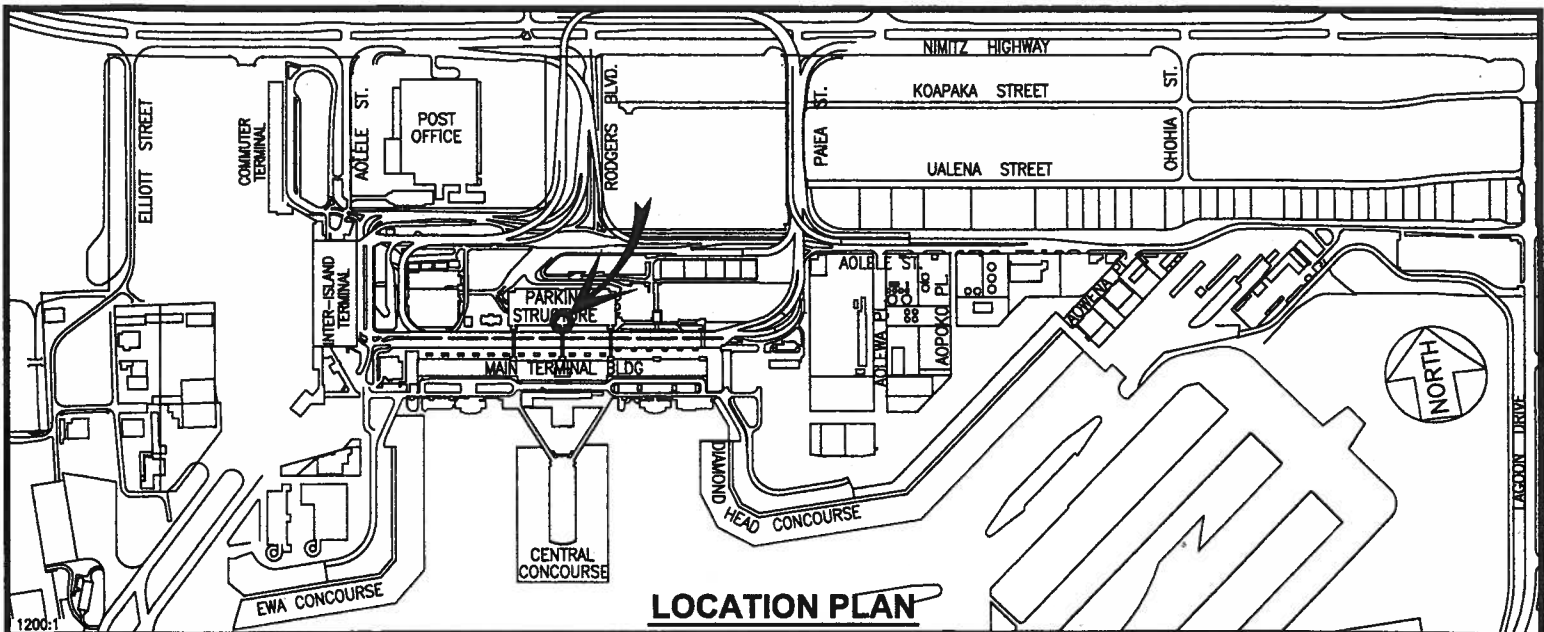

DATE : MARCH 2016

EXHIBIT: **A-2**



Airports Division

VERIZON WIRELESS

**BUILDING 355
OST PARKING GARAGE
GROUND LEVEL**

355157

PLAT A1

HONOLULU INTERNATIONAL AIRPORT

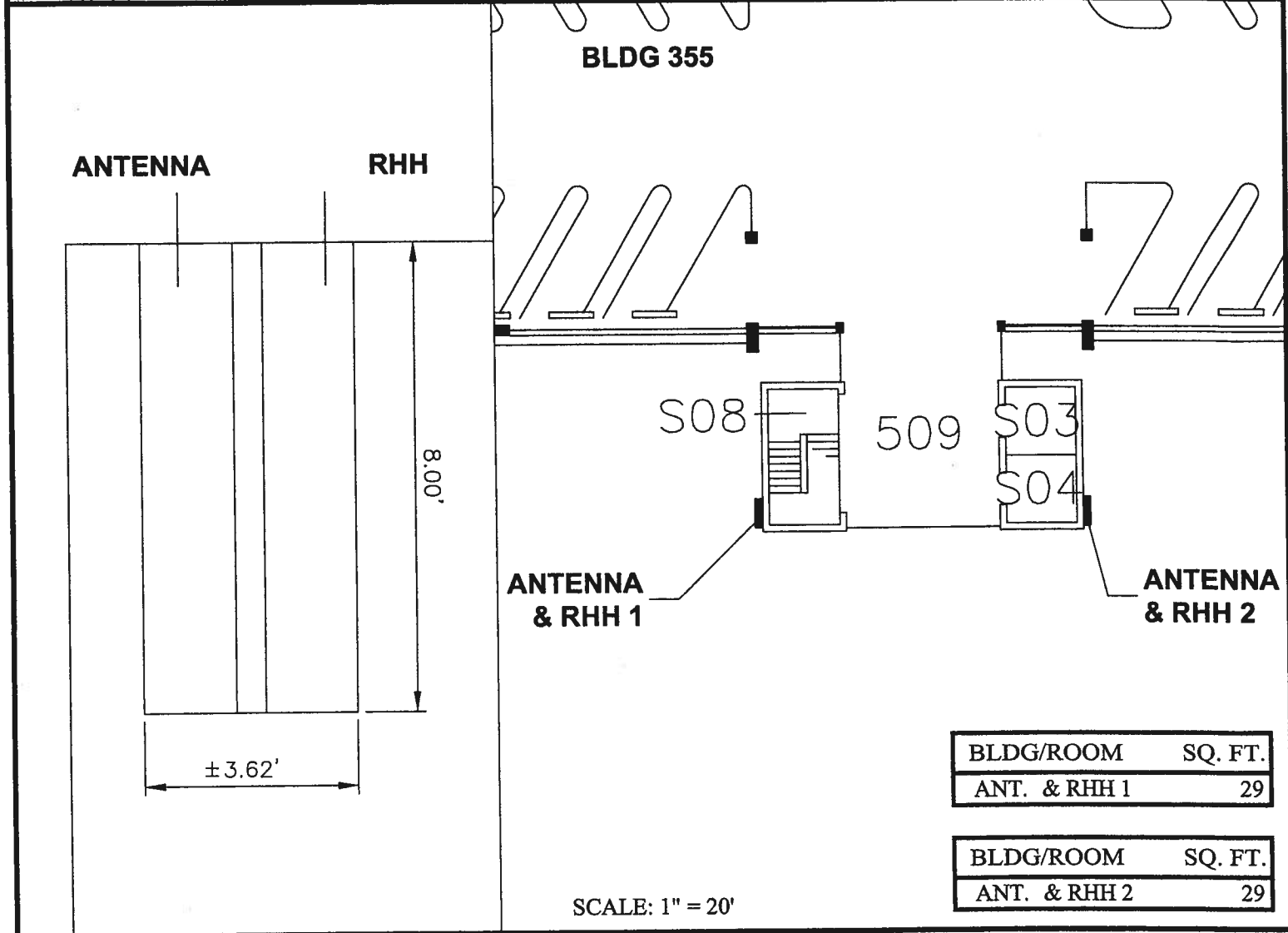
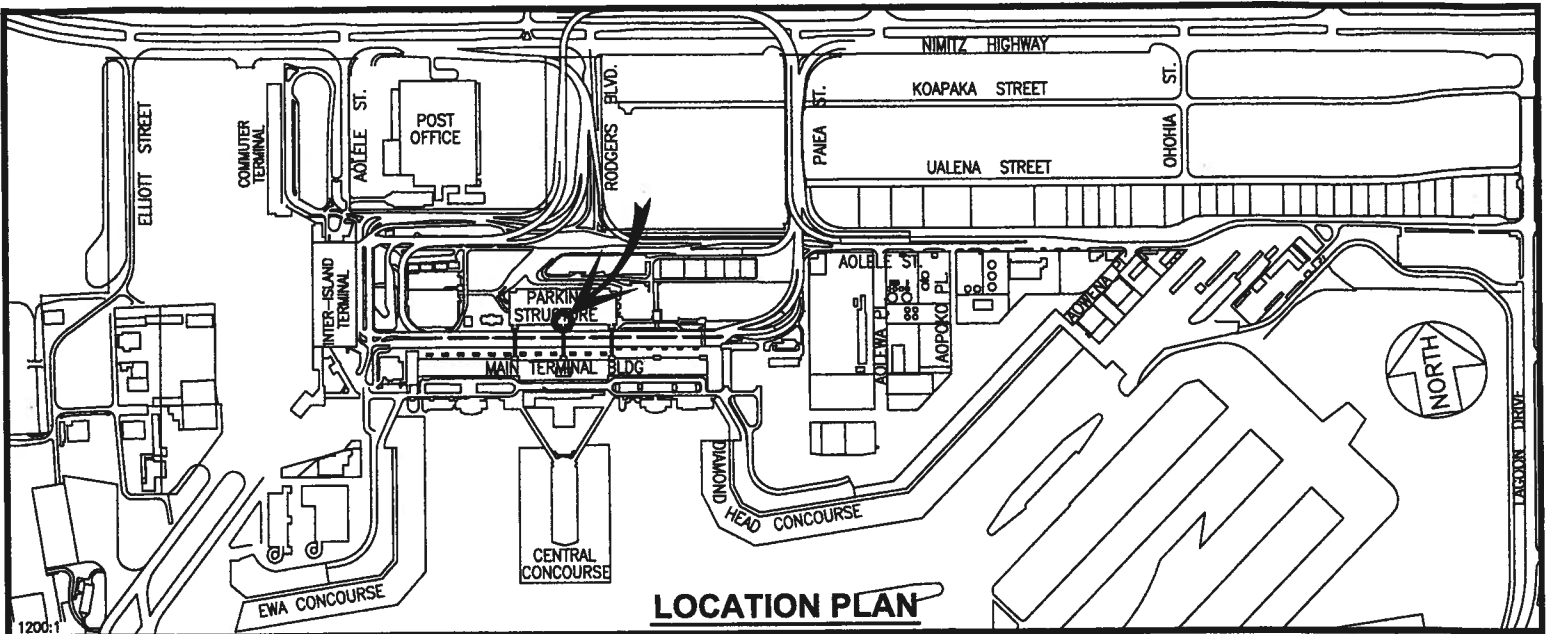

DATE : MARCH 2016

EXHIBIT: **A-3**



VERIZON WIRELESS

BUILDING 355
OST PARKING GARAGE
FIFTH LEVEL

ANTENNA
& RHH
PLAT A1