

DAVID Y. IGE  
GOVERNOR



STATE OF HAWAII  
DEPARTMENT OF TRANSPORTATION  
869 PUNCHBOWL STREET  
HONOLULU, HAWAII 96813-5097

FORD N. FUCHIGAMI  
DIRECTOR

Deputy Directors  
JADE T. BUTAY  
ROSS M. HIGASHI  
EDWIN H. SNIFFEN  
DARRELL T. YOUNG

IN REPLY REFER TO:

Board of Land and  
Natural Resources  
State of Hawai'i  
Honolulu, Hawai'i

AMEND PRIOR BOARD ACTION OF APRIL 8, 2016, ITEM M-10  
REPLACE SPACE NO. 410-106 WITH SPACE NO. 411-106  
ISSUANCE OF A REVOCABLE PERMIT  
CIVIL AIR PATROL  
LIHU'E AIRPORT  
TAX MAP KEY: (4) 3-5-01: PORTION OF 8

KAUAI

On April 8, 2016, under agenda Item M-10, the Land Board authorized the Department of Transportation (DOT) to issue a revocable permit (RP) to Civil Air Patrol (CAP), for the use Area/Space No. 410-106, for storage and maintenance of aircraft at Līhu'e Airport (LIH), Island of Kaua'i

REQUEST:

CAP requests to amend the RP by replacing Space No. 410-106 to Space No. 411-106 to provide services that directly benefit airport operators and safety.

AREAS:

Original: Area/Space No. 410-106, containing an area of approximately 1,080 square feet, as shown and delineated on the attached Exhibit A, dated February 2016.

As Amended: Area/Space No. 411-106, containing land area of approximately 1,080 square feet, as shown and delineated on the attached Exhibit B, dated May 2016.

REMARKS:

The DOT has no objections to CAP's request because the location of the land now requested would better suit the needs and operations of LIH in accordance with Section 171-59, HRS, as amended, relating generally to the Management and Disposition of Public Lands, and relating specifically to Disposition by Negotiation. All other terms of the Lease remain unchanged.

**ITEM M-9**

BLNR – AMEND PRIOR BOARD ACTION OF APRIL 8, 2016, ITEM M-10  
REPLACE SPACE NO. 410-106 WITH SPACE NO. 411-106  
CIVIL AIR PATROL  
Page 2

RECOMMENDATION:

That the Board authorize the Department of Transportation to issue an RP to CAP subject to: (1) terms and conditions herein outlined, which are by reference incorporated herein; (2) such other terms and conditions as may be prescribed by the Director of Transportation to best serve the interests of the State; and, (3) review and approval of the Department of the Attorney General as to the lease form and content.

Respectfully submitted,

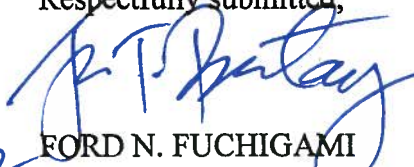
  
For FORD N. FUCHIGAMI  
Director of Transportation

APPROVED FOR SUBMITTAL:

  
SUZANNE D. CASE  
Chairperson and Member

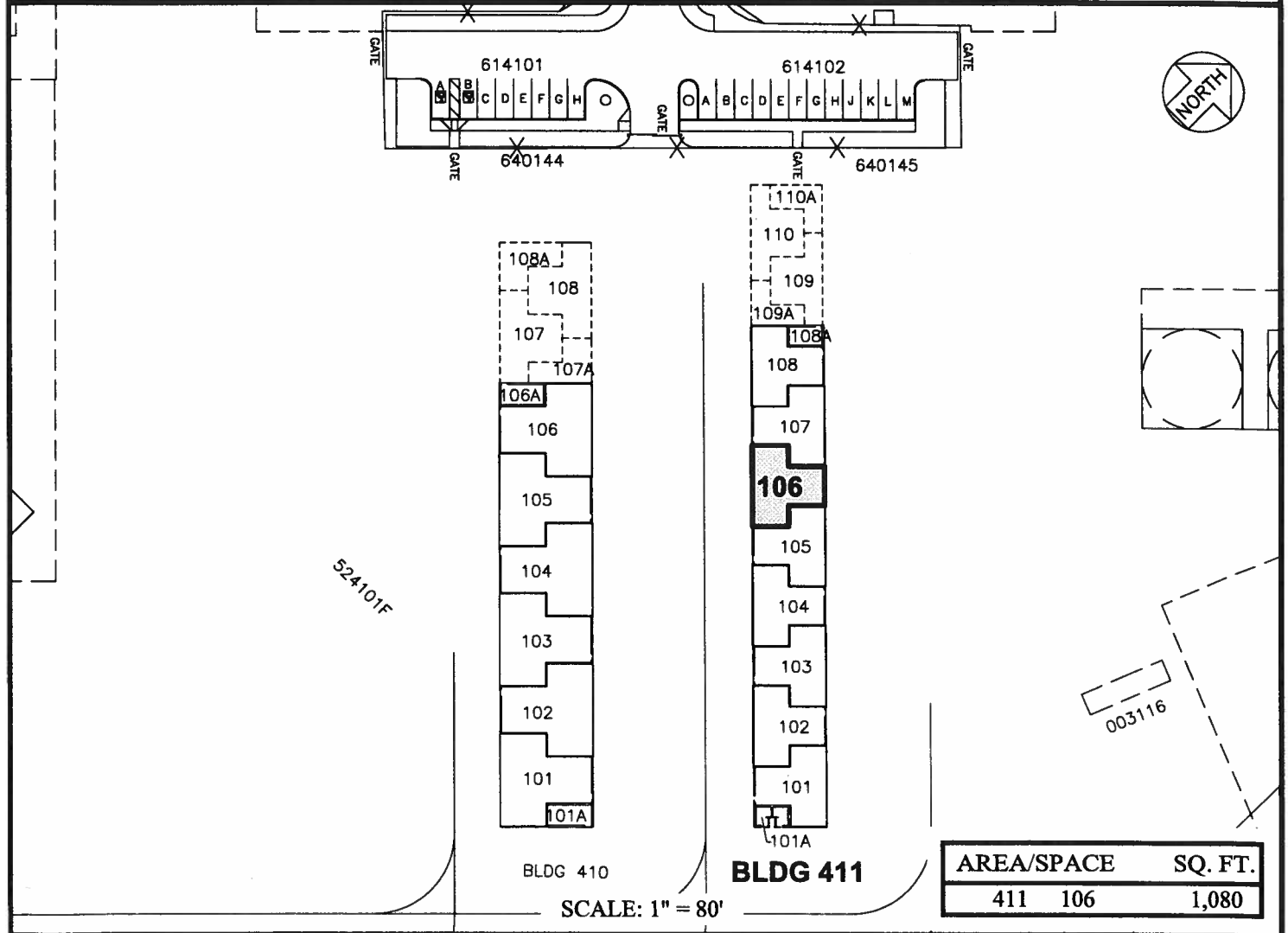
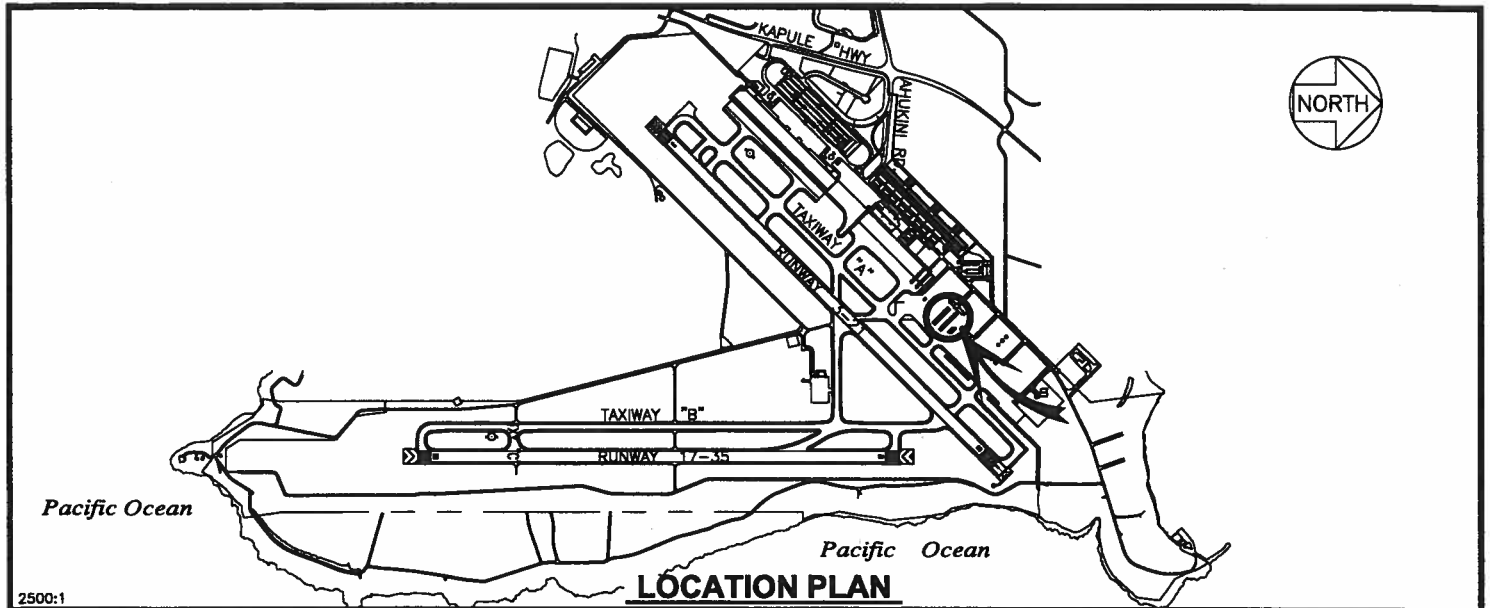

RP-8504      DATE : MAY 2016      EXHIBIT: **A**



**CIVIL AIR PATROL**

**BUILDING 411  
T-HANGAR  
GROUND LEVEL**

411106  
PLATS E1, 35

**LIHUE AIRPORT**

N:\AIRPORTS\LIH\_Lihue\CAD\PM\lth\_411106-01.dwg

DAVID Y. IGE  
GOVERNOR

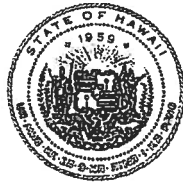

STATE OF HAWAII  
DEPARTMENT OF TRANSPORTATION  
869 PUNCHBOWL STREET  
HONOLULU, HAWAII 96813-5097

APR 8 2016

FORD N. FUCHIGAMI  
DIRECTOR

Deputy Directors  
JADE T. BUTAY  
ROSS M. HIGASHI  
EDWIN H. SNIFFEN  
DARRELL T. YOUNG

IN REPLY REFER TO:

Board of Land and  
Natural Resources  
State of Hawai'i  
Honolulu, Hawai'i

ISSUANCE OF A REVOCABLE PERMIT FOR A T-HANGAR  
FOR STORAGE AND MAINTENANCE OF AIRCRAFT  
CIVIL AIR PATROL  
LIHU'E AIRPORT  
TAX MAP KEY: (4) 3-5-01: PORTION OF 8

KAUAI

REQUEST:

Issuance of a revocable permit for a T-hangar to Civil Air Patrol (CAP), at Līhu'e Airport (LIH)

LEGAL REFERENCE:

Sections 171-55, Hawai'i Revised Statutes

APPLICANT:

CAP, whose business address is P.O. Box 3110, Līhu'e, Hawai'i 96766

LOCATION AND TAX MAP KEY:

Portion of Līhu'e Airport, Līhu'e, Island of Kaua'i, identified by  
Tax Map Key: 4<sup>th</sup> Division, 3-5-01: Portion of 8

AREA:

Area/Space No. 410-106 containing an area of approximately 1,080 square feet,  
as shown and delineated on the attached Exhibit "A".

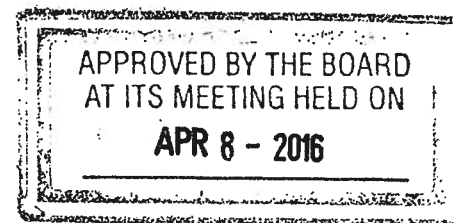

ITEM M-10

BLNR – ISSUANCE OF A REVOCABLE PERMIT FOR A T-HANGAR  
FOR STORAGE AND MAINTENANCE OF AIRCRAFT  
CIVIL AIR PATROL

Page 2

ZONING:

State Land Use District:  
County of Kaua'i,:

Urban  
Industrial (IG-STP)

LAND TITLE STATUS:

Section 5(a) lands of the Hawai'i Admission Act: Non-Ceded  
DHHL 30% entitlement lands pursuant to Hawai'i Admission Act YES \_\_\_\_\_ NO X

CURRENT USE STATUS:

Airport and aeronautical purposes

CHARACTER OF USE:

T-Hangar for storage and maintenance of aircraft

COMMENCEMENT DATE:

To be determined by the Director upon complete execution of the revocable permit.

MONTHLY RENTAL AND SECURITY DEPOSIT:

N/A

DCCA VERIFICATION:

N/A

REMARKS:

The issuance of a revocable permit to CAP at LIH complies with Chapter 343, Exemption Class 1.D.10 as a continuing aeronautical use, and is in accordance with Section 171-55 HRS, relating to Permits.

The State of Hawaii, Department of Transportation (HDOT) is obligated under the USFAA Grant Assurance to furnish, without cost to the CAP, sites that generally provide services that directly benefit airport operators and safety. Because the CAP provides by aerial warning and post-hurricane damage assessment, along with assisting in staffing the State and County Emergency Operating Centers across Hawaii, the HDOT has no

BLNR – ISSUANCE OF A REVOCABLE PERMIT FOR A T-HANGAR  
FOR STORAGE AND MAINTENANCE OF AIRCRAFT  
CIVIL AIR PATROL  
Page 3

objections to CAP's request, and therefore, the DOT proposes to issue a month-to-month revocable permit to CAP for Area/Space No. 410-106 for a T-Hangar for storage and maintenance of aircraft located at LIH.

RECOMMENDATION:

That the Board authorize the Department of Transportation to issue a month-to-month revocable permit to CAP, subject to: (1) terms and conditions herein outlined, which are by reference incorporated herein; and (2) such additional terms and conditions as may be prescribed by the Director of Transportation to best serve the interests of the State.

Respectfully submitted,



FORD N. FUCHIGAMI  
Director of Transportation

APPROVED FOR SUBMITTAL:

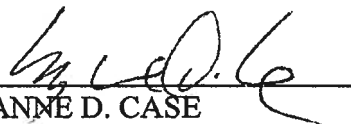
  
\_\_\_\_\_  
SUZANNE D. CASE  
Chairperson and Member

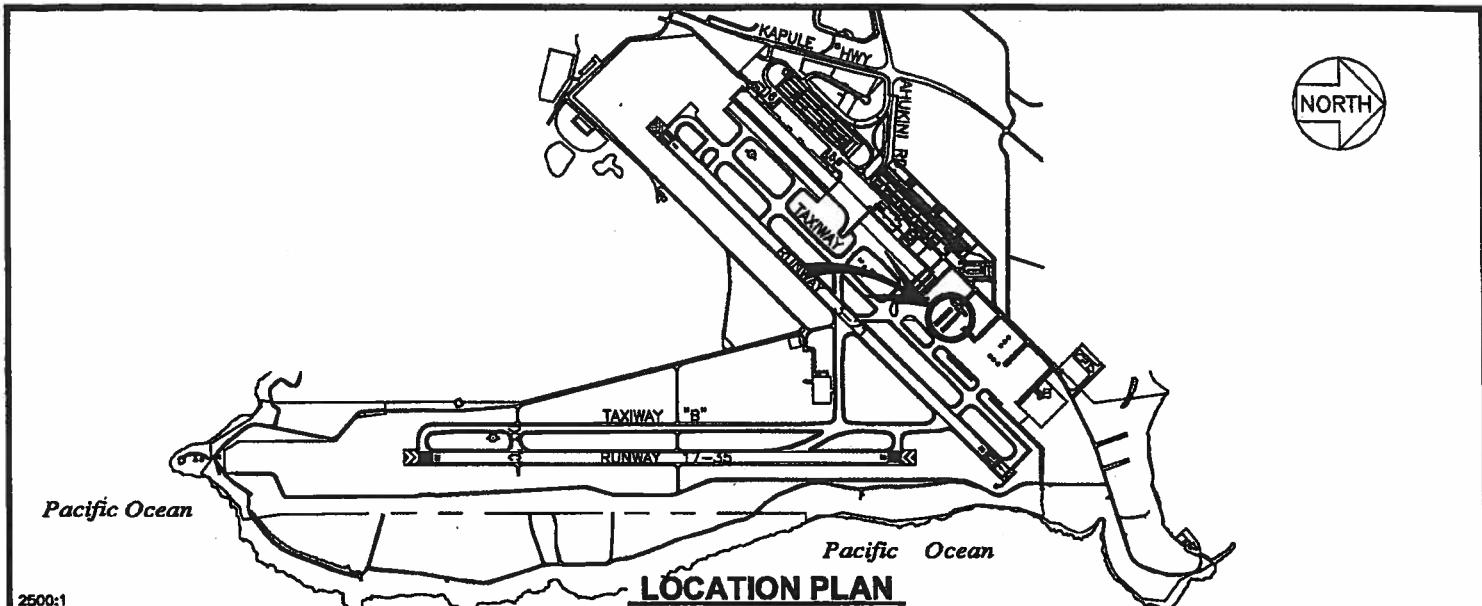

2500:1

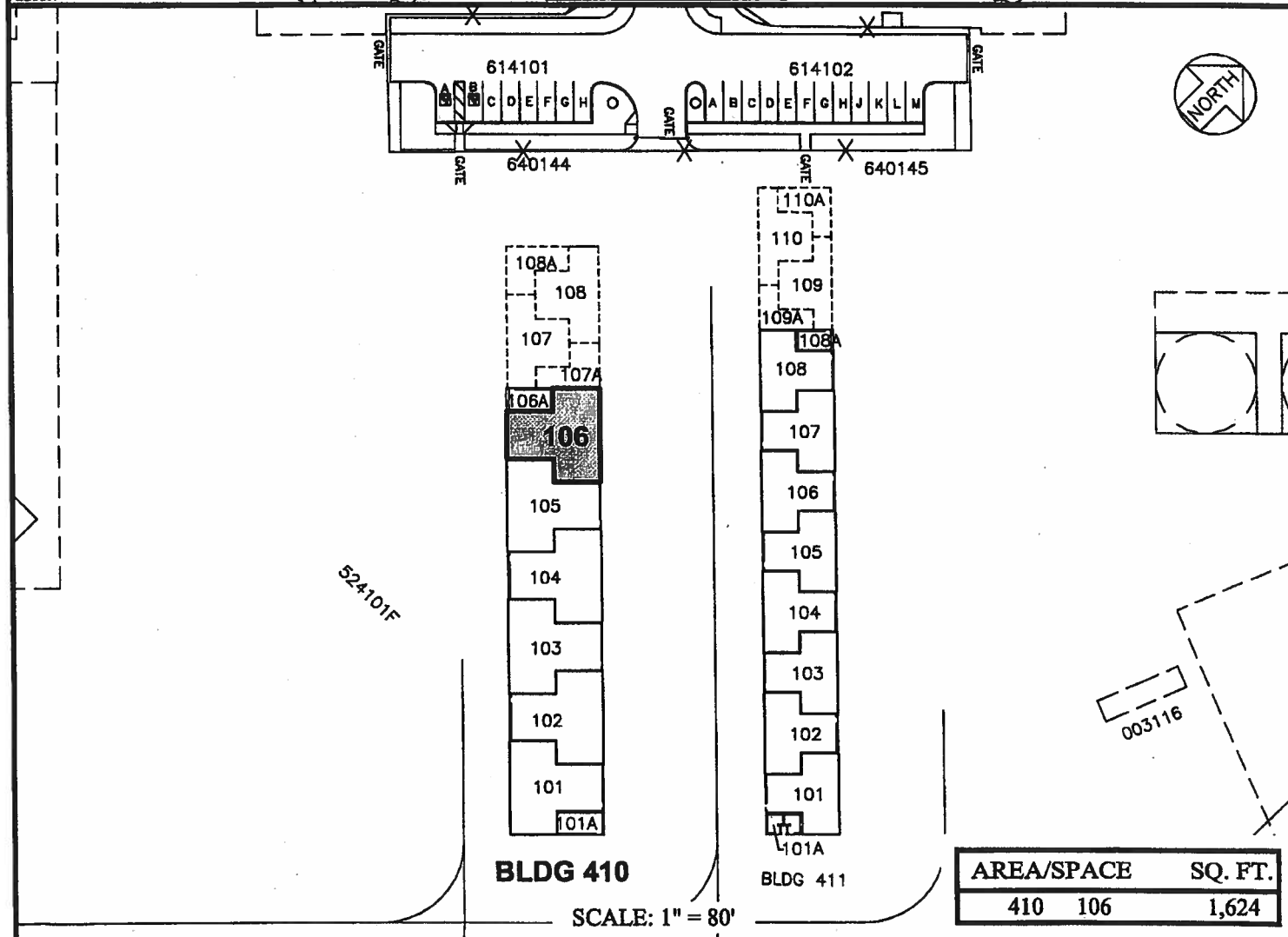

RP-8504

DATE : FEBRUARY 2016

EXHIBIT: **A**



CIVIL AIR PATROL

BUILDING 410  
T-HANGAR  
GROUND LEVEL

410106  
PLATS E1, 35

LIHUE AIRPORT