

DAVID Y. IGE  
GOVERNOR



STATE OF HAWAII  
DEPARTMENT OF TRANSPORTATION  
869 PUNCHBOWL STREET  
HONOLULU, HAWAII 96813-5097

FORD N. FUCHIGAMI  
DIRECTOR

Deputy Directors  
JADE T. BUTAY  
ROSS M. HIGASHI  
EDWIN H. SNIFFEN  
DARRELL T. YOUNG

IN REPLY REFER TO:

Board of Land and  
Natural Resources  
State of Hawai'i  
Honolulu, Hawai'i

ISSUANCE OF A REVOCABLE PERMIT FOR AIRCRAFT PARKING  
HAWAII PACIFIC AVIATION INC.  
HONOLULU INTERNATIONAL AIRPORT  
TAX MAP KEY: (1) 1-1-003: 001 (PORTION)

O'AHU

REQUEST:

Issuance of a Revocable Permit for Aircraft Parking (Parking Permit) to  
Hawaii Pacific Aviation Inc., situated at Honolulu International Airport.

LEGAL REFERENCE:

Section 171-55, Hawai'i Revised Statutes

APPLICANT:

Hawaii Pacific Aviation Inc., whose business address is 73-310 U'u Street,  
Kailua-Kona, Hawai'i 96740-2650.

LOCATION AND TAX MAP KEY:

A portion of Honolulu International Airport, identified as the South Ramp,  
Tax Map Key: 1<sup>st</sup> Division, 1-1-003: 001 (portion).

AREA:

Area/Space No. 424-103, containing an area of approximately 8,000 square feet,  
as shown and delineated on the attached map labeled Exhibit "A".

ZONING:

State Land Use District: Urban  
City and County of Honolulu LUO: Industrial (I-2)

**ITEM M-2**

BLNR – ISSUANCE OF A REVOCABLE PERMIT FOR AIRCRAFT PARKING  
HAWAII PACIFIC AVIATION INC.

Page 2

LAND TITLE STATUS:

Section 5(b) – Lands of the Hawai‘i Admissions Act: Ceded  
DHHL 30% entitlement lands pursuant to Hawai‘i Admission Act YES \_\_\_ NO X

CURRENT USE STATUS:

Land presently encumbered by Governor’s Executive Order No. 3201, dated June 8, 1983, setting aside 3,152.177 acres designated as Honolulu International Airport under the control and management of the State of Hawai‘i, Department of Transportation, Airports Division for Airport Purposes.

CHARACTER OF USE:

Aircraft Tie-down space for 3 helicopters (Tail Nos. N-4078P, N-817AB and N-820DF)

COMMENCEMENT DATE:

To be determined by the Director of Transportation at a later date.

MONTHLY RENTAL:

\$408.00 (\$136.00 for each helicopter, as determined from the DOTA schedule of rates and charges established by appraisal of Airports property statewide)

SECURITY DEPOSIT:

Three (3) times the monthly rental in effect.

DCCA VERIFICATION:

Place of business registration confirmed:	YES <u>X</u>	NO ___
Registered business name confirmed:	YES <u>X</u>	NO ___
Good standing confirmed:	YES <u>X</u>	NO ___

REMARKS:

The issuance of a Parking Permit to Hawaii Pacific Aviation Inc., at Honolulu International Airport complies with Chapter 343, Exemption Class 1.D.10 as a continuing aeronautical use, and is in accordance with Section 171-55 HRS, relating to Permits.

BLNR – ISSUANCE OF A REVOCABLE PERMIT FOR AIRCRAFT PARKING  
HAWAII PACIFIC AVIATION INC.

Page 3

RECOMMENDATION:

That the Board authorize the Department of Transportation to issue a month-to-month Parking Permit to Hawaii Pacific Aviation Inc., subject to: (1) terms and conditions herein outlined, which are by reference incorporated herein; and (2) such additional terms and conditions as may be prescribed by the Director of Transportation to best serve the interests of the State.

Respectfully submitted,



FORD N. FUCHIGAMI  
Director of Transportation

APPROVED FOR SUBMITTAL:



SUZANNE D. CASE  
Chairperson and Member

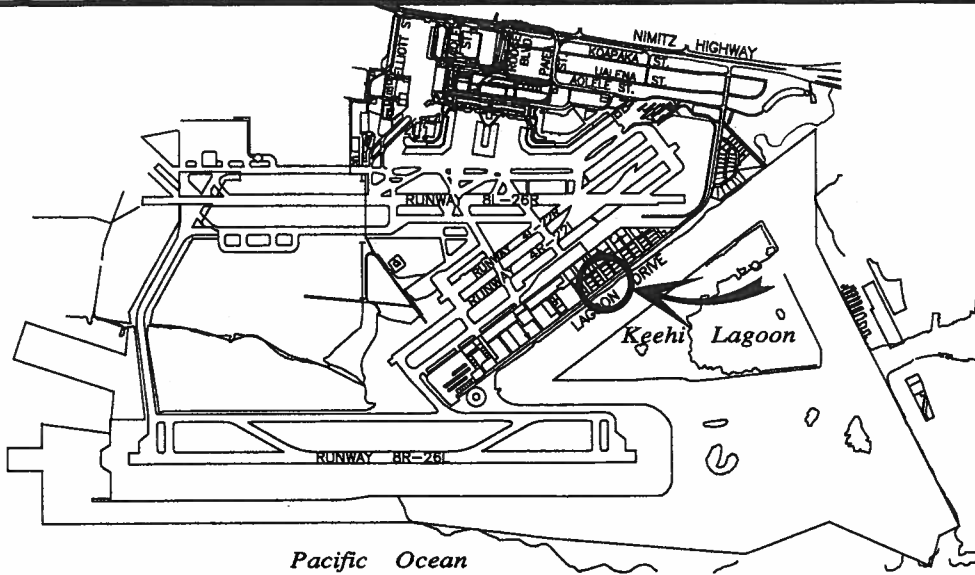

**LOCATION PLAN**

5000:1

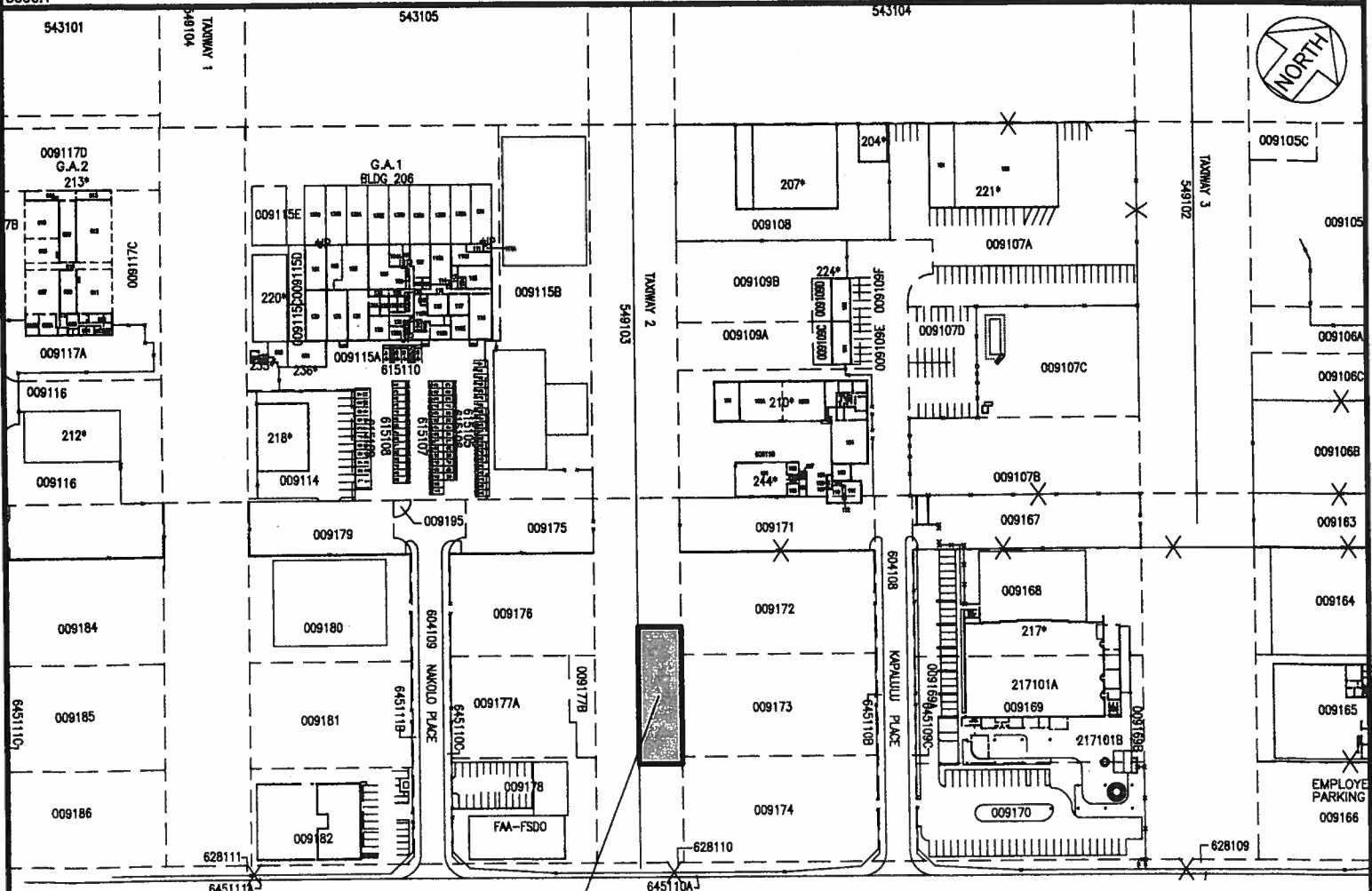

**424103**

SCALE: 1" = 200'

AREA/SPACE	SQ. FT.
424 103	8,000

DATE : MARCH 2016

EXHIBIT: **A**



Airports Division

**TIE DOWNS  
SOUTH RAMP**

424103

PLAT 36