

STATE OF HAWAII
DEPARTMENT OF LAND AND NATURAL RESOURCES
Land Division
Honolulu, Hawaii 96813

September 23, 2016

Board of Land and Natural Resources
State of Hawaii
Honolulu, Hawaii

PSF No.: 16MD-102

Maui

Issuance of Right-of-Entry Permit to Maui's Original Hawaiian Corporate Games, Inc.,
for Volleyball Competition Purposes, Wailea Beach, Paeahu, Honuaula, Maui,
TMK (2) 2-1-008: seaward of 109

APPLICANT:

Maui's Original Hawaiian Corporate Games, Inc.,
a Domestic Profit Corporation.

LEGAL REFERENCE:

Sections 171-55, Hawaii Revised Statutes, as amended.

LOCATION:

Portion of Government lands of Paeahu, fronting The Grand Wailea Resort, Honuaula,
Maui, further identified by Tax Map Key: (2) 2-1-008: seaward of 109, as shown on the
attached maps labeled Exhibits A.

AREA:

1,800 square feet

ZONING:

State Land Use District: Conservation

TRUST LAND STATUS:

Section 5(b) lands of the Hawaii Admission Act
DHHL 30% entitlement lands pursuant to the Hawaii State Constitution: No

CURRENT USE STATUS: Vacant and unencumbered

CHARACTER OF USE:

Volleyball competition purposes.

TERM OF RIGHT-OF-ENTRY:

This is a one day event. Scheduled for October 2, 2016; from 10:00 a.m. to 2:00 p.m.

RENTAL:

Payment of \$180.00 (Rental is based on 10¢ per square feet per day). Total area of requested use is 1,800 square feet for one day = \$180.00.

CHAPTER 343 - ENVIRONMENTAL ASSESSMENT:

In accordance with Hawaii Administrative Rule Section 11-200-8 and the Exemption List for the Department of Land and Natural Resources approved by the Environmental Council and dated June 5, 2015, the subject request is exempt from the preparation of an environmental assessment pursuant to Exemption Class No. 1, that states "Operations, repairs or maintenance of existing structures, facilities, equipment, or topographical features, involving negligible or no expansion or change of use beyond that previously existing" and Item No. 51, that states "Permits, licenses, registrations, and right-of-entry issued by the Department that are routine in nature, involving negligible impacts beyond that previously existing."

DCCA VERIFICATION:

Place of business registration confirmed:	YES <u>X</u>	NO <u> </u>
Registered business name confirmed:	YES <u>X</u>	NO <u> </u>
Applicant in good standing confirmed:	YES <u>X</u>	NO <u> </u>

APPLICANT REQUIREMENTS:

1. Pay consideration fee of \$180,
2. Obtain Right-of-Permit from the Maui District Land Office,
3. Supply Certificate of Insurance naming the State of Hawaii as additional insured,
4. Situate location of event in areas seaward of parcel 109 just north of the Molokini lawn of the Grand Wailea Resort. See Exhibits A & B for depiction of recommended location.

REMARKS:

Staff is requesting approval for a right-of-entry permit to Maui's Original Hawaiian

Corporate Games, Inc., for a volleyball competition scheduled for October 2, 2016, from 10:00 a.m. to 2:00 p.m. Applicant anticipates about 60 participants. The proposed activity is of a similar type and scope of beach activities that periodically occurred and continues to occur on this and other beach areas across the State. Such activities have resulted in no known significant impacts, whether immediate or cumulative, to the natural, environmental and/or cultural resources in the area. As such staff believes that the proposed event/use would involve negligible or no expansion or change in use of the subject area beyond that previously existing.

Applicant has not had a lease, permit, easement or other disposition of State lands terminated within the past five years due to non-compliance with such terms and conditions. No comments were solicited from government or community agencies.

RECOMMENDATION: That the Board

1. Declare that, after considering the potential effects of the proposed disposition as provided by Chapter 343, HRS, and Chapter 11-200, HAR, this project will probably have minimal or no significant effect on the environment and is therefore exempt from the preparation of an environmental assessment.
2. Authorize the issuance of a right-of-entry permit to Maui's Original Hawaiian Corporate Games, Inc. covering the subject area for a volleyball competition under the terms and conditions cited above, which are by this reference incorporated herein and further subject to the following:
 - A. The standard terms and conditions of the most current right-of-entry permit form, as may be amended from time to time; and,
 - B. Such other terms and conditions as may be prescribed by the Chairperson to best serve the interests of the State.

Respectfully Submitted,

Daniel Ornellas
District Land Agent

APPROVED FOR SUBMITTAL:

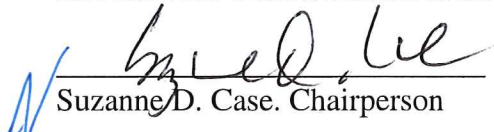
Suzanne D. Case, Chairperson

SUBJECT AREA

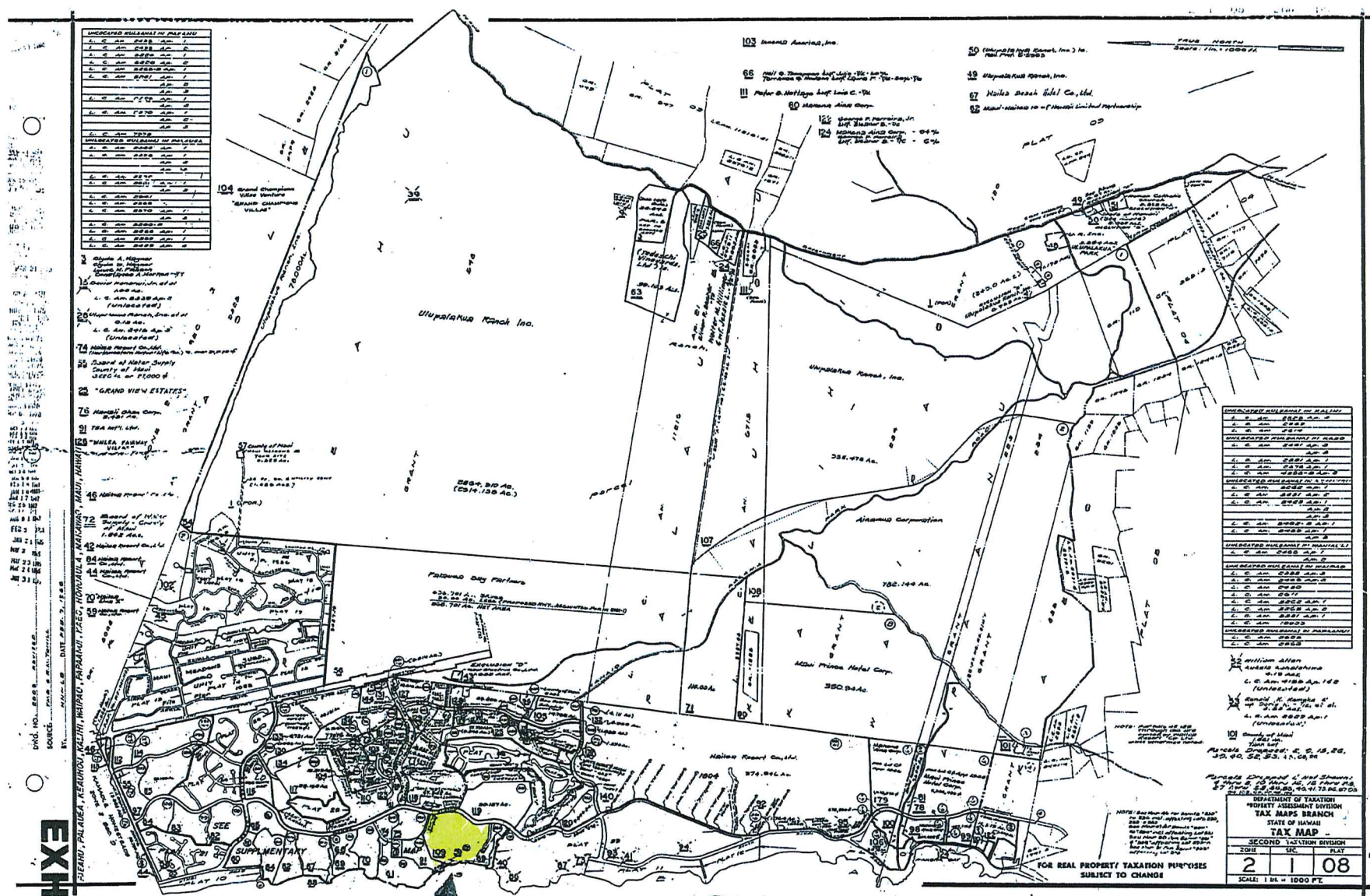

Maui County Parcel Maps



Maui County makes every effort to produce the most accurate information possible. No warranties, expressed or implied, are provided for the data herein, its use or interpretation. The assessment information is from the last certified taxroll. All data is subject to change.

TMK (2) 2-1-008: seaward of 109

EXHIBIT A

8/31/2016



SUBP

Exhibit B

8/31/2016

Maui's Original Hawaiian Corporate Games Inc.

August 7, 2016

Aloha Larry.

Please accept my request for a right of entry beach permit for the date of October 2, 2016. The Volleyball Competition we will be staging is for a group of approximately "60" participants staying at The Grand Wailea Resort, and is scheduled to take place from 10:00 A.M. to 2:00 P.M. The exact location for the event will be Makai side of The Grand Wailea's Molokini Lawn.

and North

Estimated measurements for this beach activity is 30' x 60' = 1,800.00 square feet.

Please see accompanying activity layout.

As always, we at "Maui's Original Hawaiian Corporate Games Inc." are looking forward to staging an organized and fun event for this group.

Last but not least, a Big Mahalo to the DLNR (Land Division) for all your assistance over the past 23 years.

Sincerely,

Richard Tumolo, President/Fun Specialist!

EXHIBIT " C "



**STATE OF HAWAII
DEPARTMENT OF LAND AND NATURAL RESOURCES**

POST OFFICE BOX 621
HONOLULU, HAWAII 96809

September 23, 2016

EXEMPTION NOTIFICATION

Regarding the preparation of an environmental assessment pursuant to Chapter 343, HRS and Chapter 11-200, HAR.

Project Title: Issuance of Right-of-Entry Permit to Maui's Original Hawaiian Corporate Games, Inc., for Volleyball Competition Purposes.

Project / Ref. No.: 16MD-102

Project Location: Wailea Beach, Paeahu, Honuaula, Maui; TMK: (2) 2-1-008: seaward of 109.

Project Description: Volleyball Competition Purposes

Chap. 343 Trigger(s): Use of State Land

Exemption Class No.: In accordance with Hawaii Administrative Rule Section 11-200-8 and the Exemption List for the Department of Land and Natural Resources approved by the Environmental Council and dated June 5, 2015, the subject request is exempt from the preparation of an environmental assessment pursuant to Exemption Class No. 1, that states "Operations, repairs or maintenance of existing structures, facilities, equipment, or topographical features, involving negligible or no expansion or change of use beyond that previously existing" and Item No. 51, that states "Permits, licenses, registrations, and right-of-entry issued by the Department that are routine in nature, involving negligible impacts beyond that previously existing."

Recommendation: That the Board finds this project will probably have minimal or no significant effect on the environment and is presumed to be exempt from the preparation of an environmental assessment.

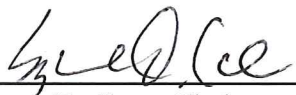
Suzanne D. Case, Chairperson