

DAVID Y. IGE
GOVERNOR



STATE OF HAWAII
DEPARTMENT OF TRANSPORTATION
869 PUNCHBOWL STREET
HONOLULU, HAWAII 96813-5097

FORD N. FUCHIGAMI
DIRECTOR

Deputy Directors
JADE T. BUTAY
ROSS M. HIGASHI
EDWIN H. SNIFFEN
DARRELL T. YOUNG

IN REPLY REFER TO:

Board of Land and
Natural Resources
State of Hawai'i
Honolulu, Hawai'i

ISSUANCE OF A REVOCABLE PERMIT FOR OFFICE SPACE
UNITED STATES OF AMERICA
GENERAL SERVICES ADMINISTRATION FOR AND ON BEHALF OF
U.S. DEPARTMENT OF HOMELAND SECURITY
KAHULUI AIRPORT
TAX MAP KEY: (2) 3-8-01: PORTION OF 19

MAUI

LEGAL REFERENCE:

Sections 171-11 and 171-55, Hawai'i Revised Statutes

APPLICANT:

United States of America General Services Administration (GSA) for and on behalf of
U.S. Department of Homeland Security whose business address is 300 Ala Moana Blvd,
#1-336, Honolulu, Hawai'i 96850.

LOCATION AND TAX MAP KEY:

Portion of Kahului Airport (OGG), Kahului, Island of Maui, identified by
Tax Map Key: 2nd Division, 3-8-01: Portion of 19

AREAS:

Building/Room No. 330-103B, containing an area of approximately 181 square feet as
shown on the attached Exhibit A.

ZONING:

State Land Use District:	Urban
County of Maui:	Airport

ITEM M-3

BLNR – ISSUANCE OF A REVOCABLE PERMIT FOR OFFICE SPACE
U.S. DEPARTMENT OF HOMELAND SECURITY
Page 2

LAND TITLE STATUS:

Section 5(a) lands of the Hawai'i Admission Act: Non-Ceded
DHHL 30% entitlement lands pursuant to Hawai'i Admission Act YES ___ NO X

CURRENT USE STATUS:

Airport purposes

CHARACTER OF USE:

Office space for administration, briefing, training and breakroom

COMMENCEMENT DATE:

Upon complete execution of the revocable permit

MONTHLY RENTAL:

\$ 731.24 (as determined from the DOTA schedule of rates and charges established by appraisal of Airports property statewide).

SECURITY DEPOSIT:

\$ 00.00

HOLDOVER TENANCY:

\$ 00.00

DCCA VERIFICATION:

Place of business registration confirmed:	YES <u>X</u>	NO _____
Registered business name confirmed:	YES <u>X</u>	NO _____
Good standing confirmed:	YES <u>X</u>	NO _____

CHAPTER 343, HRS - ENVIRONMENTAL ASSESSMENT:

Pursuant to Section 11-200-8(a), Environmental Impact Statement Rules of the Department of Health, State of Hawai'i, this disposition is exempt from requirements regarding preparation of an environmental assessment, negative declaration, or environmental impact statement as required by Chapter 343, Hawai'i Revised Statutes, as amended, relating to Environmental Impact Statements, because the proposed action falls

BLNR – ISSUANCE OF A REVOCABLE PERMIT FOR OFFICE SPACE
U.S. DEPARTMENT OF HOMELAND SECURITY
Page 3

within Exemption Class #1, Comprehensive Exemption List for the State of Hawai‘i, Department of Transportation, dated November 15, 2000, as approved by the Environmental Quality Council. Exemption Class #1 covers operations, repairs, or maintenance of existing structures, facilities, equipment, or topographical features involving negligible or no expansion or change of use beyond that previously existing.

REMARKS:

The Department of Transportation (DOT) has no objections to GSA’s request and therefore, in accordance with Sections 171-11 and 171-55, HRS, relating to Public Purposes and Permits, respectively and therefore, the DOT proposes to issue a month-to-month revocable permit to GSA, Building/Room No. 330-103B for its office space at OGG.

RECOMMENDATION:

That the Board authorize the Department of Transportation to issue a month-to-month revocable permit to GSA, subject to: (1) terms and conditions herein outlined, which are by reference incorporated herein; and (2) such additional terms and conditions as may be prescribed by the Director of Transportation to best serve the interests of the State.

Respectfully submitted,



FORD N. FUCHIGAMI
Director of Transportation

APPROVED FOR SUBMITTAL:



SUZANNE D. CASE
Chairperson and Member

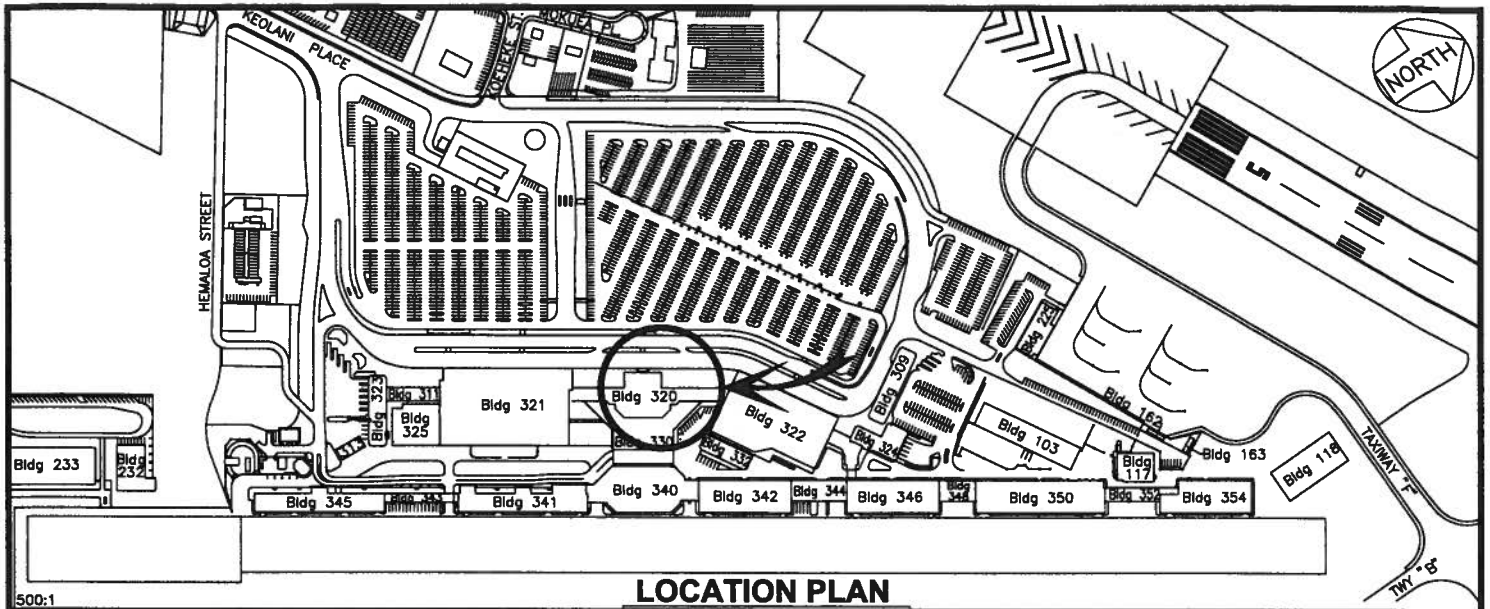

LOCATION PLAN

500:1

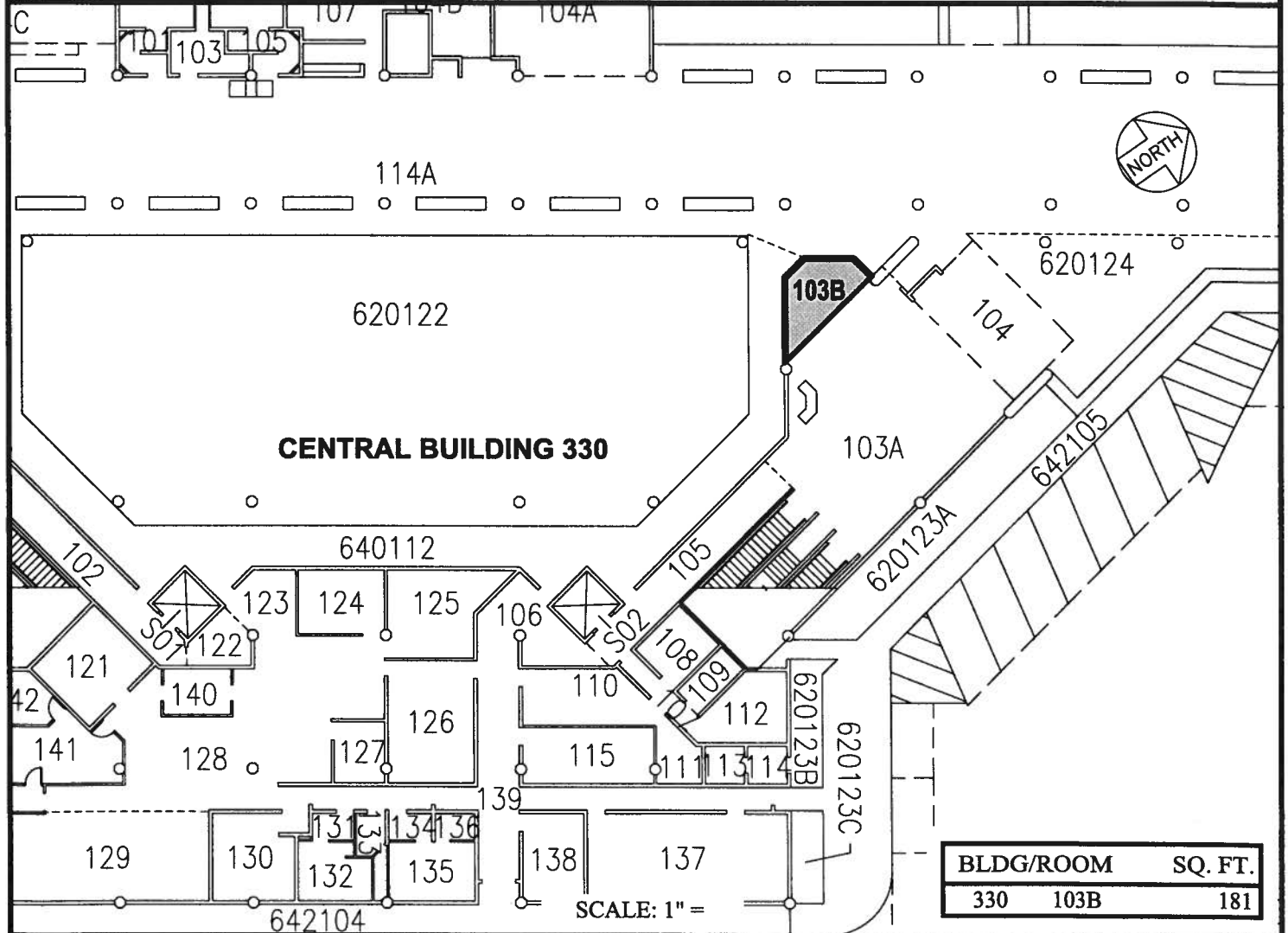

RP-8575

DATE : AUGUST 2016

EXHIBIT: **A**



US GENERAL SERVICES ADMIN/ TSA

**BUILDING 330
CENTRAL
GROUND LEVEL**

**330103B
PLAT A1**

KAHULUI AIRPORT

N:\AIRPORTS\OGG_Kohulu\CAD\PM\ogg_330103B-01.dwg