

DAVID Y. IGE
GOVERNOR



STATE OF HAWAII
DEPARTMENT OF TRANSPORTATION
869 PUNCHBOWL STREET
HONOLULU, HAWAII 96813-5097

FORD N. FUCHIGAMI
DIRECTOR

Deputy Directors
JADE T. BUTAY
ROSS M. HIGASHI
EDWIN H. SNIFFEN
DARRELL T. YOUNG

IN REPLY REFER TO:

Board of Land and
Natural Resources
State of Hawai'i
Honolulu, Hawai'i

ISSUANCE OF A REVOCABLE PERMIT FOR
AN AREA TO PARK A FUEL TRUCK
AIR SERVICE HAWAII, INC.
LĀNA'I AIRPORT
TAX MAP KEY: (2) 4-9-02: PORTION OF 55

MAUI

LEGAL REFERENCE:

Sections 171-11 and 171-55, Hawai'i Revised Statutes

APPLICANT:

Air Service Hawaii, Inc. (ASH), whose business address is 95 Nakolo Place, Honolulu,
Hawai'i 96819

LOCATION AND TAX MAP KEY:

Portion of Lāna'i Airport (LNY), Lāna'i, County of Maui, identified by
Tax Map Key: (2) 4-9-02: Portion of 55

AREAS:

Area/Space No. 503-105A, containing an area of approximately 1,100 square feet of
unimproved, unpaved land, shown on the attached Exhibit A.

ZONING:

State Land Use District: Urban
County of Maui: Airport

LAND TITLE STATUS:

Section 5(a) lands of the Hawai'i Admission Act: Non-Ceded
DHHL 30% entitlement lands pursuant to Hawai'i Admission Act YES___ NO X

ITEM M-4

BLNR – ISSUANCE OF A REVOCABLE PERMIT FOR AN AREA TO PARK A FUEL TRUCK, AIR SERVICE HAWAII, INC., LĀNA‘I AIRPORT
Page 2

CURRENT USE STATUS:

Airport and aeronautical purposes

CHARACTER OF USE:

Fuel truck parking

COMMENCEMENT DATE:

Upon complete execution of the revocable permit

MONTHLY RENTAL:

\$ 219.08 (as determined from the DOTA schedule of rates and charges established by appraisal of Airports property statewide).

SECURITY DEPOSIT:

\$ 657.24

HOLDOVER TENANCY:

\$ 7.30

DCCA VERIFICATION:

Place of business registration confirmed:	YES <u>X</u>	NO _____
Registered business name confirmed:	YES <u>X</u>	NO _____
Good standing confirmed:	YES <u>X</u>	NO _____

CHAPTER 343, HRS - ENVIRONMENTAL ASSESSMENT:

Pursuant to Section 11-200-8(a), Environmental Impact Statement Rules of the Department of Health, State of Hawai‘i, this disposition is exempt from requirements regarding preparation of an environmental assessment, negative declaration, or environmental impact statement as required by Chapter 343, Hawai‘i Revised Statutes, as amended, relating to Environmental Impact Statements, because the proposed action falls within Exemption Class #1, Comprehensive Exemption List for the State of Hawai‘i, Department of Transportation, dated November 15, 2000, as approved by the Environmental Quality Council. Exemption Class #1 covers operations, repairs, or maintenance of existing structures, facilities, equipment, or topographical features involving negligible or no expansion or change of use beyond that previously existing.

REMARKS:

The Department of Transportation (DOT) has no objections to ASH’s request and therefore, in accordance with Sections 171-11 and 171-55, HRS, relating to Public Purposes and Permits, respectively and therefore, the DOT proposes to issue a month-to-month revocable permit to ASH for parking of its fuel truck to support its fixed-base operation.

RECOMMENDATION:

That the Board authorize the Department of Transportation to issue a month-to-month revocable permit to ASH, subject to: (1) terms and conditions herein outlined, which are by reference incorporated herein; and (2) such additional terms and conditions as may be prescribed by the Director of Transportation to best serve the interests of the State.

Respectfully submitted,



FORD N. FUCHIGAMI
Director of Transportation

APPROVED FOR SUBMITTAL:



SUZANNE D. CASE
Chairperson and Member

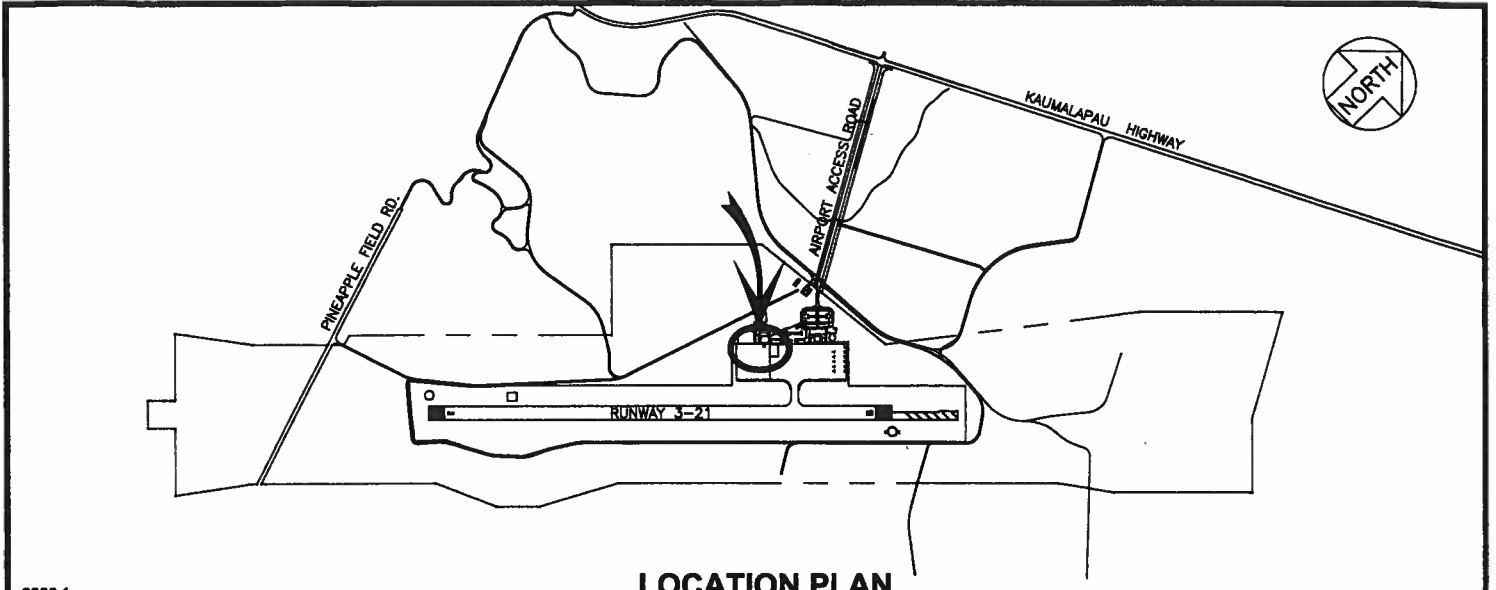

2000:1

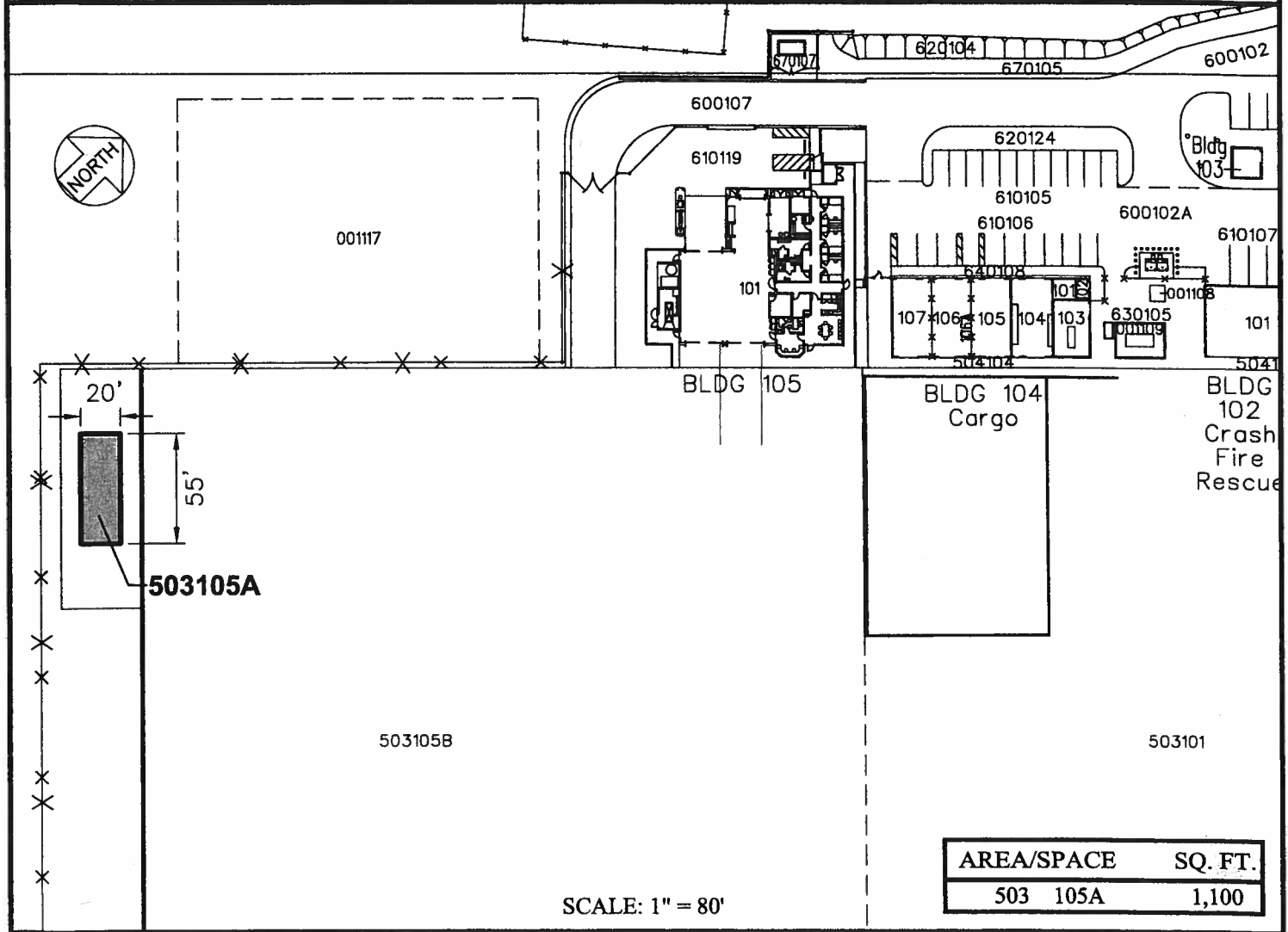

DATE : JULY 2016

EXHIBIT: **A**



AIR SERVICE HAWAII

APRON

503105A

PLAT 45

LANAI AIRPORT