

DAVID Y. IGE  
GOVERNOR



STATE OF HAWAII  
DEPARTMENT OF TRANSPORTATION  
869 PUNCHBOWL STREET  
HONOLULU, HAWAII 96813-5097

FORD N. FUCHIGAMI  
DIRECTOR

Deputy Directors  
JADE T. BUTAY  
ROSS M. HIGASHI  
EDWIN H. SNIFFEN  
DARRELL T. YOUNG

IN REPLY REFER TO:

Board of Land and  
Natural Resources  
State of Hawai'i  
Honolulu, Hawai'i

ISSUANCE OF A REVOCABLE PERMIT FOR AIRCRAFT PARKING  
GUARDIAN FLIGHT, INC.  
HILO INTERNATIONAL AIRPORT  
TAX MAP KEY: (3) 2-1-12: PORTION OF 90

HAWAI'I

REQUEST:

Issuance of a Revocable Permit for Aircraft Parking (parking permit) to  
Guardian Flight, Inc.

LEGAL REFERENCE:

Sections 171-11 and 171-55, Hawai'i Revised Statutes

APPLICANT:

Guardian Flight, Inc. (GFI), whose business address is 150 Lagoon Drive, Honolulu,  
Hawaii 96819

LOCATION AND TAX MAP KEY:

Portion of ITO, Hilo, Island of Hawai'i, identified by  
Tax Map Key: 3rd division, 2-1-12: Portion of 90

AREAS:

Area/Space No. 411-106, containing an area of approximately 990 square feet of  
improved, paved land, shown on the attached Exhibit A.

ZONING:

State Land Use District:  
County of Hawai'i:

Urban  
Industrial (ML-20)

**ITEM M-10**

BLNR – ISSUANCE OF A REVOCABLE PERMIT FOR AIRCRAFT PARKING  
GUARDIAN FLIGHT, INC, HILO INTERNATIONAL AIRPORT

Page 2

LAND TITLE STATUS:

Section 5(a) lands of the Hawai'i Admission Act: Ceded  
DHHL 30% entitlement lands pursuant to Hawai'i Admission Act YES X NO   

CURRENT USE STATUS:

Airport and aeronautical purposes

CHARACTER OF USE:

Aircraft tie-down

COMMENCEMENT DATE:

August 1, 2016

MONTHLY RENTAL:

\$ 96.00 (as determined from the DOTA schedule of rates and charges established by appraisal of Airports property statewide).

SECURITY DEPOSIT:

\$288.00

HOLDOVER TENANCY:

\$ 3.22

DCCA VERIFICATION:

Place of business registration confirmed:	YES <u>X</u>	NO <u>  </u>
Registered business name confirmed:	YES <u>X</u>	NO <u>  </u>
Good standing confirmed:	YES <u>X</u>	NO <u>  </u>

CHAPTER 343, HRS - ENVIRONMENTAL ASSESSMENT:

The issuance of a revocable permit for aircraft parking (parking permit) to GFI at Hilo International Airport complies with Chapter 343, Exemption Class 1.D.10 as a continuing aeronautical use, and is in accordance with Section 171-55 HRS, relating to Permits.

BLNR – ISSUANCE OF A REVOCABLE PERMIT FOR AIRCRAFT PARKING  
GUARDIAN FLIGHT, INC, HILO INTERNATIONAL AIRPORT

Page 3

REMARKS:

The Department of Transportation (DOT) has no objections to RA's request and therefore, in accordance with Sections 171-11 and 171-55, HRS, relating to Public Purposes and Permits, respectively, and therefore, the DOT proposes to issue a month-to-month parking permit to GFI, Area/Space No. 411-106 for aircraft parking at ITO.

RECOMMENDATION:

That the Board authorize the Department of Transportation to issue a month-to-month parking permit to GFI, subject to: (1) terms and conditions herein outlined, which are by reference incorporated herein; and (2) such additional terms and conditions as may be prescribed by the Director of Transportation to best serve the interests of the public.

Respectfully submitted,





FORD N. FUCHIGAMI  
Director of Transportation

APPROVED FOR SUBMITTAL:

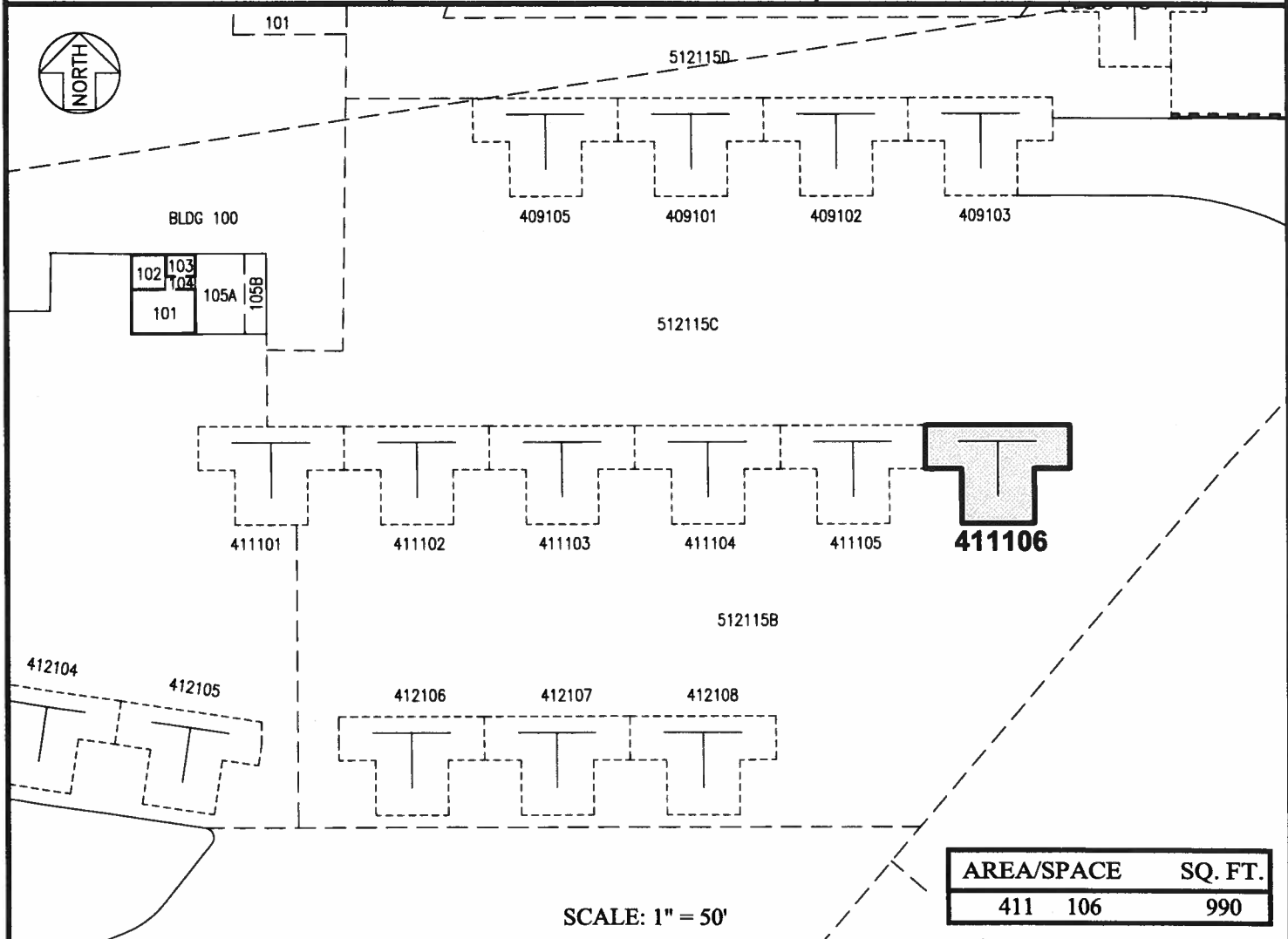
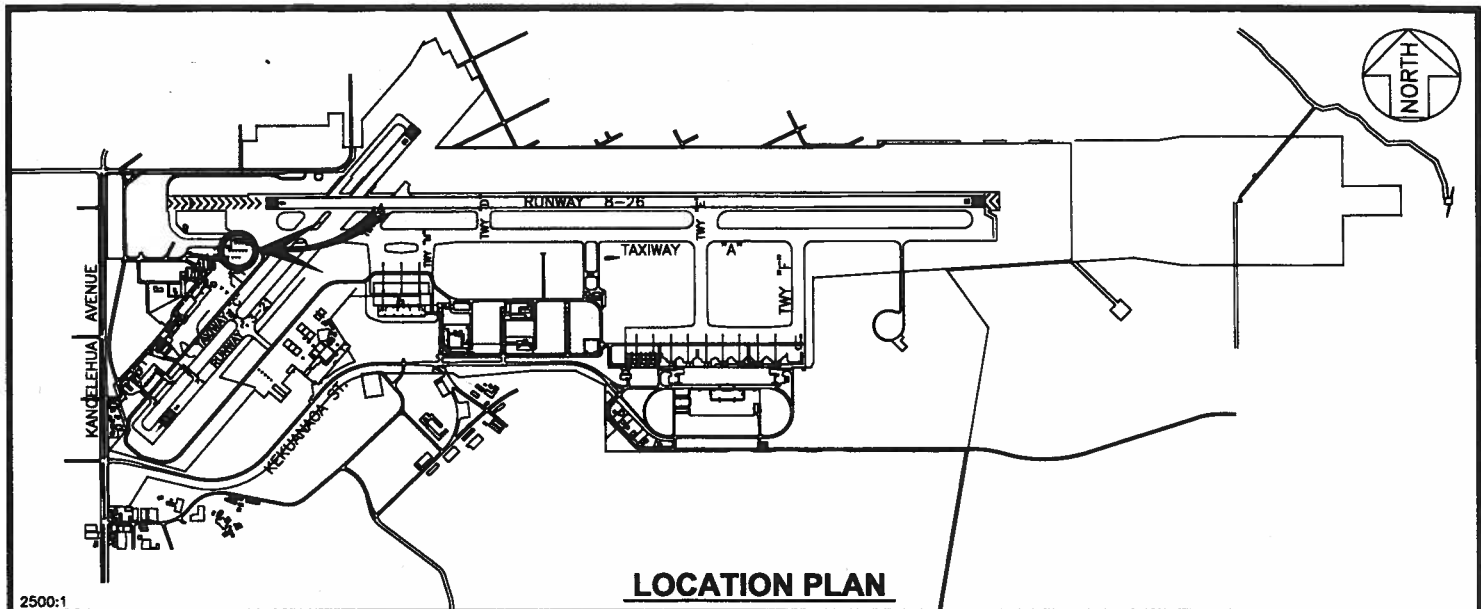

SUZANNE D. CASE  
Chairperson and Member



PP-16-S301	DATE : SEPTEMBER 2016	EXHIBIT: <b>A</b>
 Airports Division	GUARDIAN FLIGHT, INC.	TIE-DOWN
411106 PLAT 30		