

DAVID Y. IGE
GOVERNOR



STATE OF HAWAII
DEPARTMENT OF TRANSPORTATION
869 PUNCHBOWL STREET
HONOLULU, HAWAII 96813-5097

FORD N. FUCHIGAMI
DIRECTOR

Deputy Directors
JADE T. BUTAY
ROSS M. HIGASHI
EDWIN H. SNIFFEN
DARRELL T. YOUNG

IN REPLY REFER TO:

Board of Land and
Natural Resources
State of Hawai'i
Honolulu, Hawai'i

ISSUANCE OF A REVOCABLE PERMIT
FOR A T-HANGAR FOR AIRCRAFT STORAGE
JOHN G. MANGANARO II
HONOLULU INTERNATIONAL AIRPORT
TAX MAP KEY: (1) 1-1-76: PORTION OF 20

O'AHU

REQUEST:

Issuance of a Revocable Permit for a T-Hangar for aircraft storage to
John G. Manganaro II, situated at Honolulu International Airport.

LEGAL REFERENCE:

Section 171-55, Hawai'i Revised Statutes

APPLICANT:

John G. Manganaro II, whose mailing address is 1296 Kapiolani Boulevard, Apt. 3408,
Honolulu, Hawai'i 96814.

LOCATION AND TAX MAP KEY:

A portion of Honolulu International Airport, Island of O'ahu, State of Hawai'i, identified
as the South Ramp, Tax Map Key: 1st Division, 1-1-76: portion of 20.

AREA:

Area/Space No. 420-116, containing an area of approximately 1,247 square feet, as
shown and delineated on the attached map labeled Exhibit "A".

ZONING:

State Land Use District: Urban
City and County of Honolulu LUO: Industrial (I-2)

ITEM M-7

BLNR – ISSUANCE OF A REVOCABLE PERMIT
FOR A T-HANGAR FOR AIRCRAFT STORAGE
JOHN G. MANGANARO II
Page 2

LAND TITLE STATUS:

Non-ceded - Section 5(a) lands of the Hawai'i Admission Act
DHHL 30% entitlement lands pursuant to Hawai'i Admission Act YES ___ NO X

CURRENT USE STATUS:

Land presently encumbered by Governor's Executive Order No. 3201, dated June 8, 1983, setting aside 3,152.177 acres designated as Honolulu International Airport under the control and management of the State of Hawai'i, Department of Transportation, Airports Division for Airport Purposes.

CHARACTER OF USE:

T-Hangar for aircraft storage (1974 Piper PA-28-151, Tail No. N-44125)

COMMENCEMENT DATE:

Upon execution of the revocable permit.

MONTHLY RENTAL:

\$1,028.00 (\$973.00, as determined from the DOTA schedule of rates and charges established by appraisal of Airports property statewide plus \$55.00 for utilities)

SECURITY DEPOSIT:

Three (3) times the monthly rental in effect.

CHAPTER 343, HRS - ENVIRONMENTAL ASSESSMENT:

Pursuant to Section 11-200-8(a), Environmental Impact Statement Rules of the Department of Health, State of Hawaii, this disposition is exempt from requirements regarding preparation of an environmental assessment, negative declaration, or environmental impact statement as required by Chapter 343, Hawaii Revised Statutes, as amended, relating to Environmental Impact Statements, because the proposed action falls within Exemption Class #1, Comprehensive Exemption List for the State of Hawaii, Department of Transportation, dated November 15, 2000, as approved by the Environmental Quality Council. Exemption Class #1 covers operations, repairs, or maintenance of existing structures, facilities, equipment, or topographical features involving negligible or no expansion or change of use beyond that previously existing.

BLNR – ISSUANCE OF A REVOCABLE PERMIT
FOR A T-HANGAR FOR AIRCRAFT STORAGE
JOHN G. MANGANARO II
Page 3

REMARKS:

The issuance of a revocable permit to John G. Manganaro II for a T-Hangar for aircraft storage at Honolulu International Airport complies with Chapter 343, Exemption Class 1.D.10 as a continuing aeronautical use, and is in accordance with Section 171-55 HRS, relating to Permits.

RECOMMENDATION:

That the Board authorize the Department of Transportation to issue a month-to-month revocable permit to John G. Manganaro II, subject to: (1) terms and conditions herein outlined, which are by reference incorporated herein; and (2) such additional terms and conditions as may be prescribed by the Director of Transportation to best serve the interests of the State.

Respectfully submitted,

FOR FORD N. FUCHIGAMI
Director of Transportation

APPROVED FOR SUBMITTAL:



SUZANNE D. CASE
Chairperson and Member

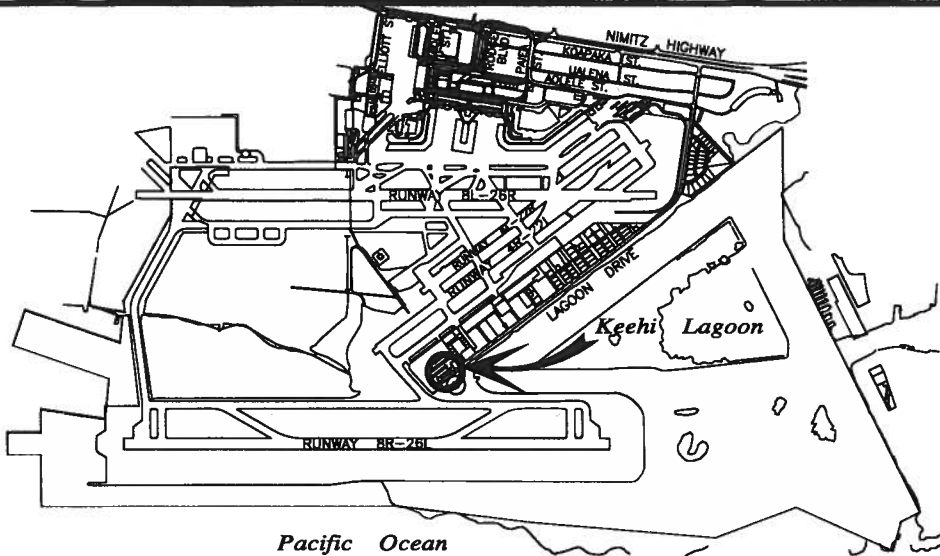

LOCATION PLAN

5000:1

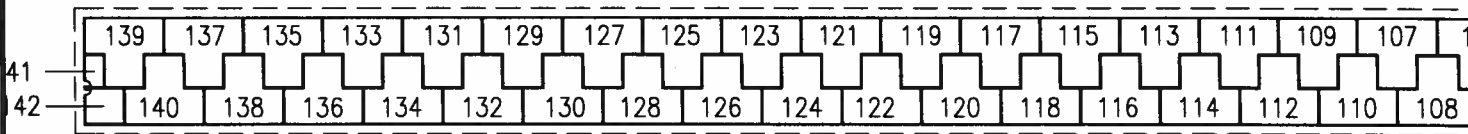

BLDG 420

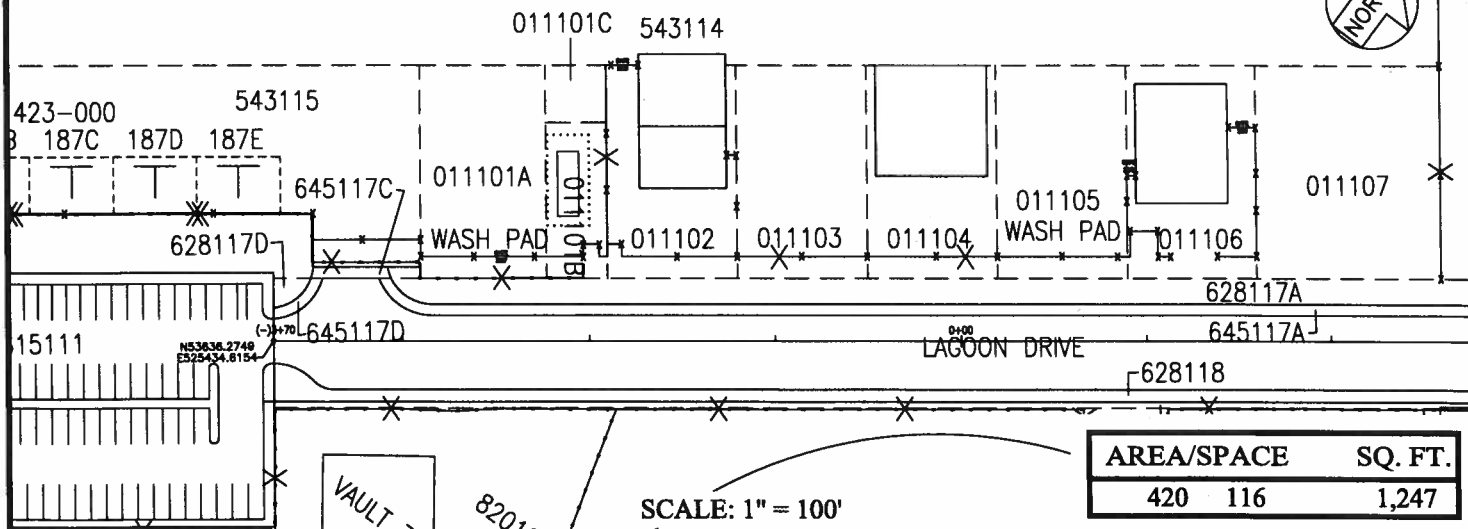
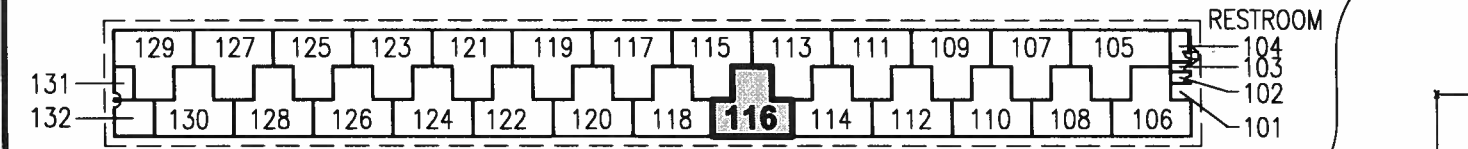

AREA/SPACE	SQ. FT.
420 116	1,247

RP-8593

DATE : NOVEMBER 2016

EXHIBIT: **A**



Airports Division

JOHN G. MANGANARO II

BUILDING 420
GENERAL AVIATION
SOUTH RAMP

420116

PLAT 45