



STATE OF HAWAII
DEPARTMENT OF TRANSPORTATION
869 PUNCHBOWL STREET
HONOLULU, HAWAII 96813-5097

FORD N. FUCHIGAMI
DIRECTOR

Deputy Directors
JADE T. BUTAY
ROSS M. HIGASHI
EDWIN H. SNIFFIN
DARRELL T. YOUNG

IN REPLY REFER TO:

Board of Land and
Natural Resources
State of Hawai'i
Honolulu, Hawai'i

ISSUANCE OF A REVOCABLE PERMIT TO AMERICAN AIRLINES, INC.
FOR THE PURPOSE OF AIRLINE OPERATIONS
HONOLULU INTERNATIONAL AIRPORT
TAX MAP KEY: (1) 1-1-003: 042 (PORTION) AND (1) 1-1-003: 050 (PORTION)

O'AHU

APPLICANT:

American Airlines, Inc. (American Airlines), whose business address is 300 Rodgers Boulevard, #36, Honolulu, Hawai'i 96819

LEGAL REFERENCE:

Section 171-55, Hawai'i Revised Statutes

LOCATION AND TAX MAP KEY:

Building No. 341, Diamond Head Extension Terminal, and Building No. 350 Central Concourse Terminal, at Honolulu International Airport, identified as Tax Map Key: 1st Division, 1-1-003: 042 (Portion) and 1-1-003: 050 (Portion).

AREA:

Diamond Head Extension:

Bldg/Room No. 341-215A, containing approximately 966 square feet;
Bldg/Room No. 341-215B, containing approximately 3,331 square feet;
Bldg/Room No. 341-259A, containing approximately 7 square feet;
Bldg/Room No. 341-259B, containing approximately 19 square feet;
Bldg/Room No. 341-259C, containing approximately 7 square feet;
Bldg/Room No. 341-259D, containing approximately 23 square feet; and
Bldg/Room No. 341-259E, containing approximately 23 square feet,
as shown and delineated on the attached map labeled Exhibit "A".

Bldg/Room No. 341-120, containing approximately 112 square feet; and
Bldg/Room No. 341-121, containing approximately 568 square feet,
as shown and delineated on the attached map labeled Exhibit "B".

ITEM M-1

BLNR – ISSUANCE OF A REVOCABLE PERMIT TO AMERICAN AIRLINES, INC. FOR THE PURPOSE OF AIRLINE OPERATIONS, HONOLULU INTERNATIONAL AIRPORT AMERICAN AIRLINES, INC.

Page 2

Central Concourse:

Bldg/Room No. 350-102D, containing approximately 502 square feet, as shown and delineated on the attached map labeled Exhibit “C”.

Bldg/Room No. 350-129, containing approximately 2,473 square feet, as shown and delineated on the attached map labeled Exhibit “D”.

ZONING:

State Land Use District: Urban
City and County of Honolulu LUO: Industrial (I-2)

LAND TITLE STATUS:

Non-Ceded - Section 5(b) lands of the Hawai‘i Admission Act
DHHL 30% entitlement lands pursuant to Hawai‘i Admission Act YES ___ NO X

CURRENT USE STATUS:

Land presently encumbered by Governor’s Executive Order No. 3201, dated June 8, 1983, setting aside 3,152.177 acres designated as Honolulu International Airport under the control and management of the State of Hawai‘i, Department of Transportation, Airports Division (DOTA) for Airport Purposes.

CHARACTER OF USE:

American Airlines will use the spaces as part of their airline operations at Honolulu International Airport.

COMMENCEMENT DATE:

Upon execution of the revocable permit.

MONTHLY RENTAL:

\$47,054.96 (per the DOTA Signatory Carrier Rates and Charges, Hawai‘i Airports System).

SECURITY DEPOSIT:

Three (3) times the monthly rental in effect.

HOLDOVER TENANCY:

\$1,568.50

**BLNR – ISSUANCE OF A REVOCABLE PERMIT TO AMERICAN AIRLINES, INC. FOR THE PURPOSE OF AIRLINE OPERATIONS, HONOLULU INTERNATIONAL AIRPORT
AMERICAN AIRLINES, INC.**

Page 3

DCCA VERIFICATION:

Place of business registration confirmed:	YES <u>X</u>	NO ____
Registered business name confirmed:	YES <u>X</u>	NO ____
Good standing confirmed:	YES <u>X</u>	NO ____

CHAPTER 343, HRS - ENVIRONMENTAL ASSESSMENT:

Pursuant to Section 11-200-8(a), Environmental Impact Statement Rules of the Department of Health, State of Hawai'i, this disposition is exempt from requirements regarding preparation of an environmental assessment, negative declaration, or environmental impact statement as required by Chapter 343, Hawai'i Revised Statutes, as amended, relating to Environmental Impact Statements, because the proposed action falls within Exemption Class #1, Comprehensive Exemption List for the State of Hawai'i, Department of Transportation, dated November 15, 2000, as approved by the Environmental Quality Council. Exemption Class #1 covers operations, repairs, or maintenance of existing structures, facilities, equipment, or topographical features involving negligible or no expansion or change of use beyond that previously existing.

REMARKS:

In accordance with Sections 171-11 and 171-55, relating to Permits, the Department of Transportation proposes to issue a month-to-month revocable permit to American Airlines, as part of their airline operations at Honolulu International Airport. American Airlines is a signatory airline carrier with airline operations located mainly within the Overseas Terminal.

RECOMMENDATION:

That the Board authorize the Department of Transportation to issue a month-to-month revocable permit to American Airlines, subject to: (1) terms and conditions herein outlined, which are by reference incorporated herein; and (2) such additional terms and conditions as may be prescribed by the Director of Transportation to best serve the interests of the State.

Respectfully submitted,



FORD N. FUCHIGAMI
Director of Transportation

APPROVED FOR SUBMITTAL:



SUZANNE D. CASE
Chairperson and Member

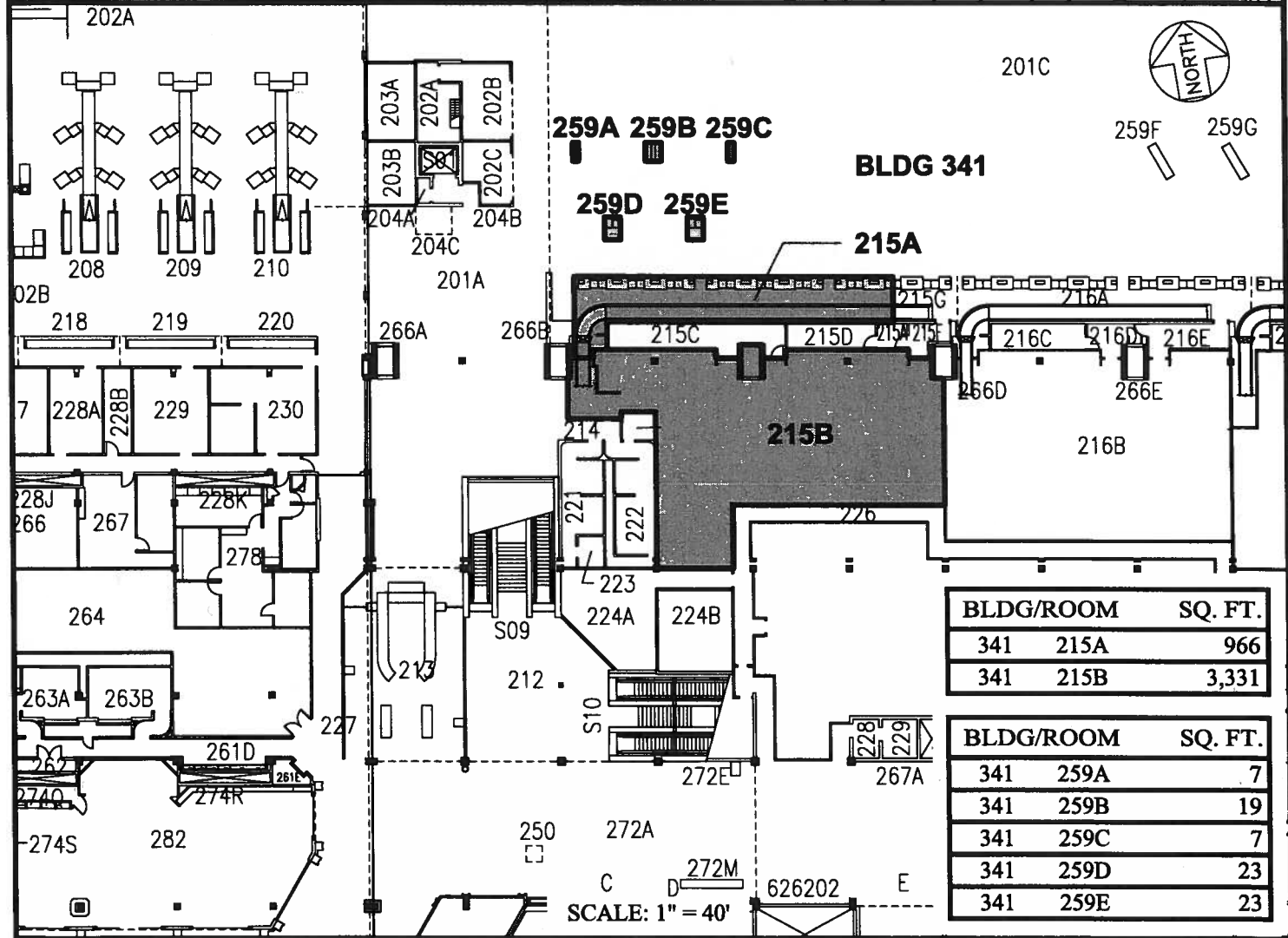
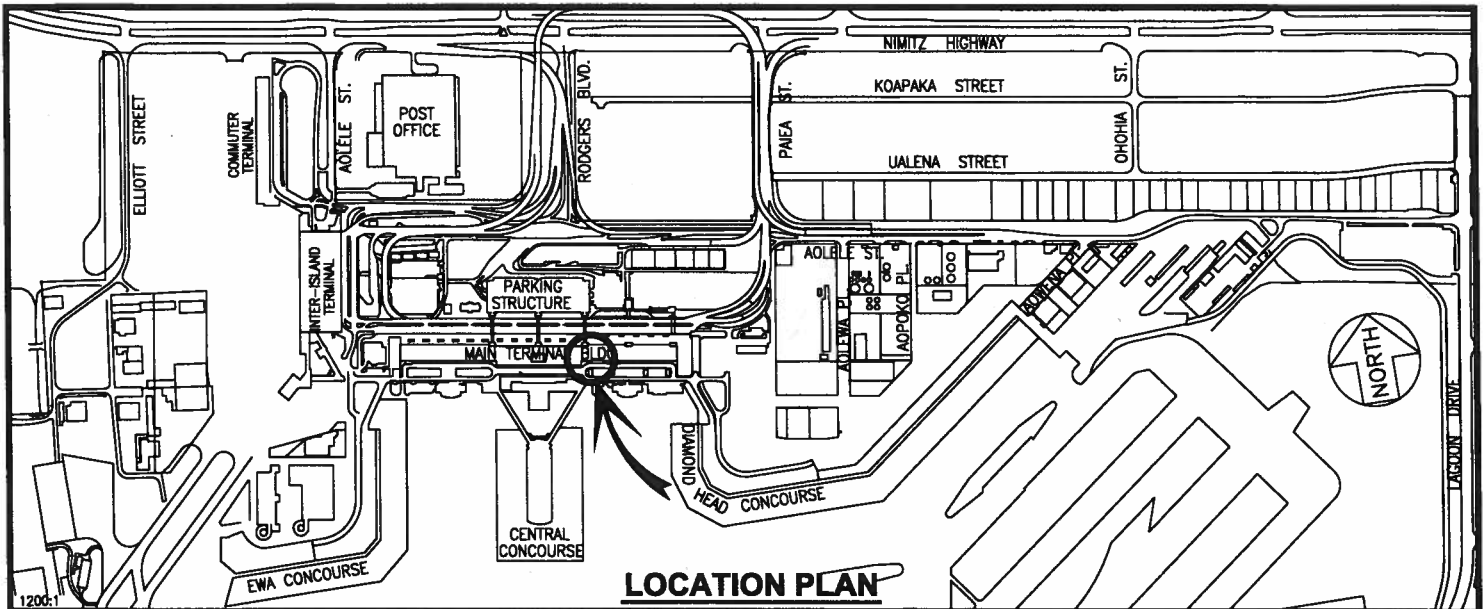

DATE : JANUARY 2017

EXHIBIT: **A**



AMERICAN AIRLINES

**BUILDING 341
DIAMOND HEAD EXTENSION
SECOND LEVEL**

**341215A-
341259E
PLAT A1**

HONOLULU INTERNATIONAL AIRPORT

N:\AIRPORTS\HNL_HONOLULU\CAD\PM\HNL_341215A-01.DWG

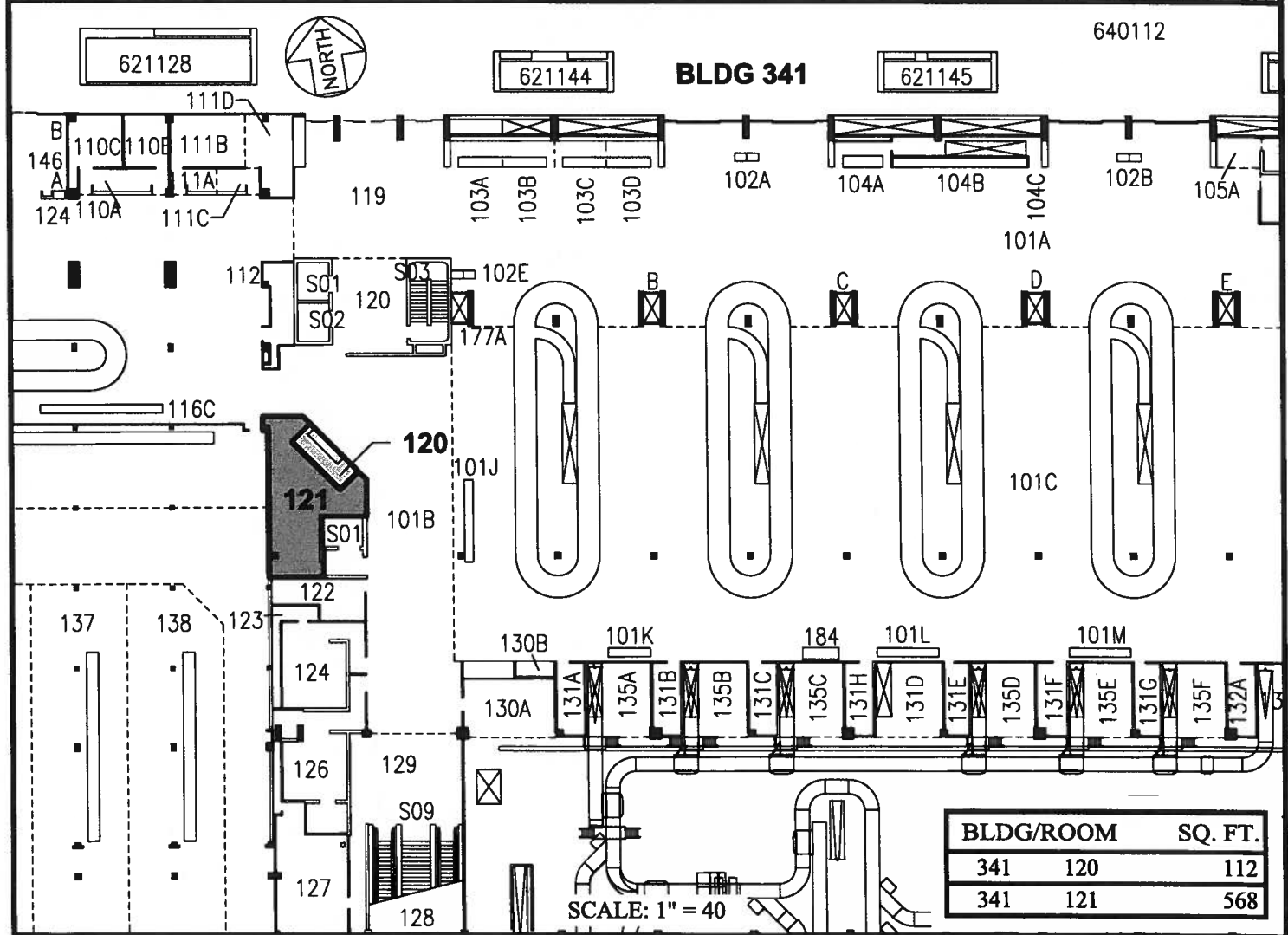
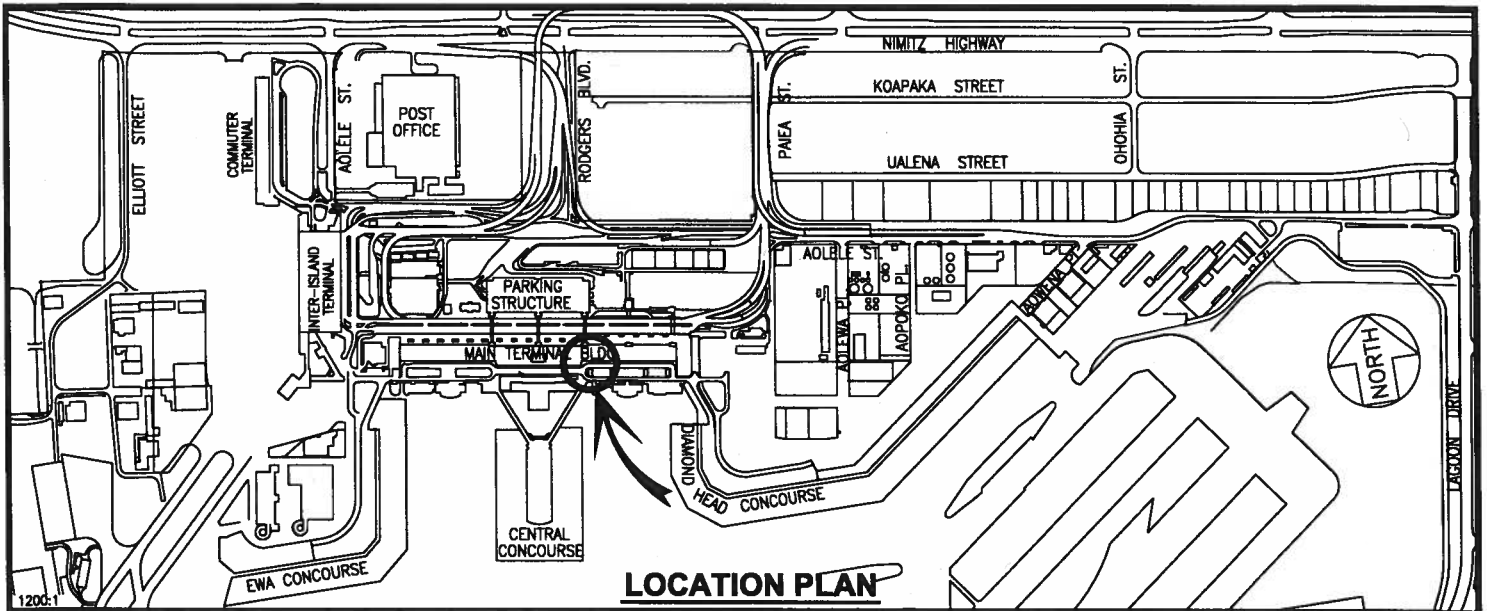

DATE : JANUARY 2017

EXHIBIT: **B**



Airports Division

AMERICAN AIRLINES, INC

**BUILDING 341
DIAMOND HEAD EXTENSION
GROUND LEVEL**

341120
341121
PLAT A1

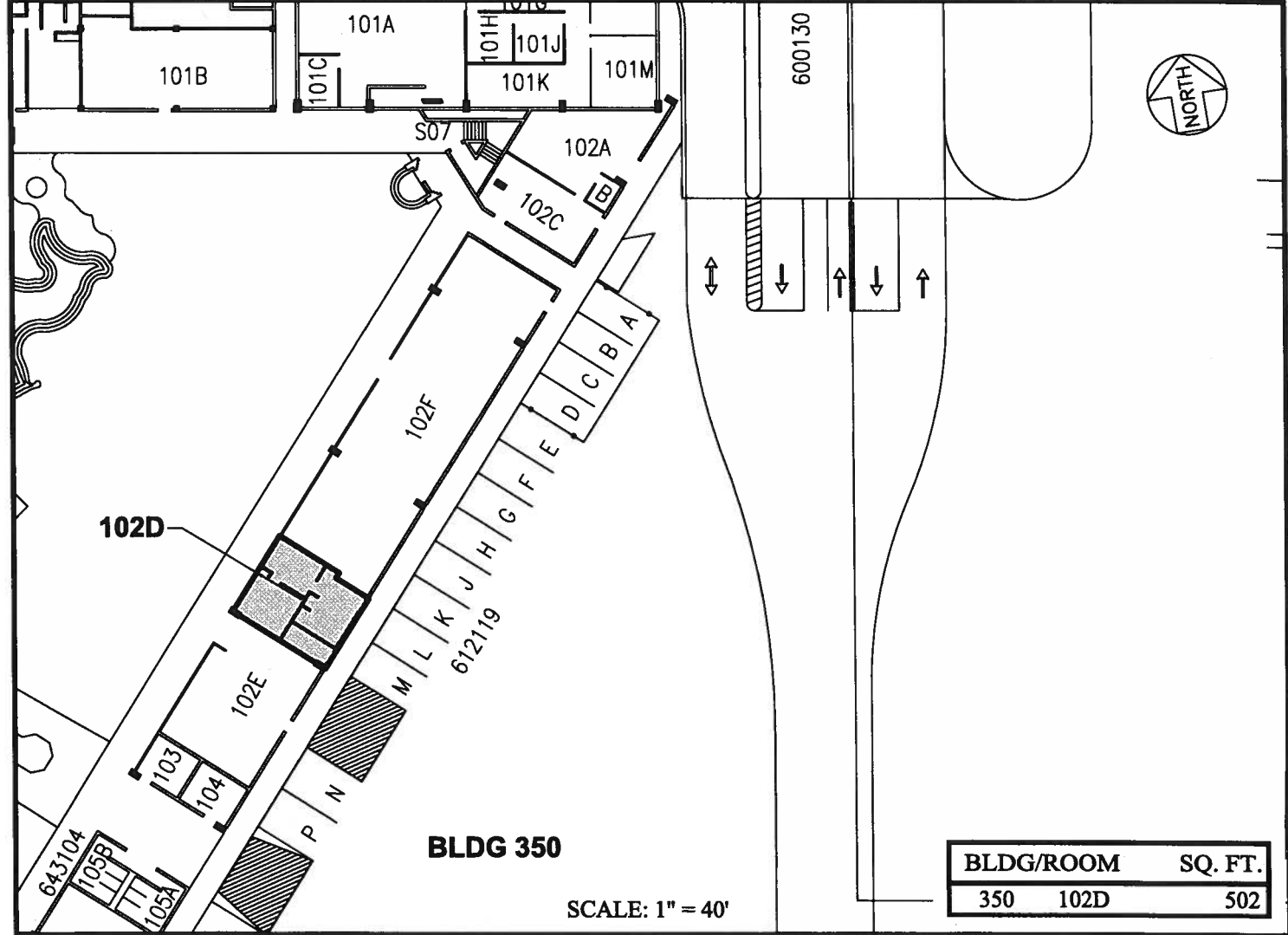
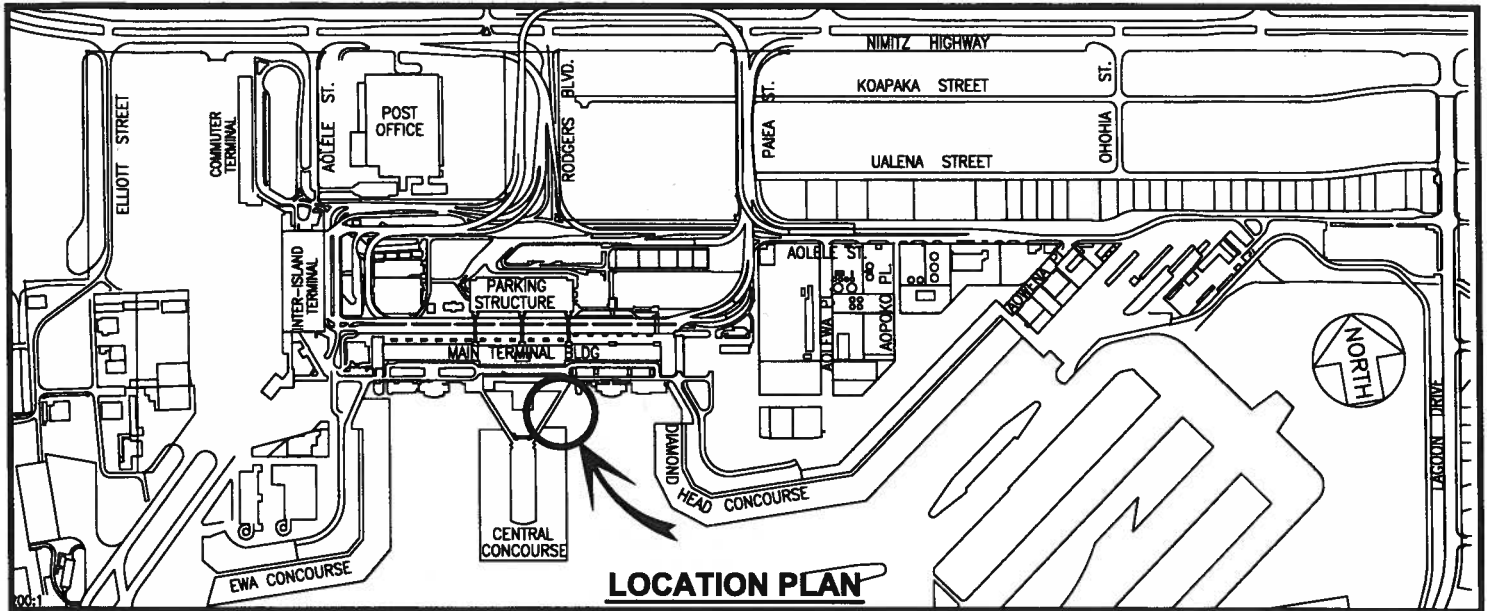

BLDG/ROOM	SQ. FT.
350 102D	502

DATE : JANUARY 2017

EXHIBIT: C



Airports Division

AMERICAN AIRLINES, INC.

**BUILDING 350
CENTRAL CONCOURSE
GROUND LEVEL**

**350102D
PLAT B1**

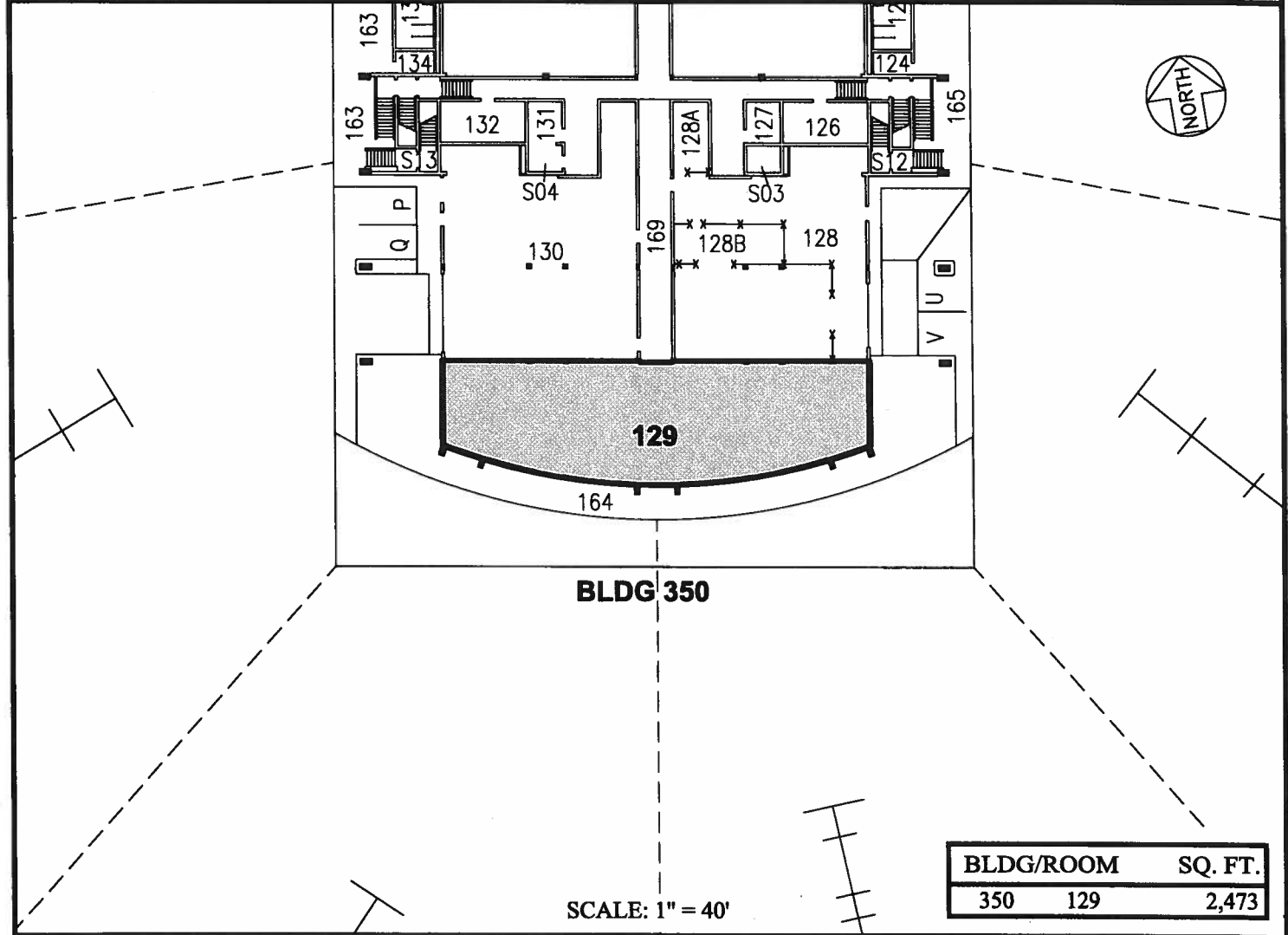
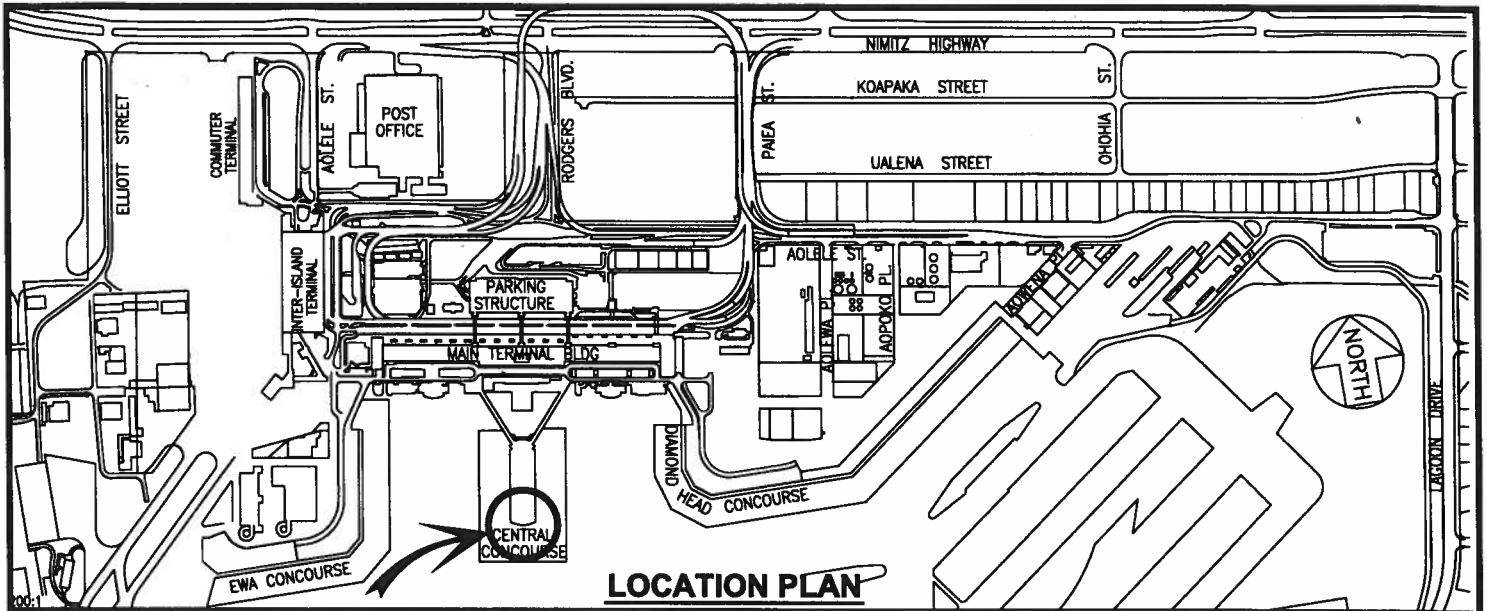

BLDG/ROOM	SQ. FT.
350 129	2,473

SCALE: 1" = 40'

DATE : JANUARY 2017

EXHIBIT: D



AMERICAN AIRLINES, INC.

BUILDING 350
CENTRAL CONCOURSE
GROUND LEVEL

350129
PLAT B1