



STATE OF HAWAII
DEPARTMENT OF TRANSPORTATION
869 PUNCHBOWL STREET
HONOLULU, HAWAII 96813-5097

FORD N. FUCHIGAMI
DIRECTOR

Deputy Directors
JADE T. BUTAY
ROSS M. HIGASHI
EDWIN H. SNIFFIN
DARRELL T. YOUNG

IN REPLY REFER TO:

Board of Land and
Natural Resources
State of Hawai'i
Honolulu, Hawai'i

ISSUANCE OF A REVOCABLE PERMIT
TO HENSEL PHELPS CONSTRUCTION CO.
FOR A FIELD OFFICE
HONOLULU INTERNATIONAL AIRPORT
TAX MAP KEYS: (1) 1-1-003: 82 (PORTION)

O'AHU

APPLICANT:

Hensel Phelps Construction Co. (HPCC), whose business address is 841 Bishop Street, Suite 2001, Honolulu, Hawai'i 96813.

LEGAL REFERENCE:

Section 171-55, Hawai'i Revised Statutes

LOCATION:

Building 302, Lei Stand, Ground Level, Honolulu International Airport, identified by Tax Map Key: 1st Division, 1-1-003: 82 (Portion).

AREA:

Building/Room No. 302-104, containing an area of approximately 354 square feet; Building/Room No. 302-115, containing an area of approximately 117 square feet; and Building/Room No. 302-116, containing an area of approximately 64 square feet, as shown and delineated on the attached map labeled Exhibit "A".

ZONING:

State Land Use District: Urban
City and County of Honolulu LUO: Industrial (I-2)

ITEM M-1

BLNR – ISSUANCE OF A REVOCABLE PERMIT
TO HENSEL PHELPS CONSTRUCTION CO. FOR A FIELD OFFICE
Page 2

LAND TITLE STATUS:

Non-ceded - Section 5(a) lands of the Hawai'i Admission Act
DHHL 30% entitlement lands pursuant to Hawai'i Admission Act YES ___ NO X

CURRENT USE STATUS:

Land presently encumbered by Governor's Executive Order No. 3201, dated June 8, 1983, setting aside 3,152.177 acres designated as Honolulu International Airport under the control and management of the State of Hawai'i, Department of Transportation, Airports Division for Airport Purposes.

CHARACTER OF USE:

HPCC will use the space for a field office, at no charge, as specifically stated under Contract No. 65065, State Project No. AO1123-30, HNL NDWP IIT Mauka Extension, Honolulu International Airport.

COMMENCEMENT DATE:

To be determined by the Director of Transportation at a later date.

MONTHLY RENTAL:

Not applicable (NA)

SECURITY DEPOSIT:

NA

DCCA VERIFICATION:

Place of business registration confirmed:	YES <u>X</u>	NO ___
Registered business name confirmed:	YES <u>X</u>	NO ___
Good standing confirmed:	YES <u>X</u>	NO ___

CHAPTER 343, HRS - ENVIRONMENTAL ASSESSMENT:

Pursuant to Section 11-200-8(a), Environmental Impact Statement Rules of the Department of Health, State of Hawai'i, this disposition is exempt from requirements regarding preparation of an environmental assessment, negative declaration, or environmental impact statement as required by Chapter 343, Hawai'i Revised Statutes, as amended, relating to Environmental Impact Statements, because the proposed action falls

BLNR – ISSUANCE OF A REVOCABLE PERMIT
TO HENSEL PHELPS CONSTRUCTION CO. FOR A FIELD OFFICE
Page 3

within Exemption Class #1, Comprehensive Exemption List for the State of Hawai'i, Department of Transportation, dated November 15, 2000, as approved by the Environmental Quality Council. Exemption Class #1 covers operations, repairs, or maintenance of existing structures, facilities, equipment, or topographical features involving negligible or no expansion or change of use beyond that previously existing.

REMARKS:

The Department of Transportation proposes to issue a permit to HPCC for the use of the space for a field office for construction materials and equipment, at no rent, as specifically stated under Contract No. 65065 State Project No. AO1123-30, HNL NDWP IIT Mauka Extension, Honolulu International Airport, Section 1.04, Provisions for Field Office/Storage Space: "Pending the availability of space on airport property, the State will issue a permit to the Contractor for the use of the space, at no charge, to be used specifically for a field office and/or storage of materials and equipment...."

RECOMMENDATION:

That the Board authorize the Department of Transportation to issue a month-to-month revocable permit to HPCC, subject to: (1) terms and conditions herein outlined, which are by reference incorporated herein; and (2) such additional terms and conditions as may be prescribed by the Director of Transportation to best serve the interests of the State.

Respectfully submitted,

FORD N. FUCHIGAMI
Director of Transportation

APPROVED FOR SUBMITTAL:

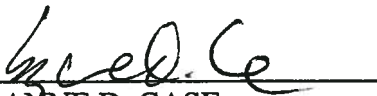
SUZANNE D. CASE
Chairperson and Member

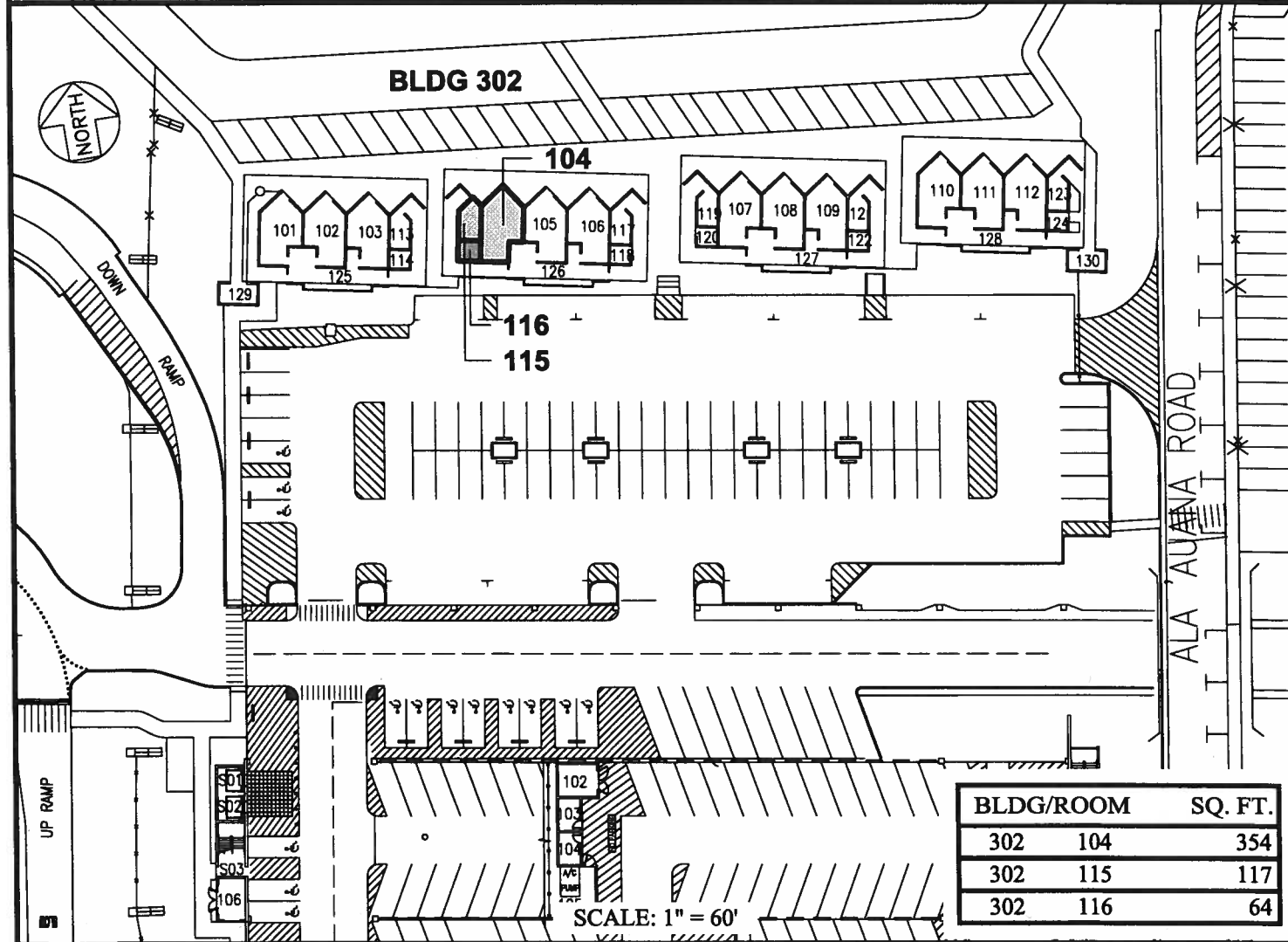
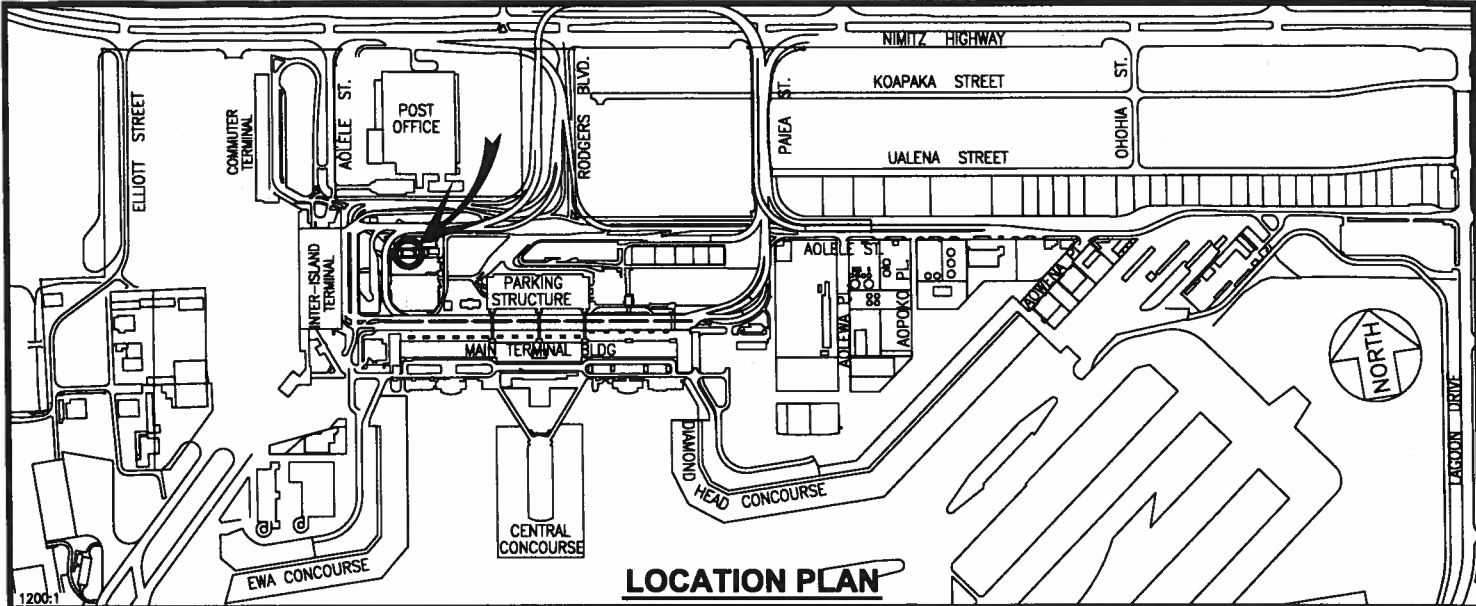

BLDG/ROOM	SQ. FT.
302 104	354
302 115	117
302 116	64

RP-8608

DATE : JANUARY 2017

EXHIBIT: **A**



Airports Division

HENSEL PHELPS
CONSTRUCTION CO.

BUILDING 302
LEI STAND
GROUND LEVEL

302104
302115
302116
PLAT D1

HONOLULU INTERNATIONAL AIRPORT

N:\AIRPORTS\HNL_HONOLULU\CAD\PM\HNL_302104-01.DWG