

DAVID Y. IGE  
GOVERNOR



STATE OF HAWAII  
DEPARTMENT OF TRANSPORTATION  
869 PUNCHBOWL STREET  
HONOLULU, HAWAII 96813-5097

FORD N. FUCHIGAMI  
DIRECTOR

Deputy Directors  
JADE T. BUTAY  
ROSS M. HIGASHI  
EDWIN H. SNIFFEN  
DARRELL T. YOUNG

IN REPLY REFER TO:

Board of Land and  
Natural Resources  
State of Hawai'i  
Honolulu, Hawai'i

ISSUANCE OF A REVOCABLE PERMIT FOR  
THREE ADDITIONAL NEWSSTANDS  
BLIND VENDORS OHANA, INC.  
HONOLULU INTERNATIONAL AIRPORT  
TAX MAP KEY: (1) 1-1-003: PORTION OF 228, 42 & 51

OAHU

LEGAL REFERENCE:

Section 171-55, Hawai'i Revised Statutes

APPLICANT:

Blind Vendors Ohana, Inc. whose business address is 300 Rodgers Boulevard,  
#56, Honolulu, Hawai'i 96819

LOCATION AND TAX MAP KEY:

Honolulu International Airport  
Tax Map Key: 1<sup>st</sup> Division, 1-1-003: portion of 228, 42 & 51

AREA:

Building 311, Space No. 224B, containing an area of approximately 343 square feet, as delineated on the attached map labeled Exhibit A dated January 2017.

Building 341, Space No. 275, containing an area of approximately 1,222 square feet, as delineated on the attached map labeled Exhibit B dated January 2017.

Building 342, Space No. 280A, containing an area of approximately 1,067 square feet, as delineated on the attached map labeled Exhibit C dated January 2017.

**ITEM M-3**

**BLNR – ISSUANCE OF A REVOCABLE PERMIT FOR THREE ADDITIONAL NEWSSTANDS TO THE BLIND VENDORS OHANA, INC.**

PAGE 2

**ZONING:**

State Land Use District: Urban  
City and County of Honolulu: Industrial (I-2)

**LAND TITLE STATUS:**

Section 5(a) lands of the Hawai‘i Admissions Act: Non-Ceded  
DHHL 30% entitlement lands pursuant to the Hawai‘i State Constitution: No

**CURRENT USE STATUS:**

Land presently encumbered by Governor’s Executive Order No. 3201, dated June 8, 1983, setting aside 3,152,177 acres designated as Honolulu International Airport under the control and management of the State of Hawai‘i, Department of Transportation Airports Division (DOTA) for Airports purposes.

**CHARACTER OF USE:**

Newsstand Concession

**COMMENCEMENT DATE:**

Upon execution of the revocable permit

**MONTHLY RENTAL:**

In accordance with the terms of the Settlement Agreement dated July 28, 1993, by and between the Hawaii State Committee of Blind Vendors, the Hawaii Blind Vendors Association, Walter Ishikawa, Charlotte Kauhane, Esrom Nihoa, Yoshiko Nishihara, Miriam Onomura, Clyde Ota, Alice Schaar, Warren Toyama, Filo Tu, Jeanette Tu, the Department of the Human Services, State of Hawai‘i, and the Department of Transportation, State of Hawai‘i, (hereinafter referred to as “Settlement Agreement”), the PERMITTEE’s Blind Vending Facility Operator (hereinafter referred to as “Blind Vendor”) shall pay directly to the Department of Transportation for the use of the facilities the higher of:

- A. Three thousand two hundred ninety and 00/100 (\$3,290.00) based on \$1.25 per square foot per month for Commercial Retail Sales Spaces (Space Nos. 311-224B, 341-275, and 342-280A), or
- B. A percentage of the gross annual income schedule as follows:
  1. Seven percent (7%) of the first \$600,000.00;

BLNR – ISSUANCE OF A REVOCABLE PERMIT FOR THREE ADDITIONAL NEWSSTANDS TO THE BLIND VENDORS OHANA, INC.  
PAGE 3

2. Eight and one-half percent (8-1/2%), of all amounts in excess of \$600,000.00 up to \$3,000,000.00; and
3. Nine and one-half percent (9-1/2%) of all amounts in excess of \$3,000,000.00.

C. Applicant shall pay for utility charges.

SECURITY DEPOSIT:

Not applicable

HOLDOVER TENANCY:

Not applicable

DCCA VERIFICATION:

Place of business registration confirmed:	YES <u>X</u>	NO _____
Registered business name confirmed:	YES <u>X</u>	NO _____
Good standing confirmed:	YES <u>X</u>	NO _____

CHAPTER 343, HRS – ENVIRONMENTAL ASSESSMENT:

Pursuant to Section 11-200-8 (a), Environmental Impact Statement Rules of the Department of Health, State of Hawai‘i, this disposition is exempt from requirements regarding preparation of an environmental assessment, negative declaration, or environmental impact statement as required by Chapter 343, Hawai‘i Revised Statutes, as amended, relating to Environmental Impact Statements because the proposed action falls within Exemption Class #1, Comprehensive Exemption List for the State of Hawai‘i Department of Transportation Amended November 15, 2000, as approved by the Environmental Quality Council. Exemption Class #1 covers operations, repairs, or maintenance of existing structures, facilities, equipment, or topographical features involving negligible or no expansion or change of use beyond that previously existing.

REMARKS:

Blind Vendors Ohana, Inc. has been successfully operating the newsstands at Honolulu International Airport under the terms of the Settlement Agreement since June 1, 1994. Therefore, in accordance with Section 171-55, HRS, relating to Permits, the Department of Transportation proposes to issue a month-to-month revocable permit to Blind Vendors Ohana, Inc., for three additional newsstands at Honolulu International Airport.

RECOMMENDATION:

That the Board authorize the Department of Transportation to issue a month-to-month revocable permit to Blind Vendors Ohana, Inc., subject to: (1) terms and conditions herein outlined, which are by reference incorporated herein; and (2) such additional terms and conditions as may be prescribed by the Director of Transportation to best serve the interests of the State.

Respectfully submitted,



FORD N. FUCHIGAMI  
Director of Transportation

APPROVAL FOR SUBMITTAL:

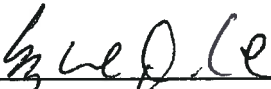

SUZANNE D. CASE  
Chairperson and Member

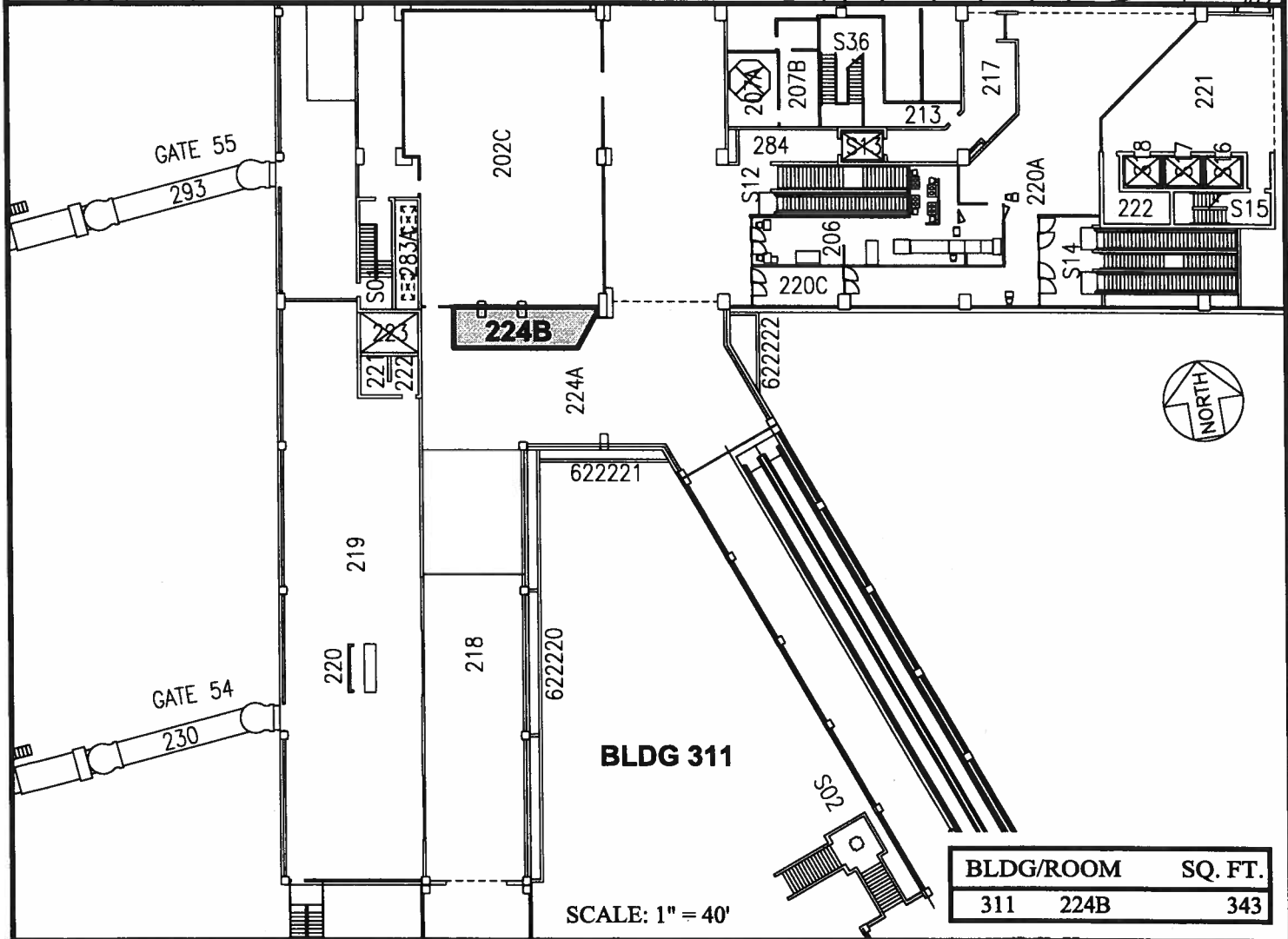
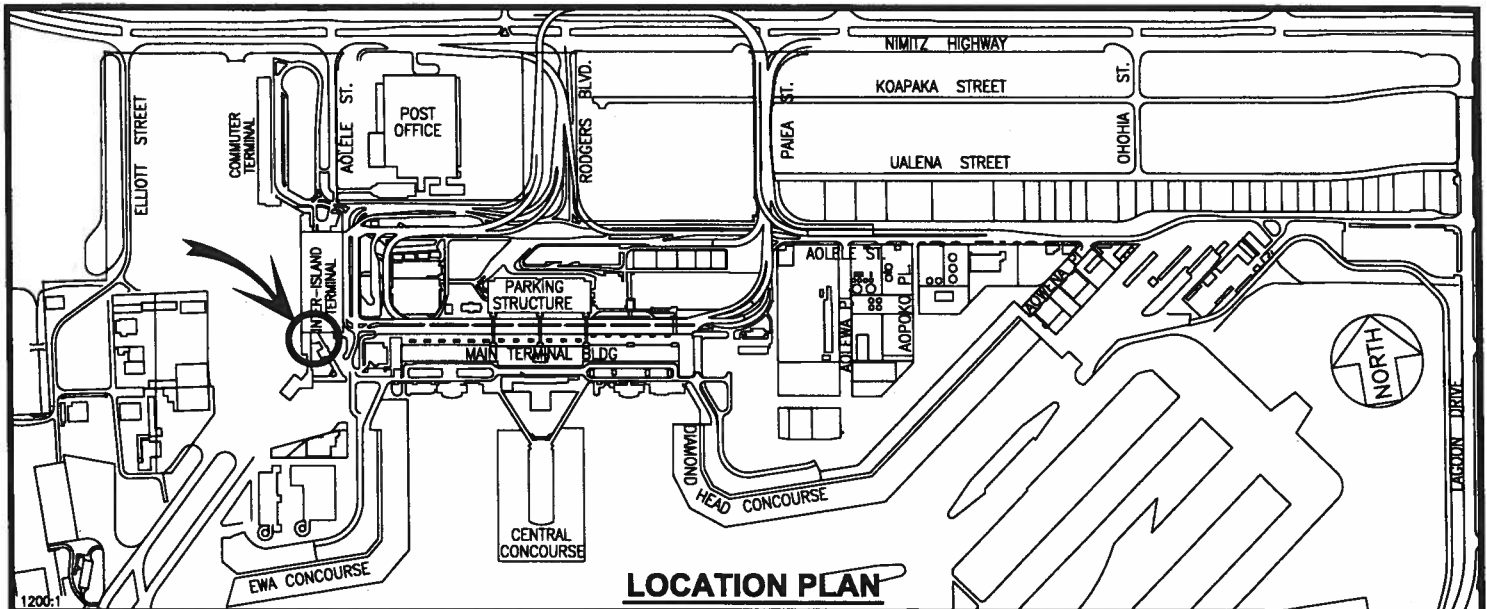

RP-8607

DATE : JANUARY 2017

EXHIBIT: A



Airports Division

BLIND VENDORS  
OHANA, INC.

BUILDING 311  
MAKAI PIER  
SECOND LEVEL

311224B

PLAT E2

**HONOLULU INTERNATIONAL AIRPORT**

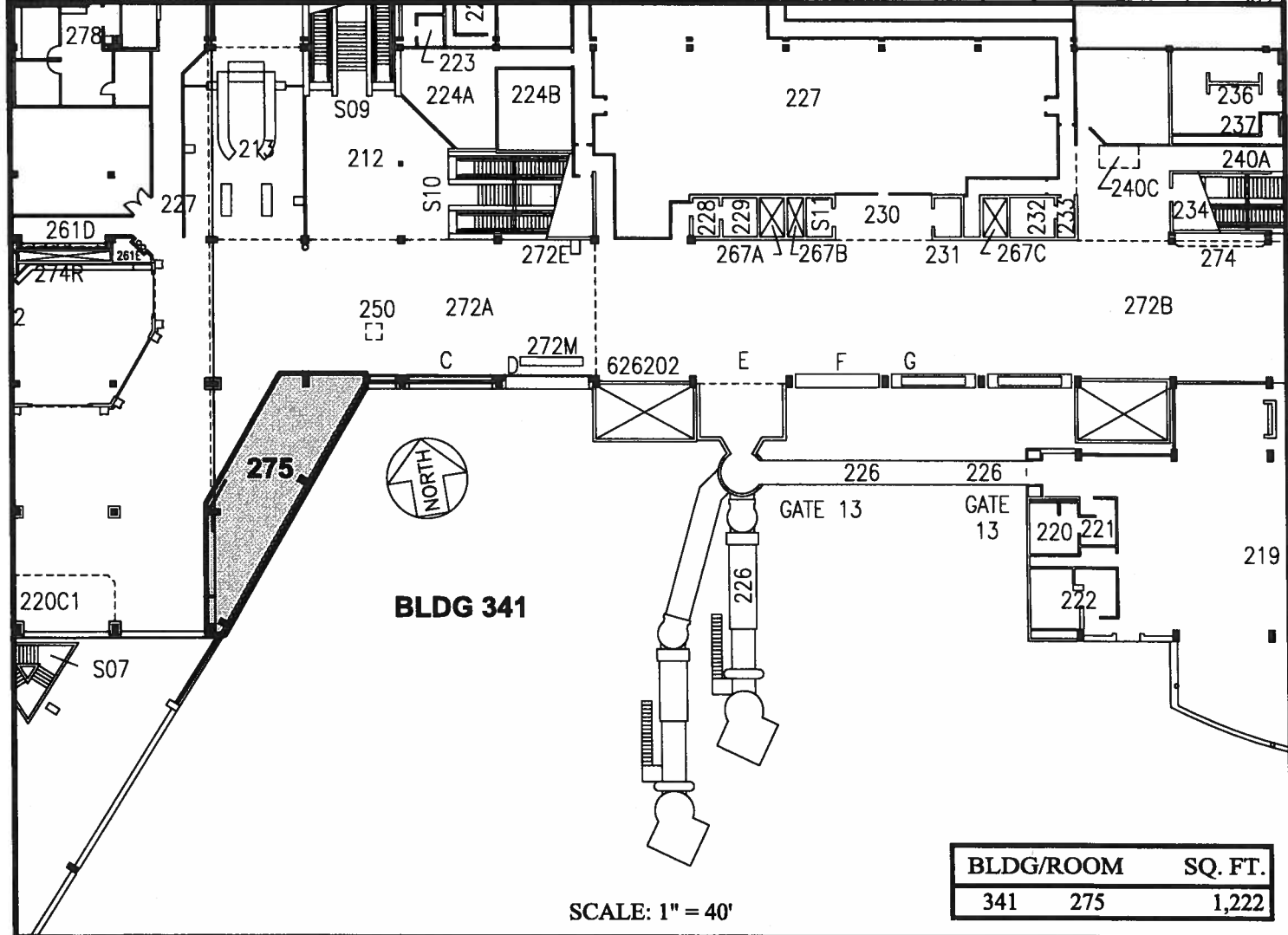
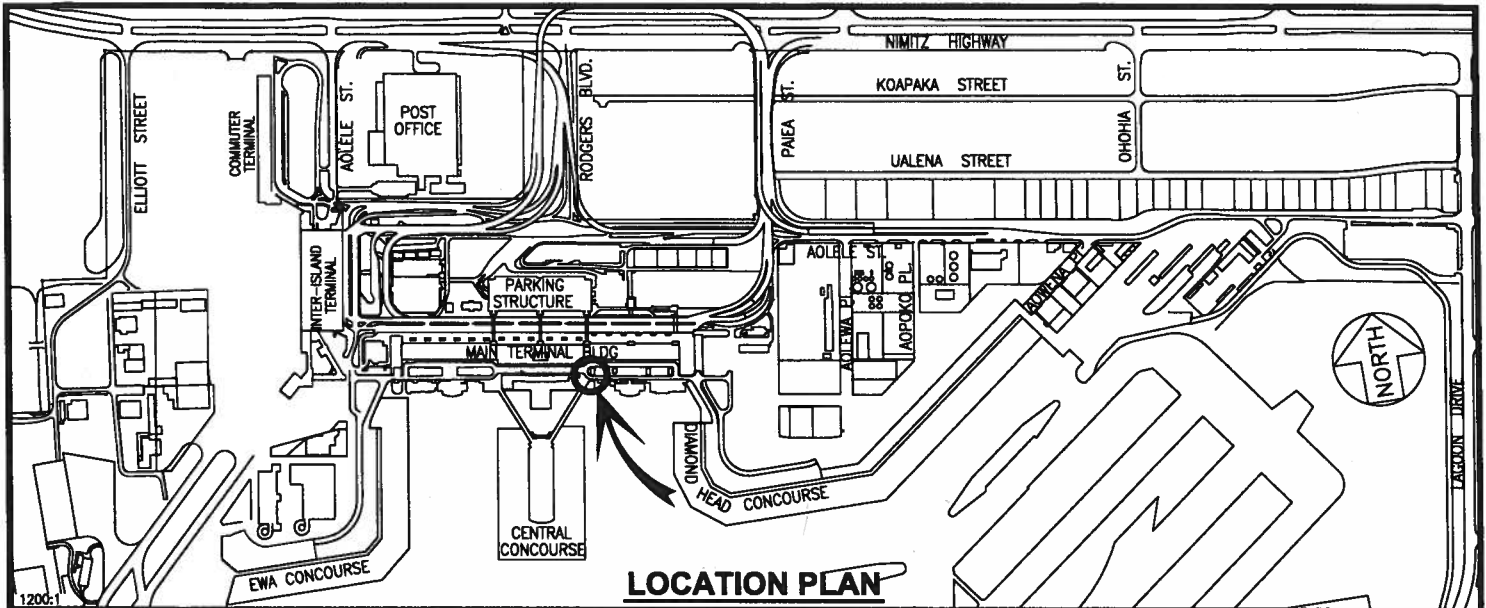

RP-8607	DATE : JANUARY 2017	EXHIBIT: B
Airports Division	BLIND VENDORS OHANA, INC.	BUILDING 341 DIAMOND HEAD EXTENSION SECOND LEVEL 341275 PLAT C1

**HONOLULU INTERNATIONAL AIRPORT**

N:\AIRPORTS\HNL\_HONOLULU\CAD\PM\HNL\_341275-01.DWG

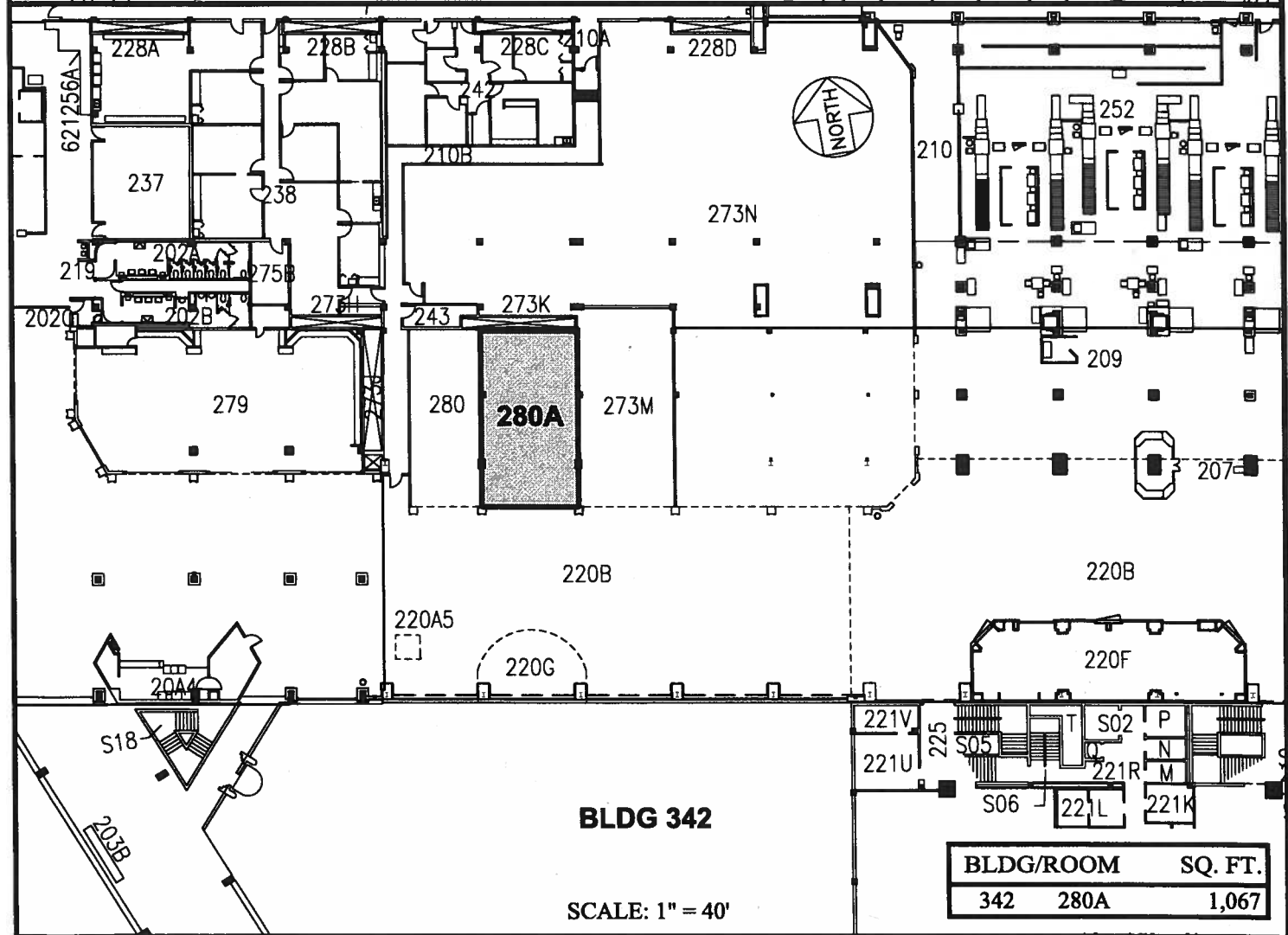
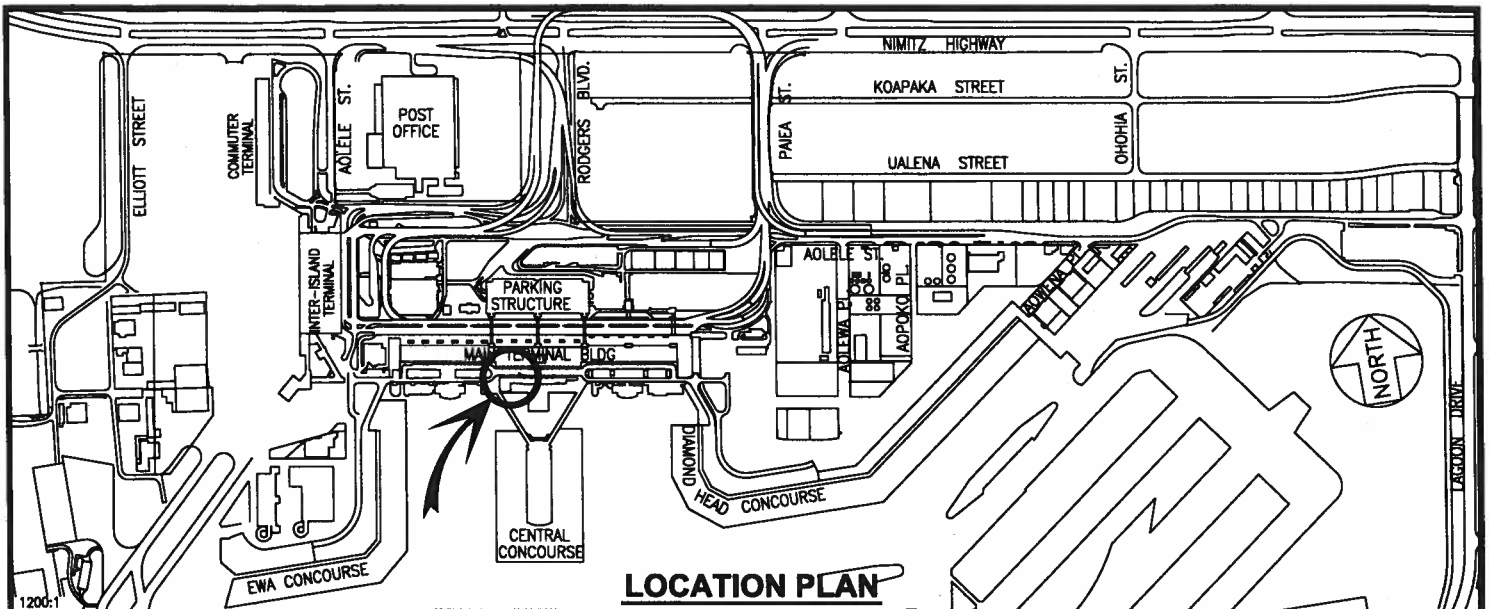

RP-8607

DATE : JANUARY 2017

EXHIBIT: C



Airports Division

BLIND VENDORS  
OHANA, INC.

BUILDING 342  
WAITING LOBBY  
SECOND LEVEL

342280A  
PLAT A2

HONOLULU INTERNATIONAL AIRPORT