

DAVID Y. IGE
GOVERNOR



STATE OF HAWAII
DEPARTMENT OF TRANSPORTATION
869 PUNCHBOWL STREET
HONOLULU, HAWAII 96813-5097

FORD N. FUCHIGAMI
DIRECTOR

Deputy Directors
JADE T. BUTAY
ROSS M. HIGASHI
EDWIN H. SNIFFEN
DARRELL T. YOUNG

IN REPLY REFER TO:
AIR-PM

Board of Land and
Natural Resources
State of Hawai'i
Honolulu, Hawai'i

ISSUANCE OF A REVOCABLE PERMIT FOR AIRCRAFT PARKING
JAMES EALER
KAHULUI AIRPORT
TAX MAP KEY: (2) 3-8-01: PORTION OF 19

MAUI

REQUEST:

Issuance of a revocable permit for aircraft parking (parking permit) to James Ealer

LEGAL REFERENCE:

Sections 171-55, Hawai'i Revised Statutes

APPLICANT:

James Ealer whose business address is 712 Upper Kimo Drive, Kula, Hawai'i 96790

LOCATION AND TAX MAP KEY:

Portion of Kahului Airport (OGG), Kahului, Island of Maui, identified by
Tax Map Key: 2nd Division, 3-8-01: Portion of 19

AREAS:

Area/Space No. 408-105, containing an area of approximately 900 square feet as shown
on the attached Exhibit A.

ZONING:

State Land Use District:
County of Maui:

Urban
Airport

ITEM M-6

BLNR – ISSUANCE OF A REVOCABLE PERMIT FOR AIRCRAFT PARKING
JAMES EALER, KAHULUI AIRPORT
Page 2

LAND TITLE STATUS:

Section 5(a) lands of the Hawai'i Admission Act: Non-Ceded
DHHL 30% entitlement lands pursuant to Hawai'i Admission Act YES___ NO X

CURRENT USE STATUS:

Airport purposes

CHARACTER OF USE:

Aircraft parking for tie-down

COMMENCEMENT DATE:

Upon complete execution of the revocable permit

MONTHLY RENTAL:

\$ 96.00 (as determined from the DOTA schedule of rates and charges established by appraisal of Airports property statewide).

SECURITY DEPOSIT:

\$ 288.00, or three times the monthly rental in effect

DCCA VERIFICATION:

Place of business registration confirmed: N/A
Registered business name confirmed: N/A
Good standing confirmed: N/A

REMARKS:

The issuance of a parking permit for an aircraft tie-down to James Ealer, at OGG complies with Chapter 343, Exemption Class 1.D.10. as continuing aeronautical use, and is in accordance with Section 171-55 HRS, relating to Permits.

RECOMMENDATION:

That the Board authorize the Department of Transportation to issue a month-to-month parking permit to James Ealer, subject to: (1) terms and conditions herein outlined, which are by reference incorporated herein; and (2) such additional terms and conditions as may be prescribed by the Director of Transportation to best serve the interests of the State.

Respectfully submitted,



FORD N. FUCHIGAMI
Director of Transportation

APPROVED FOR SUBMITTAL:



SUZANNE D. CASE
Chairperson and Member

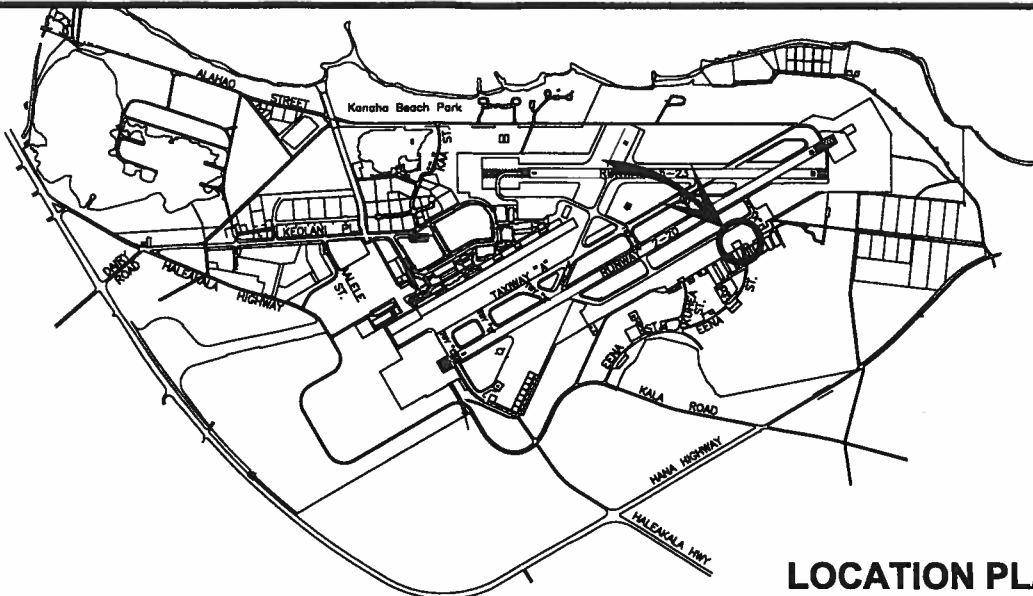

3000:1

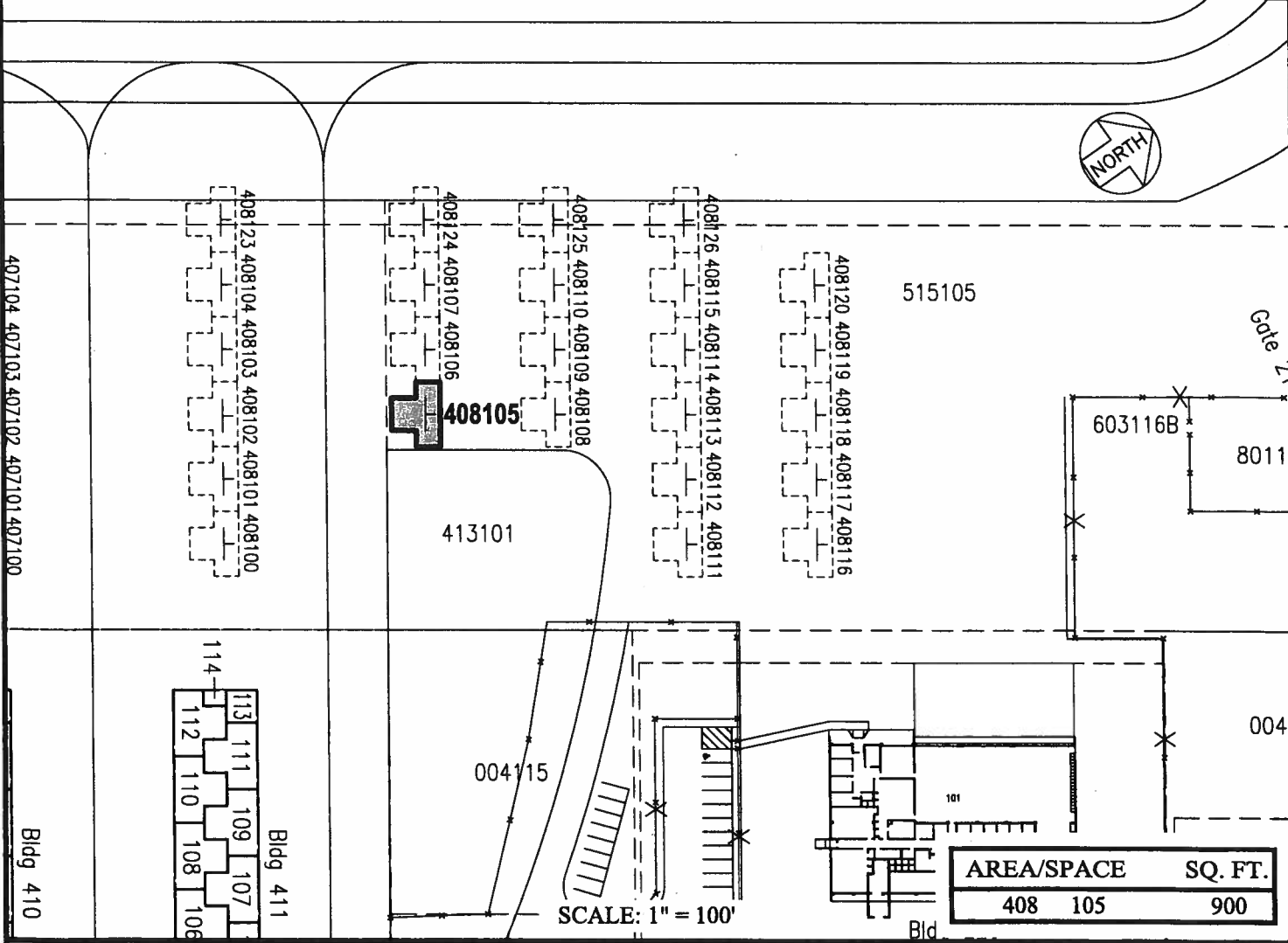

DATE : FEBRUARY 2017

EXHIBIT: A

DEPARTMENT OF TRANSPORTATION
STATE OF HAWAII
Airports Division

JAMES EALER

TIE-DOWN

408105
PLAT G1

KAHULUI AIRPORT

N:\AIRPORTS\OGG_Kahului\CAD\PM\agg_408105-01.dwg