

DAVID Y. IGE
GOVERNOR



STATE OF HAWAII
DEPARTMENT OF TRANSPORTATION
869 PUNCHBOWL STREET
HONOLULU, HAWAII 96813-5097

FORD N. FUCHIGAMI
DIRECTOR

Deputy Directors
JADE T. BUTAY
ROSS M. HIGASHI
EDWIN H. SNIFFEN
DARRELL T. YOUNG

IN REPLY REFER TO:

Board of Land and
Natural Resources
State of Hawai'i
Honolulu, Hawai'i

ISSUANCE OF A REVOCABLE PERMIT FOR AIRCRAFT PARKING
EDUARDO S. ACUNA
HONOLULU INTERNATIONAL AIRPORT
TAX MAP KEY: (1) 1-1-76: PORTION OF 23

O'AHU

REQUEST:

Issuance of a Revocable Permit for Aircraft Parking (Parking Permit) to
Eduardo S. Acuna, situated at Honolulu International Airport.

LEGAL REFERENCE:

Section 171-55, Hawai'i Revised Statutes

APPLICANT:

Eduardo S. Acuna, whose mailing address is 92-614 Anipeahi Street,
Kapolei, Hawai'i 96707-1014.

LOCATION AND TAX MAP KEY:

A portion of Honolulu International Airport, identified as the South Ramp,
Tax Map Key: 1st Division, 1-1-76: portion of 23

AREA:

Area/Space No. 423-189C, containing an area of approximately 1,305 square feet,
as shown and delineated on the attached map labeled Exhibit "A".

ZONING:

State Land Use District: Urban
City and County of Honolulu LUO: Industrial (I-2)

ITEM M-1

BLNR – ISSUANCE OF A REVOCABLE PERMIT FOR AIRCRAFT PARKING
EDUARDO S. ACUNA

Page 2

LAND TITLE STATUS:

Non-ceded - Section 5(a) lands of the Hawai'i Admission Act
DHHL 30% entitlement lands pursuant to Hawai'i Admission Act YES ___ NO X

CURRENT USE STATUS:

Land presently encumbered by Governor's Executive Order No. 3201, dated June 8, 1983, setting aside 3,152.177 acres designated as Honolulu International Airport under the control and management of the State of Hawai'i, Department of Transportation, Airports Division for Airport Purposes.

CHARACTER OF USE:

Aircraft Tie-down (1969 Cessna 177A, Tail No. N-30599)

COMMENCEMENT DATE:

To be determined by the Director of Transportation at a later date.

MONTHLY RENTAL:

\$96.00 (as determined from the DOTA schedule of rates and charges established by appraisal of Airports property statewide)

SECURITY DEPOSIT:

Three (3) times the monthly rental in effect.

CHAPTER 343, HRS - ENVIRONMENTAL ASSESSMENT:

Pursuant to Section 11-200-8(a), Environmental Impact Statement Rules of the Department of Health, State of Hawai'i, this disposition is exempt from requirements regarding preparation of an environmental assessment, negative declaration, or environmental impact statement as required by Chapter 343, Hawai'i Revised Statutes, as amended, relating to Environmental Impact Statements, because the proposed action falls within Exemption Class #1, Comprehensive Exemption List for the State of Hawai'i, Department of Transportation, dated November 15, 2000, as approved by the Environmental Quality Council. Exemption Class #1 covers operations, repairs, or maintenance of existing structures, facilities, equipment, or topographical features involving negligible or no expansion or change of use beyond that previously existing.

BLNR – ISSUANCE OF A REVOCABLE PERMIT FOR AIRCRAFT PARKING
EDUARDO S. ACUNA

Page 3

REMARKS:

The issuance of a Parking Permit to Eduardo S. Acuna, at Honolulu International Airport complies with Chapter 343, Exemption Class 1.D.10 as a continuing aeronautical use, and is in accordance with Section 171-55 HRS, relating to Permits.

RECOMMENDATION:

That the Board authorize the Department of Transportation to issue a month-to-month Parking Permit to Eduardo S. Acuna, subject to: (1) terms and conditions herein outlined, which are by reference incorporated herein; and (2) such additional terms and conditions as may be prescribed by the Director of Transportation to best serve the interests of the State.

Respectfully submitted,



FORD N. FUCHIGAMI
Director of Transportation

APPROVED FOR SUBMITTAL:

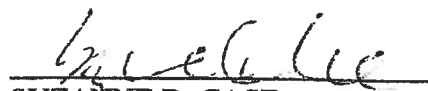

SUZANNE D. CASE
Chairperson and Member

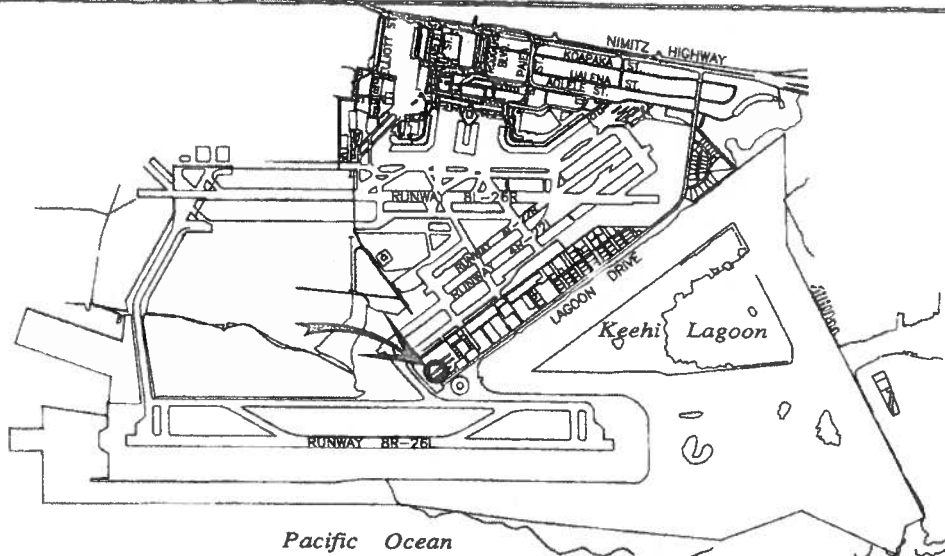

5000:1

LOCATION PLAN

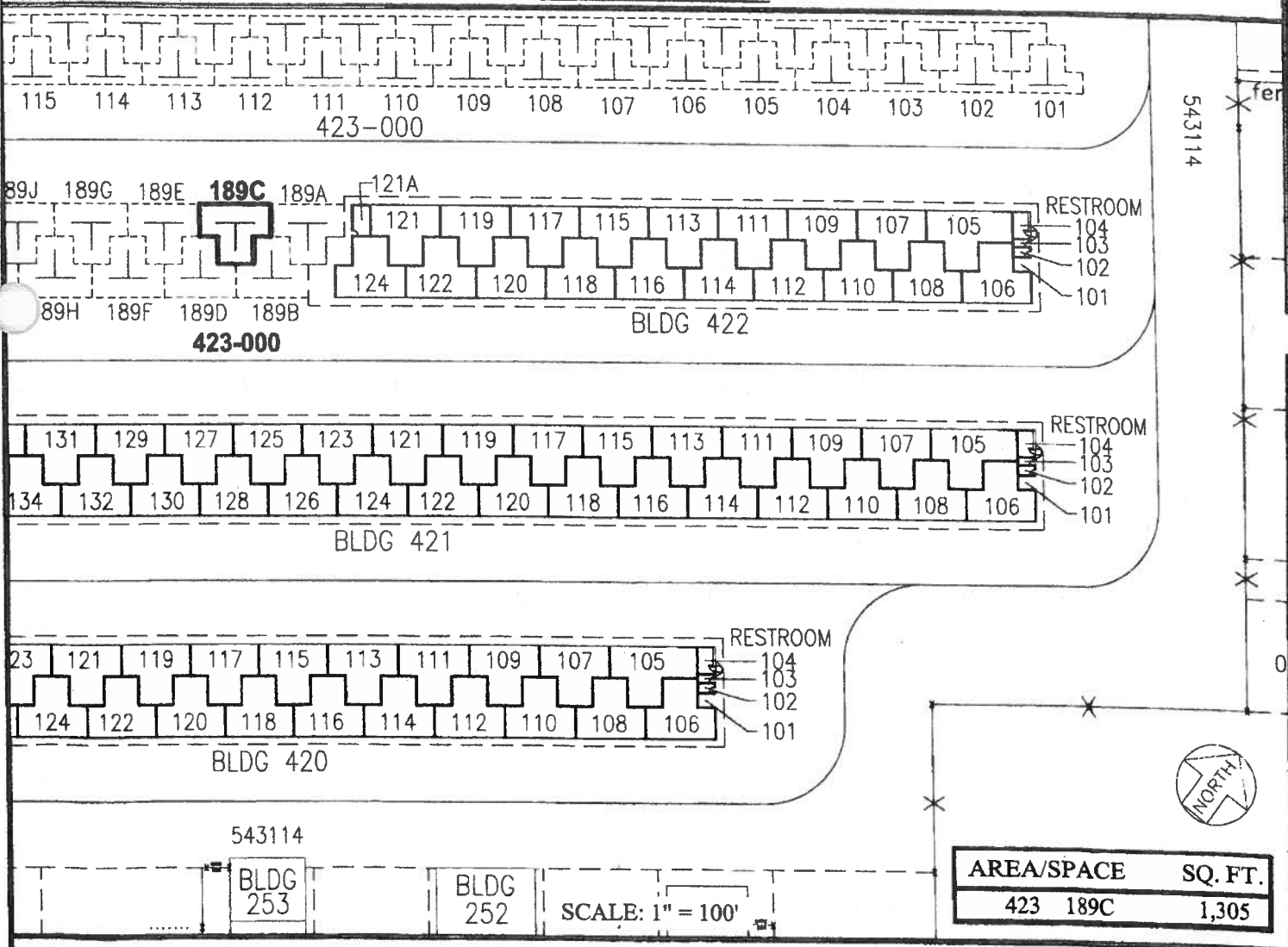

Airports Division

DATE : AUGUST 2009

EXHIBIT: **A**

**GENERAL AVIATION
FACILITIES
SOUTH RAMP**

**423189C
PLAT 45**

HONOLULU INTERNATIONAL AIRPORT

N:\AIRPORTS\HNL_HONOLULU\CAD\PM\HNL_423189C-01.DWG