

DAVID Y. IGE  
GOVERNOR



STATE OF HAWAII  
DEPARTMENT OF TRANSPORTATION  
869 PUNCHBOWL STREET  
HONOLULU, HAWAII 96813-5097

FORD N. FUCHIGAMI  
DIRECTOR

Deputy Directors  
JADE T. BUTAY  
ROSS M. HIGASHI  
EDWIN H. SNIFFEN  
DARRELL T. YOUNG

IN REPLY REFER TO:

Board of Land and  
Natural Resources  
State of Hawai'i  
Honolulu, Hawai'i

ISSUANCE OF A REVOCABLE PERMIT FOR  
VEHICLE AND EQUIPMENT PARKING  
LANDSCAPE HAWAII, INC.  
2805 UALENA STREET  
HONOLULU INTERNATIONAL AIRPORT  
TAX MAP KEY: (1) 1-1-04: PORTION OF 01

O'AHU

LEGAL REFERENCE:

Section 171-55, Hawai'i Revised Statutes

APPLICANT:

Landscape Hawaii, Inc., whose mailing address is 2621 Waiwai Loop,  
Honolulu, Hawai'i 96819.

LOCATION:

Portion of Honolulu International Airport, Island of Oahu, State of Hawai'i, identified as  
Tax Map Key: 1st Division, 1-1-04: Portion of 01.

AREA:

Area/Space No. 005-130A, containing an area of approximately 16,190 square feet,  
as shown and delineated on the attached map labeled Exhibit "A".

ZONING:

State Land Use District: Urban  
City and County of Honolulu LUO: Industrial (I2)

**ITEM M-6**

BLNR – ISSUANCE OF A REVOCABLE PERMIT  
FOR VEHICLE AND EQUIPMENT PARKING  
LANDSCAPE HAWAII, INC.

Page 2

LAND TITLE STATUS:

Non-ceded - Section 5(a) lands of the Hawai'i Admission Act  
DHHL 30% entitlement lands pursuant to Hawai'i Admission Act YES \_\_\_ NO X

CURRENT USE STATUS:

Land presently encumbered by Governor's Executive Order No. 3894, setting aside a portion of Honolulu International Airport under the control and management of the DOT for Airport Purposes.

The DOT acquired the subject property, together with most of the remaining properties (except one) along the ocean (makai) side of Ualena Street, between Lagoon Drive and Paiea Street, in the mid-1990's from Loyalty Enterprises, Ltd.

CHARACTER OF USE:

Vehicle and equipment parking.

COMMENCEMENT DATE:

Upon execution of the revocable permit.

MONTHLY RENTAL:

\$8,486.26 (based upon the Fair Market Rental for Ualena Street Properties dated November 2012)

SECURITY DEPOSIT:

Three (3) times the monthly rent in effect.

DCCA VERIFICATION:

Place of business registration confirmed: YES X NO \_\_\_  
Registered business name confirmed: YES X NO \_\_\_  
Good standing confirmed: YES X NO \_\_\_

BLNR – ISSUANCE OF A REVOCABLE PERMIT  
FOR VEHICLE AND EQUIPMENT PARKING  
LANDSCAPE HAWAII, INC.

Page 3

CHAPTER 343, HRS - ENVIRONMENTAL ASSESSMENT:

Pursuant to Section 11-200-8(a), Environmental Impact Statement Rules of the Department of Health, State of Hawai‘i, this disposition is exempt from requirements regarding preparation of an environmental assessment, negative declaration, or environmental impact statement as required by Chapter 343, Hawai‘i Revised Statutes, as amended, relating to Environmental Impact Statements, because the proposed action falls within Exemption Class #1, Comprehensive Exemption List for the State of Hawai‘i, Department of Transportation, dated November 15, 2000, as approved by the Environmental Quality Council. Exemption Class #1 covers operations, repairs, or maintenance of existing structures, facilities, equipment, or topographical features involving negligible or no expansion or change of use beyond that previously existing.

REMARKS:

In accordance with Section 171-55, HRS, relating to Permits, the Department of Transportation proposes to issue a month-to-month revocable permit to Landscape Hawaii, Inc. for vehicle and equipment parking at Honolulu International Airport.

RECOMMENDATION:

That the Board authorize the Department of Transportation to issue a month-to-month revocable permit to Landscape Hawaii, Inc., subject to: (1) terms and conditions herein outlined, which are by reference incorporated herein; and (2) such additional terms and conditions as may be prescribed by the Director of Transportation to best serve the interests of the State.

Respectfully submitted,



FORD N. FUCHIGAMI  
Director of Transportation

APPROVED FOR SUBMITTAL:

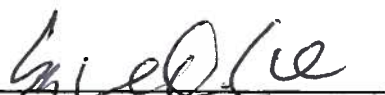

SUZANNE D. CASE  
Chairperson and Member

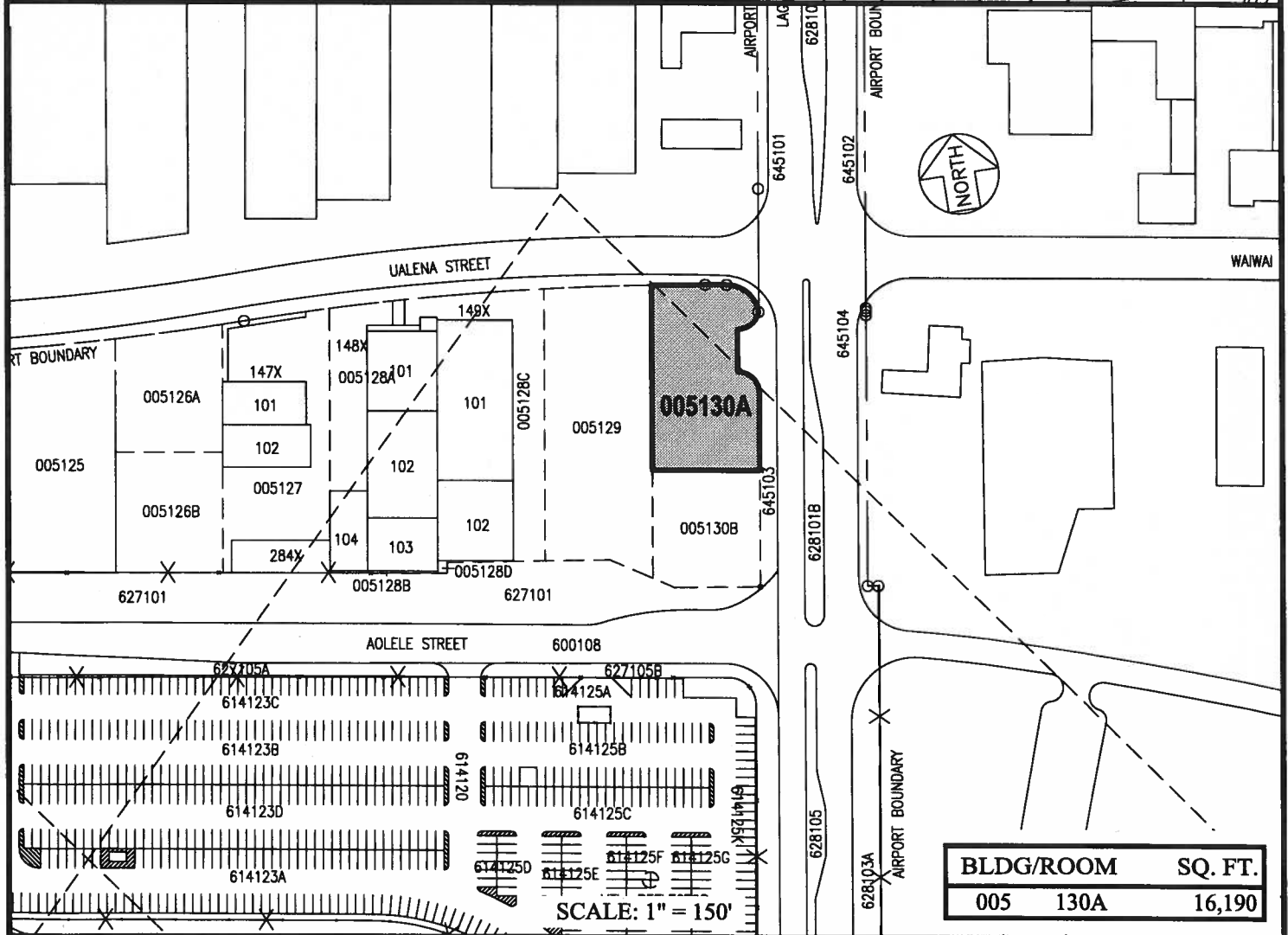
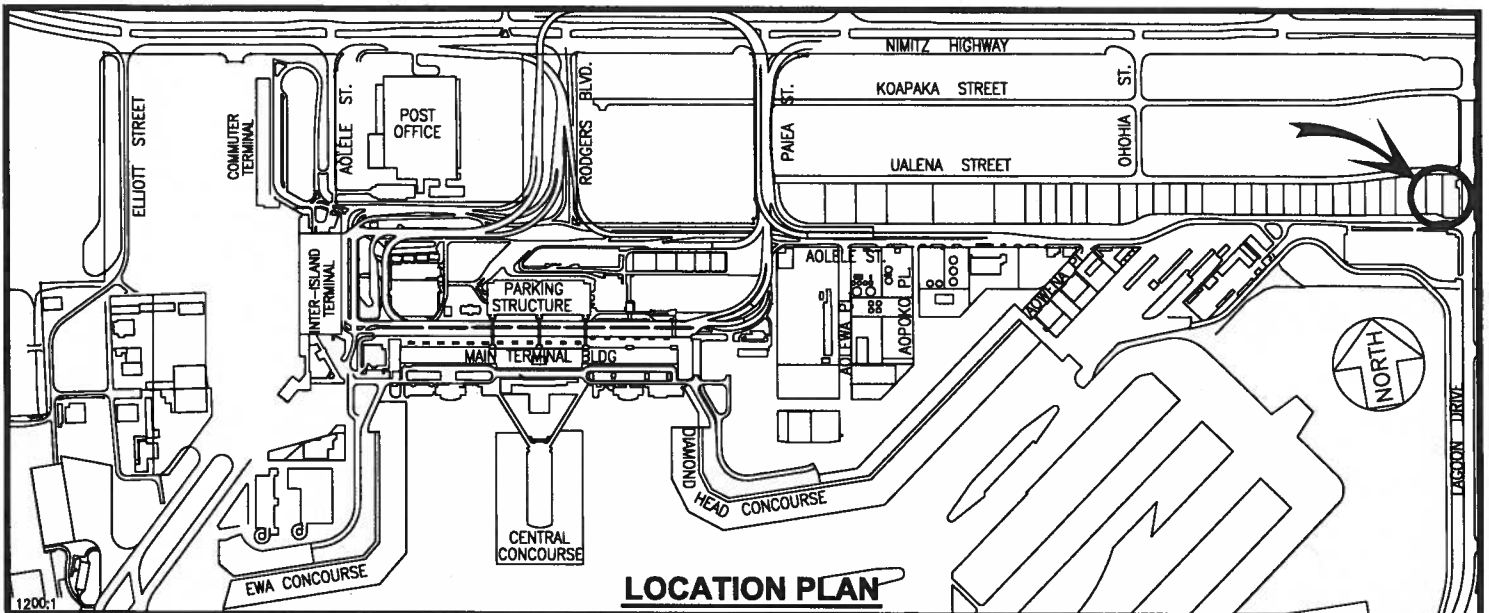

RP-8621

DATE : APRIL 2017

EXHIBIT: **A**



Airports Division

LANDSCAPE HAWAII, INC.

2805 UALENA STREET

005130A

PLAT 27

**HONOLULU INTERNATIONAL AIRPORT**