



STATE OF HAWAII
DEPARTMENT OF TRANSPORTATION
869 PUNCHBOWL STREET
HONOLULU, HAWAII 96813-5097

Board of Land and
Natural Resources
State of Hawai'i
Honolulu, Hawai'i

ISSUANCE OF A REVOCABLE PERMIT TO INDEX BUILDERS, INC.
FOR STORAGE SPACE AND ROLL OFF BIN/STAGING AREA
FOR CONSTRUCTION MATERIALS AND EQUIPMENT
HONOLULU INTERNATIONAL AIRPORT O'AHU
TAX MAP KEYS: (1) 1-1-003: 65 (PORTION) AND (1) 1-1-003: 001 (PORTION)

APPLICANT:

Index Builders, Inc., whose business address is 1019 Lauia Street, Unit 3,
Kapolei, Hawai'i 96707.

LEGAL REFERENCE:

Section 171-55, Hawai'i Revised Statutes

LOCATION:

Building No. 373, Diamond Head Concourse, Ground Level, Space No. 161C and
Area No. 540, Space No. 103C at Honolulu International Airport, identified by
Tax Map Keys: 1st Division, 1-1-003: 65 (Portion) and 1-1-003: 001 (Portion).

AREA:

Building/Room No. 373-161C, containing an area of approximately 476 square feet, and
Area/Space No. 540-103C, containing an area of approximately 2,522 square feet,
as shown and delineated on the attached map labeled Exhibits "A" and "B".

ZONING:

State Land Use District: Urban
City and County of Honolulu LUO: Industrial (I-2)

BLNR – ISSUANCE OF A REVOCABLE PERMIT TO INDEX BUILDERS, INC.
FOR STORAGE SPACE AND ROLL OFF BIN/STAGING AREA
FOR CONSTRUCTION MATERIALS AND EQUIPMENT

Page 2

LAND TITLE STATUS:

Non-ceded - Section 5(a) lands of the Hawai'i Admission Act
DHHL 30% entitlement lands pursuant to Hawai'i Admission Act YES ___ NO X

CURRENT USE STATUS:

Land presently encumbered by Governor's Executive Order No. 3201, dated June 8, 1983, setting aside 3,152.177 acres designated as Honolulu International Airport under the control and management of the State of Hawai'i, Department of Transportation, Airports Division for Airport Purposes.

CHARACTER OF USE:

Index Builders, Inc. will use the space for storage space and a roll off bin/staging area for construction materials and equipment, at no charge, as specifically stated under Contract No. 65004, State Project No. AO1035-17, HNL DH Concourse Improvements, Honolulu International Airport.

COMMENCEMENT DATE:

To be determined by the Director of Transportation at a later date.

MONTHLY RENTAL:

Not applicable (NA)

SECURITY DEPOSIT:

NA

DCCA VERIFICATION:

Place of business registration confirmed:	YES <u>X</u>	NO ___
Registered business name confirmed:	YES <u>X</u>	NO ___
Good standing confirmed:	YES <u>X</u>	NO ___

CHAPTER 343, HRS - ENVIRONMENTAL ASSESSMENT:

Pursuant to Section 11-200-8(a), Environmental Impact Statement Rules of the Department of Health, State of Hawai'i, this disposition is exempt from requirements regarding preparation of an environmental assessment, negative declaration, or

BLNR – ISSUANCE OF A REVOCABLE PERMIT TO INDEX BUILDERS, INC.
FOR STORAGE SPACE AND ROLL OFF BIN/STAGING AREA
FOR CONSTRUCTION MATERIALS AND EQUIPMENT

Page 3

environmental impact statement as required by Chapter 343, Hawai‘i Revised Statutes, as amended, relating to Environmental Impact Statements, because the proposed action falls within Exemption Class #1, Comprehensive Exemption List for the State of Hawai‘i, Department of Transportation, dated November 15, 2000, as approved by the Environmental Quality Council. Exemption Class #1 covers operations, repairs, or maintenance of existing structures, facilities, equipment, or topographical features involving negligible or no expansion or change of use beyond that previously existing.

REMARKS:

The Department of Transportation proposes to issue a permit to Index Builders, Inc. for the use of the spaces for storage space and a roll off bin/staging area for construction materials and equipment, at no rent, as specifically stated under Contract No. 65004, State Project No. AO1035-17, HNL DH Concourse Improvements, Honolulu International Airport, Section 1.04, Provisions for Field Office/Storage Space: “Pending the availability of space on airport property, the State will issue a permit to the Contractor for the use of the space, at no charge, to be used specifically for a field office and/or storage of materials and equipment....”

RECOMMENDATION:

That the Board authorize the Department of Transportation to issue a month-to-month revocable permit to Index Builders, Inc., subject to: (1) terms and conditions herein outlined, which are by reference incorporated herein; and (2) such additional terms and conditions as may be prescribed by the Director of Transportation to best serve the interests of the State.

Respectfully submitted,



FORD N. FUCHIGAMI
Director of Transportation

APPROVED FOR SUBMITTAL:



SUZANNE D. CASE
Chairperson and Member

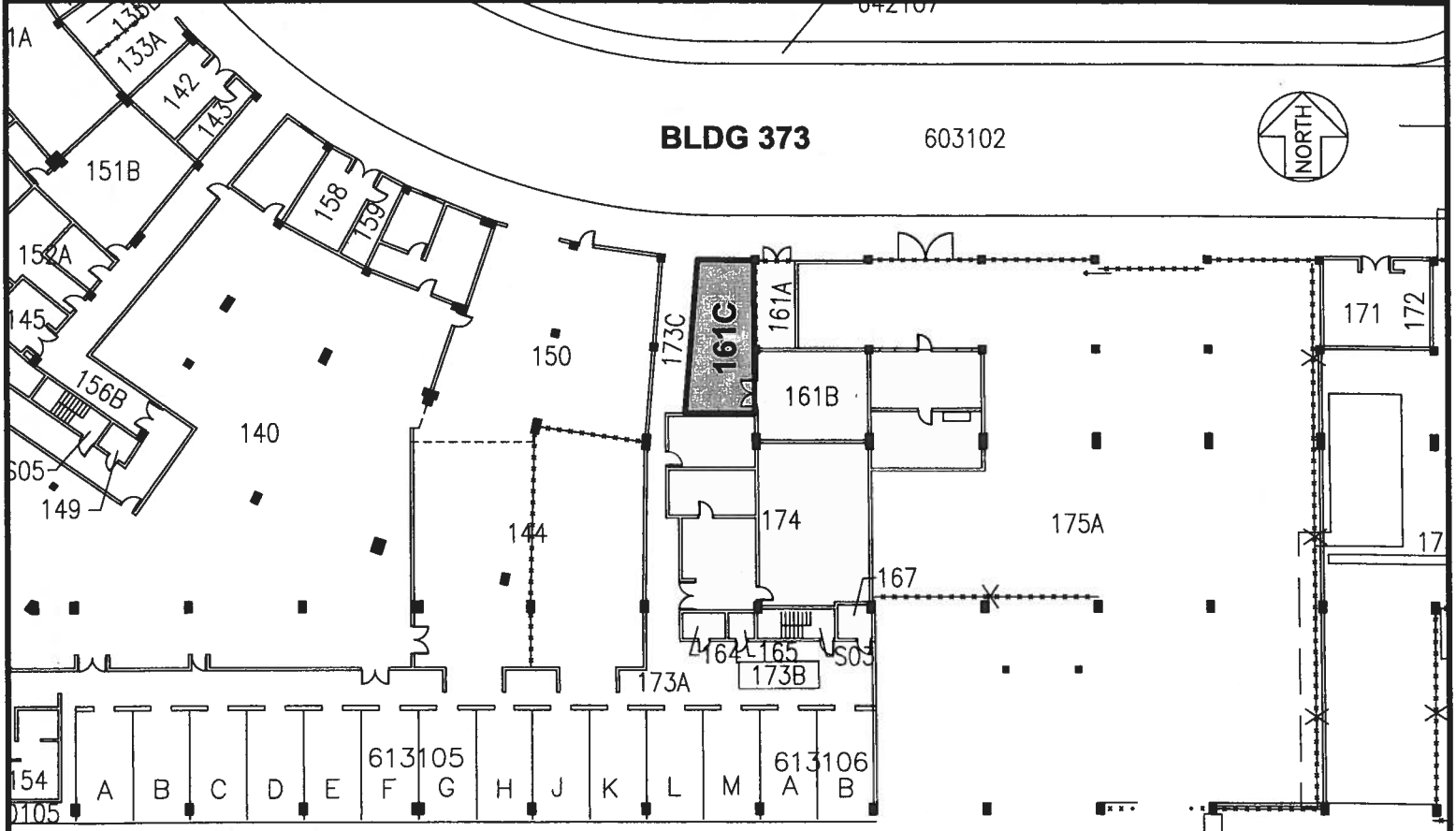
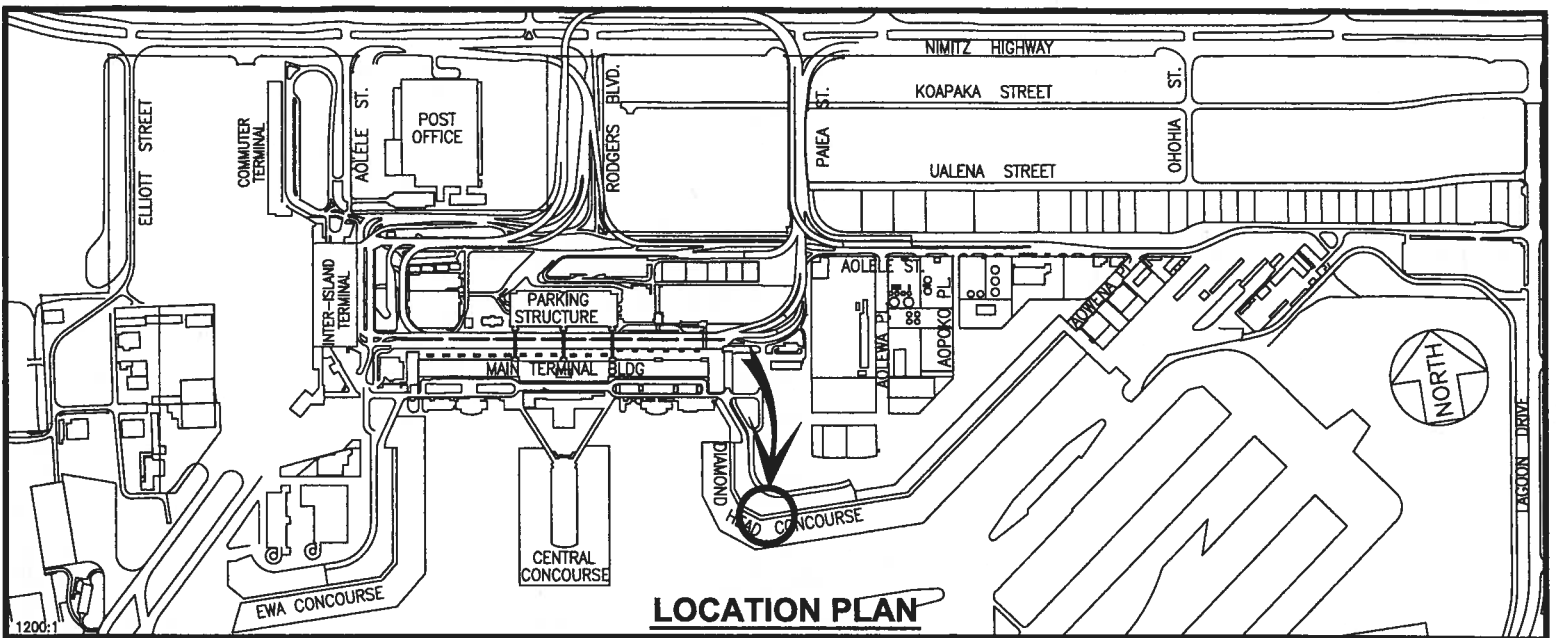

SCALE: 1" = 40'

BLDG/ROOM	SQ. FT.
373 161C	476

DATE : FEBRUARY 2017

EXHIBIT: **A**



Airports Division

INDEX BUILDERS

BUILDING 373
DIAMOND HEAD CONCOURSE
GROUND LEVEL

373161C
PLAT M1

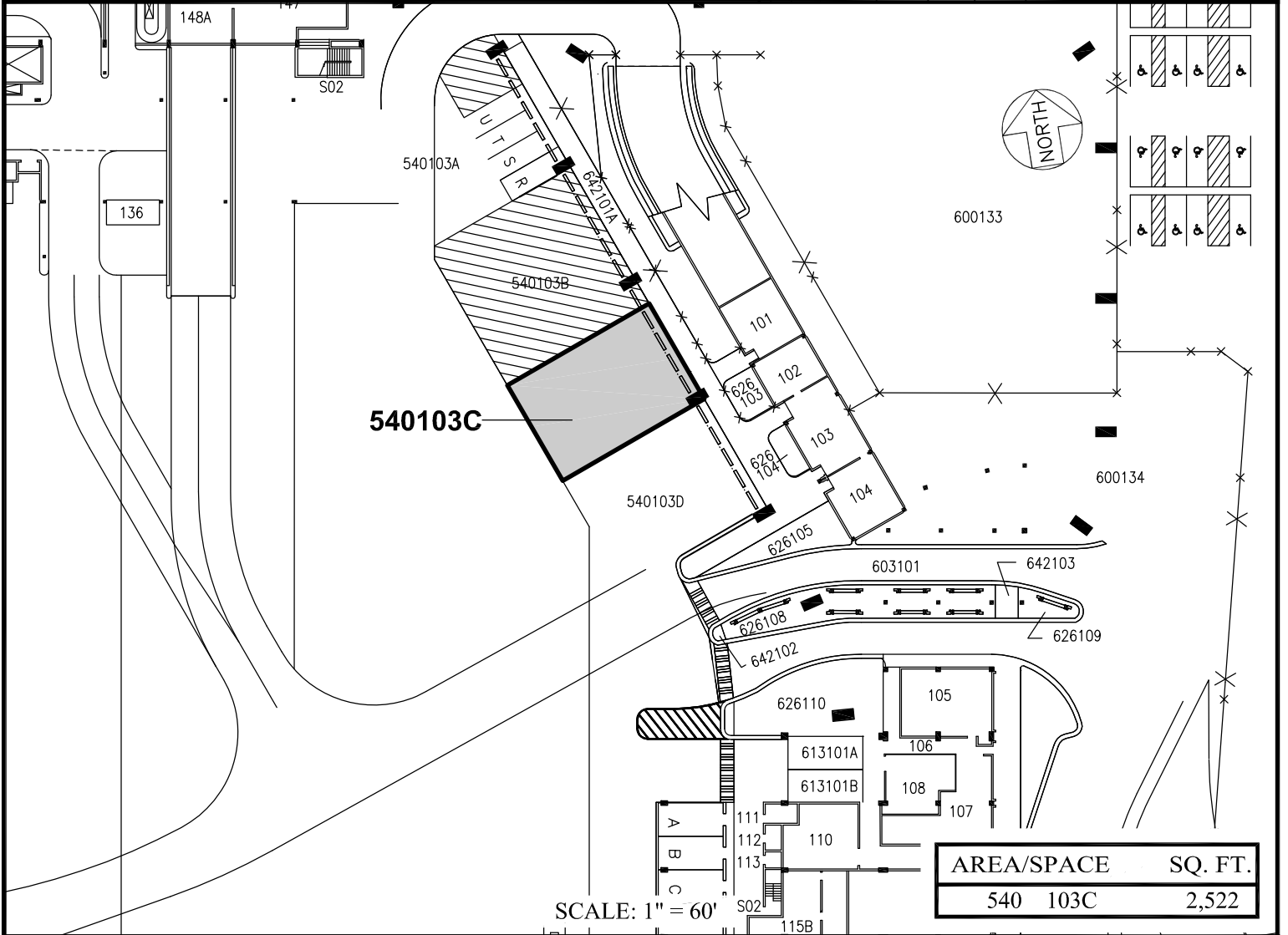
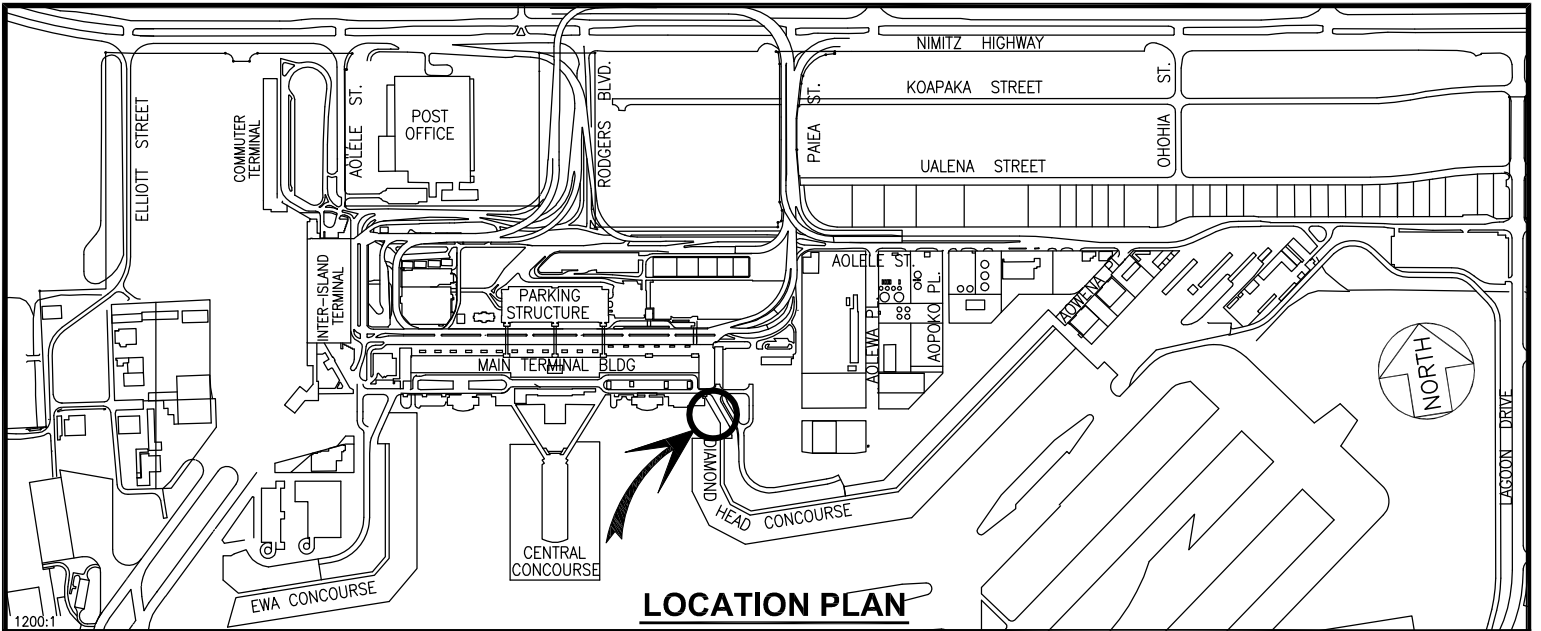

RP-8627

DATE : APRIL 2017

EXHIBIT: **B**



Airports Division

INDEX BUILDERS, INC.

APRON AREA
D.H. CONCOURSE
GROUND LEVEL

540103C
PLAT M1

HONOLULU INTERNATIONAL AIRPORT