

DAVID Y. IGE
GOVERNOR



STATE OF HAWAII
DEPARTMENT OF TRANSPORTATION
869 PUNCHBOWL STREET
HONOLULU, HAWAII 96813-5097

FORD N. FUCHIGAMI
DIRECTOR

Deputy Directors
JADE T. BUTAY
ROSS M. HIGASHI
EDWIN H. SNIFFEN
DARRELL T. YOUNG

IN REPLY REFER TO:

Board of Land and
Natural Resources
State of Hawai'i
Honolulu, Hawai'i

ISSUANCE OF A REVOCABLE PERMIT
FOR OFFICE SPACE IN THE MAIN TERMINAL
JAPAN AIRLINES CO., LTD.
KONA INTERNATIONAL AIRPORT AT KEĀHOLE
TAX MAP KEY: (3) 7-3-43: PORTION OF 40

HAWAII

LEGAL REFERENCE:

Sections 171-11 and 171-55, Hawai'i Revised Statutes

APPLICANT:

Japan Airlines Co., Ltd. (JAL), whose business address 300 Rodgers Boulevard, #12,
Honolulu, Hawai'i, 96819-1830

LOCATION AND TAX MAP KEY:

Portion of Kona International Airport at Keāhole (KOA), Kailua-Kona, Island of
Hawai'i, identified by Tax Map Key: 3rd Division, 7-3-43: Portion of 40

AREA:

Bldg/Room 374-101B in the Main Terminal, containing a total area of approximately 616
square feet shown on the attached Exhibit A.

ZONING:

State Land Use District:	Urban & Conservation
County of Hawai'i:	Industrial (MG-1a) and Open

ITEM M-10

BLNR – ISSUANCE OF A REVOCABLE PERMIT FOR OFFICE SPACE
IN THE MAIN TERMINAL, JAPAN AIRLINES CO., LTD.

Page 2

LAND TITLE STATUS:

Section 5(a) lands of the Hawai'i Admission Act: Ceded
DHHL 30% entitlement lands pursuant to Hawai'i Admission Act YES ___ NO X

CURRENT USE STATUS:

Airport and aeronautical purposes

CHARACTER OF USE:

Airline office in Main Terminal

COMMENCEMENT DATE:

July 1, 2017

MONTHLY RENTAL:

\$2,616.97

SECURITY DEPOSIT:

\$7,850.91

HOLDOVER TENANCY:

\$87.23

DCCA VERIFICATION:

Place of business registration confirmed:	YES <u>X</u>	NO _____
Registered business name confirmed:	YES <u>X</u>	NO _____
Good standing confirmed:	YES <u>X</u>	NO _____

CHAPTER 343, HRS - ENVIRONMENTAL ASSESSMENT:

Pursuant to Section 11-200-8(a), Environmental Impact Statement Rules of the Department of Health, State of Hawai'i, this disposition is exempt from requirements regarding preparation of an environmental assessment, negative declaration, or environmental impact statement as required by Chapter 343, Hawai'i Revised Statutes, as amended, relating to Environmental Impact Statements, because the proposed action falls

BLNR – ISSUANCE OF A REVOCABLE PERMIT FOR OFFICE SPACE
IN THE MAIN TERMINAL, JAPAN AIRLINES CO., LTD.

Page 3

environmental impact statement as required by Chapter 343, Hawai‘i Revised Statutes, as amended, relating to Environmental Impact Statements, because the proposed action falls within Exemption Class #1, Comprehensive Exemption List for the State of Hawai‘i, Department of Transportation, dated November 15, 2000, as approved by the Environmental Quality Council. Exemption Class #1 covers operations, repairs, or maintenance of existing structures, facilities, equipment, or topographical features involving negligible or no expansion or change of use beyond that previously existing.

REMARKS:

JAL will be resuming its non-stop daily flights between Tokyo and KOA after deleting the route in 2010 because of its financial struggles from a past bankruptcy. The flights will travel to and from Japan's Narita International Airport and KOA. Service to and from KOA will resume Sept. 15, 2017.

The Department of Transportation (DOT) has no objections to JAL's request and therefore, in accordance with Sections 171-11 and 171-55, HRS, relating to Public Purposes and Permits, respectively and therefore, the DOT proposes to issue a month-to-month revocable permit to JAL for office space in the Main Terminal.

RECOMMENDATION:

That the Board authorize the Department of Transportation to issue a month-to-month revocable permit to JAL, subject to: (1) terms and conditions herein outlined, which are by reference incorporated herein; and (2) such additional terms and conditions as may be prescribed by the Director of Transportation to best serve the interests of the State

Respectfully submitted,



FORD N. FUCHIGAMI
Director of Transportation

APPROVED FOR SUBMITTAL:



SUZANNE D. CASE
Chairperson and Member

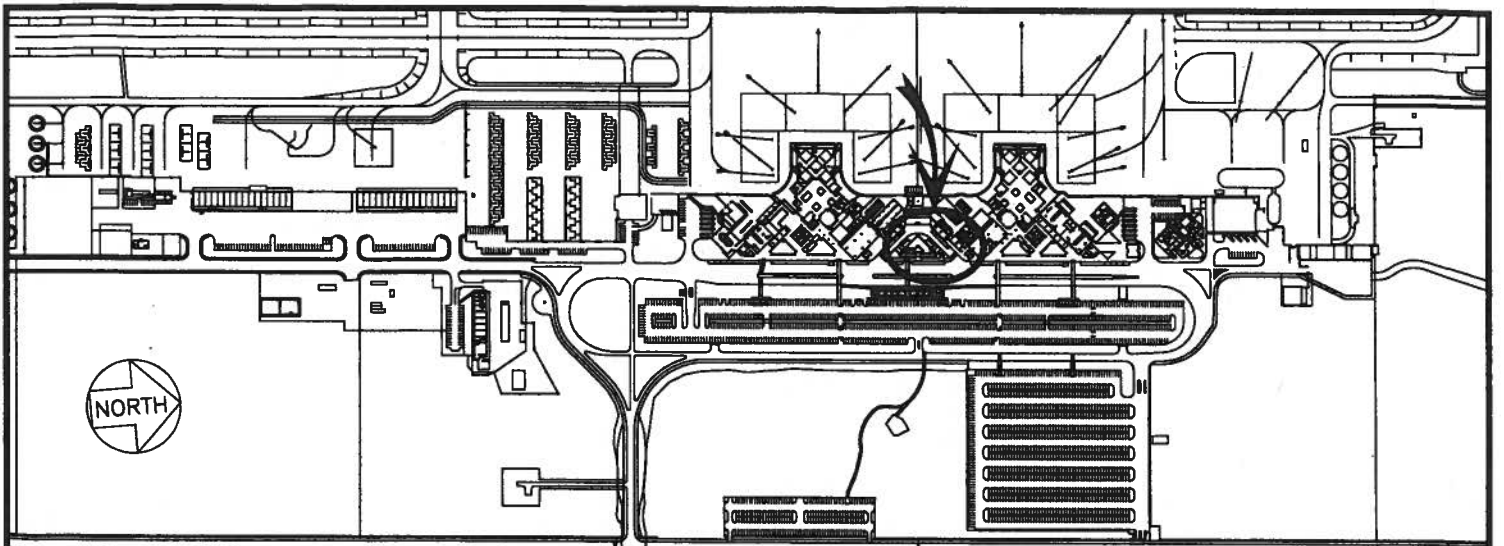

LOCATION PLAN

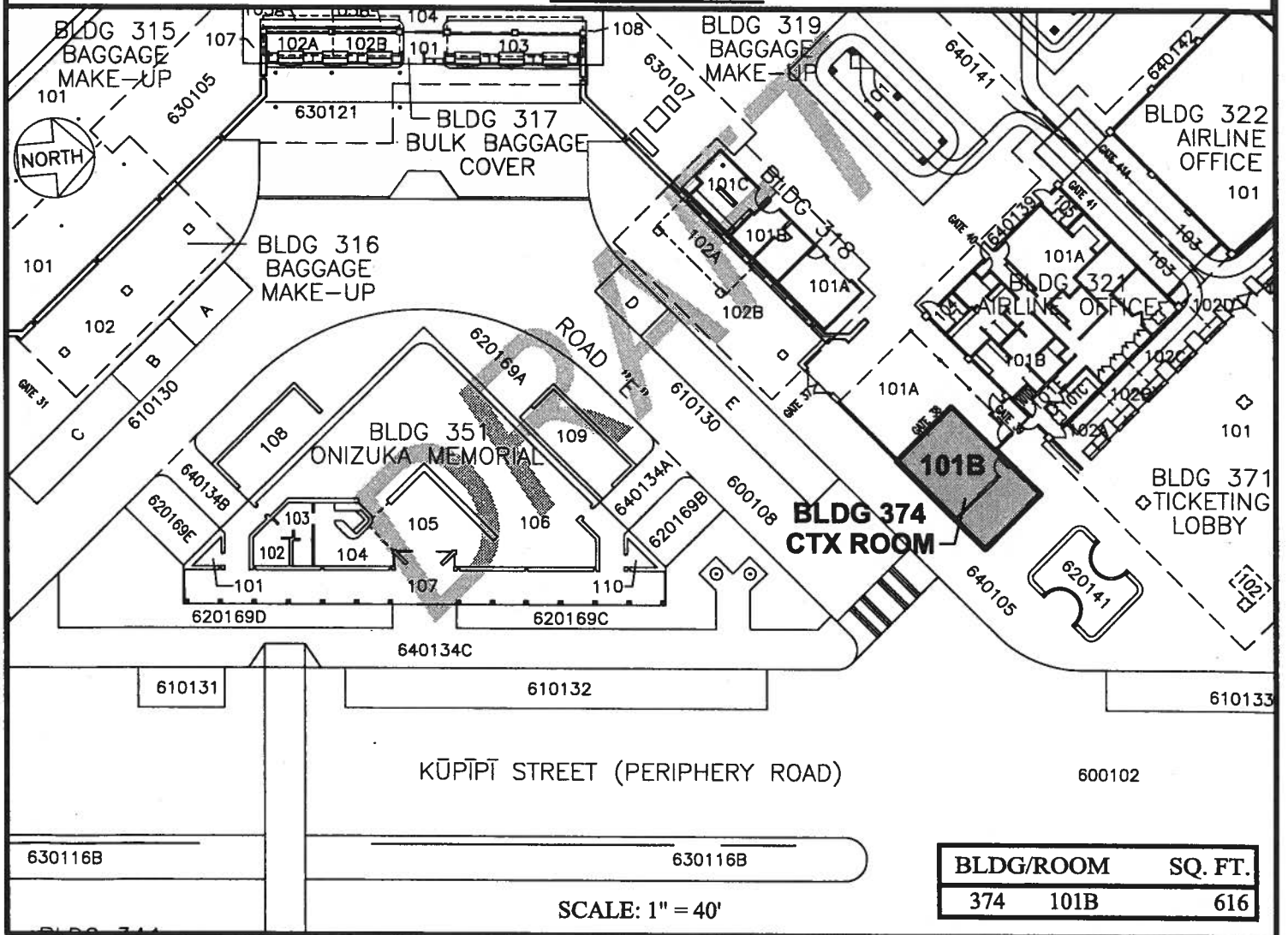

BLDG/ROOM	SQ. FT.
374 101B	616

SCALE: 1" = 40'

DRAFT

DATE : MAY 2017

EXHIBIT: **A**



Airports Division

JAPAN AIRLINES

BUILDING 374
CTX ROOM
GROUND LEVEL

374101B
PLATS E1, 58