

DAVID Y. IGE
GOVERNOR



STATE OF HAWAII
DEPARTMENT OF TRANSPORTATION
869 PUNCHBOWL STREET
HONOLULU, HAWAII 96813-5097

FORD N. FUCHIGAMI
DIRECTOR

Deputy Directors
JADE T. BUTAY
ROSS M. HIGASHI
EDWIN H. SNIFFEN
DARRELL T. YOUNG

IN REPLY REFER TO:

Board of Land and
Natural Resources
State of Hawai'i
Honolulu, Hawai'i

ISSUANCE OF A REVOCABLE PERMIT FOR A T-HANGAR
FOR STORAGE AND MAINTENANCE OF AIRCRAFT
LARRY G. JEFTS
KALAELOA AIRPORT
TAX MAP KEY: (1) 9-1-13: PORTION OF 32

O'AHU

REQUEST:

Issuance of a revocable permit for a T-Hangar for storage and maintenance of aircraft to Larry G. Jefts, situated at Kalaeloa Airport.

LEGAL REFERENCE:

Section 171-55, Hawai'i Revised Statutes

APPLICANT:

Larry G. Jefts, whose mailing address is P.O. Box 27, Kunia, Hawai'i 96759-0027.

LOCATION AND TAX MAP KEY:

A portion of Kalaeloa Airport, Island of Oahu, State of Hawaii, identified by Tax Map Key: 1st Division, 9-1-13: portion of 32.

AREA:

Area/Space No. 410-103, containing an area of 1,741 square feet, as shown and delineated on the attached map labeled Exhibit "A".

ZONING:

State Land Use District: Urban
City and County of Honolulu: P-2 (To be rezoned in the future)

ITEM M-3

BLNR – ISSUANCE OF A REVOCABLE PERMIT FOR A T-HANGAR
FOR STORAGE AND MAINTENANCE OF AIRCRAFT
LARRY G. JEFTS, KALAELOA AIRPORT

Page 2

LAND TITLE STATUS:

Non-ceded - Section 5(a) lands of the Hawai'i Admission Act
DHHL 30% entitlement lands pursuant to Hawai'i Admission Act YES ___ NO X

CURRENT USE STATUS:

Land presently encumbered by Governor's Executive Order No. 3861, setting aside Kalaeloa Airport under the control and management of the State of Hawaii, Department of Transportation, Airports Division (DOTA) for Airport Purposes.

CHARACTER OF USE:

T-Hangar for storage and maintenance of aircraft (2016 Larry Jefts JA30 Superstol, Tail No. N-413Z).

COMMENCEMENT DATE:

To be determined by the Director of Transportation at a later date.

MONTHLY RENTAL:

\$783.00 (as determined from the DOTA schedule of rates and charges established by appraisal of Airports property statewide).

SECURITY DEPOSIT:

Three (3) times the monthly rental in effect.

CHAPTER 343, HRS - ENVIRONMENTAL ASSESSMENT:

The subject land area is covered by the Final Environmental Assessment for the Kalaeloa Airfield Development Plan Improvements, State Project No. AO5011-02 dated June 2010. This Environmental Assessment was prepared by Wilson Okamoto Corp. for the State of Hawai'i, Department of Transportation, Airports Division, in part to evaluate the environmental effects of the recommended Kalaeloa Airfield Master Plan to meet existing and forecast general aviation demands.

BLNR – ISSUANCE OF A REVOCABLE PERMIT FOR A T-HANGAR
FOR STORAGE AND MAINTENANCE OF AIRCRAFT
LARRY G. JEFTS, KALAELOA AIRPORT

Page 3

REMARKS:

The issuance of a revocable permit to Larry G. Jefts for a T-Hangar for storage and maintenance of aircraft at Kalaeloa Airport complies with Chapter 343, Exemption Class 1.D.10 as a continuing aeronautical use, and is in accordance with Section 171-55 HRS, relating to Permits.

RECOMMENDATION:

That the Board authorize the Department of Transportation to issue a month-to-month revocable permit to Larry G. Jefts, subject to: (1) terms and conditions herein outlined, which are by reference incorporated herein; and (2) such additional terms and conditions as may be prescribed by the Director of Transportation to best serve the interests of the State.

Respectfully submitted,



FORD N. FUCHIGAMI
Director of Transportation

APPROVED FOR SUBMITTAL:



SUZANNE D. CASE
Chairperson and Member

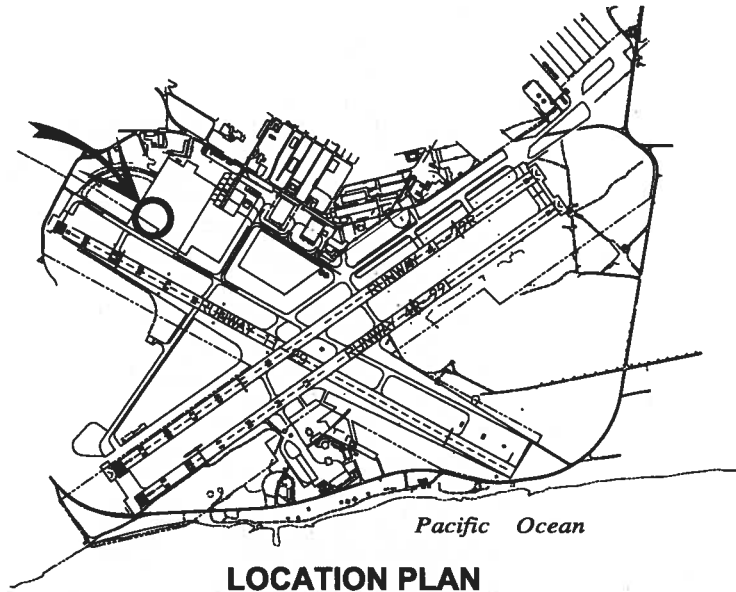

3000:1

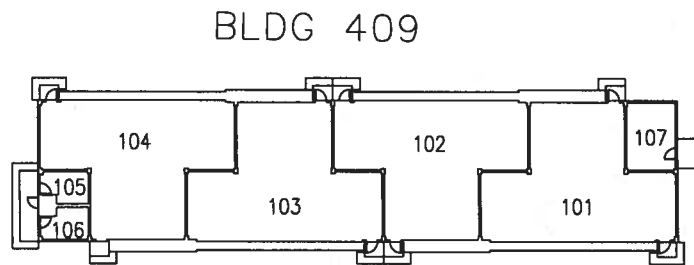
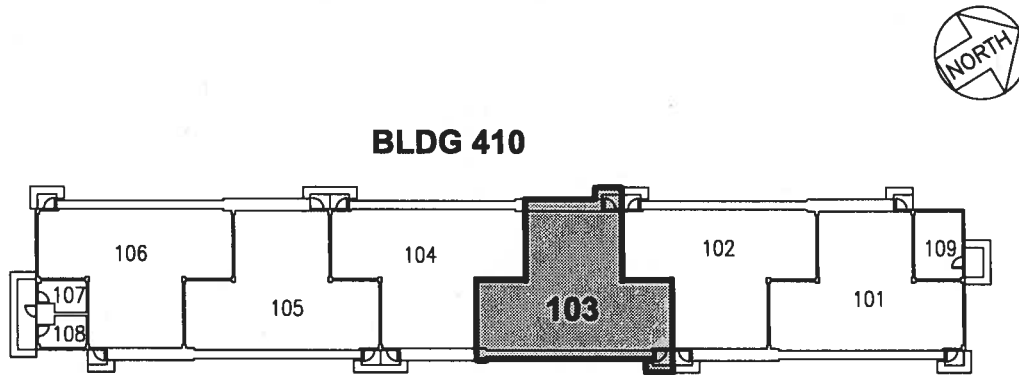

SCALE: 1" = 50'

AREA/SPACE	SQ. FT.
410 103	1,741

RP-8635

DATE : JUNE 2017

EXHIBIT: **A**



Airports Division

LARRY G. JEFTS

**BUILDING 410
T-HANGARS**

410103

KALAELOA AIRPORT

N:\AIRPORTS\JRF_KALAELOA\CAD\PM\JRF_410103-01.DWG