



STATE OF HAWAII  
DEPARTMENT OF TRANSPORTATION  
869 PUNCHBOWL STREET  
HONOLULU, HAWAII 96813-5097

IN REPLY REFER TO:

Board of Land and  
Natural Resources  
State of Hawai'i  
Honolulu, Hawai'i

ISSUANCE OF A REVOCABLE PERMIT  
FOR AN AUTOMATED TELLER MACHINE  
BANK OF HAWAII  
LĪHU'E AIRPORT  
TAX MAP KEY: (4) 3-5-01: PORTION OF 8

KAUA'I

REQUEST:

Issuance of a revocable permit for an automated teller machine to Bank of Hawaii.

LEGAL REFERENCE:

Sections 102-2, Hawai'i Revised Statutes

APPLICANT:

Bank of Hawaii (BoH), whose business address P. O. Box 2900, Honolulu, Hawai'i  
96846-6000.

LOCATION AND TAX MAP KEY:

Portion of Līhu'e Airport (LIH), Līhu'e, Island of Kaua'i, identified by Tax Map Key:  
4th Division, 3-5-01: Portion of 8.

AREA:

Area/Space No. 306-219B (terminal lobby space), containing an area of approximately  
12 square feet, as shown on the attached Exhibit A.

ZONING:

State Land Use District:	Urban
County of Kaua'i:	Industrial (IG-STP)

LAND TITLE STATUS:

Section 5(a) lands of the Hawai'i Admission Act: Non-Ceded  
DHHL 30% entitlement lands pursuant to Hawai'i Admission Act NO X

**ITEM M-12**

BLNR – ISSUANCE OF A REVOCABLE PERMIT FOR AN AUTOMATED TELLER MACHINE TO BANK OF HAWAII  
LIHUE AIRPORT  
Page 2

LAND TITLE STATUS:

Section 5(a) lands of the Hawai‘i Admission Act: Non-Ceded  
DHHL 30% entitlement lands pursuant to Hawai‘i Admission Act YES\_\_\_ NO X

CURRENT USE STATUS:

Airport and aeronautical purposes

CHARACTER OF USE:

Terminal space for an automated teller machine (ATM).

COMMENCEMENT DATE:

To be determined by the Director upon complete execution of the revocable permit.

MONTHLY RENTAL:

\$200.00

SECURITY DEPOSIT:

\$600.00, or three times the monthly rental in effect.

HOLDOVER TENANCY:

\$6.67

DCCA VERIFICATION:

Place of business registration confirmed:	YES <u>X</u>	NO _____
Registered business name confirmed:	YES <u>X</u>	NO _____
Good standing confirmed:	YES <u>X</u>	NO _____

CHAPTER 343, HRS - ENVIRONMENTAL ASSESSMENT:

Pursuant to Section 11-200-8(a), Environmental Impact Statement Rules of the Department of Health, State of Hawai‘i, this disposition is exempt from requirements regarding preparation of an environmental assessment, negative declaration, or environmental impact statement as required by Chapter 343, Hawai‘i Revised Statutes, as amended, relating to Environmental Impact Statements, because the proposed action falls

BLNR – ISSUANCE OF A REVOCABLE PERMIT FOR AN AUTOMATED TELLER  
MACHINE TO BANK OF HAWAII  
LIHUE AIRPORT

Page 3

within Exemption Class #1, Comprehensive Exemption List for the State of Hawai‘i, Department of Transportation, dated November 15, 2000, as approved by the Environmental Quality Council. Exemption Class #1 covers operations, repairs, or maintenance of existing structures, facilities, equipment, or topographical features involving negligible or no expansion or change of use beyond that previously existing.

The DOTA consulted with the U.S. Federal Aviation Administration as to the appropriateness of the citation of the Environmental Exemption Class from the Comprehensive list for the Department of Transportation dated November 15, 2000. In this case, the FAA concurred on the appropriateness.

REMARKS:

Section 102-2 (b) Hawai‘i Revised Statutes provides the following: “The bidding requirements of subsection (a) shall not apply to concessions or space on public property set aside for the following purposes.....(4) for automated teller machines and vending machines...”

The Department of Transportation (DOT) has no objections to BoH’s request to install an updated ATM machine which will provide enhanced services to the traveling public and workers at the Airport.

RECOMMENDATION:

That the Board authorize the Department of Transportation to issue a month-to-month revocable permit to BoH, subject to: (1) terms and conditions herein outlined, which are by reference incorporated herein; and (2) such additional terms and conditions as may be prescribed by the Director of Transportation to best serve the interests of the State.

Respectfully submitted,



FORD N. FUCHIGAMI  
Director of Transportation

APPROVED FOR SUBMITTAL:



SUZANNE D. CASE  
Chairperson and Member

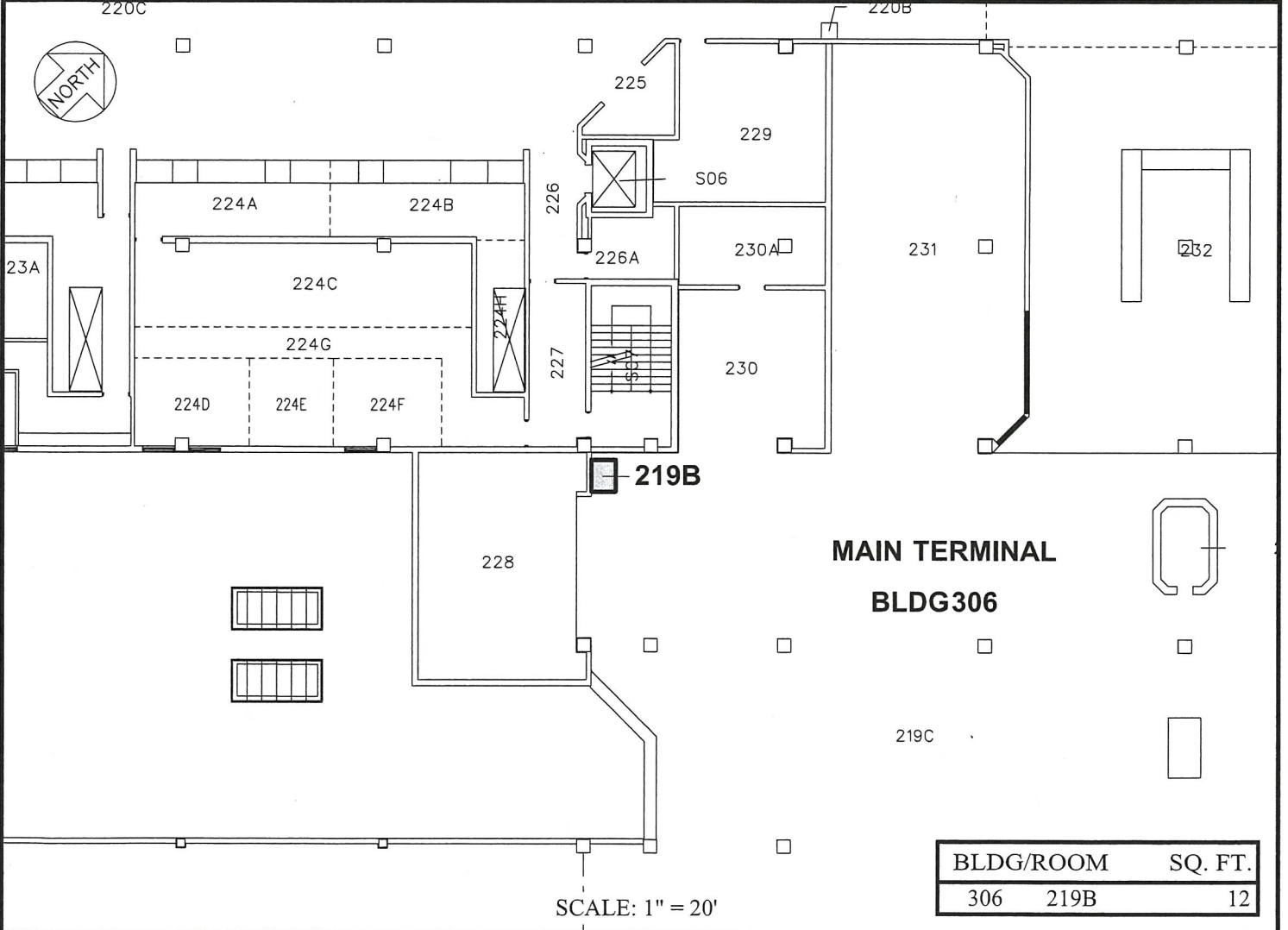
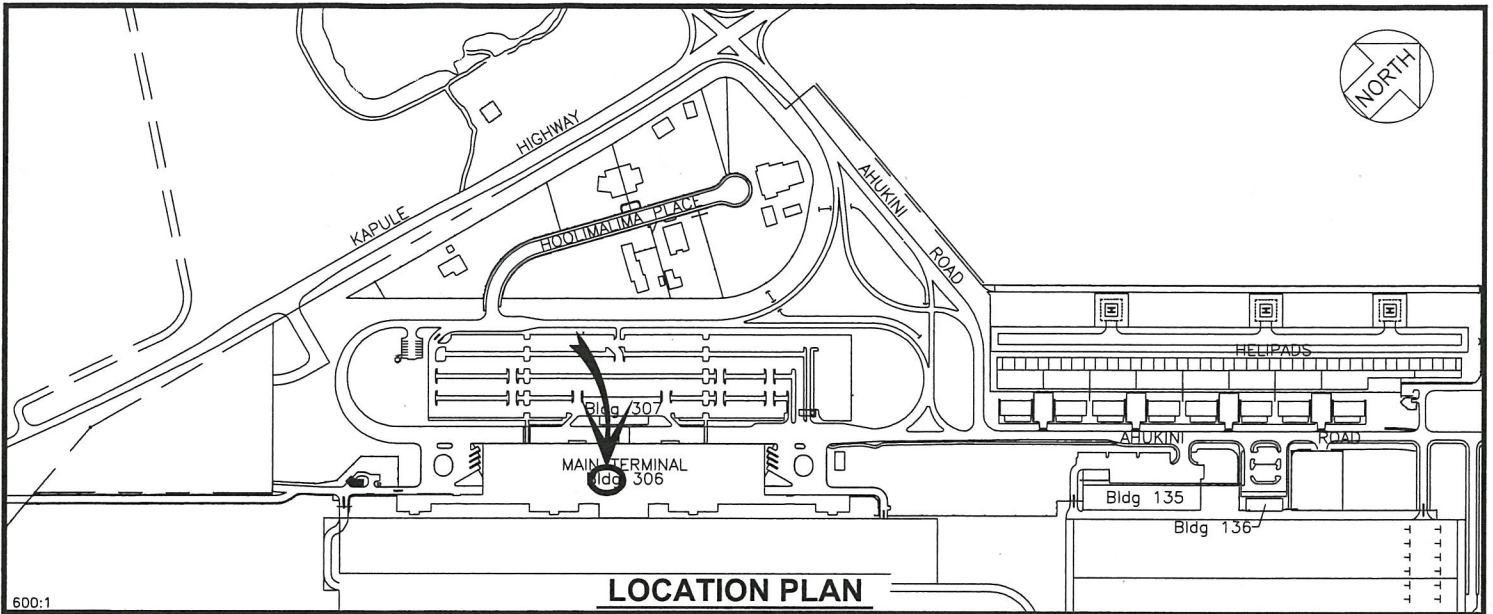

DATE : MAY 2017

EXHIBIT: **A**



BANK OF HAWAII

BUILDING 306  
MAIN TERMINAL  
TERMINAL LEVEL

306219B  
PLATS C2, 45