

DAVID Y. IGE
GOVERNOR

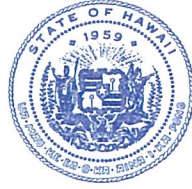

STATE OF HAWAII
DEPARTMENT OF TRANSPORTATION
869 PUNCHBOWL STREET
HONOLULU, HAWAII 96813-5097

FORD N. FUCHIGAMI
DIRECTOR

Deputy Directors
JADE T. BUTAY
ROSS M. HIGASHI
EDWIN H. SNIFFEN
DARRELL T. YOUNG

IN REPLY REFER TO:

Board of Land and
Natural Resources
State of Hawai'i
Honolulu, Hawai'i

ISSUANCE OF A REVOCABLE PERMIT FOR AIRCRAFT PARKING
DAVID BLANCETT-MADDOCK
KONA INTERNATIONAL AIRPORT AT KEĀHOLE
TAX MAP KEY: (3) 7-3-43: PORTION OF 40

HAWAII

REQUEST:

Issuance of a revocable permit for aircraft parking (parking permit) to David Blancett-Maddock.

LEGAL REFERENCE:

Sections 171-55, Hawai'i Revised Statutes.

APPLICANT:

David Blancett-Maddock, whose address is 76-101 Kamehamalu Street, Kailua-Kona, Hawai'i 96740.

LOCATION AND TAX MAP KEY:

Portion of Kona International Airport at Keāhole (KOA), Kailua-Kona, Island of Hawai'i, identified by Tax Map Key: 3rd division, 7-3-43: Portion of 40.

AREA:

Area/Space Nos. 407-116, containing an area of 990 square feet, as shown and delineated on the attached Exhibit A.

ZONING:

State Land Use District:
County of Hawai'i:

Urban & Conservation
Industrial (MG-1a) and Open

ITEM M-7

BLNR – ISSUANCE OF A REVOCABLE PERMIT FOR AIRCRAFT PARKING
DAVID BLANCETT-MADDOCK, KONA INTERNATIONAL AIRPORT AT KEĀHOLE
Page 2

LAND TITLE STATUS:

Section 5(a) lands of the Hawai'i Admission Act: Ceded
DHHL 30% entitlement lands pursuant to Hawai'i Admission Act YES___ NO X

CURRENT USE STATUS:

Airport and aeronautical purposes

CHARACTER OF USE:

Aircraft parking for tie-down

COMMENCEMENT DATE:

To be determined by Director upon complete execution of the parking permit.

MONTHLY RENTAL:

\$ 96.00 (as determined from the DOTA schedule of rates and charges established by appraisal of Airports property statewide).

SECURITY DEPOSIT:

\$ 288.00 (three times the monthly rental)

DCCA VERIFICATION:

N/A

REMARKS:

The issuance of a parking permit for an aircraft tie-down to David Blancett-Maddock, at KOA complies with Chapter 343, Exemption Class 1.D.10. as continuing aeronautical use, and is in accordance with Section 171-55 HRS, relating to Permits.

The DOTA consulted with the U.S. Federal Aviation Administration as to the appropriateness of the citation of the Environmental Exemption Class from the Comprehensive list for the Department of Transportation dated November 15, 2000. In this case, the FAA concurred on the appropriateness.

RECOMMENDATION:

That the Board authorize the Department of Transportation to issue a month-to-month parking permit to David Blancett-Maddock, subject to: (1) terms and conditions herein outlined, which are by reference incorporated herein; and (2) such additional terms and conditions as may be prescribed by the Director of Transportation to best serve the interests of the State.

Respectfully submitted,

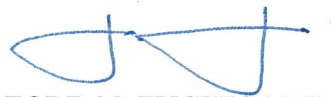

FORD N. FUCHIGAMI
Director of Transportation

APPROVED FOR SUBMITTAL:

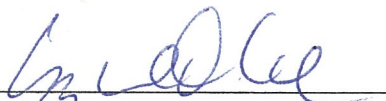

SUZANNE D. CASE
Chairperson and Member

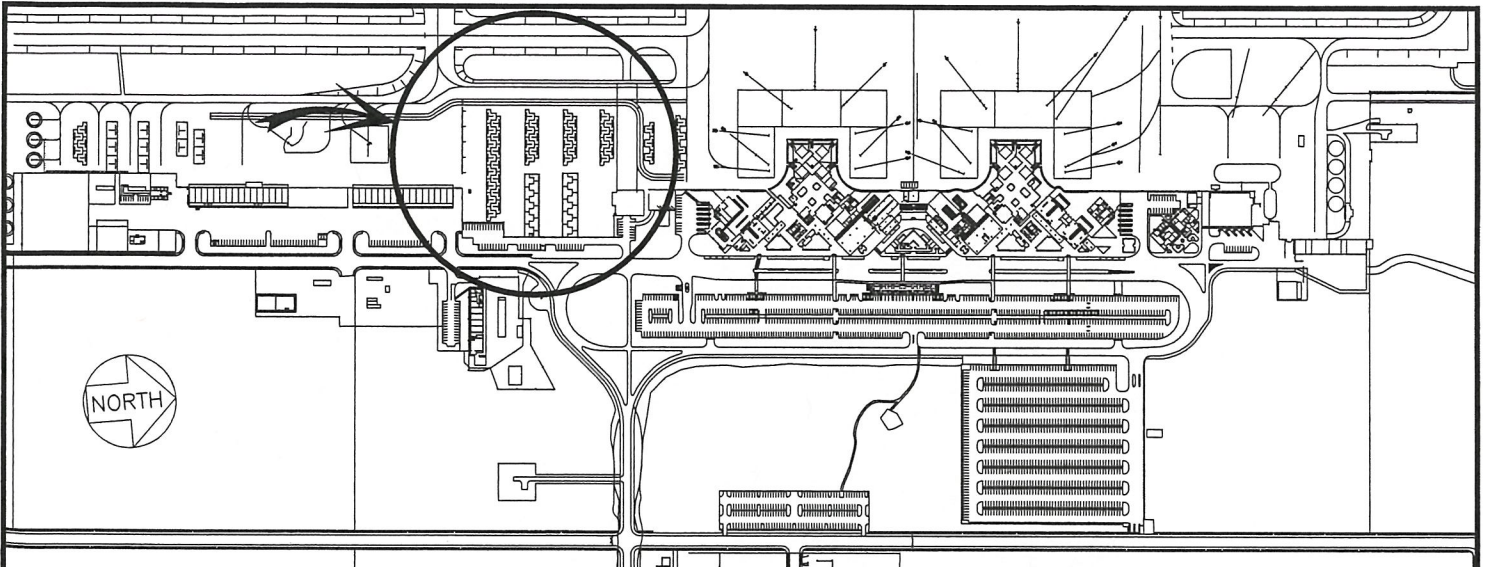

LOCATION PLAN

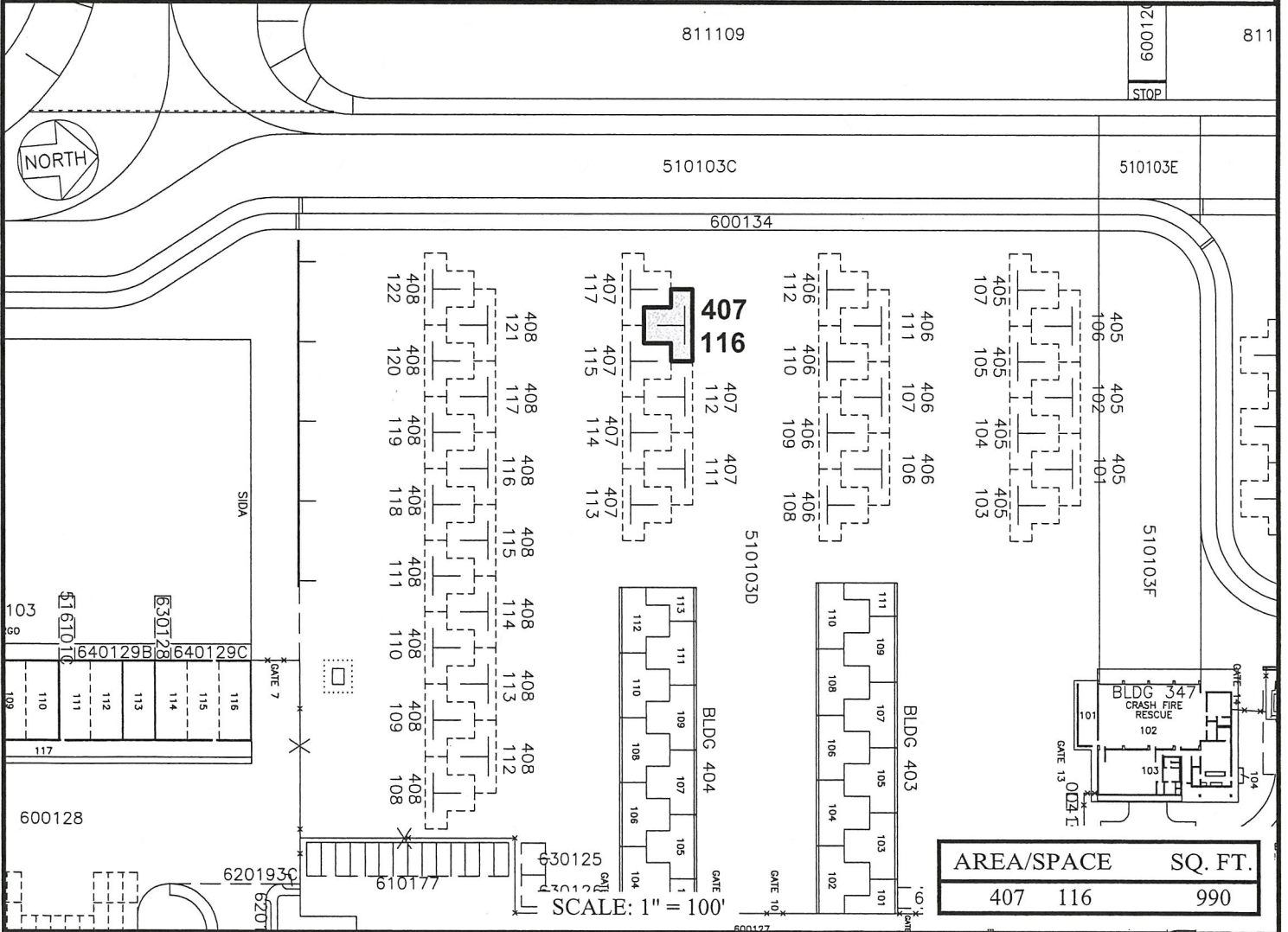

AREA/SPACE	SQ. FT.
407 116	990

PP-16-N013 DATE : JUNE 2017 EXHIBIT: **A**



DAVID BLANCETT-MADDOCK

TIE-DOWN

407116
PLATS D1, 39

KONA INTERNATIONAL AIRPORT AT KEAHOLE

N:\AIRPORTS\KOA_Kona\CAD\PM\kod_407116-01.dwg