

DAVID Y. IGE
GOVERNOR



STATE OF HAWAII
DEPARTMENT OF TRANSPORTATION
AIRPORTS DIVISION
400 RODGERS BOULEVARD, SUITE 700
HONOLULU, HAWAII 96819-1880

FORD N. FUCHIGAMI
DIRECTOR

Deputy Directors
JADE T. BUTAY
ROSS M. HIGASHI
EDWIN H. SNIFFEN
DARRELL T. YOUNG

IN REPLY REFER TO:

Board of Land and
Natural Resources
State of Hawai'i
Honolulu, Hawai'i

ISSUANCE OF A REVOCABLE PERMIT FOR AIRCRAFT PARKING
HAWAII GLIDER AND SAILPLANE ACADEMY, LLC
KAWAIHĀPAI AIRFIELD, WAIALUA, HAWAI'I
TAX MAP KEY: (1) 6-08-14:001 (PORTION)

O'AHU

REQUEST:

Issuance of a Revocable Permit for Aircraft Parking (Parking Permit) to
Hawaii Glider and Sailplane Academy, LLC, situated at Kawaihāpai Airfield.

LEGAL REFERENCE:

Section 171-55, Hawai'i Revised Statutes

APPLICANT:

Hawaii Glider and Sailplane Academy, LLC, whose mailing address is P.O. Box 705,
Waialua, Hawai'i 96791.

LOCATION:

A portion of Kawaihāpai Airfield, Waialua, Island of O'ahu, State of Hawai'i, identified
by Tax Map Key: 1st Division, 6-08-14:001 (portion).

AREA:

Area/Space No. 405-107, containing an area of approximately 1,890 square feet, as
delineated on the attached map labeled Exhibit A.

ITEM M-5

BLNR – ISSUANCE OF A REVOCABLE PERMIT FOR AIRCRAFT PARKING
HAWAII GLIDER AND SAILPLANE ACADEMY, LLC
Page 2

ZONING:

State Land Use District: Agriculture
City and County of Honolulu LUO: AG-2

LAND TITLE STATUS:

Ceded land, which the State of Hawai‘i is currently leasing the land from the United States of America.

CHARACTER OF USE:

Aircraft Tie-down (1984 GROB 103 Twin II, Tail No. N-4601M)

COMMENCEMENT DATE:

To be determined by the Director of Transportation at a later date.

MONTHLY RENTAL:

\$34.00 (as determined from the DOTA schedule of rates and charges established by appraisal of Airports property statewide)

SECURITY DEPOSIT:

Three (3) times the monthly rental in effect

CHAPTER 343, HRS - ENVIRONMENTAL ASSESSMENT:

The subject land area is covered by the revised and updated Environmental Assessment for the Dillingham Airfield Master Plan and FAR Part 150 Noise Compatibility Program project, referenced as State Contract No. 26985, State Project No. AO2011-01. This Environmental Assessment evaluated the environmental effects of the recommended Dillingham Airfield Master Plan to meet existing and forecast general aviation demands and was prepared for the State of Hawaii, Department of Transportation, Airports Division.

REMARKS:

The issuance of a Parking Permit to Hawaii Glider and Sailplane Academy, LLC, at Kawaihāpai Airfield complies with Chapter 343, Exemption Class 1.D.10 as a continuing aeronautical use, and is in accordance with Section 171-55 HRS, relating to Permits.

BLNR – ISSUANCE OF A REVOCABLE PERMIT FOR AIRCRAFT PARKING
HAWAII GLIDER AND SAILPLANE ACADEMY, LLC
Page 3

RECOMMENDATION:

That the Board authorize the Department of Transportation to issue a month-to-month Parking Permit to Hawaii Glider and Sailplane Academy, LLC, subject to: (1) terms and conditions herein outlined, which are by reference incorporated herein; and (2) such additional terms and conditions as may be prescribed by the Director of Transportation to best serve the interests of the State.

Respectfully submitted,



FORD N. FUCHIGAMI
Director of Transportation

APPROVED FOR SUBMITTAL:



SUZANNE D. CASE
Chairperson and Member

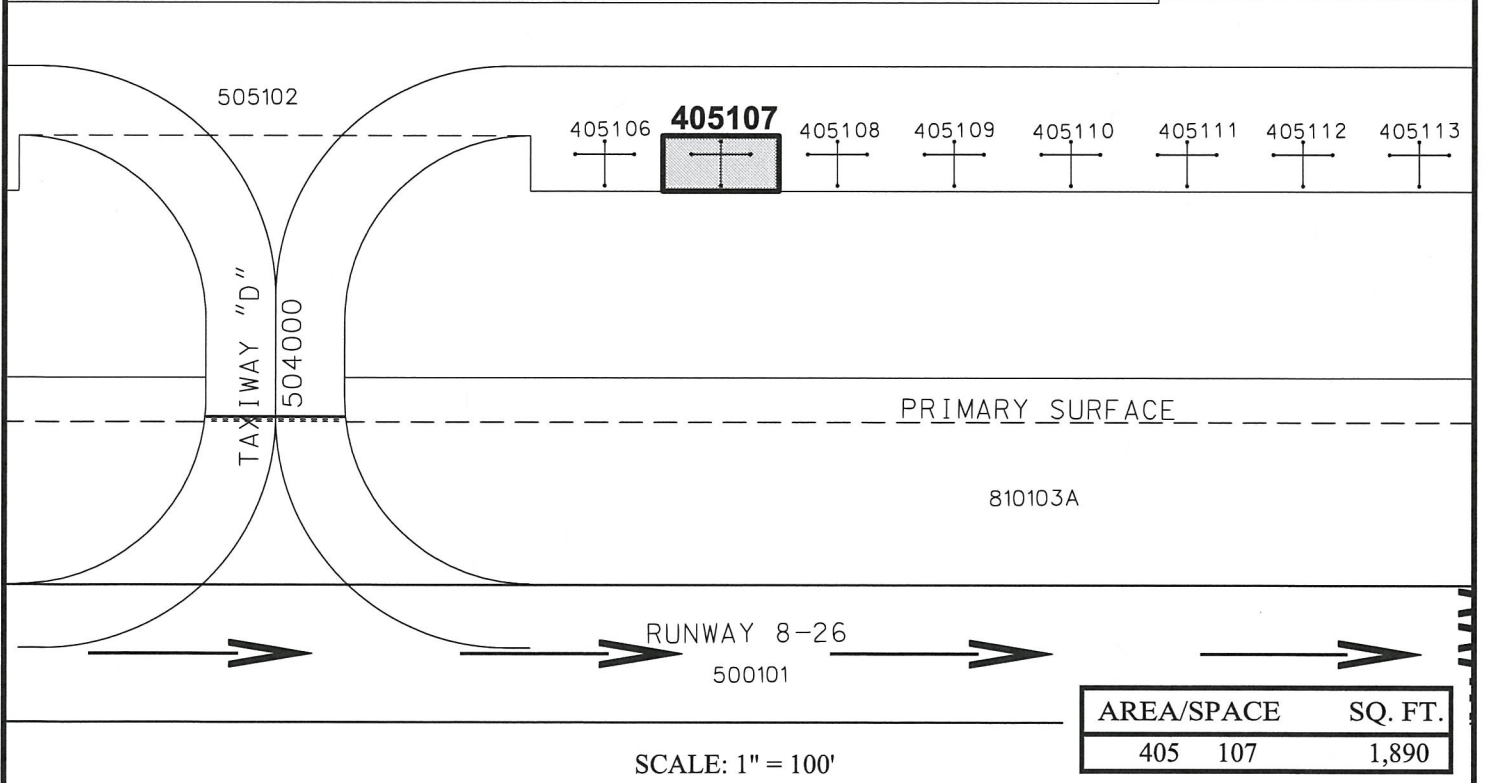
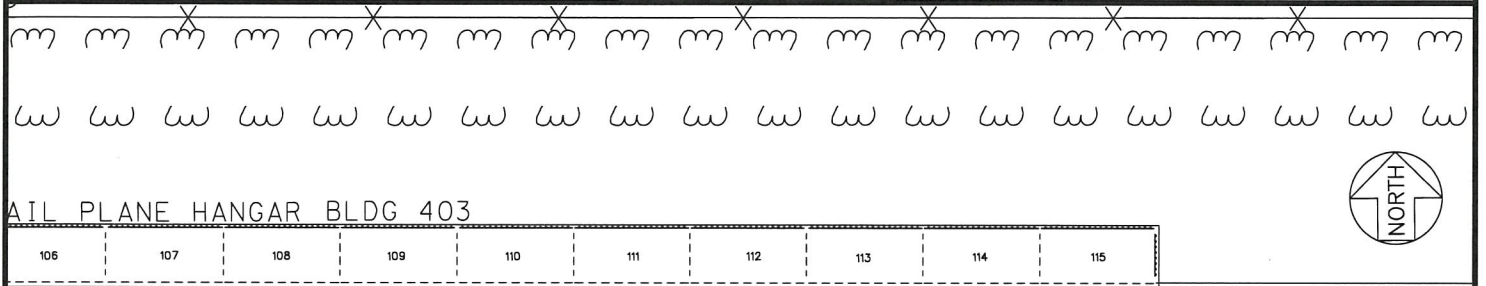
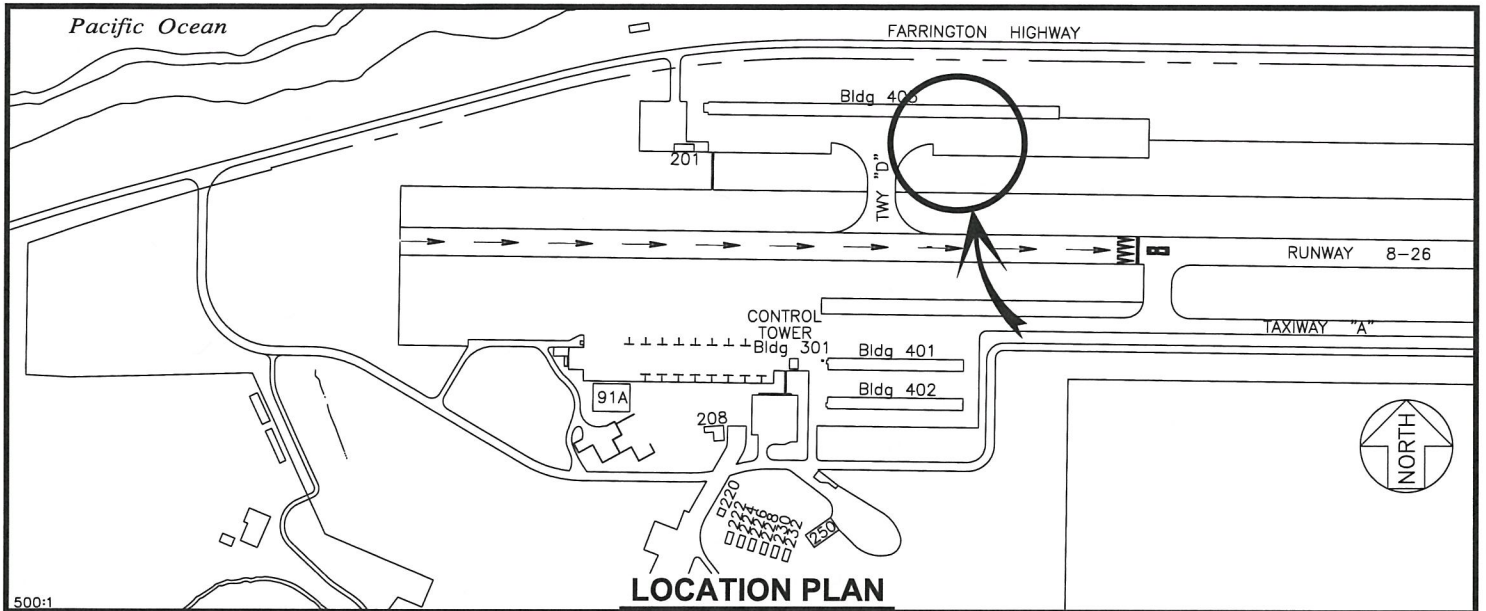

PP-17-0013	DATE : AUGUST 2017	EXHIBIT: A
 Airports Division	HAWAII GLIDER AND SAILPLANE ACADEMY, LLC	TIE DOWN GENERAL AVIATION FACILITIES
		405107 PLAT A1

DILLINGHAM AIRFIELD