

DAVID Y. IGE
GOVERNOR

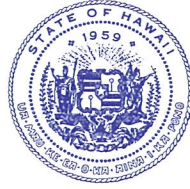

STATE OF HAWAII
DEPARTMENT OF TRANSPORTATION
869 PUNCHBOWL STREET
HONOLULU, HAWAII 96813-5097

FORD N. FUCHIGAMI
DIRECTOR

Deputy Directors
JADE T. BUTAY
ROSS M. HIGASHI
EDWIN H. SNIFFEN
DARRELL T. YOUNG

IN REPLY REFER TO:

Board of Land and
Natural Resources
State of Hawai'i
Honolulu, Hawai'i

ISSUANCE OF A REVOCABLE PERMIT FOR SPACE IN A CARGO BUILDING AND
ADJACENT RAMP SPACE FOR AN AIR CARGO OPERATION

AEKO KULA, INC.

LĪHU'E AIRPORT

TAX MAP KEY: (4) 3-5-001:008

KAUA'I

REQUEST:

Issuance of a revocable permit for space in a cargo building and adjacent ramp space to Aeko Kula, Inc.

LEGAL REFERENCE:

Sections 171-11 and 171-55, Hawai'i Revised Statutes.

APPLICANT:

Aeko Kula, Inc. (AEK) whose business address 50 Elliott Street,
Honolulu, Hawai'i 96819.

LOCATION:

Portion of Līhu'e Airport, Līhu'e, Island of Kaua'i (LIH), identified by
Tax Map Key: 4th Division, 3-5-001:008.

AREAS AND ROOMS:

Bldg/Room No. 135-107, containing an area of approximately 10,798 sq. ft.
Bldg/Room No. 135-107A, containing an area of approximately 311 sq. ft.
Bldg/Room No. 135-107B, containing an area of approximately 107 sq. ft.
Bldg/Room No. 135-107C, containing an area of approximately 95 sq. ft.
Bldg/Room No. 135-107D, containing an area of approximately 311 sq. ft.
Bldg/Room No. 135-107E, containing an area of approximately 1,178 sq. ft.
Area/Space No. 514-119D, containing an area of approximately 4,000 sq. ft.
Area/Space No. 630-101F, containing an area of approximately 2,400 sq. ft.

ITEM M-5

BLNR - ISSUANCE OF A REVOCABLE PERMIT FOR SPACE IN A CARGO BUILDING AND ADJACENT RAMP SPACE FOR AN AIR CARGO OPERATION
AEKO KULA, INC., LĪHU'E AIRPORT

Page 2

Area/Space No. 630-101G, containing an area of approximately 2,400 sq. ft.
All Areas/Rooms identified above are shown and delineated on the attached exhibit labeled Exhibit "A".

ZONING:

State Land Use District: Urban
County of Kaua'i: Industrial (I)

LAND TITLE STATUS:

Section 5(a) lands of the Hawai'i Admission Act:
DHHL 30% entitlement lands pursuant to Hawai'i Admission Act: No X

CURRENT USE STATUS:

Aeronautical and airport purposes

CHARACTER OF USE:

Cargo building and adjacent ramp spaces for an air cargo operation.

COMMENCEMENT DATE:

Upon the complete execution of the revocable permit.

MONTHLY RENTAL:

\$20,074.67 (as determined from the DOTA schedule of rates and charges established by appraisal of Airports property statewide).

SECURITY DEPOSIT:

\$ 60,224.01, or three times the monthly rental in effect.

HOLDOVER TENANCY:

\$ 669.16

DCCA VERIFICATION:

Place of business registration confirmed: YES X NO _____
Registered business name confirmed: YES X NO _____
Good standing confirmed: YES X NO _____

CHAPTER 343, HRS - ENVIRONMENTAL ASSESSMENT:

Pursuant to Section 11-200-8(a), Environmental Impact Statement Rules of the Department of Health, State of Hawai'i, this disposition is exempt from requirements regarding preparation of an environmental assessment, negative declaration, or environmental impact statement as required by Chapter 343, Hawai'i Revised Statutes, as amended, relating to Environmental Impact Statements, because the proposed action falls within Exemption Class #1, Comprehensive Exemption List for the State of Hawai'i, Department of Transportation, dated November 15, 2000, as approved by the Environmental Quality Council. Exemption Class #1 covers operations, repairs, or maintenance of existing structures, facilities, equipment, or topographical features involving negligible or no expansion or change of use beyond that previously existing. The DOTA consulted with the U.S. Federal Aviation Administration as to the appropriateness of the citation of the Environmental Exemption Class from the Comprehensive list for the Department of Transportation dated November 15, 2000. In this case, the FAA concurred on the appropriateness.

REMARKS:

The Department of Transportation (DOT) has no objections to AEK's request and therefore, in accordance with Sections 171-11 and 171-55, HRS, relating to Public Purposes and Permits, respectively and therefore, the DOT proposes to issue a month-to-month revocable permit to AEK for space in a cargo building and adjacent ramp space for AEK's air cargo operation.

RECOMMENDATION:

That the Board authorize the Department of Transportation to issue a month-to-month revocable permit to AEK, subject to: (1) terms and conditions herein outlined, which are by reference incorporated herein; and (2) such additional terms and conditions as may be prescribed by the Director of Transportation to best serve the interests of the State.

Respectfully submitted,

FORD N. FUCHIGAMI
Director of Transportation

APPROVED FOR SUBMITTAL:

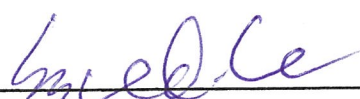

SUZANNE D. CASE
Chairperson and Member

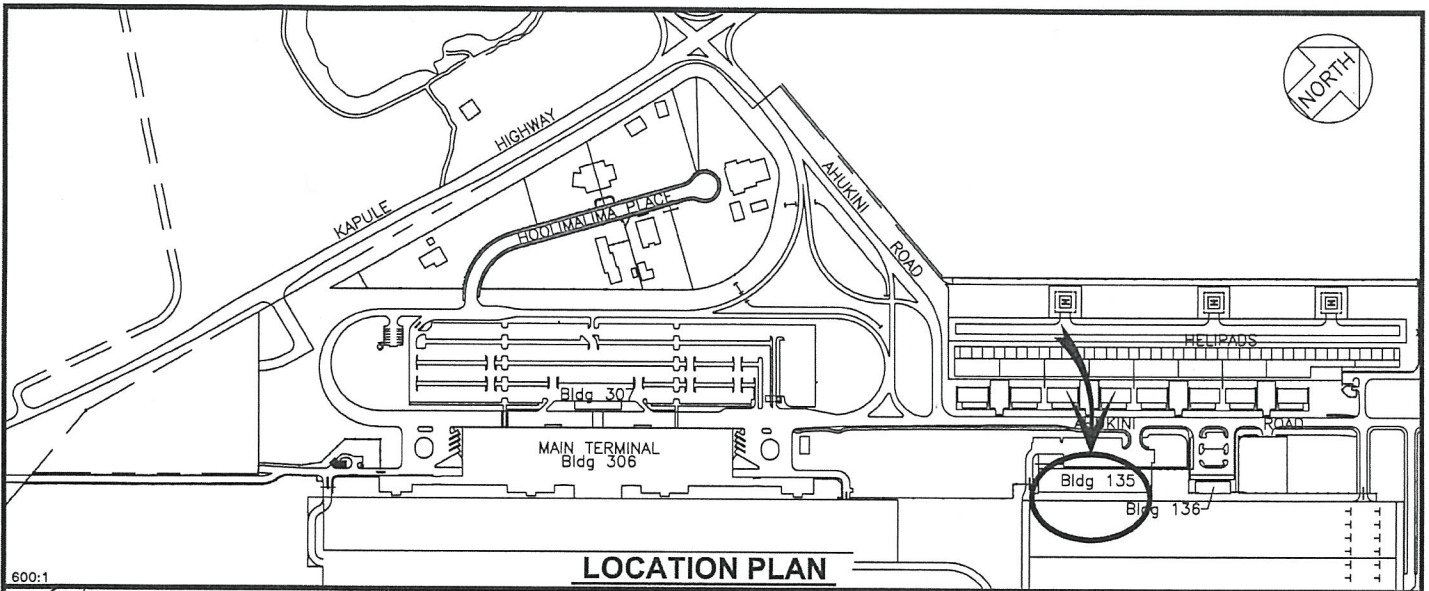

600:1

LOCATION PLAN

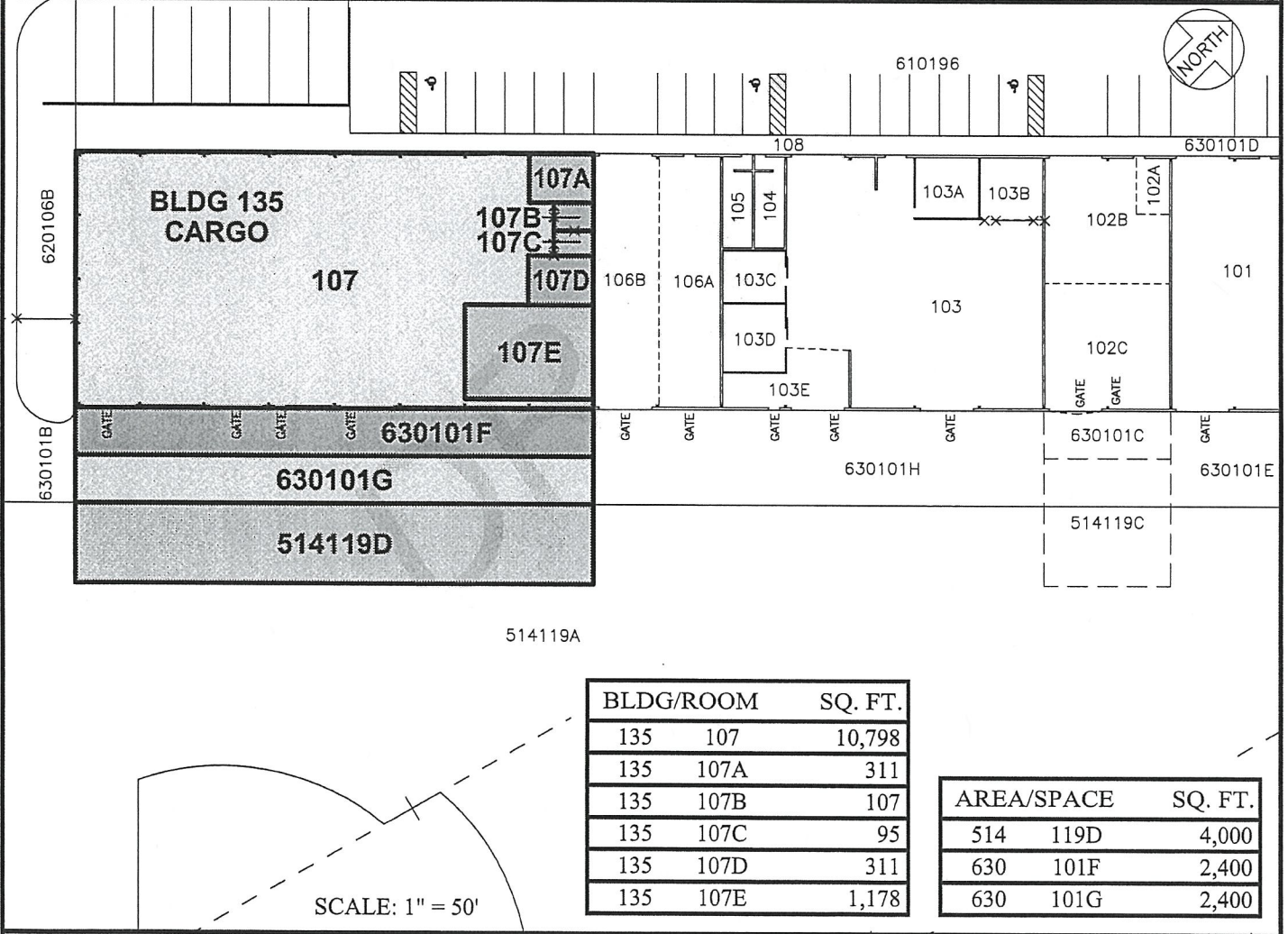

BLDG/ROOM	SQ. FT.
135 107	10,798
135 107A	311
135 107B	107
135 107C	95
135 107D	311
135 107E	1,178

AREA/SPACE	SQ. FT.
514 119D	4,000
630 101F	2,400
630 101G	2,400

SCALE: 1" = 50'

DRAFT	DATE : MAY 2017	EXHIBIT: A	
	AEKO KULA, INC.	BUILDING 135 CARGO GROUD LEVEL	135107 PLATS A1, 35

N:\AIRPORTS\LIH_Lihue\CAD\PM\lih_135107-01_draft.dwg

LIHUE AIRPORT