

DAVID Y. IGE
GOVERNOR

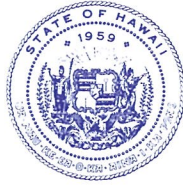

STATE OF HAWAII
DEPARTMENT OF TRANSPORTATION
AIRPORTS DIVISION
400 RODGERS BOULEVARD, SUITE 700
HONOLULU, HAWAII 96819-1880

FORD. N. FUCHIGAMI
DIRECTOR

Deputy Director
JADE T. BUTAY
ROSS M. HIGASHI
EDWIN H. SNIFFIN
DARELL T. YOUNG

IN REPLY REFER TO:

Board of Land and
Natural Resources
State of Hawai'i
Honolulu, Hawai'i

ISSUANCE OF A REVOCABLE PERMIT
TO THE GAS COMPANY, LLC DBA HAWAII GAS
FOR SPACE TO STORE A PROPANE FUEL TANK
DANIEL K. INOUE INTERNATIONAL AIRPORT
TAX MAP KEY: (1) 1-1-003: 001 (PORTION)

O'AHU

APPLICANT:

The Gas Company, LLC dba Hawaii Gas (The Gas Co.), whose mailing address is
P.O. Box 3000, Honolulu, Hawai'i 96802-3000.

LEGAL REFERENCE:

Section 171-55, Hawai'i Revised Statutes.

LOCATION:

A portion of Daniel K. Inouye International Airport, Island of O'ahu, State of Hawai'i,
identified by Tax Map Key: 1st Division, 1-1-003: 001 (Portion).

AREA:

Area/Space No. 001-116, containing an area of approximately 250 square feet,
as shown and delineated on the attached map labeled Exhibit "A".

ZONING:

State Land Use District: Urban
City and County of Honolulu LUO: Industrial (I-2)

ITEM M-6

BLNR – ISSUANCE OF A REVOCABLE PERMIT TO THE GAS COMPANY, LLC DBA HAWAII GAS FOR SPACE TO STORE A PROPANE FUEL TANK
Page 2

LAND TITLE STATUS:

Non-ceded - Section 5(a) lands of the Hawai'i Admission Act
DHHL 30% entitlement lands pursuant to Hawai'i Admission Act YES ___ NO X

CURRENT USE STATUS:

Land presently encumbered by Governor's Executive Order No. 3201, dated June 8, 1983, setting aside 3,152.177 acres designated as Daniel K. Inouye International Airport under the control and management of the State of Hawai'i, Department of Transportation, Airports Division for Airport Purposes.

CHARACTER OF USE:

The Gas Co. will use the space to store a propane fuel tank to provide airport tenants with fuel for their vehicles at Daniel K. Inouye International Airport.

COMMENCEMENT DATE:

Upon execution of the revocable permit.

MONTHLY RENTAL:

\$113.13, as determined from the DOTA schedule of rates and charges established by appraisal of Airports property statewide.

SECURITY DEPOSIT:

Three (3) times the monthly rental in effect.

DCCA VERIFICATION:

Place of business registration confirmed:	YES <u>X</u>	NO ___
Registered business name confirmed:	YES <u>X</u>	NO ___
Good standing confirmed:	YES <u>X</u>	NO ___

CHAPTER 343, HRS - ENVIRONMENTAL ASSESSMENT:

Pursuant to Section 11-200-8(a), Environmental Impact Statement Rules of the Department of Health, State of Hawai'i, this disposition is exempt from requirements regarding preparation of an environmental assessment, negative declaration, or

BLNR – ISSUANCE OF A REVOCABLE PERMIT TO THE GAS COMPANY, LLC DBA
HAWAII GAS FOR SPACE TO STORE A PROPANE FUEL TANK

Page 3

environmental impact statement as required by Chapter 343, Hawai'i Revised Statutes, as amended, relating to Environmental Impact Statements, because the proposed action falls within Exemption Class #1, Comprehensive Exemption List for the State of Hawai'i, Department of Transportation, dated November 15, 2000, as approved by the Environmental Quality Council. Exemption Class #1 covers operations, repairs, or maintenance of existing structures, facilities, equipment, or topographical features involving negligible or no expansion or change of use beyond that previously existing.

The DOTA consulted with the U.S. Federal Aviation Administration as to the appropriateness of the citation of the Environmental Exemption Class from the Comprehensive list for the Department of Transportation dated November 15, 2000. The FAA concurred on the appropriateness.

REMARKS:

In accordance with Section 171-55, HRS, relating to Permits, the Department of Transportation proposes to issue a month-to-month revocable permit to The Gas Co. for space to store a propane fuel tank to provide airport tenants with fuel for their vehicles as part of its business operation at Daniel K. Inouye International Airport.

RECOMMENDATION:

That the Board authorize the Department of Transportation to issue a month-to-month revocable permit to The Gas Co., subject to: (1) terms and conditions herein outlined, which are by reference incorporated herein; and (2) such additional terms and conditions as may be prescribed by the Director of Transportation to best serve the interests of the State.

Respectfully submitted,



FORD N. FUCHIGAMI
Director of Transportation

APPROVED FOR SUBMITTAL:



SUZANNE D. CASE
Chairperson and Member

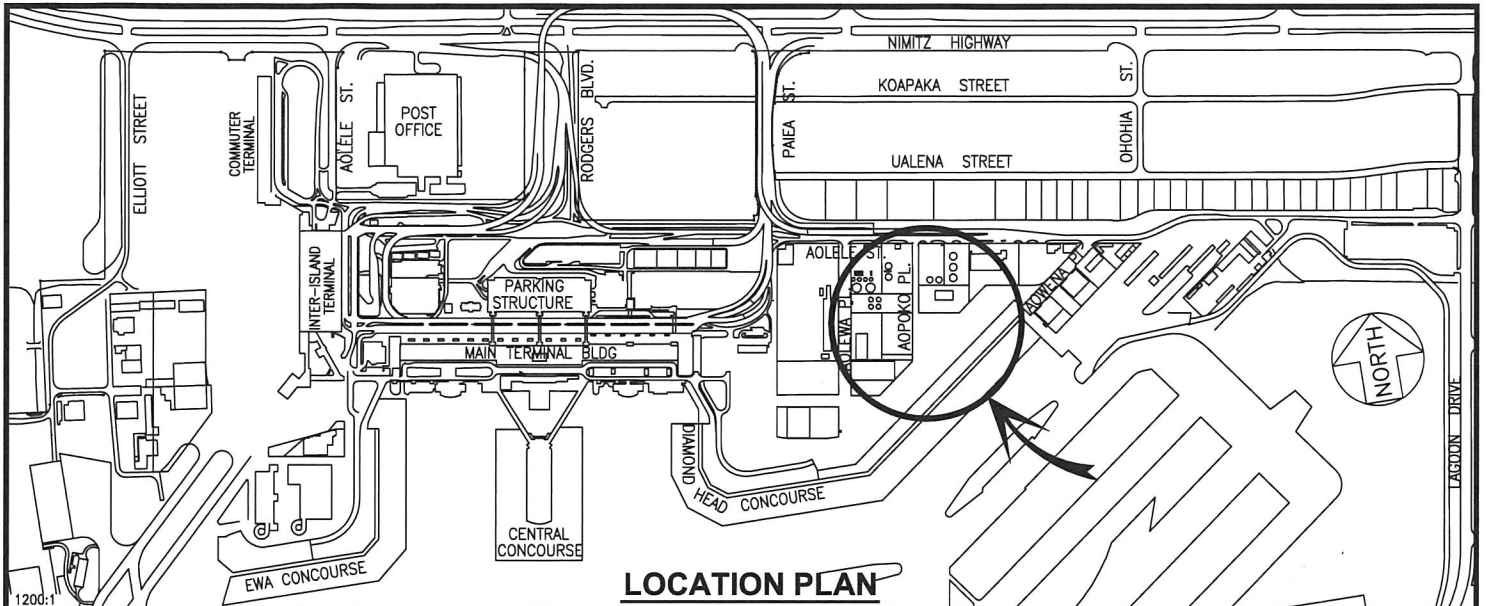

LOCATION PLAN

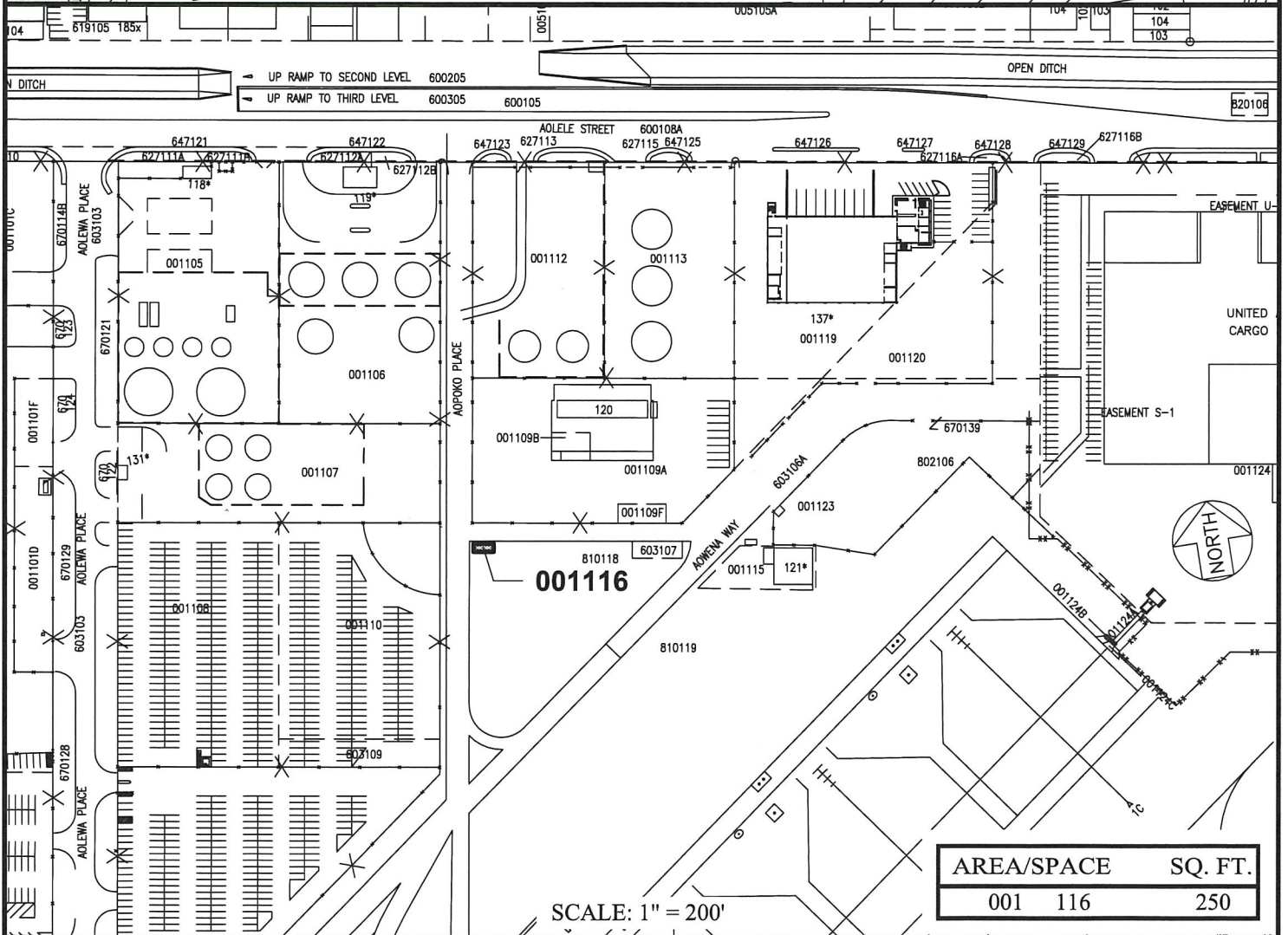

RP-8665

DATE : AUGUST 2017

EXHIBIT: **A**



Airports Division

THE GAS COMPANY, LLC
DBA HAWAII GAS

PROPANE GAS
STORAGE LOT

001116

PLAT 26