

DAVID Y. IGE  
GOVERNOR



STATE OF HAWAII  
DEPARTMENT OF TRANSPORTATION  
869 PUNCHBOWL STREET  
HONOLULU, HAWAII 96813-5097

II  
FORD N. FUCHIGAMI  
DIRECTOR

Deputy Directors  
JADE T. BUTAY  
ROSS M. HIGASHI  
EDWIN H. SNIFFEN  
DARRELL T. YOUNG

IN REPLY REFER TO:

Board of Land and  
Natural Resources  
State of Hawai'i  
Honolulu, Hawai'i

ISSUANCE OF A REVOCABLE PERMIT FOR A BUILDING SPACE  
FOR FREIGHT FORWARDING OF AIR CARGO  
ALOHA CONTRACT SERVICES, LLC  
LIHU'E AIRPORT  
TAX MAP KEY: (4) 3-5-001:146

KAUA'I

REQUEST:

Issuance of a Revocable Permit for building space for freight forwarding of air cargo to Aloha Contract Services, LLC at Lihu'e Airport ("LIH").

LEGAL REFERENCE:

Sections 171-11 and 171-55, Hawai'i Revised Statutes.

APPLICANT:

Aloha Contract Services, LLC ("ACS") whose business address 111 Keehi Place, Honolulu, Hawai'i 96819.

LOCATION:

Portion of Lihu'e Airport, Lihu'e, Island of Kaua'i, identified by Tax Map Key: 4<sup>th</sup> Division, 3-5-001:146

BLDG/ROOMS:

Bldg/Room No. 135-106C, containing an area of approximately 435 square feet; and Bldg/Room No. 135-106D, containing an area of approximately 38 square feet, as shown and delineated on the attached map labeled Exhibit "A".

ITEM M-6

BLNR - ISSUANCE OF A REVOCABLE PERMIT FOR BUILDING SPACE FOR THE FORWARDING OF AIR CARGO, ALOHA CONTRACT SERVICES, LLC  
LIHU'E AIRPORT  
Page 2

ZONING:

State Land Use District: Urban  
County of Kaua'i: Industrial (I)

LAND TITLE STATUS:

Section 5(a) lands of the Hawai'i Admission Act:  
DHHL 30% entitlement lands pursuant to Hawai'i Admission Act: No X

CURRENT USE STATUS:

Airport purposes

CHARACTER OF USE:

Building space is used for freight forwarding of air cargo by combining individual goods to make up a full container load. The combining allows the goods to be transported as containerized-cargo on aircraft. The space is also used to separate consolidated shipments into individual consignments for pick up.

COMMENCEMENT DATE:

To be determined by the Director upon complete execution of the revocable permit.

MONTHLY RENTAL:

\$681.12 (as determined from the DOTA schedule of rates and charges established by appraisal of Airports property statewide).

SECURITY DEPOSIT:

\$ 2,043.36 or three times the monthly rental.

HOLDOVER TENANCY:

\$ 22.70

DCCA VERIFICATION:

Place of business registration confirmed: YES X  
Registered business name confirmed: YES X  
Good standing confirmed: YES X

CHAPTER 343, HRS - ENVIRONMENTAL ASSESSMENT:

Pursuant to Section 11-200-8(a), Environmental Impact Statement Rules of the Department of Health, State of Hawai'i, this disposition is exempt from requirements regarding preparation of an environmental assessment, negative declaration, or environmental impact statement as required by Chapter 343, Hawai'i Revised Statutes, as amended, relating to Environmental Impact Statements, because the proposed action falls within Exemption Class #1, Comprehensive Exemption List for the State of Hawai'i, Department of Transportation, dated November 15, 2000, as approved by the Environmental Quality Council. Exemption Class #1 covers operations, repairs, or maintenance of existing structures, facilities, equipment, or topographical features involving negligible or no expansion or change of use beyond that previously existing. The DOTA consulted with the U. S. Federal Aviation Administration as to the appropriateness of the citation of the Environmental Exemption Class from the Comprehensive list for the Department of Transportation dated November 15, 2000. The FAA concurred on the appropriateness.

REMARKS:

The Department of Transportation (DOT) has no objections to ACS's request. DOT is implementing dispositions of the LIH Cargo Building in order to optimize revenue for the State in accordance with Sections 171-11 and 171-55, HRS, relating to Public Purposes and Permits, respectively, and therefore, the DOT proposes to issue a month-to-month revocable permit to ACS, Area/Space Nos. 135-106C and 135-106D for its freight forwarding of air cargo at the LIH Cargo Building.

RECOMMENDATION:

That the Board authorize the Department of Transportation to issue a month-to-month revocable permit to ACS, subject to: (1) terms and conditions herein outlined, which are by reference incorporated herein; and (2) such additional terms and conditions as may be prescribed by the Director of Transportation to best serve the interests of the State.

Respectfully submitted,



FORD N. FUCHIGAMI  
Director of Transportation

APPROVED FOR SUBMITTAL:

  
SUZANNE D. CASE  
Chairperson and Member

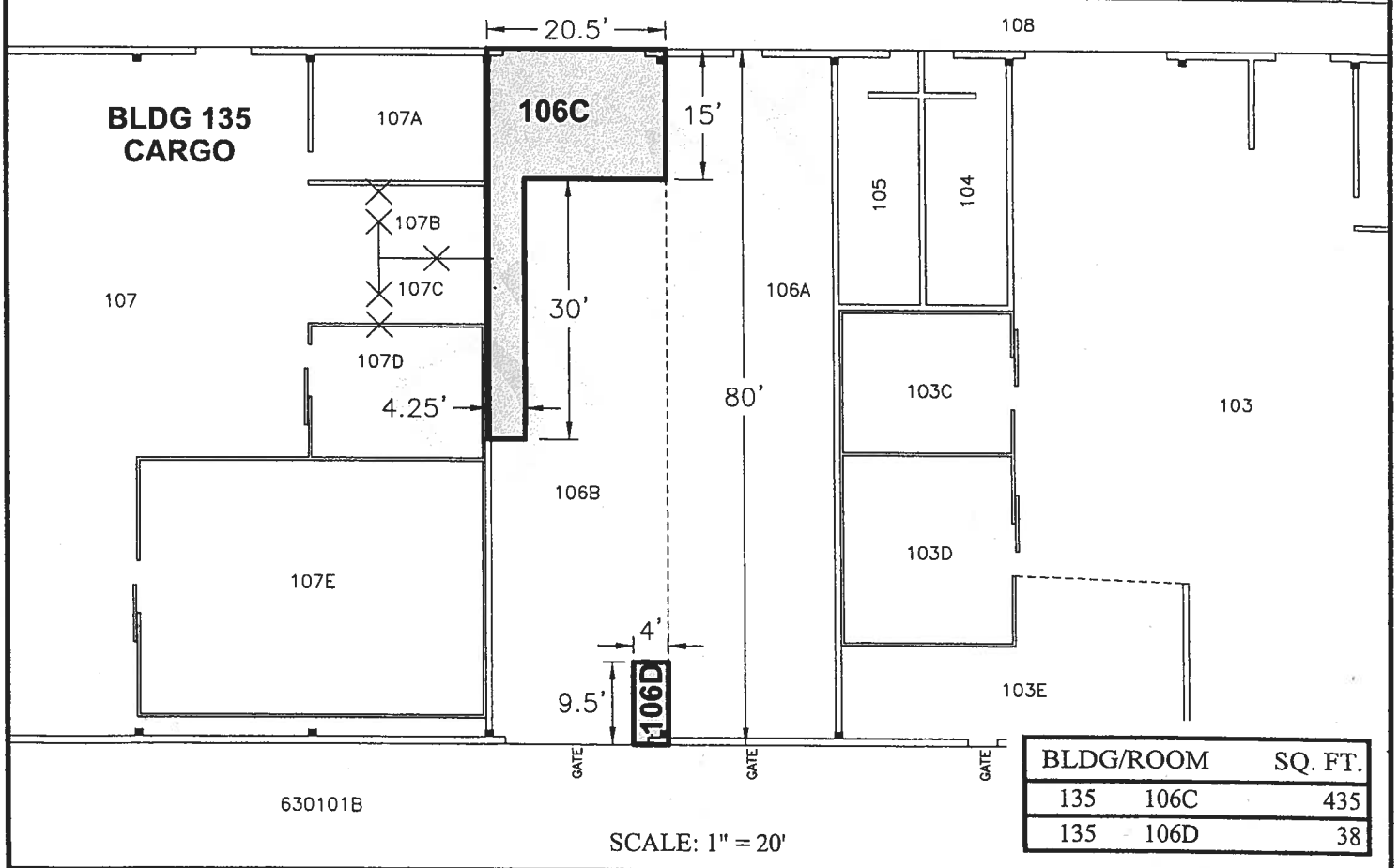
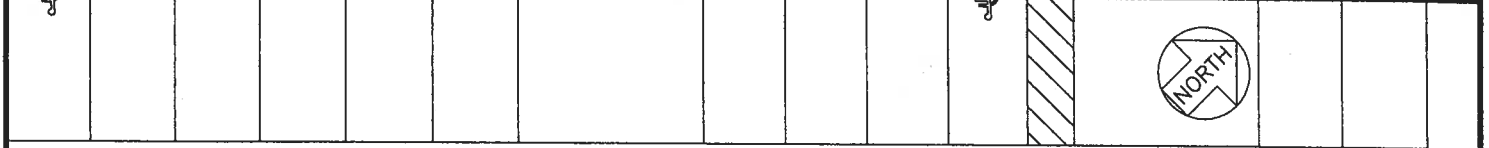
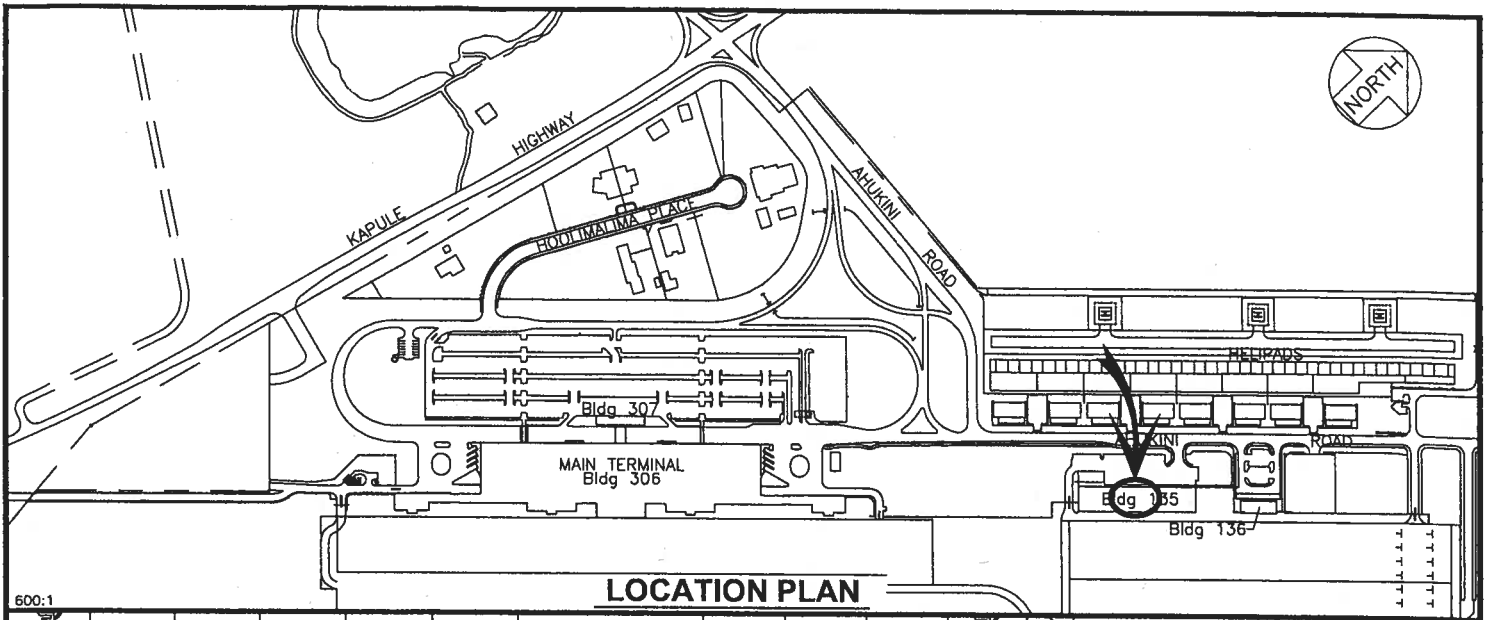

DRAFT DATE : MARCH 2017 EXHIBIT: **A**



ALOHA CONTRACT SERVICES

BUILDING 135  
CARGO  
APRON LEVEL

135106C  
135106D  
PLATS A1, 35