

DAVID Y. IGE  
GOVERNOR

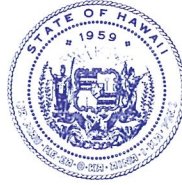

**STATE OF HAWAII  
DEPARTMENT OF TRANSPORTATION  
AIRPORTS DIVISION**

400 RODGERS BOULEVARD, SUITE 700  
HONOLULU, HAWAII 96819-1880

FORD N. FUCHIGAMI  
DIRECTOR

Deputy Directors  
JADE T. BUTAY  
ROSS M. HIGASHI  
EDWIN H. SNIFFEN  
DARRELL T. YOUNG

IN REPLY REFER TO:

Board of Land and  
Natural Resources  
State of Hawai'i  
Honolulu, Hawai'i

ISSUANCE OF A REVOCABLE PERMIT FOR A RAMP PARKING AREA  
FOR AIR CARGO GROUND SERVICE EQUIPMENT  
COMMODITY FORWARDERS, INC.  
ELLISON ONIZUKA KONA INTERNATIONAL AIRPORT AT KEĀHOLE  
TAX MAP KEY: (3) 7-3-43: PORTION OF 40

HAWAI'I

LEGAL REFERENCE:

Sections 171-11 and 171-55, Hawai'i Revised Statutes.

APPLICANT:

Commodity Forwarders, Inc. ("CFI"), whose business address 11101 South La Cienega Blvd, Los Angeles, California 90045.

LOCATION AND TAX MAP KEY:

Portion of Ellison Onizuka Kona International Airport at Keāhole ("KOA"), Kailua-Kona, Island of Hawai'i, identified by Tax Map Key: 3rd Division, 7-3-43: Portion of 40.

AREA:

Area/Space No. 630-136, containing an area of approximately 1,404 square feet shown on the attached Exhibit A.

ZONING:

State Land Use District:  
County of Hawai'i:

Urban & Conservation  
Industrial (MG-1a) and Open

**ITEM M-7**

BLNR – ISSUANCE OF A REVOCABLE PERMIT FOR A RAMP PARKING AREA FOR  
AIR CARGO GROUND SERVICE EQUIPMENT  
COMMODITY FORWARDERS, INC.

Page 2

LAND TITLE STATUS:

Section 5(a) lands of the Hawai'i Admission Act: Ceded  
DHHL 30% entitlement lands pursuant to Hawai'i Admission Act YES \_\_\_ NO X

CURRENT USE STATUS:

Airport purposes.

CHARACTER OF USE:

Ramp parking area for air cargo ground service equipment.

COMMENCEMENT DATE:

To be determined by the Deputy Director of Transportation, Airports Division.

MONTHLY RENTAL:

\$197.73

SECURITY DEPOSIT:

\$593.19

HOLDOVER TENANCY:

\$6.59

DCCA VERIFICATION:

Place of business registration confirmed:	YES <u>X</u>	NO _____
Registered business name confirmed:	YES <u>X</u>	NO _____
Good standing confirmed:	YES <u>X</u>	NO _____

CHAPTER 343, HRS - ENVIRONMENTAL ASSESSMENT:

Pursuant to Section 11-200-8(a), Environmental Impact Statement Rules of the Department of Health, State of Hawai'i, this disposition is exempt from requirements regarding preparation of an environmental assessment, negative declaration, or environmental impact statement as required by Chapter 343, Hawai'i Revised Statutes, as amended, relating to Environmental Impact Statements, because the proposed action falls

BLNR – ISSUANCE OF A REVOCABLE PERMIT FOR A RAMP PARKING AREA FOR  
AIR CARGO GROUND SERVICE EQUIPMENT  
COMMODITY FORWARDERS, INC.

Page 3

within Exemption Class #1, Comprehensive Exemption List for the State of Hawai'i, Department of Transportation, dated November 15, 2000, as approved by the Environmental Quality Council. Exemption Class #1 covers operations, repairs, or maintenance of existing structures, facilities, equipment, or topographical features involving negligible or no expansion or change of use beyond that previously existing.

The DOTA consulted with the U.S. Federal Aviation Administration as to the appropriateness of the citation of the Environmental Exemption Class from the Comprehensive list for the Department of Transportation dated November 15, 2000. The FAA concurred on the appropriateness.

REMARKS:

The Department of Transportation (DOT) has no objections to CFI's request and therefore, in accordance with Sections 171-11 and 171-55, HRS, relating to Public Purposes and Permits, respectively and therefore, the DOT proposes to issue a month-to-month revocable permit to CFI for ramp parking area for its ground service equipment.

RECOMMENDATION:

That the Board authorize the Department of Transportation to issue a month-to-month revocable permit to CFI, subject to: (1) terms and conditions herein outlined, which are by reference incorporated herein; and (2) such additional terms and conditions as may be prescribed by the Director of Transportation to best serve the interests of the State.

Respectfully submitted,



FORD N. FUCHIGAMI  
Director of Transportation

APPROVED FOR SUBMITTAL:

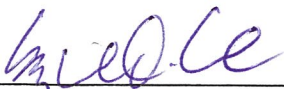

SUZANNE D. CASE  
Chairperson and Member



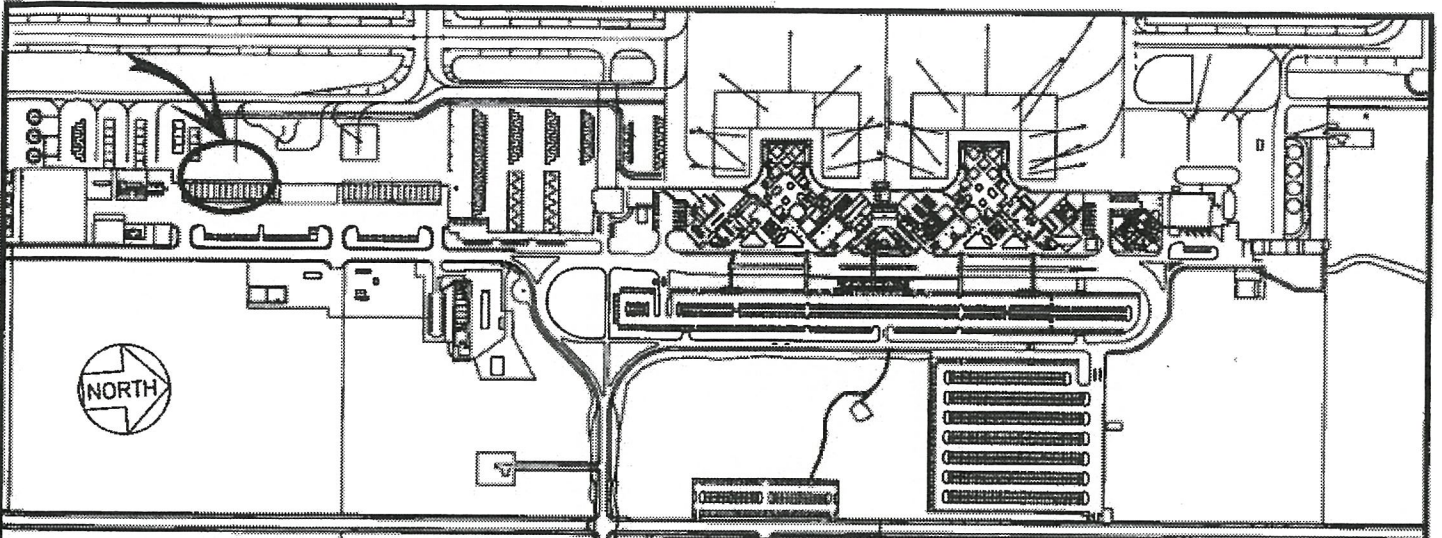

LOCATION PLAN

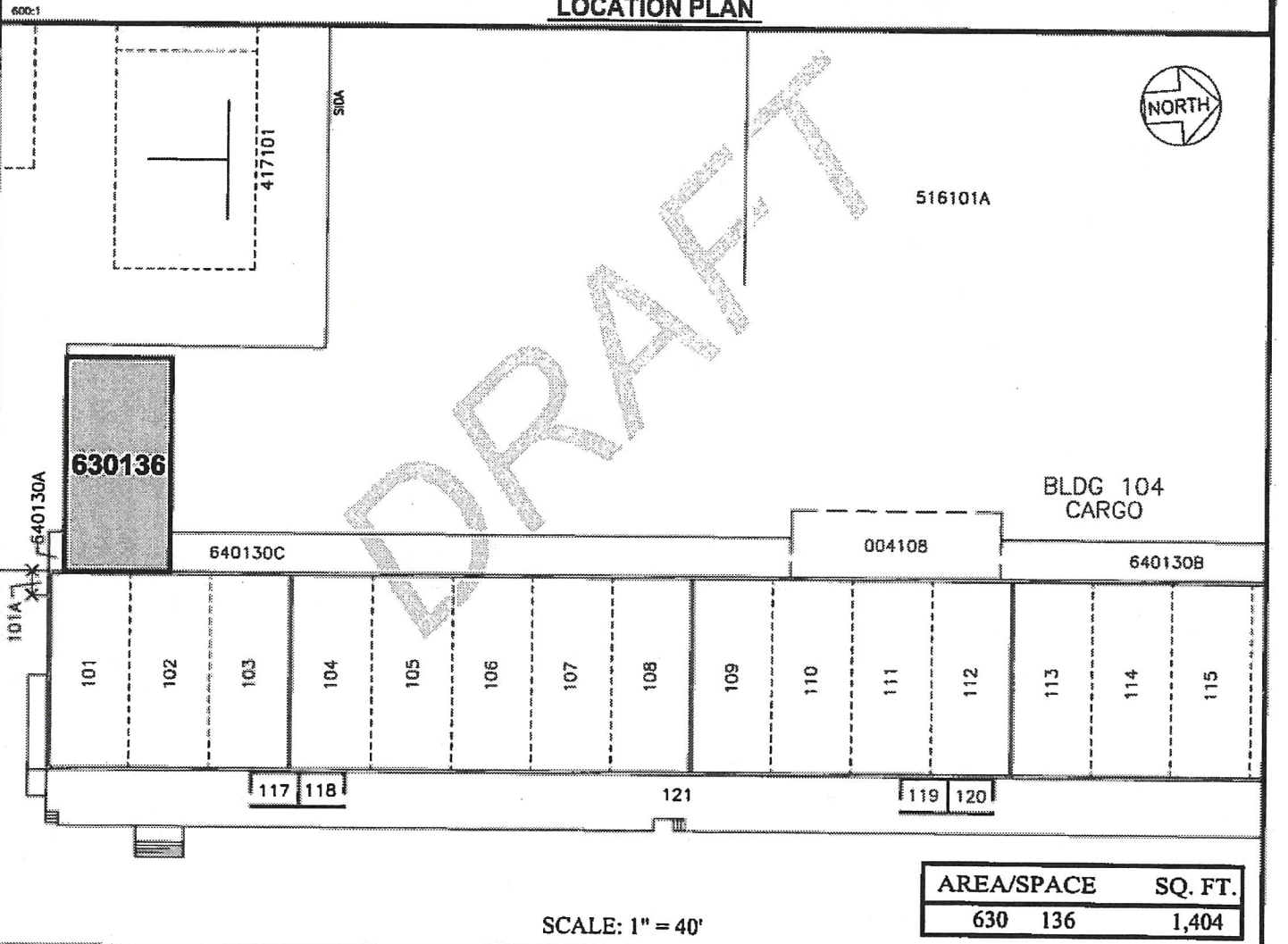

AREA/SPACE	SQ. FT.
630 136	1,404

SCALE: 1" = 40'

DRAFT	DATE : FEBRUARY 2015	EXHIBIT: <b>A</b>	
	COMMODITY FORWARDERS, INC	PAVED AREA GROUND LEVEL	630136
	dba CFI		PLATS B1, 39

KONA INTERNATIONAL AIRPORT AT KEAHOLE

N:\AIRPORTS\KOA\_Kona\CAD\PM\koa\_630136-01\_draft.dwg