

DAVID Y. IGE  
GOVERNOR



STATE OF HAWAII  
DEPARTMENT OF TRANSPORTATION  
869 PUNCHBOWL STREET  
HONOLULU, HAWAII 96813-5097

FORD N. FUCHIGAMI  
DIRECTOR

Deputy Directors  
JADE T. BUTAY  
ROSS M. HIGASHI  
EDWIN H. SNIFFEN  
DARRELL T. YOUNG

IN REPLY REFER TO:

Board of Land and  
Natural Resources  
State of Hawai'i  
Honolulu, Hawai'i

ISSUANCE OF A REVOCABLE PERMIT FOR A T-HANGAR  
FOR STORAGE AND MAINTENANCE OF AIRCRAFT  
CLARENCE K. AND CORRINE KANAE  
KALAELOA AIRPORT  
TAX MAP KEY: (1) 9-1-13: PORTION OF 32

O'AHU

REQUEST:

Issuance of a revocable permit for a T-Hangar for storage and maintenance of aircraft to Clarence K. and Corrine Kanae, situated at Kalaeloa Airport.

LEGAL REFERENCE:

Section 171-55, Hawai'i Revised Statutes.

APPLICANT:

Clarence K. and Corrine Kanae, whose mailing address is 92-898 Palailai Street, Kapolei, Hawai'i 96707-1229.

LOCATION AND TAX MAP KEY:

A portion of Kalaeloa Airport, Island of O'ahu, State of Hawai'i, identified by Tax Map Key: 1<sup>st</sup> Division, 9-1-13: portion of 32.

AREA:

Area/Space No. 409-103, containing an area of 1,750 square feet, as shown and delineated on the attached map labeled Exhibit "A".

ITEM M-3

BLNR – ISSUANCE OF A REVOCABLE PERMIT FOR A T-HANGAR  
FOR STORAGE AND MAINTENANCE OF AIRCRAFT  
CLARENCE K. AND CORRINE KANAE, KALAELOA AIRPORT

Page 2

ZONING:

State Land Use District: Urban  
City and County of Honolulu: P-2 (To be rezoned in the future)

LAND TITLE STATUS:

Non-ceded - Section 5(a) lands of the Hawai'i Admission Act  
DHHL 30% entitlement lands pursuant to Hawai'i Admission Act YES \_\_\_ NO X

CURRENT USE STATUS:

Land presently encumbered by Governor's Executive Order No. 3861, setting aside  
Kalaeloa Airport under the control and management of the State of Hawai'i, Department  
of Transportation, Airports Division (DOTA) for Airport Purposes.

CHARACTER OF USE:

T-Hangar for storage and maintenance of aircraft (1946 AERONCA 7AC,  
Tail No. N-84626).

COMMENCEMENT DATE:

To be determined by the Director of Transportation at a later date.

MONTHLY RENTAL:

\$875.00 (as determined from the DOTA schedule of rates and charges established by  
appraisal of Airports property statewide).

SECURITY DEPOSIT:

Three (3) times the monthly rental in effect.

CHAPTER 343, HRS - ENVIRONMENTAL ASSESSMENT:

The subject land area is covered by the Final Environmental Assessment for the Kalaeloa  
Airfield Development Plan Improvements, State Project No. AO5011-02 dated June 2010.  
This Environmental Assessment was prepared by Wilson Okamoto Corp. for the State of  
Hawai'i, Department of Transportation, Airports Division, in part to evaluate the

BLNR – ISSUANCE OF A REVOCABLE PERMIT FOR A T-HANGAR  
FOR STORAGE AND MAINTENANCE OF AIRCRAFT  
CLARENCE K. AND CORRINE KANAE, KALAELOA AIRPORT  
Page 3

environmental effects of the recommended Kalaeloa Airfield Master Plan to meet existing and forecast general aviation demands.

REMARKS:

The issuance of a revocable permit to Clarence K. and Corrine Kanae for a T-Hangar for storage and maintenance of aircraft at Kalaeloa Airport complies with Chapter 343, Exemption Class 1.D.10 as a continuing aeronautical use, and is in accordance with Section 171-55 HRS, relating to Permits.

RECOMMENDATION:

That the Board authorize the Department of Transportation to issue a month-to-month revocable permit to Clarence K. and Corrine Kanae, subject to: (1) terms and conditions herein outlined, which are by reference incorporated herein; and (2) such additional terms and conditions as may be prescribed by the Director of Transportation to best serve the interests of the State.

Respectfully submitted,



FORD N. FUCHIGAMI  
Director of Transportation

APPROVED FOR SUBMITTAL:



---

SUZANNE D. CASE  
Chairperson and Member

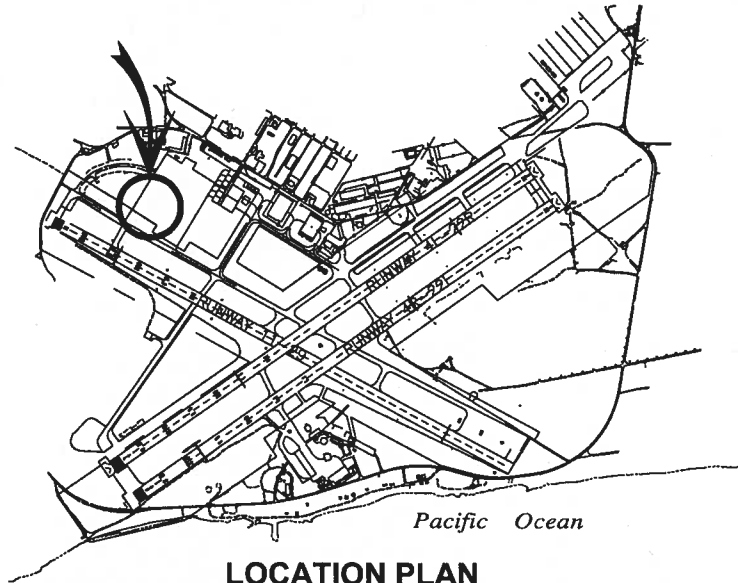

**LOCATION PLAN**

3000:1

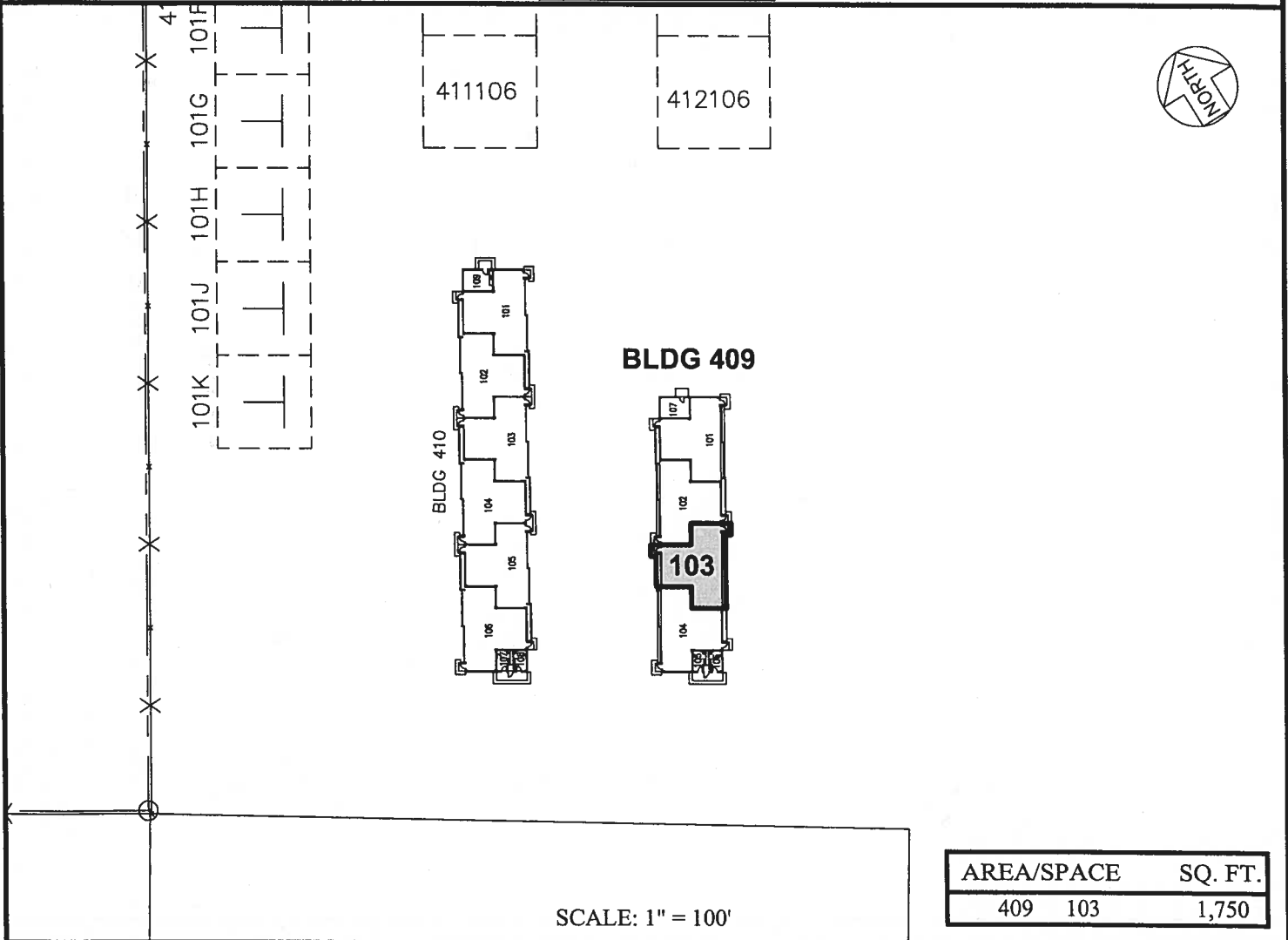

SCALE: 1" = 100'

AREA/SPACE	SQ. FT.
409 103	1,750

RP-8673

DATE : OCTOBER 2017

EXHIBIT: **A**



Airports Division

CLARENCE K. AND  
CORRINE KANAE

BUILDING 409  
T-HANGARS

409103

**KALAELOA AIRPORT**