

DAVID Y. IGE
GOVERNOR



STATE OF HAWAII
DEPARTMENT OF TRANSPORTATION
869 PUNCHBOWL STREET
HONOLULU, HAWAII 96813-5097

FORD N. FUCHIGAMI
DIRECTOR

Deputy Directors
JADE T. BUTAY
ROSS M. HIGASHI
EDWIN H. SNIFFEN
DARRELL T. YOUNG

IN REPLY REFER TO:

Board of Land and
Natural Resources
State of Hawai'i
Honolulu, Hawai'i

ISSUANCE OF A REVOCABLE PERMIT
FOR AN OFFICE SPACE AND A GREETERS' STATION
MC&A, INC.
ELLISON ONIZUKA KONA INTERNATIONAL AIRPORT AT KEĀHOLE
TAX MAP KEY: (3) 7-3-43: PORTION OF 40

HAWAII

LEGAL REFERENCE:

Sections 171-11 and 171-55, Hawai'i Revised Statutes.

APPLICANT:

MC&A, Inc. (MCA), whose business address 616 Piikoi Street, Suite 1000,
Honolulu, Hawai'i, 96814.

LOCATION AND TAX MAP KEY:

Portion of Ellison Onizuka Kona International Airport at Keāhole (KOA), Kailua-Kona,
Island of Hawai'i, identified by Tax Map Key: 3rd Division, 7-3-43: Portion of 40

AREA:

Bldg/Rooms 327-109 & -110 in the Main Terminal, containing an area of approximately
102 and 118 square feet, respectively, as shown on the attached Exhibit A

ZONING:

State Land Use District:
County of Hawai'i:

Urban & Conservation
Industrial (MG-1a) and Open

ITEM M-10

BLNR – ISSUANCE OF A REVOCABLE PERMIT FOR AN OFFICE SPACE AND
GREETERS' STATION, MC&A, INC.

ELLISON ONIZUKA KONA INTERNATIONAL AIRPORT AT KEĀHOLE

Page 2

LAND TITLE STATUS:

Section 5(a) lands of the Hawai'i Admission Act: Ceded

DHHL 30% entitlement lands pursuant to Hawai'i Admission Act YES___ NO X

CURRENT USE STATUS:

Airport and aeronautical purposes.

CHARACTER OF USE:

Greeters' station and office space in the Main Terminal

COMMENCEMENT DATE:

To be determined by the Director of Transportation

MONTHLY RENTAL:

\$521.80

SECURITY DEPOSIT:

\$1,565.40

HOLDOVER TENANCY:

\$17.39

DCCA VERIFICATION:

Place of business registration confirmed: YES X NO _____

Registered business name confirmed: YES X NO _____

Good standing confirmed: YES X NO _____

CHAPTER 343, HRS - ENVIRONMENTAL ASSESSMENT:

Pursuant to Section 11-200-8(a), Environmental Impact Statement Rules of the Department of Health, State of Hawai'i, this disposition is exempt from requirements regarding preparation of an environmental assessment, negative declaration, or environmental impact statement as required by Chapter 343, Hawai'i Revised Statutes, as amended, relating to Environmental Impact Statements, because the proposed action falls

BLNR – ISSUANCE OF A REVOCABLE PERMIT FOR AN OFFICE SPACE AND
GREETERS' STATION, MC&A, INC.
ELLISON ONIZUKA KONA INTERNATIONAL AIRPORT AT KEĀHOLE

Page 3

within Exemption Class #1, Comprehensive Exemption List for the State of Hawai'i, Department of Transportation, dated November 15, 2000, as approved by the Environmental Quality Council. Exemption Class #1 covers operations, repairs, or maintenance of existing structures, facilities, equipment, or topographical features involving negligible or no expansion or change of use beyond that previously existing.

The DOTA consulted with the U.S. Federal Aviation Administration as to the appropriateness of the citation of the Environmental Exemption Class from the Comprehensive list for the Department of Transportation dated November 15, 2000. In this case, the FAA concurred on the appropriateness.

REMARKS:

The Department of Transportation (DOT) has no objections to MCA's request and therefore, in accordance with Sections 171-11 and 171-55, HRS, relating to Public Purposes and Permits, respectively and therefore, the DOT proposes to issue a month-to-month revocable permit to MCA for a greeters' station & office space in the Main Terminal.

RECOMMENDATION:

That the Board authorize the Department of Transportation to issue a month-to-month revocable permit to MCA, subject to: (1) terms and conditions herein outlined, which are by reference incorporated herein; and (2) such additional terms and conditions as may be prescribed by the Director of Transportation to best serve the interests of the State

Respectfully submitted,



FORD N. FUCHIGAMI
Director of Transportation

APPROVED FOR SUBMITTAL:

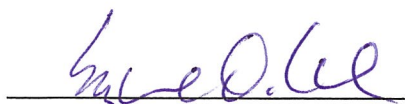

SUZANNE D. CASE
Chairperson and Member

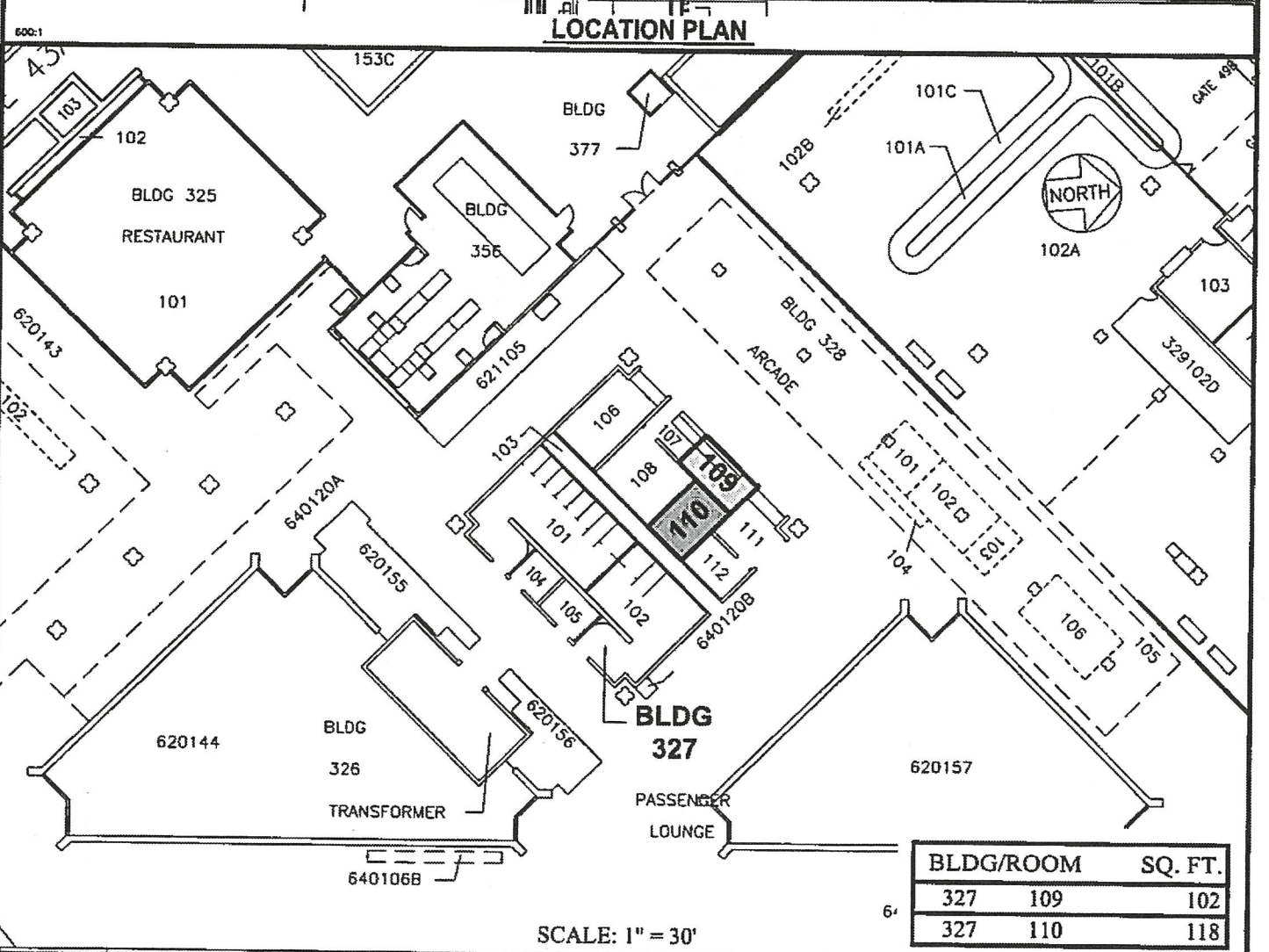
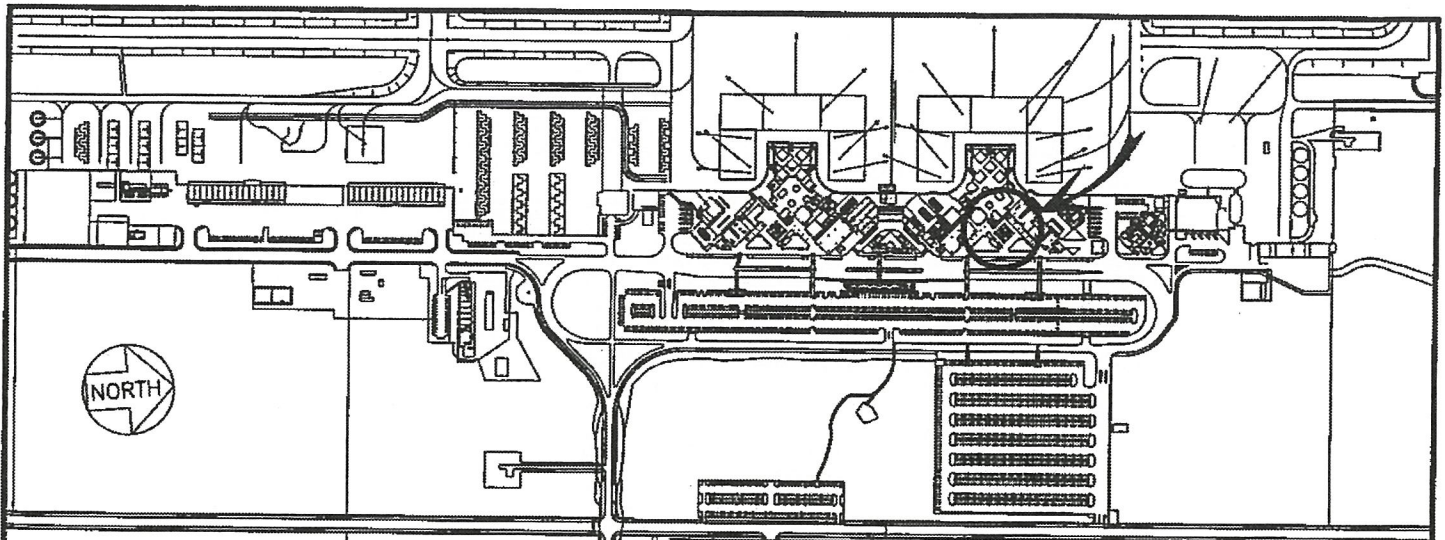

DATE : AUGUST 2017

EXHIBIT: A



Airports Division

BUILDING 327
PASSENGER LOUNGE
GROUND LEVEL

327109
327110

PLATS E1, 58

ELLISON ONIZUKA KONA INTERNATIONAL AIRPORT AT KEAHOLE

N:\AIRPORTS\KOA_Kona\CAD\PM\koa_327109-01.dwg