

DAVID Y. IGE
GOVERNOR



STATE OF HAWAII
DEPARTMENT OF TRANSPORTATION
869 PUNCHBOWL STREET
HONOLULU, HAWAII 96813-5097

FORD N. FUCHIGAMI
DIRECTOR

Deputy Directors
JADE T. BUTAY
ROSS M. HIGASHI
EDWIN H. SNIFFEN
DARRELL T. YOUNG

IN REPLY REFER TO:

Board of Land and
Natural Resources
State of Hawai'i
Honolulu, Hawai'i

ISSUANCE OF A REVOCABLE PERMIT FOR AIRCRAFT PARKING
DAVID A. OSTERHOLT
ELLISON ONIZUKA KONA INTERNATIONAL AIRPORT AT KEĀHOLE
TAX MAP KEY: (3) 7-3-43: PORTION OF 40 HAWAI'I

REQUEST:

Issuance of a revocable permit for aircraft parking (parking permit) to David A. Osterholt.

LEGAL REFERENCE:

Sections 171-55, Hawai'i Revised Statutes.

APPLICANT:

David A. Osterholt, whose address is 73-4458 Akele Place, Kailua-Kona, Hawai'i 96740.

LOCATION AND TAX MAP KEY:

Portion of Ellison Onizuka Kona International Airport at Keāhole ("KOA"), Kailua-Kona, Island of Hawai'i, identified by Tax Map Key: 3rd division, 7-3-43: Portion of 40.

AREA:

Area/Space Nos. 407-115, containing an area of 990 square feet, as shown and delineated on the attached Exhibit A.

ZONING:

State Land Use District:
County of Hawai'i:

Urban & Conservation
Industrial (MG-1a) and Open

ITEM M-11

BLNR – ISSUANCE OF A REVOCABLE PERMIT FOR AIRCRAFT PARKING
DAVID A. OSTERHOLT
ELLISON ONIZUKA KONA INTERNATIONAL AIRPORT AT KEĀHOLE
Page 2

LAND TITLE STATUS:

Section 5(a) lands of the Hawai'i Admission Act: Ceded
DHHL 30% entitlement lands pursuant to Hawai'i Admission Act YES___ NO X

CURRENT USE STATUS:

Airport and aeronautical purposes.

CHARACTER OF USE:

Aircraft parking for tie-down.

COMMENCEMENT DATE:

To be determined by Director upon complete execution of the parking permit.

MONTHLY RENTAL:

\$ 96.00 (as determined from the DOTA schedule of rates and charges established by appraisal of Airports property statewide).

SECURITY DEPOSIT:

\$ 288.00 (three times the monthly rental)

DCCA VERIFICATION:

N/A

REMARKS:

The issuance of a parking permit for an aircraft tie-down to David A. Osterholt, at KOA complies with Chapter 343, Exemption Class 1.D.10. as continuing aeronautical use, and is in accordance with Section 171-55 HRS, relating to Permits.

The DOTA consulted with the U.S. Federal Aviation Administration as to the appropriateness of the citation of the Environmental Exemption Class from the Comprehensive list for the Department of Transportation dated November 15, 2000. In this case, the FAA concurred on the appropriateness.

BLNR – ISSUANCE OF A REVOCABLE PERMIT FOR AIRCRAFT PARKING
DAVID A. OSTERHOLT
ELLISON ONIZUKA KONA INTERNATIONAL AIRPORT AT KEĀHOLE
Page 3

RECOMMENDATION:

That the Board authorize the Department of Transportation to issue a month-to-month parking permit to David A. Osterholt, subject to: (1) terms and conditions herein outlined, which are by reference incorporated herein; and (2) such additional terms and conditions as may be prescribed by the Director of Transportation to best serve the interests of the State.

Respectfully submitted,



FORD N. FUCHIGAMI
Director of Transportation

APPROVED FOR SUBMITTAL:

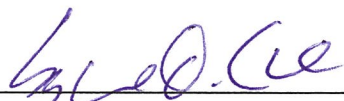

SUZANNE D. CASE
Chairperson and Member

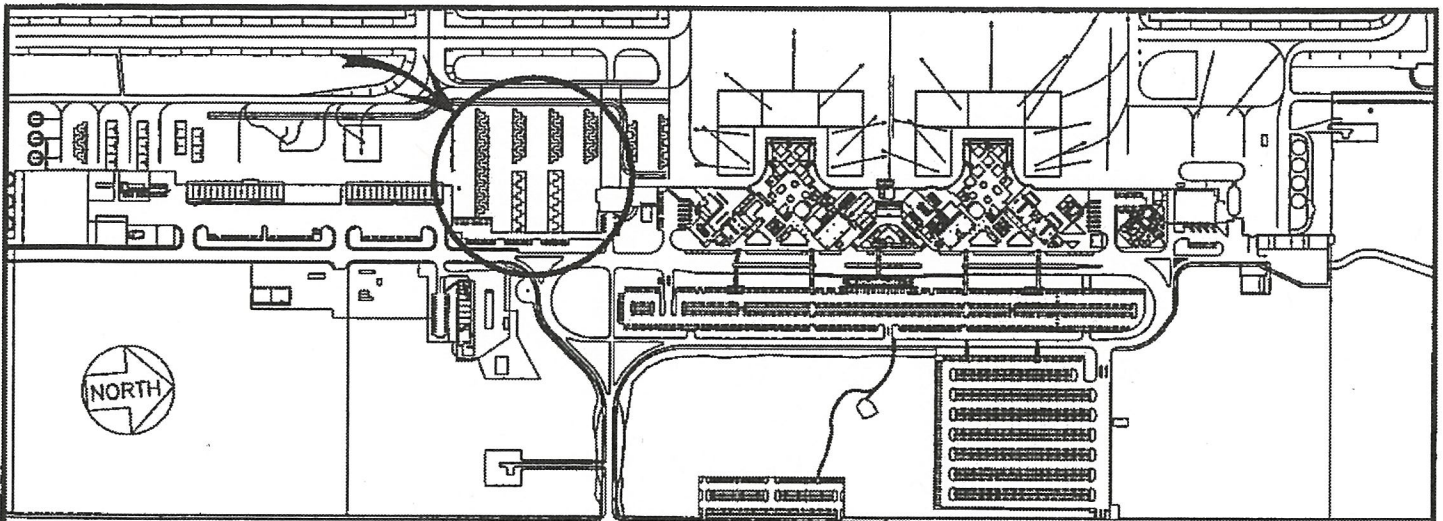

LOCATION PLAN

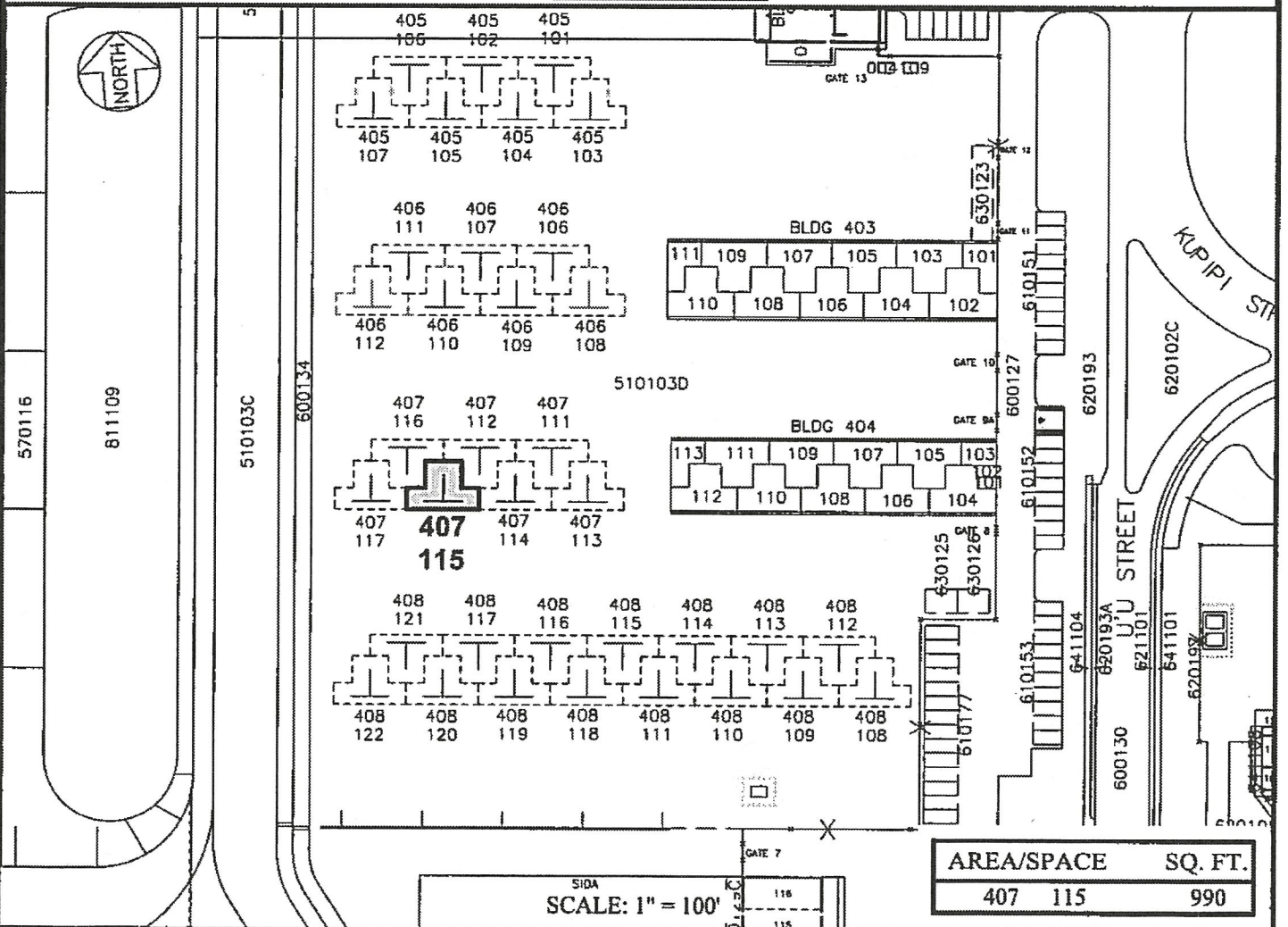

DATE : JULY 2017

EXHIBIT: A



Airports Division

DAVID OSTERHOLT

TIE-DOWN

407115

PLATS D1,39

KONA INTERNATIONAL AIRPORT AT KEAHOLE

N:\AIRPORTS\KOA_Kona\CAD\PM\koa_407115-01.dwg