

DAVID Y. IGE
GOVERNOR

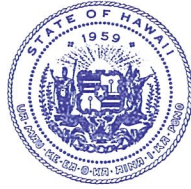

STATE OF HAWAII
DEPARTMENT OF TRANSPORTATION
869 PUNCHBOWL STREET
HONOLULU, HAWAII 96813-5097

FORD N. FUCHIGAMI
DIRECTOR

Deputy Directors
JADE T. BUTAY
ROSS M. HIGASHI
EDWIN H. SNIFFEN
DARRELL T. YOUNG

IN REPLY REFER TO:

Board of Land and
Natural Resources
State of Hawai'i
Honolulu, Hawai'i

ISSUANCE OF A REVOCABLE PERMIT FOR EQUIPMENT PARKING,
RAMP OFFICE, TICKET COUNTER, CURBSIDE CHECK-IN AND
BAGGAGE CLAIM OFFICE
UNITED AIRLINES, INC.
LĪHU'E AIRPORT
TAX MAP KEY: (4) 3-5-01: PORTION OF 8

KAUA'I

REQUEST:

Issuance of a revocable permit for equipment parking, ramp office, ticket counter and ground service equipment parking to United Airlines, Inc. at Līhu'e Airport ("LIH").

LEGAL REFERENCE:

Sections 171-11 and 171-55, Hawai'i Revised Statutes.

APPLICANT:

United Airlines, Inc. ("UA") whose business address 233 S. Wacker Drive, 11th Floor, Chicago, Illinois 60606-0649.

LOCATION:

Portion of Līhu'e Airport, Līhu'e, Island of Kaua'i, identified by
Tax Map Key: 4th Division, 3-5-01: Portion of 8

Areas & Buildings:

Area/Space Nos. 610-107, 610-188L, 640-133B, and 640-109D; and
Bldg/Room Nos. 306-105A, 306-105B, 306-105D, 306-105F, 306-107A, 306-107B, 306-114A, 306-124, 306-125, 306-212B, 306-213, 306-223A, 306-223B, 306-223C containing total areas as follows:

ITEM M-14

BLNR - ISSUANCE OF A REVOCABLE PERMIT FOR EQUIPMENT PARKING, RAMP
OFFICE, TICKET COUNTER, CURBSIDE CHECK-IN AND BAGGAGE CLAIM OFFICE
UNITED AIRLINES, INC., LĪHUʻE AIRPORT

Page 2

Total Terminal Space	7,373 sq. ft.
Total Open Ramp Space	7,324 sq. ft.
Total	14,697 sq. ft.,

as shown and delineated on the attached maps labeled Exhibits “A”, “B”, and “C”

ZONING:

State Land Use District:	Urban
County of Kauaʻi:	Industrial (I)

LAND TITLE STATUS:

Section 5(a) lands of the Hawaiʻi Admission Act: Non-Ceded
DHHL 30% entitlement lands pursuant to Hawaiʻi Admission Act YES _____ NO X

CURRENT USE STATUS:

Airport and aeronautical purposes

CHARACTER OF USE:

Ticket counter, terminal ramp offices, curbside check-in and ramp space for equipment
storage used in UA’s daily operations

COMMENCEMENT DATE:

To be determined by the Director upon complete execution of the revocable permit.

MONTHLY RENTAL:

\$47,884.63 (as determined from the DOTA schedule of rates and charges established by
appraisal of Airports property statewide).

SECURITY DEPOSIT:

\$143,653.90 (three times the monthly rental)

BLNR - ISSUANCE OF A REVOCABLE PERMIT FOR EQUIPMENT PARKING, RAMP
OFFICE, TICKET COUNTER, CURBSIDE CHECK-IN AND BAGGAGE CLAIM OFFICE
UNITED AIRLINES, INC., LĪHU'E AIRPORT

Page 3

HOLDOVER TENANCY:

\$1,596.15

DCCA VERIFICATION:

Place of business registration confirmed: YES ☒ NO ☐
Registered business name confirmed: YES ☒ NO ☐
Good standing confirmed: YES ☒ NO ☐

CHAPTER 343, HRS - ENVIRONMENTAL ASSESSMENT:

Pursuant to Section 11-200-8(a), Environmental Impact Statement Rules of the Department of Health, State of Hawaii, this disposition is exempt from requirements regarding preparation of an environmental assessment, negative declaration, or environmental impact statement as required by Chapter 343, Hawaii Revised Statutes, as amended, relating to Environmental Impact Statements, because the proposed action falls within Exemption Class #1, Comprehensive Exemption List for the State of Hawaii, Department of Transportation, dated November 15, 2000, as approved by the Environmental Quality Council. Exemption Class #1 covers operations, repairs, or maintenance of existing structures, facilities, equipment, or topographical features involving negligible or no expansion or change of use beyond that previously existing.

The DOTA consulted with the U.S. Federal Aviation Administration as to the appropriateness of the citation of the Environmental Exemption Class from the Comprehensive list for the Department of Transportation dated November 15, 2000. In this case, the FAA concurred on the appropriateness.

REMARKS:

The Department of Transportation (DOT) has no objections to UA's request. DOT is working to implement dispositions of the Līhu'e terminal ramp area in order to optimize revenue for the State and ensure the safe operation of the ramp area therefore, in accordance with Sections 171-11 and 171-55, HRS, relating to Public Purposes and Permits, respectively, and therefore, the DOT proposes to issue a month-to-month revocable permit to UA for Area/Space Nos. 610-107, 610-188L, 640-133B, 640-109D, and Bldg/Room Nos. 306-105A, 306-105B, 306-105D, 306-105F, 306-107A, 306-107B, 306-114A, 306-124, 306-125, 306-212B, 306-213, 306-223A, 306-223B, 306-223C for ticket counter, curbside check-in, baggage claim offices, GSE storage and ramp office at Līhu'e Airport.

BLNR - ISSUANCE OF A REVOCABLE PERMIT FOR EQUIPMENT PARKING, RAMP
OFFICE, TICKET COUNTER, CURBSIDE CHECK-IN AND BAGGAGE CLAIM OFFICE
UNITED AIRLINES, INC., LĪHU'E AIRPORT

Page 4

RECOMMENDATION:

That the Board authorize the Department of Transportation to issue a month-to-month revocable permit to UA subject to: (1) terms and conditions herein outlined, which are by reference incorporated herein; and (2) such additional terms and conditions as may be prescribed by the Director of Transportation to best serve the interests of the State.

Respectfully submitted,

A handwritten signature in blue ink, appearing to read 'F. N. Fuchigami', with a stylized, looped design.

FORD N. FUCHIGAMI
Director of Transportation

APPROVED FOR SUBMITTAL:

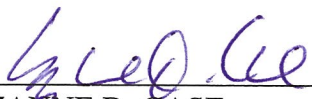
A handwritten signature in blue ink, appearing to read 'Suzanne D. Case', with a stylized, looped design.

SUZANNE D. CASE
Chairperson and Member

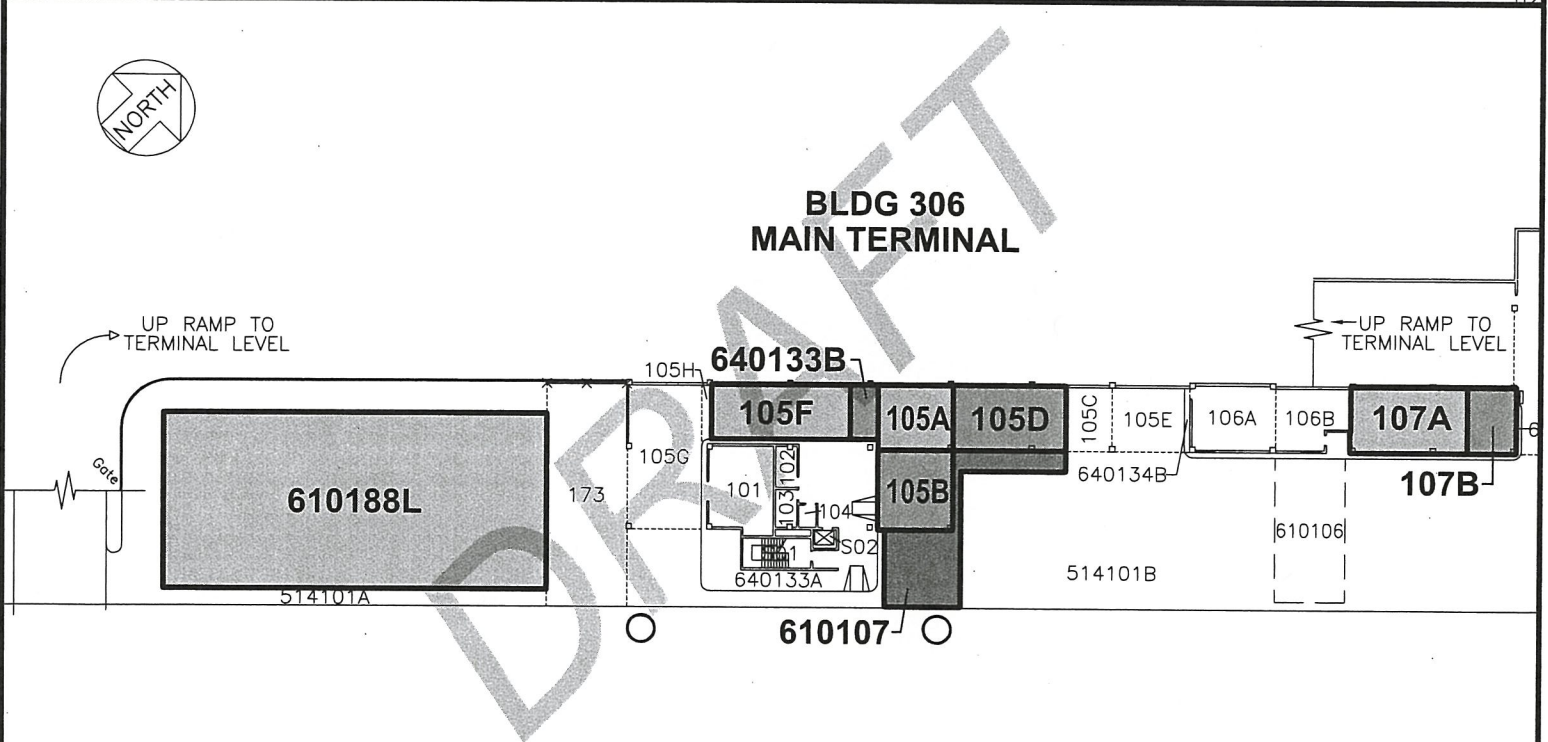
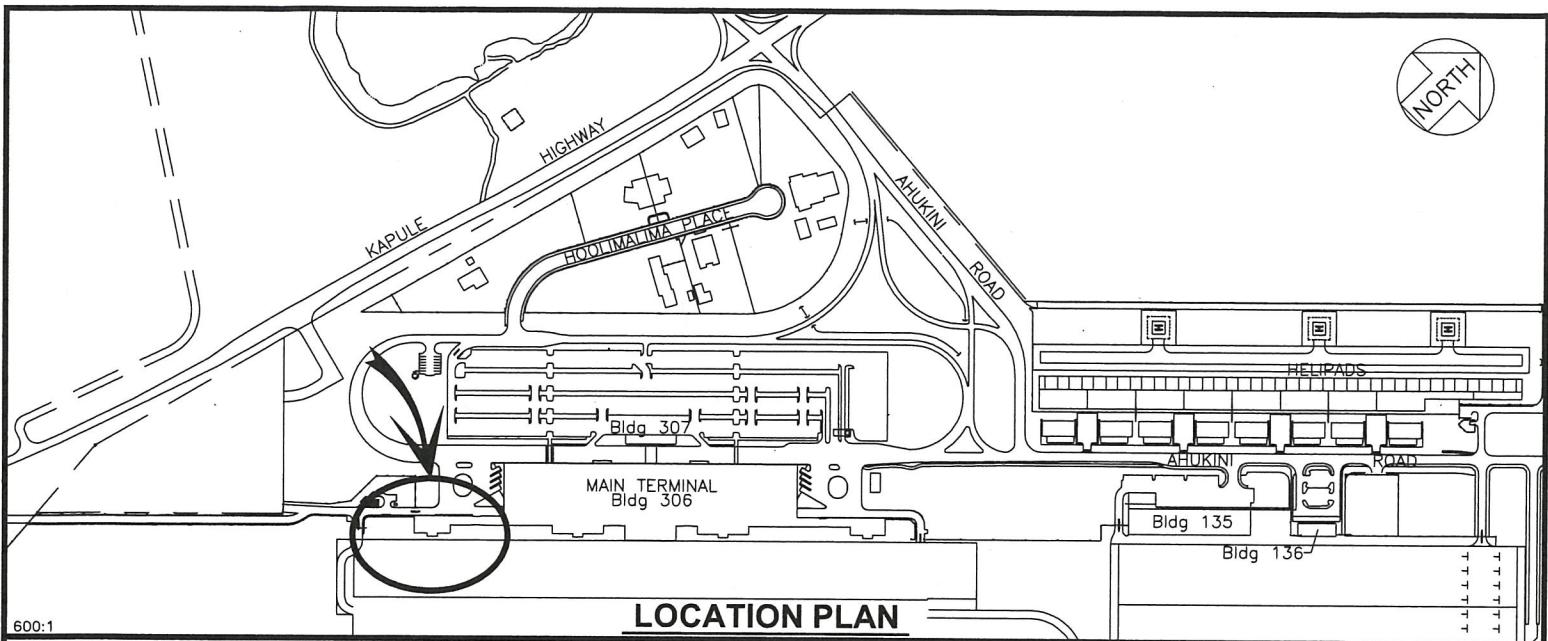

BLDG/ROOM	SQ. FT.
306 105A	476
306 105B	583
306 105D	711
306 105F	740
306 107A	756
306 107B	316

AREA/SPACE	SQ. FT.
610 107	834
610 188L	6,490
640 133B	148

RP-8642 (DRAFT)

DATE : JULY 2017

EXHIBIT: **A**



Airports Division

UNITED AIRLINES

BUILDING 306
MAIN TERMINAL
APRON LEVEL

306105A

PLATS C1, 44

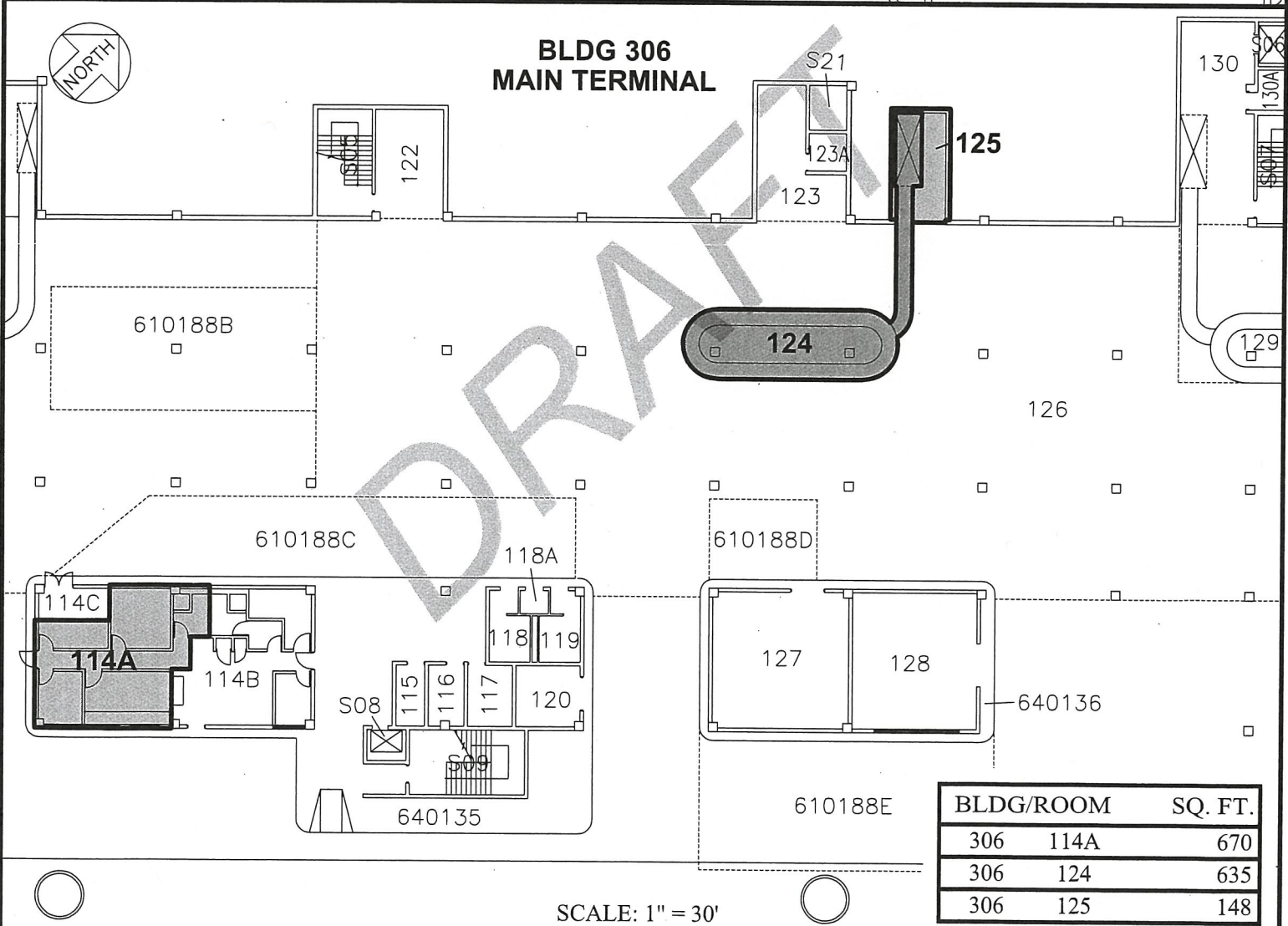
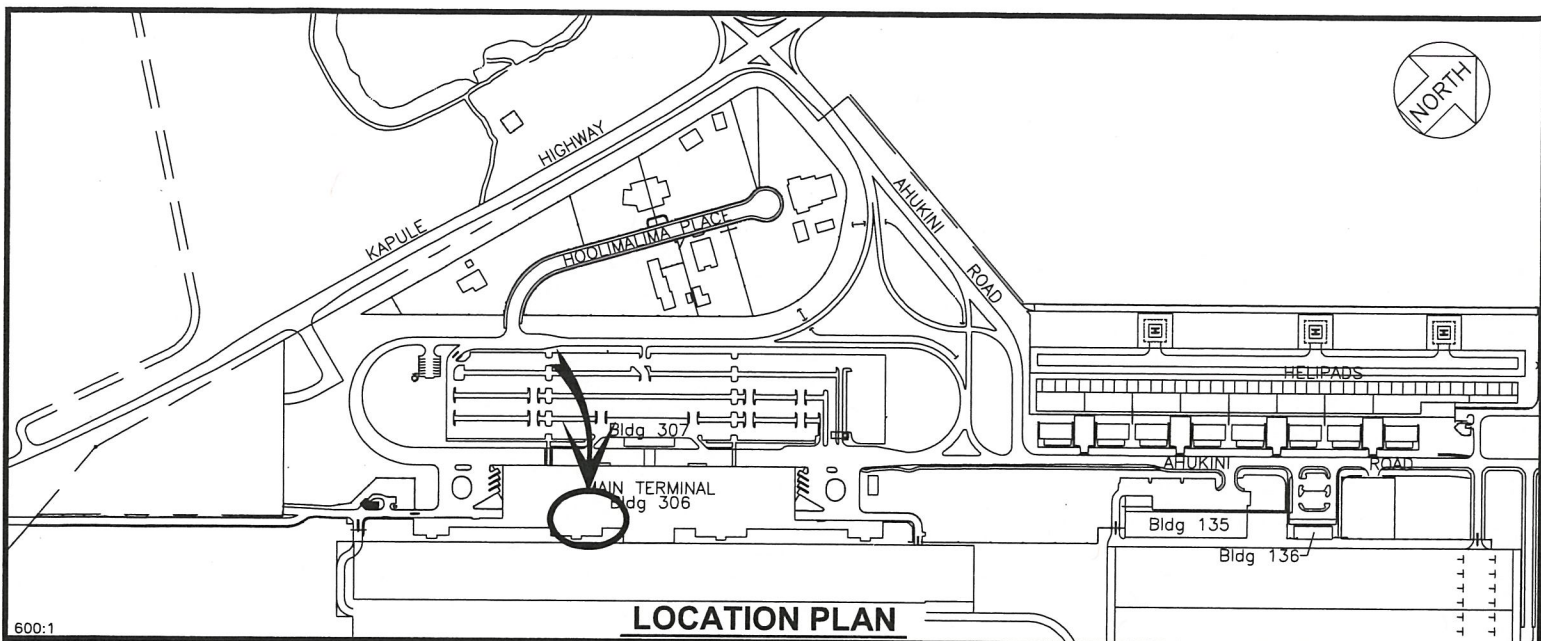

RP-8642 (DRAFT)

DATE : JULY 2017

EXHIBIT: **B**



Airports Division

UNITED AIRLINES

BUILDING 306
MAIN TERMINAL
APRON LEVEL

306114A
306124
306125
PLATS C1, 45

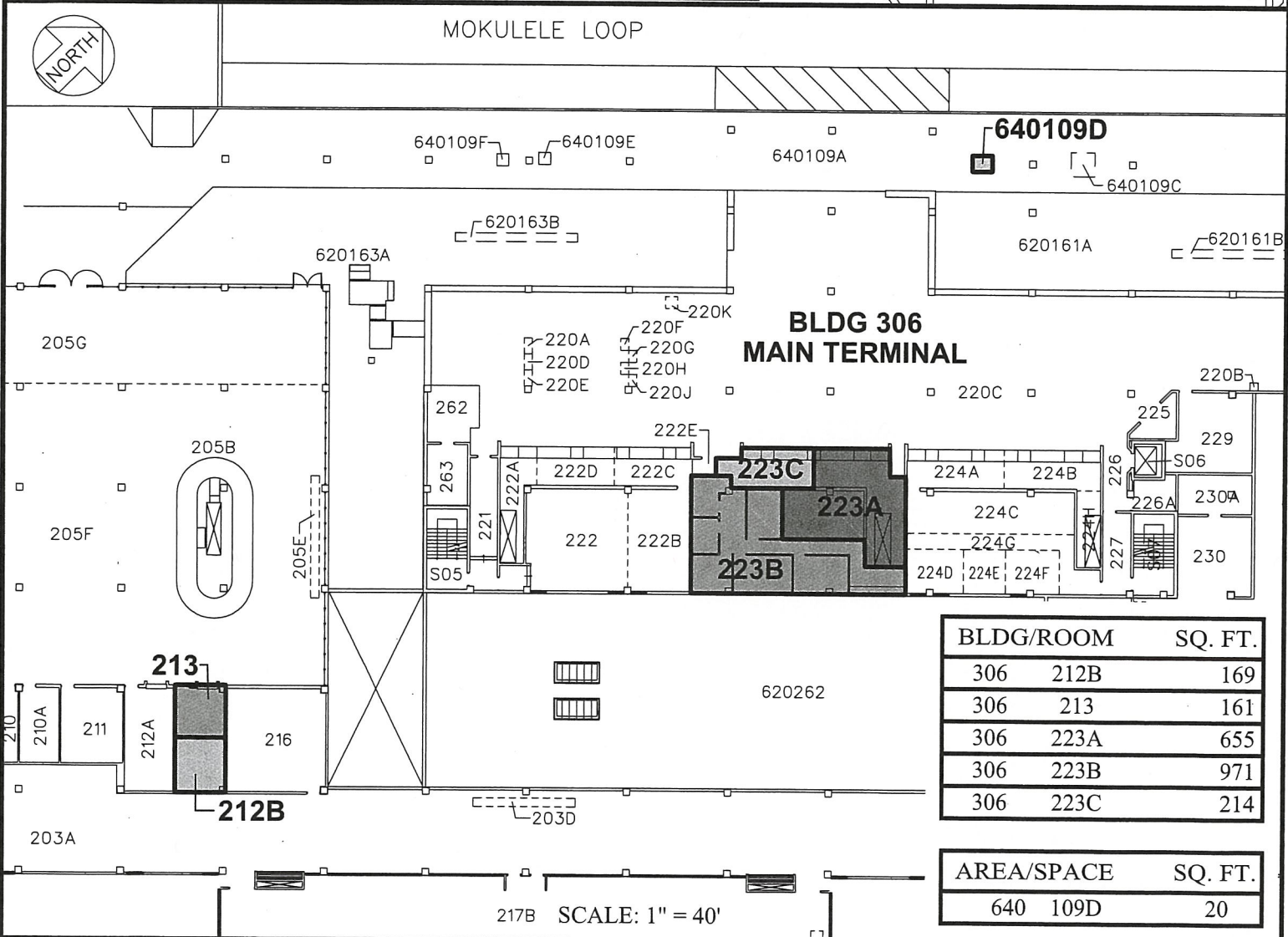
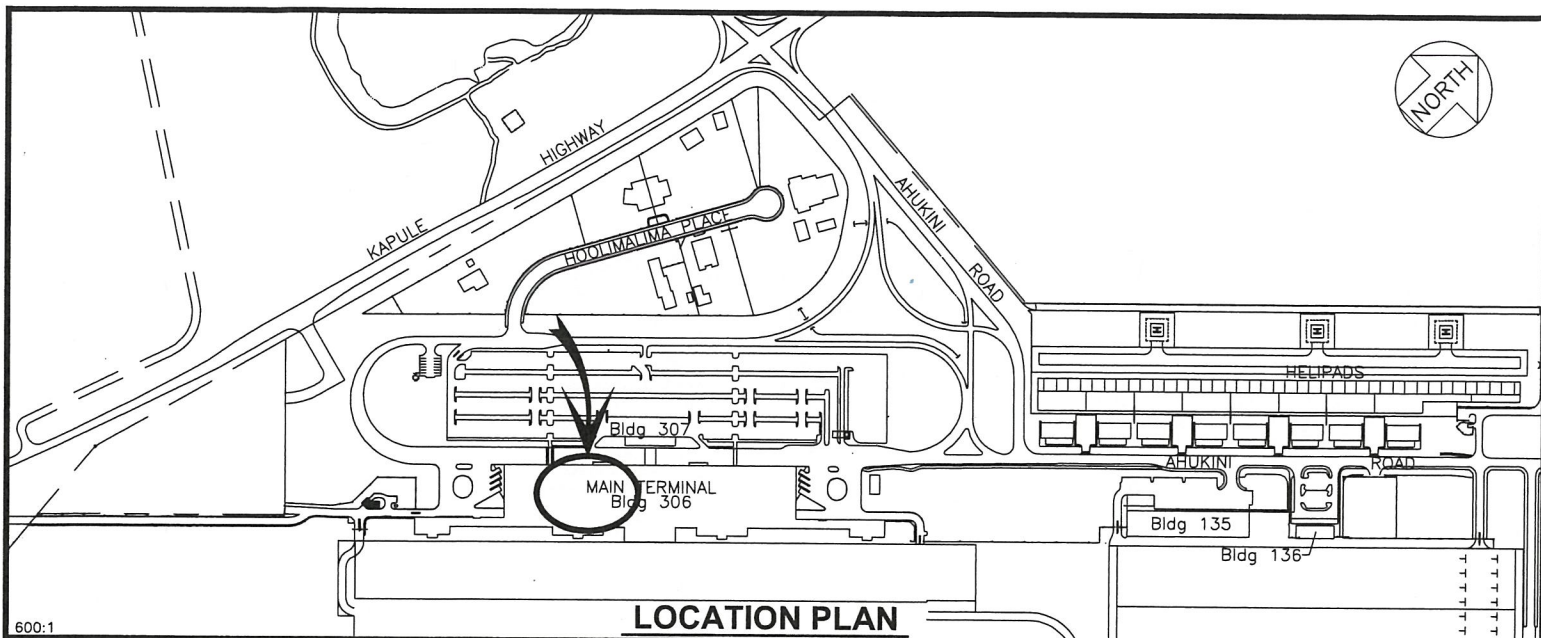

RP-8642

DATE : JULY 2017

EXHIBIT: **C**



UNITED AIRLINES

BUILDING 306
MAIN TERMINAL
TERMINAL LEVEL

306212B

PLATS C2, 45