



STATE OF HAWAII
DEPARTMENT OF TRANSPORTATION
869 PUNCHBOWL STREET
HONOLULU, HAWAII 96813-5097

JADE T. BUTAY
INTERIM DIRECTOR

Deputy Directors
ROSS M. HIGASHI
EDWIN H. SNIFFEN
DARRELL T. YOUNG

IN REPLY REFER TO:

Board of Land and
Natural Resources
State of Hawai'i
Honolulu, Hawai'i

ISSUANCE OF A REVOCABLE PERMIT FOR A T-HANGAR
FOR STORAGE AND MAINTENANCE OF AIRCRAFT
EAST OAHU PET HOSPITAL, LLC DBA GENTLE VETS HAWAII
DANIEL K. INOUE INTERNATIONAL AIRPORT
TAX MAP KEY: (1) 1-1-76: PORTION OF 20

O'AHU

REQUEST:

Issuance of a Revocable Permit for a T-Hangar for storage and maintenance of aircraft to East Oahu Pet Hospital, LLC dba Gentle Vets Hawaii, situated at Daniel K. Inouye International Airport.

LEGAL REFERENCE:

Section 171-55, Hawai'i Revised Statutes.

APPLICANT:

East Oahu Pet Hospital, LLC dba Gentle Vets Hawaii (EOPH, LLC), whose business address is 6650 Hawaii Kai Drive, Suite 105, Honolulu, Hawai'i 96825.

LOCATION AND TAX MAP KEY:

A portion of Daniel K. Inouye International Airport, Island of O'ahu, State of Hawai'i, identified as the South Ramp, Tax Map Key: 1st Division, 1-1-76: portion of 20.

AREA:

Area/Space No. 420-110, containing an area of approximately 1,247 square feet, as shown and delineated on the attached map labeled Exhibit "A".

ZONING:

State Land Use District: Urban
City and County of Honolulu LUO: Industrial (I-2)

ITEM M-2

BLNR – ISSUANCE OF A REVOCABLE PERMIT FOR A T-HANGAR
FOR STORAGE AND MAINTENANCE OF AIRCRAFT
EAST OAHU PET HOSPITAL, LLC DBA GENTLE VETS HAWAII
Page 2

LAND TITLE STATUS:

Non-ceded - Section 5(a) lands of the Hawai'i Admission Act
DHHL 30% entitlement lands pursuant to Hawai'i Admission Act YES ___ NO X

CURRENT USE STATUS:

Land presently encumbered by Governor's Executive Order No. 3201, dated June 8, 1983, setting aside 3,152.177 acres designated as Daniel K. Inouye International Airport under the control and management of the State of Hawai'i, Department of Transportation, Airports Division (DOTA) for Airport Purposes.

CHARACTER OF USE:

T-Hangar for storage and maintenance of aircraft (1985 Cessna R182, Tail No. N-64057).

COMMENCEMENT DATE:

Upon execution of the revocable permit.

MONTHLY RENTAL:

\$772.00 (\$717.00, as determined from the DOTA schedule of rates and charges established by appraisal of Airports property statewide plus \$55.00 for electricity)

SECURITY DEPOSIT:

Three (3) times the monthly rental in effect.

CHAPTER 343, HRS - ENVIRONMENTAL ASSESSMENT:

Pursuant to Section 11-200-8(a), Environmental Impact Statement Rules of the Department of Health, State of Hawai'i, this disposition is exempt from requirements regarding preparation of an environmental assessment, negative declaration, or environmental impact statement as required by Chapter 343, Hawai'i Revised Statutes, as amended, relating to Environmental Impact Statements, because the proposed action falls within Exemption Class #1, Comprehensive Exemption List for the State of Hawai'i, Department of Transportation, dated November 15, 2000, as approved by the Environmental Quality Council. Exemption Class #1 covers operations, repairs, or maintenance of existing structures, facilities, equipment, or topographical features involving negligible or no expansion or change of use beyond that previously existing.

BLNR – ISSUANCE OF A REVOCABLE PERMIT FOR A T-HANGAR
FOR STORAGE AND MAINTENANCE OF AIRCRAFT
EAST OAHU PET HOSPITAL, LLC DBA GENTLE VETS HAWAII
Page 3

The DOTA consulted with the U.S. Federal Aviation Administration as to the appropriateness of the citation of the Environmental Exemption Class from the Comprehensive list for the Department of Transportation dated November 15, 2000. The FAA concurred on the appropriateness.

REMARKS:

The issuance of a revocable permit to EOPH, LLC for a T-Hangar for storage and maintenance of aircraft at Daniel K. Inouye International Airport complies with Chapter 343, Exemption Class 1.D.10 as a continuing aeronautical use, and is in accordance with Section 171-55 HRS, relating to Permits.

RECOMMENDATION:

That the Board authorize the Department of Transportation to issue a month-to-month revocable permit to EOPH, LLC, subject to: (1) terms and conditions herein outlined, which are by reference incorporated herein; and (2) such additional terms and conditions as may be prescribed by the Director of Transportation to best serve the interests of the State.

Respectfully submitted,

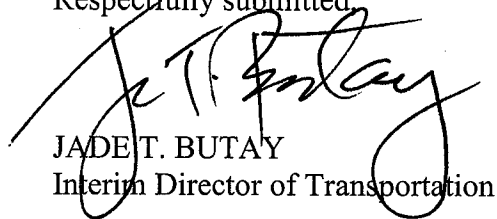
JADE T. BUTAY
Interim Director of Transportation

APPROVED FOR SUBMITTAL:

SUZANNE D. CASE
Chairperson and Member

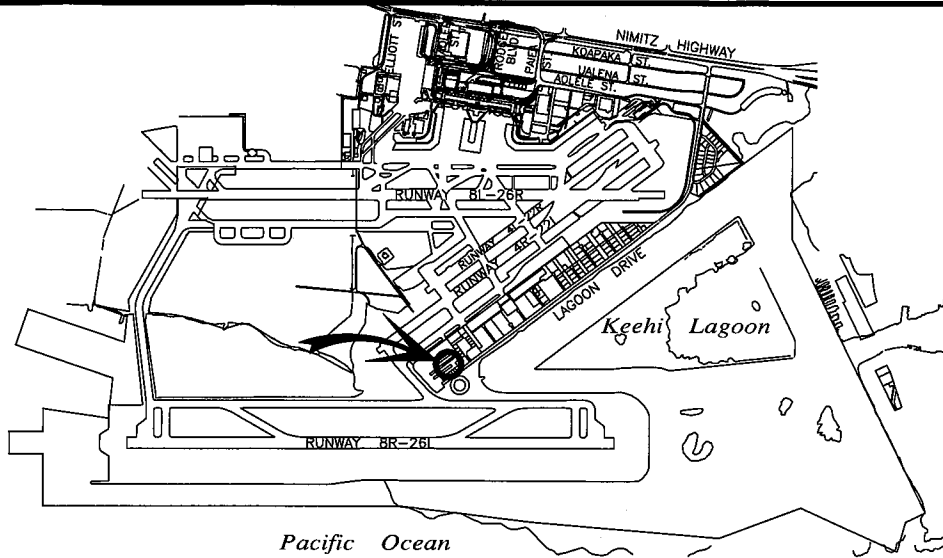

LOCATION PLAN

5000:1

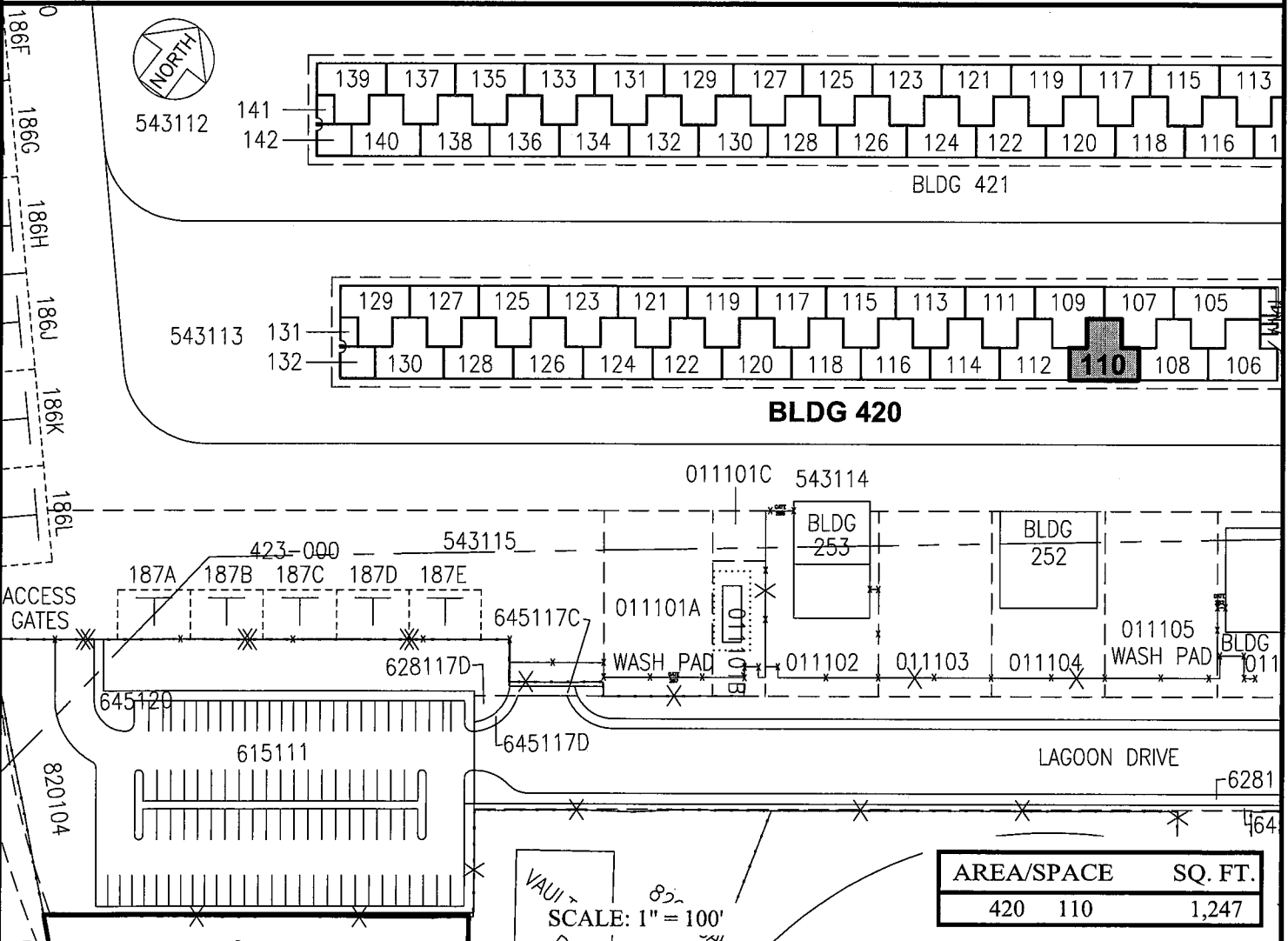

RP-8685

DATE : NOVEMBER 2017

EXHIBIT: **A**



EAST OAHU
PET HOSPITAL, LLC
DBA GENTLE VETS HAWAII

T-HANGAR
GENERAL AVIATION
SOUTH RAMP

420110
PLAT 45