

DAVID Y. IGE
GOVERNOR

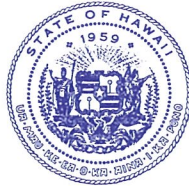

STATE OF HAWAII
DEPARTMENT OF TRANSPORTATION
869 PUNCHBOWL STREET
HONOLULU, HAWAII 96813-5097

FORD N. FUCHIGAMI
DIRECTOR

Deputy Directors
JADE T. BUTAY
ROSS M. HIGASHI
EDWIN H. SNIFFEN
DARRELL T. YOUNG

IN REPLY REFER TO:

Board of Land and
Natural Resources
State of Hawai'i
Honolulu, Hawai'i

ISSUANCE OF A REVOCABLE PERMIT FOR AIRCRAFT PARKING
DILLON R. ORIAN
ELLISON ONIZUKA KONA INTERNATIONAL AIRPORT AT KEĀHOLE HAWAI'I
TAX MAP KEY: (3) 7-3-43: PORTION OF 40

REQUEST:

Issuance of a revocable permit for aircraft parking (parking permit) to Dillon R. Orian.

LEGAL REFERENCE:

Sections 171-55, Hawai'i Revised Statutes.

APPLICANT:

Dillon R. Orian, whose business address is 23458 W Moon Shadow Dr., Malibu,
California 90265.

LOCATION AND TAX MAP KEY:

Portion of Ellison Onizuka Kona International Airport at Keāhole (KOA), Kailua-Kona,
Island of Hawai'i, identified by Tax Map Key: 3rd division, 7-3-43: Portion of 40.

AREA:

Area/Space Nos. 407-117, containing an area of 990 square feet, as shown and delineated
on the attached Exhibit A.

ZONING:

State Land Use District:
County of Hawai'i:

Urban & Conservation
Industrial (MG-1a) and Open

ITEM M-15

BLNR – ISSUANCE OF A REVOCABLE PERMIT FOR AIRCRAFT PARKING
DILLON R. ORIAN, ELLISON ONIZUKA KONA INTERNATIONAL AIRPORT AT
KEĀHOLE

Page 2

LAND TITLE STATUS:

Section 5(a) lands of the Hawai'i Admission Act: Ceded
DHHL 30% entitlement lands pursuant to Hawai'i Admission Act YES ___ NO X

CURRENT USE STATUS:

Airport and aeronautical purposes.

CHARACTER OF USE:

Aircraft parking for tie-down.

COMMENCEMENT DATE:

July 1, 2017

MONTHLY RENTAL:

\$ 96.00 (as determined from the DOTA schedule of rates and charges established by appraisal of Airports property statewide).

SECURITY DEPOSIT:

\$ 288.00 (three times the monthly rental).

DCCA VERIFICATION:

N/A

REMARKS:

The issuance of a parking permit for an aircraft tie-down to Dillon R. Orian, at KOA complies with Chapter 343, Exemption Class 1.D.10. as continuing aeronautical use, and is in accordance with Section 171-55 HRS, relating to Permits.

The DOTA consulted with the U.S. Federal Aviation Administration as to the appropriateness of the citation of the Environmental Exemption Class from the Comprehensive list for the Department of Transportation dated November 15, 2000. In this case, the FAA concurred on the appropriateness.

BLNR – ISSUANCE OF A REVOCABLE PERMIT FOR AIRCRAFT PARKING
DILLON R. ORIAN, ELLISON ONIZUKA KONA INTERNATIONAL AIRPORT AT
KEĀHOLE

Page 3

RECOMMENDATION:

That the Board authorize the Department of Transportation to issue a month-to-month parking permit to Dillon R. Orian, subject to: (1) terms and conditions herein outlined, which are by reference incorporated herein; and (2) such additional terms and conditions as may be prescribed by the Director of Transportation to best serve the interests of the State.

Respectfully submitted,

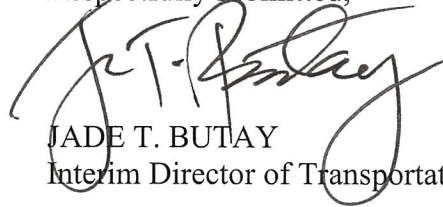
A handwritten signature in black ink, appearing to read "Jade T. Butay", written over a horizontal line.

JADE T. BUTAY
Interim Director of Transportation

APPROVED FOR SUBMITTAL:

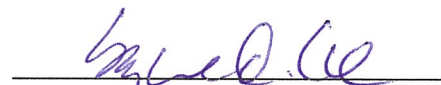
A handwritten signature in blue ink, appearing to read "Suzanne D. Case", written over a horizontal line.

SUZANNE D. CASE
Chairperson and Member

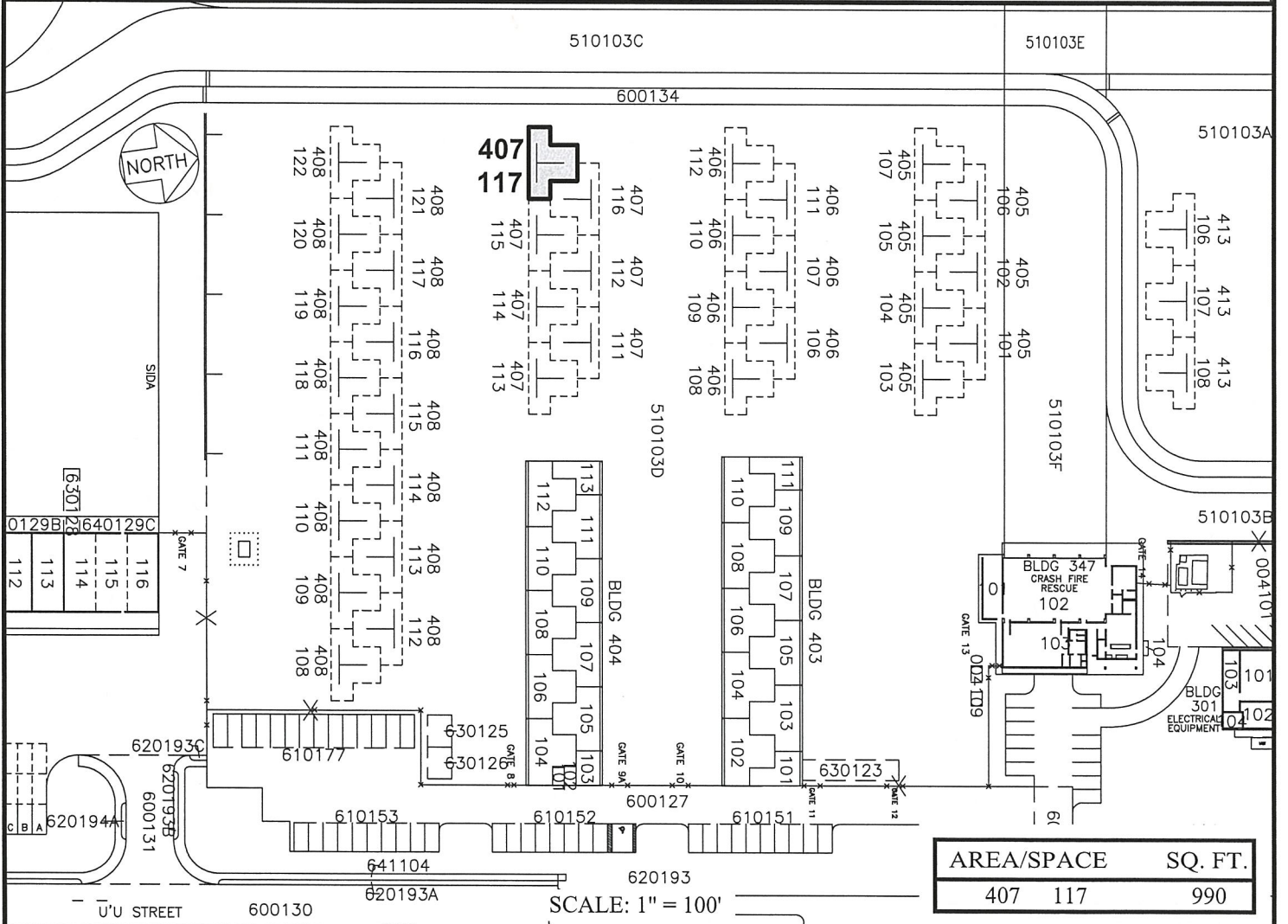
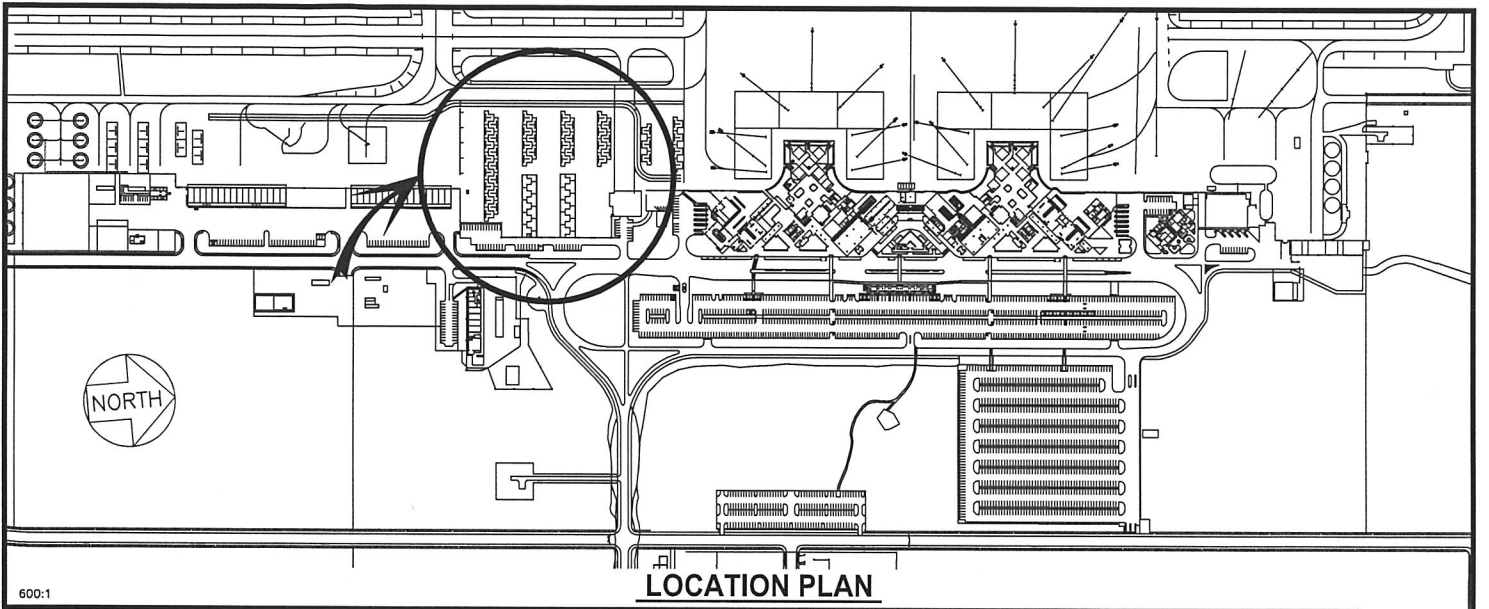

PP-17-N003

DATE : JUNE 2017

EXHIBIT: **A**



Airports Division

DILLON R. ORIAN

TIE-DOWN

407117

PLATS D1, 39

ELLISON ONIZUKA KONA INTERNATIONAL AIRPORT AT KEAHOLE

N:\AIRPORTS\KOA_Kona\CAD\PM\koa_407117-03.dwg