

**STATE OF HAWAII**  
**DEPARTMENT OF TRANSPORTATION**  
869 PUNCHBOWL STREET  
HONOLULU, HAWAII 96813-5097

JADE T. BUTAY  
INTERIM DIRECTOR

Deputy Directors  
ROSS M. HIGASHI  
EDWIN H. SNIFFEN  
DARRELL T. YOUNG

IN REPLY REFER TO:

Board of Land and  
Natural Resources  
State of Hawai'i  
Honolulu, Hawai'i

ISSUANCE OF A REVOCABLE PERMIT FOR THE PURPOSE OF OPERATING A  
CARGO TRUCK TURN AROUND AREA  
TO HAWAIIAN AIRLINES, INC.  
DANIEL K. INOUE INTERNATIONAL AIRPORT  
TAX MAP KEY: (1) 1-1-003: 001 (PORTION)

O'AHU

APPLICANT:

HAWAIIAN AIRLINES, INC (HAL) whose business address is 3375 Koapaka Street, Suite  
G350, Honolulu, Hawai'i 96820-0008.

LEGAL REFERENCE:

Section 171-55 (b), Hawai'i Revised Statutes (HRS).

LOCATION:

Portion of the Daniel K. Inouye International Airport (Airport), Honolulu, Island of O'ahu,  
Identified by Tax Map Key: 1<sup>st</sup> Division, 1-1-003: 001 (Portion).

AREA:

Area/Space No. 004-111, containing a land area of approximately 12,480 square feet, as  
shown and delineated on the attached map labeled Exhibit "A".

ZONING:

State Land Use District:	Urban
City and County of Honolulu:	Industrial (I-2)

LAND TITLE STATUS:

Non-Ceded – Section 5(a) lands of the Hawai'i Admission Act  
DHHL 30% entitlement lands pursuant to the Hawai'i State Constitution: YES \_\_\_ NO X

BLNR – ISSUANCE OF A REVOCABLE PERMIT TO HAWAIIAN AIRLINES, INC.  
FOR A CARGO TRUCK TURN AROUND AREA

Page 2

CURRENT USE:

Land presently encumbered by Governor's Executive Order No. 3529, setting aside a portion of the Airport under the control and management of the State of Hawai'i, Department of Transportation, Airports Division, (Airports Division) for Airport Purposes.

CHARACTER OF USE:

Maintenance and operation of a cargo truck turn around area, in connection with HAL's new Cargo and Maintenance Hangar Facility at the Airport.

COMMENCEMENT DATE:

Upon execution of the revocable permit.

MONTHLY RENTAL:

\$6,448.00 (based upon a rate of \$6.20 per square foot, per annum for improved/paved land at the Airport, as determined from the Airports Division Schedule of Rates and Charges established for Airport properties statewide).

SECURITY DEPOSIT:

Sum equal to three (3) months rental then in effect.

DCCA VERIFICATION:

Place of business registration confirmed:	YES <u>X</u>	NO <u>    </u>
Registered business name confirmed:	YES <u>X</u>	NO <u>    </u>
Good standing confirmed:	YES <u>X</u>	NO <u>    </u>

CHAPTER 343, HRS - ENVIRONMENTAL ASSESSMENT:

Pursuant to Section 11-200-8(a), Environmental Impact Statement Rules of the Department of Health, State of Hawai'i, this disposition is exempt from requirements regarding preparation of an environmental assessment, negative declaration, or environmental impact statement as required by Chapter 343, Hawai'i Revised Statutes, as amended, relating to Environmental Impact Statements, because the proposed action falls within Exemption Class #1, Comprehensive Exemption List for the State of Hawai'i, Department of Transportation (DOT) dated December 15, 2000, as approved by the Environmental Quality Council. Exemption Class #1 covers operations, repairs, or maintenance of existing structures, facilities, equipment, or topographical features involving negligible or no expansion or change of use beyond that previously existing.

BLNR – ISSUANCE OF A REVOCABLE PERMIT TO HAWAIIAN AIRLINES, INC.  
FOR A CARGO TRUCK TURN AROUND AREA  
Page 3

Airports Division consulted with the U.S. Federal Aviation Administration (FAA) as to the appropriateness of the citation of the Environmental Exemption Class from the comprehensive list for the DOT, dated November 15, 2000. The FAA concurred on the appropriateness.

REMARKS:

In accordance with Section 171-55, HRS, relating generally to Permits, the DOT proposes to issue a month-to-month revocable permit to HAL for the purpose of maintaining and operating a cargo truck turn around area, in connection with HAL's new Cargo and Maintenance Hangar Facility at the Airport. The DOT has no objections to HAL's request.

RECOMMENDATION:

That the Board authorize the DOT to issue a month-to-month revocable permit to HAL, subject to: (1) terms and conditions herein outlined, which are by reference incorporated herein; (2) such additional terms and conditions as may be prescribed by the Director of Transportation to best serve the interests of the State.

Respectfully submitted,

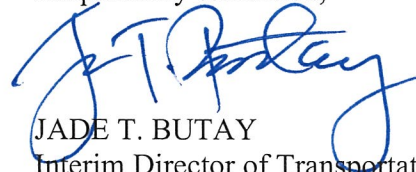

JADE T. BUTAY  
Interim Director of Transportation

APPROVED FOR SUBMITTAL:

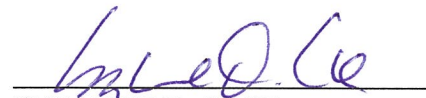

SUZANNE D. CASE  
Chairperson and Member



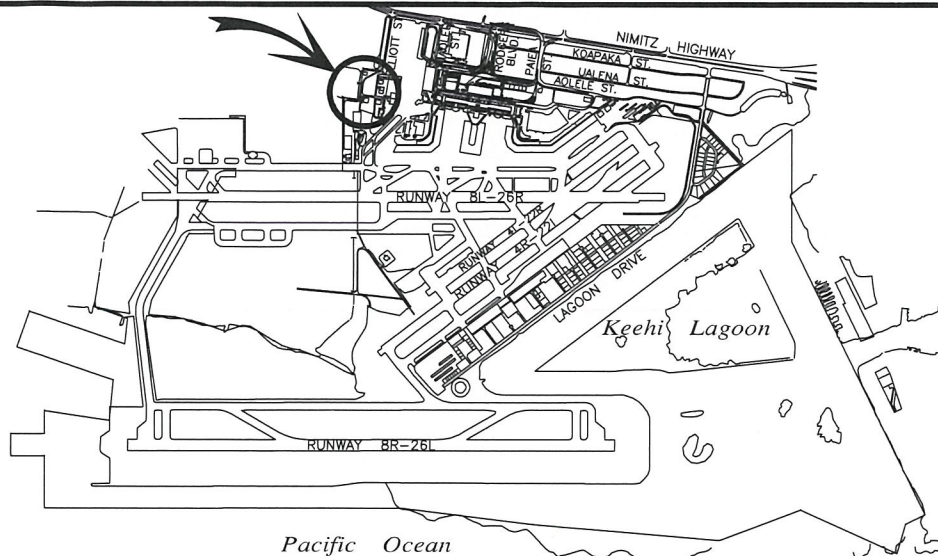

# **LOCATION PLAN**

5000:1

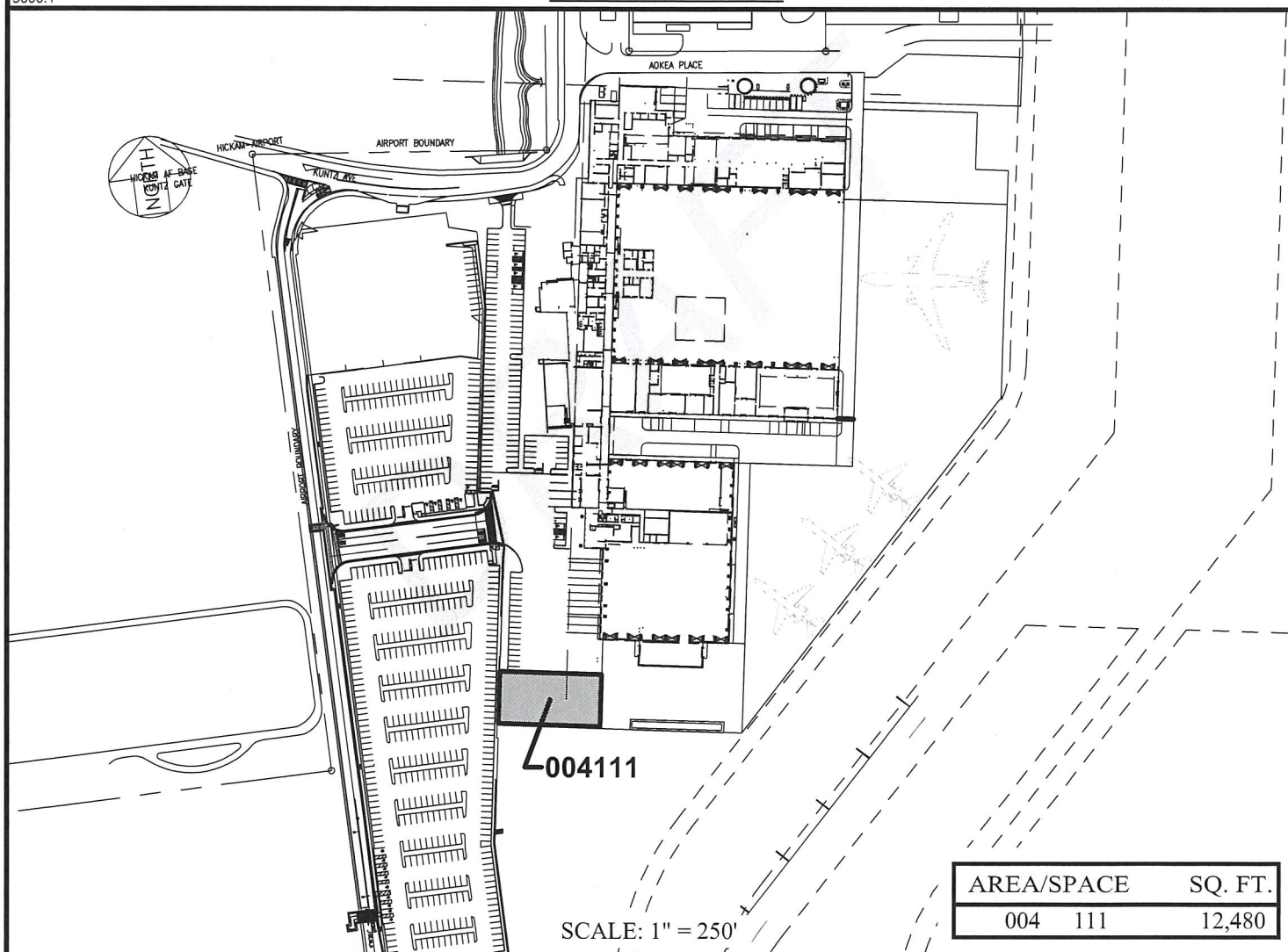

AREA/SPACE	SQ. FT.
004 111	12,480

SCALE: 1" = 250'

DRAFT

DATE : OCTOBER 2017

EXHIBIT: **A**



Airports Division

HAWAIIAN AIRLINES, INC.

INTER-ISLAND  
MAINTENANCE AREA  
GROUND LEVEL

004111

PLAT 24

**HONOLULU INTERNATIONAL AIRPORT**

N:\AIRPORTS\HNL\_HONOLULU\CAD\PM\\_DRAFT\HNL\_004111-01\_DRAFT.DWG