



STATE OF HAWAII
DEPARTMENT OF TRANSPORTATION
869 PUNCHBOWL STREET
HONOLULU, HAWAII 96813-5097

JADE T. BUTAY
INTERIM DIRECTOR

Deputy Directors
ROY CATALANI
ROSS M. HIGASHI
EDWIN H. SNIFFEN
DARRELL T. YOUNG

IN REPLY REFER TO:

Board of Land and
Natural Resources
State of Hawai'i
Honolulu, Hawai'i

ISSUANCE OF A REVOCABLE PERMIT FOR TRAILER PARKING
NEW CINGULAR WIRELESS PCS, LLC
KAHULUI AIRPORT
TAX MAP KEY: (2) 3-8-01: PORTION OF 19

MAUI

REQUEST:

Issuance of a revocable permit for trailer parking (parking permit) to NEW CINGULAR WIRELESS PCS, LLC ("NCW").

LEGAL REFERENCE:

Sections 171-55, Hawai'i Revised Statutes.

APPLICANT:

NCW, whose business address is 19801 SW 72nd Avenue, Suite 200, Tualatin, Oregon 97062.

LOCATION AND TAX MAP KEY:

Portion of Kahului Airport (OGG), Kahului, Island of Maui, identified by Tax Map Key: 2nd Division, 3-8-01: Portion of 19.

AREAS:

Area/Space No. 610-113X, containing an area of approximately 450 square feet of improved, unpaved land as shown on the attached Exhibit A.

BLNR – ISSUANCE OF A REVOCABLE PERMIT FOR TRAILER PARKING
NEW CINGULAR WIRELESS PCS, LLC, KAHULUI AIRPORT
Page 2

ZONING:

State Land Use District: Urban
County of Maui: Airport

LAND TITLE STATUS:

Section 5(a) lands of the Hawai‘i Admission Act: Non-Ceded
DHHL 30% entitlement lands pursuant to Hawai‘i Admission Act YES ___ NO X

CURRENT USE STATUS:

Airport purposes

CHARACTER OF USE:

Land area to park a trailer for storage of cellular parts.

COMMENCEMENT DATE:

To be determined by the Deputy Director of Transportation, Airports Division

MONTHLY RENTAL:

\$ 147.00 (as determined from the DOTA schedule of rates and charges established by appraisal of Airports property statewide)

SECURITY DEPOSIT:

\$ 441.00, or three times the monthly rental in effect

DCCA VERIFICATION:

Place of business registration confirmed: YES
Registered business name confirmed: YES
Good standing confirmed: YES

CHAPTER 343, HRS - ENVIRONMENTAL ASSESSMENT:

Pursuant to Section 11-200-8(a), Environmental Impact Statement Rules of the Department of Health, State of Hawaii, this disposition is exempt from requirements regarding preparation of an environmental assessment, negative declaration, or

BLNR – ISSUANCE OF A REVOCABLE PERMIT FOR TRAILER PARKING
NEW CINGULAR WIRELESS PCS, LLC, KAHULUI AIRPORT

Page 3

environmental impact statement as required by Chapter 343, Hawaii Revised Statutes, as amended, relating to Environmental Impact Statements, because the proposed action falls within Exemption Class #1, Comprehensive Exemption List for the State of Hawaii, Department of Transportation, dated November 15, 2000, as approved by the Environmental Quality Council. Exemption Class #1 covers operations, repairs, or maintenance of existing structures, facilities, equipment, or topographical features involving negligible or no expansion or change of use beyond that previously existing.

The DOTA consulted with the U.S. Federal Aviation Administration as to the appropriateness of the citation of the Environmental Exemption Class from the Comprehensive list for the Department of Transportation dated November 15, 2000. In this case, the FAA concurred on the appropriateness.

REMARKS:

The DOT has no objections to NCW's request and therefore, in accordance with Sections 171-11 and 171-55, HRS, relating to Public Purposes and Permits, respectively, and therefore, the DOT proposes to issue a month-to-month revocable permit to NCW for its trailer parking for storage of parts for its cellular system at OGG.

RECOMMENDATION:

That the Board authorize the Department of Transportation to issue a month-to-month parking permit to NCW, subject to: (1) terms and conditions herein outlined, which are by reference incorporated herein; and (2) such additional terms and conditions as may be prescribed by the Director of Transportation to best serve the interests of the State.

Respectfully submitted,

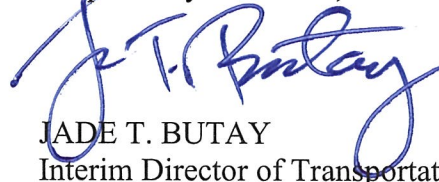

JADE T. BUTAY
Interim Director of Transportation

APPROVED FOR SUBMITTAL:

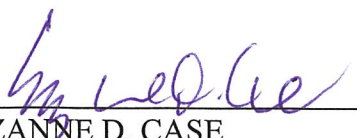

SUZANNE D. CASE
Chairperson and Member

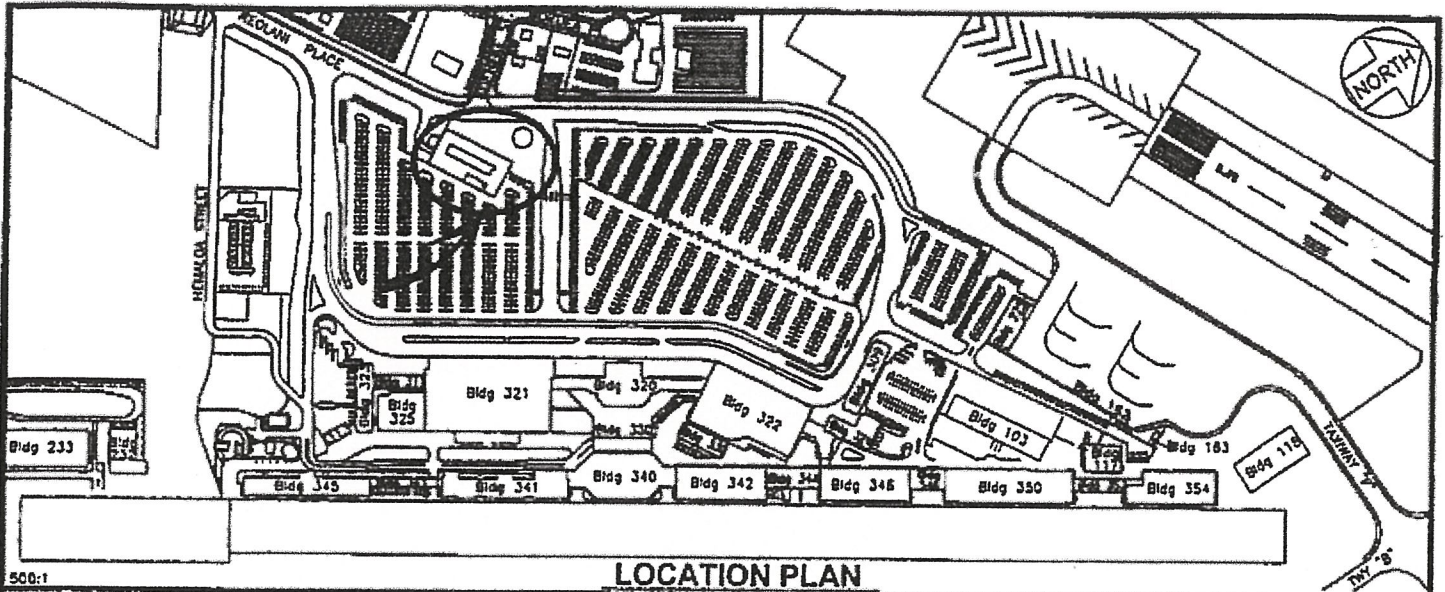

LOCATION PLAN

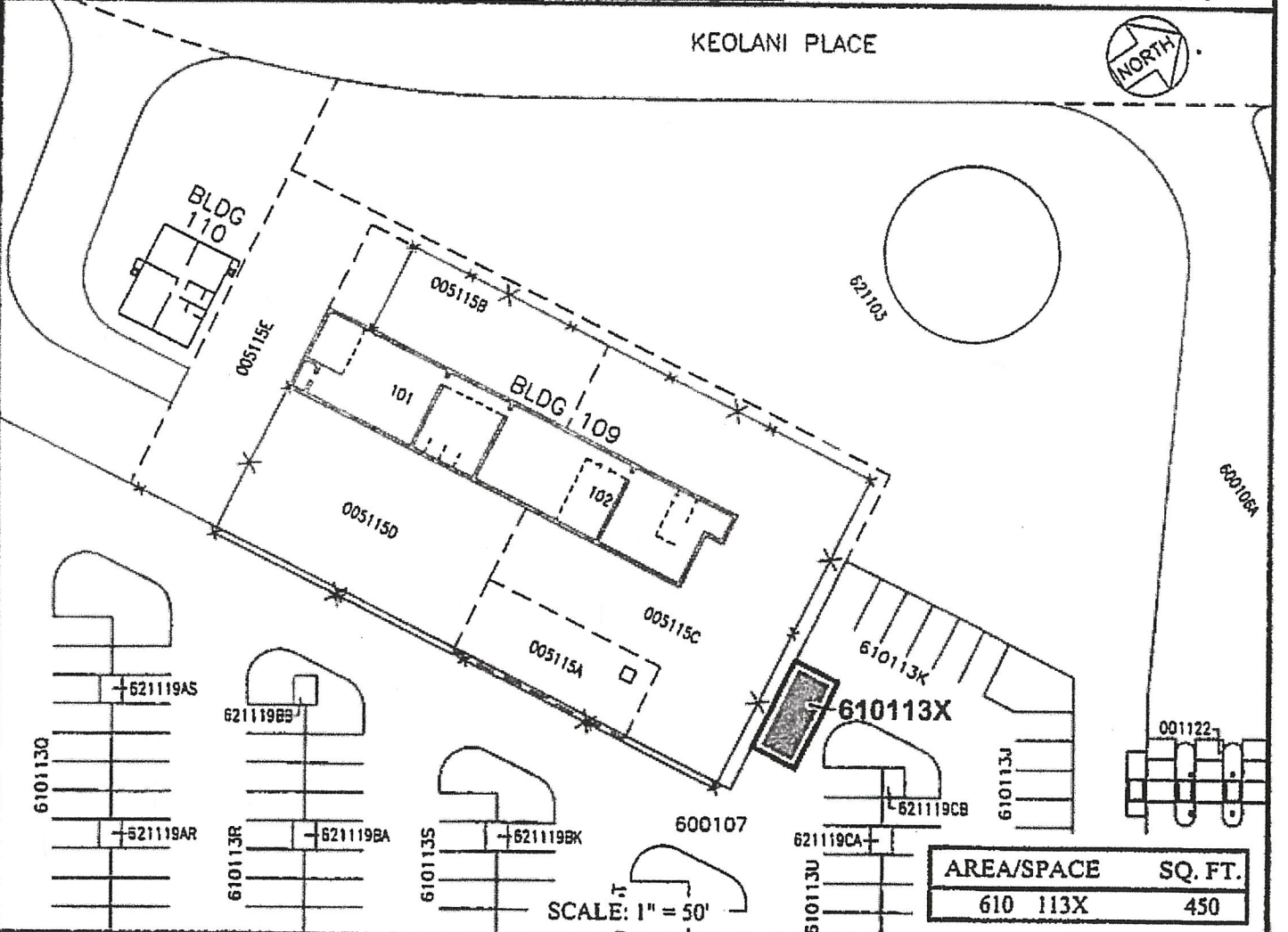

AREA/SPACE	SQ. FT.
610 113X	450

SCALE: 1" = 50'

DRAFT

DATE : OCTOBER 2017

EXHIBIT: A



Airports Division

NEW CINGULAR WIRELESS PCS LLC

AT&T

PARKING STALLS &
VEHICULAR ZONES
GROUND LEVEL

610113X

PLATS DI, 35

KAHULUI AIRPORT

N:\AIRPORTS\OGG_Kahului\CAD\PM\ogg_610113X-01_draft.dwg