

**STATE OF HAWAII**  
**DEPARTMENT OF TRANSPORTATION**  
869 PUNCHBOWL STREET  
HONOLULU, HAWAII 96813-5097

IN REPLY REFER TO:

Board of Land and Natural Resources  
State of Hawaii  
Honolulu, Hawaii

OAHU

ISSUANCE OF A REVOCABLE PERMIT TO HAWAII MEN'S SHED  
ASSOCIATION AT WAREHOUSE 6, AT PIER 20, HONOLULU  
HARBOR, HAWAII

**LEGAL REFERENCE:**

Sections 171- 11 and 55, Hawaii Revised Statutes.

**APPLICANT:**

Hawaii Men's Shed Association  
2311 Apoepoe Street  
Pearl City, Hawaii 96782

**CHARACTER OF USE:**

Public service projects to improve the health and wellbeing of older men who may suffer from mental, physical and emotional deterioration or issues related to aging, retirement, separation, and singleness.

**LOCATION:**

Portion of government lands, situated at Pier 20, Honolulu Harbor, Hawaii, TMK: 1st/1-5-39:026 (Portion), as shown on the attached Exhibit "A."

**CURRENT USE STATUS:**

Vacant.

The land is encumbered by Governor's Executive Order No. 2903, which sets aside the land to the Harbors Division, Department of Transportation.

**AREA:**

Approximately 64' x 100' = 6,400 square feet

**RENTAL:** Gratis

**SECURITY DEPOSIT:**  
\$00.00

**ZONING:** State Land Use Commission: Urban  
City and County of Honolulu: I-3 (Waterfront Industrial)

**LAND TITLE STATUS:**  
Subsection 5(a) of the Hawaii Admission Act (non-ceded land).

**COMMENCEMENT DATE:**  
To be determined by the Director of Transportation.

**CHAPTER 343 ENVIRONMENTAL ASSESSMENT:**  
The project is exempt from OEQC requirements pursuant to Sub-Chapter 11-200-8 of the Hawaii Administrative Rules, which exempts the “operation, repairs, or maintenance of existing structures, facilities, equipment, or topographical features involving negligible or no expansion or change of use beyond that previously existing.”

**REMARKS:**  
Hawaii Men’s Shed Association repairs bicycles & recycles shipping pallets and does small public service projects for non-profit organizations. In addition to repairing old bicycles, they also recycle building materials and cargo pallets, which helps to reduce impact to the land fill. This organization also serves to give retired men a purpose by helping the community. As a condition of this gratis Revocable Permit Hawaii Men’s Shed Association has agreed to remove the approximately 8” Thick x 30’ Wide x 35’ Long concrete slab from the Ewa end of the Bay, which was left by the previous tenant.

**RECOMMENDATION:**

That the Board authorizes the issuance of a revocable permit to the applicant, subject to the terms and conditions outlined above and incorporated herein by reference and such terms and conditions as may be prescribed by the Director of Transportation.

Respectfully submitted,



JADE T. BUTAY  
Interim Director of Transportation

APPROVED FOR SUBMITTAL:

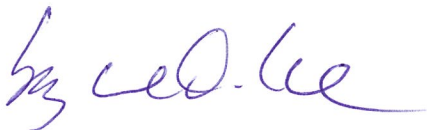

SUZANNE D. CASE  
Chairperson and Member  
Board of Land and Natural Resources

# LOCATION PLAN

SCALE: 1"=200'

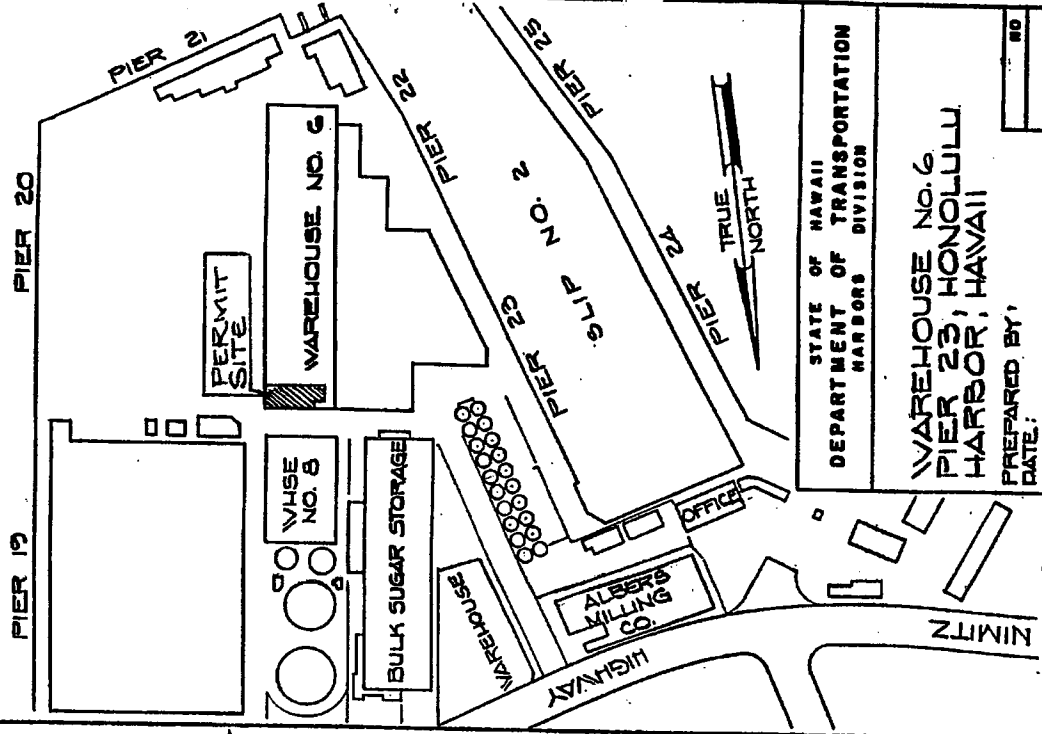

STATE OF HAWAII  
DEPARTMENT OF TRANSPORTATION  
HARBORS DIVISION

WAREHOUSE NO. 6  
PIER 23, HONOLULU  
HARBOR, HAWAII

PREPARED BY: \_\_\_\_\_  
DATE: \_\_\_\_\_

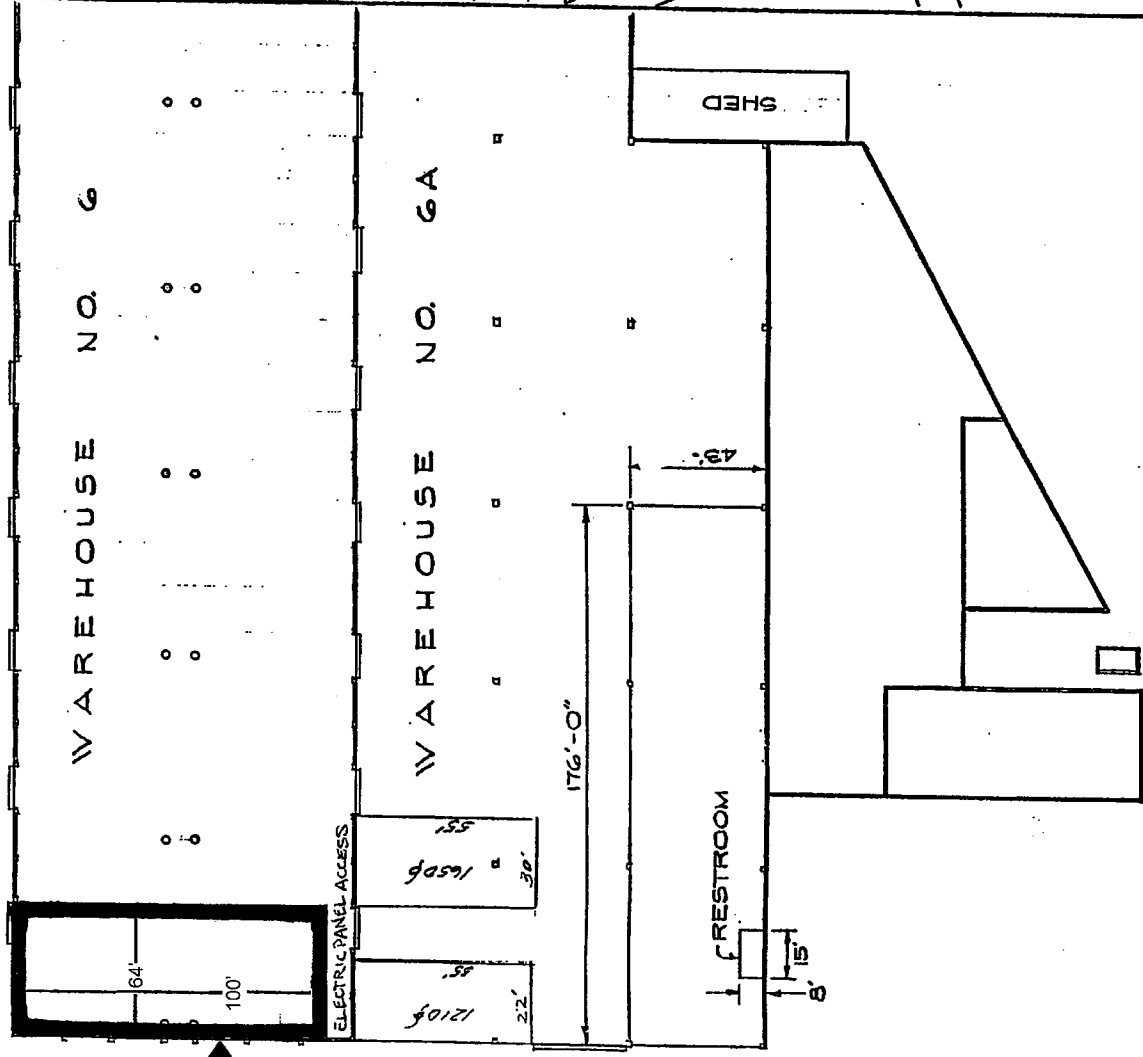

**Subject** ↑

**EXHIBIT "A"**