

STATE OF HAWAII
DEPARTMENT OF TRANSPORTATION
869 PUNCHBOWL STREET
HONOLULU, HAWAII 96813-5097

JADE T. BUTAY
DIRECTOR

Deputy Directors
ROY CATALANI
ROSS M. HIGASHI
EDWIN H. SNIFFEN
DARRELL T. YOUNG

IN REPLY REFER TO:

Board of Land and
Natural Resources
State of Hawai'i
Honolulu, Hawai'i

ISSUANCE OF A REVOCABLE PERMIT FOR SPACE
IN THE MAIN TERMINAL FOR LOCKER ROOMS
HAWAIIAN AIRLINES, INC.
KAHULUI AIRPORT
TAX MAP KEY: (2) 3-8-01: PORTION OF 19

MAUI

LEGAL REFERENCE:

Sections 171-11 and 171-55, Hawai'i Revised Statutes.

APPLICANT:

Hawaiian Airlines, Inc. (HAL), whose business address P. O. Box 30008, Honolulu,
Hawai'i 96820.

LOCATION AND TAX MAP KEY:

Portion of Kahului Airport, Kahului, Island of Maui, identified by
Tax Map Key: 2nd Division, 3-8-01: Portion of 19.

AREAS:

Bldg/Room Nos. 341-105A, -105B, and -106B, containing a total area of approximately
1,392 square feet, shown on the attached Exhibit A.

ZONING:

State Land Use District:	Urban
County of Maui:	Airport

BLNR – ISSUANCE OF A REVOCABLE PERMIT FOR SPACE IN THE MAIN TERMINAL,
FOR LOCKER ROOMS, HAWAIIAN AIRLINES, INC.

Page 2

LAND TITLE STATUS:

Section 5(a) lands of the Hawai'i Admission Act: Non-Ceded
DHHL 30% entitlement lands pursuant to Hawai'i Admission Act YES ___ NO X

CURRENT USE STATUS:

Airport and aeronautical purposes.

CHARACTER OF USE:

Space for locker rooms.

COMMENCEMENT DATE:

Upon complete execution of the revocable permit.

MONTHLY RENTAL:

\$11,514.16

SECURITY DEPOSIT:

\$34,542.48

HOLDOVER TENANCY:

\$383.81

DCCA VERIFICATION:

Place of business registration confirmed:	YES <u>X</u>	NO ___
Registered business name confirmed:	YES <u>X</u>	NO ___
Good standing confirmed:	YES <u>X</u>	NO ___

CHAPTER 343, HRS - ENVIRONMENTAL ASSESSMENT:

Pursuant to Section 11-200-8(a), Environmental Impact Statement Rules of the Department of Health, State of Hawai'i, this disposition is exempt from requirements regarding preparation of an environmental assessment, negative declaration, or environmental impact statement as required by Chapter 343, Hawai'i Revised Statutes, as amended, relating to Environmental Impact Statements, because the proposed action falls within Exemption Class #1, Comprehensive Exemption List for the State of Hawai'i, Department of Transportation, dated November 15, 2000, as approved by the

BLNR – ISSUANCE OF A REVOCABLE PERMIT FOR SPACE IN THE MAIN TERMINAL,
FOR LOCKER ROOMS, HAWAIIAN AIRLINES, INC.

Page 3

Environmental Quality Council. Exemption Class #1 covers operations, repairs, or maintenance of existing structures, facilities, equipment, or topographical features involving negligible or no expansion or change of use beyond that previously existing.

The DOTA consulted with the U.S. Federal Aviation Administration as to the appropriateness of the citation of the Environmental Exemption Class from the Comprehensive list for the Department of Transportation dated November 15, 2000. In this case, the FAA concurred on the appropriateness.

REMARKS:

The Department of Transportation (DOT) has no objections to HAL's request and therefore, in accordance with Sections 171-11 and 171-55, HRS, relating to Public Purposes and Permits, respectively and therefore, the DOT proposes to issue a month-to-month revocable permit to HAL for Bldg/Room Nos. 341-105A, -105B, and -106B, for space in the Main Terminal for its locker rooms.

RECOMMENDATION:

That the Board authorize the Department of Transportation to issue a month-to-month revocable permit to HAL, subject to: (1) terms and conditions herein outlined, which are by reference incorporated herein; and (2) such additional terms and conditions as may be prescribed by the Director of Transportation to best serve the interests of the State.

Respectfully submitted,



JADE T. BUTAY
Director of Transportation

APPROVED FOR SUBMITTAL:

SUZANNE D. CASE
Chairperson and Member

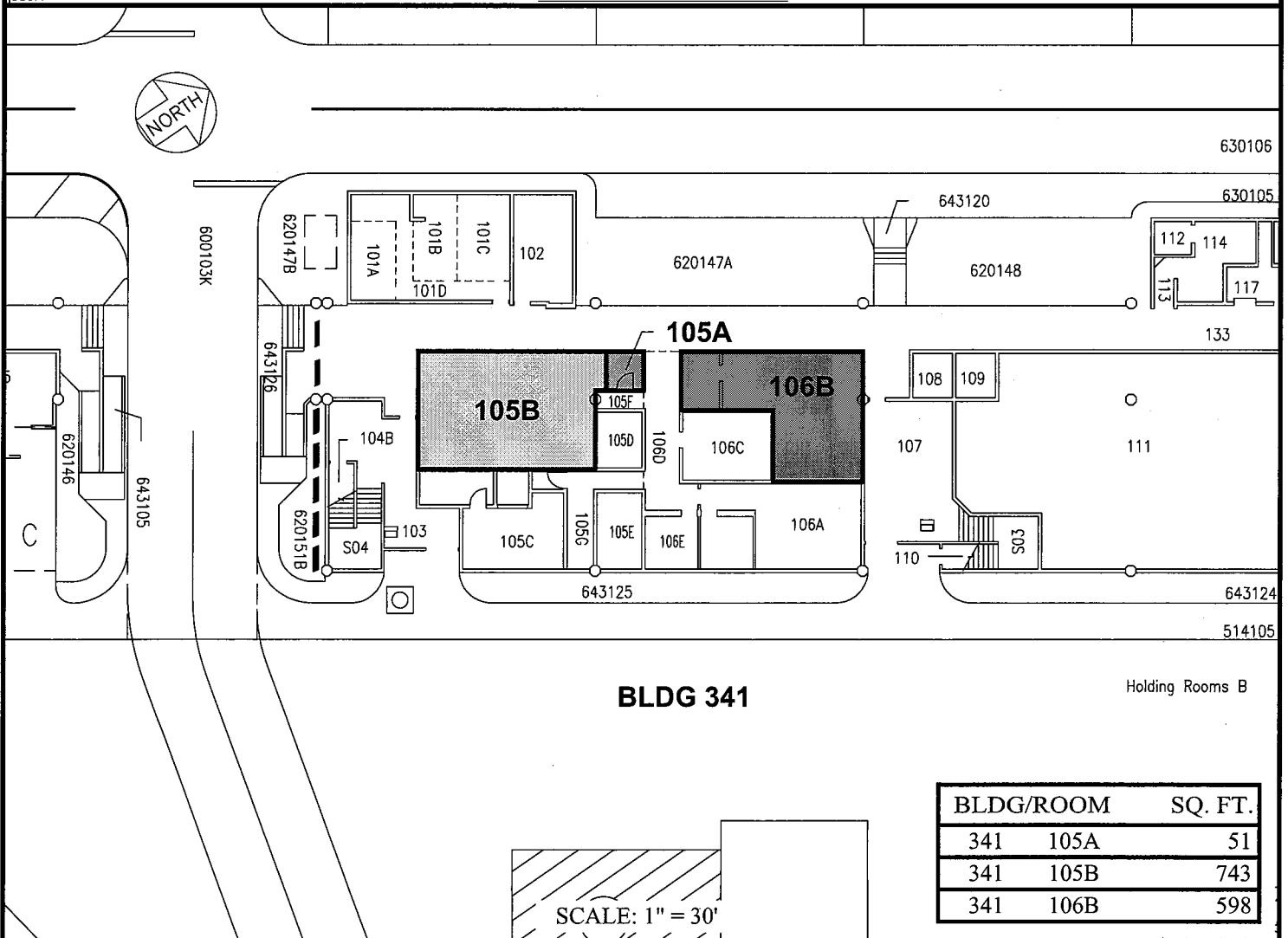
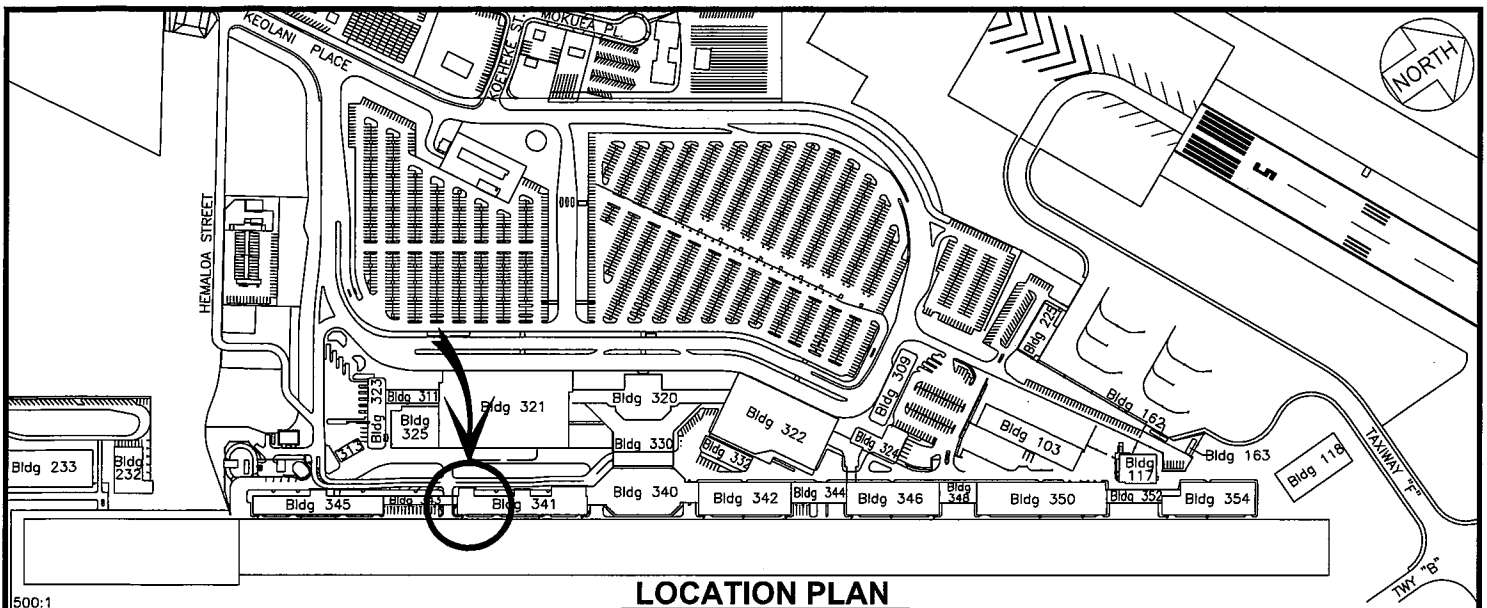

RP-8712

DATE : MARCH 2018

EXHIBIT: **A**



Airports Division

HAWAIIAN AIRLINES INC -
SWFC-POST

BUILDING 341
HOLDING ROOMS B
GROUND LEVEL

341105 A, B
341106B

PLATS 35, H1

KAHULUI AIRPORT

N:\AIRPORTS\OGG_Kahului\CAD\PM\ogg_341105A-01.dwg