

DAVID Y. IGE
GOVERNOR



STATE OF HAWAII
DEPARTMENT OF TRANSPORTATION
869 PUNCHBOWL STREET
HONOLULU, HAWAII 96813-5097

JADE T. BUTAY
DIRECTOR

Deputy Directors
ROY CATALANI
ROSS M. HIGASHI
EDWIN H. SNIFFEN
DARREL T. YOUNG

IN REPLY REFER TO:

Board of Land and
Natural Resources
State of Hawai'i
Honolulu, Hawai'i

ISSUANCE OF A REVOCABLE PERMIT FOR TWO SPACES FOR RETAIL SALES
DFS GROUP L.P.
DANIEL K. INOUE INTERNATIONAL AIRPORT
TAX MAP KEY: (1) 1-1-03: 1 (PORTION)

O'AHU

LEGAL REFERENCE:

Chapter 171-55, Hawai'i Revised Statutes.

APPLICANT:

DFS GROUP L.P., whose postal address is P.O. Box 29500, Honolulu, Hawai'i 96820.

LOCATION AND TAX MAP KEY:

Daniel K. Inouye International Airport, Island of O'ahu, Hawai'i, Terminal Complex
Tax Map Key: 1st Division: 1-1-03: 1(Portion).

AREA:

Area/Space Nos. 341-235, containing a total area of approximately 75 square feet, and
Area/Space Nos. 342-285, containing a total area of approximately 150 square feet, as
delineated on the attached Exhibits A and B dated June 2018.

ZONING:

State Land Use District:	Urban
City and County of Honolulu:	Industrial (I-2)

LAND TITLE STATUS:

Section 5(a) lands of the Hawai'i Admissions Act: Non-Ceded
DHHL 30% entitlement lands pursuant to the Hawai'i State Constitution: No

ITEM M-3

BLNR – ISSUANCE OF A REVOCABLE PERMIT FOR TWO SPACES FOR RETAIL
SALES TO DFS GROUP L.P.

Page 2

CURRENT USE STATUS:

Land presently encumbered by Governor's Executive Order No. 3201, dated June 8, 1983, setting aside 3,152,177 acres designated as Daniel K. Inouye International Airport under the control and management of the State of Hawai'i, Department of Transportation Airports Division (DOTA) for Airports purposes.

CHARACTER OF USE:

Retail sales for retail concession.

COMMENCEMENT DATE:

Upon execution of the revocable permit.

MONTHLY RENTAL:

\$ 2,137.50 (as determined from the DOTA schedule of rates and charges established by appraisal of Airports properties statewide).

All revenue generated from the additional spaces shall be reported as Gross Receipts under the Concession Agreement No. DOT-A-09-0002.

SECURITY DEPOSIT:

\$ 6,412.50 or three times the monthly rental in effect.

HOLDOVER TENANCY:

\$ 71.25

DCCA VERIFICATION:

Place of business registration confirmed:	YES <u>X</u>	NO <u> </u>
Registered business name confirmed:	YES <u>X</u>	NO <u> </u>
Good standing confirmed:	YES <u>X</u>	NO <u> </u>

CHAPTER 343, HRS - ENVIRONMENTAL ASSESSMENT:

Pursuant to Section 11-200-8(a), Environmental Impact Statement Rules of the Department of Health, State of Hawai'i, this disposition is exempt from requirements regarding preparation of an environmental assessment, negative declaration, or environmental impact statement as required by Chapter 343, Hawai'i Revised Statutes, as

BLNR – ISSUANCE OF A REVOCABLE PERMIT FOR TWO SPACES FOR RETAIL
SALES TO DFS GROUP L.P.

Page 3

amended, relating to Environmental Impact Statements because the proposed action falls within Exemption Class #1, Comprehensive Exemption List for the State of Hawai'i, Department of Transportation, amended November 15, 2000, as approved by the Environmental Quality Council. Exemption Class #1 covers operations, repairs, or maintenance of existing structures, facilities, equipment, or topographical features involving negligible or no expansion or change of use beyond that previously existing. The DOTA consulted with the U.S. Federal Aviation Administration as to the appropriateness of the citation of the Environmental Exemption Class from the Comprehensive list for the Department of Transportation dated November 15, 2000. In this case, the FAA concurred on the appropriateness.

REMARKS:

In accordance with Section 171-55, HRS, relating to Permits, the Department of Transportation proposes to issue a month-to-month Revocable Permit to DFS GROUP L.P., who has been successfully operating the retail concession at Daniel K. Inouye International Airport.

RECOMMENDATION:

That the Board authorizes the Department of Transportation to issue a month-to month revocable permit to DFS GROUP L.P., subject to: 1) terms and conditions herein outlined, which are by reference incorporated herein, and 2) such other terms and conditions as may be prescribed by the Director of Transportation to best serve the interests of the State.

Respectfully submitted,

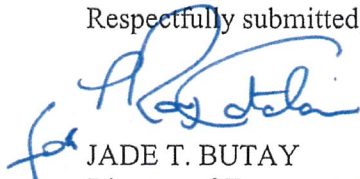
JADE T. BUTAY
Director of Transportation

APPROVED FOR SUBMITTAL:

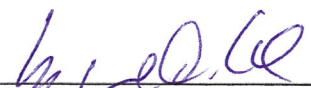
SUZANNE D. CASE
Chairperson and Member

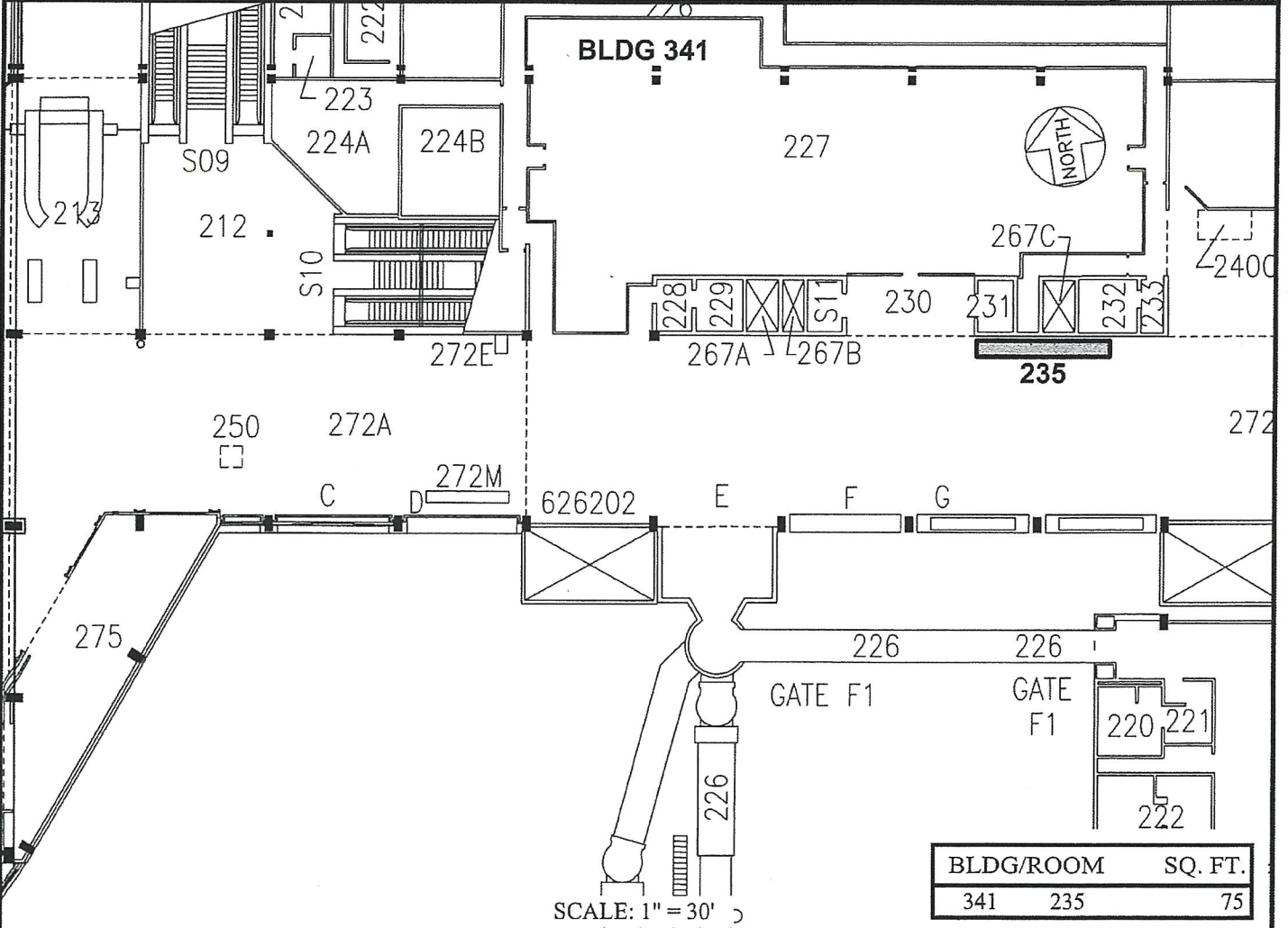
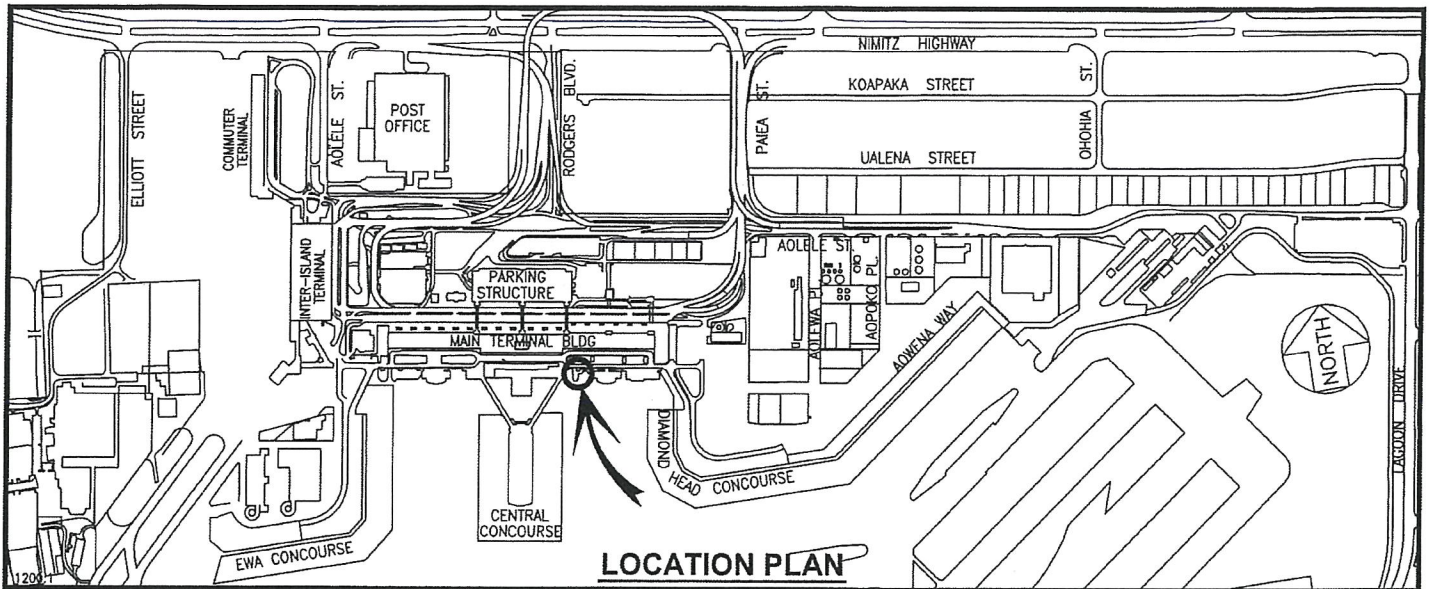

RP-8735

DATE : JUNE 2018

EXHIBIT: A



Airports Division

DFS GROUP, LP.

BUILDING 341
D.H. DOMESTIC EXTN.
SECOND LEVEL

341235

PLAT A2

DANIEL K. INOUE INTERNATIONAL AIRPORT

N:\AIRPORTS\HNL\HONOLULU\CAD\PM\DRAWING\HNL_341235-01_DRAFT.DWG

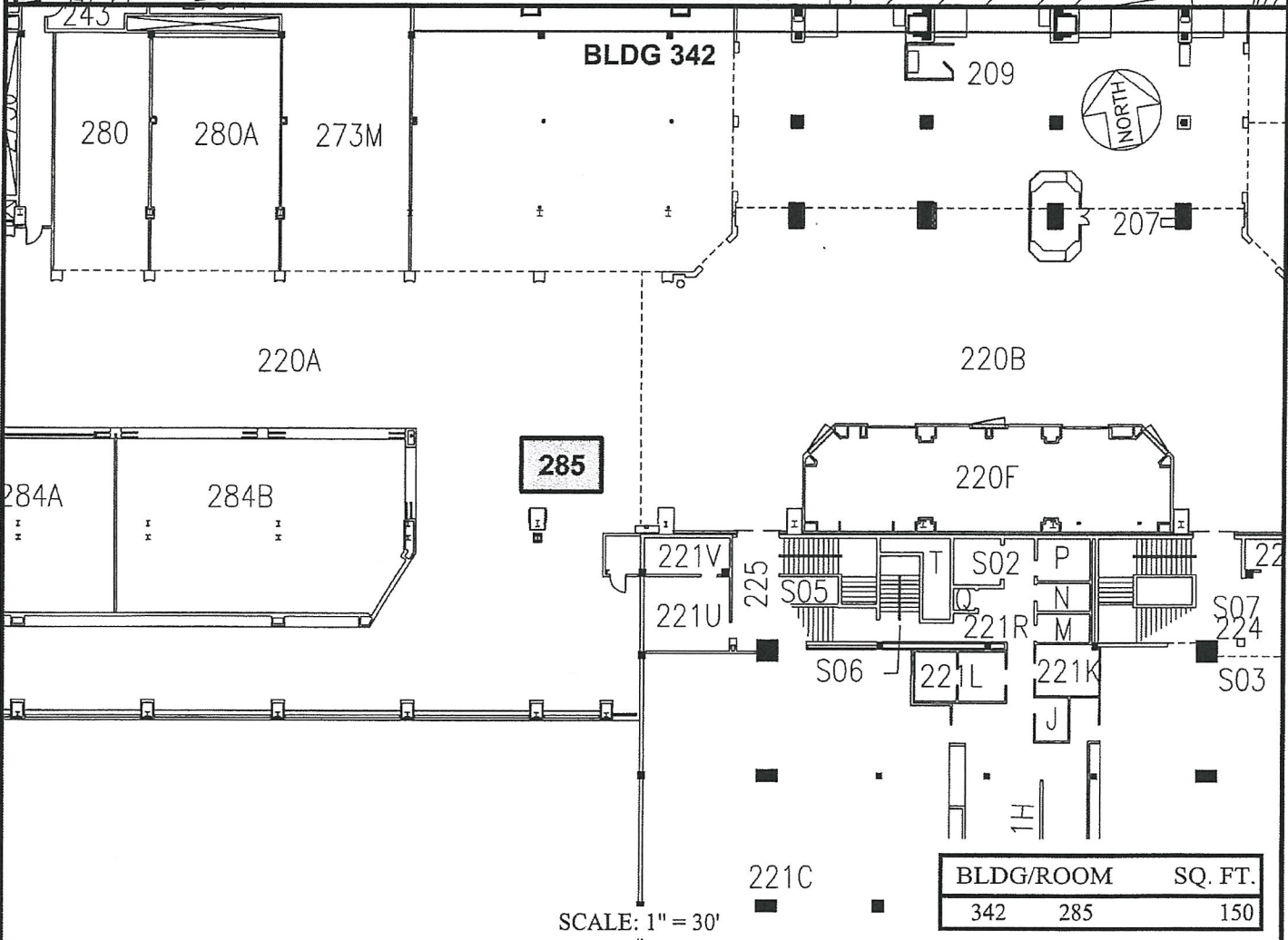
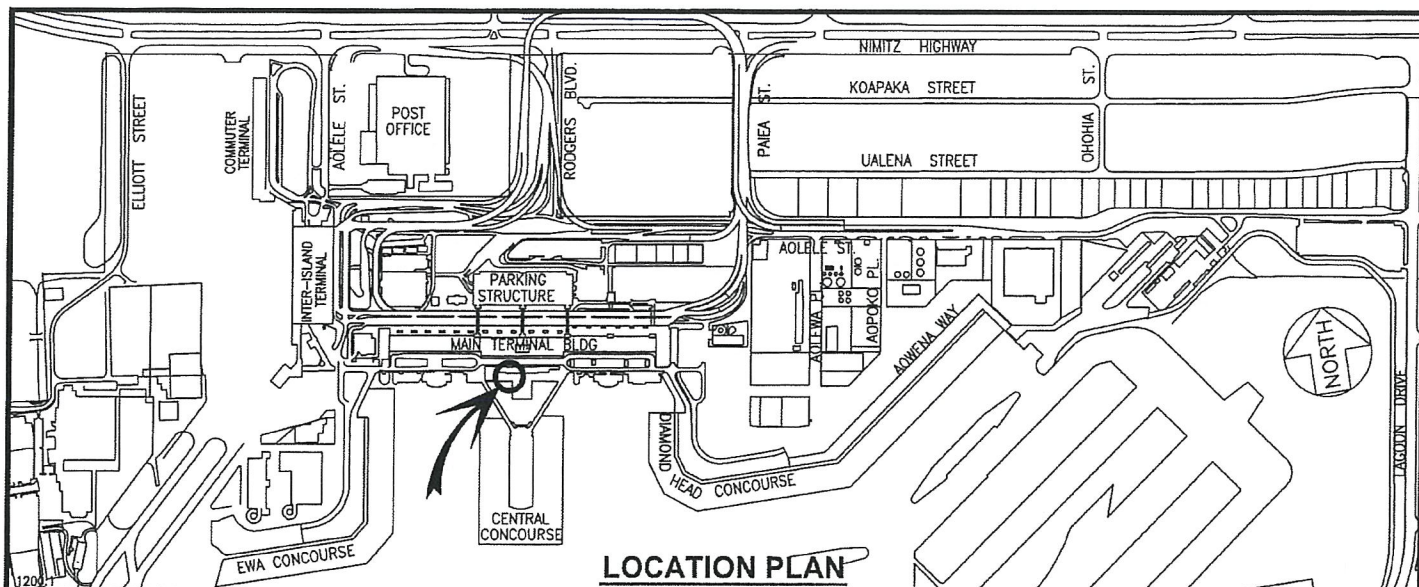

RP-8735

DATE : JUNE 2018

EXHIBIT: B



Airports Division

DFS GROUP, LP.

BUILDING 342
WAITING LOBBY
SECOND LEVEL

342285

PLAT A2

DANIEL K. INOUE INTERNATIONAL AIRPORT

N:\AIRPORTS\HNL_HONOLULU\CAD\PM_-DRAFT\HNL_342285-01_-DRAFT.DWG