

STATE OF HAWAII
DEPARTMENT OF TRANSPORTATION
869 PUNCHBOWL STREET
HONOLULU, HAWAII 96813-5097

JADE T. BUTAY
DIRECTOR

Deputy Directors
ROY CATALANI
ROSS M. HIGASHI
EDWIN H. SNIFFEN
DARRELL T. YOUNG

IN REPLY REFER TO:

Board of Land and
Natural Resources
State of Hawai'i
Honolulu, Hawai'i

ISSUANCE OF A REVOCABLE PERMIT FOR AIRCRAFT PARKING
PAIGE BOWLUS
WAIMEA-KOHALA AIRPORT
TAX MAP KEY: (3) 6-7-001: PORTION OF 08

HAWAI'I

REQUEST:

Issuance of a Revocable Permit for Aircraft Parking (parking permit) to Paige Bowlus, situated at Waimea-Kohala Airport.

LEGAL REFERENCE:

Sections 171-55, Hawai'i Revised Statutes.

APPLICANT:

Paige Bowlus, whose mailing address is P.O. Box 384085, Waikoloa, Hawai'i 96738.

LOCATION AND TAX MAP KEY:

Portion of Waimea Kohala Airport, Kamuela, Island of Hawai'i, identified by
Tax Map Key: (3) 6-7-001: PORTION OF 08

AREA:

Area/Space No. 401-102, containing an area of approximately 990 square feet, as shown on the attached Exhibit A.

ZONING:

State Land Use District:
County of Hawaii:

Agricultural District
A-40A Agriculture

ITEM M-8

BLNR – ISSUANCE OF A REVOCABLE PERMIT FOR AIRCRAFT PARKING
PAIGE BOWLUS, WAIMEA-KOHALA AIRPORT
Page 2

LAND TITLE STATUS:

Section 5(a) lands of the Hawai‘i Admission Act: Non-Ceded
DHHL 30% entitlement lands pursuant to Hawai‘i Admission Act YES ___ NO X

CURRENT USE STATUS:

Airport and aeronautical purposes.

CHARACTER OF USE:

Aircraft tie-down

COMMENCEMENT DATE:

Upon complete execution of the parking permit.

MONTHLY RENTAL:

\$54.00 (as determined from the DOTA schedule of rates and charges established by appraisal of Airports property statewide).

SECURITY DEPOSIT:

\$162.00 (three times the monthly rental)

DCCA VERIFICATION:

Place of business registration confirmed: N/A
Registered business name confirmed: N/A
Good standing confirmed: N/A

REMARKS:

The issuance of a parking permit to Paige Bowlus at Waimea-Kohala Airport complies with Chapter 343, Exemption Class 1.d.10 as a continuing aeronautical use, and is in accordance with Section 171-55 HRS, relating to Permits.

The DOTA consulted with the U.S. Federal Aviation Administration as to the appropriateness of the citation of the Environmental Exemption Class from the Comprehensive list for the Department of Transportation dated November 15, 2000. In this case, the FAA concurred on the appropriateness.

RECOMMENDATION:

That the Board authorize the Department of Transportation to issue a month-to-month parking permit to Paige Bowlus, subject to: (1) terms and conditions herein outlined, which are by reference incorporated herein; and (2) such additional terms and conditions as may be prescribed by the Director of Transportation to best serve the interests of the State.

Respectfully submitted,

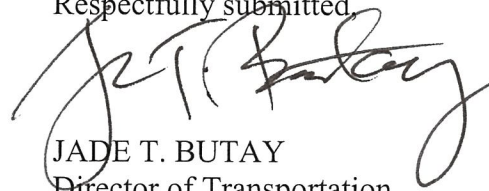

JADE T. BUTAY
Director of Transportation

APPROVED FOR SUBMITTAL:

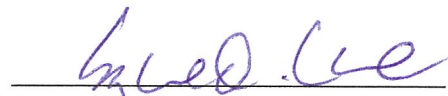

SUZANNE D. CASE
Chairperson and Member

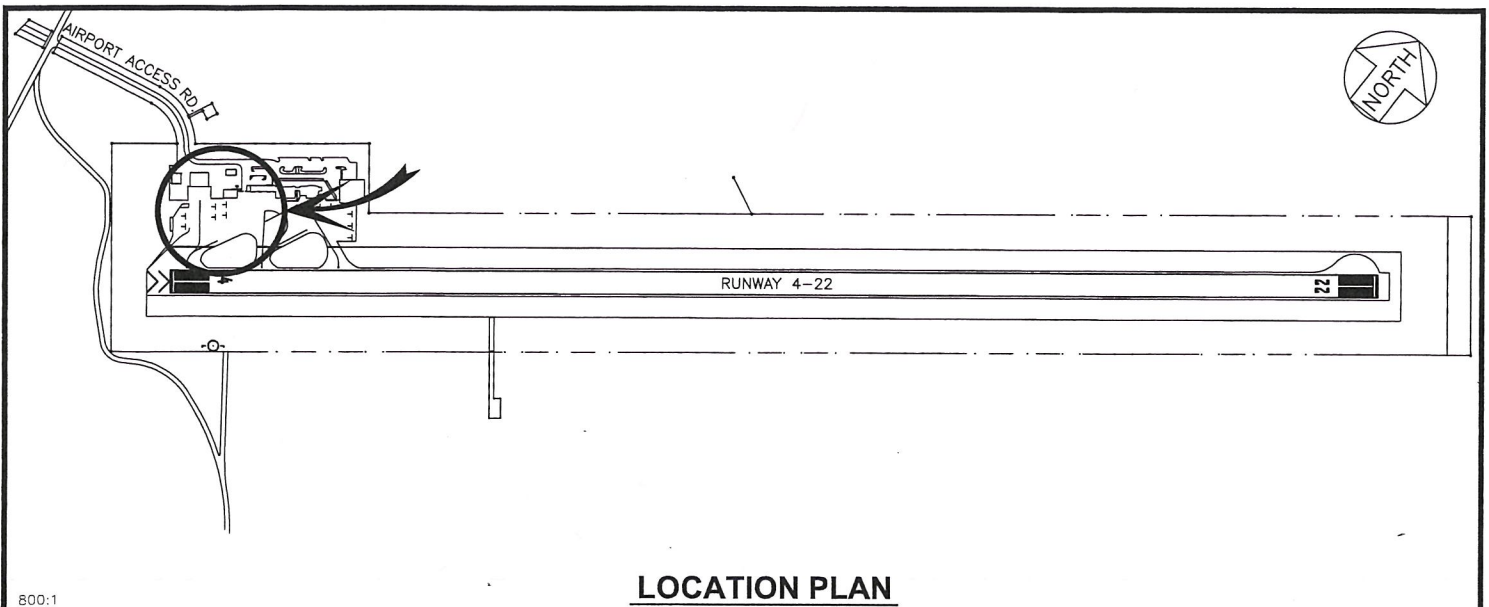

800:1

LOCATION PLAN

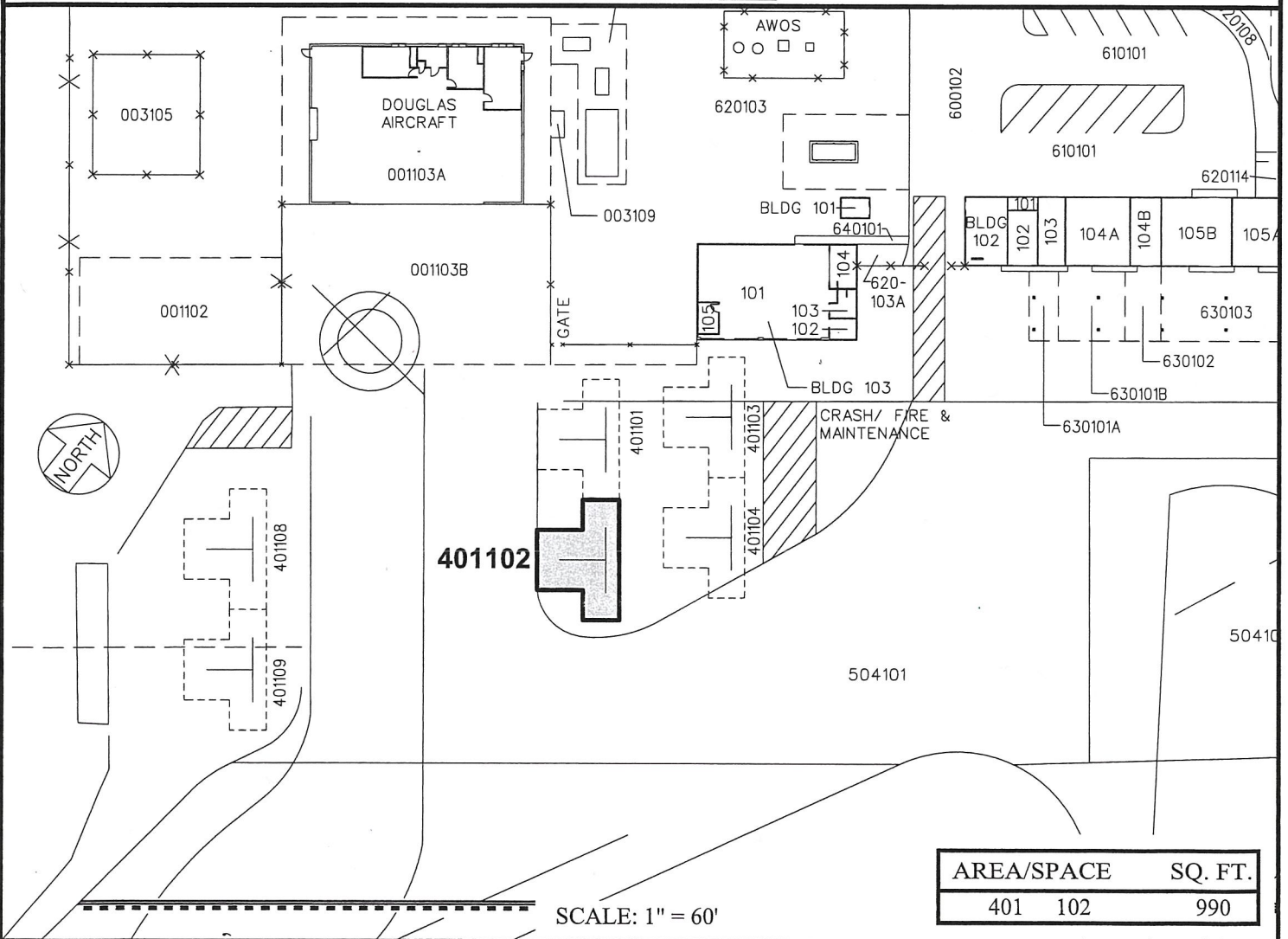

PP-17-N006

DATE : APRIL 2018

EXHIBIT: **A**



PAIGE BOWLUS

TIE-DOWN

401102
PLATS A1, 41