

STATE OF HAWAII  
DEPARTMENT OF LAND AND NATURAL RESOURCES  
Land Division  
Honolulu, Hawaii 96813

July 13, 2018

Board of Land and Natural Resources  
State of Hawaii  
Honolulu, Hawaii

PSF No. 18OD-080

Oahu

Issuance of Right-of-Entry Permit for Five (5) Days to Oahu Hawaiian Canoe Racing Association Hawaii for the Duke Kahanamoku Long Distance Canoe Race Event to be Held One Day Each Year in August 2018, August 2019, August 2020, August 2021, and August 2022, at Waikiki, Honolulu, Oahu, Tax Map Key: (1) 2-3-037: portion of 021.

APPLICANT:

Oahu Hawaiian Canoe Racing Association Hawaii, a domestic nonprofit corporation

LEGAL REFERENCE:

Section 171-55, Hawaii Revised Statutes (HRS), as amended.

LOCATION:

Portion of Government lands of Waikiki, Honolulu, Oahu, identified as tax map key: (1) 2-3-037: portion of 021, as shown on the attached **Exhibit 1**.

AREA:

- 1. VIP & Awards Tent Area: 1,200 square feet
- 2. Canoe Exit/ "De-rigging" Area: 1,800 square feet
- Total Area: 3,000 square feet

ZONING:

State Land Use District: Urban

TRUST LAND STATUS:

Section 5(a) lands of the Hawaii Admission Act  
DHHL 30% entitlement lands pursuant to the Hawaii State Constitution: No

CURRENT USE STATUS:

Requested area is unencumbered

CHARACTER OF USE:

Duke Kahanamoku Long Distance Canoe Race Event

TERM:

From 6 a.m. to 6 p.m. on August 19, 2018, August 18, 2019, August 16, 2020, August 15, 2021, and August 14, 2022.

RENTAL:

\$300.00 (One-time payment based on 10¢ per square foot per event day.)

COLLATERAL SECURITY DEPOSIT:

None

CHAPTER 343 - ENVIRONMENTAL ASSESSMENT:

In accordance with Section 11-200-8, Hawaii Administrative Rules (HAR) and the Exemption List for the Department of Land and Natural Resources concurred with by the Environmental Council and dated June 5, 2015, the subject request is exempt from the preparation of an environmental assessment pursuant to Exemption Class No. 1, Item 51, and Class No. 4. See **Exhibit 2**.

DCCA VERIFICATION:

Place of business registration confirmed:	YES <u>x</u>	NO <u>  </u>
Registered business name confirmed:	YES <u>x</u>	NO <u>  </u>
Applicant in good standing confirmed:	YES <u>x</u>	NO <u>  </u>

REMARKS:

The Oahu Hawaiian Canoe Racing Association Hawaii (OHCRAH) is requesting to conduct beach activities on State owned lands to finalize a canoe race event.

The Duke Kahanamoku Long Distance Canoe Race Event consists of approximately twenty-eight (28) nautical miles. The race is scheduled for Sunday, August 19, 2018, starting at Kailua Beach at approximately 9 a.m. and will finish offshore from the Duke Kahanamoku Beach (Waikiki) between three to five hours later. Once the canoe race is

concluded, specific areas of the beach will then be utilized by the Applicant for closing purposes of the race day's event.

Set-up for the event on Duke Kahanamoku Beach is scheduled to begin at 6 a.m. and teardown is scheduled for 6 p.m. later that day. The Applicant requests that the Board approve a right-of-entry permit for its use of two (2) specific areas of the subject beach. The right-of-entry permit request includes Beach Areas: 1 and 3, only. See **Exhibit 3**.

Beach Area 1 will be a tented area located nearby to the Ala Wai Boat Harbor. This area will be utilized for the awards presentation, hospitality purposes, and to house materials for the event.

Beach Area 3 is the canoe exit area fronting the parking lot of the Ala Wai Boat Harbor. This area is also located adjacent to the shoreline where the canoes will land onto the beach. The canoes will be "de-rigged" within this area in preparation for their removal and exit onto trailers located in the nearby parking lot.

According to the Applicant, a request has been made for access to the Hilton Hawaiian Village Pier (currently encumbered under Revocable Permit No. 7566), located adjacent to where the finish line of the canoe race event will be designated. Revocable Permit No. 7566 requires a \$1.50 toll fee per paying customer. However, it is the staff's understanding that the Hilton Hawaiian Village (HHV) will not be charging a fee to any of the canoe race officials nor to its participants for the use of the subject pier. Therefore, staff is of the opinion that HHV will not be required to pay the State for the toll fee.

The subject request pertains to the same race for the next five years, with the dates described in the TERM section. The Board has previously authorized 5-year permit requests for the Molokai Hoe and Na Wahine O Ke Kai canoe races. As such, staff has no objections to a similar 5-year permit being granted for the Duke Kahanamoku canoe race event.

The Office of Conservation and Coastal Lands and Division of Boating and Ocean Recreation has no comment on the subject request and concurs with the exemption for an environmental assessment.

Applicant has not had a lease, permit, easement or other disposition of State lands terminated within the past five years due to non-compliance with such terms and conditions.

There are no other pertinent issues and concerns regarding the subject request.

**RECOMMENDATION:** That the Board

1. Declare that, after considering the potential effects of the proposed disposition as provided by Chapter 343, HRS, and Chapter 11-200, HAR, this activity will probably have minimal or no significant effect on the environment and is

therefore exempt from the preparation of an environmental assessment.

2. Authorize the issuance of a right-of-entry permit to Oahu Hawaiian Canoe Racing Association Hawaii covering the subject area for the Duke Kahanamoku Long Distance Canoe Race Event under the terms and conditions cited above, which are by this reference incorporated herein and further subject to the following:
  - a. The standard terms and conditions of the most current right-of-entry form, as may be amended from time to time; and
  - b. Such other terms and conditions as may be prescribed by the Chairperson to best serve the interests of the State.

Respectfully Submitted,

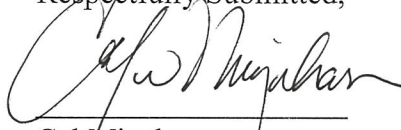

Cal Miyahara  
Shoreline Disposition Specialist

APPROVED FOR SUBMITTAL:

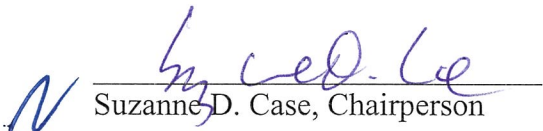

Suzanne D. Case, Chairperson

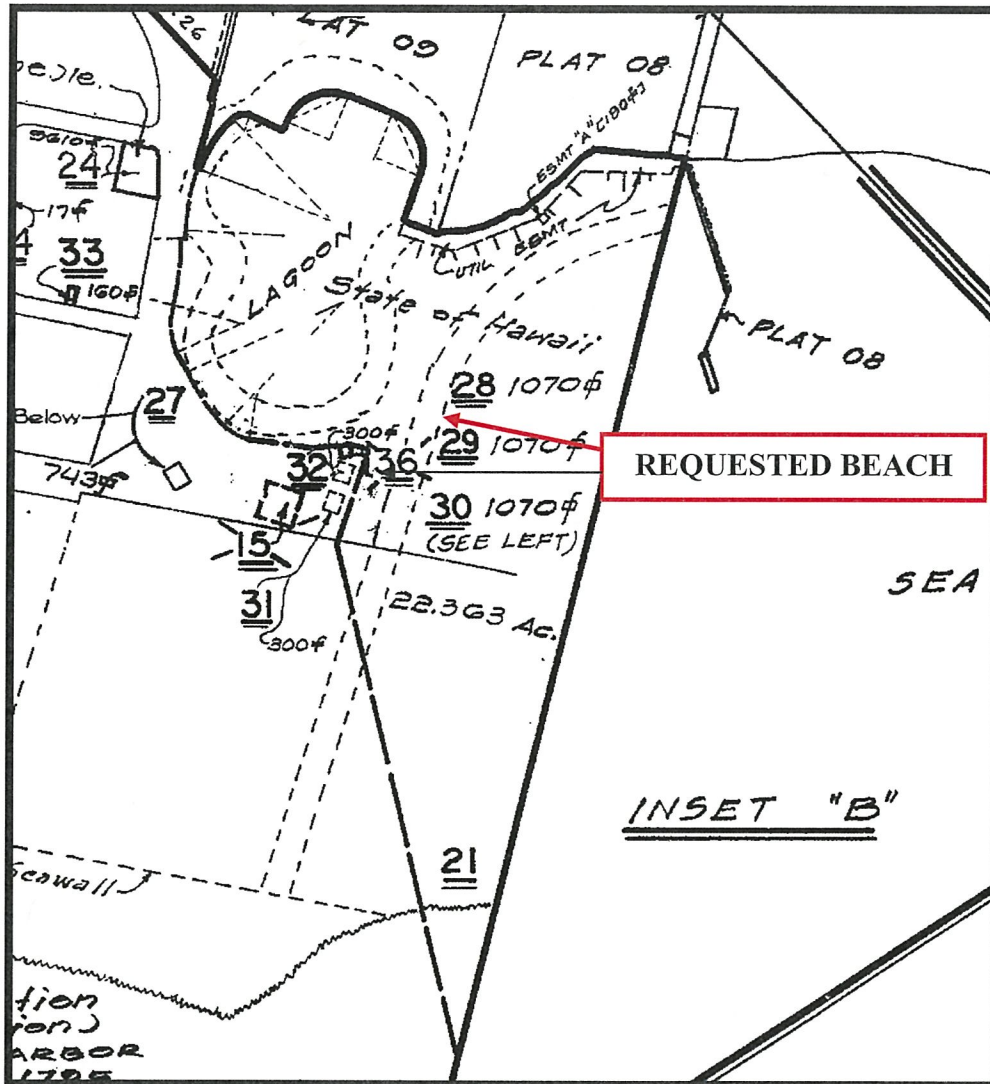

TAX MAP KEY: (1) 2-3-037: PORTION OF 21

# EXHIBIT 1

## EXEMPTION NOTIFICATION

Regarding the preparation of an environmental assessment pursuant to Chapter 343, HRS and Chapter 11-200, HAR

Project Title: Canoe Race Event

Project / Reference No.: PSF 18OD-080

Project Location: Waikiki, Honolulu, Oahu, Tax Map Key: (1) 2-3-037: portion of: 021.

Project Description: Issuance of a Right-of-Entry Permit to Oahu Hawaiian Canoe Racing Association Hawaii for the Duke Kahanamoku Canoe Race Event

Chap. 343 Trigger(s): Use of State Land.

Exemption Class No.: In accordance with Hawaii Administrative Rule Section 11-200-8 and the Exemption List for the Department of Land and Natural Resources concurred with by the Environmental Council and dated June 5, 2015, the subject request is exempt from the preparation of an environmental assessment pursuant to Exemption Class No. 1, Item 51, which states the "Permits, licenses, registrations, and rights-of-entry issued by the Department that are routine in nature, involving negligible impacts beyond that previously existing " and Class No. 4, that states "Minor alteration in the conditions of land, water, or vegetation."

Cumulative Impact of Planned Successive Actions in Same Place Significant?: No, similar events occur at the same location annually, but not on a routine or regular basis (e.g., daily or weekly). As such, staff believes that there would be no significant cumulative impact as a result of the event.

Action May Have Significant Impact on Particularly Sensitive Environment?: The requested area is a portion of State beach visited by tourists and residents, and is heavily impacted by human activity. Public access across the requested area is maintained by the Hilton Hawaiian Village staff. In addition, based on the analysis below, staff believes there would be no significant impact to sensitive environmental or ecological receptors.

**EXHIBIT 2**

- Consulted Parties: Consulted with Office of Conservation and Coastal Lands who has no objections to the subject request and concurs with the exemption for an environmental assessment.
- Analysis: The Board has permitted similar events in the past. The proposed activity is of a similar type and scope of beach activities that periodically occurred and continues to occur on this and other beach areas across the State. Such activities have resulted in no known significant impacts, whether immediate or cumulative, to the natural, environmental and/or cultural resources in the area. Staff also believes that the request would involve negligible or no expansion or change in use of the subject area beyond that previously existing.
- Recommendation: It is recommended that the Board find that this project will probably have minimal or no significant effect on the environment and is presumed to be exempt from the preparation of an environmental assessment.

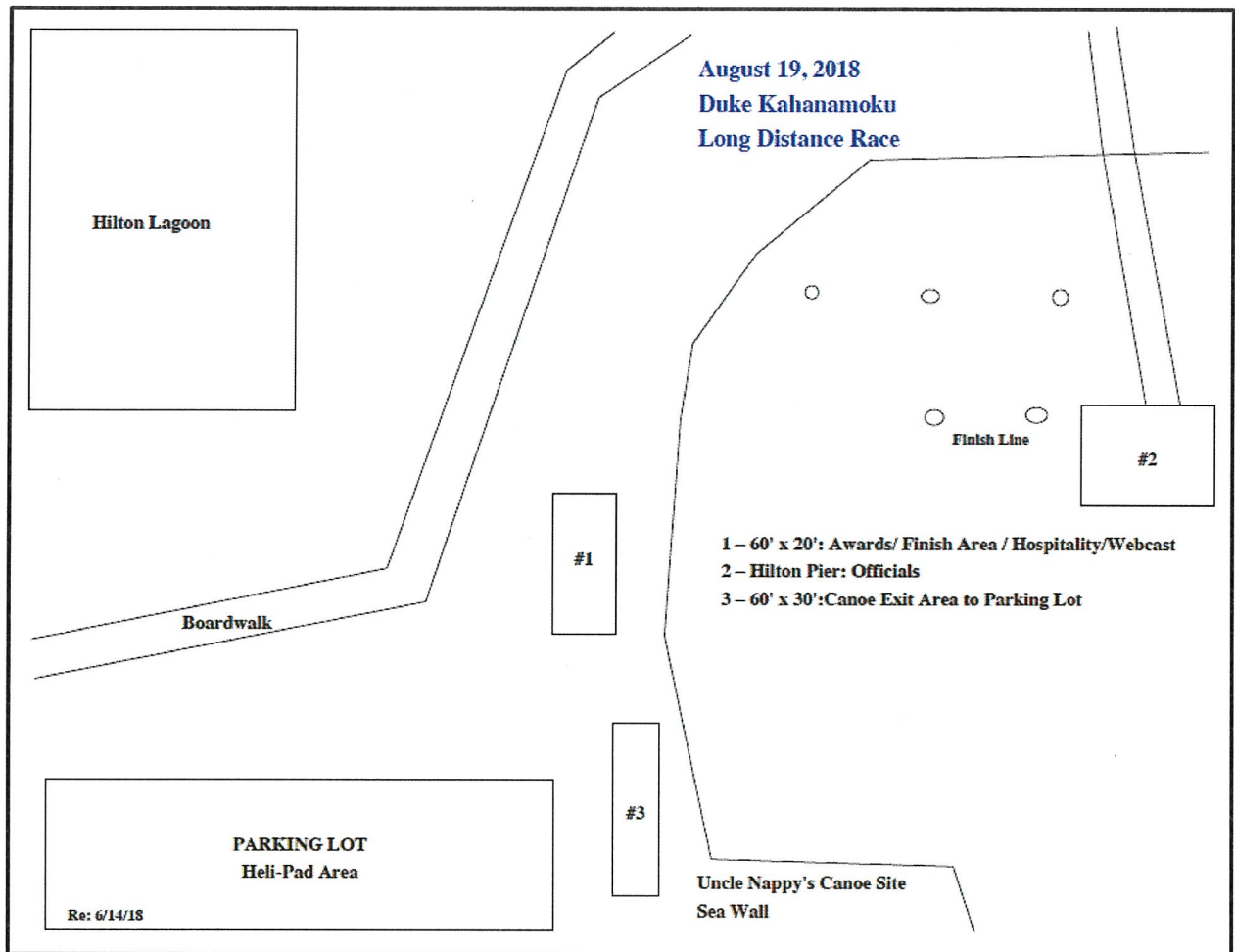

### EXHIBIT 3