

STATE OF HAWAII
DEPARTMENT OF TRANSPORTATION
869 PUNCHBOWL STREET
HONOLULU, HAWAII 96813-5097

Board of Land and
Natural Resources
State of Hawai'i
Honolulu, Hawai'i

ISSUANCE OF A REVOCABLE PERMIT FOR WAREHOUSE SPACE
FOR THE OPERATION AND MAINTENANCE OF AN IMPORT/EXPORT
BUSINESS OF MARINE ORNAMENTALS
HAWAIIAN SEALIFE INC.
DANIEL K. INOUE INTERNATIONAL AIRPORT
TAX MAP KEY: (1) 1-1-4: 21 (PORTION)

O'AHU

REQUEST:

Issuance of a revocable permit for warehouse space to Hawaiian Sealife Inc. for the operation and maintenance of an import/export business of marine ornamentals.

LEGAL REFERENCE:

Sections 171-55 and 261-7, Hawai'i Revised Statutes (HRS).

APPLICANT/LESSEE:

Hawaiian Sealife Inc., a Hawaii Corporation, authorized to do business in the State of Hawai'i, whose business address is 3239 Ualena Street, Honolulu, Hawai'i 96819.

LOCATION AND TAX MAP KEY:

A portion of Daniel K. Inouye International Airport, Island of O'ahu, State of Hawai'i, identified by Tax Map Key: 1st Division, 1-1-4: 21 (Portion).

AREA:

Bldg/Room No. 184-102, containing an area of approximately 5,062 square feet, as shown and delineated on the attached map labeled Exhibit A.

ZONING:

State Land Use District: Urban
City and County of Honolulu: I-2 (Industrial)

ITEM M-1

BLNR – ISSUANCE OF A REVOCABLE PERMIT FOR WAREHOUSE SPACE FOR THE OPERATION AND MAINTENANCE OF AN IMPORT/EXPORT BUSINESS OF MARINE ORNAMENTALS, HAWAIIAN SEALIFE INC.

Page 2

LAND TITLE STATUS:

Non-ceded – Direct purchase from private land owner.

DHHL 30% entitlement lands pursuant to the Hawai‘i State Constitution: YES ___ NO X

CURRENT USE STATUS:

Land presently encumbered by Governor’s Executive Order No. 3894, setting aside a portion of Daniel K. Inouye International Airport under the control and management of the Department of Transportation, Airports Division, State of Hawai‘i, for Airport purposes.

The Department of Transportation, Airports Division acquired the subject property together with most of the remaining properties (except one) along the ocean (makai) side of Ualena Street, between Lagoon Drive and Paiea Street, in the mid 1990’s from Loyalty Enterprises, Ltd.

CHARACTER OF USE:

Hawaiian Sealife Inc. will use the space as a warehouse for the operation and maintenance of an import/export business of marine ornamentals.

COMMENCEMENT DATE:

Upon execution of the revocable permit.

MONTHLY RENTAL:

\$8,554.78 (as determined from the DOTA schedule of rates and charges established by appraisal of Airports property statewide plus \$1,974.18 for utilities).

SECURITY DEPOSIT:

Three (3) times the monthly rent in effect.

DCCA VERIFICATION:

Place of business registration confirmed:	YES <u>X</u>	NO ___
Registered business name confirmed:	YES <u>X</u>	NO ___
Good standing confirmed:	YES <u>X</u>	NO ___

BLNR – ISSUANCE OF A REVOCABLE PERMIT FOR WAREHOUSE SPACE FOR THE OPERATION AND MAINTENANCE OF AN IMPORT/EXPORT BUSINESS OF MARINE ORNAMENTALS, HAWAIIAN SEALIFE INC.

Page 3

CHAPTER 343, HRS - ENVIRONMENTAL ASSESSMENT:

Pursuant to Section 11-200-8(a), Environmental Impact Statement Rules of the Department of Health, State of Hawai'i, this disposition is exempt from requirements regarding preparation of an environmental assessment, negative declaration, or environmental impact statement as required by Chapter 343, Hawai'i Revised Statutes, as amended, relating to Environmental Impact Statements, because the proposed action falls within Exemption Class #1, Comprehensive Exemption List for the State of Hawai'i, Department of Transportation dated November 14, 1990, as approved by the Environmental Quality Council. Exemption Class #1 covers operations, repairs, or maintenance of existing structures, facilities, equipment, or topographical features involving negligible or no expansion or change of use beyond that previously existing.

The DOTA consulted with the U.S. Federal Aviation Administration as to the appropriateness of the citation of the Environmental Exemption Class from the Comprehensive list for the Department of Transportation dated November 15, 2000. The FAA concurred on the appropriateness.

REMARKS:

In accordance with Sections 171-55, HRS, relating to Permits, and 261-7, HRS, relating to Operation and Use Privileges, the Department of Transportation proposes to issue a month-to-month revocable permit to Hawaiian Sealife Inc. for warehouse space for the operation and maintenance of an import/export business of marine ornamentals at Daniel K. Inouye International Airport.

RECOMMENDATION:

That the Board authorize the Department of Transportation to issue a month-to-month revocable permit to Hawaiian Sealife Inc., subject to: (1) terms and conditions herein outlined, which are by reference incorporated herein; (2) such additional terms and conditions as may be prescribed by the Director of Transportation to best serve the interests of the State.

Respectfully submitted,

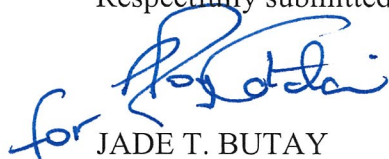

for

JADE T. BUTAY

Director of Transportation

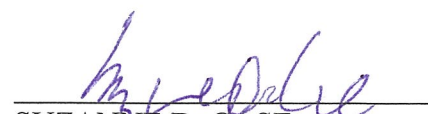
APPROVED FOR SUBMITTAL:

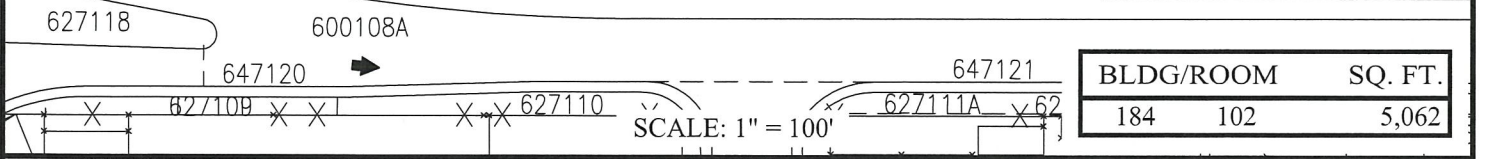
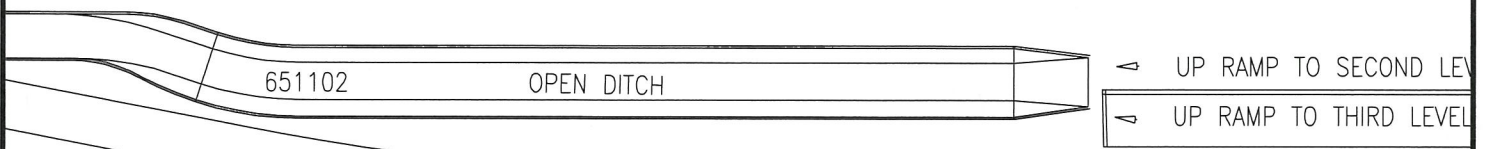
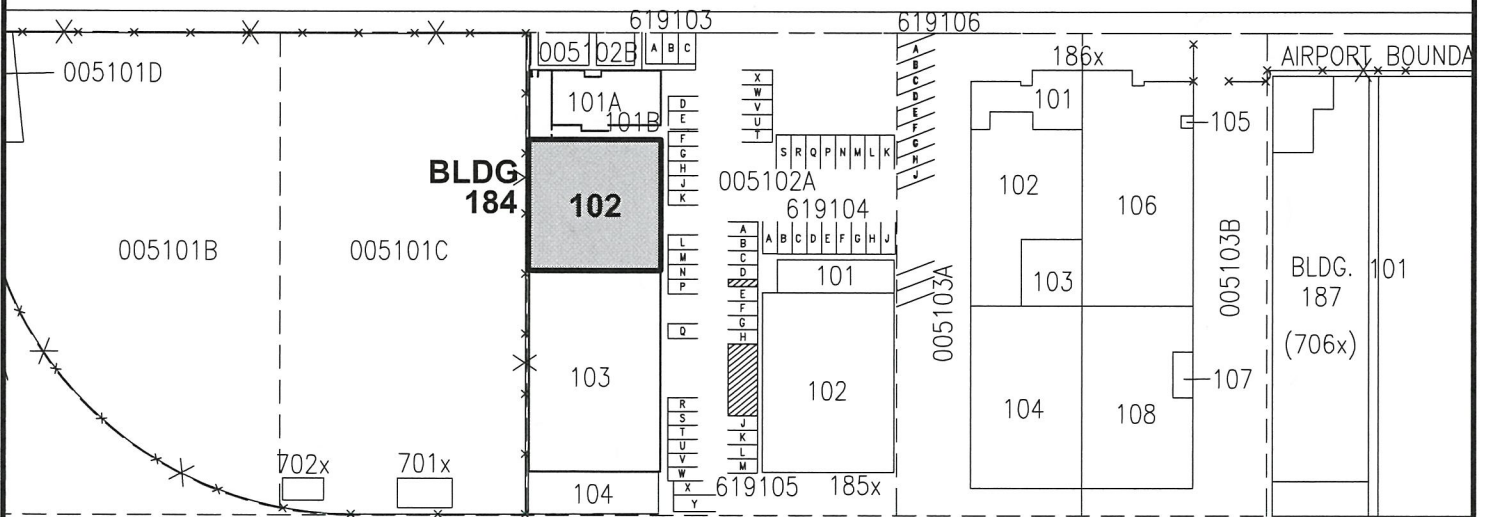
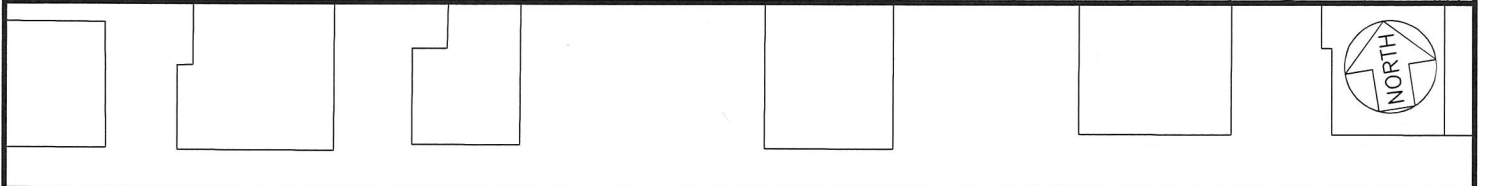
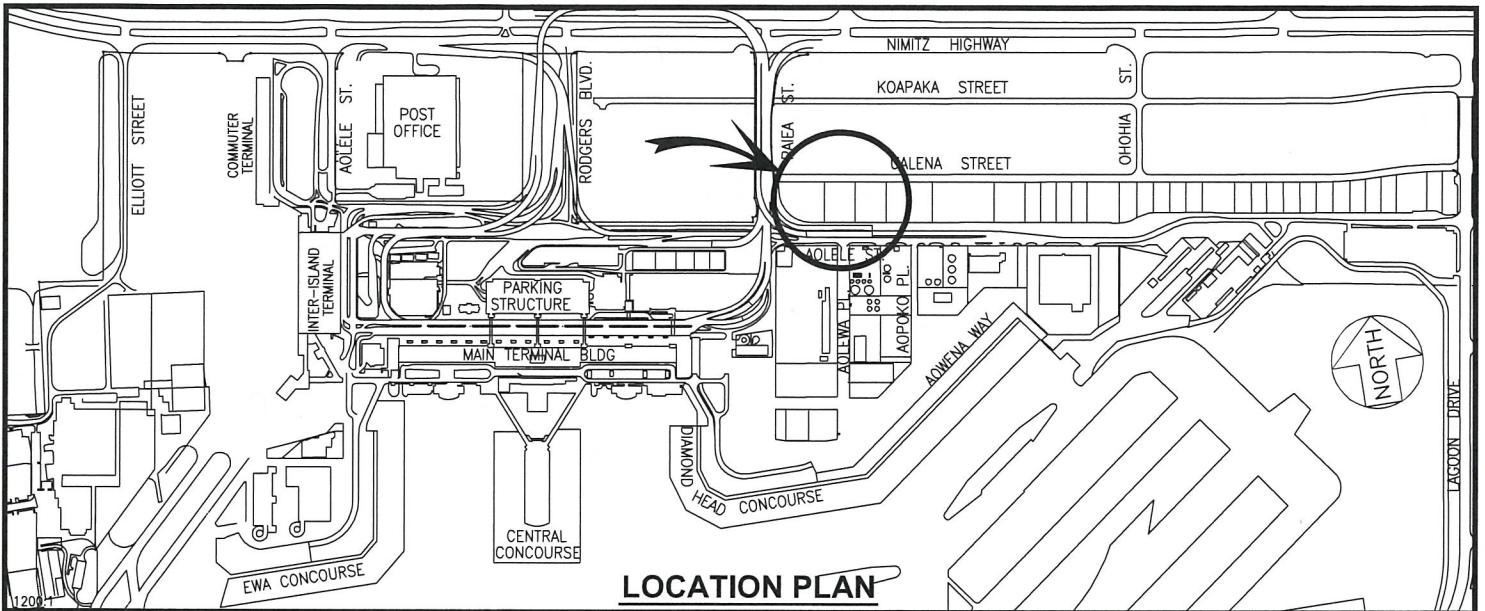
SUZANNE D. CASE
Chairperson and Member



BLDG/ROOM	SQ. FT.
184 102	5,062

DATE : JUNE 2018

EXHIBIT: **A**



HAWAIIAN SEALIFE INC.

**BUILDING 184
3239 UALENA ST
GROUND LEVEL**

**184102
PLAT 16**