

DAVID Y. IGE  
GOVERNOR

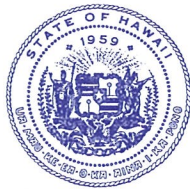

**STATE OF HAWAII**  
**DEPARTMENT OF TRANSPORTATION**  
869 PUNCHBOWL STREET  
HONOLULU, HAWAII 96813-5097

JADE T. BUTAY  
DIRECTOR

Deputy Directors  
ROY CATALANI  
ROSS M. HIGASHI  
EDWIN H. SNIFFEN  
DARRELL T. YOUNG

IN REPLY REFER TO:

Board of Land and  
Natural Resources  
State of Hawai'i  
Honolulu, Hawai'i

ISSUANCE OF A REVOCABLE PERMIT FOR AIRCRAFT PARKING  
SKY-MED, INC. DBA PACIFIC INTERNATIONAL SKY DIVING CENTER  
KAWAIHĀPAI AIRFIELD, WAIALUA, HAWAI'I O'AHU  
TAX MAP KEY: (1) 6-08-14:001 (PORTION)

REQUEST:

Issuance of a Revocable Permit for Aircraft Parking (Parking Permit) to Sky-Med, Inc.  
dba Pacific International Sky Diving Center, situated at Kawaihāpai Airfield.

LEGAL REFERENCE:

Section 171-55, Hawai'i Revised Statutes.

APPLICANT:

Sky-Med, Inc. dba Pacific International Sky Diving Center, whose mailing address is  
68-760 Farrington Highway, Waialua, Hawai'i 96791.

LOCATION:

A portion of Kawaihāpai Airfield, Waialua, Island of O'ahu, State of Hawai'i, identified  
by Tax Map Key: 1<sup>st</sup> Division, 6-08-14:001 (portion).

AREA:

Area/Space No. 404-106, containing an area of approximately 1,350 square feet, as  
shown and delineated on the attached map labeled Exhibit A.

**ITEM M-4**

BLNR – ISSUANCE OF A REVOCABLE PERMIT FOR AIRCRAFT PARKING  
SKY-MED, INC. DBA PACIFIC INTERNATIONAL SKY DIVING CENTER  
PAGE 2

ZONING:

State Land Use District: Agriculture  
City and County of Honolulu LUO: AG-2

LAND TITLE STATUS:

Ceded land, which the State of Hawai'i is currently leasing the land from the United States of America.

CHARACTER OF USE:

Aircraft tie-down (2004 Cessna 208B, Tail No. N-900SA).

COMMENCEMENT DATE:

To be determined by the Director of Transportation at a later date.

MONTHLY RENTAL:

\$54.00 (as determined from the DOTA schedule of rates and charges established by appraisal of Airports property statewide).

SECURITY DEPOSIT:

Three (3) times the monthly rental in effect

CHAPTER 343, HRS - ENVIRONMENTAL ASSESSMENT:

The subject land area is covered by the revised and updated Environmental Assessment for the Dillingham Airfield Master Plan and FAR Part 150 Noise Compatibility Program project, referenced as State Contract No. 26985, State Project No. AO2011-01. This Environmental Assessment evaluated the environmental effects of the recommended Dillingham Airfield Master Plan to meet existing and forecast general aviation demands and was prepared for the State of Hawai'i, Department of Transportation, Airports Division.

REMARKS:

The issuance of a Parking Permit to Sky-Med, Inc. dba Pacific International Sky Diving Center for aircraft parking at Kawaihāpai Airfield complies with Chapter 343, Exemption Class 1.D.10 as a continuing aeronautical use, and is in accordance with Section 171-55 HRS, relating to Permits.

BLNR – ISSUANCE OF A REVOCABLE PERMIT FOR AIRCRAFT PARKING  
SKY-MED, INC. DBA PACIFIC INTERNATIONAL SKY DIVING CENTER  
PAGE 3

RECOMMENDATION:

That the Board authorize the Department of Transportation to issue a month-to-month Parking Permit to Sky-Med, Inc. dba Pacific International Sky Diving Center, subject to:  
(1) terms and conditions herein outlined, which are by reference incorporated herein; and  
(2) such additional terms and conditions as may be prescribed by the Director of Transportation to best serve the interests of the State.

Respectfully submitted,

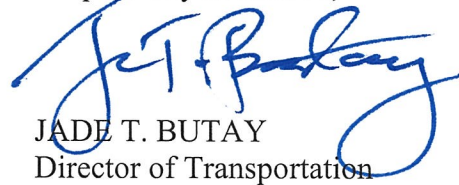

JADE T. BUTAY  
Director of Transportation

APPROVED FOR SUBMITTAL:

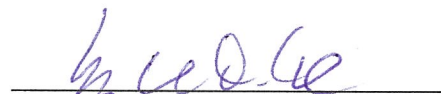

SUZANNE D. CASE  
Chairperson and Member

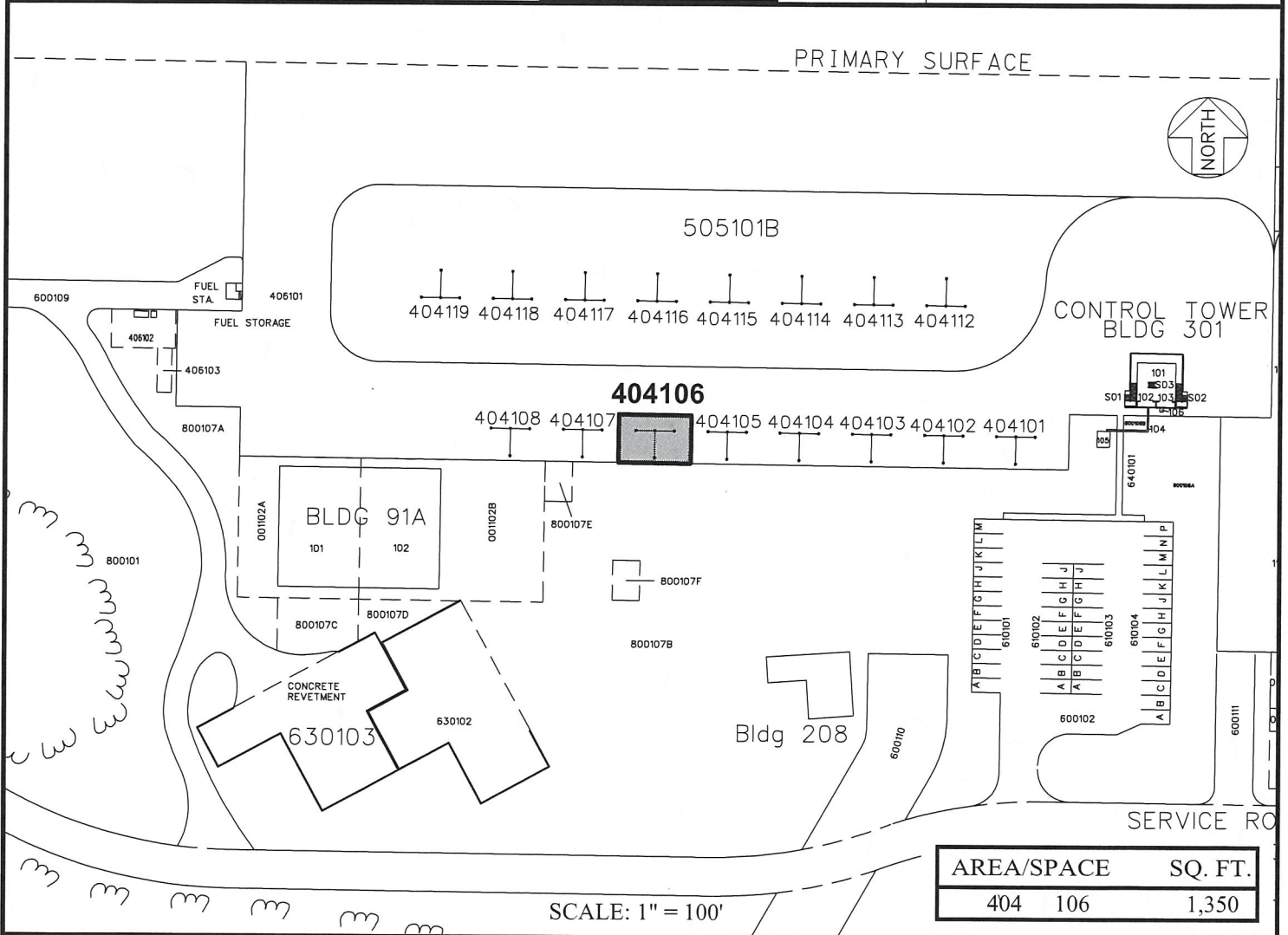
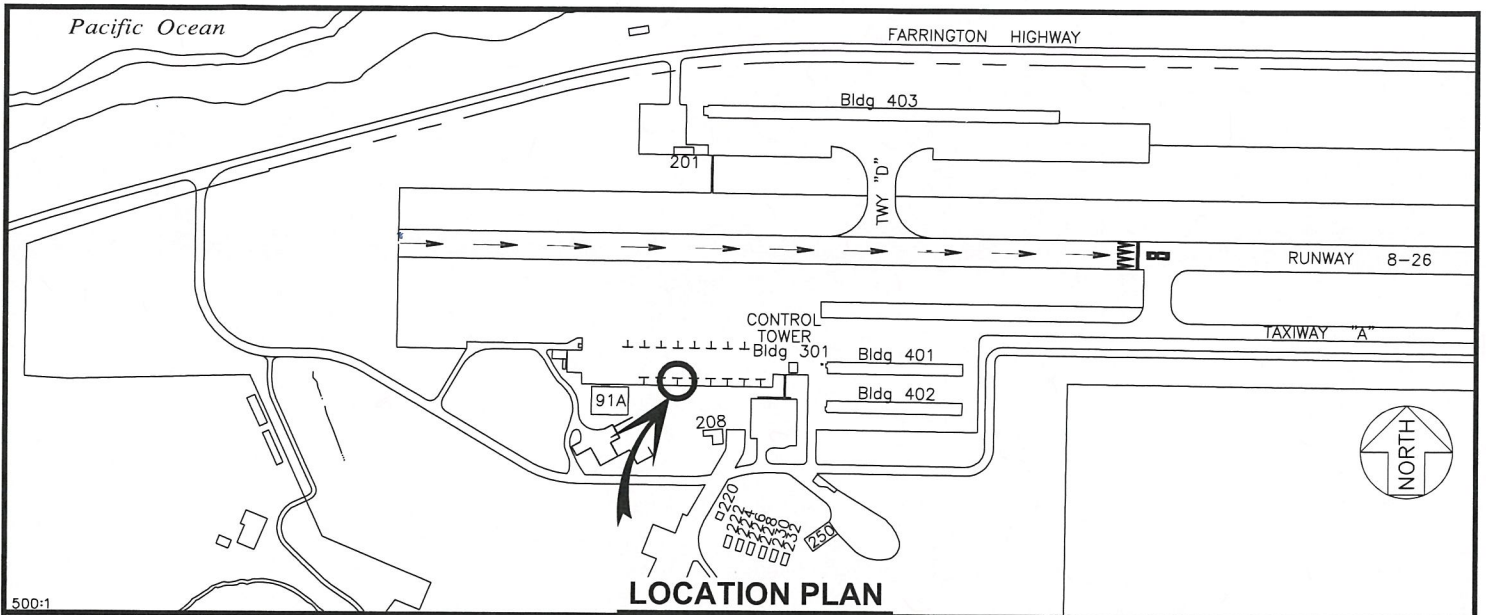

DATE : APRIL 2018

EXHIBIT: **A**



Airports Division

SKY-MED, INC.

TIE DOWN  
GENERAL AVIATION  
FACILITIES

404106

PLAT B1

**DILLINGHAM AIRFIELD**