

DAVID Y. IGE
GOVERNOR



STATE OF HAWAII
DEPARTMENT OF TRANSPORTATION
869 PUNCHBOWL STREET
HONOLULU, HAWAII 96813-5097

JADE T. BUTAY
DIRECTOR

Deputy Directors
ROY CATALANI
ROSS M. HIGASHI
EDWIN H. SNIFFEN
DARRELL T. YOUNG

IN REPLY REFER TO:

Board of Land and
Natural Resources
State of Hawai'i
Honolulu, Hawai'i

ISSUANCE OF A REVOCABLE PERMIT FOR
PARKING AND STORAGE OF RENTAL CAR VEHICLES
EAN HOLDINGS, LLC
LĪHU'E AIRPORT
TAX MAP KEY: (4) 3-5-01: PORTION OF 8

KAUA'I

APPLICANT:

EAN Holdings, LLC, whose business address is 820 Mililani Street, Honolulu, Hawai'i 96813.

LEGAL REFERENCE:

Section 171-11 and 171-55, Hawai'i Revised Statutes.

LOCATION AND TAX MAP KEY:

Līhu'e, Island of Kaua'i Airport
Tax Map Key: 4th Division, 3-5-01: Portion of 8

AREA:

Space No. 820-114, 820-119, 820-121 and 820-122, containing a total area of approximately 74,000 square feet of unimproved, unpaved land as delineated on the attached Exhibit A dated June 2018.

ZONING:

State Land Use District:	Urban
County of Kaua'i:	Industrial (IG-STP)

LAND TITLE STATUS:

Section 5(b) lands of the Hawai'i Admissions Act: Non-Ceded
DHHL 30% entitlement lands pursuant to the Hawai'i State Constitution: No

CHARACTER OF USE:

Parking and storage of rental car vehicles.

COMMENCEMENT DATE:

Upon complete execution of the revocable permit.

MONTHLY RENTAL:

\$ 5,365.00 (as determined from the DOTA schedule or rates and charges established by
appraisal of Airports property statewide).

SECURITY DEPOSIT:

\$ 16,095.00

HOLDOVER TENANCY:

\$ 178.83

DCCA VERIFICATION:

Place of business registration confirmed:	YES <u>X</u>	NO <u> </u>
Registered business name confirmed:	YES <u>X</u>	NO <u> </u>
Good standing confirmed:	YES <u>X</u>	NO <u> </u>

CHAPTER 343, HRS – ENVIRONMENTAL ASSESSMENT:

Pursuant to Section 11-200-8 (a), Environmental Impact Statement Rules of the Department of Health, State of Hawai'i, this disposition is exempt from requirements regarding preparation of an environmental assessment, negative declaration, or environmental impact statement as required by Chapter 343, Hawai'i Revised Statutes, as amended, relating to Environmental Impact Statements because the proposed action falls within Exemption Class #1, Comprehensive Exemption List for the State of Hawai'i, Department of Transportation Amended November 15, 2000, as approved by the Environmental Quality Council. Exemption Class #1 covers operations, repairs, or maintenance of existing structures, facilities, equipment, or topographical features involving negligible or no expansion or change of use beyond that previously existing.

BLNR – ISSUANCE OF A REVOCABLE PERMIT FOR PARKING AND STORAGE OF RENTAL CAR VEHICLES, EAN HOLDINGS, LLC

Page 3

The DOTA consulted with the U.S. Federal Aviation Administration as to the appropriateness of the citation of the Environmental Exemption Class from the Comprehensive list for the Department of Transportation dated November 15, 2000. In this case, the FAA concurred on the appropriateness.

REMARKS:

The DOT has no objections to EAN Holdings, LLC request and therefore, in accordance with Sections 171-11 and 171-55, HRS, relating to Public Purposes and Permits respectively, the DOT proposes to issue a month-to-month revocable permit to EAN Holdings, LLC, Space Nos. 820-114, 820-119, 820-121, and 820-122 at Līhu'e Airport.

RECOMMENDATION:

That the Board authorize the Department of Transportation to issue a month-to-month revocable permit to EAN Holdings, LLC, subject to: (1) terms and conditions herein outlined, which are by reference incorporated herein; and (2) such additional terms and conditions as may be prescribed by the Director of Transportation to best serve the interests of the State.

Respectfully submitted,

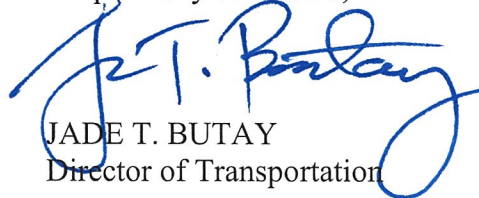
JADE T. BUTAY
Director of Transportation

APPROVAL FOR SUBMITTAL:

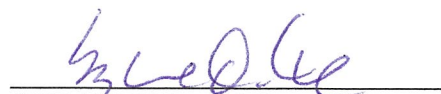
SUZANNE D. CASE
Chairperson and Member

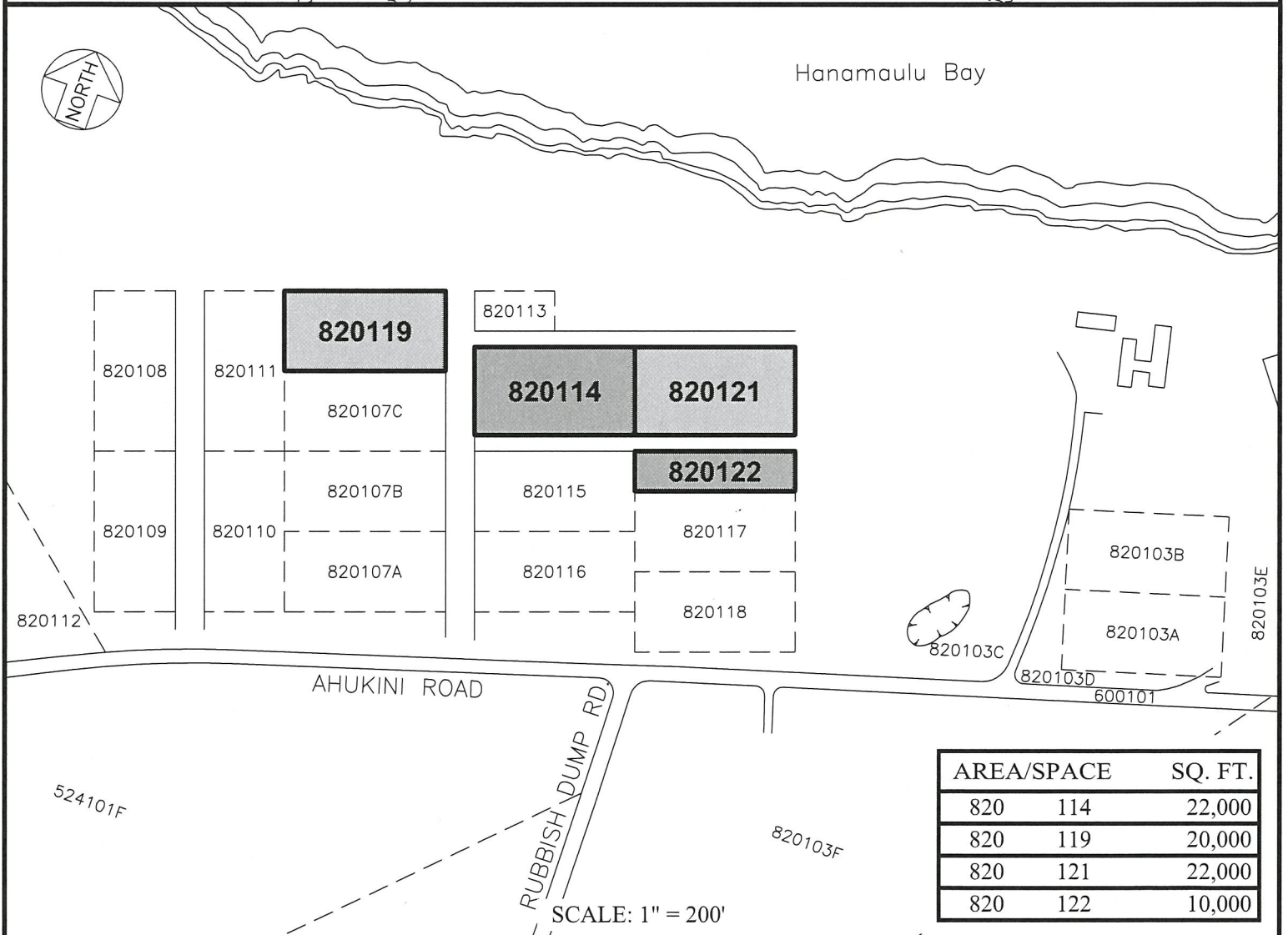
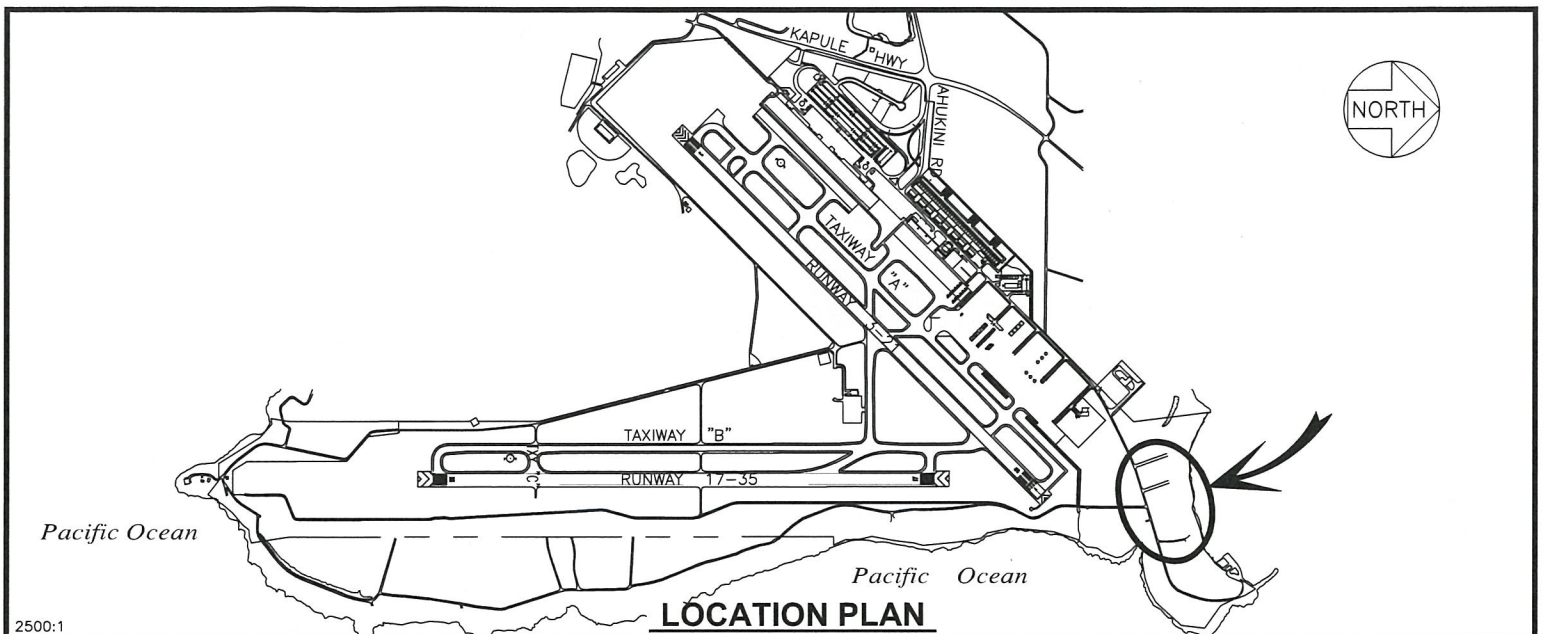

RP-8751

DATE : JUNE 2018

EXHIBIT: **A**



Airports Division

EAN HOLDINGS LLC

UNIMPROVED LAND

820-114
820-119
820-121-122
PLAT 26

LIHUE AIRPORT

N:\AIRPORTS\LIH_Lihue\CAD\PM\lih_820114-02_draft.dwg